

Please Note: This report was completed with the following assumptions: Market Approach: **Fair Market Price** , Marketing Time: **Typical** . Important additional information relating to this report, including use and restrictions, is contained in an attached addendum which is an integral part of this report.

Address	1962 King Hill Street, Las Vegas, NV 89106	Order ID	6124348	Property ID	26286762
Inspection Date	04/02/2019	Date of Report	04/02/2019		
Loan Number	21917	APN	139-20-715-130		
Borrower Name	CRE	County	Clark		

Tracking IDs					
Order Tracking ID	CS_AgedBPOs_4.1.19	Tracking ID 1	CS_AgedBPOs_4.1.19		
Tracking ID 2	--	Tracking ID 3	--		

General Conditions		
Owner	Champery Real Estate 2015 LLC	Condition Comments
R. E. Taxes	\$43,228	Subject appear to be in average condition. Little to no upgrades. No visible damage to the subject.
Assessed Value	\$32,448	
Zoning Classification	Single	
Property Type	SFR	
Occupancy	Occupied	
Ownership Type	Fee Simple	
Property Condition	Average	
Estimated Exterior Repair Cost	\$0	
Estimated Interior Repair Cost	\$0	
Total Estimated Repair	\$0	
HOA	Summit Hill 702-304-9455	
Association Fees	\$80 / Month (Other: Security)	
Visible From Street	Visible	
Road Type	Public	

Neighborhood & Market Data		
Location Type	Urban	Neighborhood Comments
Local Economy	Stable	Residential neighborhood. No known community amenities.
Sales Prices in this Neighborhood	Low: \$205,000 High: \$234,000	
Market for this type of property	Remained Stable for the past 6 months.	
Normal Marketing Days	<90	

Current Listings

	Subject	Listing 1 *	Listing 2	Listing 3
Street Address	1962 King Hill Street	1632 Wendell Williams Ave	2300 Shady Hill Ave	1908 Lone Hill St
City, State	Las Vegas, NV	Las Vegas, NV	Las Vegas, NV	Las Vegas, NV
Zip Code	89106	89106	89106	89106
Datasource	Tax Records	MLS	MLS	MLS
Miles to Subj.	--	0.41 ¹	0.21 ¹	0.19 ¹
Property Type	SFR	SFR	SFR	SFR
Original List Price \$	\$	\$207,900	\$215,000	\$235,000
List Price \$	--	\$207,900	\$215,000	\$229,900
Original List Date		03/31/2019	10/01/2018	02/13/2019
DOM · Cumulative DOM	-- · --	1 · 2	182 · 183	47 · 48
Age (# of years)	23	18	22	22
Condition	Average	Average	Average	Good
Sales Type	--	Fair Market Value	Fair Market Value	Fair Market Value
Location	Neutral ; Residential	Neutral ; Residential	Neutral ; Residential	Neutral ; Residential
View	Neutral ; Residential	Neutral ; Residential	Neutral ; Residential	Neutral ; Residential
Style/Design	1 Story Contemporary	1 Story Contemporary	1 Story Contemporary	1 Story Contemporary
# Units	1	1	1	1
Living Sq. Feet	1,244	1,309	1,244	1,244
Bdrm · Bths · ½ Bths	4 · 2	3 · 2	4 · 2	4 · 2
Total Room #	6	5	6	6
Garage (Style/Stalls)	Attached 2 Car(s)	Attached 2 Car(s)	Attached 2 Car(s)	Attached 2 Car(s)
Basement (Yes/No)	No	No	No	No
Basement (% Fin)	0%	0%	0%	0%
Basement Sq. Ft.	--	--	--	--
Pool/Spa	--	--	--	--
Lot Size	0.14 acres	0.09 acres	0.09 acres	0.15 acres
Other	--	--	--	--

* Listing 1 is the most comparable listing to the subject.

¹ Comp's "Miles to Subject" was calculated by the system.

² Comp's "Miles to Subject" provided by Real Estate Professional.

³ Subject \$/ft based upon as-is sale price.

Listing Comments Why the comparable listing is superior or inferior to the subject.

Listing 1 Little to no upgrades. Carpet and tile flooring. Low maintenance landscaping. Similar location views as the subject.

Listing 2 Grass landscaping. Low maintenance landscaping. Gated community. Similar location views as the subject. Little to no upgrades.

Listing 3 Property has been remodeled. Several upgrades throughout. Similar GLA as the subject. Grass landscaping. Adjustments for upgrades.

Recent Sales

	Subject	Sold 1 *	Sold 2	Sold 3
Street Address	1962 King Hill Street	1643 Marion Bennet Dr	2128 Patriotic Ln	2210 Cool River Ct
City, State	Las Vegas, NV	Las Vegas, NV	North Las Vegas, NV	North Las Vegas, NV
Zip Code	89106	89106	89032	89032
Datasource	Tax Records	MLS	MLS	MLS
Miles to Subj.	--	0.39 ¹	0.49 ¹	0.32 ¹
Property Type	SFR	SFR	SFR	SFR
Original List Price \$	--	\$205,000	\$220,000	\$225,000
List Price \$	--	\$205,000	\$205,000	\$225,000
Sale Price \$	--	\$205,000	\$211,000	\$225,000
Type of Financing	--	Conv	Conv	Va
Date of Sale	--	10/05/2018	11/13/2018	10/22/2018
DOM · Cumulative DOM	-- · --	41 · 41	73 · 73	63 · 63
Age (# of years)	23	17	21	18
Condition	Average	Average	Average	Good
Sales Type	--	Fair Market Value	Fair Market Value	Fair Market Value
Location	Neutral ; Residential	Neutral ; Residential	Neutral ; Residential	Neutral ; Residential
View	Neutral ; Residential	Neutral ; Residential	Neutral ; Residential	Neutral ; Residential
Style/Design	1 Story Contemporary	1 Story Contemporary	1 Story Contemporary	1 Story Contemporary
# Units	1	1	1	1
Living Sq. Feet	1,244	1,285	1,342	1,342
Bdrm · Bths · ½ Bths	4 · 2	3 · 2	4 · 2	3 · 2
Total Room #	6	5	6	6
Garage (Style/Stalls)	Attached 2 Car(s)	Attached 2 Car(s)	Attached 2 Car(s)	Attached 2 Car(s)
Basement (Yes/No)	No	No	No	No
Basement (% Fin)	0%	0%	0%	0%
Basement Sq. Ft.	--	--	--	--
Pool/Spa	--	--	--	--
Lot Size	0.14 acres	0.09 acres	0.14 acres	0.14 acres
Other	--	--	--	--
Net Adjustment	--	+\$2,000	-\$3,000	-\$18,000
Adjusted Price	--	\$207,000	\$208,000	\$207,000

* Sold 1 is the most comparable sale to the subject.

¹ Comp's "Miles to Subject" was calculated by the system.

² Comp's "Miles to Subject" provided by Real Estate Professional.

³ Subject \$/ft based upon as-is sale price.

Recent Sales - Cont.

Reasons for Adjustments Why the comparable sale is superior or inferior to the subject.

- Sold 1** Low maintenance landscaping. Little to no upgrades. Tile counters. Carpet and tile flooring. Similar condition as the subject.
- Sold 2** Little to no upgrades. Low maintenance landscaping. Similar location views as the subject. Property appears to be in similar condition as the subject.
- Sold 3** New remodel. Fresh paint. New carpet and flooring. Low maintenance desert landscaping. Similar GLA and location views as the subject. Adjustments for upgrades.

Subject Sales & Listing History

Current Listing Status	Not Currently Listed			Listing History Comments			
Listing Agency/Firm				Subject last sold on 04/26/2012 for \$44,000.00.			
Listing Agent Name							
Listing Agent Phone							
# of Removed Listings in Previous 12 Months	0						
# of Sales in Previous 12 Months	0						
Original List Date	Original List Price	Final List Date	Final List Price	Result	Result Date	Result Price	Source

Marketing Strategy

	As Is Price	Repaired Price
Suggested List Price	\$208,000	\$208,000
Sales Price	\$208,000	\$208,000
30 Day Price	\$205,000	--
Comments Regarding Pricing Strategy		
<p>Sale #1 shows the best support for my value conclusion. This property is the most similar in GLA and condition as the subject. Sale #3 is similar in condition, however this property is a new remodel. Listing #1 is the best active listing comp. This property is the most similar in GLA and condition to the subject. Listing #3 has several upgrades but is similar in GLA as the subject. Using Sale #1 and Listing #1 as my best comps, I can conclude the estimated subject value.</p>		

Clear Capital Quality Assurance Comments Addendum

Reviewer's Notes The price is based on the subject being in average condition. Comps are similar in characteristics, located within 0.49 miles and the sold comps closed within the last 6 months. In addition, there was a prior report completed 10/2018 and the variance is 6.7%. The price conclusion is deemed supported.

Subject Photos



Front



Address Verification



Side



Side



Street



Street

Subject Photos



Other

Listing Photos

L1 1632 Wendell Williams Ave
Las Vegas, NV 89106



Front

L2 2300 Shady Hill Ave
Las Vegas, NV 89106



Front

L3 1908 Lone Hill St
Las Vegas, NV 89106



Front

Sales Photos

S1 1643 Marion Bennet Dr
Las Vegas, NV 89106



Front

S2 2128 Patriotic Ln
North Las Vegas, NV 89032



Front

S3 2210 Cool River Ct
North Las Vegas, NV 89032



Front

ClearMaps Addendum

Address ★ 1962 King Hill Street, Las Vegas, NV 89106

Loan Number 21917

Suggested List \$208,000

Suggested Repaired \$208,000

Sale \$208,000

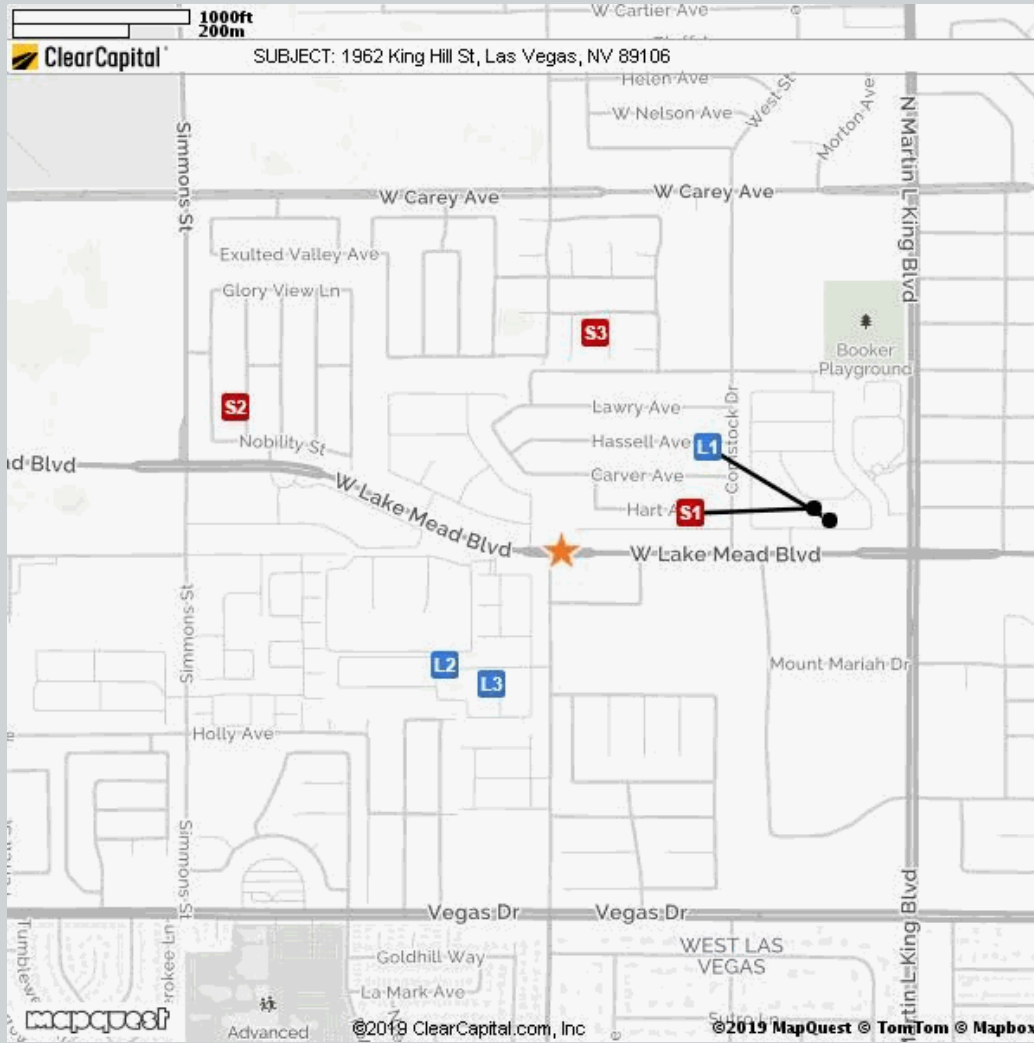

Comparable	Address	Miles to Subject	Mapping Accuracy
★ Subject	1962 King Hill St, Las Vegas, NV	--	Parcel Match
L1 Listing 1	1632 Wendell Williams Ave, Las Vegas, NV	0.41 Miles ¹	Parcel Match
L2 Listing 2	2300 Shady Hill Ave, Las Vegas, NV	0.21 Miles ¹	Parcel Match
L3 Listing 3	1908 Lone Hill St, Las Vegas, NV	0.19 Miles ¹	Parcel Match
S1 Sold 1	1643 Marion Bennet Dr, Las Vegas, NV	0.39 Miles ¹	Parcel Match
S2 Sold 2	2128 Patriotic Ln, North Las Vegas, NV	0.49 Miles ¹	Parcel Match
S3 Sold 3	2210 Cool River Ct, North Las Vegas, NV	0.32 Miles ¹	Parcel Match

¹ The Comparable "Distance from Subject" value has been calculated by the Clear Capital system.
² The Comparable "Distance from Subject" value has been provided by the Real Estate Professional.

Addendum: Report Purpose

Market Approach and Market Time

The Market Approach of this report, as established by the customer, is: **Fair Market Price**. (See definition below.)

The Marketing Time as specified by the customer is **Typical**. (See definition below.)

Definitions:

Fair Market Price

A price at which the property would sell between a willing buyer and a willing seller neither being compelled by undue pressure and both having reasonable knowledge of relevant facts.

Distressed Price

A price at which the property would sell between a willing buyer and a seller acting under duress.

Marketing Time

The amount of time the property is exposed to a pool of prospective buyers before going into contract. The customer either specifies the number of days, requests a marketing time that is typical to the subject's market area and/or requests an abbreviated marketing time.

Typical for Local Market

The estimated time required to adequately expose the subject property to the market resulting in a contract of sale.

Addendum: Report Purpose - cont.

Report Instructions

This section shows the instructions that were approved by the customer and provided to the broker prior to completing the report.

*** Please Note: This is a RUSH assignment. Do not accept if you cannot meet the current due date and time. Please reference the set terms and contact Clear Capital at 530.582.5011 if you require any changes. Thanks! ***

Instructions last updated: 7/17/2017

Purpose:

Please determine a fair market price for this property at which it would sell in a typical marketing time for the area.

Customer Specific Requests:

If the property is commercial or mixed use, please stop and contact Clear Capital as soon as possible

Form Help:

There are blue question marks (?) throughout this form. These are designed to offer guidance for that particular section of the form. Please click on them for help.

Comparable Requirements:

1. Please use fair market comps from the same neighborhood, block or subdivision whenever possible.
2. Please only use REO comparables if the market is driven by REOs and they are comparable in characteristics and condition.
3. Please use comps that have closed in the past 3 months to show the current market conditions or comment in the report if this is not possible. In rapidly changing markets, active listing comps should be given equal or greater weight than sold comps in your analysis.

Standard Instructions:

1. Clear Capital Code Of Conduct - Please make sure that you are always abiding by the Clear Capital Code of Conduct when completing valuation reports.
2. If the subject is currently listed, please consider all available information pertaining to the subject's condition. This information should be utilized when developing the assumption of the subject's condition.
3. Use the subject characteristics provided in the report Grid (if preloaded) to evaluate the property. This information is from a full interior appraisal and is assumed to be most accurate. If your inspection reveals obvious inaccuracies, please explain in the narrative of the report.
4. Include sufficient detail to help our mutual customer gain a complete understanding of the subject's neighborhood such as neighborhood desirability, amenities, parks, schools, commercial or industrial influences, REO activity, traffic, board-up-homes, etc.
5. Do not approach occupants or owners.
6. If the subject is a Commercial property, contact Clear Capital immediately at 530-582-5011 for direction on how to proceed with the report.
7. Please do not accept if you or your office has completed a report on this property in the last month, are currently listing this property, or have any vested interest in the subject property.
8. Clear Capital does not allow any log ins from IP addresses from foreign countries. This includes, but is not limited to; data entry services, form completion services, etc. Also, it is against Clear Capital code of conduct to share your password with anyone who is not a W2 employee in your office.
9. Clear Capital and our mutual customers greatly appreciate your expertise. If you cannot

Report Instructions - cont.

personally inspect the property, select comparables, and determine a price for the subject, please do not accept this report. Per the standards and guidelines adopted by Clear Capital and other industry leaders, the use of assistants to complete any of the aforementioned tasks is not permitted.

Due to the importance of an independent opinion of price, please do not discuss your price with anyone or be influenced by list price, pending offers, accept comp packets, repair estimates or the listing agent's opinion.

1. One current, original photo of the front of the subject 2. One address verification photo 3. One street scene photo looking down the street 4. MLS listing and sold comp photos required, please comment if no MLS.

Broker Information

Broker Name	Anthony Carey	Company/Brokerage	HomeSmart Encore
License No	S.0174589.LLC	Address	5321 wild sunflower st north las vegas NV 89081
License Expiration	04/30/2020	License State	NV
Phone	7022453750	Email	tonycareyre@gmail.com
Broker Distance to Subject	6.01 miles	Date Signed	04/02/2019

/Anthony Carey/

By confirming the above contact and real estate license information and submitting the report, the above signed hereby certifies and agrees that: 1) I personally took the pictures, selected comparables, and determined the price conclusion. 2) To the best of my knowledge, the statements of fact contained in this report are true and correct. 3) The reported analyses, opinions, and conclusions are my personal, impartial, and unbiased professional analyses, opinions, and conclusions. 4) I have no present or prospective interest in the property that is the subject of this report and no personal interest with respect to the parties involved. 5) I have no bias with respect to the property that is the subject of this report or to the parties involved with this assignment. 6) My compensation for completing this assignment is not contingent upon the development or reporting of a predetermined price point. 7) I did not base, either partially or completely, my analysis and/or opinion and conclusions in this report on race, color, religion, sex, age, marital status, handicap, familial status, or national origin of either the prospective owners or occupants of the subject property or of the present owners or occupants of the properties in the vicinity of the subject property or on any other basis prohibited by law. 8) I maintain errors and omissions insurance, to the extent required by state law, for all liability associated with the preparation of this Report.

Addendum: NV Broker's Price Opinion Qualification

The attached Broker's Price Opinion ("BPO") has been prepared by: **Anthony Carey** ("Licensee"), **S.0174589.LLC** (License #) who is an active licensee in good standing.

Licensee is affiliated with **HomeSmart Encore** (Company).

This Addendum is an integral part of the BPO prepared by Licensee and the BPO is considered incomplete without it.

1. This BPO has been prepared for **Wedgewood Inc** (Beneficiary or agent of Beneficiary hereinafter "Beneficiary") regarding the real property commonly known and described as: **1962 King Hill Street, Las Vegas, NV 89106**
2. Licensee is informed that the Beneficiary's interest in the real property is that of a third party making decisions or performing due diligence for an existing or potential lien holder.
3. The intended purpose of this BPO is to assist the Beneficiary in making decisions within the scope of applicable statutory and regulatory requirements and performing required due diligence.
4. Licensee certifies that Licensee has no existing or contemplated interest in the property, including without limitation the possibility of Licensee representing the seller or any purchaser.

Issue date: **April 2, 2019**

Licensee signature: **/Anthony Carey/**

NOTWITHSTANDING ANY PREPRINTED LANGUAGE TO THE CONTRARY, THIS OPINION IS NOT AN APPRAISAL OF THE MARKET VALUE OF THE PROPERTY. IF AN APPRAISAL IS DESIRED, THE SERVICES OF A LICENSED OR CERTIFIED APPRAISER MUST BE OBTAINED.

Disclaimer

Notwithstanding any preprinted language to the contrary, this opinion is not an appraisal of the market value of the property. If an appraisal is desired, the services of a licensed or certified appraiser must be obtained.

Unless otherwise specifically agreed to in writing:

The intended purpose of this report is to assist the Clear Capital account holder in making decisions within the scope of applicable statutory and regulatory requirements and performing required due diligence. This document is provided solely for the use of the Clear Capital account holder and not any other party, is not intended as any guarantee of value and/or condition of the subject property and should not be relied on as such. In the event that this document is found to be defective, incorrect, negligently prepared or unfit for its authorized use, Clear Capital's sole liability shall be to promptly refund the total fee expended by the account holder for this report or to replace it at no charge to the account holder, but in no event shall Clear Capital be responsible to the account holder for any indirect or consequential damages whatsoever. This warranty is in lieu of all other warranties, express or implied, except where otherwise required by law. The account holder shall notify Clear Capital within thirty (30) days of this report's delivery to the account holder if it believes that this document is defective, incorrect, negligently prepared or unfit for its authorized use. Under no circumstances may Clear Capital forms or their contents be published, copied, replicated, or mimicked.