

Please Note: This report was completed with the following assumptions: Market Approach: **Fair Market Price**, Marketing Time: **Typical**. Important additional information relating to this report, including use and restrictions, is contained in an attached addendum which is an integral part of this report.

<b>Address</b>	578 Brinkburn Point Avenue, Las Vegas, NEVADA 89178	<b>Order ID</b>	6016016	<b>Property ID</b>	25767819
<b>Inspection Date</b>	12/08/2018	<b>Date of Report</b>	12/10/2018		
<b>Loan Number</b>	36671	<b>APN</b>	176-18-517-010		
<b>Borrower Name</b>	Breckenridge Property Fund 2016 LLC				

#### Tracking IDs

<b>Order Tracking ID</b>	BotW New Fac-DriveBy BPO 12.07.18	<b>Tracking ID 1</b>	BotW New Fac-DriveBy BPO 12.07.18
<b>Tracking ID 2</b>	--	<b>Tracking ID 3</b>	--

#### I. General Conditions

<b>Property Type</b>	SFR	<b>Condition Comments</b>
<b>Occupancy</b>	Occupied	The subject property appeared to be in average condition for the area and didn't show any obvious damages. The home shouldn't have any issues on the resale market.
<b>Ownership Type</b>	Fee Simple	
<b>Property Condition</b>	Average	
<b>Estimated Exterior Repair Cost</b>	\$0	
<b>Estimated Interior Repair Cost</b>	\$0	
<b>Total Estimated Repair</b>	\$0	
<b>HOA</b>	No	
<b>Visible From Street</b>	Visible	

#### II. Subject Sales & Listing History

<b>Current Listing Status</b>	Not Currently Listed	<b>Listing History Comments</b>					
<b>Listing Agency/Firm</b>		NONE					
<b>Listing Agent Name</b>							
<b>Listing Agent Phone</b>							
<b># of Removed Listings in Previous 12 Months</b>	0						
<b># of Sales in Previous 12 Months</b>	0						
<b>Original List Date</b>	<b>Original List Price</b>	<b>Final List Date</b>	<b>Final List Price</b>	<b>Result</b>	<b>Result Date</b>	<b>Result Price</b>	<b>Source</b>

#### III. Neighborhood & Market Data

<b>Location Type</b>	Suburban	<b>Neighborhood Comments</b>
<b>Local Economy</b>	Improving	Home values have increased dramatically in the last 2 years. More recently, home values have leveled off and are staying the same month to month. Last months prices went up 1% from the previous month. Most expect prices to stay level through the end of the year.
<b>Sales Prices in this Neighborhood</b>	Low: \$240,000 High: \$280,000	
<b>Market for this type of property</b>	Increased 6 % in the past 6 months.	
<b>Normal Marketing Days</b>	<90	

#### IV. Current Listings

	Subject	Listing 1 *	Listing 2	Listing 3
Street Address	578 Brinkburn Point Avenue	676 Port Talbot Av	491 Keelmans Point Av	470 Haunts Walk Av
City, State	Las Vegas, NEVADA	Las Vegas, NV	Las Vegas, NV	Las Vegas, NV
Zip Code	89178	89178	89178	89178
Datasource	Tax Records	MLS	MLS	MLS
Miles to Subj.	--	0.45 <sup>1</sup>	0.34 <sup>1</sup>	0.28 <sup>1</sup>
Property Type	SFR	SFR	SFR	SFR
Original List Price \$	\$	\$269,500	\$269,000	\$300,000
List Price \$	--	\$259,900	\$269,000	\$250,000
Original List Date		10/30/2018	11/14/2018	06/05/2018
DOM · Cumulative DOM	-- · --	39 · 41	24 · 26	144 · 188
Age (# of years)	11	11	13	13
Condition	Average	Average	Average	Average
Sales Type	--	Fair Market Value	Fair Market Value	Fair Market Value
Style/Design	2 Stories CONTEMP	2 Stories CONTEMP	2 Stories CONTEMP	2 Stories CONTEMP
# Units	1	1	1	1
Living Sq. Feet	1,611	1,671	1,696	1,484
Bdrm · Bths · ½ Bths	3 · 2 · 1	3 · 2 · 1	3 · 2 · 1	3 · 2 · 1
Total Room #	6	6	6	6
Garage (Style/Stalls)	Attached 1 Car	Attached 1 Car	Attached 1 Car	Attached 1 Car
Basement (Yes/No)	No	No	No	No
Basement (% Fin)	0%	0%	0%	0%
Basement Sq. Ft.	--	--	--	--
Pool/Spa	--	--	--	--
Lot Size	0.05 acres	0.05 acres	0.06 acres	0.10 acres
Other	NONE	NONE	NONE	NONE

#### Listing Comments Why the comparable listing is superior or inferior to the subject.

- Listing 1** Beautiful 2 story home in great southwest location! Open floor plan with tons of natural light. Upgraded bamboo flooring in traffic areas. Spacious Kitchen area with granite countertops and ceramic tile flooring. All appliances included\* Private courtyard with paver stone patio. Oversize master bedroom with large walk in closet. Custom window coverings. Washer and dryer are included. Secondary bedroom has been sound proofed.
- Listing 2** Built in 2005, this Las Vegas two-story offers granite kitchen countertops, stainless steel appliances, and a one-car garage. Upgraded features include fresh interior paint and new carpet. Home comes with a 30-day buyback guarantee. Terms and conditions apply.
- Listing 3** Former KB MODEL HOME with ALL THE EXTRAS ~ Slab Granite Counter tops w/ custom back splash ~ Raised panel maple cabinetry w/ under the counter lighting ~ Kitchen Island ~ Plantation Shutters ~ Crown Molding ~ Brick paver driveway ~ Custom ceramic tile flooring on the diagonal ~ Next to community park ~ Maple Stair Rail ~ 2-Tone Paint ~ Neutral carpet ~ Large Master Suite ~ Creative and Inviting Floor Plan

\* Listing 1 is the most comparable listing to the subject.

<sup>1</sup> Comp's "Miles to Subject" was calculated by the system.

<sup>2</sup> Comp's "Miles to Subject" provided by Real Estate Professional.

<sup>3</sup> Subject \$/ft based upon as-is sale price.

## V. Recent Sales

	Subject	Sold 1	Sold 2 *	Sold 3
Street Address	578 Brinkburn Point Avenue	549 Mayfair Walk Av	540 Taunton St	561 Brinkburn Point Av
City, State	Las Vegas, NEVADA	Las Vegas, NV	Las Vegas, NV	Las Vegas, NV
Zip Code	89178	89178	89178	89178
Datasource	Tax Records	MLS	MLS	MLS
Miles to Subj.	--	0.15 <sup>1</sup>	0.21 <sup>1</sup>	0.03 <sup>1</sup>
Property Type	SFR	SFR	SFR	SFR
Original List Price \$	--	\$260,000	\$264,900	\$269,000
List Price \$	--	\$260,000	\$264,900	\$275,000
Sale Price \$	--	\$256,000	\$262,500	\$270,000
Type of Financing	--	Cash	Conv	Conv
Date of Sale	--	11/27/2018	10/22/2018	11/6/2018
DOM · Cumulative DOM	-- · --	21 · 50	5 · 45	52 · 76
Age (# of years)	11	13	12	11
Condition	Average	Average	Average	Average
Sales Type	--	Fair Market Value	Fair Market Value	Fair Market Value
Style/Design	2 Stories CONTEMP	2 Stories CONTEMP	2 Stories CONTEMP	2 Stories CONTEMP
# Units	1	1	1	1
Living Sq. Feet	1,611	1,611	1,611	1,484
Bdrm · Bths · ½ Bths	3 · 2 · 1	3 · 2 · 1	3 · 2 · 1	3 · 2 · 1
Total Room #	6	6	6	6
Garage (Style/Stalls)	Attached 1 Car	Attached 1 Car	Attached 1 Car	Attached 1 Car
Basement (Yes/No)	No	No	No	No
Basement (% Fin)	0%	0%	0%	0%
Basement Sq. Ft.	%	--	--	--
Pool/Spa	--	--	--	--
Lot Size	0.05 acres	0.05 acres	0.05 acres	0.05 acres
Other	NONE	NONE	NONE	NONE
Net Adjustment	--	+\$0	+\$0	+\$0
Adjusted Price	--	\$256,000	\$262,500	\$270,000

### Reasons for Adjustments Why the comparable sale is superior or inferior to the subject.

**Sold 1** Home has Hardwood floors throughout the house. Home is a 3 bed room 2.5 bath. located near shools, shopping.

**Sold 2** Pride of ownership shows in this 3 Bdrm + loft, 2.5 Bath & 1 car garage home in the Southwest! Open floorplan! Home boasts laminate wood flooring throughout the first floor! Kitchen has Corian counter tops, island, black appliances & pantry! Generously sized master bedroom w/ walk-in closet! Upstairs loft w/ front balcony. Bathrooms have Corian countertops and tub surrounds. Cute backyard! This home will not last!

**Sold 3** Wonderful newly renovated 3 bed 3 bath home in a great southwest location with mountain views and easy access to freeway, restaurants, hiking, you name it! This property is well maintained and has upgraded flooring downstairs, upgraded kitchen with all new appliances, renovated bathrooms and is Move in Ready! Master bedroom has a a balcony for you to enjoy the Vegas Mountain views, you do not want to miss this one

\* Sold 2 is the most comparable sale to the subject.

<sup>1</sup> Comp's "Miles to Subject" was calculated by the system.

<sup>2</sup> Comp's "Miles to Subject" provided by Real Estate Professional.

<sup>3</sup> Subject \$/ft based upon as-is sale price.

## VI. Marketing Strategy

	As Is Price	Repaired Price
<b>Suggested List Price</b>	\$262,000	\$262,000
<b>Sales Price</b>	\$262,000	\$262,000
<b>30 Day Price</b>	\$252,000	--

**Comments Regarding Pricing Strategy**  
VALUED THE SUBJECT BETWEEN SALE COMP 1 AND 2 AS THEY ARE MODEL MATCHES TO THE SUBJECT.

## VII. Clear Capital Quality Assurance Comments Addendum

**Reviewer's Notes** The broker's as-is conclusion reflects the market for the subject. Comps are within a reasonable distance, relatively current, and accurately reflect the subject's defining characteristics. Thus, the as-is conclusion appears to be adequately supported.

**VIII. Property Images**

**Address** 578 Brinkburn Point Avenue, Las Vegas, NEVADA 89178  
**Loan Number** 36671

**Suggested List** \$262,000

**Suggested Repaired** \$262,000

**Sale** \$262,000



**Subject** 578 Brinkburn Point Ave

**View** Front



**Subject** 578 Brinkburn Point Ave

**View** Address Verification



**VIII. Property Images (continued)**

**Address** 578 Brinkburn Point Avenue, Las Vegas, NEVADA 89178  
**Loan Number** 36671

**Suggested List** \$262,000

**Suggested Repaired** \$262,000

**Sale** \$262,000



**Subject** 578 Brinkburn Point Ave

**View** Side



**Subject** 578 Brinkburn Point Ave

**View** Side

**VIII. Property Images (continued)**

**Address** 578 Brinkburn Point Avenue, Las Vegas, NEVADA 89178  
**Loan Number** 36671

**Suggested List** \$262,000

**Suggested Repaired** \$262,000

**Sale** \$262,000



**Subject** 578 Brinkburn Point Ave

**View** Street



**Subject** 578 Brinkburn Point Ave

**View** Street

**VIII. Property Images (continued)**

**Address** 578 Brinkburn Point Avenue, Las Vegas, NEVADA 89178

**Loan Number** 36671

**Suggested List** \$262,000

**Suggested Repaired** \$262,000

**Sale** \$262,000



**Listing Comp 1** 676 Port Talbot Av **View** Front



**Listing Comp 2** 491 Keelmans Point Av **View** Front



**VIII. Property Images (continued)**

**Address** 578 Brinkburn Point Avenue, Las Vegas, NEVADA 89178  
**Loan Number** 36671      **Suggested List** \$262,000      **Suggested Repaired** \$262,000      **Sale** \$262,000



**Listing Comp 3** 470 Haunts Walk Av      **View** Front



**Sold Comp 1** 549 Mayfair Walk Av      **View** Front

**VIII. Property Images (continued)**

**Address** 578 Brinkburn Point Avenue, Las Vegas, NEVADA 89178  
**Loan Number** 36671

**Suggested List** \$262,000

**Suggested Repaired** \$262,000

**Sale** \$262,000



**Sold Comp 2** 540 Taunton St **View** Front



**Sold Comp 3** 561 Brinkburn Point Av **View** Front

**ClearMaps Addendum**

**Address** ★ 578 Brinkburn Point Avenue, Las Vegas, NEVADA 89178  
**Loan Number** 36671      **Suggested List** \$262,000      **Suggested Repaired** \$262,000      **Sale** \$262,000

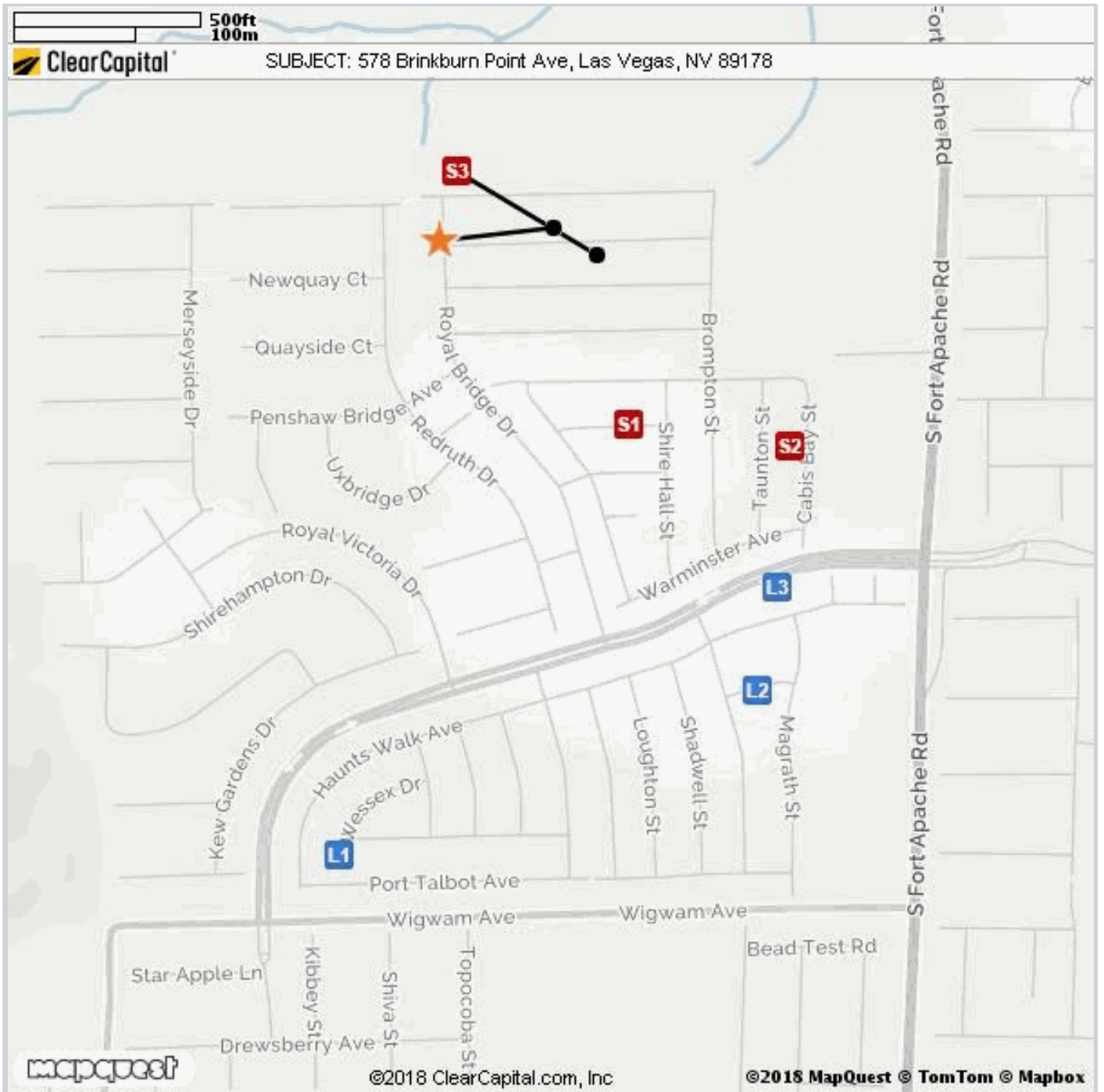

Comparable	Address	Miles to Subject	Mapping Accuracy
★ Subject	578 Brinkburn Point Ave, Las Vegas, NV	--	Parcel Match
L1 Listing 1	676 Port Talbot Av, Las Vegas, NV	0.45 Miles <sup>1</sup>	Parcel Match
L2 Listing 2	491 Keelmans Point Av, Las Vegas, NV	0.34 Miles <sup>1</sup>	Parcel Match
L3 Listing 3	470 Haunts Walk Av, Las Vegas, NV	0.28 Miles <sup>1</sup>	Parcel Match
S1 Sold 1	549 Mayfair Walk Av, Las Vegas, NV	0.15 Miles <sup>1</sup>	Parcel Match
S2 Sold 2	540 Taunton St, Las Vegas, NV	0.21 Miles <sup>1</sup>	Parcel Match
S3 Sold 3	561 Brinkburn Point Av, Las Vegas, NV	0.03 Miles <sup>1</sup>	Parcel Match

<sup>1</sup> The Comparable "Distance from Subject" value has been calculated by the Clear Capital system.  
<sup>2</sup> The Comparable "Distance from Subject" value has been provided by the Real Estate Professional.

## Market Approach and Market Time

The Market Approach of this report, as established by the customer, is: **Fair Market Price**. (See definition below.)

The Marketing Time as specified by the customer is **Typical**. (See definition below.)

Definitions:

Fair Market Price	A price at which the property would sell between a willing buyer and a willing seller neither being compelled by undue pressure and both having reasonable knowledge of relevant facts.
Distressed Price	A price at which the property would sell between a willing buyer and a seller acting under duress.
Marketing Time	The amount of time the property is exposed to a pool of prospective buyers before going into contract. The customer either specifies the number of days, requests a marketing time that is typical to the subject's market area and/or requests an abbreviated marketing time.
Typical for Local Market	The estimated time required to adequately expose the subject property to the market resulting in a contract of sale.

## Report Instructions

This section shows the instructions that were approved by the customer and provided to the broker prior to completing the report.

\*\*\* Please Note: This is a RUSH assignment. Do not accept if you cannot meet the current due date and time. Please reference the set terms and contact Clear Capital at 530.582.5011 if you require any changes. Thanks! \*\*\*

Instructions last updated: 7/17/2017

Purpose:

Please determine a fair market price for this property at which it would sell in a typical marketing time for the area.

Customer Specific Requests:

\*\*If the property is commercial or mixed use, please stop and contact Clear Capital as soon as possible\*\*

Form Help:

There are blue question marks (?) throughout this form. These are designed to offer guidance for that particular section of the form. Please click on them for help.

Comparable Requirements:

1. Please use fair market comps from the same neighborhood, block or subdivision whenever possible.
2. Please only use REO comparables if the market is driven by REOs and they are comparable in characteristics and condition.
3. Please use comps that have closed in the past 3 months to show the current market conditions or comment in the report if this is not possible. In rapidly changing markets, active listing comps should be given equal or greater weight than sold comps in your analysis.

Standard Instructions:

1. Clear Capital Code Of Conduct - Please make sure that you are always abiding by the Clear Capital Code of Conduct when completing valuation reports.
2. If the subject is currently listed, please consider all available information pertaining to the subject's condition. This information should be utilized when developing the assumption of the subject's condition.
3. Use the subject characteristics provided in the report Grid (if preloaded) to evaluate the property. This information is from a full interior appraisal and is assumed to be most accurate. If your inspection reveals obvious inaccuracies, please explain in the narrative of the report.
4. Include sufficient detail to help our mutual customer gain a complete understanding of the subject's neighborhood such as neighborhood desirability, amenities, parks, schools, commercial or industrial influences, REO activity, traffic, board-up-homes, etc.
5. Do not approach occupants or owners.
6. If the subject is a Commercial property, contact Clear Capital immediately at 530-582-5011 for direction on how to proceed with the report.
7. Please do not accept if you or your office has completed a report on this property in the last month, are currently listing this property, or have any vested interest in the subject property.
8. Clear Capital does not allow any log ins from IP addresses from foreign countries. This includes, but is not limited to; data entry services, form completion services, etc. Also, it is against Clear Capital code of conduct to share your password with anyone who is not a W2 employee in your office.
9. Clear Capital and our mutual customers greatly appreciate your expertise. If you cannot personally inspect the property, select comparables, and determine a price for the subject, please do not accept this report. Per the standards and guidelines adopted by Clear Capital and other industry leaders, the use of assistants to complete any of the aforementioned tasks is not permitted.

Due to the importance of an independent opinion of price, please do not discuss your price with anyone or be influenced by list price, pending offers, accept comp packets, repair estimates or the listing agent's opinion.

1. One current, original photo of the front of the subject
2. One address verification photo
3. One street scene photo looking down the street
4. MLS listing and sold comp photos required, please comment if no MLS.





## Broker Information

<b>Broker Name</b>	Mark Perry	<b>Company/Brokerage</b>	Local Realty
<b>License No</b>	B.1001058		
<b>License Expiration</b>	09/30/2020	<b>License State</b>	NV
<b>Phone</b>	7022454240	<b>Email</b>	marksellslasvegas@gmail.com
<b>Broker Distance to Subject</b>	2.25 miles	<b>Date Signed</b>	12/08/2018

*By confirming the above contact and real estate license information and submitting the report, the above signed hereby certifies and agrees that: 1) I personally took the pictures, selected comparables, and determined the price conclusion. 2) To the best of my knowledge, the statements of fact contained in this report are true and correct. 3) The reported analyses, opinions, and conclusions are my personal, impartial, and unbiased professional analyses, opinions, and conclusions. 4) I have no present or prospective interest in the property that is the subject of this report and no personal interest with respect to the parties involved. 5) I have no bias with respect to the property that is the subject of this report or to the parties involved with this assignment. 6) My compensation for completing this assignment is not contingent upon the development or reporting of a predetermined price point. 7) I did not base, either partially or completely, my analysis and/or opinion and conclusions in this report on race, color, religion, sex, age, marital status, handicap, familial status, or national origin of either the prospective owners or occupants of the subject property or of the present owners or occupants of the properties in the vicinity of the subject property or on any other basis prohibited by law. 8) I maintain errors and omissions insurance, to the extent required by state law, for all liability associated with the preparation of this Valuation Report.*

### Disclaimer

**Notwithstanding any preprinted language to the contrary, this opinion is not an appraisal of the market value of the property. If an appraisal is desired, the services of a licensed or certified appraiser must be obtained.**

Unless otherwise specifically agreed to in writing:

The intended purpose of this report is to assist the Clear Capital account holder in making decisions within the scope of applicable statutory and regulatory requirements and performing required due diligence. This document is provided solely for the use of the Clear Capital account holder and not any other party, is not intended as any guarantee of value and/or condition of the subject property and should not be relied on as such. In the event that this document is found to be defective, incorrect, negligently prepared or unfit for its authorized use, Clear Capital's sole liability shall be to promptly refund the total fee expended by the account holder for this report or to replace it at no charge to the account holder, but in no event shall Clear Capital be responsible to the account holder for any indirect or consequential damages whatsoever. This warranty is in lieu of all other warranties, express or implied, except where otherwise required by law. The account holder shall notify Clear Capital within thirty (30) days of this report's delivery to the account holder if it believes that this document is defective, incorrect, negligently prepared or unfit for its authorized use. Under no circumstances may Clear Capital forms or their contents be published, copied, replicated, or mimicked.