

Please Note: This report was completed with the following assumptions: Market Approach: **Fair Market Price**, Marketing Time: **Typical**. Important additional information relating to this report, including use and restrictions, is contained in an attached addendum which is an integral part of this report.

Address	7109 Jeanette Street, Las Vegas, NV 89131	Order ID	6020430	Property ID	25779542
Inspection Date	12/13/2018	Date of Report	12/13/2018		
Loan Number	36707	APN	125-24-103-002		
Borrower Name	Breckenridge Property Fund 2016 LLC				

Tracking IDs

Order Tracking ID	BotW New Fac-DriveBy BPO 12.12.18	Tracking ID 1	BotW New Fac-DriveBy BPO 12.12.18
Tracking ID 2	--	Tracking ID 3	--

I. General Conditions

Property Type	SFR	Condition Comments	
Occupancy	Occupied	Structure shows no apparent deferred maintenance, maintained landscaping. Within neighborhood standards. No repair issues noted.	
Ownership Type	Fee Simple		
Property Condition	Average		
Estimated Exterior Repair Cost	\$0		
Estimated Interior Repair Cost	\$0		
Total Estimated Repair	\$0		
HOA	No		
Visible From Street	Visible		

II. Subject Sales & Listing History

Current Listing Status	Not Currently Listed	Listing History Comments	
Listing Agency/Firm		Listed 8/13/18 380,000, price change 8/16/18 349,000, withdrawn 8/29/18. Listed 9/2/18 355,000, price change 349,000 9/14/18, withdrawn 9/17/18. List 9/22/18 330,000, withdrawn 9/26/18. Listed 9/27/18 335,000, withdrawn 10/22/18. Subj had foreclosure notification.	
Listing Agent Name			
Listing Agent Phone			
# of Removed Listings in Previous 12 Months	4		
# of Sales in Previous 12 Months	0		

Original List Date	Original List Price	Final List Date	Final List Price	Result	Result Date	Result Price	Source
08/13/2018	\$380,000	08/16/2018	\$349,000	Withdrawn	08/29/2018	\$349,000	MLS
09/02/2018	\$355,000	09/22/2018	\$330,000	Withdrawn	09/17/2018	\$349,000	MLS
09/22/2018	\$330,000	09/27/2018	\$335,000	Withdrawn	09/26/2018	\$330,000	MLS
09/27/2018	\$335,000	--	--	Withdrawn	10/22/2018	\$335,000	MLS

III. Neighborhood & Market Data

Location Type	Suburban	Neighborhood Comments	
Local Economy	Improving	Subj in neighborhood that was originally rural, now surrounded by many tract subdivisions. Expanded to 1 mile radius to get all comps on aprox 1/2 acre or larger lot. Built from 1970's to present. Maintained neighborhoods.	
Sales Prices in this Neighborhood	Low: \$250,000 High: \$649,000		
Market for this type of property	Increased 2 % in the past 6 months.		
Normal Marketing Days	<90		

IV. Current Listings

	Subject	Listing 1 *	Listing 2	Listing 3
Street Address	7109 Jeanette Street	5501 Ano Dr	7041 N Decatur Bl	6820 Unicorn St
City, State	Las Vegas, NV	Las Vegas, NV	Las Vegas, NV	Las Vegas, NV
Zip Code	89131	89131	89131	89131
Datasource	Tax Records	MLS	MLS	MLS
Miles to Subj.	--	0.65 ¹	0.56 ¹	0.45 ¹
Property Type	SFR	SFR	SFR	SFR
Original List Price \$	\$	\$320,000	\$399,000	\$440,000
List Price \$	--	\$254,900	\$465,000	\$440,000
Original List Date		07/06/2018	12/05/2018	11/29/2018
DOM · Cumulative DOM	-- · --	160 · 160	8 · 8	14 · 14
Age (# of years)	37	46	40	20
Condition	Average	Average	Average	Average
Sales Type	--	Fair Market Value	Fair Market Value	Fair Market Value
Style/Design	1 Story ranch	1 Story ranch	1 Story ranch	1 Story ranch
# Units	1	1	1	1
Living Sq. Feet	1,669	1,004	2,424	1,874
Bdrm · Bths · ½ Bths	3 · 2	3 · 1	4 · 2 · 1	4 · 2
Total Room #	6	6	7	7
Garage (Style/Stalls)	Attached 2 Car(s)	None	Attached 2 Car(s)	Attached 4 Car(s)
Basement (Yes/No)	No	No	No	No
Basement (% Fin)	0%	0%	0%	0%
Basement Sq. Ft.	--	--	--	--
Pool/Spa	--	--	--	Pool - Yes
Lot Size	0.53 acres	1.06 acres	1.04 acres	0.54 acres
Other	fireplace	none	fireplace	fireplace

Listing Comments Why the comparable listing is superior or inferior to the subject.

Listing 1 superior: lot size (\$1/sf) -23,100 inferior: GLA +33,250 1 bath +3000 no fireplace +1500 no garage +6000 last price change 12/1/18

Listing 2 superior: GLA -37,750 4 bed -3000 2.5 bath -1500 lot size -22,200 inferior: none

Listing 3 superior: GLA -10,250 4 bed -3000 4 car garage -6000 pool -12,000 age -8500 inferior: none has accepted conv offer since 12/3/18

* Listing 1 is the most comparable listing to the subject.

¹ Comp's "Miles to Subject" was calculated by the system.

² Comp's "Miles to Subject" provided by Real Estate Professional.

³ Subject \$/ft based upon as-is sale price.

V. Recent Sales

	Subject	Sold 1	Sold 2 *	Sold 3
Street Address	7109 Jeanette Street	6818 Jeannette St	5636 Dorrell Ln	6272 Dorrell Ln
City, State	Las Vegas, NV	Las Vegas, NV	Las Vegas, NV	Las Vegas, NV
Zip Code	89131	89131	89131	89131
Datasource	Tax Records	MLS	MLS	MLS
Miles to Subj.	--	0.42 ¹	0.19 ¹	0.75 ¹
Property Type	SFR	SFR	SFR	SFR
Original List Price \$	--	\$325,000	\$445,000	\$339,900
List Price \$	--	\$325,000	\$400,000	\$339,900
Sale Price \$	--	\$300,000	\$325,000	\$350,000
Type of Financing	--	Conv	Conv	Va
Date of Sale	--	8/27/2018	10/31/2018	8/1/2018
DOM · Cumulative DOM	-- · --	8 · 145	74 · 113	15 · 48
Age (# of years)	37	23	44	37
Condition	Average	Average	Average	Average
Sales Type	--	Investor	Fair Market Value	Fair Market Value
Style/Design	1 Story ranch	1 Story ranch	1 Story ranch	1 Story ranch
# Units	1	1	1	1
Living Sq. Feet	1,669	1,895	1,840	1,645
Bdrm · Bths · ½ Bths	3 · 2	3 · 2 · 1	3 · 2	4 · 2
Total Room #	6	6	6	7
Garage (Style/Stalls)	Attached 2 Car(s)	Attached 3 Car(s)	Attached 2 Car(s)	None
Basement (Yes/No)	No	No	No	No
Basement (% Fin)	0%	0%	0%	0%
Basement Sq. Ft.	%	--	--	--
Pool/Spa	--	--	--	--
Lot Size	0.53 acres	0.51 acres	1.04 acres	0.46 acres
Other	fireplace	none	fireplace	none
Net Adjustment	--	-\$21,300	-\$32,450	+\$7,550
Adjusted Price	--	\$278,700	\$292,550	\$357,550

Reasons for Adjustments Why the comparable sale is superior or inferior to the subject.

Sold 1 superior: GLA -11,300 2.5 bath -1500 3 car garage -3000 age -7000 inferior: no fireplace +1500 short term tenant occupied 800/month

Sold 2 superior: GLA -10,250 lot size -22,200 inferior: none

Sold 3 superior: 4 bed -3000 inferior: no garage +6000 no fireplace +1500 lot size +3050

* Sold 2 is the most comparable sale to the subject.

¹ Comp's "Miles to Subject" was calculated by the system.

² Comp's "Miles to Subject" provided by Real Estate Professional.

³ Subject \$/ft based upon as-is sale price.

VI. Marketing Strategy

	As Is Price	Repaired Price
Suggested List Price	\$306,000	\$306,000
Sales Price	\$300,000	\$300,000
30 Day Price	\$282,000	--

Comments Regarding Pricing Strategy

So few similar GLA on aprox 1/2 acre, prices have large variance. List within 2% of value price, discount quick sale 6%. Valued subj in lower to mid end of adjusted solds. Comps averaged short DOM, but subj has been listed over past few months and withdrawn each time. Buyers would expect discount pricig due to subj status of pre foreclosure, difficulty in timely closing.

VII. Clear Capital Quality Assurance Comments Addendum

Reviewer's Notes The price is based on the subject being in average condition. Comps are similar in characteristics, located within 0.75 miles and the sold comps closed within the last 4 months. The market is reported as having increased 2% in the last 6 months. The price conclusion is deemed supported.

VIII. Property Images

Address 7109 Jeanette Street, Las Vegas, NV 89131
Loan Number 36707

Suggested List \$306,000

Suggested Repaired \$306,000

Sale \$300,000



Subject 7109 Jeanette St

View Front



Subject 7109 Jeanette St

View Front

VIII. Property Images (continued)

Address 7109 Jeanette Street, Las Vegas, NV 89131

Loan Number 36707

Suggested List \$306,000

Suggested Repaired \$306,000

Sale \$300,000



Subject 7109 Jeanette St

View Address Verification

Comment "no address visible on subj"



Subject 7109 Jeanette St

View Street

VIII. Property Images (continued)

Address 7109 Jeanette Street, Las Vegas, NV 89131

Loan Number 36707

Suggested List \$306,000

Suggested Repaired \$306,000

Sale \$300,000



Listing Comp 1

View Front



Listing Comp 2

View Front

VIII. Property Images (continued)

Address 7109 Jeanette Street, Las Vegas, NV 89131
Loan Number 36707

Suggested List \$306,000

Suggested Repaired \$306,000

Sale \$300,000



Listing Comp 3

View Front



Sold Comp 1

View Front

VIII. Property Images (continued)

Address 7109 Jeanette Street, Las Vegas, NV 89131
Loan Number 36707

Suggested List \$306,000

Suggested Repaired \$306,000

Sale \$300,000



Sold Comp 2

View Front



Sold Comp 3

View Front

ClearMaps Addendum

Address ★ 7109 Jeanette Street, Las Vegas, NV 89131
Loan Number 36707 **Suggested List** \$306,000 **Suggested Repaired** \$306,000 **Sale** \$300,000

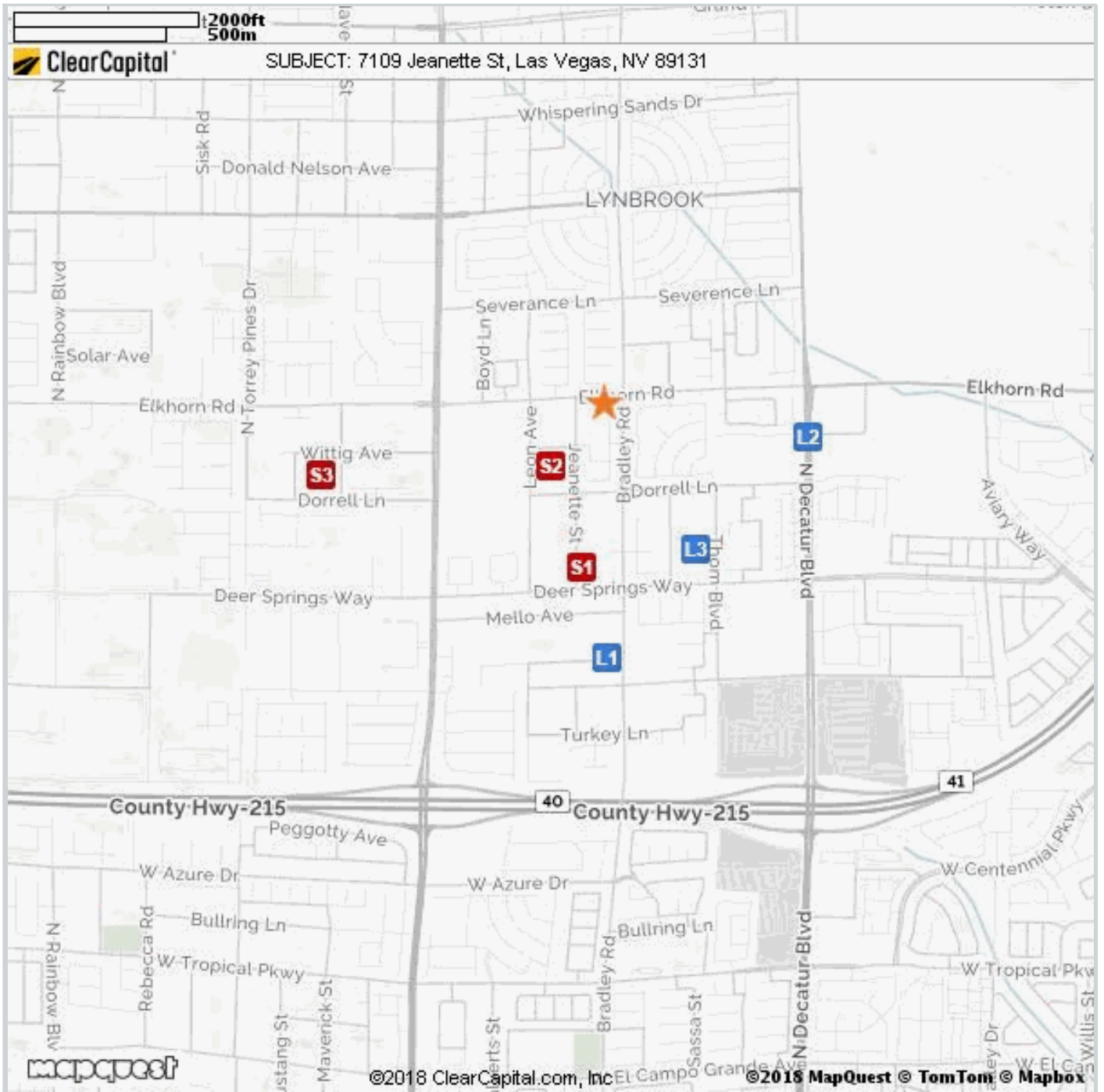

Comparable	Address	Miles to Subject	Mapping Accuracy
★ Subject	7109 Jeanette St, Las Vegas, NV	--	Parcel Match
L1 Listing 1	5501 Ano Dr, Las Vegas, NV	0.65 Miles ¹	Parcel Match
L2 Listing 2	7041 N Decatur Bl, Las Vegas, NV	0.56 Miles ¹	Parcel Match
L3 Listing 3	6820 Unicorn St, Las Vegas, NV	0.45 Miles ¹	Parcel Match
S1 Sold 1	6818 Jeannette St, Las Vegas, NV	0.42 Miles ¹	Parcel Match
S2 Sold 2	5636 Dorrell Ln, Las Vegas, NV	0.19 Miles ¹	Parcel Match
S3 Sold 3	6272 Dorrell Ln, Las Vegas, NV	0.75 Miles ¹	Parcel Match

¹ The Comparable "Distance from Subject" value has been calculated by the Clear Capital system.
² The Comparable "Distance from Subject" value has been provided by the Real Estate Professional.

Market Approach and Market Time

The Market Approach of this report, as established by the customer, is: **Fair Market Price**. (See definition below.)

The Marketing Time as specified by the customer is **Typical**. (See definition below.)

Definitions:

Fair Market Price	A price at which the property would sell between a willing buyer and a willing seller neither being compelled by undue pressure and both having reasonable knowledge of relevant facts.
Distressed Price	A price at which the property would sell between a willing buyer and a seller acting under duress.
Marketing Time	The amount of time the property is exposed to a pool of prospective buyers before going into contract. The customer either specifies the number of days, requests a marketing time that is typical to the subject's market area and/or requests an abbreviated marketing time.
Typical for Local Market	The estimated time required to adequately expose the subject property to the market resulting in a contract of sale.

Report Instructions

This section shows the instructions that were approved by the customer and provided to the broker prior to completing the report.

*** Please Note: This is a RUSH assignment. Do not accept if you cannot meet the current due date and time. Please reference the set terms and contact Clear Capital at 530.582.5011 if you require any changes. Thanks! ***

Instructions last updated: 7/17/2017

Purpose:

Please determine a fair market price for this property at which it would sell in a typical marketing time for the area.

Customer Specific Requests:

If the property is commercial or mixed use, please stop and contact Clear Capital as soon as possible

Form Help:

There are blue question marks (?) throughout this form. These are designed to offer guidance for that particular section of the form. Please click on them for help.

Comparable Requirements:

1. Please use fair market comps from the same neighborhood, block or subdivision whenever possible.
2. Please only use REO comparables if the market is driven by REOs and they are comparable in characteristics and condition.
3. Please use comps that have closed in the past 3 months to show the current market conditions or comment in the report if this is not possible. In rapidly changing markets, active listing comps should be given equal or greater weight than sold comps in your analysis.

Standard Instructions:

1. Clear Capital Code Of Conduct - Please make sure that you are always abiding by the Clear Capital Code of Conduct when completing valuation reports.
2. If the subject is currently listed, please consider all available information pertaining to the subject's condition. This information should be utilized when developing the assumption of the subject's condition.
3. Use the subject characteristics provided in the report Grid (if preloaded) to evaluate the property. This information is from a full interior appraisal and is assumed to be most accurate. If your inspection reveals obvious inaccuracies, please explain in the narrative of the report.
4. Include sufficient detail to help our mutual customer gain a complete understanding of the subject's neighborhood such as neighborhood desirability, amenities, parks, schools, commercial or industrial influences, REO activity, traffic, board-up-homes, etc.
5. Do not approach occupants or owners.
6. If the subject is a Commercial property, contact Clear Capital immediately at 530-582-5011 for direction on how to proceed with the report.
7. Please do not accept if you or your office has completed a report on this property in the last month, are currently listing this property, or have any vested interest in the subject property.
8. Clear Capital does not allow any log ins from IP addresses from foreign countries. This includes, but is not limited to; data entry services, form completion services, etc. Also, it is against Clear Capital code of conduct to share your password with anyone who is not a W2 employee in your office.
9. Clear Capital and our mutual customers greatly appreciate your expertise. If you cannot personally inspect the property, select comparables, and determine a price for the subject, please do not accept this report. Per the standards and guidelines adopted by Clear Capital and other industry leaders, the use of assistants to complete any of the aforementioned tasks is not permitted.

Due to the importance of an independent opinion of price, please do not discuss your price with anyone or be influenced by list price, pending offers, accept comp packets, repair estimates or the listing agent's opinion.

1. One current, original photo of the front of the subject
2. One address verification photo
3. One street scene photo looking down the street
4. MLS listing and sold comp photos required, please comment if no MLS.

Broker Information

Broker Name	David Berg	Company/Brokerage	Elite Realty
License No	0032371	Electronic Signature	/David Berg/
License Expiration	11/30/2019	License State	NV
Phone	7022815827	Email	lasvegasdavid@gmail.com
Broker Distance to Subject	10.85 miles	Date Signed	12/13/2018

By confirming the above contact and real estate license information and submitting the report, the above signed hereby certifies and agrees that: 1) I personally took the pictures, selected comparables, and determined the price conclusion. 2) To the best of my knowledge, the statements of fact contained in this report are true and correct. 3) The reported analyses, opinions, and conclusions are my personal, impartial, and unbiased professional analyses, opinions, and conclusions. 4) I have no present or prospective interest in the property that is the subject of this report and no personal interest with respect to the parties involved. 5) I have no bias with respect to the property that is the subject of this report or to the parties involved with this assignment. 6) My compensation for completing this assignment is not contingent upon the development or reporting of a predetermined price point. 7) I did not base, either partially or completely, my analysis and/or opinion and conclusions in this report on race, color, religion, sex, age, marital status, handicap, familial status, or national origin of either the prospective owners or occupants of the subject property or of the present owners or occupants of the properties in the vicinity of the subject property or on any other basis prohibited by law. 8) I maintain errors and omissions insurance, to the extent required by state law, for all liability associated with the preparation of this Valuation Report.

Addendum: NV Broker's Price Opinion Qualification

The attached Broker's Price Opinion ("BPO") has been prepared by: **David Berg** ("Licensee"), **0032371** (License #) who is an active licensee in good standing.

Licensee is affiliated with **Elite Realty** (Company).

This Addendum is an integral part of the BPO prepared by Licensee and the BPO is considered incomplete without it.

1. This BPO has been prepared for **Wedgewood Inc** (Beneficiary or agent of Beneficiary hereinafter "Beneficiary") regarding the real property commonly known and described as: **7109 Jeanette Street, Las Vegas, NV 89131**
2. Licensee is informed that the Beneficiary's interest in the real property is that of a third party making decisions or performing due diligence for an existing or potential lien holder.
3. The intended purpose of this BPO is to assist the Beneficiary in making decisions within the scope of applicable statutory and regulatory requirements and performing required due diligence.
4. Licensee certifies that Licensee has no existing or contemplated interest in the property, including without limitation the possibility of Licensee representing the seller or any purchaser.

Issue date: **December 13, 2018**

Licensee signature: **/David Berg/**

NOTWITHSTANDING ANY PREPRINTED LANGUAGE TO THE CONTRARY, THIS OPINION IS NOT AN APPRAISAL OF THE MARKET VALUE OF THE PROPERTY. IF AN APPRAISAL IS DESIRED, THE SERVICES OF A LICENSED OR CERTIFIED APPRAISER MUST BE OBTAINED.

Disclaimer

Notwithstanding any preprinted language to the contrary, this opinion is not an appraisal of the market value of the property. If an appraisal is desired, the services of a licensed or certified appraiser must be obtained.

Unless otherwise specifically agreed to in writing:

The intended purpose of this report is to assist the Clear Capital account holder in making decisions within the scope of applicable statutory and regulatory requirements and performing required due diligence. This document is provided solely for the use of the Clear Capital account holder and not any other party, is not intended as any guarantee of value and/or condition of the subject property and should not be relied on as such. In the event that this document is found to be defective, incorrect, negligently prepared or unfit for its authorized use, Clear Capital's sole liability shall be to promptly refund the total fee expended by the account holder for this report or to replace it at no charge to the account holder, but in no event shall Clear Capital be responsible to the account holder for any indirect or consequential damages whatsoever. This warranty is in lieu of all other warranties, express or implied, except where otherwise required by law. The account holder shall notify Clear Capital within thirty (30) days of this report's delivery to the account holder if it believes that this document is defective, incorrect, negligently prepared or unfit for its authorized use. Under no circumstances may Clear Capital forms or their contents be published, copied, replicated, or mimicked.