

Please Note: This report was completed with the following assumptions: Market Approach: **Fair Market Price**, Marketing Time: **Typical**. Important additional information relating to this report, including use and restrictions, is contained in an attached addendum which is an integral part of this report.

<b>Address</b>	14225 Desert Ash Drive, Horizon City, TEXAS 79928	<b>Order ID</b>	6035061	<b>Property ID</b>	25823709
<b>Inspection Date</b>	01/01/2019	<b>Date of Report</b>	01/02/2019		
<b>Loan Number</b>	36779	<b>APN</b>	H77100000203000		
<b>Borrower Name</b>	Breckenridge Property Fund 2016 LLC				

**Tracking IDs**

<b>Order Tracking ID</b>	BotW New Fac-DriveBy BPO 12.31.18	<b>Tracking ID 1</b>	BotW New Fac-DriveBy BPO
<b>Tracking ID 2</b>	--	<b>Tracking ID 3</b>	--

**I. General Conditions**

<b>Property Type</b>	SFR	<b>Condition Comments</b> Subject looks to be in average condition with no exterior repairs noted.
<b>Occupancy</b>	Occupied	
<b>Ownership Type</b>	Fee Simple	
<b>Property Condition</b>	Average	
<b>Estimated Exterior Repair Cost</b>		
<b>Estimated Interior Repair Cost</b>		
<b>Total Estimated Repair</b>		
<b>HOA</b>	No	
<b>Visible From Street</b>	Visible	

**II. Subject Sales & Listing History**

<b>Current Listing Status</b>	Not Currently Listed	<b>Listing History Comments</b> No listing history in the MLS
<b>Listing Agency/Firm</b>		
<b>Listing Agent Name</b>		
<b>Listing Agent Phone</b>		
<b># of Removed Listings in Previous 12 Months</b>	0	
<b># of Sales in Previous 12 Months</b>	0	

Original List Date	Original List Price	Final List Date	Final List Price	Result	Result Date	Result Price	Source
--------------------	---------------------	-----------------	------------------	--------	-------------	--------------	--------

**III. Neighborhood & Market Data**

<b>Location Type</b>	Suburban	<b>Neighborhood Comments</b> Subject is located in an established neighborhood close to schools, parks and some shopping amenities
<b>Local Economy</b>	Slow	
<b>Sales Prices in this Neighborhood</b>	Low: \$59,000 High: \$250,000	
<b>Market for this type of property</b>	Remained Stable for the past 6 months.	
<b>Normal Marketing Days</b>	<90	

#### IV. Current Listings

	Subject	Listing 1	Listing 2 *	Listing 3
Street Address	14225 Desert Ash Drive	14228 Desert Ash Dr	14253 Desert Stone Dr	14113 De Stefano Ln
City, State	Horizon City, TEXAS	Horizon City, TX	Horizon City, TX	El Paso, TX
Zip Code	79928	79928	79928	79928
Datasource	Tax Records	MLS	MLS	MLS
Miles to Subj.	--	0.03 <sup>1</sup>	0.34 <sup>1</sup>	0.81 <sup>1</sup>
Property Type	SFR	SFR	SFR	SFR
Original List Price \$	\$	\$119,000	\$109,770	\$129,900
List Price \$	--	\$115,000	\$109,770	\$119,900
Original List Date		09/05/2018	05/22/2018	08/01/2018
DOM · Cumulative DOM	-- · --	81 · 119	163 · 225	84 · 154
Age (# of years)	14	14	13	13
Condition	Average	Average	Average	Average
Sales Type	--	Fair Market Value	Fair Market Value	Fair Market Value
Style/Design	1 Story Ranch	1 Story Ranch	1 Story Ranch	1 Story Ranch
# Units	1	1	1	1
Living Sq. Feet	1,411	1,515	1,431	1,529
Bdrm · Bths · ½ Bths	4 · 2	3 · 2	4 · 2	4 · 2
Total Room #	8	7	8	8
Garage (Style/Stalls)	Attached 2 Car(s)	Attached 2 Car(s)	Attached 2 Car(s)	Attached 2 Car(s)
Basement (Yes/No)	No	No	No	No
Basement (% Fin)	0%	0%	0%	0%
Basement Sq. Ft.	--	--	--	--
Pool/Spa	--	--	--	--
Lot Size	.14 acres	.15 acres	.15 acres	.14 acres
Other	None	None	None	None

**Listing Comments** Why the comparable listing is superior or inferior to the subject.

**Listing 1** Has a walled backyard and patio. Is one story with a two car attached garage. Features evaporative air and tile flooring.

**Listing 2** Has a walled backyard and patio. Is one story with a two car attached garage. Features central air and tile flooring.

**Listing 3** Has a walled backyard and patio. Is one story with a two car attached garage. features central air and carpet flooring.

\* Listing 2 is the most comparable listing to the subject.

<sup>1</sup> Comp's "Miles to Subject" was calculated by the system.

<sup>2</sup> Comp's "Miles to Subject" provided by Real Estate Professional.

<sup>3</sup> Subject \$/ft based upon as-is sale price.

## V. Recent Sales

	Subject	Sold 1 *	Sold 2	Sold 3
Street Address	14225 Desert Ash Drive	14104 Peter Noyes	14092 Warren Belin Dr	325 Peter Noyes Dr
City, State	Horizon City, TEXAS	El Paso, TX	El Paso, TX	El Paso, TX
Zip Code	79928	79928	79928	79928
Datasource	Tax Records	MLS	MLS	MLS
Miles to Subj.	--	0.78 <sup>1</sup>	0.91 <sup>1</sup>	0.89 <sup>1</sup>
Property Type	SFR	SFR	SFR	SFR
Original List Price \$	--	\$117,000	\$121,999	\$124,500
List Price \$	--	\$114,500	\$121,999	\$120,000
Sale Price \$	--	\$110,000	\$118,000	\$120,000
Type of Financing	--	Cash	Va	Fha
Date of Sale	--	11/19/2018	9/26/2018	10/30/2018
DOM · Cumulative DOM	-- · --	108 · 119	57 · 42	209 · 226
Age (# of years)	14	13	13	12
Condition	Average	Average	Average	Average
Sales Type	--	Fair Market Value	Fair Market Value	Fair Market Value
Style/Design	1 Story Ranch	1 Story Ranch	1 Story Ranch	1 Story Ranch
# Units	1	1	1	1
Living Sq. Feet	1,411	1,370	1,466	1,502
Bdrm · Bths · ½ Bths	4 · 2	4 · 2	4 · 2	4 · 2
Total Room #	8	8	8	8
Garage (Style/Stalls)	Attached 2 Car(s)	Attached 2 Car(s)	Attached 2 Car(s)	Attached 2 Car(s)
Basement (Yes/No)	No	No	No	No
Basement (% Fin)	0%	0%	0%	0%
Basement Sq. Ft.	%	--	--	--
Pool/Spa	--	--	--	--
Lot Size	.14 acres	.14 acres	.14 acres	.14 acres
Other	None	None	None	None
Net Adjustment	--	+\$310	-\$650	+\$1,110
Adjusted Price	--	\$110,310	\$117,350	\$121,110

### Reasons for Adjustments Why the comparable sale is superior or inferior to the subject.

- Sold 1** Has a walled backyard and patio. Is one story with a two car attached garage. Features central air and carpet flooring. Adjustments are 410 for square footage and -100 for age.
- Sold 2** Has a walled backyard and patio. Is one story with a two car attached garage. features central air and tile flooring. Adjustments are -550 for square footage and -100 for age,
- Sold 3** Has a walled backyard and patio. Is one story with a two car attached garage. Features central air and tile flooring. Adjustments are -910 for square footage and -200 for age.

\* Sold 1 is the most comparable sale to the subject.

<sup>1</sup> Comp's "Miles to Subject" was calculated by the system.

<sup>2</sup> Comp's "Miles to Subject" provided by Real Estate Professional.

<sup>3</sup> Subject \$/ft based upon as-is sale price.

## VI. Marketing Strategy

	As Is Price	Repaired Price
<b>Suggested List Price</b>	\$115,000	\$115,000
<b>Sales Price</b>	\$113,000	\$113,000
<b>30 Day Price</b>	\$111,000	--

### Comments Regarding Pricing Strategy

Subject is priced according to comps currently on the market. Comp search was +/- 5 years in age, +/- 5 miles and +/- 300 square footage. Sold comps were expanded back up to 180 days. Used best comps available for this area.

## VII. Clear Capital Quality Assurance Comments Addendum

**Reviewer's Notes** Due to a lack of more similar comps available, these search parameters were expanded in order to provide comps from the subject's competitive market area that reflect current market conditions. The broker's as-is conclusion reflects the market for the subject. Comps are within a reasonable distance, relatively current, and accurately reflect the subject's defining characteristics. Thus, the as-is conclusion appears to be adequately supported.

**VIII. Property Images**

**Address** 14225 Desert Ash Drive, Horizon City, TEXAS 79928  
**Loan Number** 36779

**Suggested List** \$115,000

**Suggested Repaired** \$115,000

**Sale** \$113,000



**Subject** 14225 Desert Ash Dr

**View** Front



**Subject** 14225 Desert Ash Dr

**View** Address Verification

**VIII. Property Images (continued)**

**Address** 14225 Desert Ash Drive, Horizon City, TEXAS 79928  
**Loan Number** 36779

**Suggested List** \$115,000

**Suggested Repaired** \$115,000

**Sale** \$113,000



**Subject** 14225 Desert Ash Dr

**View** Street



**Listing Comp 1**

**View** Front

**VIII. Property Images (continued)**

**Address** 14225 Desert Ash Drive, Horizon City, TEXAS 79928  
**Loan Number** 36779

**Suggested List** \$115,000

**Suggested Repaired** \$115,000

**Sale** \$113,000



**Listing Comp 2**

**View** Front



**Listing Comp 3**

**View** Front

**VIII. Property Images (continued)**

**Address** 14225 Desert Ash Drive, Horizon City, TEXAS 79928  
**Loan Number** 36779

**Suggested List** \$115,000

**Suggested Repaired** \$115,000

**Sale** \$113,000



**Sold Comp 1**

**View** Front



**Sold Comp 2**

**View** Front



**VIII. Property Images (continued)**

**Address** 14225 Desert Ash Drive, Horizon City, TEXAS 79928

**Loan Number** 36779

**Suggested List** \$115,000

**Suggested Repaired** \$115,000

**Sale** \$113,000



**Sold Comp 3**

**View** Front

**ClearMaps Addendum**

**Address** ★ 14225 Desert Ash Drive, Horizon City, TEXAS 79928  
**Loan Number** 36779      **Suggested List** \$115,000      **Suggested Repaired** \$115,000      **Sale** \$113,000

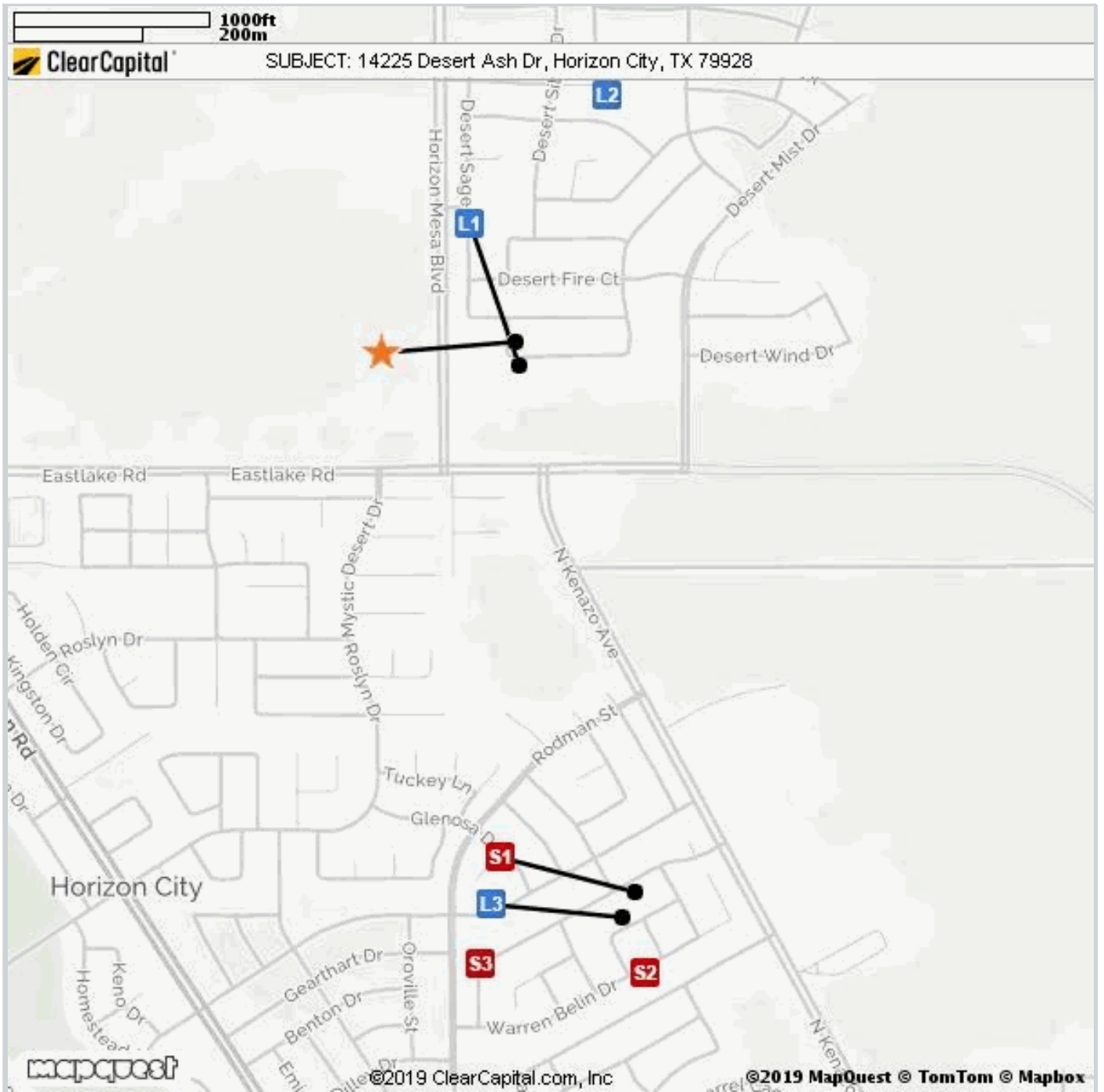

Comparable	Address	Miles to Subject	Mapping Accuracy
★ Subject	14225 Desert Ash Dr, Horizon City, TX	--	Parcel Match
L1 Listing 1	14228 Desert Ash Dr, El Paso, TX	0.03 Miles <sup>1</sup>	Parcel Match
L2 Listing 2	14253 Desert Stone Dr, El Paso, TX	0.34 Miles <sup>1</sup>	Parcel Match
L3 Listing 3	14113 De Stefano Ln, El Paso, TX	0.81 Miles <sup>1</sup>	Parcel Match
S1 Sold 1	14104 Peter Noyes, El Paso, TX	0.78 Miles <sup>1</sup>	Parcel Match
S2 Sold 2	14092 Warren Belin Dr, El Paso, TX	0.91 Miles <sup>1</sup>	Parcel Match
S3 Sold 3	325 Peter Noyes Dr, El Paso, TX	0.89 Miles <sup>1</sup>	Parcel Match

<sup>1</sup> The Comparable "Distance from Subject" value has been calculated by the Clear Capital system.  
<sup>2</sup> The Comparable "Distance from Subject" value has been provided by the Real Estate Professional.

## Market Approach and Market Time

The Market Approach of this report, as established by the customer, is: **Fair Market Price**. (See definition below.)

The Marketing Time as specified by the customer is **Typical**. (See definition below.)

Definitions:

Fair Market Price	A price at which the property would sell between a willing buyer and a willing seller neither being compelled by undue pressure and both having reasonable knowledge of relevant facts.
Distressed Price	A price at which the property would sell between a willing buyer and a seller acting under duress.
Marketing Time	The amount of time the property is exposed to a pool of prospective buyers before going into contract. The customer either specifies the number of days, requests a marketing time that is typical to the subject's market area and/or requests an abbreviated marketing time.
Typical for Local Market	The estimated time required to adequately expose the subject property to the market resulting in a contract of sale.

## Report Instructions

This section shows the instructions that were approved by the customer and provided to the broker prior to completing the report.

\*\*\* Please Note: This is a RUSH assignment. Do not accept if you cannot meet the current due date and time. Please reference the set terms and contact Clear Capital at 530.582.5011 if you require any changes. Thanks! \*\*\*

Instructions last updated: 7/17/2017

Purpose:

Please determine a fair market price for this property at which it would sell in a typical marketing time for the area.

Customer Specific Requests:

\*\*If the property is commercial or mixed use, please stop and contact Clear Capital as soon as possible\*\*

Form Help:

There are blue question marks (?) throughout this form. These are designed to offer guidance for that particular section of the form. Please click on them for help.

Comparable Requirements:

1. Please use fair market comps from the same neighborhood, block or subdivision whenever possible.
2. Please only use REO comparables if the market is driven by REOs and they are comparable in characteristics and condition.
3. Please use comps that have closed in the past 3 months to show the current market conditions or comment in the report if this is not possible. In rapidly changing markets, active listing comps should be given equal or greater weight than sold comps in your analysis.

Standard Instructions:

1. Clear Capital Code Of Conduct - Please make sure that you are always abiding by the Clear Capital Code of Conduct when completing valuation reports.
2. If the subject is currently listed, please consider all available information pertaining to the subject's condition. This information should be utilized when developing the assumption of the subject's condition.
3. Use the subject characteristics provided in the report Grid (if preloaded) to evaluate the property. This information is from a full interior appraisal and is assumed to be most accurate. If your inspection reveals obvious inaccuracies, please explain in the narrative of the report.
4. Include sufficient detail to help our mutual customer gain a complete understanding of the subject's neighborhood such as neighborhood desirability, amenities, parks, schools, commercial or industrial influences, REO activity, traffic, board-up-homes, etc.
5. Do not approach occupants or owners.
6. If the subject is a Commercial property, contact Clear Capital immediately at 530-582-5011 for direction on how to proceed with the report.
7. Please do not accept if you or your office has completed a report on this property in the last month, are currently listing this property, or have any vested interest in the subject property.
8. Clear Capital does not allow any log ins from IP addresses from foreign countries. This includes, but is not limited to; data entry services, form completion services, etc. Also, it is against Clear Capital code of conduct to share your password with anyone who is not a W2 employee in your office.
9. Clear Capital and our mutual customers greatly appreciate your expertise. If you cannot personally inspect the property, select comparables, and determine a price for the subject, please do not accept this report. Per the standards and guidelines adopted by Clear Capital and other industry leaders, the use of assistants to complete any of the aforementioned tasks is not permitted.

Due to the importance of an independent opinion of price, please do not discuss your price with anyone or be influenced by list price, pending offers, accept comp packets, repair estimates or the listing agent's opinion.

1. One current, original photo of the front of the subject
2. One address verification photo
3. One street scene photo looking down the street
4. MLS listing and sold comp photos required, please comment if no MLS.



## Broker Information

<b>Broker Name</b>	Kerry Jonas	<b>Company/Brokerage</b>	G
<b>License No</b>	694608		
<b>License Expiration</b>	09/30/2019	<b>License State</b>	TX
<b>Phone</b>	7192444408	<b>Email</b>	realtorkerryjonas@gmail.com
<b>Broker Distance to Subject</b>	7.43 miles	<b>Date Signed</b>	01/01/2019

*By confirming the above contact and real estate license information and submitting the report, the above signed hereby certifies and agrees that: 1) I personally took the pictures, selected comparables, and determined the price conclusion. 2) To the best of my knowledge, the statements of fact contained in this report are true and correct. 3) The reported analyses, opinions, and conclusions are my personal, impartial, and unbiased professional analyses, opinions, and conclusions. 4) I have no present or prospective interest in the property that is the subject of this report and no personal interest with respect to the parties involved. 5) I have no bias with respect to the property that is the subject of this report or to the parties involved with this assignment. 6) My compensation for completing this assignment is not contingent upon the development or reporting of a predetermined price point. 7) I did not base, either partially or completely, my analysis and/or opinion and conclusions in this report on race, color, religion, sex, age, marital status, handicap, familial status, or national origin of either the prospective owners or occupants of the subject property or of the present owners or occupants of the properties in the vicinity of the subject property or on any other basis prohibited by law. 8) I maintain errors and omissions insurance, to the extent required by state law, for all liability associated with the preparation of this Valuation Report.*

### Disclaimer

**THIS REPORT SHOULD NOT BE CONSIDERED AN APPRAISAL. In making any decision that relies upon my work, you should know that I have not followed the guidelines for development of an appraisal or analysis contained in the Uniform Standards of Professional Appraisal Practice of the Appraisal Foundation.**

**Unless otherwise specifically agreed to in writing:**

**The intended purpose of this report is to assist the Clear Capital account holder in making decisions within the scope of applicable statutory and regulatory requirements and performing required due diligence. This document is provided solely for the use of the Clear Capital account holder and not any other party, is not intended as any guarantee of value and/or condition of the subject property and should not be relied on as such. In the event that this document is found to be defective, incorrect, negligently prepared or unfit for its authorized use, Clear Capital's sole liability shall be to promptly refund the total fee expended by the account holder for this report or to replace it at no charge to the account holder, but in no event shall Clear Capital be responsible to the account holder for any indirect or consequential damages whatsoever. This warranty is in lieu of all other warranties, express or implied, except where otherwise required by law. The account holder shall notify Clear Capital within thirty (30) days of this report's delivery to the account holder if it believes that this document is defective, incorrect, negligently prepared or unfit for its authorized use. Under no circumstances may Clear Capital forms or their contents be published, copied, replicated, or mimicked.**