

Please Note: This report was completed with the following assumptions: Market Approach: **Fair Market Price**, Marketing Time: **Typical**. Important additional information relating to this report, including use and restrictions, is contained in an attached addendum which is an integral part of this report.

<b>Address</b>	9404 Alvera Court, Albuquerque, NM 87121	<b>Order ID</b>	6083538	<b>Property ID</b>	26111944
<b>Inspection Date</b>	02/22/2019	<b>Date of Report</b>	02/22/2019		
<b>Loan Number</b>	37121	<b>APN</b>	100905526042922137		
<b>Borrower Name</b>	Breckenridge Property Fund 2016 LLC				

**Tracking IDs**

<b>Order Tracking ID</b>	Botw New Fac-DriveBy BPO 02.21.19	<b>Tracking ID 1</b>	Botw New Fac-DriveBy BPO 02.21.19
<b>Tracking ID 2</b>	--	<b>Tracking ID 3</b>	--

**I. General Conditions**

<b>Property Type</b>	SFR	<b>Condition Comments</b>	
<b>Occupancy</b>	Occupied		Home is adequately maintained and no exterior repairs noted.
<b>Ownership Type</b>	Fee Simple		
<b>Property Condition</b>	Average		
<b>Estimated Exterior Repair Cost</b>	\$0		
<b>Estimated Interior Repair Cost</b>	\$0		
<b>Total Estimated Repair</b>	\$0		
<b>HOA</b>	No		
<b>Visible From Street</b>	Visible		

**II. Subject Sales & Listing History**

<b>Current Listing Status</b>	Not Currently Listed	<b>Listing History Comments</b>	
<b>Listing Agency/Firm</b>			Home has not been listed or sold in MLS data.
<b>Listing Agent Name</b>			
<b>Listing Agent Phone</b>			
<b># of Removed Listings in Previous 12 Months</b>	0		
<b># of Sales in Previous 12 Months</b>	0		

Original List Date	Original List Price	Final List Date	Final List Price	Result	Result Date	Result Price	Source
--------------------	---------------------	-----------------	------------------	--------	-------------	--------------	--------

**III. Neighborhood & Market Data**

<b>Location Type</b>	Urban	<b>Neighborhood Comments</b>	
<b>Local Economy</b>	Stable		Neighborhood is located on the south west side of Albuquerque in the Southwest Heights area. Homes in the area are single family site built homes.
<b>Sales Prices in this Neighborhood</b>	Low: \$110,000 High: \$190,000		
<b>Market for this type of property</b>	Remained Stable for the past 6 months.		
<b>Normal Marketing Days</b>	<90		

#### IV. Current Listings

	Subject	Listing 1	Listing 2 *	Listing 3
Street Address	9404 Alvera Court	10224 Andalusian Ave Sw	520 Mayfair Pl Sw	501 Mayfair Pl Sw
City, State	Albuquerque, NM	Albuquerque, NM	Albuquerque, NM	Albuquerque, NM
Zip Code	87121	87121	87121	87121
Datasource	Tax Records	MLS	MLS	MLS
Miles to Subj.	--	0.61 <sup>1</sup>	0.88 <sup>1</sup>	0.90 <sup>1</sup>
Property Type	SFR	SFR	SFR	SFR
Original List Price \$	\$	\$169,900	\$155,000	\$145,000
List Price \$	--	\$169,900	\$155,000	\$145,000
Original List Date		01/09/2019	02/04/2019	02/14/2019
DOM · Cumulative DOM	-- · --	43 · 44	17 · 18	7 · 8
Age (# of years)	19	19	14	18
Condition	Average	Good	Average	Average
Sales Type	--	Fair Market Value	Fair Market Value	Fair Market Value
Style/Design	1 Story ranch	1 Story ranch	1 Story ranch	1 Story ranch
# Units	1	1	1	1
Living Sq. Feet	1,560	1,450	1,415	1,668
Bdrm · Bths · ½ Bths	3 · 2	3 · 2	3 · 2	3 · 2
Total Room #	5	5	5	5
Garage (Style/Stalls)	Attached 2 Car(s)	Attached 2 Car(s)	Attached 2 Car(s)	Attached 2 Car(s)
Basement (Yes/No)	No	No	No	No
Basement (% Fin)	0%	0%	0%	0%
Basement Sq. Ft.	--	--	--	--
Pool/Spa	--	--	--	--
Lot Size	0.11 acres	0.14 acres	0.12 acres	0.14 acres
Other	--	--	fireplace	--

#### Listing Comments Why the comparable listing is superior or inferior to the subject.

**Listing 1** Three bedroom two bath home with an attached two car garage. Home has laminate and ceramic tile flooring. Home has granite counter tops, refrigerated air conditioning, stainless steel appliances.

**Listing 2** Three bedroom two bath home with an attached two car garage. Home has carpet and ceramic tile flooring. Home has a gas log fireplace. Covered patio.

**Listing 3** Three bedroom two bath home with an attached two car garage. Home has carpet and vinyl flooring. Home has a new roof.

\* Listing 2 is the most comparable listing to the subject.

<sup>1</sup> Comp's "Miles to Subject" was calculated by the system.

<sup>2</sup> Comp's "Miles to Subject" provided by Real Estate Professional.

<sup>3</sup> Subject \$/ft based upon as-is sale price.

## V. Recent Sales

	Subject	Sold 1 *	Sold 2	Sold 3
Street Address	9404 Alvera Court	9116 Sunbow Ave Sw	900 Sunbird Rd Sw	828 Terracotta Pl Sw
City, State	Albuquerque, NM	Albuquerque, NM	Albuquerque, NM	Albuquerque, NM
Zip Code	87121	87121	87121	87121
Datasource	Tax Records	MLS	MLS	MLS
Miles to Subj.	--	0.13 <sup>1</sup>	0.19 <sup>1</sup>	0.45 <sup>1</sup>
Property Type	SFR	SFR	SFR	SFR
Original List Price \$	--	\$159,900	\$165,000	\$151,000
List Price \$	--	\$159,900	\$165,000	\$151,000
Sale Price \$	--	\$150,000	\$161,000	\$145,000
Type of Financing	--	Conventional	Conventional	Cash
Date of Sale	--	1/18/2019	9/13/2018	12/14/2018
DOM · Cumulative DOM	-- · --	94 · 94	43 · 43	67 · 67
Age (# of years)	19	24	32	20
Condition	Average	Average	Average	Average
Sales Type	--	Fair Market Value	Fair Market Value	Fair Market Value
Style/Design	1 Story ranch	1 Story ranch	1 Story ranch	1 Story ranch
# Units	1	1	1	1
Living Sq. Feet	1,560	1,544	1,469	1,584
Bdrm · Bths · ½ Bths	3 · 2	3 · 2	3 · 2	3 · 2
Total Room #	5	5	5	5
Garage (Style/Stalls)	Attached 2 Car(s)	Attached 2 Car(s)	Attached 2 Car(s)	Attached 2 Car(s)
Basement (Yes/No)	No	No	No	No
Basement (% Fin)	0%	0%	0%	0%
Basement Sq. Ft.	%	--	--	--
Pool/Spa	--	--	--	--
Lot Size	0.11 acres	0.15 acres	0.16 acres	0.14 acres
Other	--	--	fireplace	--
Net Adjustment	--	+\$320	+\$1,820	-\$480
Adjusted Price	--	\$150,320	\$162,820	\$144,520

### Reasons for Adjustments Why the comparable sale is superior or inferior to the subject.

**Sold 1** Three bedroom two bath home with an attached two car garage. Home has carpet and ceramic tile flooring. Home has a new roof.

**Sold 2** Three bedroom two bath home with an attached two car garage. Home has two living areas, carpet, ceramic tile and wood flooring and a wood burning fireplace. Covered patio.

**Sold 3** Three bedroom two bath home with an attached two car garage. Home has open floor plan, cathedral ceilings, an eat in kitchen. Recently painted interior and ceramic tile flooring.

\* Sold 1 is the most comparable sale to the subject.

<sup>1</sup> Comp's "Miles to Subject" was calculated by the system.

<sup>2</sup> Comp's "Miles to Subject" provided by Real Estate Professional.

<sup>3</sup> Subject \$/ft based upon as-is sale price.

## VI. Marketing Strategy

	As Is Price	Repaired Price
<b>Suggested List Price</b>	\$155,000	\$155,000
<b>Sales Price</b>	\$150,000	\$150,000
<b>30 Day Price</b>	\$141,000	--
<b>Comments Regarding Pricing Strategy</b>		
Price conclusion based on recently listed and sold comps in the subject area.		

## VII. Clear Capital Quality Assurance Comments Addendum

**Reviewer's Notes** The price is based on the subject being in average condition. Comps are similar in characteristics, located within 0.90 miles and the sold comps closed within the last 5 months. The market is reported as being stable in the last 6 months. The price conclusion is deemed supported.

**VIII. Property Images**

**Address** 9404 Alvera Court, Albuquerque, NM 87121  
**Loan Number** 37121

**Suggested List** \$155,000

**Suggested Repaired** \$155,000

**Sale** \$150,000



**Subject** 9404 Alvera Ct Sw

**View** Front



**Subject** 9404 Alvera Ct Sw

**View** Address Verification

**VIII. Property Images (continued)**

**Address** 9404 Alvera Court, Albuquerque, NM 87121  
**Loan Number** 37121

**Suggested List** \$155,000

**Suggested Repaired** \$155,000

**Sale** \$150,000



**Subject** 9404 Alvera Ct Sw

**View** Street



**Listing Comp 1** 10224 Andalusian Ave Sw

**View** Front

**VIII. Property Images (continued)**

**Address** 9404 Alvera Court, Albuquerque, NM 87121  
**Loan Number** 37121

**Suggested List** \$155,000

**Suggested Repaired** \$155,000

**Sale** \$150,000



**Listing Comp 2** 520 Mayfair Pl Sw

**View** Front



**Listing Comp 3** 501 Mayfair Pl Sw

**View** Front

**VIII. Property Images (continued)**

**Address** 9404 Alvera Court, Albuquerque, NM 87121  
**Loan Number** 37121

**Suggested List** \$155,000

**Suggested Repaired** \$155,000

**Sale** \$150,000



**Sold Comp 1** 9116 Sunbow Ave Sw

**View** Front



**Sold Comp 2** 900 Sunbird Rd Sw

**View** Front



**VIII. Property Images (continued)**

**Address** 9404 Alvera Court, Albuquerque, NM 87121

**Loan Number** 37121

**Suggested List** \$155,000

**Suggested Repaired** \$155,000

**Sale** \$150,000



**Sold Comp 3** 828 Terracotta Pl Sw

**View** Front

**ClearMaps Addendum**

**Address** ★ 9404 Alvera Court, Albuquerque, NM 87121

**Loan Number** 37121

**Suggested List** \$155,000

**Suggested Repaired** \$155,000

**Sale** \$150,000

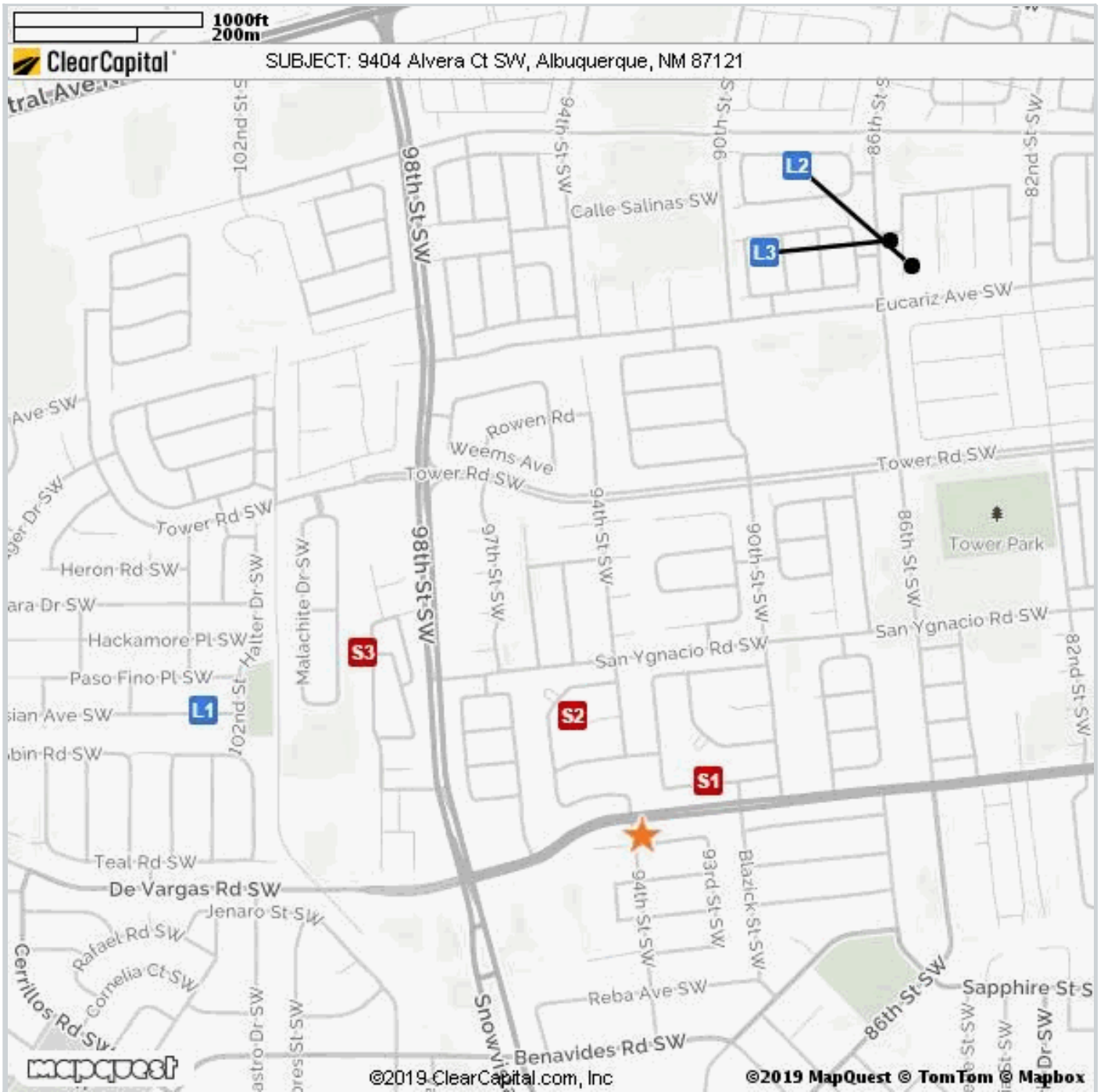

Comparable	Address	Miles to Subject	Mapping Accuracy
★ Subject	9404 Alvera Ct Sw, Albuquerque, NM	--	Parcel Match
L1 Listing 1	10224 Andalusian Ave Sw, Albuquerque, NM	0.61 Miles <sup>1</sup>	Parcel Match
L2 Listing 2	520 Mayfair Pl Sw, Albuquerque, NM	0.88 Miles <sup>1</sup>	Parcel Match
L3 Listing 3	501 Mayfair Pl Sw, Albuquerque, NM	0.90 Miles <sup>1</sup>	Parcel Match
S1 Sold 1	9116 Sunbow Ave Sw, Albuquerque, NM	0.13 Miles <sup>1</sup>	Parcel Match
S2 Sold 2	900 Sunbird Rd Sw, Albuquerque, NM	0.19 Miles <sup>1</sup>	Parcel Match
S3 Sold 3	828 Terracotta Pl Sw, Albuquerque, NM	0.45 Miles <sup>1</sup>	Parcel Match

<sup>1</sup> The Comparable "Distance from Subject" value has been calculated by the Clear Capital system.

<sup>2</sup> The Comparable "Distance from Subject" value has been provided by the Real Estate Professional.

## Market Approach and Market Time

The Market Approach of this report, as established by the customer, is: **Fair Market Price**. (See definition below.)

The Marketing Time as specified by the customer is **Typical**. (See definition below.)

Definitions:

Fair Market Price	A price at which the property would sell between a willing buyer and a willing seller neither being compelled by undue pressure and both having reasonable knowledge of relevant facts.
Distressed Price	A price at which the property would sell between a willing buyer and a seller acting under duress.
Marketing Time	The amount of time the property is exposed to a pool of prospective buyers before going into contract. The customer either specifies the number of days, requests a marketing time that is typical to the subject's market area and/or requests an abbreviated marketing time.
Typical for Local Market	The estimated time required to adequately expose the subject property to the market resulting in a contract of sale.

## Report Instructions

This section shows the instructions that were approved by the customer and provided to the broker prior to completing the report.

\*\*\* Please Note: This is a RUSH assignment. Do not accept if you cannot meet the current due date and time. Please reference the set terms and contact Clear Capital at 530.582.5011 if you require any changes. Thanks! \*\*\*

Instructions last updated: 7/17/2017

Purpose:

Please determine a fair market price for this property at which it would sell in a typical marketing time for the area.

Customer Specific Requests:

\*\*If the property is commercial or mixed use, please stop and contact Clear Capital as soon as possible\*\*

Form Help:

There are blue question marks (?) throughout this form. These are designed to offer guidance for that particular section of the form. Please click on them for help.

Comparable Requirements:

1. Please use fair market comps from the same neighborhood, block or subdivision whenever possible.
2. Please only use REO comparables if the market is driven by REOs and they are comparable in characteristics and condition.
3. Please use comps that have closed in the past 3 months to show the current market conditions or comment in the report if this is not possible. In rapidly changing markets, active listing comps should be given equal or greater weight than sold comps in your analysis.

Standard Instructions:

1. Clear Capital Code Of Conduct - Please make sure that you are always abiding by the Clear Capital Code of Conduct when completing valuation reports.
2. If the subject is currently listed, please consider all available information pertaining to the subject's condition. This information should be utilized when developing the assumption of the subject's condition.
3. Use the subject characteristics provided in the report Grid (if preloaded) to evaluate the property. This information is from a full interior appraisal and is assumed to be most accurate. If your inspection reveals obvious inaccuracies, please explain in the narrative of the report.
4. Include sufficient detail to help our mutual customer gain a complete understanding of the subject's neighborhood such as neighborhood desirability, amenities, parks, schools, commercial or industrial influences, REO activity, traffic, board-up-homes, etc.
5. Do not approach occupants or owners.
6. If the subject is a Commercial property, contact Clear Capital immediately at 530-582-5011 for direction on how to proceed with the report.
7. Please do not accept if you or your office has completed a report on this property in the last month, are currently listing this property, or have any vested interest in the subject property.
8. Clear Capital does not allow any log ins from IP addresses from foreign countries. This includes, but is not limited to; data entry services, form completion services, etc. Also, it is against Clear Capital code of conduct to share your password with anyone who is not a W2 employee in your office.
9. Clear Capital and our mutual customers greatly appreciate your expertise. If you cannot personally inspect the property, select comparables, and determine a price for the subject, please do not accept this report. Per the standards and guidelines adopted by Clear Capital and other industry leaders, the use of assistants to complete any of the aforementioned tasks is not permitted.

Due to the importance of an independent opinion of price, please do not discuss your price with anyone or be influenced by list price, pending offers, accept comp packets, repair estimates or the listing agent's opinion.

1. One current, original photo of the front of the subject
2. One address verification photo
3. One street scene photo looking down the street
4. MLS listing and sold comp photos required, please comment if no MLS.



## Broker Information

<b>Broker Name</b>	Joel Tafoya	<b>Company/Brokerage</b>	Rio Vista Realty
<b>License No</b>	34919		
<b>License Expiration</b>	11/30/2021	<b>License State</b>	NM
<b>Phone</b>	5054534325	<b>Email</b>	joeitafoya2@gmail.com
<b>Broker Distance to Subject</b>	7.80 miles	<b>Date Signed</b>	02/22/2019

*By confirming the above contact and real estate license information and submitting the report, the above signed hereby certifies and agrees that: 1) I personally took the pictures, selected comparables, and determined the price conclusion. 2) To the best of my knowledge, the statements of fact contained in this report are true and correct. 3) The reported analyses, opinions, and conclusions are my personal, impartial, and unbiased professional analyses, opinions, and conclusions. 4) I have no present or prospective interest in the property that is the subject of this report and no personal interest with respect to the parties involved. 5) I have no bias with respect to the property that is the subject of this report or to the parties involved with this assignment. 6) My compensation for completing this assignment is not contingent upon the development or reporting of a predetermined price point. 7) I did not base, either partially or completely, my analysis and/or opinion and conclusions in this report on race, color, religion, sex, age, marital status, handicap, familial status, or national origin of either the prospective owners or occupants of the subject property or of the present owners or occupants of the properties in the vicinity of the subject property or on any other basis prohibited by law. 8) I maintain errors and omissions insurance, to the extent required by state law, for all liability associated with the preparation of this Valuation Report.*

### Disclaimer

**This document is not an appraisal as defined by USPAP (Uniform Standards of Professional Appraisal Practice). It is not to be construed as an appraisal and may not be used as such for any purpose.**

**Unless otherwise specifically agreed to in writing:**

**The intended purpose of this report is to assist the Clear Capital account holder in making decisions within the scope of applicable statutory and regulatory requirements and performing required due diligence. This document is provided solely for the use of the Clear Capital account holder and not any other party, is not intended as any guarantee of value and/or condition of the subject property and should not be relied on as such. In the event that this document is found to be defective, incorrect, negligently prepared or unfit for its authorized use, Clear Capital's sole liability shall be to promptly refund the total fee expended by the account holder for this report or to replace it at no charge to the account holder, but in no event shall Clear Capital be responsible to the account holder for any indirect or consequential damages whatsoever. This warranty is in lieu of all other warranties, express or implied, except where otherwise required by law. The account holder shall notify Clear Capital within thirty (30) days of this report's delivery to the account holder if it believes that this document is defective, incorrect, negligently prepared or unfit for its authorized use. Under no circumstances may Clear Capital forms or their contents be published, copied, replicated, or mimicked.**