

Please Note: This report was completed with the following assumptions: Market Approach: **Fair Market Price** , Marketing Time: **Typical** . Important additional information relating to this report, including use and restrictions, is contained in an attached addendum which is an integral part of this report.

<b>Address</b>	4621 Adan Fuentes Street, El Paso, TX 79938	<b>Order ID</b>	6215229	<b>Property ID</b>	26695085
<b>Inspection Date</b>	06/19/2019	<b>Date of Report</b>	06/19/2019		
<b>Loan Number</b>	37686	<b>APN</b>	T82099902400600		
<b>Borrower Name</b>	Catamount Properties 2018 LLC	<b>County</b>	El Paso		

<b>Tracking IDs</b>					
<b>Order Tracking ID</b>	CITL_BPO_06.18.19	<b>Tracking ID 1</b>	CITL_BPO_06.18.19		
<b>Tracking ID 2</b>	--	<b>Tracking ID 3</b>	--		

## General Conditions

<b>Owner</b>	VANVORCE GUY F II & TRICIA L	<b>Condition Comments</b>	
<b>R. E. Taxes</b>	\$359,617	SUBJECT IS A SINGLE FAMILY RESIDENTIAL WITH STUCCO EXTERIOR, COMPOSITION SHINGLE ROOFING, REFRIGERATED COOLING, SINGLE ATTACHED GARAGE, CARPET AND TILE FLOORING. SUBJECT APPEARS TO BE IN AVERAGE CONDITION.	
<b>Assessed Value</b>	\$117,370		
<b>Zoning Classification</b>	R3		
<b>Property Type</b>	SFR		
<b>Occupancy</b>	Occupied		
<b>Ownership Type</b>	Fee Simple		
<b>Property Condition</b>	Average		
<b>Estimated Exterior Repair Cost</b>	\$0		
<b>Estimated Interior Repair Cost</b>	\$0		
<b>Total Estimated Repair</b>	\$0		
<b>HOA</b>	No		
<b>Visible From Street</b>	Visible		
<b>Road Type</b>	Public		

## Neighborhood & Market Data

<b>Location Type</b>	Suburban	<b>Neighborhood Comments</b>	
<b>Local Economy</b>	Stable	SUBJECT IS LOCATED IN FAR EAST EL PASO IN THE TRES SUENOS SUBDIVISION. SUBJECT IS LOCATED IN AN ESTABLISHED NEIGHBORHOOD SURROUNDED BY HOMES OF SIMILAR AGE, DESIGN AND CONSTRUCTION. SUBJECT IS NEAR SCHOOLS, PARKS AND SHOPPING CENTERS.	
<b>Sales Prices in this Neighborhood</b>	Low: \$105,000 High: \$180,000		
<b>Market for this type of property</b>	Remained Stable for the past 6 months.		
<b>Normal Marketing Days</b>	<180		

## Current Listings

	Subject	Listing 1	Listing 2 *	Listing 3
<b>Street Address</b>	4621 Adan Fuentes Street	12928 Beto Portugal Lane	4704 Hilario Hernandez Drive	12757 Raul Mendiola Lane
<b>City, State</b>	El Paso, TX	El Paso, TX	El Paso, TX	El Paso, TX
<b>Zip Code</b>	79938	79938	79938	79938
<b>Datasource</b>	Tax Records	MLS	MLS	MLS
<b>Miles to Subj.</b>	--	0.27 <sup>1</sup>	0.31 <sup>1</sup>	0.36 <sup>1</sup>
<b>Property Type</b>	SFR	SFR	SFR	SFR
<b>Original List Price \$</b>	\$	\$149,500	\$128,800	\$130,000
<b>List Price \$</b>	--	\$142,900	\$128,800	\$130,000
<b>Original List Date</b>		04/01/2019	05/13/2019	06/11/2019
<b>DOM · Cumulative DOM</b>	-- · --	79 · 79	37 · 37	8 · 8
<b>Age (# of years)</b>	7	7	6	7
<b>Condition</b>	Average	Average	Average	Average
<b>Sales Type</b>	--	Fair Market Value	Fair Market Value	Fair Market Value
<b>Location</b>	Neutral ; Residential	Neutral ; Residential	Neutral ; Residential	Neutral ; Residential
<b>View</b>	Neutral ; Residential	Neutral ; Residential	Neutral ; Residential	Neutral ; Residential
<b>Style/Design</b>	1 Story RANCH	1 Story RANCH	1 Story RANCH	1 Story RANCH
<b># Units</b>	1	1	1	1
<b>Living Sq. Feet</b>	1,318	1,456	1,192	1,324
<b>Bdrm · Bths · ½ Bths</b>	3 · 2	4 · 2	4 · 2	4 · 2
<b>Total Room #</b>	5	6	6	6
<b>Garage (Style/Stalls)</b>	Attached 1 Car	Attached 2 Car(s)	Attached 1 Car	Attached 2 Car(s)
<b>Basement (Yes/No)</b>	No	No	No	No
<b>Basement (% Fin)</b>	0%	0%	0%	0%
<b>Basement Sq. Ft.</b>	--	--	--	--
<b>Pool/Spa</b>	--	--	--	--
<b>Lot Size</b>	0.09 acres	0.14 acres	0.13 acres	0.12 acres
<b>Other</b>	--	--	--	--

\* Listing 2 is the most comparable listing to the subject.

<sup>1</sup> Comp's "Miles to Subject" was calculated by the system.

<sup>2</sup> Comp's "Miles to Subject" provided by Real Estate Professional.

<sup>3</sup> Subject \$/ft based upon as-is sale price.

**Listing Comments** Why the comparable listing is superior or inferior to the subject.

**Listing 1** LISTING 1 COMP IS A SINGLE FAMILY RESIDENTIAL WITH STUCCO EXTERIOR, COMPOSITION PITCHED ROOFING, REFRIGERATED COOLING, DOUBLE ATTACHED GARAGE, CARPET AND TILE FLOORING. SIMILAR TO SUBJECT. SAME SUBDIVISION AS SUBJECT.

**Listing 2** LISTING 2 COMP IS A SINGLE FAMILY RESIDENTIAL WITH STUCCO EXTERIOR, PITCHED ROOFING, REFRIGERATED COOLING, SINGLE ATTACHED GARAGE, CARPET AND TERRAZZO CERAMIC FLOORING. SIMILAR TO SUBJECT. SAME SUBDIVISION AS SUBJECT.

**Listing 3** LISTING 3 COMP IS A SINGLE FAMILY RESIDENTIAL WITH STUCCO EXTERIOR, SHINGLE ROOFING, REFRIGERATED COOLING, DOUBLE ATTACHED GARAGE, CARPET AND TILE FLOORING. SIMILAR TO SUBJECT. SAME SUBDIVISION AS SUBJECT.

### Recent Sales

	Subject	Sold 1	Sold 2 *	Sold 3
<b>Street Address</b>	4621 Adan Fuentes Street	12976 Alfredo Apodaca Drive	12721 Francisco Paz Drive	14435 Miguel Terrazas
<b>City, State</b>	El Paso, TX	El Paso, TX	El Paso, TX	El Paso, TX
<b>Zip Code</b>	79938	79938	79938	79938
<b>Datasource</b>	Tax Records	MLS	MLS	MLS
<b>Miles to Subj.</b>	--	0.18 <sup>1</sup>	0.46 <sup>1</sup>	0.15 <sup>1</sup>
<b>Property Type</b>	SFR	SFR	SFR	SFR
<b>Original List Price \$</b>	--	\$131,900	\$123,750	\$139,000
<b>List Price \$</b>	--	\$131,900	\$123,750	\$139,000
<b>Sale Price \$</b>	--	\$131,000	\$125,000	\$137,000
<b>Type of Financing</b>	--	Conventional	Conventional	Va
<b>Date of Sale</b>	--	03/29/2019	03/30/2019	06/12/2019
<b>DOM · Cumulative DOM</b>	-- · --	7 · 57	3 · 23	11 · 49
<b>Age (# of years)</b>	7	9	11	6
<b>Condition</b>	Average	Average	Average	Average
<b>Sales Type</b>	--	Fair Market Value	Fair Market Value	Fair Market Value
<b>Location</b>	Neutral ; Residential	Neutral ; Residential	Neutral ; Residential	Neutral ; Residential
<b>View</b>	Neutral ; Residential	Neutral ; Residential	Neutral ; Residential	Neutral ; Residential
<b>Style/Design</b>	1 Story RANCH	1 Story RANCH	1 Story RANCH	1 Story RANCH
<b># Units</b>	1	1	1	1
<b>Living Sq. Feet</b>	1,318	1,437	1,222	1,486
<b>Bdrm · Bths · ½ Bths</b>	3 · 2	3 · 2	3 · 2	3 · 2
<b>Total Room #</b>	5	6	5	6
<b>Garage (Style/Stalls)</b>	Attached 1 Car	Attached 2 Car(s)	Attached 1 Car	Attached 2 Car(s)
<b>Basement (Yes/No)</b>	No	No	No	No
<b>Basement (% Fin)</b>	0%	0%	0%	0%
<b>Basement Sq. Ft.</b>	--	--	--	--
<b>Pool/Spa</b>	--	--	--	--
<b>Lot Size</b>	0.09 acres	0.14 acres	0.10 acres	0.12 acres
<b>Other</b>	--	--	--	--
<b>Net Adjustment</b>	--	-\$2,190	+\$960	-\$2,680
<b>Adjusted Price</b>	--	\$128,810	\$125,960	\$134,320

\* Sold 2 is the most comparable sale to the subject.

<sup>1</sup> Comp's "Miles to Subject" was calculated by the system.

<sup>2</sup> Comp's "Miles to Subject" provided by Real Estate Professional.

<sup>3</sup> Subject \$/ft based upon as-is sale price.

## Recent Sales - Cont.

**Reasons for Adjustments** Why the comparable sale is superior or inferior to the subject.

- Sold 1** SOLD 1 COMP IS A SINGLE FAMILY RESIDENTIAL WITH STUCCO EXTERIOR, COMPOSITION FLAT ROOFING, REFRIGERATED COOLING, DOUBLE ATTACHED GARAGE, CARPET AND LAMINATE FLOORING. SIMILAR TO SUBJECT. SAME SUBDIVISION AS SUBJECT. ADJUSTMENTS MADE FOR GLA AND GARAGE.
- Sold 2** SOLD 2 COMP IS A SINGLE FAMILY RESIDENTIAL WITH STUCCO EXTERIOR, SHINGLE ROOFING, REFRIGERATED COOLING, SINGLE ATTACHED GARAGE AND TILE FLOORING. SIMILAR TO SUBJECT. SAME SUBDIVISION AS SUBJECT. ADJUSTMENTS MADE FOR GLA.
- Sold 3** SOLD 3 COMP IS A SINGLE FAMILY RESIDENTIAL WITH STUCCO EXTERIOR, COMPOSITION SHINGLE ROOFING, REFRIGERATED COOLING, DOUBLE ATTACHED GARAGE, CARPET AND TILE FLOORING. SIMILAR TO SUBJECT. ADJUSTMENTS MADE FOR GLA AND GARAGE.

## Subject Sales & Listing History

<b>Current Listing Status</b>	Not Currently Listed		<b>Listing History Comments</b>				
<b>Listing Agency/Firm</b>			NO RECENT LISTING OR SALE HISTORY.				
<b>Listing Agent Name</b>							
<b>Listing Agent Phone</b>							
<b># of Removed Listings in Previous 12 Months</b>	0						
<b># of Sales in Previous 12 Months</b>	0						
<b>Original List Date</b>	<b>Original List Price</b>	<b>Final List Date</b>	<b>Final List Price</b>	<b>Result</b>	<b>Result Date</b>	<b>Result Price</b>	<b>Source</b>

## Marketing Strategy

	<b>As Is Price</b>	<b>Repaired Price</b>
<b>Suggested List Price</b>	\$130,000	\$130,000
<b>Sales Price</b>	\$128,000	\$128,000
<b>30 Day Price</b>	\$126,000	--
<b>Comments Regarding Pricing Strategy</b>		
SELL AS IS CONDITION. SUBJECT APPEARS TO BE IN AVERAGE CONDITION WITH NO REPAIRS NOTICED. COMPS USED ARE FROM THE GREATER EL PASO ASSOCIATION OF REALTORS MLS DATABASE.		

## Clear Capital Quality Assurance Comments Addendum

<b>Reviewer's Notes</b>	The broker's as-is conclusion reflects the market for the subject. Comps are within a reasonable distance, relatively current, and accurately reflect the subject's defining characteristics. Thus, the as-is conclusion appears to be adequately supported.
-------------------------	--

## Subject Photos



Front



Address Verification



Side



Side



Street



Street

## Listing Photos

**L1** 12928 BETO PORTUGAL LANE  
El Paso, TX 79938



Front

**L2** 4704 HILARIO HERNANDEZ DIRVE  
El Paso, TX 79938



Front

**L3** 12757 RAUL MENDIOLA LANE  
El Paso, TX 79938



Front

## Sales Photos

**S1** 12976 ALFREDO APODACA DRIVE  
El Paso, TX 79938



Front

**S2** 12721 FRANCISCO PAZ DRIVE  
El Paso, TX 79938

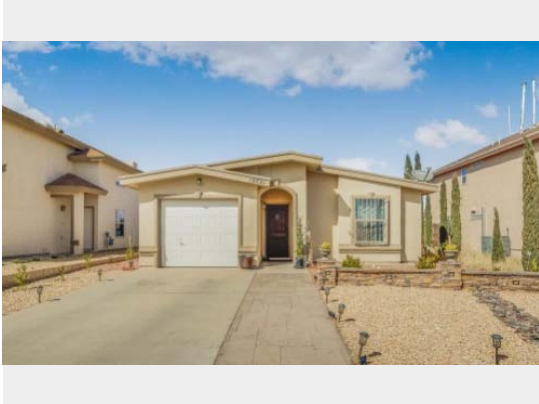

Front

**S3** 14435 MIGUEL TERRAZAS  
El Paso, TX 79938



Front



### ClearMaps Addendum

**Address** ★ 4621 Adan Fuentes Street, El Paso, TX 79938

**Loan Number** 37686

**Suggested List** \$130,000

**Suggested Repaired** \$130,000

**Sale** \$128,000

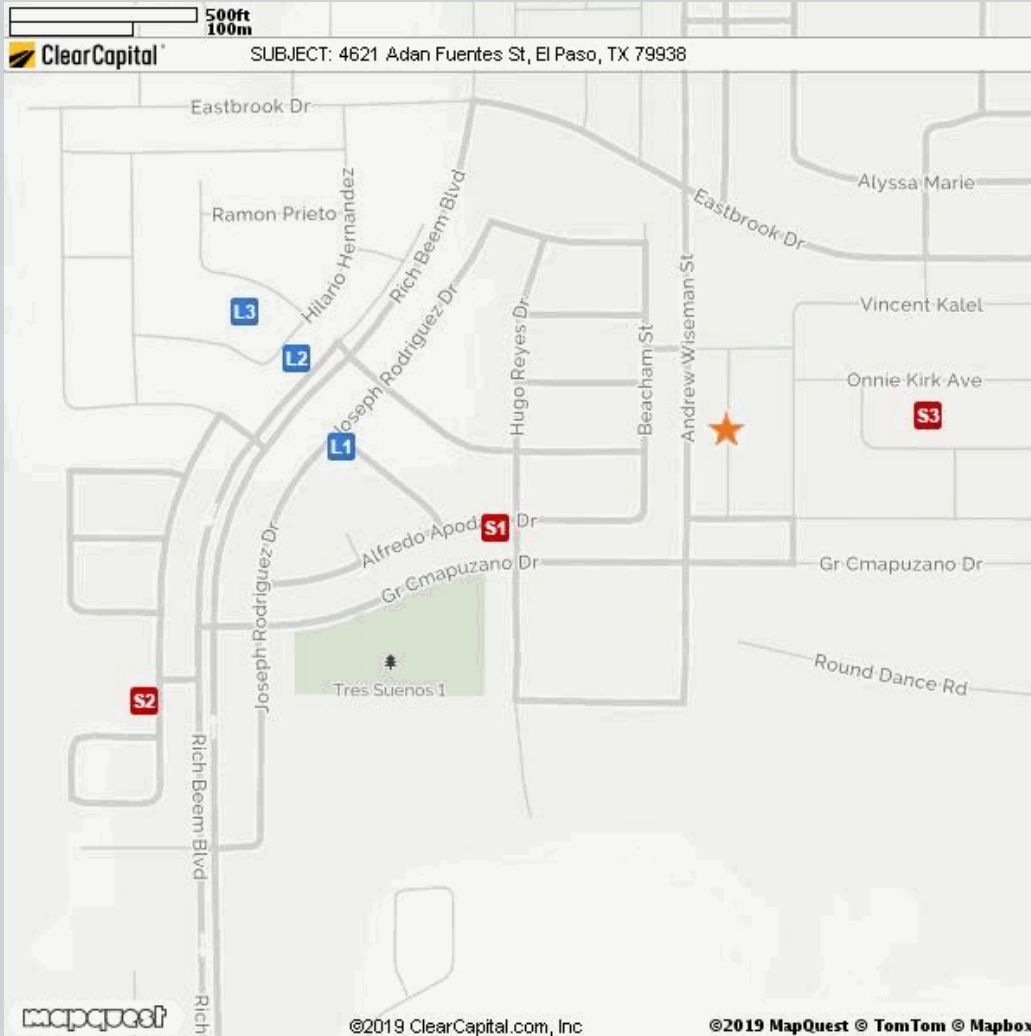

#### Comparable

Comparable	Address	Miles to Subject	Mapping Accuracy
★ Subject	4621 Adan Fuentes St, El Paso, TX	--	Parcel Match
L1 Listing 1	12928 Beto Portugal Lane, El Paso, TX	0.27 Miles <sup>1</sup>	Parcel Match
L2 Listing 2	4704 Hilario Hernandez Dirve, El Paso, TX	0.31 Miles <sup>1</sup>	Parcel Match
L3 Listing 3	12757 Raul Mendiola Lane, El Paso, TX	0.36 Miles <sup>1</sup>	Parcel Match
S1 Sold 1	12976 Alfredo Apodaca Drive, El Paso, TX	0.18 Miles <sup>1</sup>	Parcel Match
S2 Sold 2	12721 Francisco Paz Drive, El Paso, TX	0.46 Miles <sup>1</sup>	Parcel Match
S3 Sold 3	14435 Miguel Terrazas, El Paso, TX	0.15 Miles <sup>1</sup>	Parcel Match

<sup>1</sup> The Comparable "Distance from Subject" value has been calculated by the Clear Capital system.

<sup>2</sup> The Comparable "Distance from Subject" value has been provided by the Real Estate Professional.

## Addendum: Report Purpose

### Market Approach and Market Time

The Market Approach of this report, as established by the customer, is: **Fair Market Price**. (See definition below.)

The Marketing Time as specified by the customer is **Typical**. (See definition below.)

Definitions:

Fair Market Price

A price at which the property would sell between a willing buyer and a willing seller neither being compelled by undue pressure and both having reasonable knowledge of relevant facts.

Distressed Price

A price at which the property would sell between a willing buyer and a seller acting under duress.

Marketing Time

The amount of time the property is exposed to a pool of prospective buyers before going into contract. The customer either specifies the number of days, requests a marketing time that is typical to the subject's market area and/or requests an abbreviated marketing time.

Typical for Local Market

The estimated time required to adequately expose the subject property to the market resulting in a contract of sale.

## Addendum: Report Purpose - cont.

**Report Instructions**

This section shows the instructions that were approved by the customer and provided to the broker prior to completing the report.

\*\*\* Please Note: This is a RUSH assignment. Do not accept if you cannot meet the current due date and time. Please reference the set terms and contact Clear Capital at 530.582.5011 if you require any changes. Thanks! \*\*\*

Instructions last updated: 7/17/2017

Purpose:

Please determine a fair market price for this property at which it would sell in a typical marketing time for the area.

Customer Specific Requests:

\*\*If the property is commercial or mixed use, please stop and contact Clear Capital as soon as possible\*\*

Form Help:

There are blue question marks (?) throughout this form. These are designed to offer guidance for that particular section of the form. Please click on them for help.

Comparable Requirements:

1. Please use fair market comps from the same neighborhood, block or subdivision whenever possible.
2. Please only use REO comparables if the market is driven by REOs and they are comparable in characteristics and condition.
3. Please use comps that have closed in the past 3 months to show the current market conditions or comment in the report if this is not possible. In rapidly changing markets, active listing comps should be given equal or greater weight than sold comps in your analysis.

Standard Instructions:

1. Clear Capital Code Of Conduct - Please make sure that you are always abiding by the Clear Capital Code of Conduct when completing valuation reports.
2. If the subject is currently listed, please consider all available information pertaining to the subject's condition. This information should be utilized when developing the assumption of the subject's condition.
3. Use the subject characteristics provided in the report Grid (if preloaded) to evaluate the property. This information is from a full interior appraisal and is assumed to be most accurate. If your inspection reveals obvious inaccuracies, please explain in the narrative of the report.
4. Include sufficient detail to help our mutual customer gain a complete understanding of the subject's neighborhood such as neighborhood desirability, amenities, parks, schools, commercial or industrial influences, REO activity, traffic, board-up-homes, etc.
5. Do not approach occupants or owners.
6. If the subject is a Commercial property, contact Clear Capital immediately at 530-582-5011 for direction on how to proceed with the report.
7. Please do not accept if you or your office has completed a report on this property in the last month, are currently listing this property, or have any vested interest in the subject property.
8. Clear Capital does not allow any log ins from IP addresses from foreign countries. This includes, but is not limited to; data entry services, form completion services, etc. Also, it is against Clear Capital code of conduct to share your password with anyone who is not a W2 employee in your office.
9. Clear Capital and our mutual customers greatly appreciate your expertise. If you cannot

## Report Instructions - cont.

personally inspect the property, select comparables, and determine a price for the subject, please do not accept this report. Per the standards and guidelines adopted by Clear Capital and other industry leaders, the use of assistants to complete any of the aforementioned tasks is not permitted.

Due to the importance of an independent opinion of price, please do not discuss your price with anyone or be influenced by list price, pending offers, accept comp packets, repair estimates or the listing agent's opinion.

1. One current, original photo of the front of the subject 2. One address verification photo 3. One street scene photo looking down the street 4. MLS listing and sold comp photos required, please comment if no MLS.

## Broker Information

<b>Broker Name</b>	ALEJANDRO GUERRERO	<b>Company/Brokerage</b>	GUERRERO & ASSOCIATES
<b>License No</b>	0386565	<b>Address</b>	DBA GUERRERO & ASSOCIATES EL PASO TX 79935
<b>License Expiration</b>	09/30/2020	<b>License State</b>	TX
<b>Phone</b>	9155924658	<b>Email</b>	bpo@bank4closure.com
<b>Broker Distance to Subject</b>	6.25 miles	<b>Date Signed</b>	06/19/2019

*By confirming the above contact and real estate license information and submitting the report, the above signed hereby certifies and agrees that: 1) I personally took the pictures, selected comparables, and determined the price conclusion. 2) To the best of my knowledge, the statements of fact contained in this report are true and correct. 3) The reported analyses, opinions, and conclusions are my personal, impartial, and unbiased professional analyses, opinions, and conclusions. 4) I have no present or prospective interest in the property that is the subject of this report and no personal interest with respect to the parties involved. 5) I have no bias with respect to the property that is the subject of this report or to the parties involved with this assignment. 6) My compensation for completing this assignment is not contingent upon the development or reporting of a predetermined price point. 7) I did not base, either partially or completely, my analysis and/or opinion and conclusions in this report on race, color, religion, sex, age, marital status, handicap, familial status, or national origin of either the prospective owners or occupants of the subject property or of the present owners or occupants of the properties in the vicinity of the subject property or on any other basis prohibited by law. 8) I maintain errors and omissions insurance, to the extent required by state law, for all liability associated with the preparation of this Report.*

## Disclaimer

**THIS REPORT SHOULD NOT BE CONSIDERED AN APPRAISAL. In making any decision that relies upon my work, you should know that I have not followed the guidelines for development of an appraisal or analysis contained in the Uniform Standards of Professional Appraisal Practice of the Appraisal Foundation.**

**Unless otherwise specifically agreed to in writing:**

**The intended purpose of this report is to assist the Clear Capital account holder in making decisions within the scope of applicable statutory and regulatory requirements and performing required due diligence. This document is provided solely for the use of the Clear Capital account holder and not any other party, is not intended as any guarantee of value and/or condition of the subject property and should not be relied on as such. In the event that this document is found to be defective, incorrect, negligently prepared or unfit for its authorized use, Clear Capital's sole liability shall be to promptly refund the total fee expended by the account holder for this report or to replace it at no charge to the account holder, but in no event shall Clear Capital be responsible to the account holder for any indirect or consequential damages whatsoever. This warranty is in lieu of all other warranties, express or implied, except where otherwise required by law. The account holder shall notify Clear Capital within thirty (30) days of this report's delivery to the account holder if it believes that this document is defective, incorrect, negligently prepared or unfit for its authorized use. Under no circumstances may Clear Capital forms or their contents be published, copied, replicated, or mimicked.**