

Please Note: This report was completed with the following assumptions: Market Approach: **Fair Market Price** , Marketing Time: **Typical** . Important additional information relating to this report, including use and restrictions, is contained in an attached addendum which is an integral part of this report.

<b>Address</b>	4455 Harmony Court, Las Vegas, NV 89121	<b>Order ID</b>	6301881	<b>Property ID</b>	27129982
<b>Inspection Date</b>	08/24/2019	<b>Date of Report</b>	08/24/2019		
<b>Loan Number</b>	38554	<b>APN</b>	162-24-616-004		
<b>Borrower Name</b>	Catamount Properties 2018 LLC	<b>County</b>	Clark		

<b>Tracking IDs</b>					
<b>Order Tracking ID</b>	CITL_BPO_08.23.19	<b>Tracking ID 1</b>	CITL_BPO_08.23.19		
<b>Tracking ID 2</b>	--	<b>Tracking ID 3</b>	--		

## General Conditions

<b>Owner</b>	Catamount Properties	<b>Condition Comments</b>	
<b>R. E. Taxes</b>	\$1,593	<p>No damage or repair issues noted from exterior visual inspection. Doors, windows, roof, paint, landscaping appear to be in average condition for age and neighborhood. Clark County Tax Assessor data shows Cost Class for this property as Average. Subject property is a single story single family detached home with 2 car attached garage. Roof is pitched concrete tile. It has 1 fireplace but no pool or spa. Last sold 08/09/2019 for \$272,000, as cash sale, fair market transaction. There are no MLS records for this property since purchased. Subject property is located in the central southeastern area of Las Vegas in the Harmony Heights subdivision. This tract is comprised of 8 single family detached homes which vary in living area from 1,912-2,903 square feet. Access to schools, shopping is within 1 mile and freeway entry is within 3 miles. Most likely buyer is first time home buyer with FHA/VA financing.</p>	
<b>Assessed Value</b>	\$78,336		
<b>Zoning Classification</b>	R-1		
<b>Property Type</b>	SFR		
<b>Occupancy</b>	Vacant		
<b>Secure?</b>	Yes		
(Secured by deadbolt. )			
<b>Ownership Type</b>	Fee Simple		
<b>Property Condition</b>	Average		
<b>Estimated Exterior Repair Cost</b>			
<b>Estimated Interior Repair Cost</b>			
<b>Total Estimated Repair</b>			
<b>HOA</b>	No		
<b>Visible From Street</b>	Visible		
<b>Road Type</b>	Public		

## Neighborhood & Market Data

<b>Location Type</b>	Suburban	<b>Neighborhood Comments</b>	
<b>Local Economy</b>	Improving	<p>There is an oversupply of competing listings within a 1/2 mile radius of subject property. There are 14 homes listed for sale (0 REO, 0 short sale). In the past 12 months, there have been 35 closed competing sales in this area. This indicates an oversupply of listings, assuming 90 days on market. Average days on market time was 40 with range 4-130 days and average sale price was 98% of final list price. Homes considered to be comparable are single family detached homes with living area 2,000-3,500 square feet within a 1/2 mile radius. Strong presence of investor/rehab properties in this area.</p>	
<b>Sales Prices in this Neighborhood</b>	Low: \$236,000 High: \$465,000		
<b>Market for this type of property</b>	Increased 5 % in the past 6 months.		
<b>Normal Marketing Days</b>	<90		

## Current Listings

	Subject	Listing 1	Listing 2 *	Listing 3
Street Address	4455 Harmony Court	3088 Cadbury Dr	4588 Paseo Del Ray Dr	4428 Coventry Cir
City, State	Las Vegas, NV	Las Vegas, NV	Las Vegas, NV	Las Vegas, NV
Zip Code	89121	89121	89121	89121
Datasource	Tax Records	MLS	MLS	MLS
Miles to Subj.	--	0.20 <sup>1</sup>	0.46 <sup>1</sup>	0.05 <sup>1</sup>
Property Type	SFR	SFR	SFR	SFR
Original List Price \$	\$	\$299,000	\$300,000	\$399,400
List Price \$	--	\$295,000	\$300,000	\$399,400
Original List Date		06/27/2019	05/24/2019	04/26/2019
DOM · Cumulative DOM	-- · --	11 · 58	92 · 92	11 · 120
Age (# of years)	40	43	41	40
Condition	Average	Average	Average	Average
Sales Type	--	Fair Market Value	Fair Market Value	Fair Market Value
Location	Neutral ; Residential	Neutral ; Residential	Neutral ; Residential	Neutral ; Residential
View	Neutral ; Residential	Neutral ; Residential	Neutral ; Residential	Neutral ; Residential
Style/Design	1 Story Ranch	1 Story Ranch	1 Story Ranch	1 Story Ranch
# Units	1	1	1	1
Living Sq. Feet	2,695	2,044	2,020	3,379
Bdrm · Bths · ½ Bths	4 · 2 · 1	3 · 2	3 · 2 · 1	4 · 3 · 1
Total Room #	9	6	6	9
Garage (Style/Stalls)	Attached 2 Car(s)	Attached 2 Car(s)	Attached 2 Car(s)	Attached 2 Car(s)
Basement (Yes/No)	No	No	No	No
Basement (% Fin)	0%	0%	0%	0%
Basement Sq. Ft.	--	--	--	--
Pool/Spa	--	--	--	--
Lot Size	0.23 acres	0.17 acres	0.19 acres	0.30 acres
Other	1 Fireplace	1 Fireplace	1 Fireplace	2 Fireplaces

\* Listing 2 is the most comparable listing to the subject.

<sup>1</sup> Comp's "Miles to Subject" was calculated by the system.

<sup>2</sup> Comp's "Miles to Subject" provided by Real Estate Professional.

<sup>3</sup> Subject \$/ft based upon as-is sale price.

**Listing Comments** Why the comparable listing is superior or inferior to the subject.

**Listing 1** Not under contract. Owner occupied property. Identical to subject property in baths, condition, garage capacity and nearly identical in age. It is inferior in square footage, lot size. This property is inferior to subject property.

**Listing 2** Not under contract. Owner occupied property. Identical to subject property in baths, condition, garage capacity and nearly identical in age. It is inferior in square footage, lot size. This property is inferior to subject property.

**Listing 3** Vacant property. Identical to subject property in condition, garage capacity and nearly identical in age. It is superior in square footage, baths, lot size, fireplaces. This property is superior to subject property.

### Recent Sales

	Subject	Sold 1	Sold 2 *	Sold 3
<b>Street Address</b>	4455 Harmony Court	3122 Desmond Ave	3123 Cardinal Ln	4440 Newell Dr
<b>City, State</b>	Las Vegas, NV	Las Vegas, NV	Las Vegas, NV	Las Vegas, NV
<b>Zip Code</b>	89121	89121	89121	89121
<b>Datasource</b>	Tax Records	MLS	Public Records	MLS
<b>Miles to Subj.</b>	--	0.28 <sup>1</sup>	0.10 <sup>1</sup>	0.16 <sup>1</sup>
<b>Property Type</b>	SFR	SFR	SFR	SFR
<b>Original List Price \$</b>	--	\$305,000	\$339,000	\$495,000
<b>List Price \$</b>	--	\$289,900	\$329,000	\$485,000
<b>Sale Price \$</b>	--	\$284,000	\$327,000	\$465,000
<b>Type of Financing</b>	--	Fha	Va	Contract For Sale
<b>Date of Sale</b>	--	04/08/2019	07/26/2019	02/28/2019
<b>DOM · Cumulative DOM</b>	-- · --	8 · 116	11 · 52	34 · 51
<b>Age (# of years)</b>	40	44	42	27
<b>Condition</b>	Average	Average	Good	Good
<b>Sales Type</b>	--	Fair Market Value	Fair Market Value	Fair Market Value
<b>Location</b>	Neutral ; Residential	Neutral ; Residential	Neutral ; Residential	Neutral ; Residential
<b>View</b>	Neutral ; Residential	Neutral ; Residential	Neutral ; Residential	Neutral ; Residential
<b>Style/Design</b>	1 Story Ranch	1 Story Ranch	1 Story Ranch	1 Story Ranch
<b># Units</b>	1	1	1	1
<b>Living Sq. Feet</b>	2,695	2,020	2,372	3,385
<b>Bdrm · Bths · ½ Bths</b>	4 · 2 · 1	3 · 2 · 1	3 · 2 · 1	3 · 2 · 1
<b>Total Room #</b>	9	7	8	9
<b>Garage (Style/Stalls)</b>	Attached 2 Car(s)	Attached 2 Car(s)	Attached 2 Car(s)	Attached 2 Car(s)
<b>Basement (Yes/No)</b>	No	No	No	No
<b>Basement (% Fin)</b>	0%	0%	0%	0%
<b>Basement Sq. Ft.</b>	--	--	--	--
<b>Pool/Spa</b>	--	--	Pool - Yes	--
<b>Lot Size</b>	0.23 acres	0.17 acres	0.16 acres	0.39 acres
<b>Other</b>	1 Fireplace	1 Fireplace	1 Fireplace	2 Fireplaces
<b>Net Adjustment</b>	--	+\$53,600	-\$2,400	-\$105,200
<b>Adjusted Price</b>	--	\$337,600	\$324,600	\$359,800

\* Sold 2 is the most comparable sale to the subject.

<sup>1</sup> Comp's "Miles to Subject" was calculated by the system.

<sup>2</sup> Comp's "Miles to Subject" provided by Real Estate Professional.

<sup>3</sup> Subject \$/ft based upon as-is sale price.

## Recent Sales - Cont.

**Reasons for Adjustments** Why the comparable sale is superior or inferior to the subject.

- Sold 1** FHA sale, no concessions. Identical to subject property in baths, condition, garage capacity, fireplace and nearly identical in age. It is inferior in square footage adjusted @ \$60/square foot \$40,500, and lot size adjusted @ \$5/square foot \$13,100.
- Sold 2** Sold with VA financing, no concessions. Identical to subject property in baths, garage capacity, and nearly identical in age. It is inferior in square footage adjusted @ \$60/square foot \$19,400, lot size adjusted @ \$5/square foot \$15,200, but superior in pool (\$22,000). and condition with granite counters, updated cabinets, stainless appliances (\$15,000).
- Sold 3** Sold with contract for sale. Identical in baths, garage capacity, no pool or spa. It is superior in square footage adjusted @ \$60/square foot (\$41,400), lot size adjusted @ \$5/square foot (\$34,800), age adjusted @ \$1,000/year (\$13,000), fireplaces (\$1,000) and condition with updated kitchen, marble flooring (\$15,000). Less weight is given to this comp due to undetermined value for seller paid financing.

## Subject Sales & Listing History

<b>Current Listing Status</b>	Not Currently Listed			<b>Listing History Comments</b>			
<b>Listing Agency/Firm</b>				Listed for sale 04/01/2019 for \$330,000, 3 previous escrows fell out. Back on market 07/31/2019 and under contract in 4 days. Cash sale, no concessions.			
<b>Listing Agent Name</b>							
<b>Listing Agent Phone</b>							
<b># of Removed Listings in Previous 12 Months</b>	0						
<b># of Sales in Previous 12 Months</b>	1						
<b>Original List Date</b>	<b>Original List Price</b>	<b>Final List Date</b>	<b>Final List Price</b>	<b>Result</b>	<b>Result Date</b>	<b>Result Price</b>	<b>Source</b>
04/02/2019	\$330,000	06/15/2019	\$282,000	Sold	08/09/2019	\$272,000	MLS

## Marketing Strategy

	<b>As Is Price</b>	<b>Repaired Price</b>
<b>Suggested List Price</b>	\$335,000	\$335,000
<b>Sales Price</b>	\$330,000	\$330,000
<b>30 Day Price</b>	\$320,000	--
<b>Comments Regarding Pricing Strategy</b>		
Suggest pricing near low range of competing listings due to oversupply of directly competing listings. Subject property is most like Sale #2, which sold for adjusted sales price of \$324,600. It was under contract in 11 days from price adjustment. Subject property would be expected to sell slightly above this price point with 90 days on market.		

## Clear Capital Quality Assurance Comments Addendum

**Reviewer's** The broker's as-is conclusion reflects the market for the subject. Comps are within a reasonable distance, relatively current, and accurately reflect  
**Notes** the subject's defining characteristics. Thus, the as-is conclusion appears to be adequately supported.

## Subject Photos



Front



Address Verification



Side



Street

## Listing Photos

**L1** 3088 Cadbury Dr  
Las Vegas, NV 89121



Front

**L2** 4588 Paseo Del Ray Dr  
Las Vegas, NV 89121



Front

**L3** 4428 Coventry Cir  
Las Vegas, NV 89121



Front



## Sales Photos

**S1** 3122 Desmond Ave  
Las Vegas, NV 89121



Front

**S2** 3123 Cardinal Ln  
Las Vegas, NV 89121



Front

**S3** 4440 Newell Dr  
Las Vegas, NV 89121



Front

### ClearMaps Addendum

**Address** ★ 4455 Harmony Court, Las Vegas, NV 89121

**Loan Number** 38554

**Suggested List** \$335,000

**Suggested Repaired** \$335,000

**Sale** \$330,000

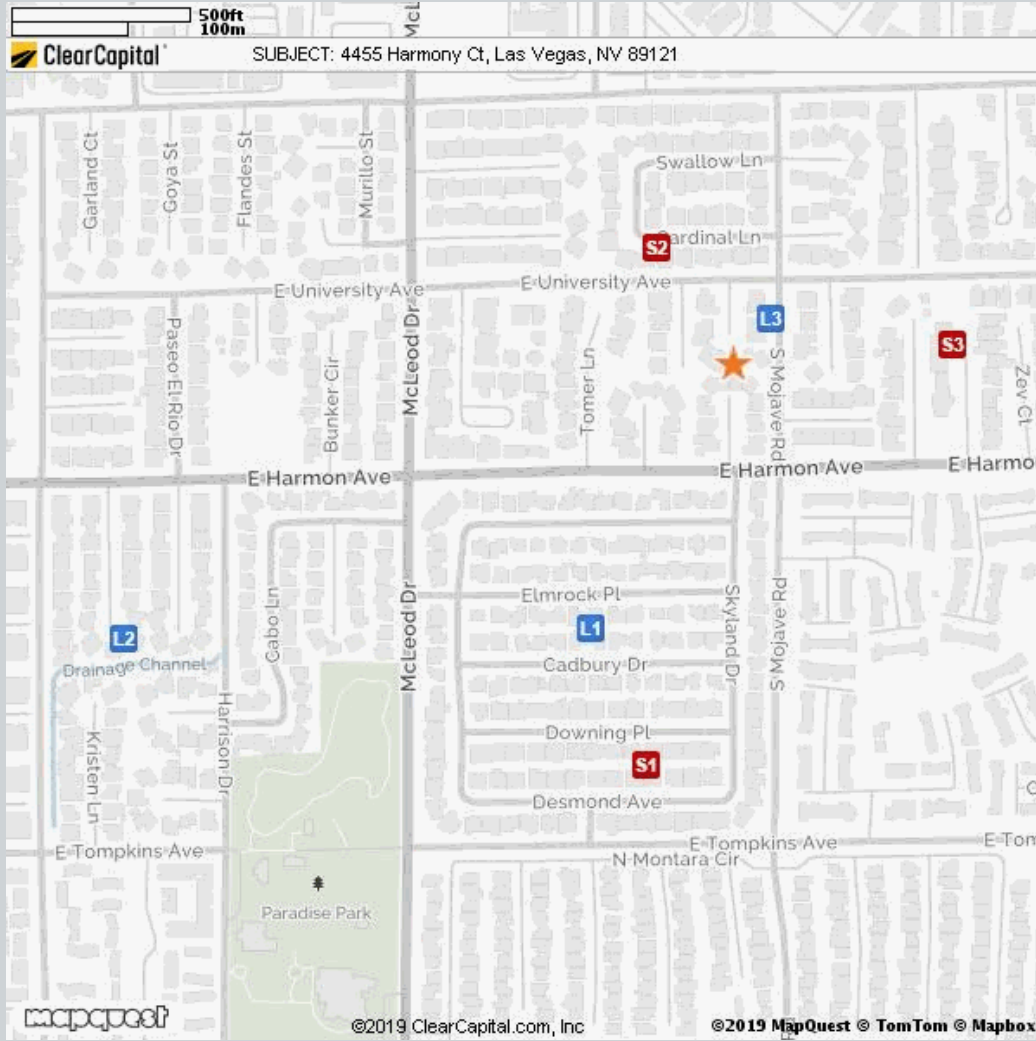

Comparable	Address	Miles to Subject	Mapping Accuracy
★ Subject	4455 Harmony Ct, Las Vegas, NV	--	Parcel Match
L1 Listing 1	3088 Cadbury Dr, Las Vegas, NV	0.20 Miles <sup>1</sup>	Parcel Match
L2 Listing 2	4588 Paseo Del Ray Dr, Las Vegas, NV	0.46 Miles <sup>1</sup>	Parcel Match
L3 Listing 3	4428 Coventry Cir, Las Vegas, NV	0.05 Miles <sup>1</sup>	Parcel Match
S1 Sold 1	3122 Desmond Ave, Las Vegas, NV	0.28 Miles <sup>1</sup>	Parcel Match
S2 Sold 2	3123 Cardinal Ln, Las Vegas, NV	0.10 Miles <sup>1</sup>	Parcel Match
S3 Sold 3	4440 Newell Dr, Las Vegas, NV	0.16 Miles <sup>1</sup>	Parcel Match

<sup>1</sup> The Comparable "Distance from Subject" value has been calculated by the Clear Capital system.

<sup>2</sup> The Comparable "Distance from Subject" value has been provided by the Real Estate Professional.

## Addendum: Report Purpose

### Market Approach and Market Time

The Market Approach of this report, as established by the customer, is: **Fair Market Price**. (See definition below.)

The Marketing Time as specified by the customer is **Typical**. (See definition below.)

Definitions:

Fair Market Price

A price at which the property would sell between a willing buyer and a willing seller neither being compelled by undue pressure and both having reasonable knowledge of relevant facts.

Distressed Price

A price at which the property would sell between a willing buyer and a seller acting under duress.

Marketing Time

The amount of time the property is exposed to a pool of prospective buyers before going into contract. The customer either specifies the number of days, requests a marketing time that is typical to the subject's market area and/or requests an abbreviated marketing time.

Typical for Local Market

The estimated time required to adequately expose the subject property to the market resulting in a contract of sale.

## Addendum: Report Purpose - cont.

**Report Instructions**

This section shows the instructions that were approved by the customer and provided to the broker prior to completing the report.

Instructions last updated: 7/17/2017

Purpose:

Please determine a fair market price for this property at which it would sell in a typical marketing time for the area.

Customer Specific Requests:

\*\*If the property is commercial or mixed use, please stop and contact Clear Capital as soon as possible\*\*

Form Help:

There are blue question marks (?) throughout this form. These are designed to offer guidance for that particular section of the form. Please click on them for help.

Comparable Requirements:

1. Please use fair market comps from the same neighborhood, block or subdivision whenever possible.
2. Please only use REO comparables if the market is driven by REOs and they are comparable in characteristics and condition.
3. Please use comps that have closed in the past 3 months to show the current market conditions or comment in the report if this is not possible. In rapidly changing markets, active listing comps should be given equal or greater weight than sold comps in your analysis.

Standard Instructions:

1. Clear Capital Code Of Conduct - Please make sure that you are always abiding by the Clear Capital Code of Conduct when completing valuation reports.
2. If the subject is currently listed, please consider all available information pertaining to the subject's condition. This information should be utilized when developing the assumption of the subject's condition.
3. Use the subject characteristics provided in the report Grid (if preloaded) to evaluate the property. This information is from a full interior appraisal and is assumed to be most accurate. If your inspection reveals obvious inaccuracies, please explain in the narrative of the report.
4. Include sufficient detail to help our mutual customer gain a complete understanding of the subject's neighborhood such as neighborhood desirability, amenities, parks, schools, commercial or industrial influences, REO activity, traffic, board-up-homes, etc.
5. Do not approach occupants or owners.
6. If the subject is a Commercial property, contact Clear Capital immediately at 530-582-5011 for direction on how to proceed with the report.
7. Please do not accept if you or your office has completed a report on this property in the last month, are currently listing this property, or have any vested interest in the subject property.
8. Clear Capital does not allow any log ins from IP addresses from foreign countries. This includes, but is not limited to; data entry services, form completion services, etc. Also, it is against Clear Capital code of conduct to share your password with anyone who is not a W2 employee in your office.
9. Clear Capital and our mutual customers greatly appreciate your expertise. If you cannot personally inspect the property, select comparables, and determine a price for the subject, please do not accept this report. Per the standards and guidelines adopted by Clear Capital and other industry leaders, the use of assistants to complete any of the aforementioned tasks is not permitted.

## Report Instructions - cont.

Due to the importance of an independent opinion of price, please do not discuss your price with anyone or be influenced by list price, pending offers, accept comp packets, repair estimates or the listing agent's opinion.

1. One current, original photo of the front of the subject 2. One address verification photo 3. One street scene photo looking down the street 4. MLS listing and sold comp photos required, please comment if no MLS.

## Broker Information

<b>Broker Name</b>	Linda Bothof	<b>Company/Brokerage</b>	Linda Bothof Broker
<b>License No</b>	B.0056344.INDV	<b>Address</b>	8760 S Maryland Parkway Las Vegas NV 89123
<b>License Expiration</b>	05/31/2020	<b>License State</b>	NV
<b>Phone</b>	7025248161	<b>Email</b>	lbothof7@gmail.com
<b>Broker Distance to Subject</b>	5.55 miles	<b>Date Signed</b>	08/24/2019

/Linda Bothof/

*By confirming the above contact and real estate license information and submitting the report, the above signed hereby certifies and agrees that: 1) I personally took the pictures, selected comparables, and determined the price conclusion. 2) To the best of my knowledge, the statements of fact contained in this report are true and correct. 3) The reported analyses, opinions, and conclusions are my personal, impartial, and unbiased professional analyses, opinions, and conclusions. 4) I have no present or prospective interest in the property that is the subject of this report and no personal interest with respect to the parties involved. 5) I have no bias with respect to the property that is the subject of this report or to the parties involved with this assignment. 6) My compensation for completing this assignment is not contingent upon the development or reporting of a predetermined price point. 7) I did not base, either partially or completely, my analysis and/or opinion and conclusions in this report on race, color, religion, sex, age, marital status, handicap, familial status, or national origin of either the prospective owners or occupants of the subject property or of the present owners or occupants of the properties in the vicinity of the subject property or on any other basis prohibited by law. 8) I maintain errors and omissions insurance, to the extent required by state law, for all liability associated with the preparation of this Report.*

## Addendum: NV Broker's Price Opinion Qualification

The attached Broker's Price Opinion ("BPO") has been prepared by: **Linda Bothof** ("Licensee"), **B.0056344.INDV** (License #) who is an active licensee in good standing.

Licensee is affiliated with **Linda Bothof Broker** (Company).

This Addendum is an integral part of the BPO prepared by Licensee and the BPO is considered incomplete without it.

1. This BPO has been prepared for **Wedgewood Inc** (Beneficiary or agent of Beneficiary hereinafter "Beneficiary") regarding the real property commonly known and described as: **4455 Harmony Court, Las Vegas, NV 89121**
2. Licensee is informed that the Beneficiary's interest in the real property is that of a third party making decisions or performing due diligence for an existing or potential lien holder.
3. The intended purpose of this BPO is to assist the Beneficiary in making decisions within the scope of applicable statutory and regulatory requirements and performing required due diligence.
4. Licensee certifies that Licensee has no existing or contemplated interest in the property, including without limitation the possibility of Licensee representing the seller or any purchaser.

Issue date: **August 24, 2019**

Licensee signature: **/Linda Bothof/**

**NOTWITHSTANDING ANY PREPRINTED LANGUAGE TO THE CONTRARY, THIS OPINION IS NOT AN APPRAISAL OF THE MARKET VALUE OF THE PROPERTY. IF AN APPRAISAL IS DESIRED, THE SERVICES OF A LICENSED OR CERTIFIED APPRAISER MUST BE OBTAINED.**

## Disclaimer

**Notwithstanding any preprinted language to the contrary, this opinion is not an appraisal of the market value of the property. If an appraisal is desired, the services of a licensed or certified appraiser must be obtained.**

Unless otherwise specifically agreed to in writing:

The intended purpose of this report is to assist the Clear Capital account holder in making decisions within the scope of applicable statutory and regulatory requirements and performing required due diligence. This document is provided solely for the use of the Clear Capital account holder and not any other party, is not intended as any guarantee of value and/or condition of the subject property and should not be relied on as such. In the event that this document is found to be defective, incorrect, negligently prepared or unfit for its authorized use, Clear Capital's sole liability shall be to promptly refund the total fee expended by the account holder for this report or to replace it at no charge to the account holder, but in no event shall Clear Capital be responsible to the account holder for any indirect or consequential damages whatsoever. This warranty is in lieu of all other warranties, express or implied, except where otherwise required by law. The account holder shall notify Clear Capital within thirty (30) days of this report's delivery to the account holder if it believes that this document is defective, incorrect, negligently prepared or unfit for its authorized use. Under no circumstances may Clear Capital forms or their contents be published, copied, replicated, or mimicked.