

Please Note: This report was completed with the following assumptions: Market Approach: **Fair Market Price** , Marketing Time: **Typical** . Important additional information relating to this report, including use and restrictions, is contained in an attached addendum which is an integral part of this report.

Address	515 Lincoln Avenue, Bakersfield, CA 93308	Order ID	6490140	Property ID	27792665
Inspection Date	01/14/2020	Date of Report	01/16/2020		
Loan Number	39595	APN	11309405		
Borrower Name	Catamount Properties 2018 LLC	County	Kern		

Tracking IDs

Order Tracking ID	20200114_Citi_BPO	Tracking ID 1	20200114_Citi_BPO
Tracking ID 2	--	Tracking ID 3	--

General Conditions

Owner	catamount properties	Condition Comments	
R. E. Taxes	\$1,167	The subject appears vacant and it appears to be in average condition, with no major damage. The agent does not recommend repairs at this time.	
Assessed Value	\$65,000		
Zoning Classification	r3		
Property Type	SFR		
Occupancy	Vacant		
Secure?	Yes (appears secured)		
Ownership Type	Fee Simple		
Property Condition	Average		
Estimated Exterior Repair Cost	\$0		
Estimated Interior Repair Cost	\$0		
Total Estimated Repair	\$0		
HOA	No		
Visible From Street	Visible		
Road Type	Public		

Neighborhood & Market Data

Location Type	Suburban	Neighborhood Comments	
Local Economy	Stable	The neighborhood is established and most of the homes in the area are of similar age and style. Most of the homes in the area are maintained in fair to average condition. The market is presently stable and homes are selling fairly quickly. There are some REOs and Short sales, but those have not affected values in this market.	
Sales Prices in this Neighborhood	Low: \$72,500 High: \$199,950		
Market for this type of property	Remained Stable for the past 6 months.		
Normal Marketing Days	<90		

Current Listings

	Subject	Listing 1	Listing 2 *	Listing 3
Street Address	515 Lincoln Avenue	604 El Tejon Ave	212 Belle Ave	319 Minner Ave
City, State	Bakersfield, CA	Bakersfield, CA	Bakersfield, CA	Bakersfield, CA
Zip Code	93308	93308	93308	93308
Datasource	Tax Records	MLS	MLS	MLS
Miles to Subj.	--	0.29 ¹	0.46 ¹	0.37 ¹
Property Type	SFR	SFR	SFR	SFR
Original List Price \$	\$	\$115,000	\$119,900	\$125,500
List Price \$	--	\$114,000	\$114,900	\$125,500
Original List Date		12/16/2019	11/26/2019	01/13/2020
DOM · Cumulative DOM	-- · --	29 · 31	49 · 51	2 · 3
Age (# of years)	63	81	64	79
Condition	Average	Average	Average	Average
Sales Type	--	Fair Market Value	Fair Market Value	Fair Market Value
Location	Neutral ; Residential	Neutral ; Residential	Neutral ; Residential	Neutral ; Residential
View	Neutral ; Residential	Neutral ; Residential	Neutral ; Residential	Neutral ; Residential
Style/Design	1 Story ranch	1 Story ranch	1 Story ranch	1 Story ranch
# Units	1	1	1	1
Living Sq. Feet	852	780	988	752
Bdrm · Bths · ½ Bths	2 · 1	2 · 1	3 · 1	2 · 1
Total Room #	4	4	5	4
Garage (Style/Stalls)	Attached 1 Car	None	Attached 1 Car	Detached 1 Car
Basement (Yes/No)	No	No	No	No
Basement (% Fin)	0%	0%	0%	0%
Basement Sq. Ft.	--	--	--	--
Pool/Spa	--	--	--	--
Lot Size	0.16 acres	0.07 acres	0.15 acres	0.12 acres
Other	n, a	n, a	n, a	n, a

* Listing 2 is the most comparable listing to the subject.

¹ Comp's "Miles to Subject" was calculated by the system.

² Comp's "Miles to Subject" provided by Real Estate Professional.

³ Subject \$/ft based upon as-is sale price.

Listing Comments Why the comparable listing is superior or inferior to the subject.

Listing 1 similar sq footage, similar condition, older in age, same bedrooms, same baths, no garage, similar lot size

Listing 2 slightly larger sq footage, similar condition, similar age, additional bedroom, same baths, similar parking, similar lot size

Listing 3 slightly smaller sq footage, similar condition, slightly older in age, same bedrooms, same baths, similar parking, similar lot size

Recent Sales

	Subject	Sold 1	Sold 2 *	Sold 3
Street Address	515 Lincoln Avenue	319 Woodrow Ave	622 Wilson Ave	710 Wilson Ave
City, State	Bakersfield, CA	Bakersfield, CA	Bakersfield, CA	Bakersfield, CA
Zip Code	93308	93308	93308	93308
Datasource	Tax Records	MLS	MLS	MLS
Miles to Subj.	--	0.28 ¹	0.27 ¹	0.33 ¹
Property Type	SFR	SFR	SFR	SFR
Original List Price \$	--	\$109,999	\$128,000	\$134,500
List Price \$	--	\$109,999	\$128,000	\$134,500
Sale Price \$	--	\$109,999	\$115,000	\$135,000
Type of Financing	--	Conv	Cah	Conv
Date of Sale	--	10/30/2019	10/30/2019	09/26/2019
DOM · Cumulative DOM	-- · --	65 · 65	120 · 120	29 · 29
Age (# of years)	63	74	80	74
Condition	Average	Average	Average	Average
Sales Type	--	Fair Market Value	Fair Market Value	Fair Market Value
Location	Neutral ; Residential	Neutral ; Residential	Neutral ; Residential	Neutral ; Residential
View	Neutral ; Residential	Neutral ; Residential	Neutral ; Residential	Neutral ; Residential
Style/Design	1 Story ranch	1 Story ranch	1 Story ranch	1 Story ranch
# Units	1	1	1	1
Living Sq. Feet	852	816	1,115	898
Bdrm · Bths · ½ Bths	2 · 1	2 · 1	3 · 1	3 · 1
Total Room #	4	4	5	5
Garage (Style/Stalls)	Attached 1 Car	Detached 1 Car	Detached 1 Car	Detached 2 Car(s)
Basement (Yes/No)	No	No	No	No
Basement (% Fin)	0%	0%	0%	0%
Basement Sq. Ft.	--	--	--	--
Pool/Spa	--	--	--	--
Lot Size	0.16 acres	0.12 acres	0.14 acres	0.16 acres
Other	n, a	n, a	n, a	n, a
Net Adjustment	--	-\$4,499	-\$2,750	-\$2,000
Adjusted Price	--	\$105,500	\$112,250	\$133,000

* Sold 2 is the most comparable sale to the subject.

¹ Comp's "Miles to Subject" was calculated by the system.

² Comp's "Miles to Subject" provided by Real Estate Professional.

³ Subject \$/ft based upon as-is sale price.

Recent Sales - Cont.

Reasons for Adjustments Why the comparable sale is superior or inferior to the subject.

- Sold 1** similar sq footage, similar condition, slightly older in age, same bedrooms, same baths, similar parking, similar lot size, concessions
- Sold 2** larger sq footage, similar condition, older in age, additional bedroom, same baths, similar parking, similar lot size, no concessions
- Sold 3** similar sq footage, similar condition, slightly older in age, additional bedroom, same baths, superior parking, similar lot size, no concessions

Subject Sales & Listing History

Current Listing Status	Not Currently Listed			Listing History Comments			
Listing Agency/Firm				none			
Listing Agent Name							
Listing Agent Phone							
# of Removed Listings in Previous 12 Months	0						
# of Sales in Previous 12 Months	0						
Original List Date	Original List Price	Final List Date	Final List Price	Result	Result Date	Result Price	Source

Marketing Strategy

	As Is Price	Repaired Price
Suggested List Price	\$106,500	\$106,500
Sales Price	\$106,000	\$106,000
30 Day Price	\$102,500	--
Comments Regarding Pricing Strategy		
<p>The agent searched an area of approximately 1 mile surrounding the subject, and the agent had to consider all comparables, including short sales and REOs. The values of those are similar to fair market comps, thus all comps are best suited for the report. The agent took into consideration all 6 comparables that were used. The agent valued the subject in comparison to all of the comparables, as a whole. All the comparables were similar to the subject in some way. The comps provided in inferior condition than the subject. comps used are more similar in style, condition, and overall appeal</p>		

Clear Capital Quality Assurance Comments Addendum

Reviewer's Notes The broker's as-is conclusion reflects the market for the subject. Comps are within a reasonable distance, relatively current, and accurately reflect the subject's defining characteristics. Thus, the as-is conclusion appears to be adequately supported.

Subject Photos



Front



Address Verification



Side



Side



Street



Street

Subject Photos



Other



Other

Listing Photos

L1 604 El Tejon Ave
Bakersfield, CA 93308



Front

L2 212 Belle Ave
Bakersfield, CA 93308



Front

L3 319 minner ave
Bakersfield, CA 93308



Front

Sales Photos

S1 319 Woodrow Ave
Bakersfield, CA 93308



Front

S2 622 Wilson Ave
Bakersfield, CA 93308



Front

S3 710 Wilson Ave
Bakersfield, CA 93308



Front

ClearMaps Addendum

Address ★ 515 Lincoln Avenue, Bakersfield, CA 93308

Loan Number 39595

Suggested List \$106,500

Suggested Repaired \$106,500

Sale \$106,000

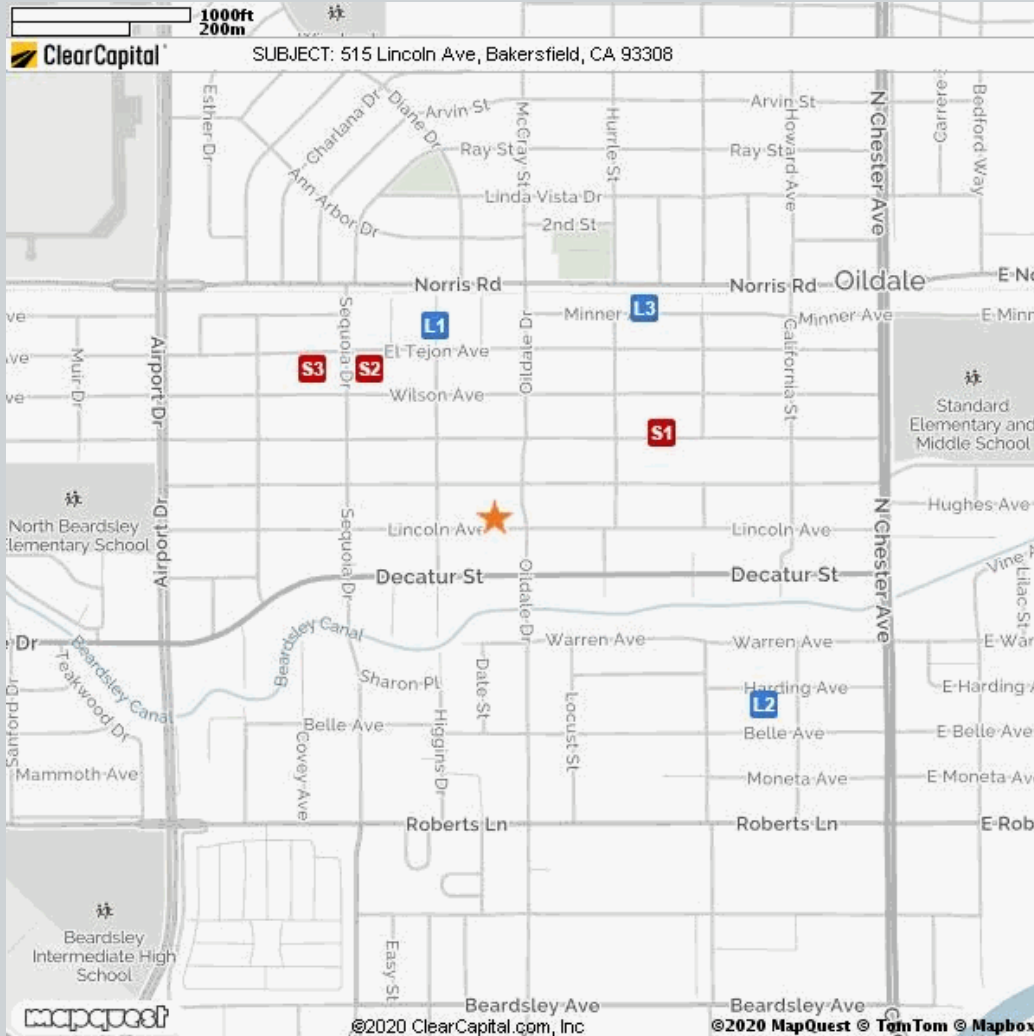

Comparable	Address	Miles to Subject	Mapping Accuracy
★ Subject	515 Lincoln Ave, Bakersfield, CA	--	Parcel Match
L1 Listing 1	604 El Tejon Ave, Bakersfield, CA	0.29 Miles ¹	Parcel Match
L2 Listing 2	212 Belle Ave, Bakersfield, CA	0.46 Miles ¹	Parcel Match
L3 Listing 3	319 Minner Ave, Bakersfield, CA	0.37 Miles ¹	Parcel Match
S1 Sold 1	319 Woodrow Ave, Bakersfield, CA	0.28 Miles ¹	Parcel Match
S2 Sold 2	622 Wilson Ave, Bakersfield, CA	0.27 Miles ¹	Parcel Match
S3 Sold 3	710 Wilson Ave, Bakersfield, CA	0.33 Miles ¹	Parcel Match

¹ The Comparable "Distance from Subject" value has been calculated by the Clear Capital system.

² The Comparable "Distance from Subject" value has been provided by the Real Estate Professional.

Addendum: Report Purpose

Market Approach and Market Time

The Market Approach of this report, as established by the customer, is: **Fair Market Price**. (See definition below.)

The Marketing Time as specified by the customer is **Typical**. (See definition below.)

Definitions:

Fair Market Price

A price at which the property would sell between a willing buyer and a willing seller neither being compelled by undue pressure and both having reasonable knowledge of relevant facts.

Distressed Price

A price at which the property would sell between a willing buyer and a seller acting under duress.

Marketing Time

The amount of time the property is exposed to a pool of prospective buyers before going into contract. The customer either specifies the number of days, requests a marketing time that is typical to the subject's market area and/or requests an abbreviated marketing time.

Typical for Local Market

The estimated time required to adequately expose the subject property to the market resulting in a contract of sale.

Addendum: Report Purpose - cont.

Report Instructions

This section shows the instructions that were approved by the customer and provided to the broker prior to completing the report.

*** Please Note: This is a RUSH assignment. Do not accept if you cannot meet the current due date and time. Please reference the set terms and contact Clear Capital at 530.582.5011 if you require any changes. Thanks! ***

Instructions last updated: 7/17/2017

Purpose:

Please determine a fair market price for this property at which it would sell in a typical marketing time for the area.

Customer Specific Requests:

If the property is commercial or mixed use, please stop and contact Clear Capital as soon as possible

Form Help:

There are blue question marks (?) throughout this form. These are designed to offer guidance for that particular section of the form. Please click on them for help.

Comparable Requirements:

1. Please use fair market comps from the same neighborhood, block or subdivision whenever possible.
2. Please only use REO comparables if the market is driven by REOs and they are comparable in characteristics and condition.
3. Please use comps that have closed in the past 3 months to show the current market conditions or comment in the report if this is not possible. In rapidly changing markets, active listing comps should be given equal or greater weight than sold comps in your analysis.

Standard Instructions:

1. Clear Capital Code Of Conduct - Please make sure that you are always abiding by the Clear Capital Code of Conduct when completing valuation reports.
2. If the subject is currently listed, please consider all available information pertaining to the subject's condition. This information should be utilized when developing the assumption of the subject's condition.
3. Use the subject characteristics provided in the report Grid (if preloaded) to evaluate the property. This information is from a full interior appraisal and is assumed to be most accurate. If your inspection reveals obvious inaccuracies, please explain in the narrative of the report.
4. Include sufficient detail to help our mutual customer gain a complete understanding of the subject's neighborhood such as neighborhood desirability, amenities, parks, schools, commercial or industrial influences, REO activity, traffic, board-up-homes, etc.
5. Do not approach occupants or owners.
6. If the subject is a Commercial property, contact Clear Capital immediately at 530-582-5011 for direction on how to proceed with the report.
7. Please do not accept if you or your office has completed a report on this property in the last month, are currently listing this property, or have any vested interest in the subject property.
8. Clear Capital does not allow any log ins from IP addresses from foreign countries. This includes, but is not limited to; data entry services, form completion services, etc. Also, it is against Clear Capital code of conduct to share your password with anyone who is not a W2 employee in your office.
9. Clear Capital and our mutual customers greatly appreciate your expertise. If you cannot

Report Instructions - cont.

personally inspect the property, select comparables, and determine a price for the subject, please do not accept this report. Per the standards and guidelines adopted by Clear Capital and other industry leaders, the use of assistants to complete any of the aforementioned tasks is not permitted.

Due to the importance of an independent opinion of price, please do not discuss your price with anyone or be influenced by list price, pending offers, accept comp packets, repair estimates or the listing agent's opinion.

1. One current, original photo of the front of the subject 2. One address verification photo 3. One street scene photo looking down the street 4. MLS listing and sold comp photos required, please comment if no MLS.

Broker Information

Broker Name	Jeffrey Ward	Company/Brokerage	Miramar international
License No	01394654	Address	11809 Wethersfield St Bakersfield CA 93312
License Expiration	08/19/2023	License State	CA
Phone	6613300248	Email	jeffwardagent@gmail.com
Broker Distance to Subject	6.72 miles	Date Signed	01/16/2020

By confirming the above contact and real estate license information and submitting the report, the above signed hereby certifies and agrees that: 1) I personally took the pictures, selected comparables, and determined the price conclusion. 2) To the best of my knowledge, the statements of fact contained in this report are true and correct. 3) The reported analyses, opinions, and conclusions are my personal, impartial, and unbiased professional analyses, opinions, and conclusions. 4) I have no present or prospective interest in the property that is the subject of this report and no personal interest with respect to the parties involved. 5) I have no bias with respect to the property that is the subject of this report or to the parties involved with this assignment. 6) My compensation for completing this assignment is not contingent upon the development or reporting of a predetermined price point. 7) I did not base, either partially or completely, my analysis and/or opinion and conclusions in this report on race, color, religion, sex, age, marital status, handicap, familial status, or national origin of either the prospective owners or occupants of the subject property or of the present owners or occupants of the properties in the vicinity of the subject property or on any other basis prohibited by law. 8) I maintain errors and omissions insurance, to the extent required by state law, for all liability associated with the preparation of this Report.

Disclaimer

This document is not an appraisal as defined by USPAP (Uniform Standards of Professional Appraisal Practice). It is not to be construed as an appraisal and may not be used as such for any purpose.

Unless otherwise specifically agreed to in writing:

The intended purpose of this report is to assist the Clear Capital account holder in making decisions within the scope of applicable statutory and regulatory requirements and performing required due diligence. This document is provided solely for the use of the Clear Capital account holder and not any other party, is not intended as any guarantee of value and/or condition of the subject property and should not be relied on as such. In the event that this document is found to be defective, incorrect, negligently prepared or unfit for its authorized use, Clear Capital's sole liability shall be to promptly refund the total fee expended by the account holder for this report or to replace it at no charge to the account holder, but in no event shall Clear Capital be responsible to the account holder for any indirect or consequential damages whatsoever. This warranty is in lieu of all other warranties, express or implied, except where otherwise required by law. The account holder shall notify Clear Capital within thirty (30) days of this report's delivery to the account holder if it believes that this document is defective, incorrect, negligently prepared or unfit for its authorized use. Under no circumstances may Clear Capital forms or their contents be published, copied, replicated, or mimicked.