

Please Note: This report was completed with the following assumptions: Market Approach: **Fair Market Price** , Marketing Time: **Typical** . Important additional information relating to this report, including use and restrictions, is contained in an attached addendum which is an integral part of this report.

Address	11844 Branch Court, Adelanto, CA 92301	Order ID	6515005	Property ID	27913782
Inspection Date	02/04/2020	Date of Report	02/04/2020		
Loan Number	40025	APN	3128-682-29-0000		
Borrower Name	Catamount Properties 2018 LLC	County	San Bernardino		

Tracking IDs					
Order Tracking ID	20200203_Citi_BPO	Tracking ID 1	20200203_Citi_BPO		
Tracking ID 2	--	Tracking ID 3	--		

General Conditions		Condition Comments
Owner	Macias Steven Jess Jr	<p>Subject is located in a subdivision on standard lot size with sidewalks and curbs. The curb appeal is average with tile roofing and established landscaping. The square footage and room counts are common for the build as well as the lot size. Normal wear and tear updating should be expected though subject is assumed to be move in ready. A full interior inspection is needed for the most accurate value. Improved properties are still common so some level of updating may be needed to meet average market standards. Subject MLS comments: Beautiful home all the upgrades! Enjoy hardwood flooring throughout the entire home. Open concept floor plan with natural light, upgraded lighting with ceiling fans, and a large 'great room' concept for the kitchen, dining, and family room. This home is perfect for entertaining! Kitchen features an island with sink, breakfast bar/barstool seating, under cabinet lighting, stainless steel appliances, and walk-in corner pantry. Tall ceilings throughout. Upgraded panel doors throughout. Indoor laundry with storage. Finished garage. Wide side yards with room for dog run, garden, storage shed, etc. Enjoy living near all the amenities and conveniences with schools, parks, shopping, grocery, banking, and more just minutes away!</p>
R. E. Taxes	\$2,964	
Assessed Value	\$209,120	
Zoning Classification	Residential	
Property Type	SFR	
Occupancy	Occupied	
Ownership Type	Fee Simple	
Property Condition	Average	
Estimated Exterior Repair Cost	\$0	
Estimated Interior Repair Cost	\$0	
Total Estimated Repair	\$0	
HOA	No	
Visible From Street	Visible	
Road Type	Public	

Neighborhood & Market Data		Neighborhood Comments
Location Type	Suburban	<p>The market remains dominated by traditional sales with the majority of the homes sold in the last 6 months having been FMV. The market values have shown an average increase of around 3.2% for the last 12 months but have shown a total decrease of 0.3% in the past month. Standard seller concessions remain at 3% sale price. Average marketing time is at 32 days. Median GLA for SFR is 1655. Data based on half mile radius and 6 month sale date.</p>
Local Economy	Stable	
Sales Prices in this Neighborhood	Low: \$220,000 High: \$292,000	
Market for this type of property	Remained Stable for the past 6 months.	
Normal Marketing Days	<90	

Current Listings

	Subject	Listing 1	Listing 2	Listing 3 *
Street Address	11844 Branch Court	15484 Pearmain St	11840 Lupin Rd	15794 Mcvay Ln
City, State	Adelanto, CA	Adelanto, CA	Adelanto, CA	Adelanto, CA
Zip Code	92301	92301	92301	92301
Datasource	Tax Records	MLS	MLS	MLS
Miles to Subj.	--	0.48 ¹	0.45 ¹	0.44 ¹
Property Type	SFR	SFR	SFR	SFR
Original List Price \$	\$	\$285,000	\$235,000	\$280,000
List Price \$	--	\$284,999	\$235,000	\$275,000
Original List Date		11/21/2019	01/07/2020	09/09/2019
DOM · Cumulative DOM	-- · --	75 · 75	6 · 28	148 · 148
Age (# of years)	16	17	15	3
Condition	Average	Average	Average	Good
Sales Type	--	Fair Market Value	Fair Market Value	Fair Market Value
Location	Neutral ; Residential	Neutral ; Residential	Neutral ; Residential	Neutral ; Residential
View	Neutral ; Residential	Neutral ; Residential	Neutral ; Residential	Neutral ; Residential
Style/Design	1 Story Trad	1 Story Trad	1 Story Trad	1 Story Trad
# Units	1	1	1	1
Living Sq. Feet	1,756	1,564	1,630	1,892
Bdrm · Bths · ½ Bths	3 · 2	4 · 2	4 · 2	3 · 2
Total Room #	6	7	7	6
Garage (Style/Stalls)	Attached 2 Car(s)	Attached 2 Car(s)	Attached 2 Car(s)	Attached 2 Car(s)
Basement (Yes/No)	No	No	No	No
Basement (% Fin)	0%	0%	0%	0%
Basement Sq. Ft.	--	--	--	--
Pool/Spa	--	--	--	--
Lot Size	0.17 acres	0.17 acres	0.17 acres	0.17 acres
Other	Patio, porch	Patio, porch	Patio, porch	Patio, porch

* Listing 3 is the most comparable listing to the subject.

¹ Comp's "Miles to Subject" was calculated by the system.

² Comp's "Miles to Subject" provided by Real Estate Professional.

³ Subject \$/ft based upon as-is sale price.

Current Listings - Cont.

Listing Comments Why the comparable listing is superior or inferior to the subject.

- Listing 1** This home has tile throughout the house, interior paint, shutters throughout the home! Move-in ready! This home has 3 bedrooms and a den/bonus room that would make a great office or 4th bedroom. Newer home on large corner lot. Large patio area in rear. Two car attached garage.
- Listing 2** Nice Single Story with Open Floor Plan. 4 Bedrooms and 2 Full Baths. Living Room with Fireplace. Kitchen with Built In Appliances and Pantry. Dining Room next to Kitchen with Slider to Backyard. Spacious Master Bedroom. Master Bathroom with His & Hers Sinks and Walk In Closet. Hallway with Main Full Bathroom, Cabinets for Storage and Coat Closet. All other Bedrooms with Mirrored Closets and Carpet. Indoor Laundry Room. Newer Interior Paint. Tile throughout Living Room, Kitchen, Hallway and Laundry Room. Blinds on All Windows. Attached 2 Car Garage. Front Yard Landscaped with Dry Scape. Great Size Backyard with RV Parking on West Side of Home. Convenient Location.
- Listing 3** (Non descriptive MLS comments) Newer in build with updated features being move in ready, quartz counters, hardwood floors.

Recent Sales

	Subject	Sold 1	Sold 2	Sold 3 *
Street Address	11844 Branch Court	11632 Desert Falls St	11954 Poppy Rd	11873 Branch Ct
City, State	Adelanto, CA	Adelanto, CA	Adelanto, CA	Adelanto, CA
Zip Code	92301	92301	92301	92301
Datasource	Tax Records	MLS	MLS	MLS
Miles to Subj.	--	0.28 ¹	0.08 ¹	0.05 ¹
Property Type	SFR	SFR	SFR	SFR
Original List Price \$	--	\$275,000	\$265,000	\$239,000
List Price \$	--	\$275,000	\$265,000	\$239,000
Sale Price \$	--	\$275,000	\$260,000	\$239,000
Type of Financing	--	5k Conv	5k Conv	3k Va
Date of Sale	--	01/17/2020	09/10/2019	01/15/2020
DOM · Cumulative DOM	-- · --	19 · 57	42 · 98	17 · 64
Age (# of years)	16	15	13	16
Condition	Average	Average	Average	Average
Sales Type	--	Fair Market Value	Fair Market Value	Fair Market Value
Location	Neutral ; Residential	Neutral ; Residential	Neutral ; Residential	Neutral ; Residential
View	Neutral ; Residential	Neutral ; Residential	Neutral ; Residential	Neutral ; Residential
Style/Design	1 Story Trad	1 Story Trad	1 Story Trad	1 Story Trad
# Units	1	1	1	1
Living Sq. Feet	1,756	2,038	1,771	1,756
Bdrm · Bths · ½ Bths	3 · 2	4 · 2	4 · 3	3 · 2
Total Room #	6	7	7	6
Garage (Style/Stalls)	Attached 2 Car(s)	Attached 2 Car(s)	Attached 2 Car(s)	Attached 3 Car(s)
Basement (Yes/No)	No	No	No	No
Basement (% Fin)	0%	0%	0%	0%
Basement Sq. Ft.	--	--	--	--
Pool/Spa	--	--	--	--
Lot Size	0.17 acres	0.17 acres	0.17 acres	0.17 acres
Other	Patio, porch	Patio, porch	Patio, porch	Patio, porch
Net Adjustment	--	-\$25,900	-\$9,000	\$0
Adjusted Price	--	\$249,100	\$251,000	\$239,000

* Sold 3 is the most comparable sale to the subject.

¹ Comp's "Miles to Subject" was calculated by the system.

² Comp's "Miles to Subject" provided by Real Estate Professional.

³ Subject \$/ft based upon as-is sale price.

Recent Sales - Cont.

Reasons for Adjustments Why the comparable sale is superior or inferior to the subject.

- Sold 1** This lovely single family home features 4 spacious Bedrooms and 2 Full Baths, it has been freshly painted and new carpet throughout. The kitchen has new appliances and lots of cabinets. -9900 sqft, -6K room, -10K cond
- Sold 2** Beautiful single story home with four bedrooms and three baths. Two master bedrooms with walk in closets. The first master bedroom has it's own private entrance. Granite countertops in kitchen with plenty of cabinets and with an added pantry room. You will love the open floor plan throughout the kitchen into family and dining rooms, plenty of space to entertain. All three bathrooms have matching granite countertops. In the backyard you will find a built in BBQ island with a gas grill and a mini refrigerator. A working jacuzzi for those perfect nights. Plenty of room in the backyard to add your finishing touches. Front desert rock landscape and backyard with very little maintenance. -6K room, -3K bath
- Sold 3** Talk about attention to detail! This home is in excellent condition and is ready for your family! Drive up to find a beautifully landscaped front yard with drought tolerant plants and decorative rock that will help you conserve water year round! Open your front door and to the left is a cozy living space equipped with a fire place for those cold desert nights. Sit down and enjoy quiet time reading your favorite book or game night with the entire family. Your new kitchen is placed and laid out perfectly for entertaining guests! Directly adjacent to a comfortable sized dining area and overlooking the family room, you will be serving meals and drinks without missing a minute of social time! When it's time to call it a night, take a left down the hallway to a spacious master suite. The master bedroom boasts a large walk-in closet, private bathroom with dual sinks, stand up shower, and a separate bath tub for those late night soaks. With two spacious guest bedrooms, another full bathroom, indoor laundry room, and a three car garage, you can't go wrong with this home! Wood laminate and ceramic tile flooring throughout make for easy maintenance and let's not forget to mention your covered patio, white privacy fence, and block wall in the back yard and last, but certainly not least, swamp cooler to keep those summer electricity bills to a minimum! This home is all set! Come take a look!

Subject Sales & Listing History

Current Listing Status	Currently Listed	Listing History Comments					
Listing Agency/Firm	Intero Real Estate Services	Currently listed					
Listing Agent Name	Henry Hill						
Listing Agent Phone	909-212-0329						
# of Removed Listings in Previous 12 Months	0						
# of Sales in Previous 12 Months	0						
Original List Date	Original List Price	Final List Date	Final List Price	Result	Result Date	Result Price	Source
09/06/2019	\$245,000	10/23/2019	\$240,000	--	--	--	MLS

Marketing Strategy

	As Is Price	Repaired Price
Suggested List Price	\$250,000	\$250,000
Sales Price	\$245,000	\$245,000
30 Day Price	\$235,000	--
Comments Regarding Pricing Strategy		
<p>Parameters for search used were: 6 months sale date, half mile radius, +- 300 sqft, +-5 year age difference. 10 sold comps and 2 list comps were returned. Comps chosen are similar in marketability and amenity as well as location, unless otherwise noted due to a lack of available comps. This report is completed assuming subject was built using standard builder grade materials with no assumed updating. List parameters were relaxed in order to return more comps. Adjustments to the comps have been made, where necessary, to bring the comps as close to subject as possible for accurate pricing. The most weight has been placed on sold comp 3 which is most similar in overall appeal and condition. Subject is located in a populated area that can be marketed to most average home buyers. Subject list price should be competitive with the available list comps for maximum exposure with pricing emphasis placed on the pending list comps. 90 day marketing times are uncommon in this area so an increased list price above available list comps would be needed if 90+ day marketing time is the goal. Value is based on exterior only and the assumption the interior is in average condition. Any discrepancies in this assumption could affect the suggested value either way.</p>		

Clear Capital Quality Assurance Comments Addendum

Reviewer's The broker's as-is conclusion reflects the market for the subject. Comps are within a reasonable distance, relatively current, and accurately reflect
Notes the subject's defining characteristics. Thus, the as-is conclusion appears to be adequately supported.

Subject Photos



Front



Address Verification



Side



Side



Street

Listing Photos

L1 15484 Pearmain St
Adelanto, CA 92301



Front

L2 11840 Lupin Rd
Adelanto, CA 92301



Front

L3 15794 Mcvay Ln
Adelanto, CA 92301



Front

Sales Photos

S1 11632 Desert Falls St
Adelanto, CA 92301



Front

S2 11954 Poppy Rd
Adelanto, CA 92301



Front

S3 11873 Branch Ct
Adelanto, CA 92301



Front

ClearMaps Addendum

Address ★ 11844 Branch Court, Adelanto, CA 92301

Loan Number 40025

Suggested List \$250,000

Suggested Repaired \$250,000

Sale \$245,000

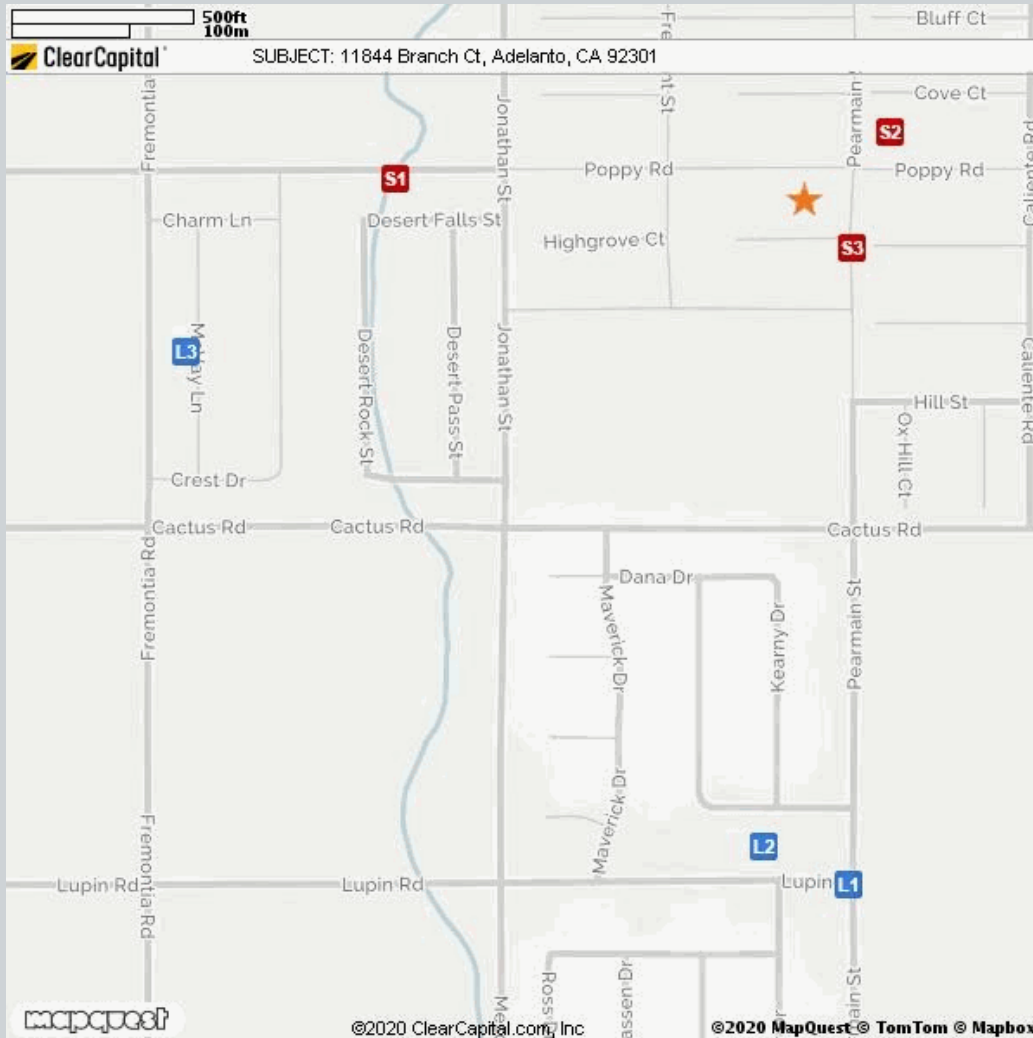

Comparable

Comparable	Address	Miles to Subject	Mapping Accuracy
★ Subject	11844 Branch Ct, Adelanto, CA	--	Parcel Match
L1	15484 Pearmain St, Adelanto, CA	0.48 Miles ¹	Parcel Match
L2	11840 Lupin Rd, Adelanto, CA	0.45 Miles ¹	Parcel Match
L3	15794 Mcvay Ln, Adelanto, CA	0.44 Miles ¹	Parcel Match
S1	11632 Desert Falls St, Adelanto, CA	0.28 Miles ¹	Parcel Match
S2	11954 Poppy Rd, Adelanto, CA	0.08 Miles ¹	Parcel Match
S3	11873 Branch Ct, Adelanto, CA	0.05 Miles ¹	Parcel Match

¹ The Comparable "Distance from Subject" value has been calculated by the Clear Capital system.

² The Comparable "Distance from Subject" value has been provided by the Real Estate Professional.

Addendum: Report Purpose

Market Approach and Market Time

The Market Approach of this report, as established by the customer, is: **Fair Market Price**. (See definition below.)

The Marketing Time as specified by the customer is **Typical**. (See definition below.)

Definitions:

Fair Market Price	A price at which the property would sell between a willing buyer and a willing seller neither being compelled by undue pressure and both having reasonable knowledge of relevant facts.
Distressed Price	A price at which the property would sell between a willing buyer and a seller acting under duress.
Marketing Time	The amount of time the property is exposed to a pool of prospective buyers before going into contract. The customer either specifies the number of days, requests a marketing time that is typical to the subject's market area and/or requests an abbreviated marketing time.
Typical for Local Market	The estimated time required to adequately expose the subject property to the market resulting in a contract of sale.

Addendum: Report Purpose - cont.

Report Instructions

This section shows the instructions that were approved by the customer and provided to the broker prior to completing the report.

*** Please Note: This is a RUSH assignment. Do not accept if you cannot meet the current due date and time. Please reference the set terms and contact Clear Capital at 530.582.5011 if you require any changes. Thanks! ***

Instructions last updated: 7/17/2017

Purpose:

Please determine a fair market price for this property at which it would sell in a typical marketing time for the area.

Customer Specific Requests:

If the property is commercial or mixed use, please stop and contact Clear Capital as soon as possible

Form Help:

There are blue question marks (?) throughout this form. These are designed to offer guidance for that particular section of the form. Please click on them for help.

Comparable Requirements:

1. Please use fair market comps from the same neighborhood, block or subdivision whenever possible.
2. Please only use REO comparables if the market is driven by REOs and they are comparable in characteristics and condition.
3. Please use comps that have closed in the past 3 months to show the current market conditions or comment in the report if this is not possible. In rapidly changing markets, active listing comps should be given equal or greater weight than sold comps in your analysis.

Standard Instructions:

1. Clear Capital Code Of Conduct - Please make sure that you are always abiding by the Clear Capital Code of Conduct when completing valuation reports.
2. If the subject is currently listed, please consider all available information pertaining to the subject's condition. This information should be utilized when developing the assumption of the subject's condition.
3. Use the subject characteristics provided in the report Grid (if preloaded) to evaluate the property. This information is from a full interior appraisal and is assumed to be most accurate. If your inspection reveals obvious inaccuracies, please explain in the narrative of the report.
4. Include sufficient detail to help our mutual customer gain a complete understanding of the subject's neighborhood such as neighborhood desirability, amenities, parks, schools, commercial or industrial influences, REO activity, traffic, board-up-homes, etc.
5. Do not approach occupants or owners.
6. If the subject is a Commercial property, contact Clear Capital immediately at 530-582-5011 for direction on how to proceed with the report.
7. Please do not accept if you or your office has completed a report on this property in the last month, are currently listing this property, or have any vested interest in the subject property.
8. Clear Capital does not allow any log ins from IP addresses from foreign countries. This includes, but is not limited to; data entry services, form completion services, etc. Also, it is against Clear Capital code of conduct to share your password with anyone who is not a W2 employee in your office.
9. Clear Capital and our mutual customers greatly appreciate your expertise. If you cannot

Report Instructions - cont.

personally inspect the property, select comparables, and determine a price for the subject, please do not accept this report. Per the standards and guidelines adopted by Clear Capital and other industry leaders, the use of assistants to complete any of the aforementioned tasks is not permitted.

Due to the importance of an independent opinion of price, please do not discuss your price with anyone or be influenced by list price, pending offers, accept comp packets, repair estimates or the listing agent's opinion.

1. One current, original photo of the front of the subject 2. One address verification photo 3. One street scene photo looking down the street 4. MLS listing and sold comp photos required, please comment if no MLS.

Broker Information

Broker Name	Jessica Lynn Lewis 1	Company/Brokerage	Elite REO Services
License No	01733706	Address	13735 Kiowa Rd Apple Valley CA 92308
License Expiration	12/27/2022	License State	CA
Phone	7607845224	Email	jessica.lewis@elitereo.com
Broker Distance to Subject	11.61 miles	Date Signed	02/04/2020

By confirming the above contact and real estate license information and submitting the report, the above signed hereby certifies and agrees that: 1) I personally took the pictures, selected comparables, and determined the price conclusion. 2) To the best of my knowledge, the statements of fact contained in this report are true and correct. 3) The reported analyses, opinions, and conclusions are my personal, impartial, and unbiased professional analyses, opinions, and conclusions. 4) I have no present or prospective interest in the property that is the subject of this report and no personal interest with respect to the parties involved. 5) I have no bias with respect to the property that is the subject of this report or to the parties involved with this assignment. 6) My compensation for completing this assignment is not contingent upon the development or reporting of a predetermined price point. 7) I did not base, either partially or completely, my analysis and/or opinion and conclusions in this report on race, color, religion, sex, age, marital status, handicap, familial status, or national origin of either the prospective owners or occupants of the subject property or of the present owners or occupants of the properties in the vicinity of the subject property or on any other basis prohibited by law. 8) I maintain errors and omissions insurance, to the extent required by state law, for all liability associated with the preparation of this Report.

Disclaimer

This document is not an appraisal as defined by USPAP (Uniform Standards of Professional Appraisal Practice). It is not to be construed as an appraisal and may not be used as such for any purpose.

Unless otherwise specifically agreed to in writing:

The intended purpose of this report is to assist the Clear Capital account holder in making decisions within the scope of applicable statutory and regulatory requirements and performing required due diligence. This document is provided solely for the use of the Clear Capital account holder and not any other party, is not intended as any guarantee of value and/or condition of the subject property and should not be relied on as such. In the event that this document is found to be defective, incorrect, negligently prepared or unfit for its authorized use, Clear Capital's sole liability shall be to promptly refund the total fee expended by the account holder for this report or to replace it at no charge to the account holder, but in no event shall Clear Capital be responsible to the account holder for any indirect or consequential damages whatsoever. This warranty is in lieu of all other warranties, express or implied, except where otherwise required by law. The account holder shall notify Clear Capital within thirty (30) days of this report's delivery to the account holder if it believes that this document is defective, incorrect, negligently prepared or unfit for its authorized use. Under no circumstances may Clear Capital forms or their contents be published, copied, replicated, or mimicked.