

Please Note: This report was completed with the following assumptions: Market Approach: **Fair Market Price** , Marketing Time: **Typical** . Important additional information relating to this report, including use and restrictions, is contained in an attached addendum which is an integral part of this report.

Address	2830 W Bismark Avenue - Holdback, Spokane, WA 99205	Order ID	7349306	Property ID	30451724
Inspection Date	06/09/2021	Date of Report	06/10/2021		
Loan Number	42863	APN	263620231		
Borrower Name	Catamount Properties 2018 LLC	County	Spokane		

Tracking IDs

Order Tracking ID	0608_BPOUpdate	Tracking ID 1	0608_BPOUpdate
Tracking ID 2	--	Tracking ID 3	--

General Conditions

Owner	CATAMOUNT PROPERTIES 2018 LLC	Condition Comments Subject is in average condition, needing no repairs. Curb appeal of the subject is average and favorable. Subject is comparable to homes in the neighborhood.
R. E. Taxes	\$2,450	
Assessed Value	\$180,100	
Zoning Classification	Residential	
Property Type	SFR	
Occupancy	Occupied	
Ownership Type	Fee Simple	
Property Condition	Average	
Estimated Exterior Repair Cost	\$0	
Estimated Interior Repair Cost	\$0	
Total Estimated Repair	\$0	
HOA	No	
Visible From Street	Visible	
Road Type	Public	

Neighborhood & Market Data

Location Type	Suburban	Neighborhood Comments Subject is located in a neighborhood of homes comparable to the subject in condition, but diverse in year built and square footage. Subject is close to schools, shopping and commerce. There is no new growth near the subject. REO activity is low and there are no boarded up homes in the neighborhood of the subject.
Local Economy	Stable	
Sales Prices in this Neighborhood	Low: \$209500 High: \$322600	
Market for this type of property	Increased 5 % in the past 6 months.	
Normal Marketing Days	<30	

Current Listings

	Subject	Listing 1 *	Listing 2	Listing 3
Street Address	2830 W Bismark Avenue - Holdback	6019 N A St	5519 N G St	4117 W Wellesley Ave
City, State	Spokane, WA	Spokane, WA	Spokane, WA	Spokane, WA
Zip Code	99205	99205	99205	99205
Datasource	Public Records	MLS	MLS	MLS
Miles to Subj.	--	0.05 ¹	0.46 ¹	1.25 ¹
Property Type	SFR	SFR	SFR	SFR
Original List Price \$	\$	\$227,000	\$229,900	\$265,000
List Price \$	--	\$227,000	\$229,900	\$265,000
Original List Date		05/20/2021	05/05/2021	04/27/2020
DOM · Cumulative DOM	-- · --	4 · 21	36 · 36	1 · 409
Age (# of years)	71	71	67	71
Condition	Average	Average	Average	Average
Sales Type	--	Fair Market Value	Fair Market Value	Fair Market Value
Location	Neutral ; Residential	Neutral ; Residential	Neutral ; Residential	Neutral ; Residential
View	Neutral ; Residential	Neutral ; Residential	Neutral ; Residential	Neutral ; Residential
Style/Design	1 Story Ranch/Rambler	1 Story Ranch	1 Story Ranch	1 Story Ranch
# Units	1	1	1	1
Living Sq. Feet	1,008	998	816	1,042
Bdrm · Bths · ½ Bths	3 · 1	3 · 1	2 · 2	3 · 1
Total Room #	6	6	5	6
Garage (Style/Stalls)	Detached 2 Car(s)	None	Attached 1 Car	Detached 1 Car
Basement (Yes/No)	Yes	No	Yes	No
Basement (% Fin)	0%	0%	0%	0%
Basement Sq. Ft.	672	--	816	--
Pool/Spa	--	--	--	Pool - Yes
Lot Size	0.16 acres	.12 acres	.16 acres	.16 acres
Other	Patio	Patio	Porch	Patio

* Listing 1 is the most comparable listing to the subject.

¹ Comp's "Miles to Subject" was calculated by the system.

² Comp's "Miles to Subject" provided by Real Estate Professional.

³ Subject \$/ft based upon as-is sale price.

Listing Comments Why the comparable listing is superior or inferior to the subject.

Listing 1 Listing comp 1 is equal to subject due to condition, square footage, year built and proximity to the subject.

Listing 2 Listing comp 2 is equal to the subject due to square footage, style, condition, age and location within the grid of the subject.

Listing 3 Listing comp 3 is equal to the subject due to style, condition, square footage, year built and location.

Recent Sales

	Subject	Sold 1	Sold 2 *	Sold 3
Street Address	2830 W Bismark Avenue - Holdback	5408 N Audubon St	5941 N Fotheringham St	5610 N F St
City, State	Spokane, WA	Spokane, WA	Spokane, WA	Spokane, WA
Zip Code	99205	99205	99205	99205
Datasource	Public Records	MLS	MLS	MLS
Miles to Subj.	--	0.41 ¹	0.48 ¹	0.39 ¹
Property Type	SFR	SFR	SFR	SFR
Original List Price \$	--	\$185,000	\$207,000	\$230,000
List Price \$	--	\$185,000	\$207,000	\$230,000
Sale Price \$	--	\$213,000	\$207,000	\$241,000
Type of Financing	--	Cash	Fha	Conventional
Date of Sale	--	01/20/2021	08/31/2020	12/08/2020
DOM · Cumulative DOM	-- · --	5 · 15	1 · 0	8 · 60
Age (# of years)	71	71	63	71
Condition	Average	Average	Average	Average
Sales Type	--	Fair Market Value	Fair Market Value	Fair Market Value
Location	Neutral ; Residential	Neutral ; Residential	Neutral ; Residential	Neutral ; Residential
View	Neutral ; Residential	Neutral ; Residential	Neutral ; Residential	Neutral ; Residential
Style/Design	1 Story Ranch/Rambler	1 Story Ranch	1 Story Ranch	1 Story Ranch
# Units	1	1	1	1
Living Sq. Feet	1,008	924	1,033	864
Bdrm · Bths · ½ Bths	3 · 1	2 · 1	2 · 1	2 · 1
Total Room #	6	5	5	5
Garage (Style/Stalls)	Detached 2 Car(s)	Detached 1 Car	Detached 2 Car(s)	Detached 3 Car(s)
Basement (Yes/No)	Yes	Yes	Yes	Yes
Basement (% Fin)	0%	0%	0%	0%
Basement Sq. Ft.	672	924	1,008	864
Pool/Spa	--	--	--	--
Lot Size	0.16 acres	.28 acres	.28 acres	.21 acres
Other	Patio	Patio	Porch	Deck
Net Adjustment	--	+\$2,000	\$0	-\$2,000
Adjusted Price	--	\$215,000	\$207,000	\$239,000

* Sold 2 is the most comparable sale to the subject.

¹ Comp's "Miles to Subject" was calculated by the system.

² Comp's "Miles to Subject" provided by Real Estate Professional.

³ Subject \$/ft based upon as-is sale price.

Recent Sales - Cont.

Reasons for Adjustments Why the comparable sale is superior or inferior to the subject.

- Sold 1** Sold comp 1 is equal to subject due to square footage, style, age, condition and proximity to the subject. Adjustment made for inferior garage \$2000.00.
- Sold 2** Comp 2 is equal to subject due to style, condition, year built, square footage and location within the neighborhood.
- Sold 3** Sold comp 3 is equal to subject due to age, condition, style, square footage and location. Adjustment made for superior garage - \$2000.00.

Subject Sales & Listing History

Current Listing Status	Not Currently Listed		Listing History Comments				
Listing Agency/Firm			Subject last sold 11/30/2020 \$203,900.00.				
Listing Agent Name							
Listing Agent Phone							
# of Removed Listings in Previous 12 Months	0						
# of Sales in Previous 12 Months	1						
Original List Date	Original List Price	Final List Date	Final List Price	Result	Result Date	Result Price	Source
11/30/2020	\$204,900	12/05/2020	\$204,900	Sold	12/22/2020	\$207,500	MLS

Marketing Strategy

	As Is Price	Repaired Price
Suggested List Price	\$225,000	\$225,000
Sales Price	\$225,000	\$225,000
30 Day Price	\$223,000	--
Comments Regarding Pricing Strategy		
Search for comps was extended 3 miles and back 12 months resulted in 3 listing and 3 sold properties similar in characteristics and price. Extending distance beyond the distance noted would not provide good comps due to condition, square footage and year built. A wide range of prices is unavoidable, therefore primary reliance is placed on sold comps due to value.		

Clear Capital Quality Assurance Comments Addendum

Reviewer's The broker's as-is conclusion reflects the market for the subject. Comps are within a reasonable distance, relatively current, and accurately reflect
Notes the subject's defining characteristics. Thus, the as-is conclusion appears to be adequately supported.

Subject Photos



Front



Address Verification



Street



Other



Other

Listing Photos

L1 6019 N A St
Spokane, WA 99205



Front

L2 5519 N G St
Spokane, WA 99205



Front

L3 4117 W Wellesley Ave
Spokane, WA 99205



Front

Sales Photos

S1 5408 N Audubon St
Spokane, WA 99205



Front

S2 5941 N Fotheringham St
Spokane, WA 99205



Front

S3 5610 N F St
Spokane, WA 99205



Front

ClearMaps Addendum

Address ★ 2830 W Bismark Avenue - Holdback, Spokane, WA 99205

Loan Number 42863

Suggested List \$225,000

Suggested Repaired \$225,000

Sale \$225,000

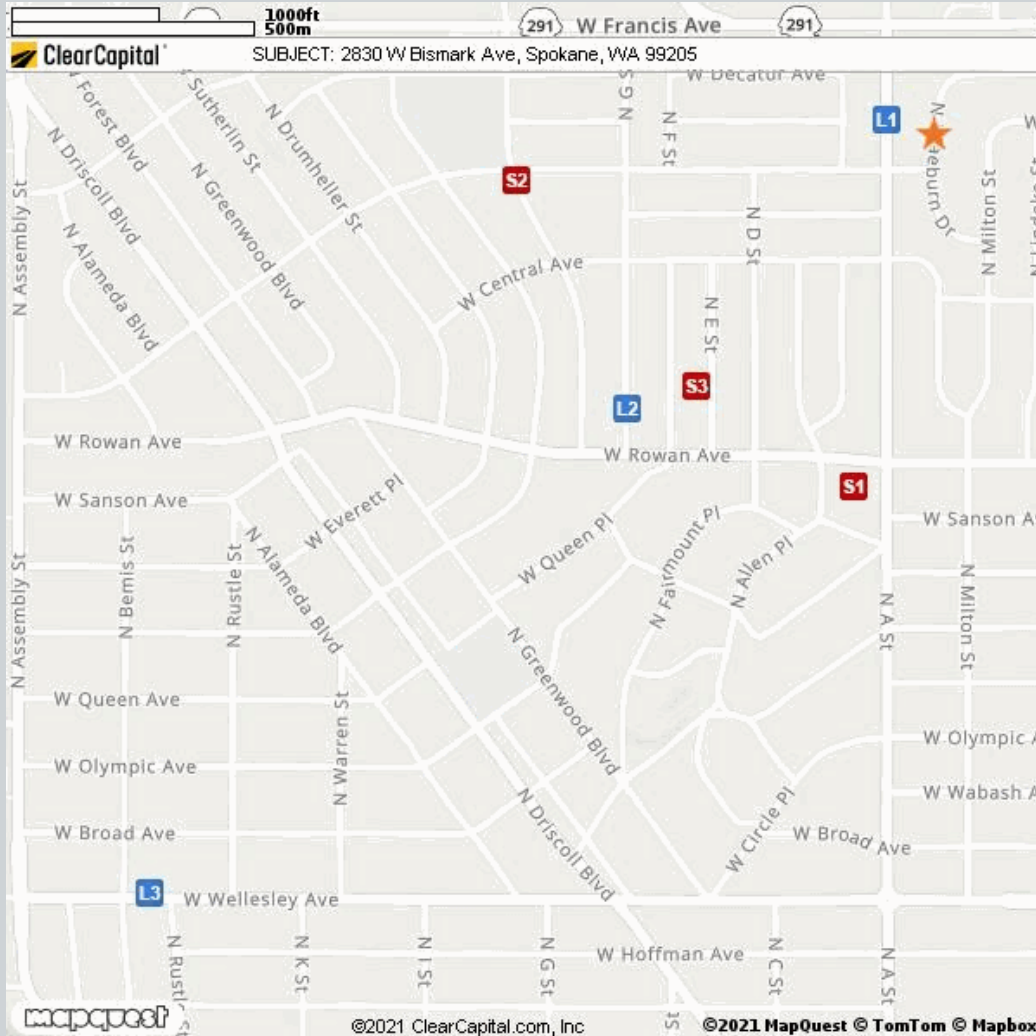

Comparable	Address	Miles to Subject	Mapping Accuracy
★ Subject	2830 W Bismark Avenue - Holdback, Spokane, WA 99205	--	Parcel Match
L1	6019 N A St, Spokane, WA 99205	0.05 Miles ¹	Parcel Match
L2	5519 N G St, Spokane, WA 99205	0.46 Miles ¹	Parcel Match
L3	4117 W Wellesley Ave, Spokane, WA 99205	1.25 Miles ¹	Parcel Match
S1	5408 N Audubon St, Spokane, WA 99205	0.41 Miles ¹	Parcel Match
S2	5941 N Fotheringham St, Spokane, WA 99205	0.48 Miles ¹	Parcel Match
S3	5610 N F St, Spokane, WA 99205	0.39 Miles ¹	Parcel Match

¹ The Comparable "Distance from Subject" value has been calculated by the Clear Capital system.

² The Comparable "Distance from Subject" value has been provided by the Real Estate Professional.

Addendum: Report Purpose

Market Approach and Market Time

The Market Approach of this report, as established by the customer, is: **Fair Market Price**. (See definition below.)

The Marketing Time as specified by the customer is **Typical**. (See definition below.)

Definitions:

Fair Market Price	A price at which the property would sell between a willing buyer and a willing seller neither being compelled by undue pressure and both having reasonable knowledge of relevant facts.
Distressed Price	A price at which the property would sell between a willing buyer and a seller acting under duress.
Marketing Time	The amount of time the property is exposed to a pool of prospective buyers before going into contract. The customer either specifies the number of days, requests a marketing time that is typical to the subject's market area and/or requests an abbreviated marketing time.
Typical for Local Market	The estimated time required to adequately expose the subject property to the market resulting in a contract of sale.

Addendum: Report Purpose - cont.

Report Instructions

This section shows the instructions that were approved by the customer and provided to the broker prior to completing the report.

Instructions last updated: 7/17/2017

Purpose:

Please determine a fair market price for this property at which it would sell in a typical marketing time for the area.

Customer Specific Requests:

If the property is commercial or mixed use, please stop and contact Clear Capital as soon as possible

Form Help:

There are blue question marks (?) throughout this form. These are designed to offer guidance for that particular section of the form. Please click on them for help.

Comparable Requirements:

1. Please use fair market comps from the same neighborhood, block or subdivision whenever possible.
2. Please only use REO comparables if the market is driven by REOs and they are comparable in characteristics and condition.
3. Please use comps that have closed in the past 3 months to show the current market conditions or comment in the report if this is not possible. In rapidly changing markets, active listing comps should be given equal or greater weight than sold comps in your analysis.

Standard Instructions:

1. Clear Capital Code Of Conduct - Please make sure that you are always abiding by the Clear Capital Code of Conduct when completing valuation reports.
2. If the subject is currently listed, please consider all available information pertaining to the subject's condition. This information should be utilized when developing the assumption of the subject's condition.
3. Use the subject characteristics provided in the report Grid (if preloaded) to evaluate the property. This information is from a full interior appraisal and is assumed to be most accurate. If your inspection reveals obvious inaccuracies, please explain in the narrative of the report.
4. Include sufficient detail to help our mutual customer gain a complete understanding of the subject's neighborhood such as neighborhood desirability, amenities, parks, schools, commercial or industrial influences, REO activity, traffic, board-up-homes, etc.
5. Do not approach occupants or owners.
6. If the subject is a Commercial property, contact Clear Capital immediately at 530-582-5011 for direction on how to proceed with the report.
7. Please do not accept if you or your office has completed a report on this property in the last month, are currently listing this property, or have any vested interest in the subject property.
8. Clear Capital does not allow any log ins from IP addresses from foreign countries. This includes, but is not limited to; data entry services, form completion services, etc. Also, it is against Clear Capital code of conduct to share your password with anyone who is not a W2 employee in your office.
9. Clear Capital and our mutual customers greatly appreciate your expertise. If you cannot personally inspect the property, select comparables, and determine a price for the subject, please do not accept this report. Per the standards and guidelines adopted by Clear Capital and other industry leaders, the use of assistants to complete any of the aforementioned tasks is not permitted.

Report Instructions - cont.

Due to the importance of an independent opinion of price, please do not discuss your price with anyone or be influenced by list price, pending offers, accept comp packets, repair estimates or the listing agent's opinion.

1. One current, original photo of the front of the subject 2. One address verification photo 3. One street scene photo looking down the street 4. MLS listing and sold comp photos required, please comment if no MLS.

Broker Information

Broker Name	Sheila Biegler	Company/Brokerage	Sheila Biegler
License No	50375	Address	3812 N Indian Bluff Rd Spokane WA 99224
License Expiration	12/05/2022	License State	WA
Phone	5097145244	Email	sdbiegler@gmail.com
Broker Distance to Subject	2.67 miles	Date Signed	06/10/2021

By confirming the above contact and real estate license information and submitting the report, the above signed hereby certifies and agrees that: 1) I personally took the pictures, selected comparables, and determined the price conclusion. 2) To the best of my knowledge, the statements of fact contained in this report are true and correct. 3) The reported analyses, opinions, and conclusions are my personal, impartial, and unbiased professional analyses, opinions, and conclusions. 4) I have no present or prospective interest in the property that is the subject of this report and no personal interest with respect to the parties involved. 5) I have no bias with respect to the property that is the subject of this report or to the parties involved with this assignment. 6) My compensation for completing this assignment is not contingent upon the development or reporting of a predetermined price point. 7) I did not base, either partially or completely, my analysis and/or opinion and conclusions in this report on race, color, religion, sex, age, marital status, handicap, familial status, or national origin of either the prospective owners or occupants of the subject property or of the present owners or occupants of the properties in the vicinity of the subject property or on any other basis prohibited by law. 8) I maintain errors and omissions insurance, to the extent required by state law, for all liability associated with the preparation of this Report.

Disclaimer

If this report is developed as a brokers price opinion, this brokers price opinion is not an appraisal as defined in chapter 18.140 RCW and has been prepared by a real estate licensee, licensed under chapter 18.85 RCW, who IS/IS NOT also state-certified or state-licensed as a real estate appraiser under chapter 18.140 RCW.

If this report is developed as an Evaluation, this Evaluation is not an appraisal as defined in chapter 18.140 RCW and has been prepared by a real estate licensee, licensed under chapter 18.85 RCW who IS/IS NOT also state-certified or state-licensed as a real estate appraiser under chapter 18.140 RCW.

Unless otherwise specifically agreed to in writing:

The intended purpose of this report is to assist the Clear Capital account holder in making decisions within the scope of applicable statutory and regulatory requirements and performing required due diligence. This document is provided solely for the use of the Clear Capital account holder and not any other party, is not intended as any guarantee of value and/or condition of the subject property and should not be relied on as such. In the event that this document is found to be defective, incorrect, negligently prepared or unfit for its authorized use, Clear Capital's sole liability shall be to promptly refund the total fee expended by the account holder for this report or to replace it at no charge to the account holder, but in no event shall Clear Capital be responsible to the account holder for any indirect or consequential damages whatsoever. This warranty is in lieu of all other warranties, express or implied, except where otherwise required by law. The account holder shall notify Clear Capital within thirty (30) days of this report's delivery to the account holder if it believes that this document is defective, incorrect, negligently prepared or unfit for its authorized use. Under no circumstances may Clear Capital forms or their contents be published, copied, replicated, or mimicked.