

Please Note: This report was completed with the following assumptions: Market Approach: **Fair Market Price** , Marketing Time: **Typical** . Important additional information relating to this report, including use and restrictions, is contained in an attached addendum which is an integral part of this report.

Address	142 Fern Street Nw, Royal City, WA 99357	Order ID	7049166	Property ID	29373449
Inspection Date	01/19/2021	Date of Report	01/22/2021		
Loan Number	43128	APN	071741000		
Borrower Name	Catamount Properties 2018 LLC	County	Grant		

Tracking IDs					
Order Tracking ID	0116BPOs	Tracking ID 1	43128		
Tracking ID 2	--	Tracking ID 3	--		

General Conditions		
Owner	Meza	Condition Comments There is no posted house number. The property was identified with the legal description. When a visual inspection of the property was made it was found to be in average condition with no obvious signs of deferred maintenance.
R. E. Taxes	\$933	
Assessed Value	\$106,695	
Zoning Classification	R1	
Property Type	Manuf. Home	
Occupancy	Occupied	
Ownership Type	Fee Simple	
Property Condition	Average	
Estimated Exterior Repair Cost	\$0	
Estimated Interior Repair Cost	\$0	
Total Estimated Repair	\$0	
HOA	No	
Visible From Street	Visible	
Road Type	Public	

Neighborhood & Market Data		
Location Type	Rural	Neighborhood Comments This home is located in an established neighborhood of detached one unit dwellings. It is in a small city in the rural county of Grant county in North Central Washington State.
Local Economy	Stable	
Sales Prices in this Neighborhood	Low: \$120,000 High: \$200,000	
Market for this type of property	Remained Stable for the past 6 months.	
Normal Marketing Days	<90	

Current Listings

	Subject	Listing 1	Listing 2 *	Listing 3
Street Address	142 Fern Street Nw	8597 Ne Vince Rd.	205 Beale Ave.	8692 Ne Jean
City, State	Royal City, WA	Moses Lake, WA	Moses Lake, WA	Moses Lake, WA
Zip Code	99357	98837	98837	98837
Datasource	MLS	MLS	MLS	MLS
Miles to Subj.	--	23.33 ¹	23.10 ¹	23.47 ¹
Property Type	Manuf. Home	Manufactured	Manufactured	Manufactured
Original List Price \$	\$	\$159,900	\$167,000	\$169,900
List Price \$	--	\$159,900	\$154,900	\$169,900
Original List Date		10/01/2020	07/24/2020	10/07/2020
DOM · Cumulative DOM	-- · --	111 · 113	180 · 182	105 · 107
Age (# of years)	33	42	22	27
Condition	Average	Average	Average	Average
Sales Type	--	Fair Market Value	Fair Market Value	Fair Market Value
Location	Neutral ; Residential	Neutral ; Residential	Neutral ; Residential	Neutral ; Residential
View	Neutral ; Residential	Neutral ; Residential	Neutral ; Residential	Neutral ; Residential
Style/Design	1 Story Manufactured	1 Story Manufactured	1 Story Manufactured	1 Story Manufactured
# Units	1	1	1	1
Living Sq. Feet	1,232	938	1,296	1,080
Bdrm · Bths · ½ Bths	3 · 2	2 · 1	3 · 2	3 · 2
Total Room #	6	4	6	6
Garage (Style/Stalls)	None	None	None	Detached 2 Car(s)
Basement (Yes/No)	No	No	No	No
Basement (% Fin)	0%	0%	0%	0%
Basement Sq. Ft.	--	--	--	--
Pool/Spa	--	--	--	--
Lot Size	.19 acres	.31 acres	.15 acres	.31 acres
Other	None	None	None	None

* Listing 2 is the most comparable listing to the subject.

¹ Comp's "Miles to Subject" was calculated by the system.

² Comp's "Miles to Subject" provided by Real Estate Professional.

³ Subject \$/ft based upon as-is sale price.

Listing Comments Why the comparable listing is superior or inferior to the subject.

Listing 1 This home is smaller than the subject home (+\$14,700), older home (+\$900), one less bedroom (+1k), one less bathroom (+2k), one car garage (-5k), larger lot (-\$2,400).

Listing 2 This is a larger home than the subject home (-\$3,200), newer (-\$1,100), this home is situated on a slightly smaller lot than the subject home (+\$800). This listing went pending sale on 1/16/2021

Listing 3 This home is smaller than the subject home (+\$7,600), newer (-\$600), two car garage (-10k), larger lot (-\$2,400). This listing went pending sale on 12/03/2020

Recent Sales

	Subject	Sold 1	Sold 2	Sold 3 *
Street Address	142 Fern Street Nw	7200 Se Bayview	7240 Cascadia	7200 Terrace Ave.
City, State	Royal City, WA	Othello, WA	Othello, WA	Othello, WA
Zip Code	99357	99344	99344	99344
Datasource	MLS	MLS	MLS	MLS
Miles to Subj.	--	14.44 ¹	14.49 ¹	14.40 ¹
Property Type	Manuf. Home	Manufactured	Manufactured	Manufactured
Original List Price \$	--	\$149,000	\$159,900	\$166,900
List Price \$	--	\$145,000	\$159,900	\$166,900
Sale Price \$	--	\$136,500	\$159,900	\$165,000
Type of Financing	--	Conventional	Conventional	Conventional
Date of Sale	--	11/04/2020	08/18/2020	04/15/2020
DOM · Cumulative DOM	-- · --	33 · 106	22 · 147	87 · 233
Age (# of years)	33	43	44	18
Condition	Average	Average	Average	Average
Sales Type	--	Fair Market Value	Fair Market Value	Fair Market Value
Location	Neutral ; Residential	Neutral ; Residential	Neutral ; Residential	Neutral ; Residential
View	Neutral ; Residential	Neutral ; Residential	Neutral ; Residential	Beneficial ; Water
Style/Design	1 Story Manufactured	1 Story Manufactured	1 Story Manufactured	1 Story Manufactured
# Units	1	1	1	1
Living Sq. Feet	1,232	960	1,248	1,040
Bdrm · Bths · ½ Bths	3 · 2	2 · 2	3 · 2	3 · 2
Total Room #	6	5	6	5
Garage (Style/Stalls)	None	Attached 1 Car	Attached 2 Car(s)	Attached 1 Car
Basement (Yes/No)	No	No	No	No
Basement (% Fin)	0%	0%	0%	0%
Basement Sq. Ft.	--	--	--	--
Pool/Spa	--	--	--	--
Lot Size	.19 acres	.31 acres	.31 acres	.31 acres
Other	None	None	None	None
Net Adjustment	--	+\$8,200	-\$12,200	-\$10,300
Adjusted Price	--	\$144,700	\$147,700	\$154,700

* Sold 3 is the most comparable sale to the subject.

¹ Comp's "Miles to Subject" was calculated by the system.

² Comp's "Miles to Subject" provided by Real Estate Professional.

³ Subject \$/ft based upon as-is sale price.

Recent Sales - Cont.

Reasons for Adjustments Why the comparable sale is superior or inferior to the subject.

Sold 1 This home is smaller than the subject home (+\$13,600), older home (+1k), one less bedroom (+1k), one car garage (-5k), larger lot (-\$2,400).

Sold 2 This is a slightly larger home (-\$800), older home than the subject home (+\$1,100), has a 2 car garage (-10k), larger lot (-\$2,400).

Sold 3 This home is smaller than the subject home (+\$8,600), newer home (-\$1,500), one car garage (-5k), superior view (-10k), larger lot (-\$2,400).

Subject Sales & Listing History

Current Listing Status	Not Currently Listed			Listing History Comments			
Listing Agency/Firm				For this property there was neither any listings nor any sales found in the MLS Database.			
Listing Agent Name							
Listing Agent Phone							
# of Removed Listings in Previous 12 Months	0						
# of Sales in Previous 12 Months	0						
Original List Date	Original List Price	Final List Date	Final List Price	Result	Result Date	Result Price	Source

Marketing Strategy

	As Is Price	Repaired Price
Suggested List Price	\$155,000	\$155,000
Sales Price	\$152,000	\$152,000
30 Day Price	\$149,000	--
Comments Regarding Pricing Strategy		
This is a rural area. There are not many homes period. I incrementally expanded the search parameters and selected the best comparable properties that are available. This home when marketed in a manner consistent with the recommendation in this report would be very saleable with the current conditions we are experiencing.		

Clear Capital Quality Assurance Comments Addendum

Reviewer's The broker's as-is conclusion reflects the market for the subject. Comps are within a reasonable distance, relatively current, and accurately reflect
Notes the subject's defining characteristics. Thus, the as-is conclusion appears to be adequately supported.

Subject Photos

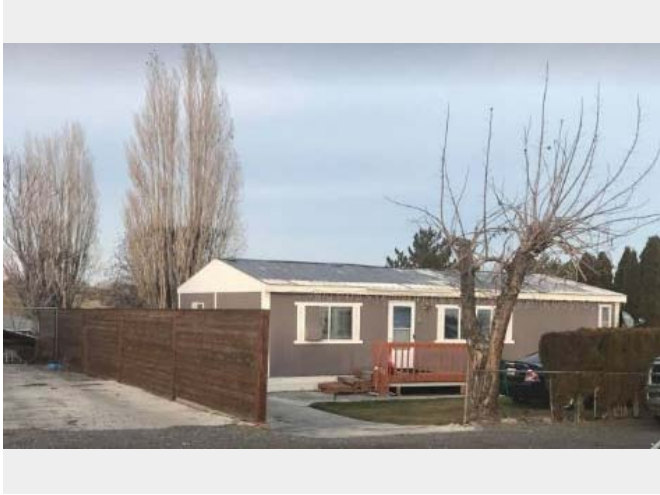

Front



Address Verification



Side



Side



Street



Street

Listing Photos

L1 8597 NE Vince Rd.
Moses Lake, WA 98837



Front

L2 205 Beale Ave.
Moses Lake, WA 98837



Front

L3 8692 NE Jean
Moses Lake, WA 98837



Front

Sales Photos

S1 7200 SE Bayview
Othello, WA 99344



Front

S2 7240 Cascadia
Othello, WA 99344



Front

S3 7200 Terrace Ave.
Othello, WA 99344



Front

ClearMaps Addendum

Address ★ 142 Fern Street Nw, Royal City, WA 99357

Loan Number 43128

Suggested List \$155,000

Suggested Repaired \$155,000

Sale \$152,000

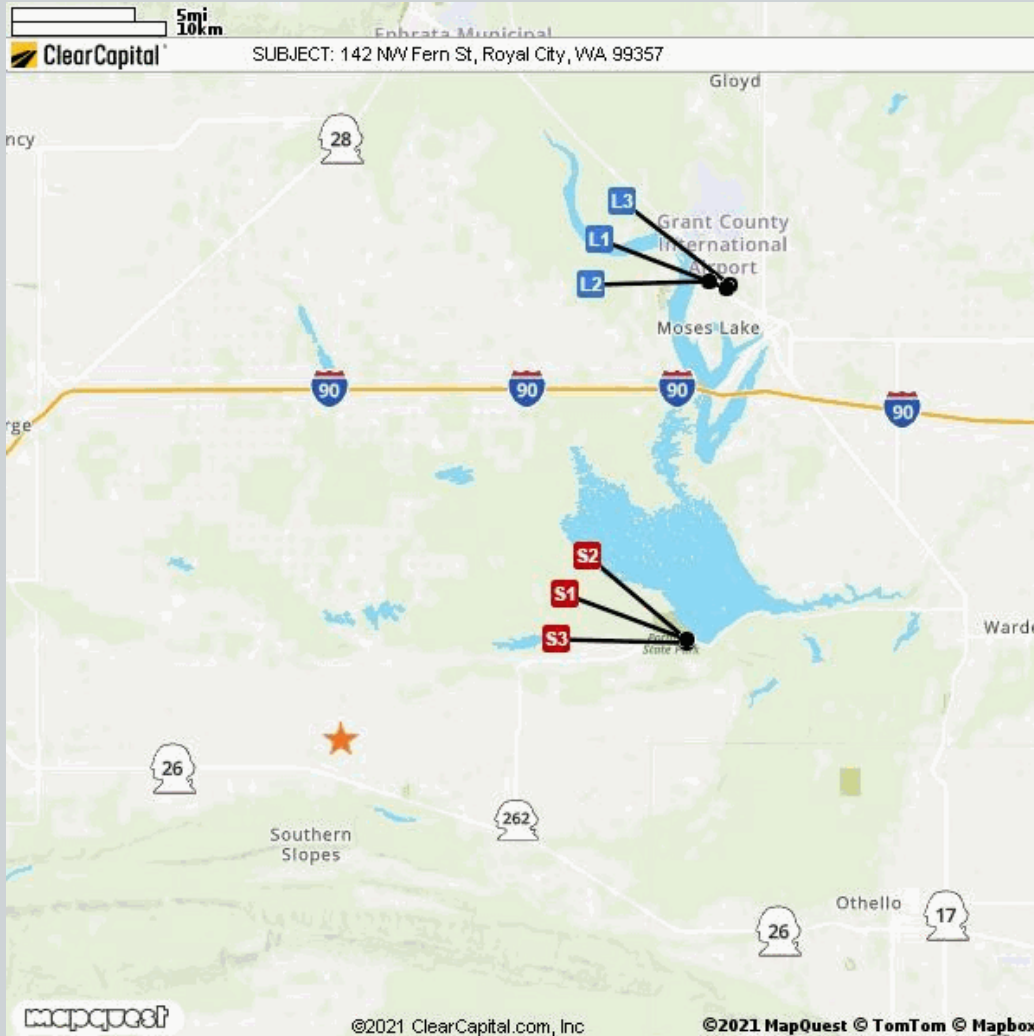

Comparable	Address	Miles to Subject	Mapping Accuracy
★ Subject	142 Fern Street Nw, Royal City, WA 99357	--	Parcel Match
L1 Listing 1	8597 Ne Vince Rd., Moses Lake, WA 98837	23.33 Miles ¹	Parcel Match
L2 Listing 2	205 Beale Ave., Moses Lake, WA 98837	23.10 Miles ¹	Parcel Match
L3 Listing 3	8692 Ne Jean, Moses Lake, WA 98837	23.47 Miles ¹	Parcel Match
S1 Sold 1	7200 Se Bayview, Othello, WA 99344	14.44 Miles ¹	Parcel Match
S2 Sold 2	7240 Cascadia, Othello, WA 99344	14.49 Miles ¹	Parcel Match
S3 Sold 3	7200 Terrace Ave., Othello, WA 99344	14.40 Miles ¹	Parcel Match

¹ The Comparable "Distance from Subject" value has been calculated by the Clear Capital system.

² The Comparable "Distance from Subject" value has been provided by the Real Estate Professional.

Addendum: Report Purpose

Market Approach and Market Time

The Market Approach of this report, as established by the customer, is: **Fair Market Price**. (See definition below.)

The Marketing Time as specified by the customer is **Typical**. (See definition below.)

Definitions:

Fair Market Price

A price at which the property would sell between a willing buyer and a willing seller neither being compelled by undue pressure and both having reasonable knowledge of relevant facts.

Distressed Price

A price at which the property would sell between a willing buyer and a seller acting under duress.

Marketing Time

The amount of time the property is exposed to a pool of prospective buyers before going into contract. The customer either specifies the number of days, requests a marketing time that is typical to the subject's market area and/or requests an abbreviated marketing time.

Typical for Local Market

The estimated time required to adequately expose the subject property to the market resulting in a contract of sale.

Addendum: Report Purpose - cont.

Report Instructions

This section shows the instructions that were approved by the customer and provided to the broker prior to completing the report.

Instructions last updated: 7/17/2017

Purpose:

Please determine a fair market price for this property at which it would sell in a typical marketing time for the area.

Customer Specific Requests:

If the property is commercial or mixed use, please stop and contact Clear Capital as soon as possible

Form Help:

There are blue question marks (?) throughout this form. These are designed to offer guidance for that particular section of the form. Please click on them for help.

Comparable Requirements:

1. Please use fair market comps from the same neighborhood, block or subdivision whenever possible.
2. Please only use REO comparables if the market is driven by REOs and they are comparable in characteristics and condition.
3. Please use comps that have closed in the past 3 months to show the current market conditions or comment in the report if this is not possible. In rapidly changing markets, active listing comps should be given equal or greater weight than sold comps in your analysis.

Standard Instructions:

1. Clear Capital Code Of Conduct - Please make sure that you are always abiding by the Clear Capital Code of Conduct when completing valuation reports.
2. If the subject is currently listed, please consider all available information pertaining to the subject's condition. This information should be utilized when developing the assumption of the subject's condition.
3. Use the subject characteristics provided in the report Grid (if preloaded) to evaluate the property. This information is from a full interior appraisal and is assumed to be most accurate. If your inspection reveals obvious inaccuracies, please explain in the narrative of the report.
4. Include sufficient detail to help our mutual customer gain a complete understanding of the subject's neighborhood such as neighborhood desirability, amenities, parks, schools, commercial or industrial influences, REO activity, traffic, board-up-homes, etc.
5. Do not approach occupants or owners.
6. If the subject is a Commercial property, contact Clear Capital immediately at 530-582-5011 for direction on how to proceed with the report.
7. Please do not accept if you or your office has completed a report on this property in the last month, are currently listing this property, or have any vested interest in the subject property.
8. Clear Capital does not allow any log ins from IP addresses from foreign countries. This includes, but is not limited to; data entry services, form completion services, etc. Also, it is against Clear Capital code of conduct to share your password with anyone who is not a W2 employee in your office.
9. Clear Capital and our mutual customers greatly appreciate your expertise. If you cannot personally inspect the property, select comparables, and determine a price for the subject, please do not accept this report. Per the standards and guidelines adopted by Clear Capital and other industry leaders, the use of assistants to complete any of the aforementioned tasks is not permitted.

Report Instructions - cont.

Due to the importance of an independent opinion of price, please do not discuss your price with anyone or be influenced by list price, pending offers, accept comp packets, repair estimates or the listing agent's opinion.

1. One current, original photo of the front of the subject 2. One address verification photo 3. One street scene photo looking down the street 4. MLS listing and sold comp photos required, please comment if no MLS.

Broker Information

Broker Name	Greg Wright	Company/Brokerage	Nick McLean Real Estate Group
License No	8301	Address	580 7th St. NE East Wenatchee WA 98802
License Expiration	01/07/2023	License State	WA
Phone	5096797800	Email	gwag2001@yahoo.com
Broker Distance to Subject	46.68 miles	Date Signed	01/20/2021

By confirming the above contact and real estate license information and submitting the report, the above signed hereby certifies and agrees that: 1) I personally took the pictures, selected comparables, and determined the price conclusion. 2) To the best of my knowledge, the statements of fact contained in this report are true and correct. 3) The reported analyses, opinions, and conclusions are my personal, impartial, and unbiased professional analyses, opinions, and conclusions. 4) I have no present or prospective interest in the property that is the subject of this report and no personal interest with respect to the parties involved. 5) I have no bias with respect to the property that is the subject of this report or to the parties involved with this assignment. 6) My compensation for completing this assignment is not contingent upon the development or reporting of a predetermined price point. 7) I did not base, either partially or completely, my analysis and/or opinion and conclusions in this report on race, color, religion, sex, age, marital status, handicap, familial status, or national origin of either the prospective owners or occupants of the subject property or of the present owners or occupants of the properties in the vicinity of the subject property or on any other basis prohibited by law. 8) I maintain errors and omissions insurance, to the extent required by state law, for all liability associated with the preparation of this Report.

Disclaimer

If this report is developed as a brokers price opinion, this brokers price opinion is not an appraisal as defined in chapter 18.140 RCW and has been prepared by a real estate licensee, licensed under chapter 18.85 RCW, who IS/IS NOT also state-certified or state-licensed as a real estate appraiser under chapter 18.140 RCW.

If this report is developed as an Evaluation, this Evaluation is not an appraisal as defined in chapter 18.140 RCW and has been prepared by a real estate licensee, licensed under chapter 18.85 RCW who IS/IS NOT also state-certified or state-licensed as a real estate appraiser under chapter 18.140 RCW.

Unless otherwise specifically agreed to in writing:

The intended purpose of this report is to assist the Clear Capital account holder in making decisions within the scope of applicable statutory and regulatory requirements and performing required due diligence. This document is provided solely for the use of the Clear Capital account holder and not any other party, is not intended as any guarantee of value and/or condition of the subject property and should not be relied on as such. In the event that this document is found to be defective, incorrect, negligently prepared or unfit for its authorized use, Clear Capital's sole liability shall be to promptly refund the total fee expended by the account holder for this report or to replace it at no charge to the account holder, but in no event shall Clear Capital be responsible to the account holder for any indirect or consequential damages whatsoever. This warranty is in lieu of all other warranties, express or implied, except where otherwise required by law. The account holder shall notify Clear Capital within thirty (30) days of this report's delivery to the account holder if it believes that this document is defective, incorrect, negligently prepared or unfit for its authorized use. Under no circumstances may Clear Capital forms or their contents be published, copied, replicated, or mimicked.