

Please Note: This report was completed with the following assumptions: Market Approach: **Fair Market Price** , Marketing Time: **Typical** . Important additional information relating to this report, including use and restrictions, is contained in an attached addendum which is an integral part of this report.

Address	2405 Skylark Drive, Arlington, TX 76010	Order ID	7180872	Property ID	29834622
Inspection Date	03/19/2021	Date of Report	03/22/2021		
Loan Number	43785	APN	00364258		
Borrower Name	Catamount Properties 2018 LLC	County	Tarrant		

Tracking IDs

Order Tracking ID	0319BPO	Tracking ID 1	0319BPO
Tracking ID 2	--	Tracking ID 3	--

General Conditions

Owner	PACK FINANCIAL SERVICES LLC	Condition Comments	
R. E. Taxes	\$4,868	Subject appears in average condition structurally from what is visible on the exterior. No damage or defect observed with only wear and tear showing on the exterior; Roof appears intact and free from damage; The landscaping is in need of some general maintenance and care; Appears to conform with the other properties located on the block;	
Assessed Value	\$187,391		
Zoning Classification	Residential		
Property Type	SFR		
Occupancy	Occupied		
Ownership Type	Fee Simple		
Property Condition	Average		
Estimated Exterior Repair Cost	\$0		
Estimated Interior Repair Cost	\$0		
Total Estimated Repair	\$0		
HOA	No		
Visible From Street	Visible		
Road Type	Public		

Neighborhood & Market Data

Location Type	Suburban	Neighborhood Comments	
Local Economy	Stable	Older neighborhood located in one of the more mature parts of the of the city; A number of large trees line the street adding some character and desirability; Properties confirm reasonably well to each other with some showing larger than normal amounts of wear versus other properties in the area; The signs of neglect are visible in many areas of the subdivision; Area contains places of worship, schools, parks and small retail with access to highways and shopping;	
Sales Prices in this Neighborhood	Low: \$124080 High: \$229999		
Market for this type of property	Decreased 4 % in the past 6 months.		
Normal Marketing Days	<30		

Current Listings

	Subject	Listing 1 *	Listing 2	Listing 3
Street Address	2405 Skylark Drive	2906 Leigh Ann Ln	1415 Carswell Terrace	2316 Stonegate St
City, State	Arlington, TX	Arlington, TX	Arlington, TX	Arlington, TX
Zip Code	76010	76010	76010	76010
Datasource	MLS	MLS	MLS	MLS
Miles to Subj.	--	0.87 ¹	1.58 ¹	0.15 ¹
Property Type	SFR	SFR	SFR	SFR
Original List Price \$	\$	\$210,000	\$219,900	\$252,900
List Price \$	--	\$210,000	\$224,900	\$252,900
Original List Date		01/26/2021	02/14/2021	02/03/2021
DOM · Cumulative DOM	-- · --	53 · 55	15 · 36	45 · 47
Age (# of years)	60	52	68	56
Condition	Average	Average	Good	Good
Sales Type	--	Fair Market Value	Fair Market Value	Fair Market Value
Location	Neutral ; Residential	Neutral ; Residential	Neutral ; Residential	Neutral ; Residential
View	Neutral ; Residential	Neutral ; Residential	Neutral ; Residential	Neutral ; Residential
Style/Design	1 Story Traditional	1 Story Traditional	1 Story Traditional	2 Stories Traditional
# Units	1	1	1	1
Living Sq. Feet	1,953	1,714	1,884	1,974
Bdrm · Bths · ½ Bths	3 · 2	3 · 2	4 · 2	4 · 2 · 1
Total Room #	10	7	8	10
Garage (Style/Stalls)	None	Carport 2 Car(s)	Attached 1 Car	None
Basement (Yes/No)	No	No	No	No
Basement (% Fin)	0%	0%	0%	0%
Basement Sq. Ft.	--	--	--	--
Pool/Spa	Pool - Yes	--	--	--
Lot Size	0.21 acres	0.17 acres	.199 acres	0.18 acres
Other	--	--	--	--

* Listing 1 is the most comparable listing to the subject.

¹ Comp's "Miles to Subject" was calculated by the system.

² Comp's "Miles to Subject" provided by Real Estate Professional.

³ Subject \$/ft based upon as-is sale price.

Listing Comments Why the comparable listing is superior or inferior to the subject.

Listing 1 Listing is the most comparable in age, number of rooms, and size; Dissimilar in garage type and square footage;

Listing 2 Listing is the most comparable in views, build quality, size and number of rooms; Dissimilar in condition, bedroom count and garage capacity;

Listing 3 Listing is the most comparable in size, number of rooms, amenities, build quality and location; Dissimilar in condition, bed/bathroom count and garage type;

Recent Sales

	Subject	Sold 1 *	Sold 2	Sold 3
Street Address	2405 Skylark Drive	2102 Reeve St	2216 Reeve St	2105 Barton Drive
City, State	Arlington, TX	Arlington, TX	Arlington, TX	Arlington, TX
Zip Code	76010	76010	76010	76010
Datasource	MLS	MLS	MLS	MLS
Miles to Subj.	--	0.49 ¹	0.26 ¹	0.61 ¹
Property Type	SFR	SFR	SFR	SFR
Original List Price \$	--	\$200,000	\$184,900	\$200,000
List Price \$	--	\$160,000	\$173,000	\$213,000
Sale Price \$	--	\$160,000	\$173,000	\$213,000
Type of Financing	--	Fha	Conv	Fha
Date of Sale	--	12/11/2020	09/11/2020	02/05/2021
DOM · Cumulative DOM	-- · --	118 · 118	111 · 111	2 · 25
Age (# of years)	60	66	58	56
Condition	Average	Average	Average	Good
Sales Type	--	Fair Market Value	Fair Market Value	Fair Market Value
Location	Neutral ; Residential	Neutral ; Residential	Neutral ; Residential	Neutral ; Residential
View	Neutral ; Residential	Neutral ; Residential	Neutral ; Residential	Neutral ; Residential
Style/Design	1 Story Traditional	1 Story Traditional	1 Story Traditional	1 Story Traditional
# Units	1	1	1	1
Living Sq. Feet	1,953	1,746	1,770	2,158
Bdrm · Bths · ½ Bths	3 · 2	4 · 2	3 · 2	4 · 2
Total Room #	10	8	10	10
Garage (Style/Stalls)	None	None	Attached 2 Car(s)	Carport 2 Car(s)
Basement (Yes/No)	No	No	No	No
Basement (% Fin)	0%	0%	0%	0%
Basement Sq. Ft.	--	--	--	--
Pool/Spa	Pool - Yes	--	--	--
Lot Size	0.21 acres	0.18 acres	0.18 acres	.212 acres
Other	--	--	--	--
Net Adjustment	--	+\$13,000	+\$11,000	-\$15,000
Adjusted Price	--	\$173,000	\$184,000	\$198,000

* Sold 1 is the most comparable sale to the subject.

¹ Comp's "Miles to Subject" was calculated by the system.

² Comp's "Miles to Subject" provided by Real Estate Professional.

³ Subject \$/ft based upon as-is sale price.

Recent Sales - Cont.

Reasons for Adjustments Why the comparable sale is superior or inferior to the subject.

- Sold 1** Listing is the most comparable in location, age, number of rooms, size and build quality; Adjustments for dissimilar amenities, square footage, garage type and bedroom count;
- Sold 2** Listing is the most comparable in size, number of rooms, age and build quality; Adjustments for dissimilar bed/bathroom count and amenities;
- Sold 3** Listing is the most comparable in construction quality, age, number of rooms and size; Adjustments for dissimilar bedroom count, garage type, square footage and additional amenities;

Subject Sales & Listing History

Current Listing Status	Not Currently Listed			Listing History Comments			
Listing Agency/Firm				Subject was listed and sold in 2012 at fair market with no unusual activity noted.			
Listing Agent Name							
Listing Agent Phone							
# of Removed Listings in Previous 12 Months	0						
# of Sales in Previous 12 Months	0						
Original List Date	Original List Price	Final List Date	Final List Price	Result	Result Date	Result Price	Source

Marketing Strategy

	As Is Price	Repaired Price
Suggested List Price	\$185,000	\$185,000
Sales Price	\$175,000	\$175,000
30 Day Price	\$169,000	--
Comments Regarding Pricing Strategy		
<p>Many of the comparable listings in this area have either gone through recent updates or a complete remodel. This has created a wider than typical range in pricing. Values have been adjusted as appropriate based on differences in condition or amenities. The value conclusion is based on an calculated weighting of both the sold and active listings with greatest weight placed on those listings closest in condition and square footage. The sold comparable listings moved off the market below what is typical for this area which allowed the final pricing for the subject to be set aggressively to encourage the desired marketing period for a fair market value as requested in this report.</p>		

Clear Capital Quality Assurance Comments Addendum

Reviewer's Notes The broker's as-is conclusion reflects the market for the subject. Comps are within a reasonable distance, relatively current, and accurately reflect the subject's defining characteristics. Thus, the as-is conclusion appears to be adequately supported.

Subject Photos



Front



Address Verification



Street

Listing Photos

L1 2906 Leigh Ann Ln
Arlington, TX 76010



Front

L2 1415 Carswell Terrace
Arlington, TX 76010



Front

L3 2316 Stonegate St
Arlington, TX 76010



Front

Sales Photos

S1 2102 Reeve St
Arlington, TX 76010



Front

S2 2216 Reeve St
Arlington, TX 76010



Front

S3 2105 Barton Drive
Arlington, TX 76010



Front

ClearMaps Addendum

Address ★ 2405 Skylark Drive, Arlington, TX 76010

Loan Number 43785

Suggested List \$185,000

Suggested Repaired \$185,000

Sale \$175,000

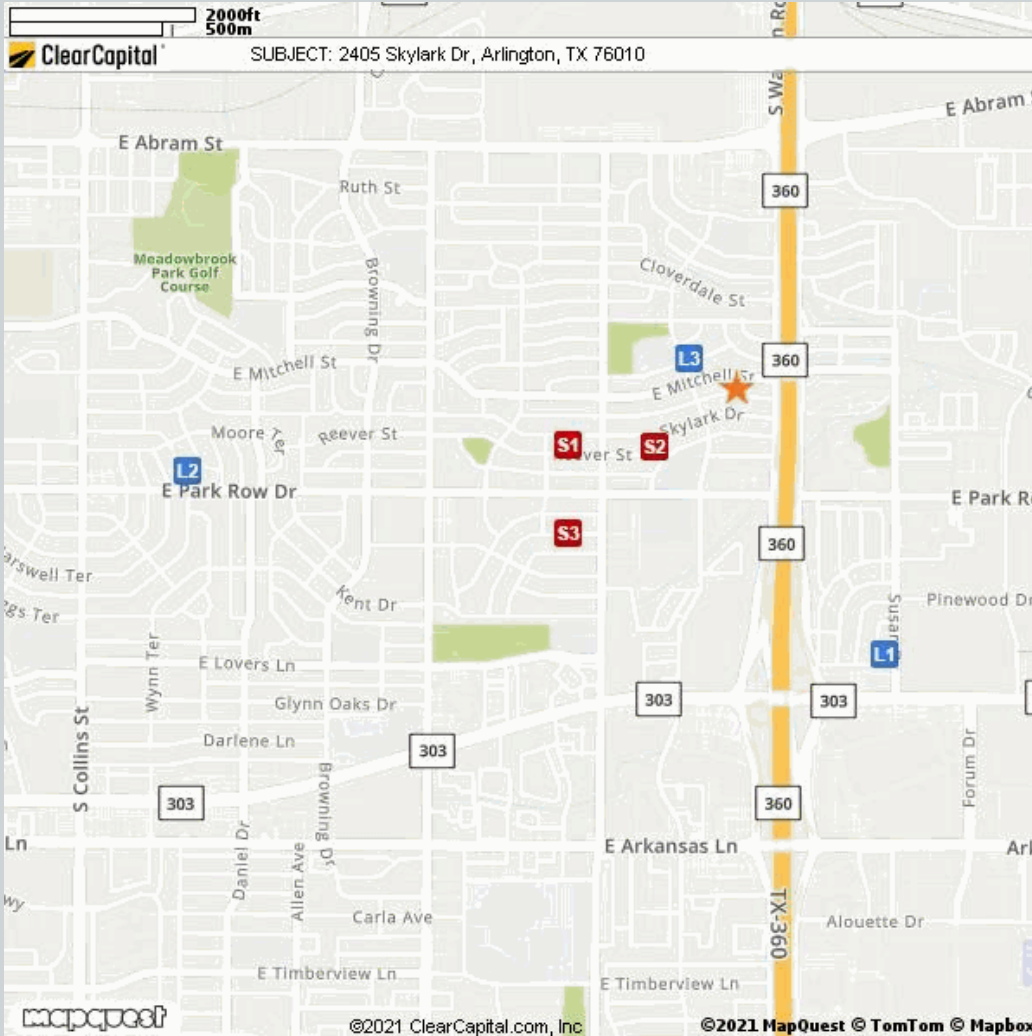

Comparable	Address	Miles to Subject	Mapping Accuracy
★ Subject	2405 Skylark Drive, Arlington, TX 76010	--	Parcel Match
L1	2906 Leigh Ann Ln, Arlington, TX 76010	0.87 Miles ¹	Parcel Match
L2	1415 Carswell Terrace, Arlington, TX 76010	1.58 Miles ¹	Parcel Match
L3	2316 Stonegate St, Arlington, TX 76010	0.15 Miles ¹	Parcel Match
S1	2102 Reever St, Arlington, TX 76010	0.49 Miles ¹	Parcel Match
S2	2216 Reever St, Arlington, TX 76010	0.26 Miles ¹	Parcel Match
S3	2105 Barton Drive, Arlington, TX 76010	0.61 Miles ¹	Parcel Match

¹ The Comparable "Distance from Subject" value has been calculated by the Clear Capital system.

² The Comparable "Distance from Subject" value has been provided by the Real Estate Professional.

Addendum: Report Purpose

Market Approach and Market Time

The Market Approach of this report, as established by the customer, is: **Fair Market Price**. (See definition below.)

The Marketing Time as specified by the customer is **Typical**. (See definition below.)

Definitions:

Fair Market Price

A price at which the property would sell between a willing buyer and a willing seller neither being compelled by undue pressure and both having reasonable knowledge of relevant facts.

Distressed Price

A price at which the property would sell between a willing buyer and a seller acting under duress.

Marketing Time

The amount of time the property is exposed to a pool of prospective buyers before going into contract. The customer either specifies the number of days, requests a marketing time that is typical to the subject's market area and/or requests an abbreviated marketing time.

Typical for Local Market

The estimated time required to adequately expose the subject property to the market resulting in a contract of sale.

Addendum: Report Purpose - cont.

Report Instructions

This section shows the instructions that were approved by the customer and provided to the broker prior to completing the report.

Instructions last updated: 7/17/2017

Purpose:

Please determine a fair market price for this property at which it would sell in a typical marketing time for the area.

Customer Specific Requests:

If the property is commercial or mixed use, please stop and contact Clear Capital as soon as possible

Form Help:

There are blue question marks (?) throughout this form. These are designed to offer guidance for that particular section of the form. Please click on them for help.

Comparable Requirements:

1. Please use fair market comps from the same neighborhood, block or subdivision whenever possible.
2. Please only use REO comparables if the market is driven by REOs and they are comparable in characteristics and condition.
3. Please use comps that have closed in the past 3 months to show the current market conditions or comment in the report if this is not possible. In rapidly changing markets, active listing comps should be given equal or greater weight than sold comps in your analysis.

Standard Instructions:

1. Clear Capital Code Of Conduct - Please make sure that you are always abiding by the Clear Capital Code of Conduct when completing valuation reports.
2. If the subject is currently listed, please consider all available information pertaining to the subject's condition. This information should be utilized when developing the assumption of the subject's condition.
3. Use the subject characteristics provided in the report Grid (if preloaded) to evaluate the property. This information is from a full interior appraisal and is assumed to be most accurate. If your inspection reveals obvious inaccuracies, please explain in the narrative of the report.
4. Include sufficient detail to help our mutual customer gain a complete understanding of the subject's neighborhood such as neighborhood desirability, amenities, parks, schools, commercial or industrial influences, REO activity, traffic, board-up-homes, etc.
5. Do not approach occupants or owners.
6. If the subject is a Commercial property, contact Clear Capital immediately at 530-582-5011 for direction on how to proceed with the report.
7. Please do not accept if you or your office has completed a report on this property in the last month, are currently listing this property, or have any vested interest in the subject property.
8. Clear Capital does not allow any log ins from IP addresses from foreign countries. This includes, but is not limited to; data entry services, form completion services, etc. Also, it is against Clear Capital code of conduct to share your password with anyone who is not a W2 employee in your office.
9. Clear Capital and our mutual customers greatly appreciate your expertise. If you cannot personally inspect the property, select comparables, and determine a price for the subject, please do not accept this report. Per the standards and guidelines adopted by Clear Capital and other industry leaders, the use of assistants to complete any of the aforementioned tasks is not permitted.

Report Instructions - cont.

Due to the importance of an independent opinion of price, please do not discuss your price with anyone or be influenced by list price, pending offers, accept comp packets, repair estimates or the listing agent's opinion.

1. One current, original photo of the front of the subject 2. One address verification photo 3. One street scene photo looking down the street 4. MLS listing and sold comp photos required, please comment if no MLS.

Broker Information

Broker Name	LaToya Flanigan	Company/Brokerage	Avid Real Estate, LLC
License No	533322	Address	1806 Park Highland Way arlington TX 76012
License Expiration	06/30/2022	License State	TX
Phone	8173718692	Email	support@myavidre.com
Broker Distance to Subject	5.41 miles	Date Signed	03/21/2021

By confirming the above contact and real estate license information and submitting the report, the above signed hereby certifies and agrees that: 1) I personally took the pictures, selected comparables, and determined the price conclusion. 2) To the best of my knowledge, the statements of fact contained in this report are true and correct. 3) The reported analyses, opinions, and conclusions are my personal, impartial, and unbiased professional analyses, opinions, and conclusions. 4) I have no present or prospective interest in the property that is the subject of this report and no personal interest with respect to the parties involved. 5) I have no bias with respect to the property that is the subject of this report or to the parties involved with this assignment. 6) My compensation for completing this assignment is not contingent upon the development or reporting of a predetermined price point. 7) I did not base, either partially or completely, my analysis and/or opinion and conclusions in this report on race, color, religion, sex, age, marital status, handicap, familial status, or national origin of either the prospective owners or occupants of the subject property or of the present owners or occupants of the properties in the vicinity of the subject property or on any other basis prohibited by law. 8) I maintain errors and omissions insurance, to the extent required by state law, for all liability associated with the preparation of this Report.

Disclaimer

THIS REPORT SHOULD NOT BE CONSIDERED AN APPRAISAL. In making any decision that relies upon my work, you should know that I have not followed the guidelines for development of an appraisal or analysis contained in the Uniform Standards of Professional Appraisal Practice of the Appraisal Foundation.

Unless otherwise specifically agreed to in writing:

The intended purpose of this report is to assist the Clear Capital account holder in making decisions within the scope of applicable statutory and regulatory requirements and performing required due diligence. This document is provided solely for the use of the Clear Capital account holder and not any other party, is not intended as any guarantee of value and/or condition of the subject property and should not be relied on as such. In the event that this document is found to be defective, incorrect, negligently prepared or unfit for its authorized use, Clear Capital's sole liability shall be to promptly refund the total fee expended by the account holder for this report or to replace it at no charge to the account holder, but in no event shall Clear Capital be responsible to the account holder for any indirect or consequential damages whatsoever. This warranty is in lieu of all other warranties, express or implied, except where otherwise required by law. The account holder shall notify Clear Capital within thirty (30) days of this report's delivery to the account holder if it believes that this document is defective, incorrect, negligently prepared or unfit for its authorized use. Under no circumstances may Clear Capital forms or their contents be published, copied, replicated, or mimicked.