

Please Note: This report was completed with the following assumptions: Market Approach: **Fair Market Price** , Marketing Time: **Typical** . Important additional information relating to this report, including use and restrictions, is contained in an attached addendum which is an integral part of this report.

Address	4401 Kinglet Street, Houston, TX 77035	Order ID	7317957	Property ID	30373691
Inspection Date	05/25/2021	Date of Report	05/25/2021		
Loan Number	44808	APN	0834420000008		
Borrower Name	Hollyvale Rental Holdings LLC	County	Harris		

Tracking IDs					
Order Tracking ID	0524BPO_Citi	Tracking ID 1	0524BPO_Citi		
Tracking ID 2	--	Tracking ID 3	--		

General Conditions		Condition Comments
Owner	OCAMPO, R	Subject needs siding repair, exterior painting and a roof inspection No other adverse conditions noted at time of exterior inspection
R. E. Taxes	\$30,800	
Assessed Value	\$231,242	
Zoning Classification	Residential	
Property Type	SFR	
Occupancy	Occupied	
Ownership Type	Fee Simple	
Property Condition	Good	
Estimated Exterior Repair Cost	\$2,000	
Estimated Interior Repair Cost	\$0	
Total Estimated Repair	\$2,000	
HOA	No	
Visible From Street	Visible	
Road Type	Public	

Neighborhood & Market Data		Neighborhood Comments
Location Type	Urban	Many homes in area are maintained and landscaped Close proximity to schools, places of worship and medical center There are absolutely no comps in the immediate neighborhood and/or general area; forced to extend search pass lot size range, GLA, age, among diverse style homes and 1 mile due to lack of; please be advised that there were absolutely no listing comps in area; forced to extend search pass 1 mile to find any comps at all
Local Economy	Stable	
Sales Prices in this Neighborhood	Low: \$247,270 High: \$275,000	
Market for this type of property	Remained Stable for the past 6 months.	
Normal Marketing Days	<90	

Current Listings

	Subject	Listing 1	Listing 2	Listing 3 *
Street Address	4401 Kinglet Street	9822 Bassoon	4154 Sarong	4423 Benning
City, State	Houston, TX	Houston, TX	Houston, TX	Houston, TX
Zip Code	77035	77025	77025	77035
Datasource	Public Records	MLS	MLS	MLS
Miles to Subj.	--	1.08 ¹	1.23 ¹	0.28 ¹
Property Type	SFR	SFR	SFR	SFR
Original List Price \$	\$	\$279,000	\$289,000	\$300,000
List Price \$	--	\$270,000	\$289,000	\$290,000
Original List Date		05/01/2021	05/20/2021	04/12/2021
DOM · Cumulative DOM	-- · --	24 · 24	5 · 5	43 · 43
Age (# of years)	63	66	67	66
Condition	Good	Good	Good	Good
Sales Type	--	Fair Market Value	Fair Market Value	Fair Market Value
Location	Neutral ; Residential	Neutral ; Residential	Neutral ; Residential	Neutral ; Residential
View	Neutral ; Residential	Neutral ; Residential	Neutral ; Residential	Neutral ; Residential
Style/Design	1 Story Traditional	1 Story Traditional	1 Story Traditional	1 Story Traditional
# Units	1	1	1	1
Living Sq. Feet	1,731	1,379	1,467	1,800
Bdrm · Bths · ½ Bths	3 · 2	3 · 2	3 · 2	3 · 2
Total Room #	9	9	9	9
Garage (Style/Stalls)	Attached 2 Car(s)	Detached 2 Car(s)	Attached 1 Car	Attached 1 Car
Basement (Yes/No)	No	No	No	No
Basement (% Fin)	0%	0%	0%	0%
Basement Sq. Ft.	--	--	--	--
Pool/Spa	--	--	--	--
Lot Size	0.18 acres	0.18 acres	0.17 acres	0.16 acres
Other	--	--	--	--

* Listing 3 is the most comparable listing to the subject.

¹ Comp's "Miles to Subject" was calculated by the system.

² Comp's "Miles to Subject" provided by Real Estate Professional.

³ Subject \$/ft based upon as-is sale price.

Current Listings - Cont.

Listing Comments Why the comparable listing is superior or inferior to the subject.

- Listing 1** Smaller in GLA, closer in lot size Best comps used There are absolutely no comps in the immediate neighborhood and/or general area; forced to extend search pass lot size range, GLA, age, among diverse style homes and 1 mile due to lack of; please be advised that there were absolutely no listing comps in area; forced to extend search pass 1 mile to find any comps at all
- Listing 2** Smaller in GLA, smaller in lot size Best comps used There are absolutely no comps in the immediate neighborhood and/or general area; forced to extend search pass lot size range, GLA, age, among diverse style homes and 1 mile due to lack of; please be advised that there were absolutely no listing comps in area; forced to extend search pass 1 mile to find any comps at all
- Listing 3** Close in GLA, smaller in lot size Best comps used There are absolutely no comps in the immediate neighborhood and/or general area; forced to extend search pass lot size range, GLA, age, among diverse style homes and 1 mile due to lack of; please be advised that there were absolutely no listing comps in area; forced to extend search pass 1 mile to find any comps at all

Recent Sales

	Subject	Sold 1	Sold 2	Sold 3 *
Street Address	4401 Kinglet Street	4838 Kinglet	4817 Kinglet	4321 Kingfisher
City, State	Houston, TX	Houston, TX	Houston, TX	Houston, TX
Zip Code	77035	77035	77035	77035
Datasource	Public Records	MLS	MLS	MLS
Miles to Subj.	--	0.66 ¹	0.62 ¹	0.11 ¹
Property Type	SFR	SFR	SFR	SFR
Original List Price \$	--	\$250,000	\$267,000	\$279,000
List Price \$	--	\$250,000	\$267,000	\$279,000
Sale Price \$	--	\$247,270	\$267,500	\$275,000
Type of Financing	--	Fha	Unknown	Cash Sale
Date of Sale	--	11/25/2020	05/07/2021	03/31/2021
DOM · Cumulative DOM	-- · --	20 · 56	122 · 145	2 · 22
Age (# of years)	63	66	66	57
Condition	Good	Good	Good	Good
Sales Type	--	Fair Market Value	Fair Market Value	Fair Market Value
Location	Neutral ; Residential	Neutral ; Residential	Neutral ; Residential	Neutral ; Residential
View	Neutral ; Residential	Neutral ; Residential	Neutral ; Residential	Neutral ; Residential
Style/Design	1 Story Traditional	1 Story Traditional	1 Story Traditional	1 Story Traditional
# Units	1	1	1	1
Living Sq. Feet	1,731	1,302	1,370	1,838
Bdrm · Bths · ½ Bths	3 · 2	3 · 2	3 · 2	3 · 2
Total Room #	9	9	9	9
Garage (Style/Stalls)	Attached 2 Car(s)	Detached 1 Car	Attached 2 Car(s)	Detached 2 Car(s)
Basement (Yes/No)	No	No	No	No
Basement (% Fin)	0%	0%	0%	0%
Basement Sq. Ft.	--	--	--	--
Pool/Spa	--	--	--	--
Lot Size	0.18 acres	0.25 acres	0.17 acres	0.18 acres
Other	--	--	--	--
Net Adjustment	--	-\$500	+\$4,000	-\$2,000
Adjusted Price	--	\$246,770	\$271,500	\$273,000

* Sold 3 is the most comparable sale to the subject.

¹ Comp's "Miles to Subject" was calculated by the system.

² Comp's "Miles to Subject" provided by Real Estate Professional.

³ Subject \$/ft based upon as-is sale price.

Recent Sales - Cont.

Reasons for Adjustments Why the comparable sale is superior or inferior to the subject.

- Sold 1** Smaller in GLA, greater in lot size Best comps used There are absolutely no comps in the immediate neighborhood and/or general area; forced to extend search pass lot size range, GLA, age, among diverse style homes and 1 mile due to lack of; please be advised that there were absolutely no listing comps in area; forced to extend search pass 1 mile to find any comps at all
- Sold 2** Smaller in GLA, closer in lot size Best comps used There are absolutely no comps in the immediate neighborhood and/or general area; forced to extend search pass lot size range, GLA, age, among diverse style homes and 1 mile due to lack of; please be advised that there were absolutely no listing comps in area; forced to extend search pass 1 mile to find any comps at all
- Sold 3** Close in GLA, greater in lot size Best comps used There are absolutely no comps in the immediate neighborhood and/or general area; forced to extend search pass lot size range, GLA, age, among diverse style homes and 1 mile due to lack of; please be advised that there were absolutely no listing comps in area; forced to extend search pass 1 mile to find any comps at all

Subject Sales & Listing History

Current Listing Status	Not Currently Listed			Listing History Comments			
Listing Agency/Firm				There is no evidence of the subject being listed on the market within the last 12 months			
Listing Agent Name							
Listing Agent Phone							
# of Removed Listings in Previous 12 Months	0						
# of Sales in Previous 12 Months	0						
Original List Date	Original List Price	Final List Date	Final List Price	Result	Result Date	Result Price	Source

Marketing Strategy

	As Is Price	Repaired Price
Suggested List Price	\$274,000	\$276,000
Sales Price	\$272,000	\$274,000
30 Day Price	\$265,000	--
Comments Regarding Pricing Strategy		
Pricing stayed within sold comp range; there are absolutely no comps in the immediate neighborhood and/or general area; forced to extend search pass lot size range, GLA, age, among diverse style homes and 1 mile due to lack of; please be advised that there were absolutely no listing comps in area; forced to extend search pass 1 mile to find any comps at all; best comp used		

Clear Capital Quality Assurance Comments Addendum

Reviewer's Notes The broker's as-is conclusion reflects the market for the subject. Comps are within a reasonable distance, relatively current, and accurately reflect the subject's defining characteristics. Thus, the as-is conclusion appears to be adequately supported.

Subject Photos



Front



Front



Front



Address Verification

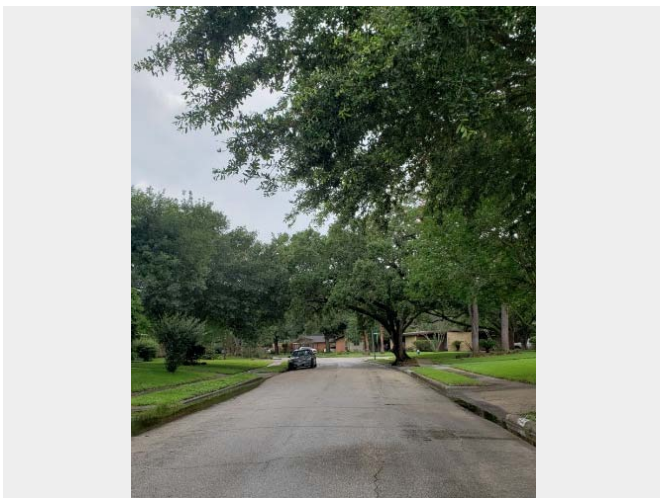

Street



Other

Listing Photos

L1 9822 Bassoon
Houston, TX 77025



Front

L2 4154 Sarong
Houston, TX 77025



Front

L3 4423 Benning
Houston, TX 77035



Front

Sales Photos

S1 4838 Kinglet
Houston, TX 77035



Front

S2 4817 Kinglet
Houston, TX 77035



Front

S3 4321 Kingfisher
Houston, TX 77035



Front

ClearMaps Addendum

Address ★ 4401 Kinglet Street, Houston, TX 77035

Loan Number 44808

Suggested List \$274,000

Suggested Repaired \$276,000

Sale \$272,000

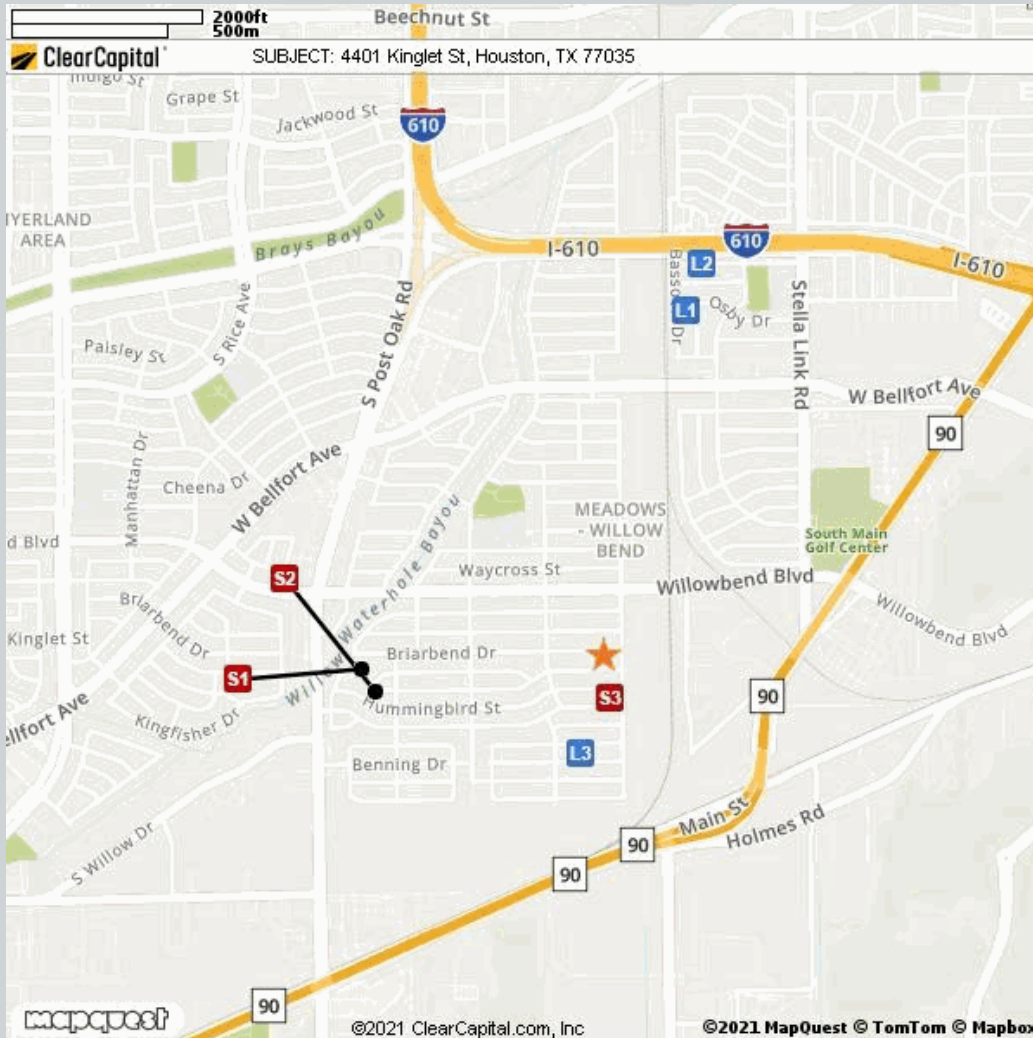

Comparable

Address

Miles to Subject

Mapping Accuracy

Comparable	Address	Miles to Subject	Mapping Accuracy
★ Subject	4401 Kinglet Street, Houston, TX 77035	--	Parcel Match
L1 Listing 1	9822 Bassoon, Houston, TX 77025	1.08 Miles ¹	Parcel Match
L2 Listing 2	4154 Sarong, Houston, TX 77025	1.23 Miles ¹	Parcel Match
L3 Listing 3	4423 Benning, Houston, TX 77035	0.28 Miles ¹	Parcel Match
S1 Sold 1	4838 Kinglet, Houston, TX 77035	0.66 Miles ¹	Parcel Match
S2 Sold 2	4817 Kinglet, Houston, TX 77035	0.62 Miles ¹	Parcel Match
S3 Sold 3	4321 Kingfisher, Houston, TX 77035	0.11 Miles ¹	Parcel Match

¹ The Comparable "Distance from Subject" value has been calculated by the Clear Capital system.

² The Comparable "Distance from Subject" value has been provided by the Real Estate Professional.

Addendum: Report Purpose

Market Approach and Market Time

The Market Approach of this report, as established by the customer, is: **Fair Market Price**. (See definition below.)

The Marketing Time as specified by the customer is **Typical**. (See definition below.)

Definitions:

Fair Market Price

A price at which the property would sell between a willing buyer and a willing seller neither being compelled by undue pressure and both having reasonable knowledge of relevant facts.

Distressed Price

A price at which the property would sell between a willing buyer and a seller acting under duress.

Marketing Time

The amount of time the property is exposed to a pool of prospective buyers before going into contract. The customer either specifies the number of days, requests a marketing time that is typical to the subject's market area and/or requests an abbreviated marketing time.

Typical for Local Market

The estimated time required to adequately expose the subject property to the market resulting in a contract of sale.

Addendum: Report Purpose - cont.

Report Instructions

This section shows the instructions that were approved by the customer and provided to the broker prior to completing the report.

*** Please Note: This is a RUSH assignment. Do not accept if you cannot meet the current due date and time. Please reference the set terms and contact Clear Capital at 530.582.5011 if you require any changes. Thanks! ***

Instructions last updated: 7/17/2017

Purpose:

Please determine a fair market price for this property at which it would sell in a typical marketing time for the area.

Customer Specific Requests:

If the property is commercial or mixed use, please stop and contact Clear Capital as soon as possible

Form Help:

There are blue question marks (?) throughout this form. These are designed to offer guidance for that particular section of the form. Please click on them for help.

Comparable Requirements:

1. Please use fair market comps from the same neighborhood, block or subdivision whenever possible.
2. Please only use REO comparables if the market is driven by REOs and they are comparable in characteristics and condition.
3. Please use comps that have closed in the past 3 months to show the current market conditions or comment in the report if this is not possible. In rapidly changing markets, active listing comps should be given equal or greater weight than sold comps in your analysis.

Standard Instructions:

1. Clear Capital Code Of Conduct - Please make sure that you are always abiding by the Clear Capital Code of Conduct when completing valuation reports.
2. If the subject is currently listed, please consider all available information pertaining to the subject's condition. This information should be utilized when developing the assumption of the subject's condition.
3. Use the subject characteristics provided in the report Grid (if preloaded) to evaluate the property. This information is from a full interior appraisal and is assumed to be most accurate. If your inspection reveals obvious inaccuracies, please explain in the narrative of the report.
4. Include sufficient detail to help our mutual customer gain a complete understanding of the subject's neighborhood such as neighborhood desirability, amenities, parks, schools, commercial or industrial influences, REO activity, traffic, board-up-homes, etc.
5. Do not approach occupants or owners.
6. If the subject is a Commercial property, contact Clear Capital immediately at 530-582-5011 for direction on how to proceed with the report.
7. Please do not accept if you or your office has completed a report on this property in the last month, are currently listing this property, or have any vested interest in the subject property.
8. Clear Capital does not allow any log ins from IP addresses from foreign countries. This includes, but is not limited to; data entry services, form completion services, etc. Also, it is against Clear Capital code of conduct to share your password with anyone who is not a W2 employee in your office.
9. Clear Capital and our mutual customers greatly appreciate your expertise. If you cannot

Report Instructions - cont.

personally inspect the property, select comparables, and determine a price for the subject, please do not accept this report. Per the standards and guidelines adopted by Clear Capital and other industry leaders, the use of assistants to complete any of the aforementioned tasks is not permitted.

Due to the importance of an independent opinion of price, please do not discuss your price with anyone or be influenced by list price, pending offers, accept comp packets, repair estimates or the listing agent's opinion.

1. One current, original photo of the front of the subject 2. One address verification photo 3. One street scene photo looking down the street 4. MLS listing and sold comp photos required, please comment if no MLS.

Broker Information

Broker Name	Charmetta Harris	Company/Brokerage	Clayton Nash Realty
License No	543659	Address	1106 Creekmont Houston TX 77091
License Expiration	10/31/2021	License State	TX
Phone	7139064252	Email	charmetta@hotmail.com
Broker Distance to Subject	12.67 miles	Date Signed	05/25/2021

By confirming the above contact and real estate license information and submitting the report, the above signed hereby certifies and agrees that: 1) I personally took the pictures, selected comparables, and determined the price conclusion. 2) To the best of my knowledge, the statements of fact contained in this report are true and correct. 3) The reported analyses, opinions, and conclusions are my personal, impartial, and unbiased professional analyses, opinions, and conclusions. 4) I have no present or prospective interest in the property that is the subject of this report and no personal interest with respect to the parties involved. 5) I have no bias with respect to the property that is the subject of this report or to the parties involved with this assignment. 6) My compensation for completing this assignment is not contingent upon the development or reporting of a predetermined price point. 7) I did not base, either partially or completely, my analysis and/or opinion and conclusions in this report on race, color, religion, sex, age, marital status, handicap, familial status, or national origin of either the prospective owners or occupants of the subject property or of the present owners or occupants of the properties in the vicinity of the subject property or on any other basis prohibited by law. 8) I maintain errors and omissions insurance, to the extent required by state law, for all liability associated with the preparation of this Report.

Disclaimer

THIS REPORT SHOULD NOT BE CONSIDERED AN APPRAISAL. In making any decision that relies upon my work, you should know that I have not followed the guidelines for development of an appraisal or analysis contained in the Uniform Standards of Professional Appraisal Practice of the Appraisal Foundation.

Unless otherwise specifically agreed to in writing:

The intended purpose of this report is to assist the Clear Capital account holder in making decisions within the scope of applicable statutory and regulatory requirements and performing required due diligence. This document is provided solely for the use of the Clear Capital account holder and not any other party, is not intended as any guarantee of value and/or condition of the subject property and should not be relied on as such. In the event that this document is found to be defective, incorrect, negligently prepared or unfit for its authorized use, Clear Capital's sole liability shall be to promptly refund the total fee expended by the account holder for this report or to replace it at no charge to the account holder, but in no event shall Clear Capital be responsible to the account holder for any indirect or consequential damages whatsoever. This warranty is in lieu of all other warranties, express or implied, except where otherwise required by law. The account holder shall notify Clear Capital within thirty (30) days of this report's delivery to the account holder if it believes that this document is defective, incorrect, negligently prepared or unfit for its authorized use. Under no circumstances may Clear Capital forms or their contents be published, copied, replicated, or mimicked.