

Please Note: This report was completed with the following assumptions: Market Approach: **Fair Market Price** , Marketing Time: **Typical** . Important additional information relating to this report, including use and restrictions, is contained in an attached addendum which is an integral part of this report.

Address	14203 Wadebridge Way, Houston, TX 77015	Order ID	7449954	Property ID	30689337
Inspection Date	07/21/2021	Date of Report	07/21/2021		
Loan Number	45482	APN	0970230000006		
Borrower Name	Catamount Properties 2018 LLC	County	Harris		

Tracking IDs					
Order Tracking ID	0721BPO_Citi	Tracking ID 1	0721BPO_Citi		
Tracking ID 2	--	Tracking ID 3	--		

General Conditions

Owner	Smith Nancy M Salvaggio	Condition Comments	
R. E. Taxes	\$3,425	The subject property is a 1-story average quality and condition SFR consisting of 3 bedrooms, 2 baths with 1544 sq ft built 1967 and sits on 0.17 acres. The subject is located in a non-gated planned unit development with a homeowner association. The improvement is of modern design/appeal and conforms well to the neighborhood. Minor landscaping is recommended to improve the marketability of the subject property.	
Assessed Value	\$133,894		
Zoning Classification	Residential		
Property Type	SFR		
Occupancy	Occupied		
Ownership Type	Fee Simple		
Property Condition	Average		
Estimated Exterior Repair Cost	\$0		
Estimated Interior Repair Cost	\$0		
Total Estimated Repair	\$0		
HOA	Woodforest Civic--Rivergrove Garden/North Shore 713-453-1503		
Association Fees	\$21 / Month (Landscaping,Insurance,Other: Trash/Street Lights/Security/Newsletter)		
Visible From Street	Visible		
Road Type	Public		

Neighborhood & Market Data

Location Type	Suburban	Neighborhood Comments	
Local Economy	Stable	The subjects neighborhood is typical for Houston and surrounding areas, with schools, shopping centers, places of worship, and employment centers located within proximity. Public transportation, recreational facilities, utilities, city police, and city fire protections are typical for the subjects neighborhood.	
Sales Prices in this Neighborhood	Low: \$90,000 High: \$280,000		
Market for this type of property	Remained Stable for the past 6 months.		
Normal Marketing Days	<30		

Current Listings

	Subject	Listing 1	Listing 2 *	Listing 3
Street Address	14203 Wadebridge Way	14110 Waterville Way	242 Black Rock Rd	14310 Lantern Ln
City, State	Houston, TX	Houston, TX	Houston, TX	Houston, TX
Zip Code	77015	77015	77015	77015
Datasource	Tax Records	MLS	MLS	MLS
Miles to Subj.	--	0.14 ¹	0.39 ¹	0.22 ¹
Property Type	SFR	SFR	SFR	SFR
Original List Price \$	\$	\$177,000	\$185,000	\$225,000
List Price \$	--	\$177,000	\$185,000	\$225,000
Original List Date		05/24/2021	06/24/2021	06/21/2021
DOM · Cumulative DOM	-- · --	18 · 58	27 · 27	3 · 30
Age (# of years)	54	50	51	51
Condition	Average	Average	Average	Good
Sales Type	--	Fair Market Value	Fair Market Value	Fair Market Value
Location	Neutral ; Residential	Neutral ; Residential	Neutral ; Residential	Neutral ; Residential
View	Neutral ; Residential	Neutral ; Residential	Neutral ; Residential	Neutral ; Residential
Style/Design	1 Story Traditional	1 Story Traditional	1 Story Traditional	1 Story Traditional
# Units	1	1	1	1
Living Sq. Feet	1,544	1,714	1,613	1,571
Bdrm · Bths · ½ Bths	3 · 2	3 · 2	3 · 2	4 · 2
Total Room #	6	6	6	8
Garage (Style/Stalls)	Attached 2 Car(s)	Detached 2 Car(s)	Detached 2 Car(s)	Attached 2 Car(s)
Basement (Yes/No)	No	No	No	No
Basement (% Fin)	0%	0%	0%	0%
Basement Sq. Ft.	--	--	--	--
Pool/Spa	--	--	--	Pool - Yes Spa - Yes
Lot Size	0.17 acres	0.21 acres	0.17 acres	0.18 acres
Other	None	None	None	None

* Listing 2 is the most comparable listing to the subject.

¹ Comp's "Miles to Subject" was calculated by the system.

² Comp's "Miles to Subject" provided by Real Estate Professional.

³ Subject \$/ft based upon as-is sale price.

Listing Comments Why the comparable listing is superior or inferior to the subject.

Listing 1 It is inferior because of needing TLC. Overall, similar in design and appeal and has comparable views.

Listing 2 Shows the best support from my value conclusion. Overall, it has the most comparable characteristics.

Listing 3 Represents a pending good condition comp at the upper end of this neighborhood. The subject would compete below this.

Recent Sales

	Subject	Sold 1	Sold 2 *	Sold 3
Street Address	14203 Wadebridge Way	434 Castlebar Ct	14218 Woodforest Blvd	13930 Lantern Ln
City, State	Houston, TX	Houston, TX	Houston, TX	Houston, TX
Zip Code	77015	77015	77015	77015
Datasource	Tax Records	MLS	MLS	MLS
Miles to Subj.	--	0.17 ¹	0.17 ¹	0.29 ¹
Property Type	SFR	SFR	SFR	SFR
Original List Price \$	--	\$145,000	\$178,000	\$199,000
List Price \$	--	\$145,000	\$178,000	\$199,000
Sale Price \$	--	\$155,000	\$180,000	\$209,500
Type of Financing	--	Conventional	Fha	Fha
Date of Sale	--	06/15/2021	05/14/2021	06/07/2021
DOM · Cumulative DOM	-- · --	11 · 32	4 · 43	6 · 54
Age (# of years)	54	57	57	50
Condition	Average	Average	Average	Good
Sales Type	--	Fair Market Value	Fair Market Value	Fair Market Value
Location	Neutral ; Residential	Neutral ; Residential	Neutral ; Residential	Neutral ; Residential
View	Neutral ; Residential	Neutral ; Residential	Neutral ; Residential	Neutral ; Residential
Style/Design	1 Story Traditional	1 Story Traditional	2 Stories Traditional	1 Story Traditional
# Units	1	1	1	1
Living Sq. Feet	1,544	1,657	1,411	1,624
Bdrm · Bths · ½ Bths	3 · 2	3 · 2	3 · 2	3 · 2
Total Room #	6	6	6	6
Garage (Style/Stalls)	Attached 2 Car(s)	Attached 2 Car(s)	Attached 2 Car(s)	Attached 2 Car(s)
Basement (Yes/No)	No	No	No	No
Basement (% Fin)	0%	0%	0%	0%
Basement Sq. Ft.	--	--	--	--
Pool/Spa	--	--	--	--
Lot Size	0.17 acres	0.19 acres	0.19 acres	0.18 acres
Other	None	None	None	None
Net Adjustment	--	+\$8,221	-\$7,856	-\$27,171
Adjusted Price	--	\$163,221	\$172,144	\$182,329

* Sold 2 is the most comparable sale to the subject.

¹ Comp's "Miles to Subject" was calculated by the system.

² Comp's "Miles to Subject" provided by Real Estate Professional.

³ Subject \$/ft based upon as-is sale price.

Recent Sales - Cont.

Reasons for Adjustments Why the comparable sale is superior or inferior to the subject.

- Sold 1** It is inferior because of being an older building and needing TLC. Overall, similar in design and appeal and has comparable views. Adjustments: -\$1695 due to sq ft, -\$684 due to the lot, \$600 due to age, \$10,000 due to needing TLC.
- Sold 2** Shows the best support from my value conclusion. Overall, it has the most comparable characteristics and most importantly the most similar location/view which is one of the biggest factors with the subject. Adjustments: \$1995 due to sq ft, -\$451 due to the lot, \$600 due to age, -\$10,000 due to updates.
- Sold 3** It also has the same view as the subject, but its larger GLA, being a newer building and having updates make this superior to the subject. Therefore my value conclusion most aligns with Sale 2. Adjustments: -\$1200 due to sq ft, -\$171 due to lot, -\$800 due to age, -\$25,000 due to updates.

Subject Sales & Listing History

Current Listing Status	Not Currently Listed	Listing History Comments					
Listing Agency/Firm		Historical transaction data is not available. No history found on MLS, Tax, or County Records.					
Listing Agent Name							
Listing Agent Phone							
# of Removed Listings in Previous 12 Months	0						
# of Sales in Previous 12 Months	0						
Original List Date	Original List Price	Final List Date	Final List Price	Result	Result Date	Result Price	Source

Marketing Strategy

	As Is Price	Repaired Price
Suggested List Price	\$182,000	\$182,000
Sales Price	\$172,000	\$172,000
30 Day Price	\$162,000	--
Comments Regarding Pricing Strategy		
<p>Listing: MLS# 6734828/ 14106 Foxford Way was considered but is a foreclosure. The comps below were considered but because they reflected a value very different than the rest of my comps, they were replaced with comps that better supported the market and my final value conclusion. Listing: MLS# 59072503/ 435 Castlebar Listing: MLS# 4752495/ 14007 Oak Leaf Note: Commercial Influences, freeway, open spaces, and busy roads in the immediate vicinity of the subject will not negatively influence the marketability and value of the property. Upon review of all the pertinent information, an opinion of the as-is market value of \$172,000 is adequately supported with emphasis placed on List No. 2 and Sale No. 2. Based upon an exterior inspection, from the street, the subject property has no observable adverse condition noted that would cause a safety or health risk/concern at the time of inspection. Therefore no resale issues are foreseen.</p>		

Clear Capital Quality Assurance Comments Addendum

Reviewer's The broker's as-is conclusion reflects the market for the subject. Comps are within a reasonable distance, relatively current, and accurately reflect
Notes the subject's defining characteristics. Thus, the as-is conclusion appears to be adequately supported.

Subject Photos



Front



Address Verification



Street

Listing Photos

L1 14110 Waterville Way
Houston, TX 77015



Front

L2 242 Black Rock Rd
Houston, TX 77015



Front

L3 14310 Lantern Ln
Houston, TX 77015



Front

Sales Photos

S1 434 Castlebar Ct
Houston, TX 77015



Front

S2 14218 Woodforest Blvd
Houston, TX 77015



Front

S3 13930 Lantern Ln
Houston, TX 77015



Front

ClearMaps Addendum

Address ★ 14203 Wadebridge Way, Houston, TX 77015

Loan Number 45482

Suggested List \$182,000

Suggested Repaired \$182,000

Sale \$172,000

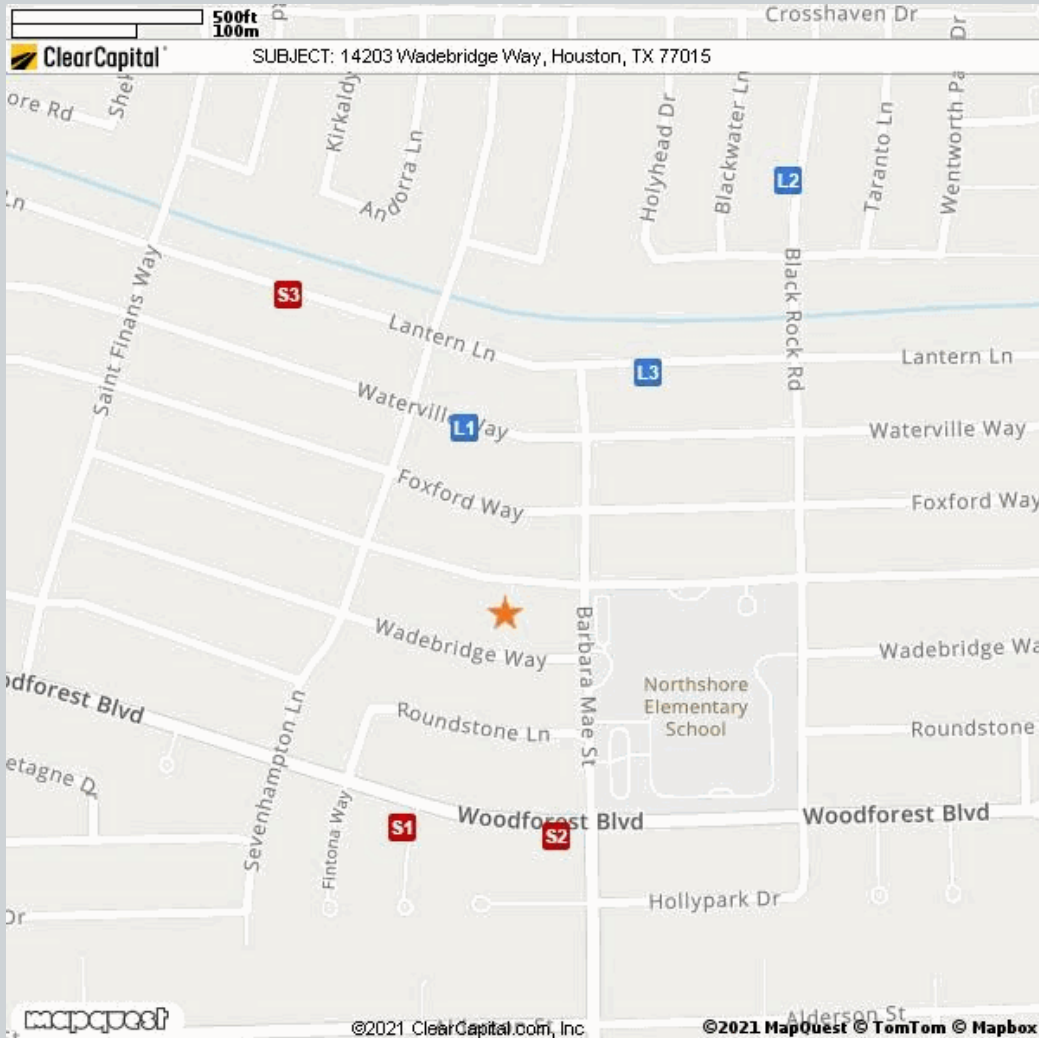

Comparable	Address	Miles to Subject	Mapping Accuracy
★ Subject	14203 Wadebridge Way, Houston, Tx 77015	--	Parcel Match
L1 Listing 1	14110 Waterville Way, Houston, TX 77015	0.14 Miles ¹	Parcel Match
L2 Listing 2	242 Black Rock Rd, Houston, TX 77015	0.39 Miles ¹	Parcel Match
L3 Listing 3	14310 Lantern Ln, Houston, TX 77015	0.22 Miles ¹	Parcel Match
S1 Sold 1	434 Castlebar Ct, Houston, TX 77015	0.17 Miles ¹	Parcel Match
S2 Sold 2	14218 Woodforest Blvd, Houston, TX 77015	0.17 Miles ¹	Parcel Match
S3 Sold 3	13930 Lantern Ln, Houston, TX 77015	0.29 Miles ¹	Parcel Match

¹ The Comparable "Distance from Subject" value has been calculated by the Clear Capital system.

² The Comparable "Distance from Subject" value has been provided by the Real Estate Professional.

Addendum: Report Purpose

Market Approach and Market Time

The Market Approach of this report, as established by the customer, is: **Fair Market Price**. (See definition below.)

The Marketing Time as specified by the customer is **Typical**. (See definition below.)

Definitions:

Fair Market Price	A price at which the property would sell between a willing buyer and a willing seller neither being compelled by undue pressure and both having reasonable knowledge of relevant facts.
Distressed Price	A price at which the property would sell between a willing buyer and a seller acting under duress.
Marketing Time	The amount of time the property is exposed to a pool of prospective buyers before going into contract. The customer either specifies the number of days, requests a marketing time that is typical to the subject's market area and/or requests an abbreviated marketing time.
Typical for Local Market	The estimated time required to adequately expose the subject property to the market resulting in a contract of sale.

Addendum: Report Purpose - cont.

Report Instructions

This section shows the instructions that were approved by the customer and provided to the broker prior to completing the report.

*** Please Note: This is a RUSH assignment. Do not accept if you cannot meet the current due date and time. Please reference the set terms and contact Clear Capital at 530.582.5011 if you require any changes. Thanks! ***

Instructions last updated: 7/17/2017

Purpose:

Please determine a fair market price for this property at which it would sell in a typical marketing time for the area.

Customer Specific Requests:

If the property is commercial or mixed use, please stop and contact Clear Capital as soon as possible

Form Help:

There are blue question marks (?) throughout this form. These are designed to offer guidance for that particular section of the form. Please click on them for help.

Comparable Requirements:

1. Please use fair market comps from the same neighborhood, block or subdivision whenever possible.
2. Please only use REO comparables if the market is driven by REOs and they are comparable in characteristics and condition.
3. Please use comps that have closed in the past 3 months to show the current market conditions or comment in the report if this is not possible. In rapidly changing markets, active listing comps should be given equal or greater weight than sold comps in your analysis.

Standard Instructions:

1. Clear Capital Code Of Conduct - Please make sure that you are always abiding by the Clear Capital Code of Conduct when completing valuation reports.
2. If the subject is currently listed, please consider all available information pertaining to the subject's condition. This information should be utilized when developing the assumption of the subject's condition.
3. Use the subject characteristics provided in the report Grid (if preloaded) to evaluate the property. This information is from a full interior appraisal and is assumed to be most accurate. If your inspection reveals obvious inaccuracies, please explain in the narrative of the report.
4. Include sufficient detail to help our mutual customer gain a complete understanding of the subject's neighborhood such as neighborhood desirability, amenities, parks, schools, commercial or industrial influences, REO activity, traffic, board-up-homes, etc.
5. Do not approach occupants or owners.
6. If the subject is a Commercial property, contact Clear Capital immediately at 530-582-5011 for direction on how to proceed with the report.
7. Please do not accept if you or your office has completed a report on this property in the last month, are currently listing this property, or have any vested interest in the subject property.
8. Clear Capital does not allow any log ins from IP addresses from foreign countries. This includes, but is not limited to; data entry services, form completion services, etc. Also, it is against Clear Capital code of conduct to share your password with anyone who is not a W2 employee in your office.
9. Clear Capital and our mutual customers greatly appreciate your expertise. If you cannot

Report Instructions - cont.

personally inspect the property, select comparables, and determine a price for the subject, please do not accept this report. Per the standards and guidelines adopted by Clear Capital and other industry leaders, the use of assistants to complete any of the aforementioned tasks is not permitted.

Due to the importance of an independent opinion of price, please do not discuss your price with anyone or be influenced by list price, pending offers, accept comp packets, repair estimates or the listing agent's opinion.

1. One current, original photo of the front of the subject 2. One address verification photo 3. One street scene photo looking down the street 4. MLS listing and sold comp photos required, please comment if no MLS.

Broker Information

Broker Name	Frank Oveo	Company/Brokerage	Texas Premier Realty
License No	630688	Address	10207 Moonset Lane Houston TX 77016
License Expiration	07/31/2023	License State	TX
Phone	8329555212	Email	oveofrank@gmail.com
Broker Distance to Subject	8.13 miles	Date Signed	07/21/2021

By confirming the above contact and real estate license information and submitting the report, the above signed hereby certifies and agrees that: 1) I personally took the pictures, selected comparables, and determined the price conclusion. 2) To the best of my knowledge, the statements of fact contained in this report are true and correct. 3) The reported analyses, opinions, and conclusions are my personal, impartial, and unbiased professional analyses, opinions, and conclusions. 4) I have no present or prospective interest in the property that is the subject of this report and no personal interest with respect to the parties involved. 5) I have no bias with respect to the property that is the subject of this report or to the parties involved with this assignment. 6) My compensation for completing this assignment is not contingent upon the development or reporting of a predetermined price point. 7) I did not base, either partially or completely, my analysis and/or opinion and conclusions in this report on race, color, religion, sex, age, marital status, handicap, familial status, or national origin of either the prospective owners or occupants of the subject property or of the present owners or occupants of the properties in the vicinity of the subject property or on any other basis prohibited by law. 8) I maintain errors and omissions insurance, to the extent required by state law, for all liability associated with the preparation of this Report.

Disclaimer

THIS REPORT SHOULD NOT BE CONSIDERED AN APPRAISAL. In making any decision that relies upon my work, you should know that I have not followed the guidelines for development of an appraisal or analysis contained in the Uniform Standards of Professional Appraisal Practice of the Appraisal Foundation.

Unless otherwise specifically agreed to in writing:

The intended purpose of this report is to assist the Clear Capital account holder in making decisions within the scope of applicable statutory and regulatory requirements and performing required due diligence. This document is provided solely for the use of the Clear Capital account holder and not any other party, is not intended as any guarantee of value and/or condition of the subject property and should not be relied on as such. In the event that this document is found to be defective, incorrect, negligently prepared or unfit for its authorized use, Clear Capital's sole liability shall be to promptly refund the total fee expended by the account holder for this report or to replace it at no charge to the account holder, but in no event shall Clear Capital be responsible to the account holder for any indirect or consequential damages whatsoever. This warranty is in lieu of all other warranties, express or implied, except where otherwise required by law. The account holder shall notify Clear Capital within thirty (30) days of this report's delivery to the account holder if it believes that this document is defective, incorrect, negligently prepared or unfit for its authorized use. Under no circumstances may Clear Capital forms or their contents be published, copied, replicated, or mimicked.