

Please Note: This report was completed with the following assumptions: Market Approach: **Fair Market Price** , Marketing Time: **Typical** . Important additional information relating to this report, including use and restrictions, is contained in an attached addendum which is an integral part of this report.

<b>Address</b>	7259 Madeira Drive, Fort Worth, TX 76112	<b>Order ID</b>	7480100	<b>Property ID</b>	30762886
<b>Inspection Date</b>	08/03/2021	<b>Date of Report</b>	08/03/2021		
<b>Loan Number</b>	45745	<b>APN</b>	02623315		
<b>Borrower Name</b>	Catamount Properties 2018 LLC	<b>County</b>	Tarrant		

Tracking IDs					
<b>Order Tracking ID</b>	0803BPO_Citi	<b>Tracking ID 1</b>	0803BPO_Citi		
<b>Tracking ID 2</b>	--	<b>Tracking ID 3</b>	--		

## General Conditions

<b>Owner</b>	Hicks Asa	<b>Condition Comments</b>	
<b>R. E. Taxes</b>	\$3,323	Subject appears in average condition with only typical wear and tear visible and no areas of defect or damage observed; Landscaping is maintained and compliments the exterior; Subject conforms well with the neighborhood and exhibits typical curb appeal; The quality and type of the construction matches the build trends of this area;	
<b>Assessed Value</b>	\$170,575		
<b>Zoning Classification</b>	Residential		
<b>Property Type</b>	SFR		
<b>Occupancy</b>	Occupied		
<b>Ownership Type</b>	Fee Simple		
<b>Property Condition</b>	Average		
<b>Estimated Exterior Repair Cost</b>	\$0		
<b>Estimated Interior Repair Cost</b>	\$0		
<b>Total Estimated Repair</b>	\$0		
<b>HOA</b>	No		
<b>Visible From Street</b>	Visible		
<b>Road Type</b>	Public		

## Neighborhood & Market Data

<b>Location Type</b>	Suburban	<b>Neighborhood Comments</b>	
<b>Local Economy</b>	Slow	Older neighborhood located in an established area of the city; A number of large trees line the street providing desirability and character; Properties confirm reasonably well to each other and show an acceptable amount of wear and tear given their age; Area has access to highways, parks, schools, and places of worship with links to shopping and major retail;	
<b>Sales Prices in this Neighborhood</b>	Low: \$154400 High: \$267461		
<b>Market for this type of property</b>	Decreased 5 % in the past 6 months.		
<b>Normal Marketing Days</b>	<30		

### Current Listings

	Subject	Listing 1 *	Listing 2	Listing 3
Street Address	7259 Madeira Drive	7200 Ellis Rd	1517 Mims St	1904 Milam St
City, State	Fort Worth, TX	Fort Worth, TX	Fort Worth, TX	Fort Worth, TX
Zip Code	76112	76112	76112	76112
Datasource	MLS	MLS	MLS	MLS
Miles to Subj.	--	0.16 <sup>1</sup>	0.43 <sup>1</sup>	0.47 <sup>1</sup>
Property Type	SFR	SFR	SFR	SFR
Original List Price \$	\$	\$230,000	\$249,900	\$215,000
List Price \$	--	\$230,000	\$249,900	\$215,000
Original List Date		06/06/2021	06/21/2021	07/13/2021
DOM · Cumulative DOM	-- · --	58 · 58	43 · 43	21 · 21
Age (# of years)	57	59	54	62
Condition	Average	Average	Average	Good
Sales Type	--	Fair Market Value	Fair Market Value	Fair Market Value
Location	Neutral ; Residential	Neutral ; Residential	Neutral ; Residential	Neutral ; Residential
View	Neutral ; Residential	Neutral ; Residential	Neutral ; Residential	Neutral ; Residential
Style/Design	1 Story Traditional	1 Story Traditional	1 Story Traditional	1 Story Traditional
# Units	1	1	1	1
Living Sq. Feet	1,869	1,870	1,957	1,818
Bdrm · Bths · ½ Bths	3 · 2	3 · 2	5 · 2	4 · 2
Total Room #	8	7	10	2
Garage (Style/Stalls)	Attached 2 Car(s)	Attached 2 Car(s)	Attached 2 Car(s)	Attached 2 Car(s)
Basement (Yes/No)	No	No	No	No
Basement (% Fin)	0%	0%	0%	0%
Basement Sq. Ft.	--	--	--	--
Pool/Spa	--	--	--	--
Lot Size	0.19 acres	0.24 acres	0.19 acres	0.17 acres
Other	--	Updates	Updates	--

\* Listing 1 is the most comparable listing to the subject.

<sup>1</sup> Comp's "Miles to Subject" was calculated by the system.

<sup>2</sup> Comp's "Miles to Subject" provided by Real Estate Professional.

<sup>3</sup> Subject \$/ft based upon as-is sale price.

**Listing Comments** Why the comparable listing is superior or inferior to the subject.

**Listing 1** Listing is the most comparable in location, age, number of rooms, size and build quality; Dissimilar in updates;

**Listing 2** Listing is the most in construction quality, age, number of rooms and size; Dissimilar in bedroom count and updates;

**Listing 3** Listing is the most comparable in size, number of rooms, amenities, build quality and views; Dissimilar in condition and bedroom count;

### Recent Sales

	Subject	Sold 1	Sold 2	Sold 3 *
<b>Street Address</b>	7259 Madeira Drive	7220 Ellis Rd	2000 Muse Street	7200 Martha Ln
<b>City, State</b>	Fort Worth, TX	Fort Worth, TX	Fort Worth, TX	Fort Worth, TX
<b>Zip Code</b>	76112	76112	76112	76112
<b>Datasource</b>	MLS	MLS	MLS	MLS
<b>Miles to Subj.</b>	--	0.14 <sup>1</sup>	0.22 <sup>1</sup>	0.29 <sup>1</sup>
<b>Property Type</b>	SFR	SFR	SFR	SFR
<b>Original List Price \$</b>	--	\$205,000	\$215,000	\$197,000
<b>List Price \$</b>	--	\$184,000	\$205,500	\$190,000
<b>Sale Price \$</b>	--	\$184,000	\$205,500	\$190,000
<b>Type of Financing</b>	--	Cash	Fha	Conv
<b>Date of Sale</b>	--	05/20/2021	12/07/2020	12/30/2020
<b>DOM · Cumulative DOM</b>	-- · --	14 · 14	88 · 88	38 · 38
<b>Age (# of years)</b>	57	59	55	53
<b>Condition</b>	Average	Average	Average	Average
<b>Sales Type</b>	--	Fair Market Value	Fair Market Value	Fair Market Value
<b>Location</b>	Neutral ; Residential	Neutral ; Residential	Neutral ; Residential	Neutral ; Residential
<b>View</b>	Neutral ; Residential	Neutral ; Residential	Neutral ; Residential	Neutral ; Residential
<b>Style/Design</b>	1 Story Traditional	1 Story Traditional	1 Story Traditional	1 Story Traditional
<b># Units</b>	1	1	1	1
<b>Living Sq. Feet</b>	1,869	1,783	1,896	1,774
<b>Bdrm · Bths · ½ Bths</b>	3 · 2	3 · 2	3 · 2	3 · 2
<b>Total Room #</b>	8	7	7	7
<b>Garage (Style/Stalls)</b>	Attached 2 Car(s)	Attached 2 Car(s)	Attached 2 Car(s)	Attached 2 Car(s)
<b>Basement (Yes/No)</b>	No	No	No	No
<b>Basement (% Fin)</b>	0%	0%	0%	0%
<b>Basement Sq. Ft.</b>	--	--	--	--
<b>Pool/Spa</b>	--	--	--	--
<b>Lot Size</b>	0.19 acres	0.23 acres	.218 acres	0.26 acres
<b>Other</b>	--	--	Updates	--
<b>Net Adjustment</b>	--	\$0	-\$7,000	\$0
<b>Adjusted Price</b>	--	\$184,000	\$198,500	\$190,000

\* Sold 3 is the most comparable sale to the subject.

<sup>1</sup> Comp's "Miles to Subject" was calculated by the system.

<sup>2</sup> Comp's "Miles to Subject" provided by Real Estate Professional.

<sup>3</sup> Subject \$/ft based upon as-is sale price.

#### Reasons for Adjustments Why the comparable sale is superior or inferior to the subject.

**Sold 1** Listing is the most comparable in size, number of rooms, age, build quality, views, condition, and curb appeal;

**Sold 2** Listing is the most comparable in views, build quality, size and number of rooms; Adjustment for dissimilar updates;

**Sold 3** Listing is the most comparable in views, curb appeal, location, age, condition, number of rooms, size and build quality;

## Subject Sales & Listing History

<b>Current Listing Status</b>	Not Currently Listed			<b>Listing History Comments</b>			
<b>Listing Agency/Firm</b>				Subject was listed and sold in 2006 at fair market with no unusual activity noted.			
<b>Listing Agent Name</b>							
<b>Listing Agent Phone</b>							
<b># of Removed Listings in Previous 12 Months</b>	0						
<b># of Sales in Previous 12 Months</b>	0						
<b>Original List Date</b>	<b>Original List Price</b>	<b>Final List Date</b>	<b>Final List Price</b>	<b>Result</b>	<b>Result Date</b>	<b>Result Price</b>	<b>Source</b>

## Marketing Strategy

	<b>As Is Price</b>	<b>Repaired Price</b>
<b>Suggested List Price</b>	\$200,000	\$200,000
<b>Sales Price</b>	\$190,000	\$190,000
<b>30 Day Price</b>	\$185,000	--
<b>Comments Regarding Pricing Strategy</b>		
<p>Many of the comparable listings in this area have either gone through recent updates or a complete remodel. This has created a wider than typical range in pricing. Values have been adjusted as appropriate based on differences in condition, location, amenities or other significant features. The value conclusion is based on a calculated weighting of both the sold and active listings with greatest weight placed on those listings closest in condition and square footage. The sold comparable listings moved off the market above what is typical for this area which led to the final pricing for the subject to be set less aggressively to encourage the desired marketing period for a fair market value as requested in this report.</p>		

## Clear Capital Quality Assurance Comments Addendum

**Reviewer's Notes** The broker's as-is conclusion reflects the market for the subject. Comps are within a reasonable distance, relatively current, and accurately reflect the subject's defining characteristics. Thus, the as-is conclusion appears to be adequately supported.

## Subject Photos



Front



Address Verification



Side



Side



Street



Street

## Subject Photos



Other

## Listing Photos

**L1** 7200 Ellis Rd  
Fort Worth, TX 76112



Front

**L2** 1517 Mims St  
Fort Worth, TX 76112



Front

**L3** 1904 Milam St  
Fort Worth, TX 76112



Front



## Sales Photos

**S1** 7220 Ellis Rd  
Fort Worth, TX 76112



Front

**S2** 2000 Muse Street  
Fort Worth, TX 76112



Front

**S3** 7200 Martha Ln  
Fort Worth, TX 76112



Front

### ClearMaps Addendum

**Address** ★ 7259 Madeira Drive, Fort Worth, TX 76112

**Loan Number** 45745

**Suggested List** \$200,000

**Suggested Repaired** \$200,000

**Sale** \$190,000

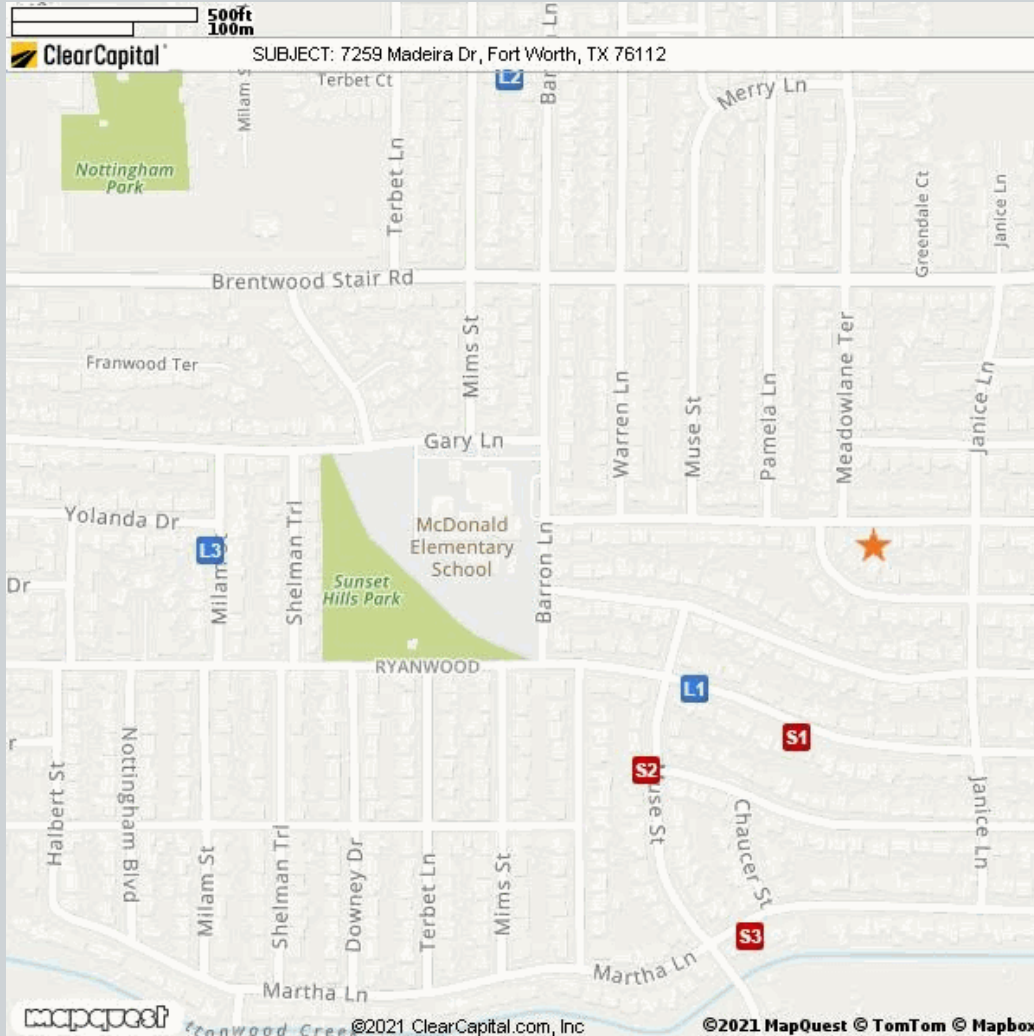

Comparable	Address	Miles to Subject	Mapping Accuracy
★ Subject	7259 Madeira Drive, Fort Worth, TX 76112	--	Parcel Match
L1 Listing 1	7200 Ellis Rd, Fort Worth, TX 76112	0.16 Miles <sup>1</sup>	Parcel Match
L2 Listing 2	1517 Mims St, Fort Worth, TX 76112	0.43 Miles <sup>1</sup>	Parcel Match
L3 Listing 3	1904 Milam St, Fort Worth, TX 76112	0.47 Miles <sup>1</sup>	Parcel Match
S1 Sold 1	7220 Ellis Rd, Fort Worth, TX 76112	0.14 Miles <sup>1</sup>	Parcel Match
S2 Sold 2	2000 Muse Street, Fort Worth, TX 76112	0.22 Miles <sup>1</sup>	Parcel Match
S3 Sold 3	7200 Martha Ln, Fort Worth, TX 76112	0.29 Miles <sup>1</sup>	Parcel Match

<sup>1</sup> The Comparable "Distance from Subject" value has been calculated by the Clear Capital system.

<sup>2</sup> The Comparable "Distance from Subject" value has been provided by the Real Estate Professional.

## Addendum: Report Purpose

### Market Approach and Market Time

The Market Approach of this report, as established by the customer, is: **Fair Market Price**. (See definition below.)

The Marketing Time as specified by the customer is **Typical**. (See definition below.)

Definitions:

Fair Market Price

A price at which the property would sell between a willing buyer and a willing seller neither being compelled by undue pressure and both having reasonable knowledge of relevant facts.

Distressed Price

A price at which the property would sell between a willing buyer and a seller acting under duress.

Marketing Time

The amount of time the property is exposed to a pool of prospective buyers before going into contract. The customer either specifies the number of days, requests a marketing time that is typical to the subject's market area and/or requests an abbreviated marketing time.

Typical for Local Market

The estimated time required to adequately expose the subject property to the market resulting in a contract of sale.

## Addendum: Report Purpose - cont.

**Report Instructions**

This section shows the instructions that were approved by the customer and provided to the broker prior to completing the report.

\*\*\* Please Note: This is a RUSH assignment. Do not accept if you cannot meet the current due date and time. Please reference the set terms and contact Clear Capital at 530.582.5011 if you require any changes. Thanks! \*\*\*

Instructions last updated: 7/17/2017

Purpose:

Please determine a fair market price for this property at which it would sell in a typical marketing time for the area.

Customer Specific Requests:

\*\*If the property is commercial or mixed use, please stop and contact Clear Capital as soon as possible\*\*

Form Help:

There are blue question marks (?) throughout this form. These are designed to offer guidance for that particular section of the form. Please click on them for help.

Comparable Requirements:

1. Please use fair market comps from the same neighborhood, block or subdivision whenever possible.
2. Please only use REO comparables if the market is driven by REOs and they are comparable in characteristics and condition.
3. Please use comps that have closed in the past 3 months to show the current market conditions or comment in the report if this is not possible. In rapidly changing markets, active listing comps should be given equal or greater weight than sold comps in your analysis.

Standard Instructions:

1. Clear Capital Code Of Conduct - Please make sure that you are always abiding by the Clear Capital Code of Conduct when completing valuation reports.
2. If the subject is currently listed, please consider all available information pertaining to the subject's condition. This information should be utilized when developing the assumption of the subject's condition.
3. Use the subject characteristics provided in the report Grid (if preloaded) to evaluate the property. This information is from a full interior appraisal and is assumed to be most accurate. If your inspection reveals obvious inaccuracies, please explain in the narrative of the report.
4. Include sufficient detail to help our mutual customer gain a complete understanding of the subject's neighborhood such as neighborhood desirability, amenities, parks, schools, commercial or industrial influences, REO activity, traffic, board-up-homes, etc.
5. Do not approach occupants or owners.
6. If the subject is a Commercial property, contact Clear Capital immediately at 530-582-5011 for direction on how to proceed with the report.
7. Please do not accept if you or your office has completed a report on this property in the last month, are currently listing this property, or have any vested interest in the subject property.
8. Clear Capital does not allow any log ins from IP addresses from foreign countries. This includes, but is not limited to; data entry services, form completion services, etc. Also, it is against Clear Capital code of conduct to share your password with anyone who is not a W2 employee in your office.
9. Clear Capital and our mutual customers greatly appreciate your expertise. If you cannot

## Report Instructions - cont.

personally inspect the property, select comparables, and determine a price for the subject, please do not accept this report. Per the standards and guidelines adopted by Clear Capital and other industry leaders, the use of assistants to complete any of the aforementioned tasks is not permitted.

Due to the importance of an independent opinion of price, please do not discuss your price with anyone or be influenced by list price, pending offers, accept comp packets, repair estimates or the listing agent's opinion.

1. One current, original photo of the front of the subject
2. One photo of each side of the subject
3. One photo of what the subject faces
4. One address verification photo
5. Two street scene photos looking down the street in each direction from the subject
6. Photos of any damages viewable from the exterior inspection
7. MLS listing and sold comp photos required, please comment if no MLS.

## Broker Information

<b>Broker Name</b>	LaToya Flanigan	<b>Company/Brokerage</b>	Avid Real Estate, LLC
<b>License No</b>	533322	<b>Address</b>	4405 Huntsman Ridge Lane arlington TX 76005
<b>License Expiration</b>	04/30/2022	<b>License State</b>	TX
<b>Phone</b>	8173718692	<b>Email</b>	support@myavidre.com
<b>Broker Distance to Subject</b>	8.25 miles	<b>Date Signed</b>	08/03/2021

*By confirming the above contact and real estate license information and submitting the report, the above signed hereby certifies and agrees that: 1) I personally took the pictures, selected comparables, and determined the price conclusion. 2) To the best of my knowledge, the statements of fact contained in this report are true and correct. 3) The reported analyses, opinions, and conclusions are my personal, impartial, and unbiased professional analyses, opinions, and conclusions. 4) I have no present or prospective interest in the property that is the subject of this report and no personal interest with respect to the parties involved. 5) I have no bias with respect to the property that is the subject of this report or to the parties involved with this assignment. 6) My compensation for completing this assignment is not contingent upon the development or reporting of a predetermined price point. 7) I did not base, either partially or completely, my analysis and/or opinion and conclusions in this report on race, color, religion, sex, age, marital status, handicap, familial status, or national origin of either the prospective owners or occupants of the subject property or of the present owners or occupants of the properties in the vicinity of the subject property or on any other basis prohibited by law. 8) I maintain errors and omissions insurance, to the extent required by state law, for all liability associated with the preparation of this Report.*

## Disclaimer

**THIS REPORT SHOULD NOT BE CONSIDERED AN APPRAISAL. In making any decision that relies upon my work, you should know that I have not followed the guidelines for development of an appraisal or analysis contained in the Uniform Standards of Professional Appraisal Practice of the Appraisal Foundation.**

**Unless otherwise specifically agreed to in writing:**

**The intended purpose of this report is to assist the Clear Capital account holder in making decisions within the scope of applicable statutory and regulatory requirements and performing required due diligence. This document is provided solely for the use of the Clear Capital account holder and not any other party, is not intended as any guarantee of value and/or condition of the subject property and should not be relied on as such. In the event that this document is found to be defective, incorrect, negligently prepared or unfit for its authorized use, Clear Capital's sole liability shall be to promptly refund the total fee expended by the account holder for this report or to replace it at no charge to the account holder, but in no event shall Clear Capital be responsible to the account holder for any indirect or consequential damages whatsoever. This warranty is in lieu of all other warranties, express or implied, except where otherwise required by law. The account holder shall notify Clear Capital within thirty (30) days of this report's delivery to the account holder if it believes that this document is defective, incorrect, negligently prepared or unfit for its authorized use. Under no circumstances may Clear Capital forms or their contents be published, copied, replicated, or mimicked.**