

Please Note: This report was completed with the following assumptions: Market Approach: **Fair Market Price** , Marketing Time: **Typical** . Important additional information relating to this report, including use and restrictions, is contained in an attached addendum which is an integral part of this report.

Address	8243 Knute Rochne Street, San Antonio, TX 78240	Order ID	7713595	Property ID	31524841
Inspection Date	11/02/2021	Date of Report	11/03/2021		
Loan Number	46784	APN	179590080110		
Borrower Name	Breckenridge Property Fund 2016 LLC	County	Bexar		

Tracking IDs					
Order Tracking ID	1102BPO	Tracking ID 1	1102BPO		
Tracking ID 2	--	Tracking ID 3	--		

General Conditions

		Condition Comments
Owner	JOSEPH D ALEMAN	Subject is typical in size and amenities. Needs exterior paint Subject has good functional utility and conforms within the neighborhood.
R. E. Taxes	\$4,285	
Assessed Value	\$165,500	
Zoning Classification	Residential	
Property Type	SFR	
Occupancy	Occupied	
Ownership Type	Fee Simple	
Property Condition	Average	
Estimated Exterior Repair Cost	\$1,500	
Estimated Interior Repair Cost	\$0	
Total Estimated Repair	\$1,500	
HOA	No	
Visible From Street	Visible	
Road Type	Public	

Neighborhood & Market Data

		Neighborhood Comments
Location Type	Suburban	387 homes in the neighborhood with an average size of 1683 and average age of 43
Local Economy	Improving	
Sales Prices in this Neighborhood	Low: \$210,000 High: \$259,900	
Market for this type of property	Increased 2 % in the past 6 months.	
Normal Marketing Days	<90	

Current Listings

	Subject	Listing 1 *	Listing 2	Listing 3
Street Address	8243 Knute Rochne Street	8318 Kyle Rote St	8107 Babe Ruth St	8231 Budge St
City, State	San Antonio, TX	San Antonio, TX	San Antonio, TX	San Antonio, TX
Zip Code	78240	78240	78240	78240
Datasource	Tax Records	MLS	MLS	MLS
Miles to Subj.	--	0.11 ¹	0.20 ¹	0.12 ¹
Property Type	SFR	SFR	SFR	SFR
Original List Price \$	\$	\$240,000	\$249,500	\$255,000
List Price \$	--	\$240,000	\$249,500	\$252,950
Original List Date		10/12/2021	09/23/2021	08/24/2021
DOM · Cumulative DOM	-- · --	18 · 22	11 · 41	36 · 71
Age (# of years)	44	46	43	43
Condition	Average	Average	Good	Good
Sales Type	--	Fair Market Value	Fair Market Value	Fair Market Value
Location	Neutral ; Residential	Neutral ; Residential	Neutral ; Residential	Neutral ; Residential
View	Neutral ; Residential	Neutral ; Residential	Neutral ; Residential	Neutral ; Residential
Style/Design	1 Story ranch	1 Story ranch	1 Story ranch	1 Story ranch
# Units	1	1	1	1
Living Sq. Feet	1,381	1,573	1,520	1,399
Bdrm · Bths · ½ Bths	3 · 2	3 · 2	3 · 2	3 · 2
Total Room #	6	6	6	6
Garage (Style/Stalls)	Attached 2 Car(s)	Attached 2 Car(s)	Attached 2 Car(s)	Attached 2 Car(s)
Basement (Yes/No)	No	No	No	No
Basement (% Fin)	0%	0%	0%	0%
Basement Sq. Ft.	--	--	--	--
Pool/Spa	--	--	--	--
Lot Size	0.21 acres	0.22 acres	0.17 acres	0.16 acres
Other	None	None	None	None

* Listing 1 is the most comparable listing to the subject.

¹ Comp's "Miles to Subject" was calculated by the system.

² Comp's "Miles to Subject" provided by Real Estate Professional.

³ Subject \$/ft based upon as-is sale price.

Current Listings - Cont.

Listing Comments Why the comparable listing is superior or inferior to the subject.

- Listing 1** One Living Area, Separate Dining Room, Utility Room Inside, High Ceilings, Cable TV Available, Laundry Main Level, Laundry Room, Walk in Closets, Attic - Pull Down Stairs, Ceiling Fans, Chandelier, Washer Connection, Dryer Connection, Self-Cleaning Oven, Stove/Range, Refrigerator, Disposal, Dishwasher, Ice Maker Connection, Water Softener (owned), Vent Fan, Smoke Alarm, Gas Water Heater, Garage Door Opener, Solid Counter Tops, City Garbage service.
- Listing 2** Two Living Areas, Liv/Din Combo, Separate Dining Room, Eat-In Kitchen, Island Kitchen, Study/Office, Florida Room, Utility Area in Garage, Converted Garage, Open Floor Plan, High Speed Internet, All Bedrooms Downstairs, Laundry in Garage, Walk in Closets, Ceiling Fans, Washer Connection, Dryer Connection, Cook Top, Built-In Oven, Stove/Range, Refrigerator, Dishwasher, Water Softener (owned), Vent Fan, City Garbage service.
- Listing 3** One Living Area, Ceiling Fans, Washer Connection, Dryer Connection, Disposal, Upgraded floors, kitchen, and bathrooms. Space for an office/playroom too.

Recent Sales

	Subject	Sold 1	Sold 2 *	Sold 3
Street Address	8243 Knute Rochne Street	8214 Devlin Pt	8110 Babe Ruth St	7011 Dana Bible Dr
City, State	San Antonio, TX	San Antonio, TX	San Antonio, TX	San Antonio, TX
Zip Code	78240	78240	78240	78240
Datasource	Tax Records	MLS	MLS	MLS
Miles to Subj.	--	0.13 ¹	0.22 ¹	0.09 ¹
Property Type	SFR	SFR	SFR	SFR
Original List Price \$	--	\$212,500	\$243,600	\$230,000
List Price \$	--	\$212,500	\$235,248	\$230,000
Sale Price \$	--	\$213,200	\$220,000	\$235,000
Type of Financing	--	Fha	Cash	Fha
Date of Sale	--	10/13/2021	10/28/2021	08/23/2021
DOM · Cumulative DOM	-- · --	16 · 70	14 · 26	14 · 58
Age (# of years)	44	43	42	44
Condition	Average	Average	Average	Good
Sales Type	--	Fair Market Value	Fair Market Value	Fair Market Value
Location	Neutral ; Residential	Neutral ; Residential	Neutral ; Residential	Neutral ; Residential
View	Neutral ; Residential	Neutral ; Residential	Neutral ; Residential	Neutral ; Residential
Style/Design	1 Story ranch	1 Story ranch	1 Story ranch	1 Story ranch
# Units	1	1	1	1
Living Sq. Feet	1,381	1,350	1,392	1,383
Bdrm · Bths · ½ Bths	3 · 2	3 · 2	3 · 2	3 · 2
Total Room #	6	6	6	6
Garage (Style/Stalls)	Attached 2 Car(s)	Attached 2 Car(s)	Attached 2 Car(s)	Attached 2 Car(s)
Basement (Yes/No)	No	No	No	No
Basement (% Fin)	0%	0%	0%	0%
Basement Sq. Ft.	--	--	--	--
Pool/Spa	--	--	--	--
Lot Size	0.21 acres	0.17 acres	0.17 acres	0.21 acres
Other	None	None	None	None
Net Adjustment	--	+\$4,000	+\$4,000	-\$15,000
Adjusted Price	--	\$217,200	\$224,000	\$220,000

* Sold 2 is the most comparable sale to the subject.

¹ Comp's "Miles to Subject" was calculated by the system.

² Comp's "Miles to Subject" provided by Real Estate Professional.

³ Subject \$/ft based upon as-is sale price.

Recent Sales - Cont.

Reasons for Adjustments Why the comparable sale is superior or inferior to the subject.

- Sold 1** adj. +4000 lot size, One Living Area, Liv/Din Combo, Eat-In Kitchen, Two Eating Areas, Utility Room Inside, High Ceilings, Open Floor Plan, Cable TV Available, High Speed Internet, Ceiling Fans, Chandelier, Washer Connection, Dryer Connection, Stove/Range, Dishwasher, Ice Maker Connection, Smoke Alarm, Gas Water Heater, Garage Door Opener, Solid Counter Tops, City Garbage service.
- Sold 2** adj. +4000 lot size, One Living Area, Liv/Din Combo, Eat-In Kitchen, Breakfast Bar, Study/Office, Utility Room Inside, Converted Garage, High Ceilings, Open Floor Plan, High Speed Internet, Laundry Main Level, Laundry Room, Attic - Partially Floored, Ceiling Fans, Washer Connection, Dryer Connection, Washer, Dryer, Stove/Range, Refrigerator, Disposal, Dishwasher, Electric Water Heater, Garage Door Opener, City Garbage service.
- Sold 3** adj. -15000 condition, One Living Area, Separate Dining Room, Eat-In Kitchen, Utility Room Inside, Walk in Closets, Ceiling Fans, Washer Connection, Dryer Connection, Stove/Range, Dishwasher, Water Softener (owned), Security System (Owned), Gas Water Heater, City Garbage service, has nice upgrades water softener , kitchen expanded with granite and subway tile backsplash, water heaters 6 months old, 2 year old carpet, double pane windows, New 30 year roof, all RING cameras stay and the 14x14 shed has AC.

Subject Sales & Listing History

Current Listing Status	Not Currently Listed		Listing History Comments				
Listing Agency/Firm			all prior listing have been for rental, last rental on 08/23/2012 for 975 per month				
Listing Agent Name							
Listing Agent Phone							
# of Removed Listings in Previous 12 Months	0						
# of Sales in Previous 12 Months	0						
Original List Date	Original List Price	Final List Date	Final List Price	Result	Result Date	Result Price	Source

Marketing Strategy

	As Is Price	Repaired Price
Suggested List Price	\$224,000	\$227,000
Sales Price	\$220,000	\$223,000
30 Day Price	\$217,000	--
Comments Regarding Pricing Strategy		
Used most similar comps in size, condition and amenities and within the same neighborhood. Decreasing and very limited active comps with steady demand.		

Clear Capital Quality Assurance Comments Addendum

Reviewer's Notes	The broker's as-is conclusion reflects the market for the subject. Comps are within a reasonable distance, relatively current, and accurately reflect the subject's defining characteristics. Thus, the as-is conclusion appears to be adequately supported.
-------------------------	--

Subject Photos



Front



Address Verification



Side



Side



Street



Other

Listing Photos

L1 8318 Kyle Rote St
San Antonio, TX 78240



Front

L2 8107 Babe Ruth St
San Antonio, TX 78240



Front

L3 8231 Budge St
San Antonio, TX 78240



Front

Sales Photos

S1 8214 Devlin Pt
San Antonio, TX 78240



Front

S2 8110 Babe Ruth St
San Antonio, TX 78240



Front

S3 7011 Dana Bible Dr
San Antonio, TX 78240



Front

ClearMaps Addendum

Address ★ 8243 Knute Rochne Street, San Antonio, TX 78240

Loan Number 46784

Suggested List \$224,000

Suggested Repaired \$227,000

Sale \$220,000

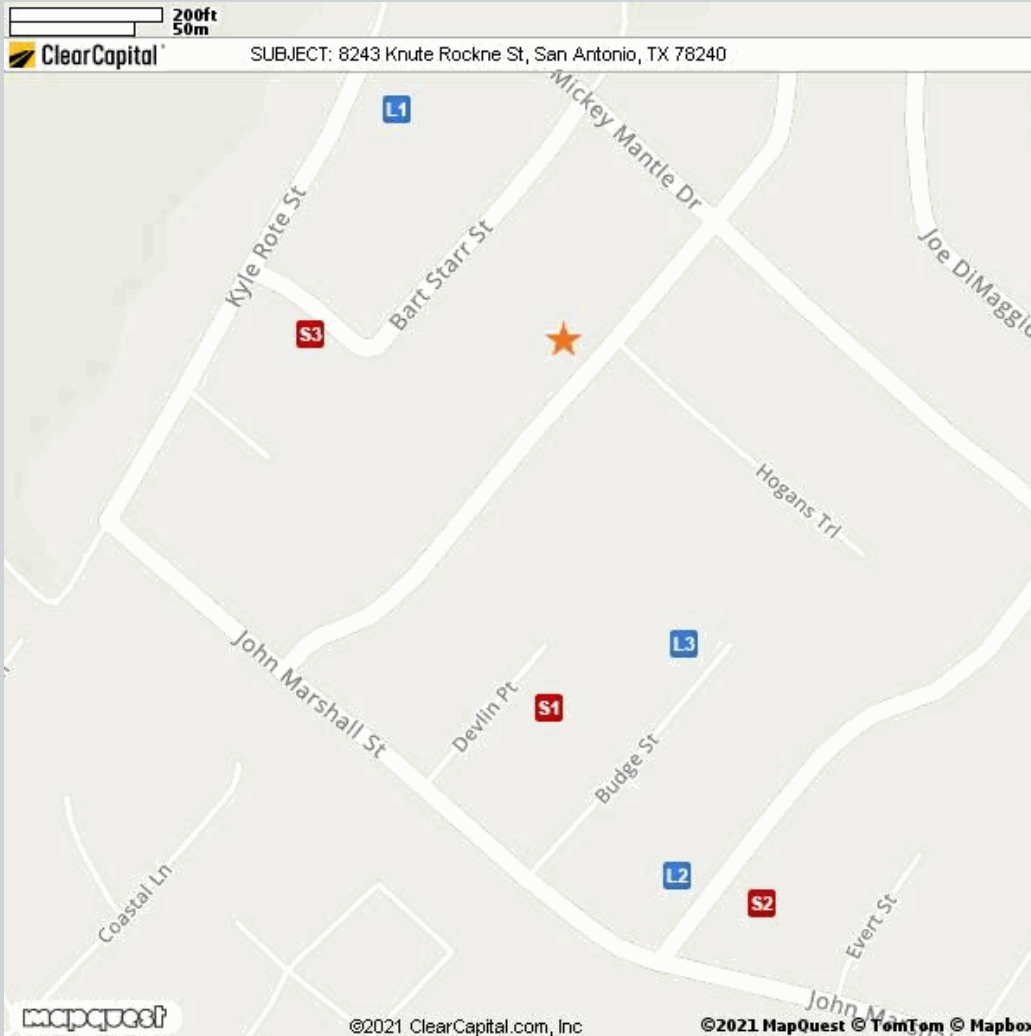

Comparable	Address	Miles to Subject	Mapping Accuracy
★ Subject	8243 Knute Rochne Street, San Antonio, TX 78240	--	Parcel Match
L1 Listing 1	8318 Kyle Rote St, San Antonio, TX 78240	0.11 Miles ¹	Parcel Match
L2 Listing 2	8107 Babe Ruth St, San Antonio, TX 78240	0.20 Miles ¹	Parcel Match
L3 Listing 3	8231 Budge St, San Antonio, TX 78240	0.12 Miles ¹	Parcel Match
S1 Sold 1	8214 Devlin Pt, San Antonio, TX 78240	0.13 Miles ¹	Parcel Match
S2 Sold 2	8110 Babe Ruth St, San Antonio, TX 78240	0.22 Miles ¹	Parcel Match
S3 Sold 3	7011 Dana Bible Dr, San Antonio, TX 78240	0.09 Miles ¹	Parcel Match

¹ The Comparable "Distance from Subject" value has been calculated by the Clear Capital system.

² The Comparable "Distance from Subject" value has been provided by the Real Estate Professional.

Addendum: Report Purpose

Market Approach and Market Time

The Market Approach of this report, as established by the customer, is: **Fair Market Price**. (See definition below.)

The Marketing Time as specified by the customer is **Typical**. (See definition below.)

Definitions:

Fair Market Price	A price at which the property would sell between a willing buyer and a willing seller neither being compelled by undue pressure and both having reasonable knowledge of relevant facts.
Distressed Price	A price at which the property would sell between a willing buyer and a seller acting under duress.
Marketing Time	The amount of time the property is exposed to a pool of prospective buyers before going into contract. The customer either specifies the number of days, requests a marketing time that is typical to the subject's market area and/or requests an abbreviated marketing time.
Typical for Local Market	The estimated time required to adequately expose the subject property to the market resulting in a contract of sale.

Addendum: Report Purpose - cont.

Report Instructions

This section shows the instructions that were approved by the customer and provided to the broker prior to completing the report.

*** Please Note: This is a RUSH assignment. Do not accept if you cannot meet the current due date and time. Please reference the set terms and contact Clear Capital at 530.582.5011 if you require any changes. Thanks! ***

Instructions last updated: 7/17/2017

Purpose:

Please determine a fair market price for this property at which it would sell in a typical marketing time for the area.

Customer Specific Requests:

If the property is commercial or mixed use, please stop and contact Clear Capital as soon as possible

Form Help:

There are blue question marks (?) throughout this form. These are designed to offer guidance for that particular section of the form. Please click on them for help.

Comparable Requirements:

1. Please use fair market comps from the same neighborhood, block or subdivision whenever possible.
2. Please only use REO comparables if the market is driven by REOs and they are comparable in characteristics and condition.
3. Please use comps that have closed in the past 3 months to show the current market conditions or comment in the report if this is not possible. In rapidly changing markets, active listing comps should be given equal or greater weight than sold comps in your analysis.

Standard Instructions:

1. Clear Capital Code Of Conduct - Please make sure that you are always abiding by the Clear Capital Code of Conduct when completing valuation reports.
2. If the subject is currently listed, please consider all available information pertaining to the subject's condition. This information should be utilized when developing the assumption of the subject's condition.
3. Use the subject characteristics provided in the report Grid (if preloaded) to evaluate the property. This information is from a full interior appraisal and is assumed to be most accurate. If your inspection reveals obvious inaccuracies, please explain in the narrative of the report.
4. Include sufficient detail to help our mutual customer gain a complete understanding of the subject's neighborhood such as neighborhood desirability, amenities, parks, schools, commercial or industrial influences, REO activity, traffic, board-up-homes, etc.
5. Do not approach occupants or owners.
6. If the subject is a Commercial property, contact Clear Capital immediately at 530-582-5011 for direction on how to proceed with the report.
7. Please do not accept if you or your office has completed a report on this property in the last month, are currently listing this property, or have any vested interest in the subject property.
8. Clear Capital does not allow any log ins from IP addresses from foreign countries. This includes, but is not limited to; data entry services, form completion services, etc. Also, it is against Clear Capital code of conduct to share your password with anyone who is not a W2 employee in your office.
9. Clear Capital and our mutual customers greatly appreciate your expertise. If you cannot

Report Instructions - cont.

personally inspect the property, select comparables, and determine a price for the subject, please do not accept this report. Per the standards and guidelines adopted by Clear Capital and other industry leaders, the use of assistants to complete any of the aforementioned tasks is not permitted.

Due to the importance of an independent opinion of price, please do not discuss your price with anyone or be influenced by list price, pending offers, accept comp packets, repair estimates or the listing agent's opinion.

1. One current, original photo of the front of the subject 2. One address verification photo 3. One street scene photo looking down the street 4. MLS listing and sold comp photos required, please comment if no MLS.

Broker Information

Broker Name	Karen Wesler	Company/Brokerage	Sterling Real Estate Services
License No	0515538	Address	7417 Peaceful Mdws San Antonio TX 78250
License Expiration	10/31/2022	License State	TX
Phone	2102157740	Email	karenwesler@gmail.com
Broker Distance to Subject	2.22 miles	Date Signed	11/03/2021

By confirming the above contact and real estate license information and submitting the report, the above signed hereby certifies and agrees that: 1) I personally took the pictures, selected comparables, and determined the price conclusion. 2) To the best of my knowledge, the statements of fact contained in this report are true and correct. 3) The reported analyses, opinions, and conclusions are my personal, impartial, and unbiased professional analyses, opinions, and conclusions. 4) I have no present or prospective interest in the property that is the subject of this report and no personal interest with respect to the parties involved. 5) I have no bias with respect to the property that is the subject of this report or to the parties involved with this assignment. 6) My compensation for completing this assignment is not contingent upon the development or reporting of a predetermined price point. 7) I did not base, either partially or completely, my analysis and/or opinion and conclusions in this report on race, color, religion, sex, age, marital status, handicap, familial status, or national origin of either the prospective owners or occupants of the subject property or of the present owners or occupants of the properties in the vicinity of the subject property or on any other basis prohibited by law. 8) I maintain errors and omissions insurance, to the extent required by state law, for all liability associated with the preparation of this Report.

Disclaimer

THIS REPORT SHOULD NOT BE CONSIDERED AN APPRAISAL. In making any decision that relies upon my work, you should know that I have not followed the guidelines for development of an appraisal or analysis contained in the Uniform Standards of Professional Appraisal Practice of the Appraisal Foundation.

Unless otherwise specifically agreed to in writing:

The intended purpose of this report is to assist the Clear Capital account holder in making decisions within the scope of applicable statutory and regulatory requirements and performing required due diligence. This document is provided solely for the use of the Clear Capital account holder and not any other party, is not intended as any guarantee of value and/or condition of the subject property and should not be relied on as such. In the event that this document is found to be defective, incorrect, negligently prepared or unfit for its authorized use, Clear Capital's sole liability shall be to promptly refund the total fee expended by the account holder for this report or to replace it at no charge to the account holder, but in no event shall Clear Capital be responsible to the account holder for any indirect or consequential damages whatsoever. This warranty is in lieu of all other warranties, express or implied, except where otherwise required by law. The account holder shall notify Clear Capital within thirty (30) days of this report's delivery to the account holder if it believes that this document is defective, incorrect, negligently prepared or unfit for its authorized use. Under no circumstances may Clear Capital forms or their contents be published, copied, replicated, or mimicked.