

Please Note: This report was completed with the following assumptions: Market Approach: **Fair Market Price** , Marketing Time: **Typical** . Important additional information relating to this report, including use and restrictions, is contained in an attached addendum which is an integral part of this report.

Address	202 Canaberry Circle, Summerville, SC 29483	Order ID	7908052	Property ID	32004414
Inspection Date	01/21/2022	Date of Report	01/23/2022		
Loan Number	47557	APN	1361402006000		
Borrower Name	Catamount Properties 2018 LLC	County	Dorchester		

Tracking IDs					
Order Tracking ID	01.20.22	Tracking ID 1	01.20.22		
Tracking ID 2	--	Tracking ID 3	--		

General Conditions

Owner	HOWARD N RAMSDELL JR	Condition Comments	
R. E. Taxes	\$886	Subject conform to neighborhood in quality, age, style, and size. The subject is nearby to several potential external influences. The external influences near the subject do not have an impact on the subject's marketability or value based on my Real Estate experience and knowledge of the local area.	
Assessed Value	\$4,090		
Zoning Classification	Residential		
Property Type	SFR		
Occupancy	Occupied		
Ownership Type	Fee Simple		
Property Condition	Average		
Estimated Exterior Repair Cost	\$0		
Estimated Interior Repair Cost	\$0		
Total Estimated Repair	\$0		
HOA	No		
Visible From Street	Visible		
Road Type	Public		

Neighborhood & Market Data

Location Type	Suburban	Neighborhood Comments	
Local Economy	Stable	Desirable neighborhood, quiet street, near all amenities, schools, shopping and parks, with no commercial or industrial influences. Low REO activity. There were no boarded- up-homes near the subject property. The area exhibits generally average to good maintenance patterns and marketability. Property values have stabilized in the past year with demand and supply currently in apparent balance.	
Sales Prices in this Neighborhood	Low: \$184750 High: \$359910		
Market for this type of property	Remained Stable for the past 6 months.		
Normal Marketing Days	<30		

Current Listings

	Subject	Listing 1	Listing 2 *	Listing 3
Street Address	202 Canaberry Circle	104 Lionel Ct	226 Moon Dance Lane	206 Trillium Ave
City, State	Summerville, SC	Summerville, SC	Summerville, SC	Summerville, SC
Zip Code	29483	29483	29483	29483
Datasource	Public Records	MLS	MLS	MLS
Miles to Subj.	--	0.41 ¹	0.66 ¹	0.26 ¹
Property Type	SFR	SFR	SFR	SFR
Original List Price \$	\$	\$224,900	\$265,000	\$294,999
List Price \$	--	\$224,900	\$265,000	\$294,499
Original List Date		01/05/2022	01/15/2022	12/29/2021
DOM · Cumulative DOM	-- · --	15 · 18	6 · 8	22 · 25
Age (# of years)	43	49	20	17
Condition	Average	Average	Average	Average
Sales Type	--	Fair Market Value	Fair Market Value	Fair Market Value
Location	Neutral ; Residential	Neutral ; Residential	Neutral ; Residential	Neutral ; Residential
View	Neutral ; Residential	Neutral ; Residential	Neutral ; Residential	Neutral ; Residential
Style/Design	1 Story Ranch	1 Story Ranch	1 Story Ranch	2 Stories Trad
# Units	1	1	1	1
Living Sq. Feet	1,224	1,148	1,297	1,344
Bdrm · Bths · ½ Bths	3 · 2	4 · 1 · 1	3 · 2	3 · 2 · 1
Total Room #	6	6	6	6
Garage (Style/Stalls)	Attached 1 Car	None	None	None
Basement (Yes/No)	No	No	No	No
Basement (% Fin)	0%	0%	0%	0%
Basement Sq. Ft.	--	--	--	--
Pool/Spa	--	--	--	--
Lot Size	0.38 acres	0.43 acres	0.17 acres	0.10 acres
Other	--	--	--	--

* Listing 2 is the most comparable listing to the subject.

¹ Comp's "Miles to Subject" was calculated by the system.

² Comp's "Miles to Subject" provided by Real Estate Professional.

³ Subject \$/ft based upon as-is sale price.

Current Listings - Cont.

Listing Comments Why the comparable listing is superior or inferior to the subject.

- Listing 1** Fair market comp located in subject area near all amenities, schools, parks and shopping, comp offered is considered the most suitable listing available for comparison to the subject in today's market with subject's characteristics. Comparable in style, design, quality, age and size. Inferior to subject in sqft/age/full baths. Superior in acreage/bedrooms/half baths.
- Listing 2** Fair market comp located in subject area near all amenities, schools, parks and shopping, comp offered is considered the most suitable listing available for comparison to the subject in today's market with subject's characteristics. Comparable in style, design, quality, age and size. Equal to subject in bed/full baths/ sqft. Superior in age. Inferior in acreage.
- Listing 3** Fair market comp located in subject area near all amenities, schools, parks and shopping, comp offered is considered the most suitable listing available for comparison to the subject in today's market with subject's characteristics. Comparable in style, design, quality, age and size. Superior to subject in sqft/age/half baths. Inferior in acreage.

Recent Sales

	Subject	Sold 1	Sold 2 *	Sold 3
Street Address	202 Canaberry Circle	210 Woodward Boulevard	205 Canaberry Cir	118 Bradd St
City, State	Summerville, SC	Summerville, SC	Summerville, SC	Summerville, SC
Zip Code	29483	29483	29483	29483
Datasource	Public Records	MLS	MLS	MLS
Miles to Subj.	--	0.21 ¹	0.06 ¹	0.19 ¹
Property Type	SFR	SFR	SFR	SFR
Original List Price \$	--	\$250,000	\$244,900	\$245,000
List Price \$	--	\$250,000	\$244,900	\$245,000
Sale Price \$	--	\$250,000	\$255,000	\$260,000
Type of Financing	--	Fha	Fha	Conv
Date of Sale	--	10/07/2021	07/12/2021	07/30/2021
DOM · Cumulative DOM	-- · --	1 · 49	1 · 32	0 · 37
Age (# of years)	43	45	44	33
Condition	Average	Average	Average	Average
Sales Type	--	Fair Market Value	Fair Market Value	Fair Market Value
Location	Neutral ; Residential	Neutral ; Residential	Neutral ; Residential	Neutral ; Residential
View	Neutral ; Residential	Neutral ; Residential	Neutral ; Residential	Neutral ; Residential
Style/Design	1 Story Ranch	1 Story Ranch	1 Story Ranch	1 Story Ranch
# Units	1	1	1	1
Living Sq. Feet	1,224	1,620	1,700	1,365
Bdrm · Bths · ½ Bths	3 · 2	4 · 2	3 · 2	3 · 2
Total Room #	6	6	6	6
Garage (Style/Stalls)	Attached 1 Car	Attached 2 Car(s)	Attached 1 Car	Attached 2 Car(s)
Basement (Yes/No)	No	No	No	No
Basement (% Fin)	0%	0%	0%	0%
Basement Sq. Ft.	--	--	--	--
Pool/Spa	--	--	--	--
Lot Size	0.38 acres	0.24 acres	0.30 acres	0.26 acres
Other	--	--	--	--
Net Adjustment	--	-\$5,000	\$0	+\$5,000
Adjusted Price	--	\$245,000	\$255,000	\$265,000

* Sold 2 is the most comparable sale to the subject.

¹ Comp's "Miles to Subject" was calculated by the system.

² Comp's "Miles to Subject" provided by Real Estate Professional.

³ Subject \$/ft based upon as-is sale price.

Recent Sales - Cont.

Reasons for Adjustments Why the comparable sale is superior or inferior to the subject.

- Sold 1** Fair market comp located in subject area near all amenities, schools, parks and shopping, comp offered is considered the most suitable listing available for comparison to the subject in today's market with subject's characteristics. Comparable in style, design, quality, age and size. Inferior to subject in acreage. Superior in sqft/bedrms. -5k adjustments made. +-5k acreage/-5k sqft/-5k bedrms.
- Sold 2** Fair market comp located in subject area near all amenities, schools, parks and shopping, comp offered is considered the most suitable listing available for comparison to the subject in today's market with subject's characteristics. Comparable in style, design, quality, age and size. Equal to subject in bed/full baths/age. Inferior in acreage. Superior in sqft. No adjustments made.
- Sold 3** Fair market comp located in subject area near all amenities, schools, parks and shopping, comp offered is considered the most suitable listing available for comparison to the subject in today's market with subject's characteristics. Comparable in style, design, quality, age and size. Superior to subject in sqft. Inferior in acreage/age. +5k adjustments made. -5k sqft/+5k acreage/+5k age.

Subject Sales & Listing History

Current Listing Status	Not Currently Listed			Listing History Comments			
Listing Agency/Firm				subject has not been listed and removed from the market in the last 12 months. Subject has sold 1 time in the last 12 months.			
Listing Agent Name							
Listing Agent Phone							
# of Removed Listings in Previous 12 Months	0						
# of Sales in Previous 12 Months	1						
Original List Date	Original List Price	Final List Date	Final List Price	Result	Result Date	Result Price	Source
12/29/2021	\$199,000	--	--	Sold	01/19/2022	\$185,000	MLS

Marketing Strategy

	As Is Price	Repaired Price
Suggested List Price	\$265,000	\$265,000
Sales Price	\$255,000	\$255,000
30 Day Price	\$245,000	--
Comments Regarding Pricing Strategy		
All comps are verified closed sales. Non realty items were not included in the final value estimate. The comps selected represent the most similar available properties to the subject at the time of the inspection and were selected by sqft, quality and age. Consideration has been given to all factors to include but are not limited to market conditions, financing terms, location subject condition and competition. Subject's house number was on the front, it did not photograph well because of the coloring of the lettering. A neighboring address was used to verify subject's address.		

Clear Capital Quality Assurance Comments Addendum

Reviewer's Notes The broker's as-is conclusion reflects the market for the subject. Comps are within a reasonable distance, relatively current, and accurately reflect the subject's defining characteristics. Thus, the as-is conclusion appears to be adequately supported.

Subject Photos



Front



Address Verification



Street

Listing Photos

L1 104 Lionel Ct
Summerville, SC 29483



Front

L2 226 Moon Dance Lane
Summerville, SC 29483



Front

L3 206 Trillium Ave
Summerville, SC 29483



Front

Sales Photos

S1 210 Woodward Boulevard
Summerville, SC 29483



Front

S2 205 Canaberry Cir
Summerville, SC 29483



Front

S3 118 Bradd St
Summerville, SC 29483



Front

ClearMaps Addendum

Address ★ 202 Canaberry Circle, Summerville, SC 29483

Loan Number 47557

Suggested List \$265,000

Suggested Repaired \$265,000

Sale \$255,000

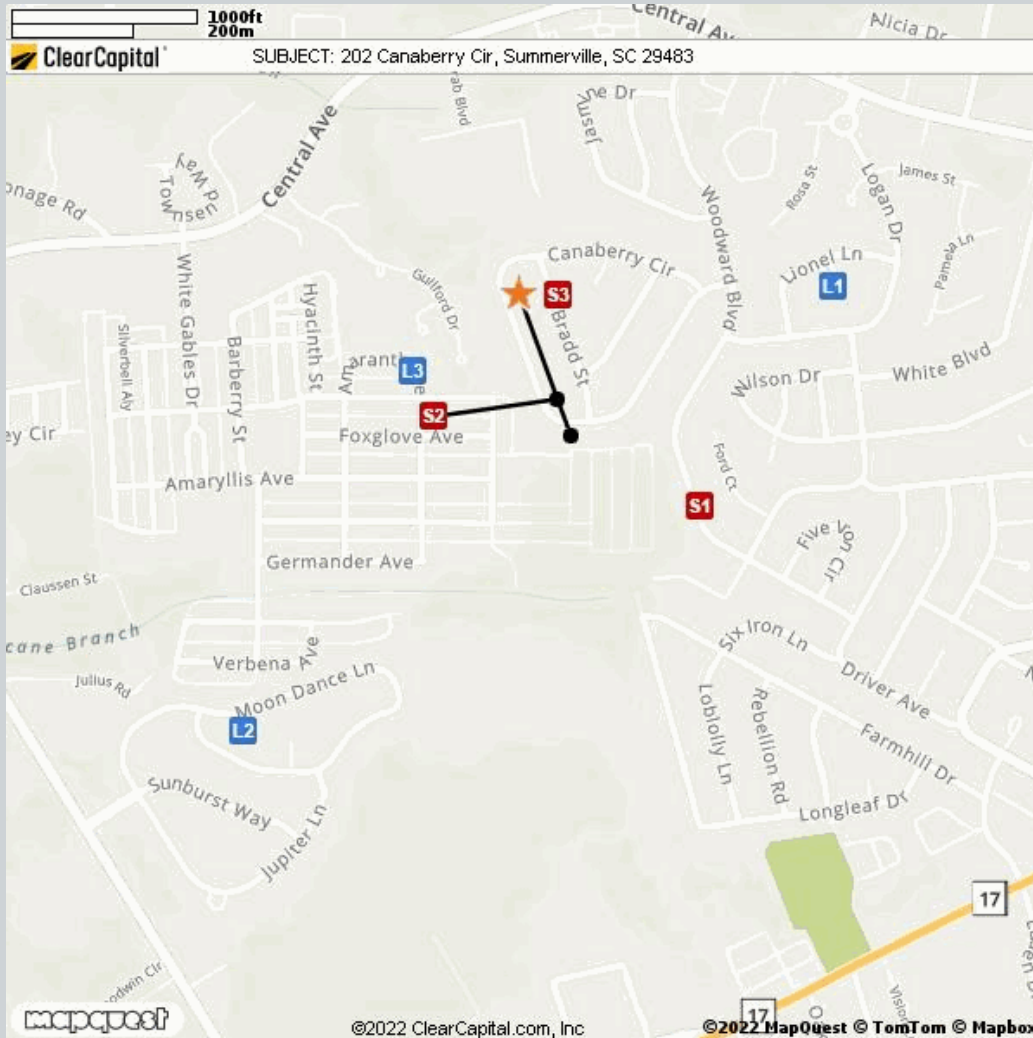

Comparable	Address	Miles to Subject	Mapping Accuracy
★ Subject	202 Canaberry Circle, Summerville, SC 29483	--	Parcel Match
L1 Listing 1	104 Lionel Ct, Summerville, SC 29483	0.41 Miles ¹	Parcel Match
L2 Listing 2	226 Moon Dance Lane, Summerville, SC 29483	0.66 Miles ¹	Parcel Match
L3 Listing 3	206 Trillium Ave, Summerville, SC 29483	0.26 Miles ¹	Parcel Match
S1 Sold 1	210 Woodward Boulevard, Summerville, SC 29483	0.21 Miles ¹	Parcel Match
S2 Sold 2	205 Canaberry Cir, Summerville, SC 29483	0.06 Miles ¹	Parcel Match
S3 Sold 3	118 Bradd St, Summerville, SC 29483	0.19 Miles ¹	Parcel Match

¹ The Comparable "Distance from Subject" value has been calculated by the Clear Capital system.

² The Comparable "Distance from Subject" value has been provided by the Real Estate Professional.

Addendum: Report Purpose

Market Approach and Market Time

The Market Approach of this report, as established by the customer, is: **Fair Market Price**. (See definition below.)

The Marketing Time as specified by the customer is **Typical**. (See definition below.)

Definitions:

Fair Market Price

A price at which the property would sell between a willing buyer and a willing seller neither being compelled by undue pressure and both having reasonable knowledge of relevant facts.

Distressed Price

A price at which the property would sell between a willing buyer and a seller acting under duress.

Marketing Time

The amount of time the property is exposed to a pool of prospective buyers before going into contract. The customer either specifies the number of days, requests a marketing time that is typical to the subject's market area and/or requests an abbreviated marketing time.

Typical for Local Market

The estimated time required to adequately expose the subject property to the market resulting in a contract of sale.

Addendum: Report Purpose - cont.

Report Instructions

This section shows the instructions that were approved by the customer and provided to the broker prior to completing the report.

Instructions last updated: 7/17/2017

Purpose:

Please determine a fair market price for this property at which it would sell in a typical marketing time for the area.

Customer Specific Requests:

If the property is commercial or mixed use, please stop and contact Clear Capital as soon as possible

Form Help:

There are blue question marks (?) throughout this form. These are designed to offer guidance for that particular section of the form. Please click on them for help.

Comparable Requirements:

1. Please use fair market comps from the same neighborhood, block or subdivision whenever possible.
2. Please only use REO comparables if the market is driven by REOs and they are comparable in characteristics and condition.
3. Please use comps that have closed in the past 3 months to show the current market conditions or comment in the report if this is not possible. In rapidly changing markets, active listing comps should be given equal or greater weight than sold comps in your analysis.

Standard Instructions:

1. Clear Capital Code Of Conduct - Please make sure that you are always abiding by the Clear Capital Code of Conduct when completing valuation reports.
2. If the subject is currently listed, please consider all available information pertaining to the subject's condition. This information should be utilized when developing the assumption of the subject's condition.
3. Use the subject characteristics provided in the report Grid (if preloaded) to evaluate the property. This information is from a full interior appraisal and is assumed to be most accurate. If your inspection reveals obvious inaccuracies, please explain in the narrative of the report.
4. Include sufficient detail to help our mutual customer gain a complete understanding of the subject's neighborhood such as neighborhood desirability, amenities, parks, schools, commercial or industrial influences, REO activity, traffic, board-up-homes, etc.
5. Do not approach occupants or owners.
6. If the subject is a Commercial property, contact Clear Capital immediately at 530-582-5011 for direction on how to proceed with the report.
7. Please do not accept if you or your office has completed a report on this property in the last month, are currently listing this property, or have any vested interest in the subject property.
8. Clear Capital does not allow any log ins from IP addresses from foreign countries. This includes, but is not limited to; data entry services, form completion services, etc. Also, it is against Clear Capital code of conduct to share your password with anyone who is not a W2 employee in your office.
9. Clear Capital and our mutual customers greatly appreciate your expertise. If you cannot personally inspect the property, select comparables, and determine a price for the subject, please do not accept this report. Per the standards and guidelines adopted by Clear Capital and other industry leaders, the use of assistants to complete any of the aforementioned tasks is not permitted.

Report Instructions - cont.

Due to the importance of an independent opinion of price, please do not discuss your price with anyone or be influenced by list price, pending offers, accept comp packets, repair estimates or the listing agent's opinion.

1. One current, original photo of the front of the subject 2. One address verification photo 3. One street scene photo looking down the street 4. MLS listing and sold comp photos required, please comment if no MLS.

Broker Information

Broker Name	Barbara Knowell	Company/Brokerage	B K REALTY & ASSOCIATES, INC
License No	16644	Address	6650 Rivers Ave North Charleston SC 29406
License Expiration	06/30/2023	License State	SC
Phone	8435090466	Email	bkrealty7@att.net
Broker Distance to Subject	12.80 miles	Date Signed	01/21/2022

By confirming the above contact and real estate license information and submitting the report, the above signed hereby certifies and agrees that: 1) I personally took the pictures, selected comparables, and determined the price conclusion. 2) To the best of my knowledge, the statements of fact contained in this report are true and correct. 3) The reported analyses, opinions, and conclusions are my personal, impartial, and unbiased professional analyses, opinions, and conclusions. 4) I have no present or prospective interest in the property that is the subject of this report and no personal interest with respect to the parties involved. 5) I have no bias with respect to the property that is the subject of this report or to the parties involved with this assignment. 6) My compensation for completing this assignment is not contingent upon the development or reporting of a predetermined price point. 7) I did not base, either partially or completely, my analysis and/or opinion and conclusions in this report on race, color, religion, sex, age, marital status, handicap, familial status, or national origin of either the prospective owners or occupants of the subject property or of the present owners or occupants of the properties in the vicinity of the subject property or on any other basis prohibited by law. 8) I maintain errors and omissions insurance, to the extent required by state law, for all liability associated with the preparation of this Report.

Disclaimer

This market analysis may not be used for the purposes of obtaining financing in a federally-related transaction.

Unless otherwise specifically agreed to in writing:

The intended purpose of this report is to assist the Clear Capital account holder in making decisions within the scope of applicable statutory and regulatory requirements and performing required due diligence. This document is provided solely for the use of the Clear Capital account holder and not any other party, is not intended as any guarantee of value and/or condition of the subject property and should not be relied on as such. In the event that this document is found to be defective, incorrect, negligently prepared or unfit for its authorized use, Clear Capital's sole liability shall be to promptly refund the total fee expended by the account holder for this report or to replace it at no charge to the account holder, but in no event shall Clear Capital be responsible to the account holder for any indirect or consequential damages whatsoever. This warranty is in lieu of all other warranties, express or implied, except where otherwise required by law. The account holder shall notify Clear Capital within thirty (30) days of this report's delivery to the account holder if it believes that this document is defective, incorrect, negligently prepared or unfit for its authorized use. Under no circumstances may Clear Capital forms or their contents be published, copied, replicated, or mimicked.