

Please Note: This report was completed with the following assumptions: Market Approach: **Fair Market Price** , Marketing Time: **Typical** . Important additional information relating to this report, including use and restrictions, is contained in an attached addendum which is an integral part of this report.

Address	1905 Red Cypress Court, Arlington, TEXAS 76012	Order ID	7997501	Property ID	32234044
Inspection Date	02/25/2022	Date of Report	02/25/2022		
Loan Number	48329	APN	02262495		
Borrower Name	Breckenridge Property Fund 2016 LLC	County	Tarrant		

Tracking IDs					
Order Tracking ID	47494	Tracking ID 1	47494		
Tracking ID 2	--	Tracking ID 3	--		

General Conditions

General Conditions		Condition Comments
Owner	MARLYCE GARRETT	Subject appears in average condition with only typical wear and tear visible and no areas of defect or damage observed; Landscaping is maintained and compliments the exterior; Subject conforms well with the neighborhood and exhibits typical curb appeal; The quality and type of the construction matches the build trends of this area;
R. E. Taxes	\$3,260	
Assessed Value	\$290,145	
Zoning Classification	Residential	
Property Type	SFR	
Occupancy	Occupied	
Ownership Type	Fee Simple	
Property Condition	Average	
Estimated Exterior Repair Cost	\$0	
Estimated Interior Repair Cost	\$0	
Total Estimated Repair	\$0	
HOA	No	
Visible From Street	Visible	
Road Type	Public	

Neighborhood & Market Data

Neighborhood & Market Data		Neighborhood Comments
Location Type	Suburban	Established neighborhood located in one of the more mature parts of the of the city; A number of large trees line the street adding character and desirability; Properties conform reasonably well to each other with above curb appeal; Area contains places of worship, schools, parks, retail, shopping and highways with access to local area attractions such as the amusement parks and professional sports stadiums;
Local Economy	Stable	
Sales Prices in this Neighborhood	Low: \$292000 High: \$514600	
Market for this type of property	Remained Stable for the past 6 months.	
Normal Marketing Days	<30	

Current Listings

	Subject	Listing 1	Listing 2 *	Listing 3
Street Address	1905 Red Cypress Court	1715 Park Hill Dr	1707 Lincrest Ct	1827 Waterwood Dr
City, State	Arlington, TEXAS	Arlington, TX	Arlington, TX	Arlington, TX
Zip Code	76012	76012	76012	76012
Datasource	Tax Records	MLS	MLS	MLS
Miles to Subj.	--	0.24 ¹	0.12 ¹	0.03 ¹
Property Type	SFR	SFR	SFR	SFR
Original List Price \$	\$	\$364,900	\$365,000	\$409,000
List Price \$	--	\$364,900	\$365,000	\$409,000
Original List Date		02/14/2022	02/10/2022	01/27/2022
DOM · Cumulative DOM	-- · --	10 · 11	14 · 15	28 · 29
Age (# of years)	45	54	45	46
Condition	Average	Average	Average	Average
Sales Type	--	Fair Market Value	Fair Market Value	Fair Market Value
Location	Neutral ; Residential	Neutral ; Residential	Neutral ; Residential	Neutral ; Residential
View	Neutral ; Residential	Neutral ; Residential	Neutral ; Residential	Neutral ; Residential
Style/Design	1 Story Traditional	1 Story Traditional	1 Story Traditional	1 Story Traditional
# Units	1	1	1	1
Living Sq. Feet	2,390	2,185	2,214	2,484
Bdrm · Bths · ½ Bths	3 · 3	4 · 2	4 · 2	4 · 2 · 1
Total Room #	10	8	8	10
Garage (Style/Stalls)	Attached 2 Car(s)	None	Attached 2 Car(s)	Attached 2 Car(s)
Basement (Yes/No)	No	No	No	No
Basement (% Fin)	0%	0%	0%	0%
Basement Sq. Ft.	--	--	--	--
Pool/Spa	--	--	--	Pool - Yes
Lot Size	0.15 acres	0.20 acres	0.24 acres	0.18 acres
Other	Updates	Updates	Updates	Updates

* Listing 2 is the most comparable listing to the subject.

¹ Comp's "Miles to Subject" was calculated by the system.

² Comp's "Miles to Subject" provided by Real Estate Professional.

³ Subject \$/ft based upon as-is sale price.

Listing Comments Why the comparable listing is superior or inferior to the subject.

Listing 1 Listing is the most comparable in size, number of rooms, age and build quality; Dissimilar in bath/bedroom count and square footage;

Listing 2 Listing is the most comparable in location, age, number of rooms, size and build quality; Dissimilar in bed/bathroom count;

Listing 3 Listing is the most in construction quality, age, number of rooms and size; Dissimilar in bedroom count and amenities;

Recent Sales

	Subject	Sold 1 *	Sold 2	Sold 3
Street Address	1905 Red Cypress Court	2105 Stonehill Ct	1906 Briarcrest Ln	1808 Elmhurst Dr
City, State	Arlington, TEXAS	Arlington, TX	Arlington, TX	Arlington, TX
Zip Code	76012	76012	76012	76012
Datasource	Tax Records	MLS	MLS	MLS
Miles to Subj.	--	0.17 ¹	0.20 ¹	0.46 ¹
Property Type	SFR	SFR	SFR	SFR
Original List Price \$	--	\$349,900	\$350,000	\$349,000
List Price \$	--	\$361,000	\$350,000	\$359,000
Sale Price \$	--	\$361,000	\$350,000	\$359,000
Type of Financing	--	Conv	Fha	Conv
Date of Sale	--	03/30/2021	08/27/2021	12/28/2021
DOM · Cumulative DOM	-- · --	39 · 39	37 · 37	88 · 88
Age (# of years)	45	45	44	53
Condition	Average	Average	Average	Average
Sales Type	--	Fair Market Value	Fair Market Value	Fair Market Value
Location	Neutral ; Residential	Neutral ; Residential	Neutral ; Residential	Neutral ; Residential
View	Neutral ; Residential	Neutral ; Residential	Neutral ; Residential	Neutral ; Residential
Style/Design	1 Story Traditional	1 Story Traditional	1 Story Traditional	1 Story Traditional
# Units	1	1	1	1
Living Sq. Feet	2,390	2,459	2,417	2,281
Bdrm · Bths · ½ Bths	3 · 3	4 · 2 · 1	4 · 3	4 · 2
Total Room #	10	9	9	10
Garage (Style/Stalls)	Attached 2 Car(s)	Attached 2 Car(s)	Attached 2 Car(s)	Attached 2 Car(s)
Basement (Yes/No)	No	No	No	No
Basement (% Fin)	0%	0%	0%	0%
Basement Sq. Ft.	--	--	--	--
Pool/Spa	--	--	--	Pool - Yes
Lot Size	0.15 acres	0.29 acres	0.23 acres	0.29 acres
Other	Updates	Updates	Updates	Updates
Net Adjustment	--	-\$4,000	-\$4,000	-\$8,000
Adjusted Price	--	\$357,000	\$346,000	\$351,000

* Sold 1 is the most comparable sale to the subject.

¹ Comp's "Miles to Subject" was calculated by the system.

² Comp's "Miles to Subject" provided by Real Estate Professional.

³ Subject \$/ft based upon as-is sale price.

Reasons for Adjustments Why the comparable sale is superior or inferior to the subject.

Sold 1 Listing is the most comparable in size, number of rooms, amenities, build quality and location; Adjustments for dissimilar bedroom count;

Sold 2 Listing is the most comparable in views, build quality, size and number of rooms; Adjustment for dissimilar bedroom count;

Sold 3 Listing is the most comparable in age, number of rooms, and size; Adjustment for dissimilar bedroom count;

Subject Sales & Listing History

Current Listing Status	Not Currently Listed			Listing History Comments			
Listing Agency/Firm				No previous sales information available in either the MLS or public records.			
Listing Agent Name							
Listing Agent Phone							
# of Removed Listings in Previous 12 Months	0						
# of Sales in Previous 12 Months	1						
Original List Date	Original List Price	Final List Date	Final List Price	Result	Result Date	Result Price	Source
12/27/2021	\$320,000	--	--	Sold	02/23/2022	\$330,100	MLS

Marketing Strategy

	As Is Price	Repaired Price
Suggested List Price	\$365,000	\$365,000
Sales Price	\$355,000	\$355,000
30 Day Price	\$347,000	--
Comments Regarding Pricing Strategy		
<p>The final price point was determined by near even comparison between the current and sold listings. The variance in values was relatively modest while there appears to be a flat trend. Due to the fact that values are stable and most of the sold listings days on the market are within what is typical for this area, the final valuation will reflect a more aggressive value. The final valuation is for a fair market value set to encourage the requested marketing period for this area.</p>		

Clear Capital Quality Assurance Comments Addendum

Reviewer's The current report has included the most current and most proximate data available to support the price conclusion. The broker's comps are
Notes appropriate for the subject's attributes, surrounding amenities and market conditions. Thus, the price conclusion appears to be adequately supported

Subject Photos



Front



Address Verification



Street

Listing Photos

L1 1715 Park Hill Dr
Arlington, TX 76012



Front

L2 1707 Lincrest Ct
Arlington, TX 76012



Front

L3 1827 Waterwood Dr
Arlington, TX 76012



Front

Sales Photos

S1 2105 Stonehill Ct
Arlington, TX 76012



Front

S2 1906 Briarcrest Ln
Arlington, TX 76012



Front

S3 1808 Elmhurst Dr
Arlington, TX 76012



Front

ClearMaps Addendum

Address ★ 1905 Red Cypress Court, Arlington, TEXAS 76012

Loan Number 48329

Suggested List \$365,000

Suggested Repaired \$365,000

Sale \$355,000

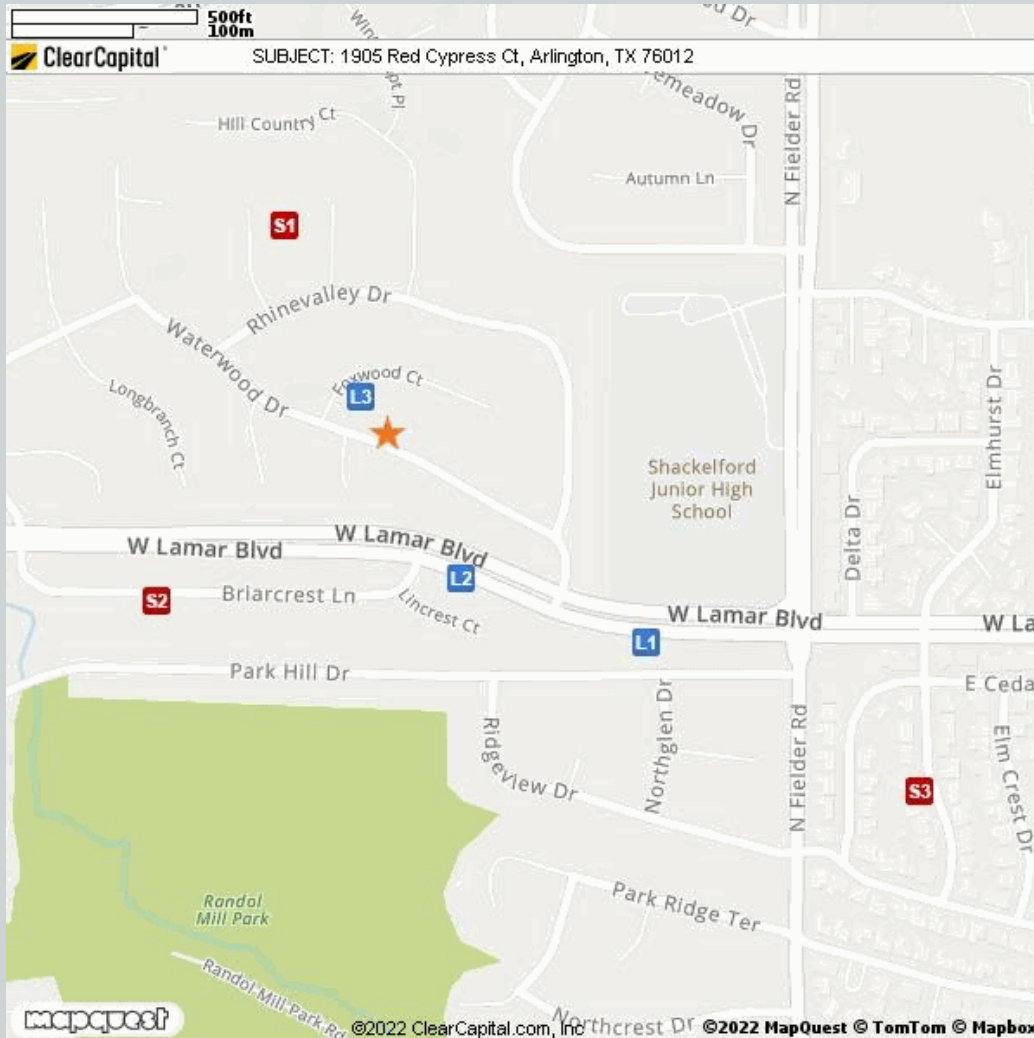

Comparable

Comparable	Address	Miles to Subject	Mapping Accuracy
★ Subject	1905 Red Cypress Court, Arlington, Texas 76012	--	Parcel Match
L1 Listing 1	1715 Park Hill Dr, Arlington, TX 76012	0.24 Miles ¹	Parcel Match
L2 Listing 2	1707 Lincrest Ct, Arlington, TX 76012	0.12 Miles ¹	Parcel Match
L3 Listing 3	1827 Waterwood Dr, Arlington, TX 76012	0.03 Miles ¹	Parcel Match
S1 Sold 1	2105 Stonehill Ct, Arlington, TX 76012	0.17 Miles ¹	Parcel Match
S2 Sold 2	1906 Briarcrest Ln, Arlington, TX 76012	0.20 Miles ¹	Parcel Match
S3 Sold 3	1808 Elmhurst Dr, Arlington, TX 76012	0.46 Miles ¹	Parcel Match

¹ The Comparable "Distance from Subject" value has been calculated by the Clear Capital system.

² The Comparable "Distance from Subject" value has been provided by the Real Estate Professional.

Addendum: Report Purpose

Market Approach and Market Time

The Market Approach of this report, as established by the customer, is: **Fair Market Price**. (See definition below.)

The Marketing Time as specified by the customer is **Typical**. (See definition below.)

Definitions:

Fair Market Price

A price at which the property would sell between a willing buyer and a willing seller neither being compelled by undue pressure and both having reasonable knowledge of relevant facts.

Distressed Price

A price at which the property would sell between a willing buyer and a seller acting under duress.

Marketing Time

The amount of time the property is exposed to a pool of prospective buyers before going into contract. The customer either specifies the number of days, requests a marketing time that is typical to the subject's market area and/or requests an abbreviated marketing time.

Typical for Local Market

The estimated time required to adequately expose the subject property to the market resulting in a contract of sale.

Addendum: Report Purpose - cont.

Report Instructions

This section shows the instructions that were approved by the customer and provided to the broker prior to completing the report.

*** Please Note: This is a RUSH assignment. Do not accept if you cannot meet the current due date and time. Please reference the set terms and contact Clear Capital at 530.582.5011 if you require any changes. Thanks! ***

Instructions last updated: 7/17/2017

Purpose:

Please determine a fair market price for this property at which it would sell in a typical marketing time for the area.

Customer Specific Requests:

If the property is commercial or mixed use, please stop and contact Clear Capital as soon as possible

Form Help:

There are blue question marks (?) throughout this form. These are designed to offer guidance for that particular section of the form. Please click on them for help.

Comparable Requirements:

1. Please use fair market comps from the same neighborhood, block or subdivision whenever possible.
2. Please only use REO comparables if the market is driven by REOs and they are comparable in characteristics and condition.
3. Please use comps that have closed in the past 3 months to show the current market conditions or comment in the report if this is not possible. In rapidly changing markets, active listing comps should be given equal or greater weight than sold comps in your analysis.

Standard Instructions:

1. Clear Capital Code Of Conduct - Please make sure that you are always abiding by the Clear Capital Code of Conduct when completing valuation reports.
2. If the subject is currently listed, please consider all available information pertaining to the subject's condition. This information should be utilized when developing the assumption of the subject's condition.
3. Use the subject characteristics provided in the report Grid (if preloaded) to evaluate the property. This information is from a full interior appraisal and is assumed to be most accurate. If your inspection reveals obvious inaccuracies, please explain in the narrative of the report.
4. Include sufficient detail to help our mutual customer gain a complete understanding of the subject's neighborhood such as neighborhood desirability, amenities, parks, schools, commercial or industrial influences, REO activity, traffic, board-up-homes, etc.
5. Do not approach occupants or owners.
6. If the subject is a Commercial property, contact Clear Capital immediately at 530-582-5011 for direction on how to proceed with the report.
7. Please do not accept if you or your office has completed a report on this property in the last month, are currently listing this property, or have any vested interest in the subject property.
8. Clear Capital does not allow any log ins from IP addresses from foreign countries. This includes, but is not limited to; data entry services, form completion services, etc. Also, it is against Clear Capital code of conduct to share your password with anyone who is not a W2 employee in your office.
9. Clear Capital and our mutual customers greatly appreciate your expertise. If you cannot

Report Instructions - cont.

personally inspect the property, select comparables, and determine a price for the subject, please do not accept this report. Per the standards and guidelines adopted by Clear Capital and other industry leaders, the use of assistants to complete any of the aforementioned tasks is not permitted.

Due to the importance of an independent opinion of price, please do not discuss your price with anyone or be influenced by list price, pending offers, accept comp packets, repair estimates or the listing agent's opinion.

1. One current, original photo of the front of the subject 2. One address verification photo 3. One street scene photo looking down the street 4. MLS listing and sold comp photos required, please comment if no MLS.

Broker Information

Broker Name	LaToya Flanigan	Company/Brokerage	Avid Real Estate, LLC
License No	533322	Address	4405 Huntsman Ridge Lane arlington TX 76005
License Expiration	04/30/2022	License State	TX
Phone	8173718692	Email	support@myavidre.com
Broker Distance to Subject	4.44 miles	Date Signed	02/25/2022

By confirming the above contact and real estate license information and submitting the report, the above signed hereby certifies and agrees that: 1) I personally took the pictures, selected comparables, and determined the price conclusion. 2) To the best of my knowledge, the statements of fact contained in this report are true and correct. 3) The reported analyses, opinions, and conclusions are my personal, impartial, and unbiased professional analyses, opinions, and conclusions. 4) I have no present or prospective interest in the property that is the subject of this report and no personal interest with respect to the parties involved. 5) I have no bias with respect to the property that is the subject of this report or to the parties involved with this assignment. 6) My compensation for completing this assignment is not contingent upon the development or reporting of a predetermined price point. 7) I did not base, either partially or completely, my analysis and/or opinion and conclusions in this report on race, color, religion, sex, age, marital status, handicap, familial status, or national origin of either the prospective owners or occupants of the subject property or of the present owners or occupants of the properties in the vicinity of the subject property or on any other basis prohibited by law. 8) I maintain errors and omissions insurance, to the extent required by state law, for all liability associated with the preparation of this Report.

Disclaimer

THIS REPORT SHOULD NOT BE CONSIDERED AN APPRAISAL. In making any decision that relies upon my work, you should know that I have not followed the guidelines for development of an appraisal or analysis contained in the Uniform Standards of Professional Appraisal Practice of the Appraisal Foundation.

Unless otherwise specifically agreed to in writing:

The intended purpose of this report is to assist the Clear Capital account holder in making decisions within the scope of applicable statutory and regulatory requirements and performing required due diligence. This document is provided solely for the use of the Clear Capital account holder and not any other party, is not intended as any guarantee of value and/or condition of the subject property and should not be relied on as such. In the event that this document is found to be defective, incorrect, negligently prepared or unfit for its authorized use, Clear Capital's sole liability shall be to promptly refund the total fee expended by the account holder for this report or to replace it at no charge to the account holder, but in no event shall Clear Capital be responsible to the account holder for any indirect or consequential damages whatsoever. This warranty is in lieu of all other warranties, express or implied, except where otherwise required by law. The account holder shall notify Clear Capital within thirty (30) days of this report's delivery to the account holder if it believes that this document is defective, incorrect, negligently prepared or unfit for its authorized use. Under no circumstances may Clear Capital forms or their contents be published, copied, replicated, or mimicked.