

Please Note: This report was completed with the following assumptions: Market Approach: **Fair Market Price** , Marketing Time: **Typical** . Important additional information relating to this report, including use and restrictions, is contained in an attached addendum which is an integral part of this report.

Address	3133 Market Center Drive, Rockwall, TX 75032	Order ID	8006114	Property ID	32251982
Inspection Date	03/01/2022	Date of Report	03/02/2022		
Loan Number	48408	APN	000000052941		
Borrower Name	Breckenridge Property Fund 2016 LLC	County	Rockwall		

Tracking IDs					
Order Tracking ID	02.28.22 BPO	Tracking ID 1	02.28.22 BPO		
Tracking ID 2	--	Tracking ID 3	--		

General Conditions

Owner	Sexton Mickel	Condition Comments	
R. E. Taxes	\$7,265	The subject is in average condition with no major repairs noted at the time of inspection.	
Assessed Value	\$375,140		
Zoning Classification	SFR		
Property Type	SFR		
Occupancy	Occupied		
Ownership Type	Fee Simple		
Property Condition	Average		
Estimated Exterior Repair Cost	\$0		
Estimated Interior Repair Cost	\$0		
Total Estimated Repair	\$0		
HOA	No		
Visible From Street	Visible		
Road Type	Public		

Neighborhood & Market Data

Location Type	Suburban	Neighborhood Comments	
Local Economy	Stable	The subject is located in an area that consists of mostly of conventional style SFR homes of various ages, displaying general similarity in design, appeal and utility, with variations in size.	
Sales Prices in this Neighborhood	Low: \$390,000 High: \$470,000		
Market for this type of property	Remained Stable for the past 6 months.		
Normal Marketing Days	<90		

Current Listings

	Subject	Listing 1	Listing 2 *	Listing 3
Street Address	3133 Market Center Drive	141 Kirkhaven Drive	2842 Wild Oak	7909 Amesbury Lane
City, State	Rockwall, TX	Rockwall, TX	Rockwall, TX	Rowlett, TX
Zip Code	75032	75032	75032	75089
Datasource	Tax Records	MLS	MLS	MLS
Miles to Subj.	--	0.08 ¹	1.17 ¹	4.35 ¹
Property Type	SFR	SFR	SFR	SFR
Original List Price \$	\$	\$430,000	\$450,000	\$449,900
List Price \$	--	\$430,000	\$450,000	\$449,900
Original List Date		02/07/2022	02/10/2022	02/07/2022
DOM · Cumulative DOM	-- · --	10 · 23	8 · 20	4 · 23
Age (# of years)	20	20	19	19
Condition	Average	Average	Average	Average
Sales Type	--	Fair Market Value	Fair Market Value	Fair Market Value
Location	Neutral ; Residential	Neutral ; Residential	Neutral ; Residential	Neutral ; Residential
View	Neutral ; Residential	Neutral ; Residential	Neutral ; Residential	Neutral ; Residential
Style/Design	2 Stories Colonial	2 Stories Colonial	2 Stories Colonial	2 Stories Colonial
# Units	1	1	1	1
Living Sq. Feet	4,822	3,487	3,753	3,464
Bdrm · Bths · ½ Bths	4 · 2 · 1	5 · 2 · 1	5 · 3	5 · 3
Total Room #	8	9	10	10
Garage (Style/Stalls)	Attached 2 Car(s)	Attached 2 Car(s)	Attached 2 Car(s)	Attached 2 Car(s)
Basement (Yes/No)	No	No	No	No
Basement (% Fin)	0%	0%	0%	0%
Basement Sq. Ft.	--	--	--	--
Pool/Spa	--	--	--	--
Lot Size	0.16 acres	0.16 acres	0.16 acres	0.18 acres
Other	None	None	None	None

* Listing 2 is the most comparable listing to the subject.

¹ Comp's "Miles to Subject" was calculated by the system.

² Comp's "Miles to Subject" provided by Real Estate Professional.

³ Subject \$/ft based upon as-is sale price.

Listing Comments Why the comparable listing is superior or inferior to the subject.

Listing 1 Single family detached home, fair market, same style, average condition, similar in year built, 5/2.5 floor plan, no basement, has garage, no pool, inferior GLA.

Listing 2 Single family detached home, fair market, same style, average condition, similar in year built, 5/3 floor plan, no basement, has garage, no pool, inferior GLA.

Listing 3 Single family detached home, fair market, same style, 5/3 floor plan, no basement, average condition, similar in year built, has garage, no pool, inferior GLA.

Recent Sales

	Subject	Sold 1 *	Sold 2	Sold 3
Street Address	3133 Market Center Drive	130 Wembley Way	139 Wembley Way	161 Kirkhaven Drive
City, State	Rockwall, TX	Rockwall, TX	Rockwall, TX	Rockwall, TX
Zip Code	75032	75032	75032	75032
Datasource	Tax Records	MLS	MLS	MLS
Miles to Subj.	--	0.08 ¹	0.12 ¹	0.14 ¹
Property Type	SFR	SFR	SFR	SFR
Original List Price \$	--	\$425,000	\$439,000	\$437,500
List Price \$	--	\$425,000	\$439,000	\$437,500
Sale Price \$	--	\$445,000	\$425,000	\$410,000
Type of Financing	--	Conventional	Conventional	Conventional
Date of Sale	--	06/24/2021	12/27/2021	09/09/2021
DOM · Cumulative DOM	-- · --	3 · 34	5 · 45	49 · 70
Age (# of years)	20	22	23	20
Condition	Average	Average	Average	Average
Sales Type	--	Fair Market Value	Fair Market Value	Fair Market Value
Location	Neutral ; Residential	Neutral ; Residential	Neutral ; Residential	Neutral ; Residential
View	Neutral ; Residential	Neutral ; Residential	Neutral ; Residential	Neutral ; Residential
Style/Design	2 Stories Colonial	2 Stories Colonial	2 Stories Colonial	2 Stories Colonial
# Units	1	1	1	1
Living Sq. Feet	4,822	3,931	3,892	3,503
Bdrm · Bths · ½ Bths	4 · 2 · 1	6 · 4 · 1	4 · 2 · 1	4 · 3 · 1
Total Room #	8	12	8	9
Garage (Style/Stalls)	Attached 2 Car(s)	Attached 2 Car(s)	Attached 2 Car(s)	Attached 2 Car(s)
Basement (Yes/No)	No	No	No	No
Basement (% Fin)	0%	0%	0%	0%
Basement Sq. Ft.	--	--	--	--
Pool/Spa	--	--	Pool - Yes	Pool - Yes
Lot Size	0.16 acres	0.16 acres	0.15 acres	0.26 acres
Other	None	None	None	None
Net Adjustment	--	+\$6,620	+\$14,820	+\$19,180
Adjusted Price	--	\$451,620	\$439,820	\$429,180

* Sold 1 is the most comparable sale to the subject.

¹ Comp's "Miles to Subject" was calculated by the system.

² Comp's "Miles to Subject" provided by Real Estate Professional.

³ Subject \$/ft based upon as-is sale price.

Recent Sales - Cont.

Reasons for Adjustments Why the comparable sale is superior or inferior to the subject.

- Sold 1** Single family detached home, fair market, same style, average condition, similar in year built, 6/4.5 floor plan, no basement, has garage, no pool, inferior GLA. -8000 bedroom, -4000 fbath, 17820 GLA, 800 year built.
- Sold 2** Single family detached home, fair market, same style, average condition, similar in year built, 4/2.5 floor plan, no basement, has garage, no pool, inferior GLA. 20 lot size, -5000 pool, 18600 GLA, 1200 year built.
- Sold 3** Single family detached home, fair market, same style, average condition, similar in year built, 4/3.5 floor plan, no basement, has garage, no pool, inferior GLA. -200 lot size, -5000 pool, -2000 fbath, 26380 GLA.

Subject Sales & Listing History

Current Listing Status	Not Currently Listed	Listing History Comments					
Listing Agency/Firm		N/A					
Listing Agent Name							
Listing Agent Phone							
# of Removed Listings in Previous 12 Months	0						
# of Sales in Previous 12 Months	0						
Original List Date	Original List Price	Final List Date	Final List Price	Result	Result Date	Result Price	Source

Marketing Strategy

	As Is Price	Repaired Price
Suggested List Price	\$450,000	\$450,000
Sales Price	\$440,000	\$440,000
30 Day Price	\$430,000	--
Comments Regarding Pricing Strategy		
<p>Search for comparable market sales and listings was focused on the home's immediate market area, providing comps that reside within direct competition to the subject. All comps offered feature an interior size that remains within 20% of the home's interior size, and offer a maturity that remains within +/-30 years of the subject in age. Comp selection was focused on providing FMV transactions, while also offering recent market sales. The subject should be valued with recent market sales, offering a consistent and accurate market value for the home. Due to limited available market data for similar properties in the subject's immediate neighborhood, it was necessary to utilize comps with a variance in GLA, lotsize, age, style, expand proximity guidelines and slightly outside the allowable price threshold. It brackets the subject well in regards to size, style and condition. Sale date criteria was expanded over 6 months in date to attain comparable sales which have sold within a 12 month time frame.</p>		

Clear Capital Quality Assurance Comments Addendum

Reviewer's The broker's as-is conclusion reflects the market for the subject. Comps are within a reasonable distance, relatively current, and accurately reflect
Notes the subject's defining characteristics. Thus, the as-is conclusion appears to be adequately supported.

Subject Photos



Front



Address Verification



Address Verification



Address Verification



Street

Listing Photos

L1 141 Kirkhaven Drive
Rockwall, TX 75032



Front

L2 2842 Wild Oak
Rockwall, TX 75032



Front

L3 7909 Amesbury Lane
Rowlett, TX 75089



Front

Sales Photos

S1 130 Wembley Way
Rockwall, TX 75032



Front

S2 139 Wembley Way
Rockwall, TX 75032



Front

S3 161 Kirkhaven Drive
Rockwall, TX 75032



Front

ClearMaps Addendum

Address ★ 3133 Market Center Drive, Rockwall, TX 75032
Loan Number 48408 **Suggested List** \$450,000 **Suggested Repaired** \$450,000 **Sale** \$440,000

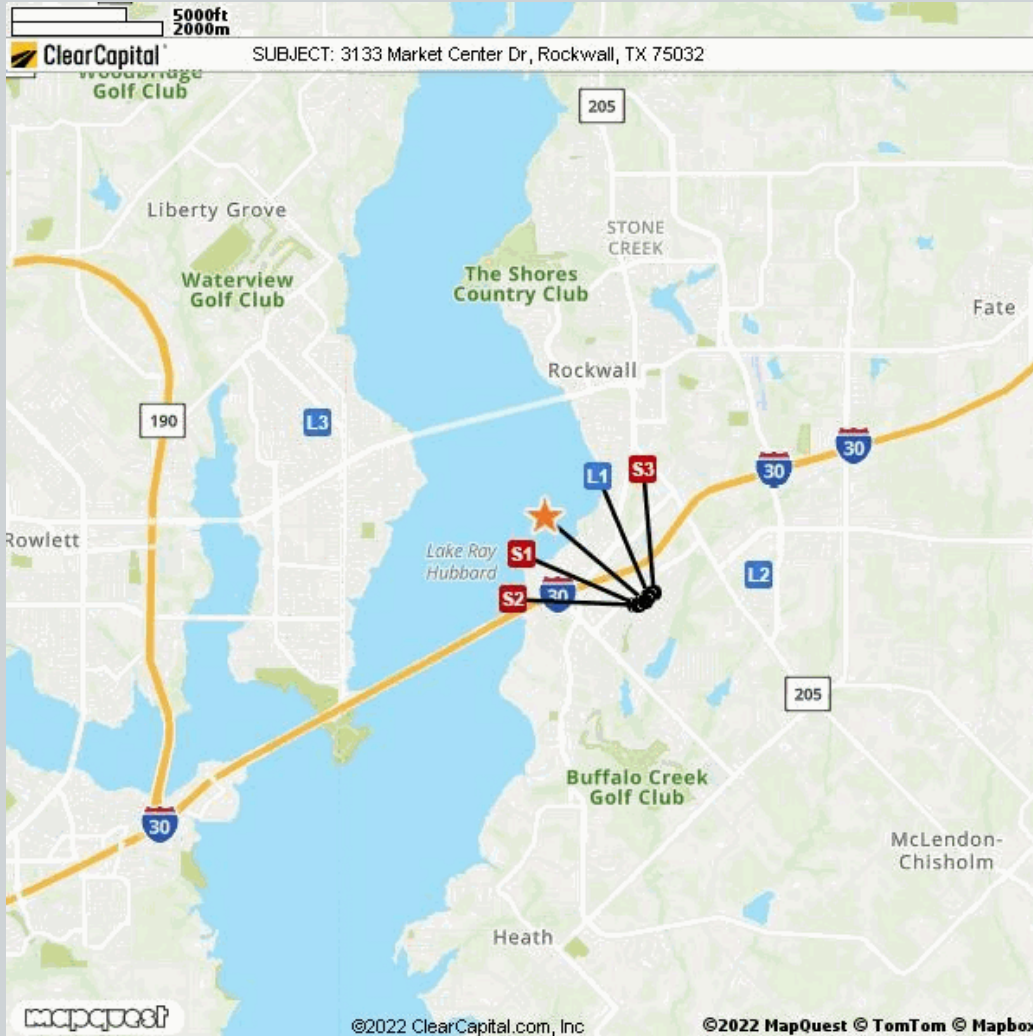

Comparable	Address	Miles to Subject	Mapping Accuracy
★ Subject	3133 Market Center Drive, Rockwall, TX 75032	--	Parcel Match
L1 Listing 1	141 Kirkhaven Drive, Rockwall, TX 75032	0.08 Miles ¹	Parcel Match
L2 Listing 2	2842 Wild Oak, Rockwall, TX 75032	1.17 Miles ¹	Parcel Match
L3 Listing 3	7909 Amesbury Lane, Rowlett, TX 75089	4.35 Miles ¹	Parcel Match
S1 Sold 1	130 Wembley Way, Rockwall, TX 75032	0.08 Miles ¹	Parcel Match
S2 Sold 2	139 Wembley Way, Rockwall, TX 75032	0.12 Miles ¹	Parcel Match
S3 Sold 3	161 Kirkhaven Drive, Rockwall, TX 75032	0.14 Miles ¹	Parcel Match

¹ The Comparable "Distance from Subject" value has been calculated by the Clear Capital system.
² The Comparable "Distance from Subject" value has been provided by the Real Estate Professional.

Addendum: Report Purpose

Market Approach and Market Time

The Market Approach of this report, as established by the customer, is: **Fair Market Price**. (See definition below.)

The Marketing Time as specified by the customer is **Typical**. (See definition below.)

Definitions:

Fair Market Price	A price at which the property would sell between a willing buyer and a willing seller neither being compelled by undue pressure and both having reasonable knowledge of relevant facts.
Distressed Price	A price at which the property would sell between a willing buyer and a seller acting under duress.
Marketing Time	The amount of time the property is exposed to a pool of prospective buyers before going into contract. The customer either specifies the number of days, requests a marketing time that is typical to the subject's market area and/or requests an abbreviated marketing time.
Typical for Local Market	The estimated time required to adequately expose the subject property to the market resulting in a contract of sale.

Addendum: Report Purpose - cont.

Report Instructions

This section shows the instructions that were approved by the customer and provided to the broker prior to completing the report.

*** Please Note: This is a RUSH assignment. Do not accept if you cannot meet the current due date and time. Please reference the set terms and contact Clear Capital at 530.582.5011 if you require any changes. Thanks! ***

Instructions last updated: 7/17/2017

Purpose:

Please determine a fair market price for this property at which it would sell in a typical marketing time for the area.

Customer Specific Requests:

If the property is commercial or mixed use, please stop and contact Clear Capital as soon as possible

Form Help:

There are blue question marks (?) throughout this form. These are designed to offer guidance for that particular section of the form. Please click on them for help.

Comparable Requirements:

1. Please use fair market comps from the same neighborhood, block or subdivision whenever possible.
2. Please only use REO comparables if the market is driven by REOs and they are comparable in characteristics and condition.
3. Please use comps that have closed in the past 3 months to show the current market conditions or comment in the report if this is not possible. In rapidly changing markets, active listing comps should be given equal or greater weight than sold comps in your analysis.

Standard Instructions:

1. Clear Capital Code Of Conduct - Please make sure that you are always abiding by the Clear Capital Code of Conduct when completing valuation reports.
2. If the subject is currently listed, please consider all available information pertaining to the subject's condition. This information should be utilized when developing the assumption of the subject's condition.
3. Use the subject characteristics provided in the report Grid (if preloaded) to evaluate the property. This information is from a full interior appraisal and is assumed to be most accurate. If your inspection reveals obvious inaccuracies, please explain in the narrative of the report.
4. Include sufficient detail to help our mutual customer gain a complete understanding of the subject's neighborhood such as neighborhood desirability, amenities, parks, schools, commercial or industrial influences, REO activity, traffic, board-up-homes, etc.
5. Do not approach occupants or owners.
6. If the subject is a Commercial property, contact Clear Capital immediately at 530-582-5011 for direction on how to proceed with the report.
7. Please do not accept if you or your office has completed a report on this property in the last month, are currently listing this property, or have any vested interest in the subject property.
8. Clear Capital does not allow any log ins from IP addresses from foreign countries. This includes, but is not limited to; data entry services, form completion services, etc. Also, it is against Clear Capital code of conduct to share your password with anyone who is not a W2 employee in your office.

Report Instructions - cont.

9. Clear Capital and our mutual customers greatly appreciate your expertise. If you cannot personally inspect the property, select comparables, and determine a price for the subject, please do not accept this report. Per the standards and guidelines adopted by Clear Capital and other industry leaders, the use of assistants to complete any of the aforementioned tasks is not permitted.

Due to the importance of an independent opinion of price, please do not discuss your price with anyone or be influenced by list price, pending offers, accept comp packets, repair estimates or the listing agent's opinion.

1. One current, original photo of the front of the subject 2. One address verification photo 3. One street scene photo looking down the street 4. MLS listing and sold comp photos required, please comment if no MLS.

Broker Information

Broker Name	Rashundra Hawkins	Company/Brokerage	Rashundra Hawkins
License No	541428	Address	1617 Grand Court Royse City TX 75189
License Expiration	08/31/2022	License State	TX
Phone	2146161613	Email	rhawkinsre@gmail.com
Broker Distance to Subject	9.78 miles	Date Signed	03/02/2022

By confirming the above contact and real estate license information and submitting the report, the above signed hereby certifies and agrees that: 1) I personally took the pictures, selected comparables, and determined the price conclusion. 2) To the best of my knowledge, the statements of fact contained in this report are true and correct. 3) The reported analyses, opinions, and conclusions are my personal, impartial, and unbiased professional analyses, opinions, and conclusions. 4) I have no present or prospective interest in the property that is the subject of this report and no personal interest with respect to the parties involved. 5) I have no bias with respect to the property that is the subject of this report or to the parties involved with this assignment. 6) My compensation for completing this assignment is not contingent upon the development or reporting of a predetermined price point. 7) I did not base, either partially or completely, my analysis and/or opinion and conclusions in this report on race, color, religion, sex, age, marital status, handicap, familial status, or national origin of either the prospective owners or occupants of the subject property or of the present owners or occupants of the properties in the vicinity of the subject property or on any other basis prohibited by law. 8) I maintain errors and omissions insurance, to the extent required by state law, for all liability associated with the preparation of this Report.

Disclaimer

THIS REPORT SHOULD NOT BE CONSIDERED AN APPRAISAL. In making any decision that relies upon my work, you should know that I have not followed the guidelines for development of an appraisal or analysis contained in the Uniform Standards of Professional Appraisal Practice of the Appraisal Foundation.

Unless otherwise specifically agreed to in writing:

The intended purpose of this report is to assist the Clear Capital account holder in making decisions within the scope of applicable statutory and regulatory requirements and performing required due diligence. This document is provided solely for the use of the Clear Capital account holder and not any other party, is not intended as any guarantee of value and/or condition of the subject property and should not be relied on as such. In the event that this document is found to be defective, incorrect, negligently prepared or unfit for its authorized use, Clear Capital's sole liability shall be to promptly refund the total fee expended by the account holder for this report or to replace it at no charge to the account holder, but in no event shall Clear Capital be responsible to the account holder for any indirect or consequential damages whatsoever. This warranty is in lieu of all other warranties, express or implied, except where otherwise required by law. The account holder shall notify Clear Capital within thirty (30) days of this report's delivery to the account holder if it believes that this document is defective, incorrect, negligently prepared or unfit for its authorized use. Under no circumstances may Clear Capital forms or their contents be published, copied, replicated, or mimicked.