

Please Note: This report was completed with the following assumptions: Market Approach: **Fair Market Price** , Marketing Time: **Typical** . Important additional information relating to this report, including use and restrictions, is contained in an attached addendum which is an integral part of this report.

Address	1418 Santa Rosa Street, Oceanside, CALIFORNIA 92058	Order ID	8444660	Property ID	33346461
Inspection Date	09/28/2022	Date of Report	09/28/2022		
Loan Number	48955	APN	144-092-19-00		
Borrower Name	Redwood Holdings LLC	County	San Diego		

Tracking IDs

Order Tracking ID	09.26.22 BPO	Tracking ID 1	09.26.22 BPO
Tracking ID 2	--	Tracking ID 3	--

General Conditions

Owner	Redwood Holdings LLC	Condition Comments Subject is in average condition and has been well maintained
R. E. Taxes	\$5,029	
Assessed Value	\$446,749	
Zoning Classification	r1	
Property Type	SFR	
Occupancy	Occupied	
Ownership Type	Fee Simple	
Property Condition	Average	
Estimated Exterior Repair Cost	\$0	
Estimated Interior Repair Cost	\$0	
Total Estimated Repair	\$0	
HOA	No	
Visible From Street	Visible	
Road Type	Public	

Neighborhood & Market Data

Location Type	Suburban	Neighborhood Comments Subject is located close to schools, shopping and freeway access.
Local Economy	Stable	
Sales Prices in this Neighborhood	Low: \$650,000 High: \$850,000	
Market for this type of property	Remained Stable for the past 6 months.	
Normal Marketing Days	<90	

Current Listings

	Subject	Listing 1	Listing 2 *	Listing 3
Street Address	1418 Santa Rosa Street	1016 San Juan	2538 Mesa	301 Archer St
City, State	Oceanside, CALIFORNIA	Oceanside, CA	Oceanside, CA	Oceanside, CA
Zip Code	92058	92058	92054	92058
Datasource	Tax Records	MLS	MLS	MLS
Miles to Subj.	--	0.10 ¹	1.26 ¹	1.00 ¹
Property Type	SFR	SFR	SFR	SFR
Original List Price \$	\$	\$765,000	\$829,000	\$749,000
List Price \$	--	\$765,000	\$829,000	\$749,000
Original List Date		07/07/2022	08/15/2022	09/22/2022
DOM · Cumulative DOM	-- · --	82 · 83	18 · 44	2 · 6
Age (# of years)	68	68	66	44
Condition	Average	Average	Average	Average
Sales Type	--	Fair Market Value	Fair Market Value	Fair Market Value
Location	Neutral ; Residential	Neutral ; Residential	Neutral ; Residential	Neutral ; Residential
View	Neutral ; Residential	Neutral ; Residential	Neutral ; Residential	Neutral ; Residential
Style/Design	1 Story contemp	1 Story contemp	1 Story contemp	1 Story contemp
# Units	1	1	1	1
Living Sq. Feet	1,159	899	1,164	1,000
Bdrm · Bths · ½ Bths	3 · 2	3 · 1	3 · 2	3 · 1
Total Room #	6	5	6	5
Garage (Style/Stalls)	Attached 1 Car	Attached 1 Car	Attached 2 Car(s)	Attached 2 Car(s)
Basement (Yes/No)	No	No	No	No
Basement (% Fin)	0%	0%	0%	0%
Basement Sq. Ft.	--	--	--	--
Pool/Spa	--	--	--	--
Lot Size	.14 acres	.13 acres	.18 acres	.14 acres
Other	--	--	--	--

* Listing 2 is the most comparable listing to the subject.

¹ Comp's "Miles to Subject" was calculated by the system.

² Comp's "Miles to Subject" provided by Real Estate Professional.

³ Subject \$/ft based upon as-is sale price.

Listing Comments Why the comparable listing is superior or inferior to the subject.

Listing 1 Equal in appeal of style, quality, exterior features and general likeness.

Listing 2 Equal in general condition with similar upkeep and appearance and likeness.

Listing 3 Equal in location, near to schools and shopping and homes of similar age, style and cond

Recent Sales

	Subject	Sold 1	Sold 2 *	Sold 3
Street Address	1418 Santa Rosa Street	1236 Langford	708 San Luis Rey Drive	808 Santa Paula St
City, State	Oceanside, CALIFORNIA	Oceanside, CA	Oceanside, CA	Oceanside, CA
Zip Code	92058	92058	92058	92058
Datasource	Tax Records	MLS	MLS	MLS
Miles to Subj.	--	0.64 ¹	0.76 ¹	0.60 ¹
Property Type	SFR	SFR	SFR	SFR
Original List Price \$	--	\$734,000	\$745,000	\$780,000
List Price \$	--	\$734,000	\$745,000	\$780,000
Sale Price \$	--	\$734,000	\$745,000	\$780,000
Type of Financing	--	Conv	Conv	Conv
Date of Sale	--	05/27/2022	08/29/2022	05/17/2022
DOM · Cumulative DOM	-- · --	4 · 30	28 · 79	8 · 25
Age (# of years)	68	60	67	68
Condition	Average	Average	Average	Average
Sales Type	--	Fair Market Value	Fair Market Value	Fair Market Value
Location	Neutral ; Residential	Neutral ; Residential	Neutral ; Residential	Neutral ; Residential
View	Neutral ; Residential	Neutral ; Residential	Neutral ; Residential	Neutral ; Residential
Style/Design	1 Story contemp	1 Story contemp	1 Story contemp	1 Story contemp
# Units	1	1	1	1
Living Sq. Feet	1,159	1,000	1,227	1,012
Bdrm · Bths · ½ Bths	3 · 2	3 · 2	3 · 1	3 · 2
Total Room #	6	6	5	6
Garage (Style/Stalls)	Attached 1 Car	Attached 1 Car	None	Attached 1 Car
Basement (Yes/No)	No	No	No	No
Basement (% Fin)	0%	0%	0%	0%
Basement Sq. Ft.	--	--	--	--
Pool/Spa	--	--	--	--
Lot Size	.14 acres	.07 acres	.13 acres	.13 acres
Other	--	--	--	--
Net Adjustment	--	+\$4,770	+\$2,000	+\$4,410
Adjusted Price	--	\$738,770	\$747,000	\$784,410

* Sold 2 is the most comparable sale to the subject.

¹ Comp's "Miles to Subject" was calculated by the system.

² Comp's "Miles to Subject" provided by Real Estate Professional.

³ Subject \$/ft based upon as-is sale price.

Reasons for Adjustments Why the comparable sale is superior or inferior to the subject.

Sold 1 gla 4770 Equal in general area of similar type styled homes, similar in age, size and condition

Sold 2 bth 1000 grg 1000 Equal in general area of similar type styled homes

Sold 3 gla 4410 Equal in location, close to schools and shopping

Subject Sales & Listing History

Current Listing Status	Not Currently Listed			Listing History Comments			
Listing Agency/Firm				none			
Listing Agent Name							
Listing Agent Phone							
# of Removed Listings in Previous 12 Months	0						
# of Sales in Previous 12 Months	0						
Original List Date	Original List Price	Final List Date	Final List Price	Result	Result Date	Result Price	Source

Marketing Strategy

	As Is Price	Repaired Price
Suggested List Price	\$765,000	\$765,000
Sales Price	\$750,000	\$750,000
30 Day Price	\$740,000	--
Comments Regarding Pricing Strategy		
<p>It was necessary to extend search parameters in order to find the most comparable listings. There is an inventory shortage. All comparables are taken from similar neighborhoods. Subject property is noted to be in average condition from the exterior and is located in a residential area of similar homes with no adverse external influences noticed. I went back 12 months, out in distance 2 miles, and even with relaxing gla search criteria I was unable to find any comps which fit the requirements. Within 2 miles and back 12 months I found 10 comps of which I could only use 3 due to lot size factors. The ones used are the best possible currently available comps within 2 miles and the adjustments are sufficient for this area to account for the differences in the subject and comps</p>		

Clear Capital Quality Assurance Comments Addendum

Reviewer's Notes The broker's as-is conclusion reflects the market for the subject. Comps are within a reasonable distance, relatively current, and accurately reflect the subject's defining characteristics. Thus, the as-is conclusion appears to be adequately supported.

Subject Photos



Front



Address Verification

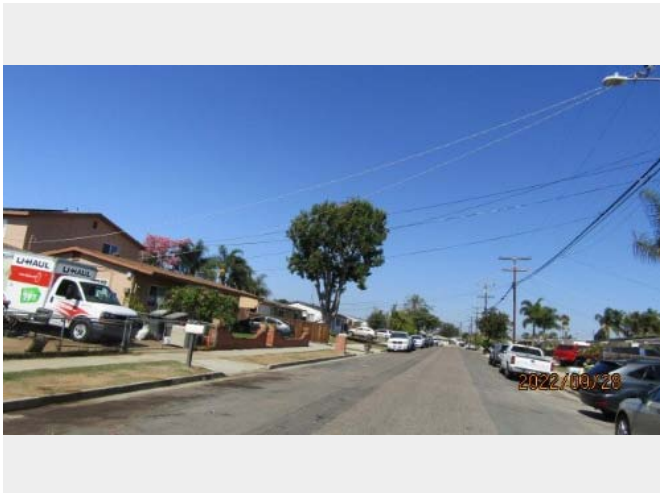

Street

Listing Photos

L1 1016 San Juan
Oceanside, CA 92058



Front

L2 2538 Mesa
Oceanside, CA 92054



Front

L3 301 Archer St
Oceanside, CA 92058



Front

Sales Photos

S1 1236 Langford
Oceanside, CA 92058



Front

S2 708 San Luis Rey Drive
Oceanside, CA 92058



Front

S3 808 Santa Paula St
Oceanside, CA 92058



Front

ClearMaps Addendum

Address ★ 1418 Santa Rosa Street, Oceanside, CALIFORNIA 92058

Loan Number 48955

Suggested List \$765,000

Suggested Repaired \$765,000

Sale \$750,000

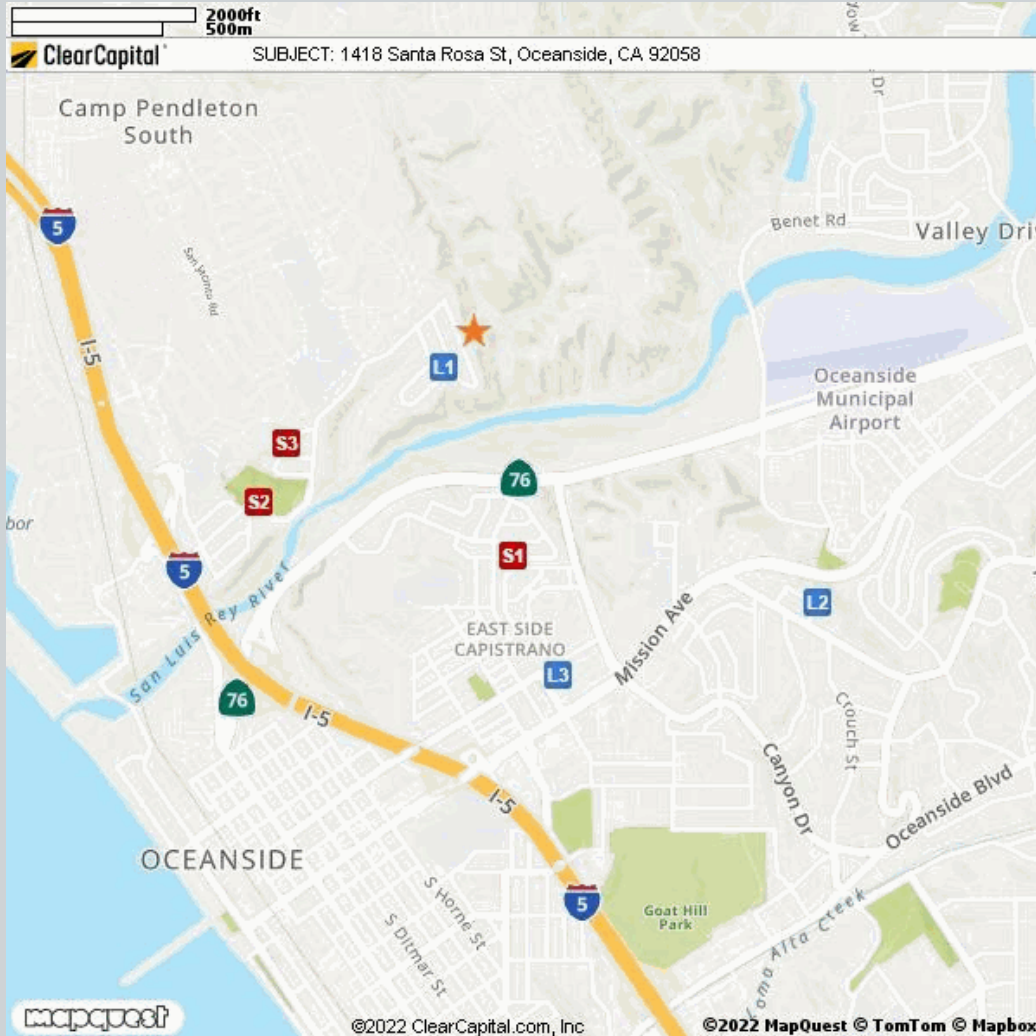

Comparable

Address

Miles to Subject

Mapping Accuracy

★	Subject	1418 Santa Rosa Street, Oceanside, California 92058	--	Parcel Match
L1	Listing 1	1016 San Juan, Oceanside, CA 92058	0.10 Miles ¹	Parcel Match
L2	Listing 2	2538 Mesa, Oceanside, CA 92058	1.26 Miles ¹	Parcel Match
L3	Listing 3	301 Archer St, Oceanside, CA 92058	1.00 Miles ¹	Parcel Match
S1	Sold 1	1236 Langford, Oceanside, CA 92058	0.64 Miles ¹	Parcel Match
S2	Sold 2	708 San Luis Rey Drive, Oceanside, CA 92058	0.76 Miles ¹	Parcel Match
S3	Sold 3	808 Santa Paula St, Oceanside, CA 92058	0.60 Miles ¹	Parcel Match

¹ The Comparable "Distance from Subject" value has been calculated by the Clear Capital system.

² The Comparable "Distance from Subject" value has been provided by the Real Estate Professional.

Addendum: Report Purpose

Market Approach and Market Time

The Market Approach of this report, as established by the customer, is: **Fair Market Price**. (See definition below.)

The Marketing Time as specified by the customer is **Typical**. (See definition below.)

Definitions:

Fair Market Price

A price at which the property would sell between a willing buyer and a willing seller neither being compelled by undue pressure and both having reasonable knowledge of relevant facts.

Distressed Price

A price at which the property would sell between a willing buyer and a seller acting under duress.

Marketing Time

The amount of time the property is exposed to a pool of prospective buyers before going into contract. The customer either specifies the number of days, requests a marketing time that is typical to the subject's market area and/or requests an abbreviated marketing time.

Typical for Local Market

The estimated time required to adequately expose the subject property to the market resulting in a contract of sale.

Addendum: Report Purpose - cont.

Report Instructions

This section shows the instructions that were approved by the customer and provided to the broker prior to completing the report.

Instructions last updated: 7/17/2017

Purpose:

Please determine a fair market price for this property at which it would sell in a typical marketing time for the area.

Customer Specific Requests:

If the property is commercial or mixed use, please stop and contact Clear Capital as soon as possible

Form Help:

There are blue question marks (?) throughout this form. These are designed to offer guidance for that particular section of the form. Please click on them for help.

Comparable Requirements:

1. Please use fair market comps from the same neighborhood, block or subdivision whenever possible.
2. Please only use REO comparables if the market is driven by REOs and they are comparable in characteristics and condition.
3. Please use comps that have closed in the past 3 months to show the current market conditions or comment in the report if this is not possible. In rapidly changing markets, active listing comps should be given equal or greater weight than sold comps in your analysis.

Standard Instructions:

1. Clear Capital Code Of Conduct - Please make sure that you are always abiding by the Clear Capital Code of Conduct when completing valuation reports.
2. If the subject is currently listed, please consider all available information pertaining to the subject's condition. This information should be utilized when developing the assumption of the subject's condition.
3. Use the subject characteristics provided in the report Grid (if preloaded) to evaluate the property. This information is from a full interior appraisal and is assumed to be most accurate. If your inspection reveals obvious inaccuracies, please explain in the narrative of the report.
4. Include sufficient detail to help our mutual customer gain a complete understanding of the subject's neighborhood such as neighborhood desirability, amenities, parks, schools, commercial or industrial influences, REO activity, traffic, board-up-homes, etc.
5. Do not approach occupants or owners.
6. If the subject is a Commercial property, contact Clear Capital immediately at 530-582-5011 for direction on how to proceed with the report.
7. Please do not accept if you or your office has completed a report on this property in the last month, are currently listing this property, or have any vested interest in the subject property.
8. Clear Capital does not allow any log ins from IP addresses from foreign countries. This includes, but is not limited to; data entry services, form completion services, etc. Also, it is against Clear Capital code of conduct to share your password with anyone who is not a W2 employee in your office.
9. Clear Capital and our mutual customers greatly appreciate your expertise. If you cannot personally inspect the property, select comparables, and determine a price for the subject, please do not accept this report. Per the standards and guidelines adopted by Clear Capital and other industry leaders, the use of assistants to complete any of the aforementioned tasks is not permitted.

Report Instructions - cont.

Due to the importance of an independent opinion of price, please do not discuss your price with anyone or be influenced by list price, pending offers, accept comp packets, repair estimates or the listing agent's opinion.

1. One current, original photo of the front of the subject 2. One address verification photo 3. One street scene photo looking down the street 4. MLS listing and sold comp photos required, please comment if no MLS.

Broker Information

Broker Name	Colleen Barnhart	Company/Brokerage	Realty Source
License No	01335263	Address	4706 rose Dr oceanside CA 92056
License Expiration	04/22/2026	License State	CA
Phone	7606876210	Email	colleen@76af.com
Broker Distance to Subject	6.36 miles	Date Signed	09/28/2022

By confirming the above contact and real estate license information and submitting the report, the above signed hereby certifies and agrees that: 1) I personally took the pictures, selected comparables, and determined the price conclusion. 2) To the best of my knowledge, the statements of fact contained in this report are true and correct. 3) The reported analyses, opinions, and conclusions are my personal, impartial, and unbiased professional analyses, opinions, and conclusions. 4) I have no present or prospective interest in the property that is the subject of this report and no personal interest with respect to the parties involved. 5) I have no bias with respect to the property that is the subject of this report or to the parties involved with this assignment. 6) My compensation for completing this assignment is not contingent upon the development or reporting of a predetermined price point. 7) I did not base, either partially or completely, my analysis and/or opinion and conclusions in this report on race, color, religion, sex, age, marital status, handicap, familial status, or national origin of either the prospective owners or occupants of the subject property or of the present owners or occupants of the properties in the vicinity of the subject property or on any other basis prohibited by law. 8) I maintain errors and omissions insurance, to the extent required by state law, for all liability associated with the preparation of this Report.

Disclaimer

This document is not an appraisal as defined by USPAP (Uniform Standards of Professional Appraisal Practice). It is not to be construed as an appraisal and may not be used as such for any purpose.

Unless otherwise specifically agreed to in writing:

The intended purpose of this report is to assist the Clear Capital account holder in making decisions within the scope of applicable statutory and regulatory requirements and performing required due diligence. This document is provided solely for the use of the Clear Capital account holder and not any other party, is not intended as any guarantee of value and/or condition of the subject property and should not be relied on as such. In the event that this document is found to be defective, incorrect, negligently prepared or unfit for its authorized use, Clear Capital's sole liability shall be to promptly refund the total fee expended by the account holder for this report or to replace it at no charge to the account holder, but in no event shall Clear Capital be responsible to the account holder for any indirect or consequential damages whatsoever. This warranty is in lieu of all other warranties, express or implied, except where otherwise required by law. The account holder shall notify Clear Capital within thirty (30) days of this report's delivery to the account holder if it believes that this document is defective, incorrect, negligently prepared or unfit for its authorized use. Under no circumstances may Clear Capital forms or their contents be published, copied, replicated, or mimicked.