

Please Note: This report was completed with the following assumptions: Market Approach: **Fair Market Price** , Marketing Time: **Typical** . Important additional information relating to this report, including use and restrictions, is contained in an attached addendum which is an integral part of this report.

Address	3244 S 1000 E, Salt Lake City, UT 84106	Order ID	8555255	Property ID	33745181
Inspection Date	12/19/2022	Date of Report	12/19/2022		
Loan Number	49908	APN	16293300500000		
Borrower Name	Catamount Properties 2018 LLC	County	Salt Lake		

Tracking IDs					
Order Tracking ID	20221215_BPO_Update	Tracking ID 1	20221215_BPO_Update		
Tracking ID 2	--	Tracking ID 3	--		

General Conditions		
Owner	CATAMOUNT PROPERTIES 2018 LLC,	Condition Comments The property appears to be in good condition, home windows, doors, roof all look good. Home has good curb appeal
R. E. Taxes	\$2,155	
Assessed Value	\$334,800	
Zoning Classification	Residential 1205	
Property Type	SFR	
Occupancy	Occupied	
Ownership Type	Fee Simple	
Property Condition	Average	
Estimated Exterior Repair Cost	\$0	
Estimated Interior Repair Cost	\$0	
Total Estimated Repair	\$0	
HOA	No	
Visible From Street	Visible	
Road Type	Public	

Neighborhood & Market Data		
Location Type	Suburban	Neighborhood Comments Home is located in a nice clean, well-established neighborhood. Homes are well-maintained and have the curb appeal. There are no short sales in the neighborhood.
Local Economy	Stable	
Sales Prices in this Neighborhood	Low: \$421300 High: \$708500	
Market for this type of property	Decreased 10 % in the past 6 months.	
Normal Marketing Days	>180	

Current Listings

	Subject	Listing 1	Listing 2	Listing 3 *
Street Address	3244 S 1000 E	2936 S 700 E	1325 E Zenith Ave	960 E Fairclough Dr
City, State	Salt Lake City, UT	Salt Lake City, UT	Salt Lake City, UT	Salt Lake City, UT
Zip Code	84106	84106	84106	84106
Datasource	Public Records	MLS	MLS	MLS
Miles to Subj.	--	0.64 ¹	0.74 ¹	0.49 ¹
Property Type	SFR	SFR	SFR	SFR
Original List Price \$	\$	\$475,000	\$575,000	\$615,000
List Price \$	--	\$475,000	\$575,000	\$489,900
Original List Date		08/15/2022	09/20/2022	09/29/2022
DOM · Cumulative DOM	-- · --	126 · 126	89 · 90	80 · 81
Age (# of years)	83	63	73	66
Condition	Average	Average	Average	Average
Sales Type	--	Fair Market Value	Fair Market Value	Fair Market Value
Location	Neutral ; Residential	Neutral ; Residential	Neutral ; Residential	Neutral ; Residential
View	Neutral ; Residential	Neutral ; Mountain	Neutral ; Mountain	Neutral ; Residential
Style/Design	1 Story Bungalow	1 Story Ranch/Rambler	1 Story Bungalow	1 Story Ranch/Rambler
# Units	1	1	1	1
Living Sq. Feet	1,285	999	929	1,208
Bdrm · Bths · ½ Bths	3 · 1 · 1	2 · 1	4 · 1	4 · 1
Total Room #	8	11	11	13
Garage (Style/Stalls)	None	Detached 1 Car	Detached 2 Car(s)	Detached 1 Car
Basement (Yes/No)	Yes	Yes	Yes	Yes
Basement (% Fin)	75%	100%	100%	100%
Basement Sq. Ft.	685	980	929	849
Pool/Spa	--	--	--	--
Lot Size	0.23 acres	0.26 acres	0.14 acres	0.19 acres
Other	--	--	--	--

* Listing 3 is the most comparable listing to the subject.

¹ Comp's "Miles to Subject" was calculated by the system.

² Comp's "Miles to Subject" provided by Real Estate Professional.

³ Subject \$/ft based upon as-is sale price.

Listing Comments Why the comparable listing is superior or inferior to the subject.

Listing 1 | This home is comparable to the subject due to the age of the home as well as the square footage. Homes are also close in size

Listing 2 | This home is comparable to the subject you to the square footage, as well as the age homes are close in style

Listing 3 | This property is the most comparable to the subject you to the square footage, as well as homes are close in lot sizes. However, this home is newer.

Recent Sales

	Subject	Sold 1	Sold 2	Sold 3 *
Street Address	3244 S 1000 E	715 E 3155 S	740 E Barrows Ave	781 E 3155 S
City, State	Salt Lake City, UT	Salt Lake City, UT	Salt Lake City, UT	Salt Lake City, UT
Zip Code	84106	84106	84106	84106
Datasource	Public Records	MLS	MLS	MLS
Miles to Subj.	--	0.40 ¹	0.41 ¹	0.32 ¹
Property Type	SFR	SFR	SFR	SFR
Original List Price \$	--	\$500,000	\$569,000	\$580,000
List Price \$	--	\$500,000	\$569,000	\$580,000
Sale Price \$	--	\$546,800	\$620,000	\$550,000
Type of Financing	--	Conventional	Conventional	Conventional
Date of Sale	--	02/15/2022	03/11/2022	12/16/2021
DOM · Cumulative DOM	-- · --	12 · 12	21 · 21	58 · 58
Age (# of years)	83	92	70	89
Condition	Average	Average	Average	Average
Sales Type	--	Fair Market Value	Fair Market Value	Fair Market Value
Location	Neutral ; Residential	Neutral ; Residential	Neutral ; Residential	Neutral ; Residential
View	Neutral ; Residential	Neutral ; Residential	Neutral ; Residential	Neutral ; Mountain
Style/Design	1 Story Bungalow	1 Story Bungalow	2 Stories Other	1 Story Bungalow
# Units	1	1	1	1
Living Sq. Feet	1,285	957	1,106	1,162
Bdrm · Bths · ½ Bths	3 · 1 · 1	3 · 1	4 · 1	4 · 2
Total Room #	8	10	11	10
Garage (Style/Stalls)	None	Detached 1 Car	Detached 1 Car	Detached 4 Car(s)
Basement (Yes/No)	Yes	Yes	Yes	Yes
Basement (% Fin)	75%	100%	100%	100%
Basement Sq. Ft.	685	457	768	792
Pool/Spa	--	--	--	--
Lot Size	0.23 acres	0.10 acres	0.14 acres	0.14 acres
Other	--	--	--	--
Net Adjustment	--	+\$10,000	-\$10,000	+\$5,000
Adjusted Price	--	\$556,800	\$610,000	\$555,000

* Sold 3 is the most comparable sale to the subject.

¹ Comp's "Miles to Subject" was calculated by the system.

² Comp's "Miles to Subject" provided by Real Estate Professional.

³ Subject \$/ft based upon as-is sale price.

Recent Sales - Cont.

Reasons for Adjustments Why the comparable sale is superior or inferior to the subject.

- Sold 1** This property is comparable to the subject due to the square footage, as well as the age of the home. However, this home is on a smaller lot size. Adjustment made for lot size and square footage difference
- Sold 2** This home is also comparable to the subject you to the square footage, as well as the age again this home is on a smaller lot are adjustment made for age
- Sold 3** This Home is the most comparable to the subject due to the square footage, age however, this home is on a slightly smaller lot size adjustment made accordingly

Subject Sales & Listing History

Current Listing Status	Currently Listed	Listing History Comments					
Listing Agency/Firm	Dimension Realty Services	listing history below					
Listing Agent Name	Brad Olsen						
Listing Agent Phone	801-560-8448						
# of Removed Listings in Previous 12 Months	0						
# of Sales in Previous 12 Months	1						
Original List Date	Original List Price	Final List Date	Final List Price	Result	Result Date	Result Price	Source
04/26/2022	\$480,000	--	--	Sold	05/20/2022	\$450,000	MLS
09/28/2022	\$589,900	12/01/2022	\$534,900	--	--	--	MLS

Marketing Strategy

	As Is Price	Repaired Price
Suggested List Price	\$555,000	\$555,000
Sales Price	\$555,000	\$555,000
30 Day Price	\$555,000	--
Comments Regarding Pricing Strategy		
This home is located in a nice area. Homes in the area are older and well-established homes. Do you have a good curb peel this home would be great for a first time homebuyer starting out or an investor looking for additional income.		

Clear Capital Quality Assurance Comments Addendum

Reviewer's Notes	The broker's as-is conclusion reflects the market for the subject. Comps are within a reasonable distance, relatively current, and accurately reflect the subject's defining characteristics. Thus, the as-is conclusion appears to be adequately supported.
-------------------------	--

Subject Photos



Front



Front



Front



Address Verification



Address Verification

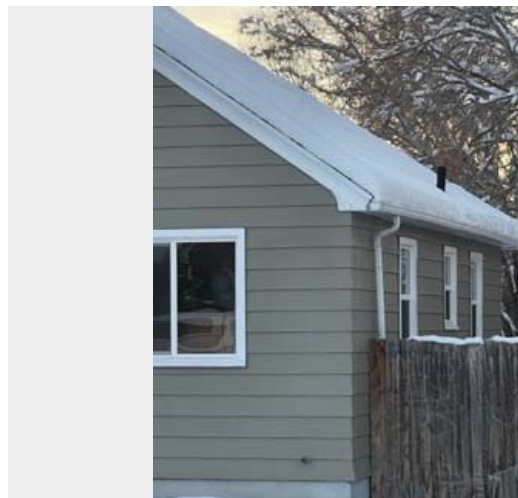

Side

Subject Photos



Side



Street



Street

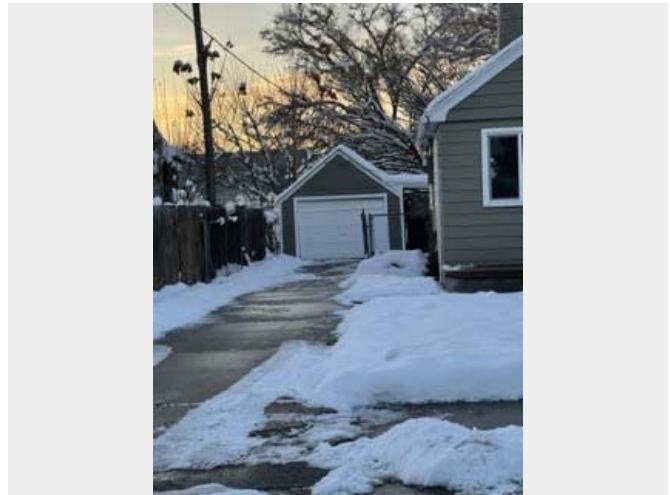

Garage

Listing Photos

L1 2936 S 700 E
Salt Lake City, UT 84106



Front

L2 1325 E Zenith Ave
Salt Lake City, UT 84106



Front

L3 960 E Fairclough Dr
Salt Lake City, UT 84106



Front

Sales Photos

S1 715 E 3155 S
Salt Lake City, UT 84106



Front

S2 740 E Barrows Ave
Salt Lake City, UT 84106



Front

S3 781 E 3155 S
Salt Lake City, UT 84106



Front

ClearMaps Addendum

Address ★ 3244 S 1000 E, Salt Lake City, UT 84106

Loan Number 49908

Suggested List \$555,000

Suggested Repaired \$555,000

Sale \$555,000

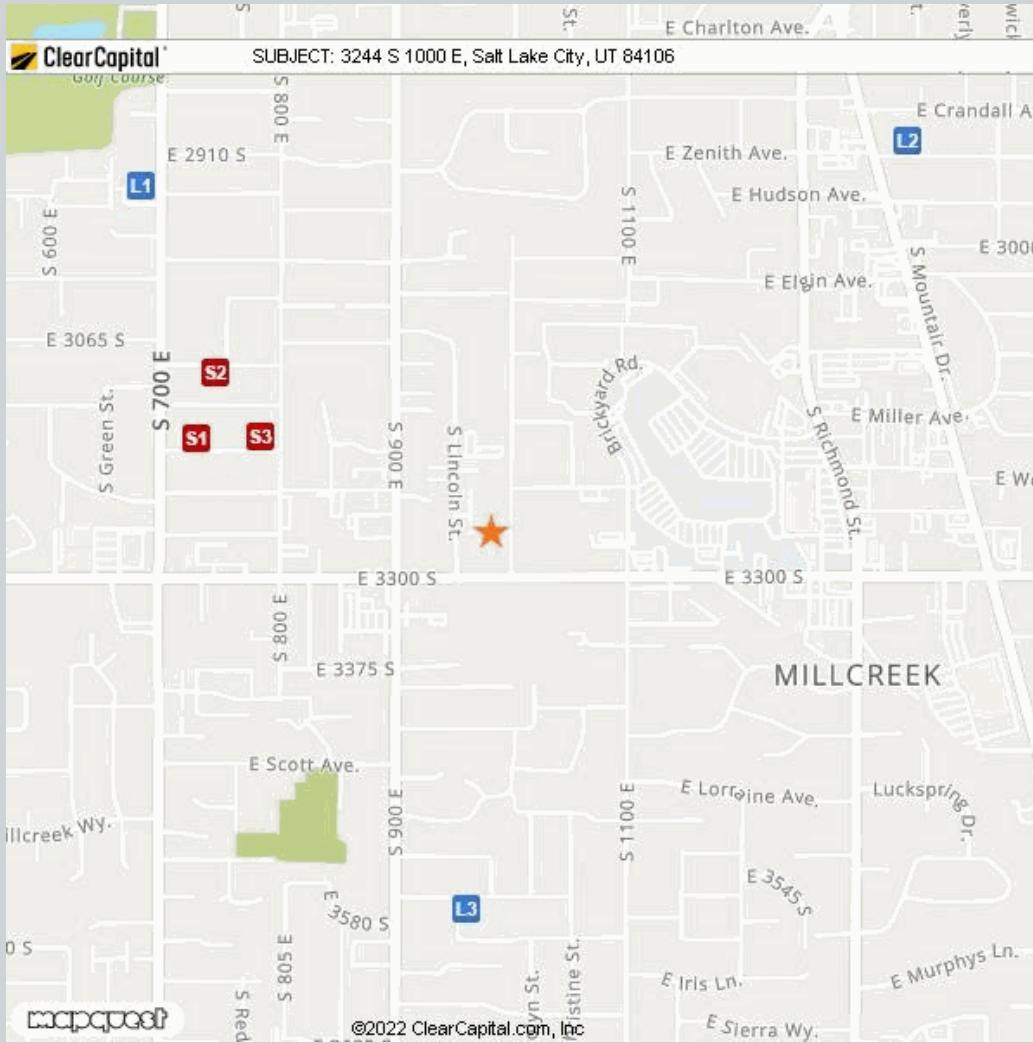

Comparable	Address	Miles to Subject	Mapping Accuracy
★ Subject	3244 S 1000 E, Salt Lake City, Ut 84106	--	Parcel Match
L1 Listing 1	2936 S 700 E, Salt Lake City, UT 84106	0.64 Miles ¹	Parcel Match
L2 Listing 2	1325 E Zenith Ave, Salt Lake City, UT 84106	0.74 Miles ¹	Parcel Match
L3 Listing 3	960 E Fairclough Dr, Salt Lake City, UT 84106	0.49 Miles ¹	Parcel Match
S1 Sold 1	715 E 3155 S, Salt Lake City, UT 84106	0.40 Miles ¹	Parcel Match
S2 Sold 2	740 E Barrows Ave, Salt Lake City, UT 84106	0.41 Miles ¹	Parcel Match
S3 Sold 3	781 E 3155 S, Salt Lake City, UT 84106	0.32 Miles ¹	Parcel Match

¹ The Comparable "Distance from Subject" value has been calculated by the Clear Capital system.

² The Comparable "Distance from Subject" value has been provided by the Real Estate Professional.

Addendum: Report Purpose

Market Approach and Market Time

The Market Approach of this report, as established by the customer, is: **Fair Market Price**. (See definition below.)

The Marketing Time as specified by the customer is **Typical**. (See definition below.)

Definitions:

Fair Market Price	A price at which the property would sell between a willing buyer and a willing seller neither being compelled by undue pressure and both having reasonable knowledge of relevant facts.
Distressed Price	A price at which the property would sell between a willing buyer and a seller acting under duress.
Marketing Time	The amount of time the property is exposed to a pool of prospective buyers before going into contract. The customer either specifies the number of days, requests a marketing time that is typical to the subject's market area and/or requests an abbreviated marketing time.
Typical for Local Market	The estimated time required to adequately expose the subject property to the market resulting in a contract of sale.

Addendum: Report Purpose - cont.

Report Instructions

This section shows the instructions that were approved by the customer and provided to the broker prior to completing the report.

Instructions last updated: 7/17/2017

Purpose:

Please determine a fair market price for this property at which it would sell in a typical marketing time for the area.

Customer Specific Requests:

If the property is commercial or mixed use, please stop and contact Clear Capital as soon as possible

Form Help:

There are blue question marks (?) throughout this form. These are designed to offer guidance for that particular section of the form. Please click on them for help.

Comparable Requirements:

1. Please use fair market comps from the same neighborhood, block or subdivision whenever possible.
2. Please only use REO comparables if the market is driven by REOs and they are comparable in characteristics and condition.
3. Please use comps that have closed in the past 3 months to show the current market conditions or comment in the report if this is not possible. In rapidly changing markets, active listing comps should be given equal or greater weight than sold comps in your analysis.

Standard Instructions:

1. Clear Capital Code Of Conduct - Please make sure that you are always abiding by the Clear Capital Code of Conduct when completing valuation reports.
2. If the subject is currently listed, please consider all available information pertaining to the subject's condition. This information should be utilized when developing the assumption of the subject's condition.
3. Use the subject characteristics provided in the report Grid (if preloaded) to evaluate the property. This information is from a full interior appraisal and is assumed to be most accurate. If your inspection reveals obvious inaccuracies, please explain in the narrative of the report.
4. Include sufficient detail to help our mutual customer gain a complete understanding of the subject's neighborhood such as neighborhood desirability, amenities, parks, schools, commercial or industrial influences, REO activity, traffic, board-up-homes, etc.
5. Do not approach occupants or owners.
6. If the subject is a Commercial property, contact Clear Capital immediately at 530-582-5011 for direction on how to proceed with the report.
7. Please do not accept if you or your office has completed a report on this property in the last month, are currently listing this property, or have any vested interest in the subject property.
8. Clear Capital does not allow any log ins from IP addresses from foreign countries. This includes, but is not limited to; data entry services, form completion services, etc. Also, it is against Clear Capital code of conduct to share your password with anyone who is not a W2 employee in your office.
9. Clear Capital and our mutual customers greatly appreciate your expertise. If you cannot personally inspect the property, select comparables, and determine a price for the subject, please do not accept this report. Per the standards and guidelines adopted by Clear Capital and other industry leaders, the use of assistants to complete any of the aforementioned tasks is not permitted.

Report Instructions - cont.

Due to the importance of an independent opinion of price, please do not discuss your price with anyone or be influenced by list price, pending offers, accept comp packets, repair estimates or the listing agent's opinion.

1. One current, original photo of the front of the subject 2. One address verification photo 3. One street scene photo looking down the street 4. MLS listing and sold comp photos required, please comment if no MLS.

Broker Information

Broker Name	Bethany Baty	Company/Brokerage	Parker Brown Real Estate
License No	9003407	Address	187 W Main St Lehi UT 84043
License Expiration	04/30/2024	License State	UT
Phone	8016648279	Email	bethany@parker-brown.com
Broker Distance to Subject	21.65 miles	Date Signed	12/19/2022

By confirming the above contact and real estate license information and submitting the report, the above signed hereby certifies and agrees that: 1) I personally took the pictures, selected comparables, and determined the price conclusion. 2) To the best of my knowledge, the statements of fact contained in this report are true and correct. 3) The reported analyses, opinions, and conclusions are my personal, impartial, and unbiased professional analyses, opinions, and conclusions. 4) I have no present or prospective interest in the property that is the subject of this report and no personal interest with respect to the parties involved. 5) I have no bias with respect to the property that is the subject of this report or to the parties involved with this assignment. 6) My compensation for completing this assignment is not contingent upon the development or reporting of a predetermined price point. 7) I did not base, either partially or completely, my analysis and/or opinion and conclusions in this report on race, color, religion, sex, age, marital status, handicap, familial status, or national origin of either the prospective owners or occupants of the subject property or of the present owners or occupants of the properties in the vicinity of the subject property or on any other basis prohibited by law. 8) I maintain errors and omissions insurance, to the extent required by state law, for all liability associated with the preparation of this Report.

Disclaimer

This document is not an appraisal as defined by USPAP (Uniform Standards of Professional Appraisal Practice). It is not to be construed as an appraisal and may not be used as such for any purpose.

Unless otherwise specifically agreed to in writing:

The intended purpose of this report is to assist the Clear Capital account holder in making decisions within the scope of applicable statutory and regulatory requirements and performing required due diligence. This document is provided solely for the use of the Clear Capital account holder and not any other party, is not intended as any guarantee of value and/or condition of the subject property and should not be relied on as such. In the event that this document is found to be defective, incorrect, negligently prepared or unfit for its authorized use, Clear Capital's sole liability shall be to promptly refund the total fee expended by the account holder for this report or to replace it at no charge to the account holder, but in no event shall Clear Capital be responsible to the account holder for any indirect or consequential damages whatsoever. This warranty is in lieu of all other warranties, express or implied, except where otherwise required by law. The account holder shall notify Clear Capital within thirty (30) days of this report's delivery to the account holder if it believes that this document is defective, incorrect, negligently prepared or unfit for its authorized use. Under no circumstances may Clear Capital forms or their contents be published, copied, replicated, or mimicked.