

Please Note: This report was completed with the following assumptions: Market Approach: **Fair Market Price** , Marketing Time: **Typical** . Important additional information relating to this report, including use and restrictions, is contained in an attached addendum which is an integral part of this report.

Address	2938 Weaver Avenue, Billings, MT 59101	Order ID	9103648	Property ID	34969092
Inspection Date	01/15/2024	Date of Report	01/15/2024		
Loan Number	49961	APN	C04293B		
Borrower Name	Catamount Properties 2018 LLC	County	Yellowstone		

Tracking IDs

Order Tracking ID	1.9_CitiReadvance	Tracking ID 1	1.9_CitiReadvance
Tracking ID 2	--	Tracking ID 3	--

General Conditions

Owner	CATAMOUNT PROPERTIES 2018 LLC	Condition Comments Per the MLS description the subject has a newly renovated interior with remodeled kitchen and bathrooms. No repairs needed. Subject conforms to the neighborhood in age, size and style. The exterior has been painted. No updates to the landscaping so curb appeal could be improved.
R. E. Taxes	\$3,210	
Assessed Value	\$260,600	
Zoning Classification	Residential	
Property Type	SFR	
Occupancy	Vacant	
Secure?	Yes	
(Subject is vacant but currently on the market. Doors and windows secure.)		
Ownership Type	Fee Simple	
Property Condition	Good	
Estimated Exterior Repair Cost	\$0	
Estimated Interior Repair Cost	\$0	
Total Estimated Repair	\$0	
HOA	No	
Visible From Street	Visible	
Road Type	Public	

Neighborhood & Market Data

Location Type	Suburban	Neighborhood Comments Subject neighborhood is a residential neighborhood comprised of single family homes built primarily in the 1970s. Low REO activity. No boarded up homes.
Local Economy	Stable	
Sales Prices in this Neighborhood	Low: \$250,000 High: \$450,000	
Market for this type of property	Increased 1 % in the past 6 months.	
Normal Marketing Days	<90	

Current Listings

	Subject	Listing 1	Listing 2 *	Listing 3
Street Address	2938 Weaver Avenue	3557 Fleetwood	1015 Spotted Jack Loop E	826 Saddle Lane
City, State	Billings, MT	Billings, MT	Billings, MT	Billings, MT
Zip Code	59101	59101	59101	59101
Datasource	MLS	MLS	MLS	MLS
Miles to Subj.	--	0.79 ¹	1.11 ¹	0.27 ¹
Property Type	SFR	SFR	SFR	SFR
Original List Price \$	\$	\$339,000	\$339,900	\$380,000
List Price \$	--	\$329,000	\$339,900	\$370,000
Original List Date		12/05/2023	12/21/2023	07/17/2023
DOM · Cumulative DOM	-- · --	39 · 41	6 · 25	177 · 182
Age (# of years)	47	46	41	48
Condition	Good	Average	Average	Average
Sales Type	--	Fair Market Value	Fair Market Value	Fair Market Value
Location	Neutral ; Residential	Neutral ; Residential	Neutral ; Residential	Neutral ; Residential
View	Neutral ; Residential	Neutral ; Residential	Neutral ; Residential	Neutral ; Residential
Style/Design	Split split entry	Split split entry	Split 4 level	1 Story ranch
# Units	1	1	1	1
Living Sq. Feet	930	976	974	1,288
Bdrm · Bths · ½ Bths	2 · 1	2 · 1	2 · 1	3 · 2
Total Room #	6	6	6	8
Garage (Style/Stalls)	Attached 2 Car(s)	Detached 2 Car(s)	Attached 1 Car	Attached 2 Car(s)
Basement (Yes/No)	Yes	Yes	Yes	Yes
Basement (% Fin)	90%	100%	50%	90%
Basement Sq. Ft.	900	912	936	1,288
Pool/Spa	--	--	--	--
Lot Size	0.19 acres	0.27 acres	0.49 acres	0.35 acres
Other	--	central air	detached shop building	--

* Listing 2 is the most comparable listing to the subject.

¹ Comp's "Miles to Subject" was calculated by the system.

² Comp's "Miles to Subject" provided by Real Estate Professional.

³ Subject \$/ft based upon as-is sale price.

Listing Comments Why the comparable listing is superior or inferior to the subject.

Listing 1 Listing comp 1 is inferior to the subject because it doesn't have as many updates. The comp has central air the subject does not.

Listing 2 Listing comp 2 and the subject are balanced. The comp is less updated but has a larger lot and a shop building. The comp has less basement room count.

Listing 3 Listing comp 3 is superior to the subject because it has higher room count, higher GLA, and it has a larger lot. The comp is less updated.

Recent Sales

	Subject	Sold 1 *	Sold 2	Sold 3
Street Address	2938 Weaver Avenue	611 Lile Road	1023 Marie Drive	3428 Carmel Dr
City, State	Billings, MT	Billings, MT	Billings, MT	Billings, MT
Zip Code	59101	59101	59101	59101
Datasource	MLS	MLS	MLS	MLS
Miles to Subj.	--	0.58 ¹	0.65 ¹	0.70 ¹
Property Type	SFR	SFR	SFR	SFR
Original List Price \$	--	\$349,900	\$365,000	\$365,000
List Price \$	--	\$335,000	\$365,000	\$365,000
Sale Price \$	--	\$335,000	\$367,000	\$370,000
Type of Financing	--	Conventional	Conventional	Fha
Date of Sale	--	01/02/2024	08/28/2023	12/04/2023
DOM · Cumulative DOM	-- · --	94 · 122	2 · 34	1 · 55
Age (# of years)	47	46	45	43
Condition	Good	Good	Good	Good
Sales Type	--	Fair Market Value	Fair Market Value	Fair Market Value
Location	Neutral ; Residential	Neutral ; Residential	Neutral ; Residential	Neutral ; Residential
View	Neutral ; Residential	Neutral ; Residential	Neutral ; Residential	Neutral ; Residential
Style/Design	Split split entry	Split split entry	Split split entry	Split split entry
# Units	1	1	1	1
Living Sq. Feet	930	974	976	976
Bdrm · Bths · ½ Bths	2 · 1	2 · 1	2 · 1	2 · 1
Total Room #	6	6	6	6
Garage (Style/Stalls)	Attached 2 Car(s)	Detached 2 Car(s)	Attached 2 Car(s)	Attached 2 Car(s)
Basement (Yes/No)	Yes	Yes	Yes	Yes
Basement (% Fin)	90%	100%	100%	100%
Basement Sq. Ft.	900	912	912	912
Pool/Spa	--	--	--	--
Lot Size	0.19 acres	0.26 acres	0.46 acres	0.46 acres
Other	--	central air	central air	central air, large shed
Net Adjustment	--	+\$4,040	+\$2,195	+\$1,195
Adjusted Price	--	\$339,040	\$369,195	\$371,195

* Sold 1 is the most comparable sale to the subject.

¹ Comp's "Miles to Subject" was calculated by the system.

² Comp's "Miles to Subject" provided by Real Estate Professional.

³ Subject \$/ft based upon as-is sale price.

Recent Sales - Cont.

Reasons for Adjustments Why the comparable sale is superior or inferior to the subject.

- Sold 1** Sold comp 1 is inferior to the subject because it is less updated. The comp has slightly higher GLA and basement finish, central air, and it has a larger lot.
- Sold 2** Sold comp 2 is slightly inferior to the subject because it has fewer updates. The comp has slightly higher GLA, central air, and it has a larger lot.
- Sold 3** Sold comp 3 is slightly inferior to the subject because it has less interior updates. The comp has slightly higher GLA, central air, and it has a larger lot.

Subject Sales & Listing History

Current Listing Status	Currently Listed	Listing History Comments					
Listing Agency/Firm	Keller Williams	Subject is currently listed.					
Listing Agent Name	Hannah Reno						
Listing Agent Phone	406-210-0136						
# of Removed Listings in Previous 12 Months	0						
# of Sales in Previous 12 Months	0						
Original List Date	Original List Price	Final List Date	Final List Price	Result	Result Date	Result Price	Source
01/05/2024	\$340,000	--	--	--	--	--	MLS

Marketing Strategy

	As Is Price	Repaired Price
Suggested List Price	\$340,000	\$340,000
Sales Price	\$340,000	\$340,000
30 Day Price	\$340,000	--
Comments Regarding Pricing Strategy		
Recommend pricing with most emphasis on sold comp 1 and list comp 2. No listing comps available with same updated condition.		

Clear Capital Quality Assurance Comments Addendum

Reviewer's Notes The broker's as-is conclusion reflects the market for the subject. Comps are within a reasonable distance, relatively current, and accurately reflect the subject's defining characteristics. Thus, the as-is conclusion appears to be adequately supported.

Subject Photos



Front



Front



Address Verification



Side



Street

Listing Photos

L1 3557 Fleetwood
Billings, MT 59101



Front

L2 1015 Spotted Jack Loop E
Billings, MT 59101



Front

L3 826 Saddle Lane
Billings, MT 59101



Front

Sales Photos

S1 611 Lile Road
Billings, MT 59101



Front

S2 1023 Marie Drive
Billings, MT 59101



Front

S3 3428 Carmel Dr
Billings, MT 59101



Front

ClearMaps Addendum

Address ★ 2938 Weaver Avenue, Billings, MT 59101

Loan Number 49961

Suggested List \$340,000

Suggested Repaired \$340,000

Sale \$340,000

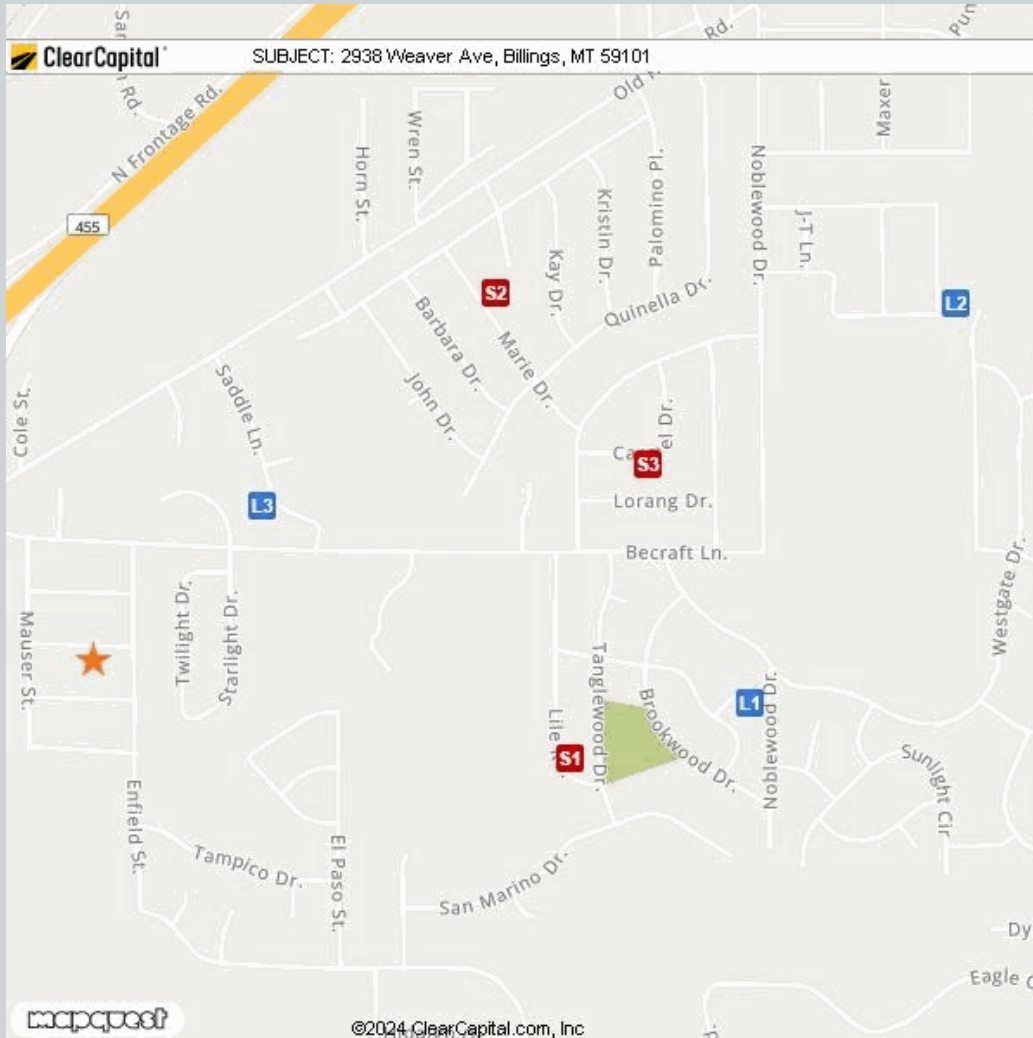

Comparable	Address	Miles to Subject	Mapping Accuracy
★ Subject	2938 Weaver Avenue, Billings, MT 59101	--	Parcel Match
L1 Listing 1	3557 Fleetwood, Billings, MT 59101	0.79 Miles ¹	Parcel Match
L2 Listing 2	1015 Spotted Jack Loop E, Billings, MT 59101	1.11 Miles ¹	Parcel Match
L3 Listing 3	826 Saddle Lane, Billings, MT 59101	0.27 Miles ¹	Parcel Match
S1 Sold 1	611 Lile Road, Billings, MT 59101	0.58 Miles ¹	Parcel Match
S2 Sold 2	1023 Marie Drive, Billings, MT 59101	0.65 Miles ¹	Parcel Match
S3 Sold 3	3428 Carmel Dr, Billings, MT 59101	0.70 Miles ¹	Parcel Match

¹ The Comparable "Distance from Subject" value has been calculated by the Clear Capital system.

² The Comparable "Distance from Subject" value has been provided by the Real Estate Professional.

Addendum: Report Purpose

Market Approach and Market Time

The Market Approach of this report, as established by the customer, is: **Fair Market Price**. (See definition below.)

The Marketing Time as specified by the customer is **Typical**. (See definition below.)

Definitions:

Fair Market Price

A price at which the property would sell between a willing buyer and a willing seller neither being compelled by undue pressure and both having reasonable knowledge of relevant facts.

Distressed Price

A price at which the property would sell between a willing buyer and a seller acting under duress.

Marketing Time

The amount of time the property is exposed to a pool of prospective buyers before going into contract. The customer either specifies the number of days, requests a marketing time that is typical to the subject's market area and/or requests an abbreviated marketing time.

Typical for Local Market

The estimated time required to adequately expose the subject property to the market resulting in a contract of sale.

Addendum: Report Purpose - cont.

Report Instructions

This section shows the instructions that were approved by the customer and provided to the broker prior to completing the report.

Instructions last updated: 7/17/2017

Purpose:

Please determine a fair market price for this property at which it would sell in a typical marketing time for the area.

Customer Specific Requests:

If the property is commercial or mixed use, please stop and contact Clear Capital as soon as possible

Form Help:

There are blue question marks (?) throughout this form. These are designed to offer guidance for that particular section of the form. Please click on them for help.

Comparable Requirements:

1. Please use fair market comps from the same neighborhood, block or subdivision whenever possible.
2. Please only use REO comparables if the market is driven by REOs and they are comparable in characteristics and condition.
3. Please use comps that have closed in the past 3 months to show the current market conditions or comment in the report if this is not possible. In rapidly changing markets, active listing comps should be given equal or greater weight than sold comps in your analysis.

Standard Instructions:

1. Clear Capital Code Of Conduct - Please make sure that you are always abiding by the Clear Capital Code of Conduct when completing valuation reports.
2. If the subject is currently listed, please consider all available information pertaining to the subject's condition. This information should be utilized when developing the assumption of the subject's condition.
3. Use the subject characteristics provided in the report Grid (if preloaded) to evaluate the property. This information is from a full interior appraisal and is assumed to be most accurate. If your inspection reveals obvious inaccuracies, please explain in the narrative of the report.
4. Include sufficient detail to help our mutual customer gain a complete understanding of the subject's neighborhood such as neighborhood desirability, amenities, parks, schools, commercial or industrial influences, REO activity, traffic, board-up-homes, etc.
5. Do not approach occupants or owners.
6. If the subject is a Commercial property, contact Clear Capital immediately at 530-582-5011 for direction on how to proceed with the report.
7. Please do not accept if you or your office has completed a report on this property in the last month, are currently listing this property, or have any vested interest in the subject property.
8. Clear Capital does not allow any log ins from IP addresses from foreign countries. This includes, but is not limited to; data entry services, form completion services, etc. Also, it is against Clear Capital code of conduct to share your password with anyone who is not a W2 employee in your office.
9. Clear Capital and our mutual customers greatly appreciate your expertise. If you cannot personally inspect the property, select comparables, and determine a price for the subject, please do not accept this report. Per the standards and guidelines adopted by Clear Capital and other industry leaders, the use of assistants to complete any of the aforementioned tasks is not permitted.

Report Instructions - cont.

Due to the importance of an independent opinion of price, please do not discuss your price with anyone or be influenced by list price, pending offers, accept comp packets, repair estimates or the listing agent's opinion.

1. One current, original photo of the front of the subject 2. One address verification photo 3. One street scene photo looking down the street 4. MLS listing and sold comp photos required, please comment if no MLS.

Broker Information

Broker Name	Jami Clark	Company/Brokerage	Yellowstone Realty Brokers
License No	RRE-BRO-LIC-109297	Address	107 33rd St W Billings MT 59102
License Expiration	10/31/2024	License State	MT
Phone	4066962215	Email	jami@ownbillings.com
Broker Distance to Subject	9.53 miles	Date Signed	01/15/2024

By confirming the above contact and real estate license information and submitting the report, the above signed hereby certifies and agrees that: 1) I personally took the pictures, selected comparables, and determined the price conclusion. 2) To the best of my knowledge, the statements of fact contained in this report are true and correct. 3) The reported analyses, opinions, and conclusions are my personal, impartial, and unbiased professional analyses, opinions, and conclusions. 4) I have no present or prospective interest in the property that is the subject of this report and no personal interest with respect to the parties involved. 5) I have no bias with respect to the property that is the subject of this report or to the parties involved with this assignment. 6) My compensation for completing this assignment is not contingent upon the development or reporting of a predetermined price point. 7) I did not base, either partially or completely, my analysis and/or opinion and conclusions in this report on race, color, religion, sex, age, marital status, handicap, familial status, or national origin of either the prospective owners or occupants of the subject property or of the present owners or occupants of the properties in the vicinity of the subject property or on any other basis prohibited by law. 8) I maintain errors and omissions insurance, to the extent required by state law, for all liability associated with the preparation of this Report.

Disclaimer

This document is not an appraisal as defined by USPAP (Uniform Standards of Professional Appraisal Practice). It is not to be construed as an appraisal and may not be used as such for any purpose.

Unless otherwise specifically agreed to in writing:

The intended purpose of this report is to assist the Clear Capital account holder in making decisions within the scope of applicable statutory and regulatory requirements and performing required due diligence. This document is provided solely for the use of the Clear Capital account holder and not any other party, is not intended as any guarantee of value and/or condition of the subject property and should not be relied on as such. In the event that this document is found to be defective, incorrect, negligently prepared or unfit for its authorized use, Clear Capital's sole liability shall be to promptly refund the total fee expended by the account holder for this report or to replace it at no charge to the account holder, but in no event shall Clear Capital be responsible to the account holder for any indirect or consequential damages whatsoever. This warranty is in lieu of all other warranties, express or implied, except where otherwise required by law. The account holder shall notify Clear Capital within thirty (30) days of this report's delivery to the account holder if it believes that this document is defective, incorrect, negligently prepared or unfit for its authorized use. Under no circumstances may Clear Capital forms or their contents be published, copied, replicated, or mimicked.