

Please Note: This report was completed with the following assumptions: Market Approach: **Fair Market Price** , Marketing Time: **Typical** . Important additional information relating to this report, including use and restrictions, is contained in an attached addendum which is an integral part of this report.

Address	2043 Mesquite Lane, Colton, CA 92324	Order ID	8406944	Property ID	33234618
Inspection Date	08/31/2022	Date of Report	08/31/2022		
Loan Number	51025	APN	0254-282-13-0000		
Borrower Name	Breckenridge Property Fund 2016 LLC	County	San Bernardino		

Tracking IDs

Order Tracking ID	08.30.22 BPO	Tracking ID 1	08.30.22 BPO
Tracking ID 2	--	Tracking ID 3	--

General Conditions

Owner	Esquivel Marco Antonio	Condition Comments The subject is a SFR style home in average condition. All maintenance appears to be up to date and no repairs are necessary based on the exterior inspection. No address corrections or recent market activity to report.
R. E. Taxes	\$3,121	
Assessed Value	\$592,900	
Zoning Classification	Residential	
Property Type	SFR	
Occupancy	Occupied	
Ownership Type	Fee Simple	
Property Condition	Average	
Estimated Exterior Repair Cost	\$0	
Estimated Interior Repair Cost	\$0	
Total Estimated Repair	\$0	
HOA	No	
Visible From Street	Visible	
Road Type	Public	

Neighborhood & Market Data

Location Type	Suburban	Neighborhood Comments The subject is located in a suburban neighborhood with increased property values and the economy and employment conditions are stable.
Local Economy	Stable	
Sales Prices in this Neighborhood	Low: \$469,000 High: \$605,000	
Market for this type of property	Increased 6 % in the past 6 months.	
Normal Marketing Days	<180	

Current Listings

	Subject	Listing 1 *	Listing 2	Listing 3
Street Address	2043 Mesquite Lane	2038 Mesquite Ln	2142 Lavender Ln	2139 Lavender Ln
City, State	Colton, CA	Colton, CA	Colton, CA	Colton, CA
Zip Code	92324	92324	92324	92324
Datasource	Tax Records	MLS	MLS	MLS
Miles to Subj.	--	0.03 ¹	0.10 ¹	0.07 ¹
Property Type	SFR	SFR	SFR	SFR
Original List Price \$	\$	\$560,000	\$524,888	\$575,000
List Price \$	--	\$549,990	\$519,888	\$575,000
Original List Date		08/05/2022	08/12/2022	08/25/2022
DOM · Cumulative DOM	-- · --	24 · 26	19 · 19	5 · 6
Age (# of years)	4	4	3	4
Condition	Average	Average	Average	Average
Sales Type	--	Fair Market Value	Fair Market Value	Fair Market Value
Location	Neutral ; Residential	Neutral ; Residential	Neutral ; Residential	Neutral ; Residential
View	Neutral ; Residential	Neutral ; Residential	Neutral ; Residential	Neutral ; Residential
Style/Design	2 Stories Contemporary	2 Stories Contemporary	2 Stories Contemporary	2 Stories Contemporary
# Units	1	1	1	1
Living Sq. Feet	1,717	1,717	1,731	1,931
Bdrm · Bths · ½ Bths	3 · 2 · 1	3 · 2 · 1	3 · 2 · 1	3 · 2 · 1
Total Room #	6	6	6	6
Garage (Style/Stalls)	Attached 2 Car(s)	Attached 2 Car(s)	Attached 2 Car(s)	Attached 2 Car(s)
Basement (Yes/No)	No	No	No	No
Basement (% Fin)	0%	0%	0%	0%
Basement Sq. Ft.	--	--	--	--
Pool/Spa	--	--	--	--
Lot Size	0.06 acres	0.05 acres	0.06 acres	0.05 acres
Other	None	None	None	None

* Listing 1 is the most comparable listing to the subject.

¹ Comp's "Miles to Subject" was calculated by the system.

² Comp's "Miles to Subject" provided by Real Estate Professional.

³ Subject \$/ft based upon as-is sale price.

Current Listings - Cont.

Listing Comments Why the comparable listing is superior or inferior to the subject.

- Listing 1** Welcome home to this beautiful two story 3 bedroom and 2.5 bathroom home located in the highly desired Wildrose Community. Open concept layout on main floor, kitchen has granite countertops and white cabinetry, stainless steel appliances, walk in pantry, crown molding on most of the main floor as well as upgraded flooring on main level. Laundry room and half bathroom on main floor. This home has a two car garage that is spacious with direct access to home and an additional parking space next to garage with entry to a private patio. Tankless water heater, solar panels, & low tax rate. The community offers a gorgeous swimming pool, barbecue area, large grass area for your pets and tot-lot for the kids! Property is similar in GLA, similar in condition, similar in year built and similar in bed/bath count. Adjustments Lot Size \$250, Total Adjustments \$250, Net Adjusted Value \$550240
- Listing 2** Just bring your furniture on this one! This is a semi new property. 3Bedrooms and 2.5 baths with just over 1730 sq ft and 2 car garage. Property was just painted. New Vinyl laminate flooring installed throughout the entire home. Flooring is water resistant. All appliances and blinds already included. Set up your viewing appointment today! Property is similar in GLA, similar in condition, similar in year built and similar in bed/bath count. Adjustments Net Adjusted Value \$519888
- Listing 3** Built in 2018 and recently painted throughout, this beautiful home is perfect for an easy move-in. Need extra space? This home has it! The spacious open-concept kitchen and living room can accommodate hosting and get-togethers offering a large island, stainless steel appliances, and granite countertops. The kitchen also houses and walk-in pantry and laundry room. The same flooring throughout the entire home makes it easy to maintain. All bedrooms and a large loft can be found upstairs along with another full bathroom. The large loft can be used in several ways such as a playroom, family room, or home office. This home also has solar panels that are not owned or leased with no payment needed for equipment, but instead for energy use. The 2-car garage is conveniently attached to the home with direct access from the house's interior. If you love having an extra grass area, play area, and pool but don't have the time to maintain them all this home is perfect for you. The low-cost HOA also provides access and upkeep for the bbq areas, greenbelts, and security. Call me to arrange a private showing. Property is superior in GLA, similar in condition, similar in year built and similar in bed/bath count. Adjustments GLA -\$6420, Lot Size \$250, Total Adjustments -\$6170, Net Adjusted Value \$568830

Recent Sales

	Subject	Sold 1	Sold 2	Sold 3 *
Street Address	2043 Mesquite Lane	2025 Juniper Ln	2018 Juniper Ln	1902 Larry Sheffield Ln
City, State	Colton, CA	Colton, CA	Colton, CA	Colton, CA
Zip Code	92324	92324	92324	92324
Datasource	Tax Records	MLS	MLS	MLS
Miles to Subj.	--	0.11 ¹	0.14 ¹	0.22 ¹
Property Type	SFR	SFR	SFR	SFR
Original List Price \$	--	\$549,000	\$499,000	\$599,990
List Price \$	--	\$548,000	\$499,000	\$549,990
Sale Price \$	--	\$550,000	\$499,000	\$545,000
Type of Financing	--	Conventional	Conventional	Conventional
Date of Sale	--	06/24/2022	10/18/2021	12/23/2021
DOM · Cumulative DOM	-- · --	12 · 59	6 · 61	59 · 95
Age (# of years)	4	2	4	3
Condition	Average	Average	Average	Average
Sales Type	--	Fair Market Value	Fair Market Value	Fair Market Value
Location	Neutral ; Residential	Neutral ; Residential	Neutral ; Residential	Neutral ; Residential
View	Neutral ; Residential	Neutral ; Residential	Neutral ; Residential	Neutral ; Residential
Style/Design	2 Stories Contemporary	2 Stories Contemporary	2 Stories Contemporary	2 Stories Contemporary
# Units	1	1	1	1
Living Sq. Feet	1,717	1,717	1,717	1,720
Bdrm · Bths · ½ Bths	3 · 2 · 1	3 · 2 · 1	3 · 2 · 1	3 · 2 · 1
Total Room #	6	6	6	6
Garage (Style/Stalls)	Attached 2 Car(s)	Attached 2 Car(s)	Attached 2 Car(s)	Attached 2 Car(s)
Basement (Yes/No)	No	No	No	No
Basement (% Fin)	0%	0%	0%	0%
Basement Sq. Ft.	--	--	--	--
Pool/Spa	--	--	--	--
Lot Size	0.06 acres	0.05 acres	0.05 acres	0.05 acres
Other	None	None	None	None
Net Adjustment	--	+\$250	+\$250	+\$250
Adjusted Price	--	\$550,250	\$499,250	\$545,250

* Sold 3 is the most comparable sale to the subject.

¹ Comp's "Miles to Subject" was calculated by the system.

² Comp's "Miles to Subject" provided by Real Estate Professional.

³ Subject \$/ft based upon as-is sale price.

Recent Sales - Cont.

Reasons for Adjustments Why the comparable sale is superior or inferior to the subject.

- Sold 1** Beautiful two-story home. Open-concept layout on the main floor, with a great room and a dining room leading into a high-end kitchen with a center island and a walk-in pantry. You'll also find a powder room and a laundry room on this floor. This home is full of designer finishes and fixtures! The home features 3 bedroom 2.5 bathrooms, including a primary suite. This is a must see property that you will love. Amenities include pool, playground, and barbeque areas. Property is similar in GLA, similar in condition, similar in year built and similar in bed/bath count. Adjustments Lot Size \$250, Total Adjustments \$250, Net Adjusted Value \$550250
- Sold 2** Stunning and Move-In Ready Home located in a Brand New Community! This immaculately designed home was the previous model home for the community and includes an open layout with tall ceilings and lots of natural light. Beautiful kitchen with large island and upgraded cabinets. Too many additional upgrades to mention! This wonderful home offers 3 large bedrooms upstairs with 2 bathrooms. Nicely appointed backyard for playing and entertaining. Large garage with plenty of storage. The community offers a gorgeous swimming pool, barbecue area, and tot-lot for the kids! Property is similar in GLA, similar in condition, similar in year built and similar in bed/bath count. Adjustments Lot Size \$250, Total Adjustments \$250, Net Adjusted Value \$499250
- Sold 3** MODEL HOME FOR SALE: Beautiful two-story Elsie plan boasts a popular open-concept layout on the main floor, with a great room and a dining room leading into an impressive kitchen with GE appliances including refrigerator, light gray cabinetry, white subway tile backsplash, Quartz countertops, a center island and a walk-in pantry. You'll also find a powder room and a laundry room on this floor. This home is full of designer finishes and fixtures! A sleek, modern look is complimented by the horizontal stair rail leading to the second floor open loft space with additional cabinetry. The lavish owner's bedroom features a private bath with dual sinks and large shower. This home features upgraded electrical, lighting, ceiling fans, custom interior paint, a deluxe, top-load laundry package with cabinets, upgraded flooring, surround sound audio package, home security system, a full landscape package, complete exterior gutters, new home energy efficiencies and warranties plus so much more. Property is similar in GLA, similar in condition, similar in year built and similar in bed/bath count. Adjustments Lot Size \$250, Total Adjustments \$250, Net Adjusted Value \$545250

Subject Sales & Listing History

Current Listing Status	Not Currently Listed	Listing History Comments					
Listing Agency/Firm		No listing history available.					
Listing Agent Name							
Listing Agent Phone							
# of Removed Listings in Previous 12 Months	0						
# of Sales in Previous 12 Months	0						
Original List Date	Original List Price	Final List Date	Final List Price	Result	Result Date	Result Price	Source

Marketing Strategy

	As Is Price	Repaired Price
Suggested List Price	\$550,000	\$550,000
Sales Price	\$545,000	\$545,000
30 Day Price	\$540,000	--

Comments Regarding Pricing Strategy

This is a Broker's Price Opinion and was prepared by a licensed Real Estate Agent. It is not an Appraisal. This opinion cannot be used for the purpose of obtaining financing. Notwithstanding any preprinted language to the contrary, this is not an Appraisal of the market value of the property. If an Appraisal is desired, the services of a licensed or certified Appraiser must be obtained. This document is not an appraisal as defined by USPAP (Uniform Standards of Professional Appraisal Practice). It is not to be construed as an appraisal and may not be used as such for any purpose. Within 1 mile, 20% GLA +/-, Year built 30 +/-, there were limited comparables available in the subject neighborhood. Therefore it was necessary to exceed the GLA, Lot size. The comparable selected were considered to be the best available. In delivering final valuation, most weight has been placed on CS3 and LC1 as they are most similar to subject condition and overall structure. Market values remained stable during last 12 months within subject's market area.

Clear Capital Quality Assurance Comments Addendum

Reviewer's The broker's as-is conclusion reflects the market for the subject. Comps are within a reasonable distance, relatively current, and accurately reflect
Notes the subject's defining characteristics. Thus, the as-is conclusion appears to be adequately supported.

Subject Photos



Front

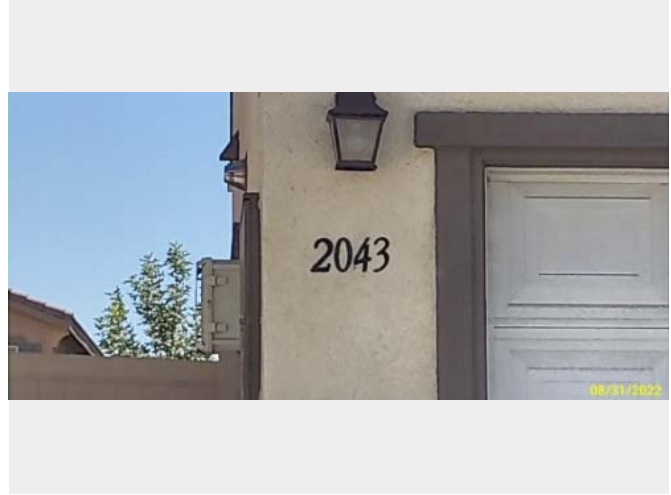

Address Verification



Street

Listing Photos

L1 2038 Mesquite Ln
Colton, CA 92324



Front

L2 2142 Lavender Ln
Colton, CA 92324



Front

L3 2139 Lavender Ln
Colton, CA 92324



Front

Sales Photos

S1 2025 Juniper Ln
Colton, CA 92324



Front

S2 2018 Juniper Ln
Colton, CA 92324



Front

S3 1902 Larry Sheffield Ln
Colton, CA 92324



Front

ClearMaps Addendum

Address ★ 2043 Mesquite Lane, Colton, CA 92324

Loan Number 51025

Suggested List \$550,000

Suggested Repaired \$550,000

Sale \$545,000

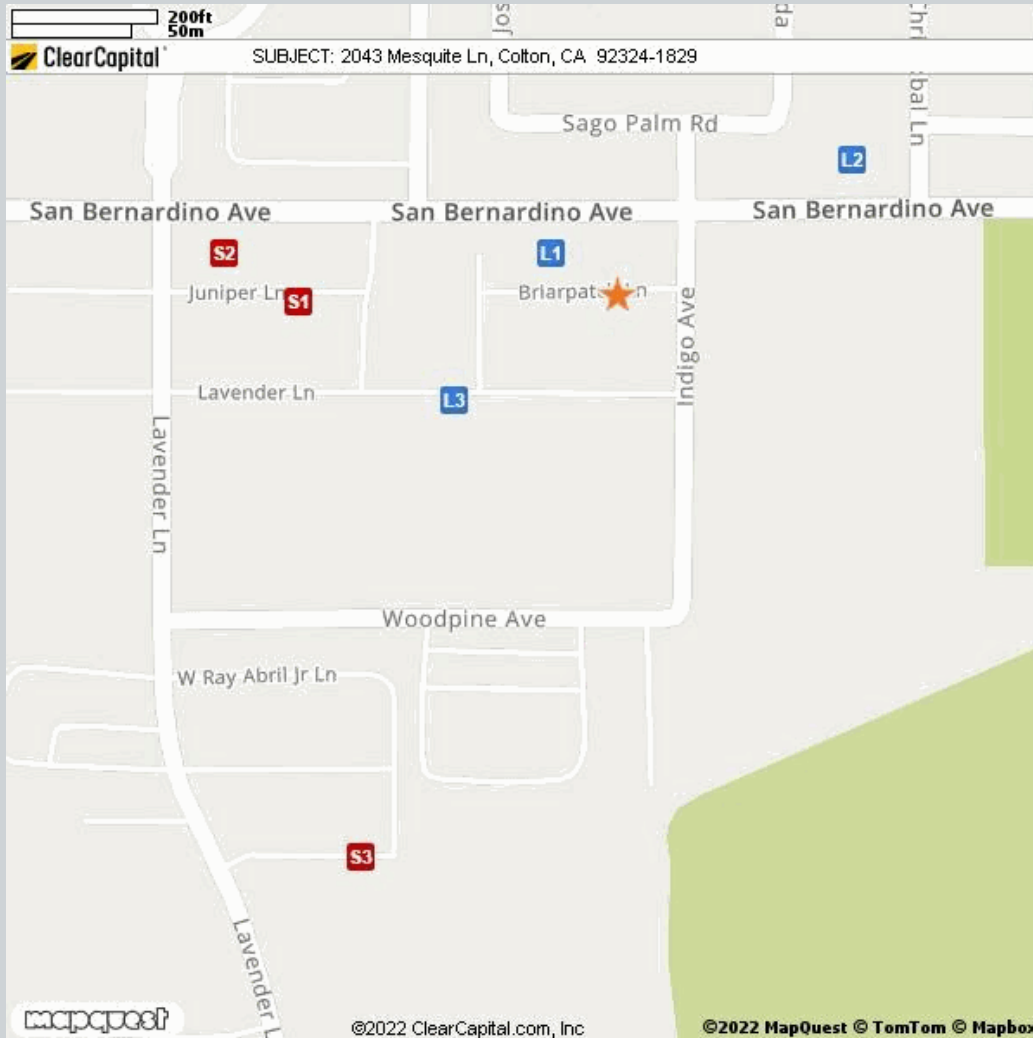

Comparable	Address	Miles to Subject	Mapping Accuracy
★ Subject	2043 Mesquite Lane, Colton, CA 92324	--	Parcel Match
L1 Listing 1	2038 Mesquite Ln, Colton, CA 92324	0.03 Miles ¹	Parcel Match
L2 Listing 2	2142 Lavender Ln, Colton, CA 92324	0.10 Miles ¹	Parcel Match
L3 Listing 3	2139 Lavender Ln, Colton, CA 92324	0.07 Miles ¹	Parcel Match
S1 Sold 1	2025 Juniper Ln, Colton, CA 92324	0.11 Miles ¹	Parcel Match
S2 Sold 2	2018 Juniper Ln, Colton, CA 92324	0.14 Miles ¹	Parcel Match
S3 Sold 3	1902 Larry Sheffield Ln, Colton, CA 92324	0.22 Miles ¹	Parcel Match

¹ The Comparable "Distance from Subject" value has been calculated by the Clear Capital system.

² The Comparable "Distance from Subject" value has been provided by the Real Estate Professional.

Addendum: Report Purpose

Market Approach and Market Time

The Market Approach of this report, as established by the customer, is: **Fair Market Price**. (See definition below.)

The Marketing Time as specified by the customer is **Typical**. (See definition below.)

Definitions:

Fair Market Price

A price at which the property would sell between a willing buyer and a willing seller neither being compelled by undue pressure and both having reasonable knowledge of relevant facts.

Distressed Price

A price at which the property would sell between a willing buyer and a seller acting under duress.

Marketing Time

The amount of time the property is exposed to a pool of prospective buyers before going into contract. The customer either specifies the number of days, requests a marketing time that is typical to the subject's market area and/or requests an abbreviated marketing time.

Typical for Local Market

The estimated time required to adequately expose the subject property to the market resulting in a contract of sale.

Addendum: Report Purpose - cont.

Report Instructions

This section shows the instructions that were approved by the customer and provided to the broker prior to completing the report.

Instructions last updated: 7/17/2017

Purpose:

Please determine a fair market price for this property at which it would sell in a typical marketing time for the area.

Customer Specific Requests:

If the property is commercial or mixed use, please stop and contact Clear Capital as soon as possible

Form Help:

There are blue question marks (?) throughout this form. These are designed to offer guidance for that particular section of the form. Please click on them for help.

Comparable Requirements:

1. Please use fair market comps from the same neighborhood, block or subdivision whenever possible.
2. Please only use REO comparables if the market is driven by REOs and they are comparable in characteristics and condition.
3. Please use comps that have closed in the past 3 months to show the current market conditions or comment in the report if this is not possible. In rapidly changing markets, active listing comps should be given equal or greater weight than sold comps in your analysis.

Standard Instructions:

1. Clear Capital Code Of Conduct - Please make sure that you are always abiding by the Clear Capital Code of Conduct when completing valuation reports.
2. If the subject is currently listed, please consider all available information pertaining to the subject's condition. This information should be utilized when developing the assumption of the subject's condition.
3. Use the subject characteristics provided in the report Grid (if preloaded) to evaluate the property. This information is from a full interior appraisal and is assumed to be most accurate. If your inspection reveals obvious inaccuracies, please explain in the narrative of the report.
4. Include sufficient detail to help our mutual customer gain a complete understanding of the subject's neighborhood such as neighborhood desirability, amenities, parks, schools, commercial or industrial influences, REO activity, traffic, board-up-homes, etc.
5. Do not approach occupants or owners.
6. If the subject is a Commercial property, contact Clear Capital immediately at 530-582-5011 for direction on how to proceed with the report.
7. Please do not accept if you or your office has completed a report on this property in the last month, are currently listing this property, or have any vested interest in the subject property.
8. Clear Capital does not allow any log ins from IP addresses from foreign countries. This includes, but is not limited to; data entry services, form completion services, etc. Also, it is against Clear Capital code of conduct to share your password with anyone who is not a W2 employee in your office.
9. Clear Capital and our mutual customers greatly appreciate your expertise. If you cannot personally inspect the property, select comparables, and determine a price for the subject, please do not accept this report. Per the standards and guidelines adopted by Clear Capital and other industry leaders, the use of assistants to complete any of the aforementioned tasks is not permitted.

Report Instructions - cont.

Due to the importance of an independent opinion of price, please do not discuss your price with anyone or be influenced by list price, pending offers, accept comp packets, repair estimates or the listing agent's opinion.

1. One current, original photo of the front of the subject 2. One address verification photo 3. One street scene photo looking down the street 4. MLS listing and sold comp photos required, please comment if no MLS.

Broker Information

Broker Name	Chris Estevez	Company/Brokerage	Home Advisors
License No	01856462	Address	13511 Pheasant Knoll Rd Corona CA 92880
License Expiration	08/06/2025	License State	CA
Phone	9514157265	Email	home_advisors@live.com
Broker Distance to Subject	14.88 miles	Date Signed	08/31/2022

By confirming the above contact and real estate license information and submitting the report, the above signed hereby certifies and agrees that: 1) I personally took the pictures, selected comparables, and determined the price conclusion. 2) To the best of my knowledge, the statements of fact contained in this report are true and correct. 3) The reported analyses, opinions, and conclusions are my personal, impartial, and unbiased professional analyses, opinions, and conclusions. 4) I have no present or prospective interest in the property that is the subject of this report and no personal interest with respect to the parties involved. 5) I have no bias with respect to the property that is the subject of this report or to the parties involved with this assignment. 6) My compensation for completing this assignment is not contingent upon the development or reporting of a predetermined price point. 7) I did not base, either partially or completely, my analysis and/or opinion and conclusions in this report on race, color, religion, sex, age, marital status, handicap, familial status, or national origin of either the prospective owners or occupants of the subject property or of the present owners or occupants of the properties in the vicinity of the subject property or on any other basis prohibited by law. 8) I maintain errors and omissions insurance, to the extent required by state law, for all liability associated with the preparation of this Report.

Disclaimer

This document is not an appraisal as defined by USPAP (Uniform Standards of Professional Appraisal Practice). It is not to be construed as an appraisal and may not be used as such for any purpose.

Unless otherwise specifically agreed to in writing:

The intended purpose of this report is to assist the Clear Capital account holder in making decisions within the scope of applicable statutory and regulatory requirements and performing required due diligence. This document is provided solely for the use of the Clear Capital account holder and not any other party, is not intended as any guarantee of value and/or condition of the subject property and should not be relied on as such. In the event that this document is found to be defective, incorrect, negligently prepared or unfit for its authorized use, Clear Capital's sole liability shall be to promptly refund the total fee expended by the account holder for this report or to replace it at no charge to the account holder, but in no event shall Clear Capital be responsible to the account holder for any indirect or consequential damages whatsoever. This warranty is in lieu of all other warranties, express or implied, except where otherwise required by law. The account holder shall notify Clear Capital within thirty (30) days of this report's delivery to the account holder if it believes that this document is defective, incorrect, negligently prepared or unfit for its authorized use. Under no circumstances may Clear Capital forms or their contents be published, copied, replicated, or mimicked.