

Please Note: This report was completed with the following assumptions: Market Approach: **Fair Market Price** , Marketing Time: **Typical** . Important additional information relating to this report, including use and restrictions, is contained in an attached addendum which is an integral part of this report.

Address	21110 Foothill Pine, San Antonio, TX 78259	Order ID	8501261	Property ID	33514624
Inspection Date	11/02/2022	Date of Report	11/03/2022		
Loan Number	51154	APN	049181160040		
Borrower Name	Breckenridge Property Fund 2016 LLC	County	Bexar		

Tracking IDs					
Order Tracking ID	11.02.22 BPO	Tracking ID 1	11.02.22 BPO		
Tracking ID 2	--	Tracking ID 3	--		

General Conditions

Owner	Eckles Jack	Condition Comments	
R. E. Taxes	\$6,143	Based on exterior observation, subject property is in Average condition. No immediate repair or modernization required.	
Assessed Value	\$297,000		
Zoning Classification	Residential		
Property Type	SFR		
Occupancy	Occupied		
Ownership Type	Fee Simple		
Property Condition	Average		
Estimated Exterior Repair Cost	\$800		
Estimated Interior Repair Cost	\$0		
Total Estimated Repair	\$800		
HOA	No		
Visible From Street	Visible		
Road Type	Public		

Neighborhood & Market Data

Location Type	Suburban	Neighborhood Comments	
Local Economy	Stable	The subject is located in a suburban neighborhood with property values increasing and a balanced supply Vs demand of homes. The economy and employment conditions are stable.	
Sales Prices in this Neighborhood	Low: \$284,000 High: \$515,000		
Market for this type of property	Increased 1 % in the past 6 months.		
Normal Marketing Days	<90		

Current Listings

	Subject	Listing 1	Listing 2 *	Listing 3
Street Address	21110 Foothill Pine	21415 Branding Bay	20823 Coral Spur	4030 Regal Rose
City, State	San Antonio, TX	San Antonio, TX	San Antonio, TX	San Antonio, TX
Zip Code	78259	78259	78259	78259
Datasource	Tax Records	MLS	MLS	MLS
Miles to Subj.	--	0.44 ¹	0.28 ¹	0.47 ¹
Property Type	SFR	SFR	SFR	SFR
Original List Price \$	\$	\$390,894	\$424,900	\$394,900
List Price \$	--	\$390,894	\$414,900	\$389,900
Original List Date		10/05/2022	08/30/2022	10/07/2022
DOM · Cumulative DOM	-- · --	28 · 29	64 · 65	26 · 27
Age (# of years)	16	16	15	18
Condition	Average	Average	Average	Average
Sales Type	--	Fair Market Value	Fair Market Value	Fair Market Value
Location	Neutral ; Residential	Neutral ; Residential	Neutral ; Residential	Neutral ; Residential
View	Neutral ; Residential	Neutral ; Residential	Neutral ; Residential	Neutral ; Residential
Style/Design	2 Stories Colonial	2 Stories Colonial	2 Stories Colonial	2 Stories Colonial
# Units	1	1	1	1
Living Sq. Feet	2,576	2,686	2,576	3,030
Bdrm · Bths · ½ Bths	4 · 2 · 1	3 · 2 · 1	4 · 2	4 · 3 · 1
Total Room #	7	6	7	8
Garage (Style/Stalls)	Attached 2 Car(s)	Attached 2 Car(s)	Attached 2 Car(s)	Attached 2 Car(s)
Basement (Yes/No)	No	No	No	No
Basement (% Fin)	0%	0%	0%	0%
Basement Sq. Ft.	--	--	--	--
Pool/Spa	--	--	--	--
Lot Size	0.14 acres	0.24 acres	0.14 acres	0.14 acres
Other	None	None	None	None

* Listing 2 is the most comparable listing to the subject.

¹ Comp's "Miles to Subject" was calculated by the system.

² Comp's "Miles to Subject" provided by Real Estate Professional.

³ Subject \$/ft based upon as-is sale price.

Listing Comments Why the comparable listing is superior or inferior to the subject.

Listing 1 Property is similar in bath count, condition, age but superior in GLA, lot size to the subject. Active1 => Bed= \$4000, GLA= \$-2200, Lot= \$-200, Total= \$1600, Net Adjusted Value= \$392494

Listing 2 Property is similar in full bath, bed count, GLA but inferior in half bath to the subject. Active2 => Half Bath= \$1000, Total= \$1000, Net Adjusted Value= \$415900

Listing 3 Property is similar in bed count, half bath, age but superior in GLA, full bath to the subject. Active3 => Bath= \$-2000, GLA= \$-9080, Total= \$-11080, Net Adjusted Value= \$378820

Recent Sales

	Subject	Sold 1	Sold 2 *	Sold 3
Street Address	21110 Foothill Pine	4015 Regal Rose	4414 Manitou Bay	4518 Summer Fall
City, State	San Antonio, TX	San Antonio, TX	San Antonio, TX	San Antonio, TX
Zip Code	78259	78259	78259	78259
Datasource	Tax Records	MLS	MLS	MLS
Miles to Subj.	--	0.51 ¹	0.36 ¹	0.18 ¹
Property Type	SFR	SFR	SFR	SFR
Original List Price \$	--	\$383,000	\$400,000	\$402,000
List Price \$	--	\$360,000	\$400,000	\$402,000
Sale Price \$	--	\$355,000	\$398,500	\$402,000
Type of Financing	--	Conventional	Conventional	Conventional
Date of Sale	--	11/01/2022	08/16/2022	07/14/2022
DOM · Cumulative DOM	-- · --	109 · 109	33 · 33	41 · 41
Age (# of years)	16	18	19	15
Condition	Average	Average	Average	Average
Sales Type	--	Fair Market Value	Fair Market Value	Fair Market Value
Location	Neutral ; Residential	Neutral ; Residential	Neutral ; Residential	Neutral ; Residential
View	Neutral ; Residential	Neutral ; Residential	Neutral ; Residential	Neutral ; Residential
Style/Design	2 Stories Colonial	2 Stories Colonial	1 Story Ranch	2 Stories Colonial
# Units	1	1	1	1
Living Sq. Feet	2,576	2,596	2,846	2,818
Bdrm · Bths · ½ Bths	4 · 2 · 1	4 · 2 · 1	3 · 2	3 · 2 · 1
Total Room #	7	7	6	6
Garage (Style/Stalls)	Attached 2 Car(s)	Attached 2 Car(s)	Attached 2 Car(s)	Attached 2 Car(s)
Basement (Yes/No)	No	No	No	No
Basement (% Fin)	0%	0%	0%	0%
Basement Sq. Ft.	--	--	--	--
Pool/Spa	--	--	--	--
Lot Size	0.14 acres	0.14 acres	0.23 acres	0.17 acres
Other	None	None	None	None
Net Adjustment	--	\$0	-\$580	+\$160
Adjusted Price	--	\$355,000	\$397,920	\$402,160

* Sold 2 is the most comparable sale to the subject.

¹ Comp's "Miles to Subject" was calculated by the system.

² Comp's "Miles to Subject" provided by Real Estate Professional.

³ Subject \$/ft based upon as-is sale price.

Recent Sales - Cont.

Reasons for Adjustments Why the comparable sale is superior or inferior to the subject.

- Sold 1** Property is similar in GLA, bed bath count, condition, age, lot size to the subject. Sold1 => Net Adjusted Value= \$355000.
- Sold 2** Property is superior in GLA, lot size but inferior in half bath, bed count to the subject. Sold2 => Bed= \$4000, Half Bath= \$1000, GLA= \$-5400, Lot= \$-180, Total= \$-580, Net Adjusted Value= \$397920.
- Sold 3** Property is similar in bath count, condition, age but superior in GLA to the subject. Sold3 => Bed= \$4000, GLA= \$-4840, sold date:\$1000, Total= \$160, Net Adjusted Value= \$402160.

Subject Sales & Listing History

Current Listing Status	Not Currently Listed			Listing History Comments			
Listing Agency/Firm				None Noted			
Listing Agent Name							
Listing Agent Phone							
# of Removed Listings in Previous 12 Months	0						
# of Sales in Previous 12 Months	0						
Original List Date	Original List Price	Final List Date	Final List Price	Result	Result Date	Result Price	Source

Marketing Strategy

	As Is Price	Repaired Price
Suggested List Price	\$405,000	\$406,600
Sales Price	\$395,000	\$396,600
30 Day Price	\$385,000	--
Comments Regarding Pricing Strategy		
<p>The subject is single family SFR Colonial with GLA 2576, bed count 4, bath count 3 and was built in the year 2006. All maintenance appears to be up to date and no repairs are necessary based on the exterior inspection. All necessary amenities and public transportation are located within close proximity to the subject. There was no functional or economic obsolescence observed. I exceeded the style, bed/bath count and lot size due to very few comps availability. All comps are taken within 1 mile and GLA exceeded to +/-30%. The value and marketability will not be affected with the subject being located near highway, railway track and commercial area. Comparable crossed neighborhood railroad tracks and highway. This however, will not have effect on value and marketability. The comps were still valued correctly and is an accurate reflection of the local market value. More weight has been given to CS2 and LC2 which are maintaining the overall value and structure related to the subject. Subject attributes are taken from the tax record.</p>		

Clear Capital Quality Assurance Comments Addendum

Reviewer's Notes The broker's as-is conclusion reflects the market for the subject. Comps are within a reasonable distance, relatively current, and accurately reflect the subject's defining characteristics. Thus, the as-is conclusion appears to be adequately supported.

Subject Photos



Front

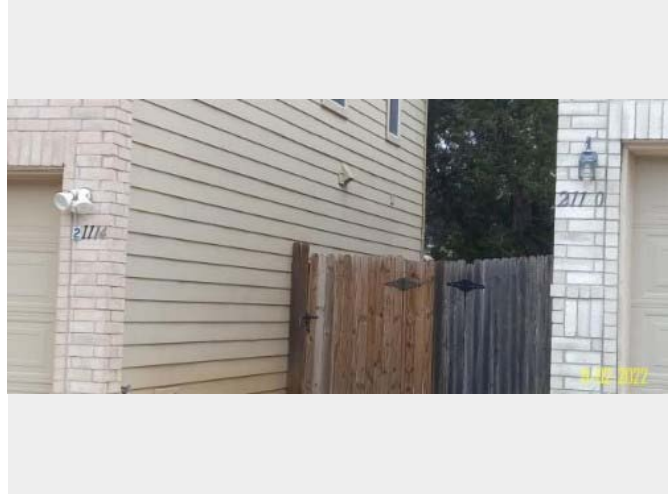

Address Verification



Street

Listing Photos

L1 21415 Branding Bay
San Antonio, TX 78259



Front

L2 20823 Coral Spur
San Antonio, TX 78259



Front

L3 4030 Regal Rose
San Antonio, TX 78259



Front

Sales Photos

S1 4015 Regal Rose
San Antonio, TX 78259



Front

S2 4414 Manitou Bay
San Antonio, TX 78259



Front

S3 4518 Summer Fall
San Antonio, TX 78259



Front

ClearMaps Addendum

Address ★ 21110 Foothill Pine, San Antonio, TX 78259

Loan Number 51154

Suggested List \$405,000

Suggested Repaired \$406,600

Sale \$395,000

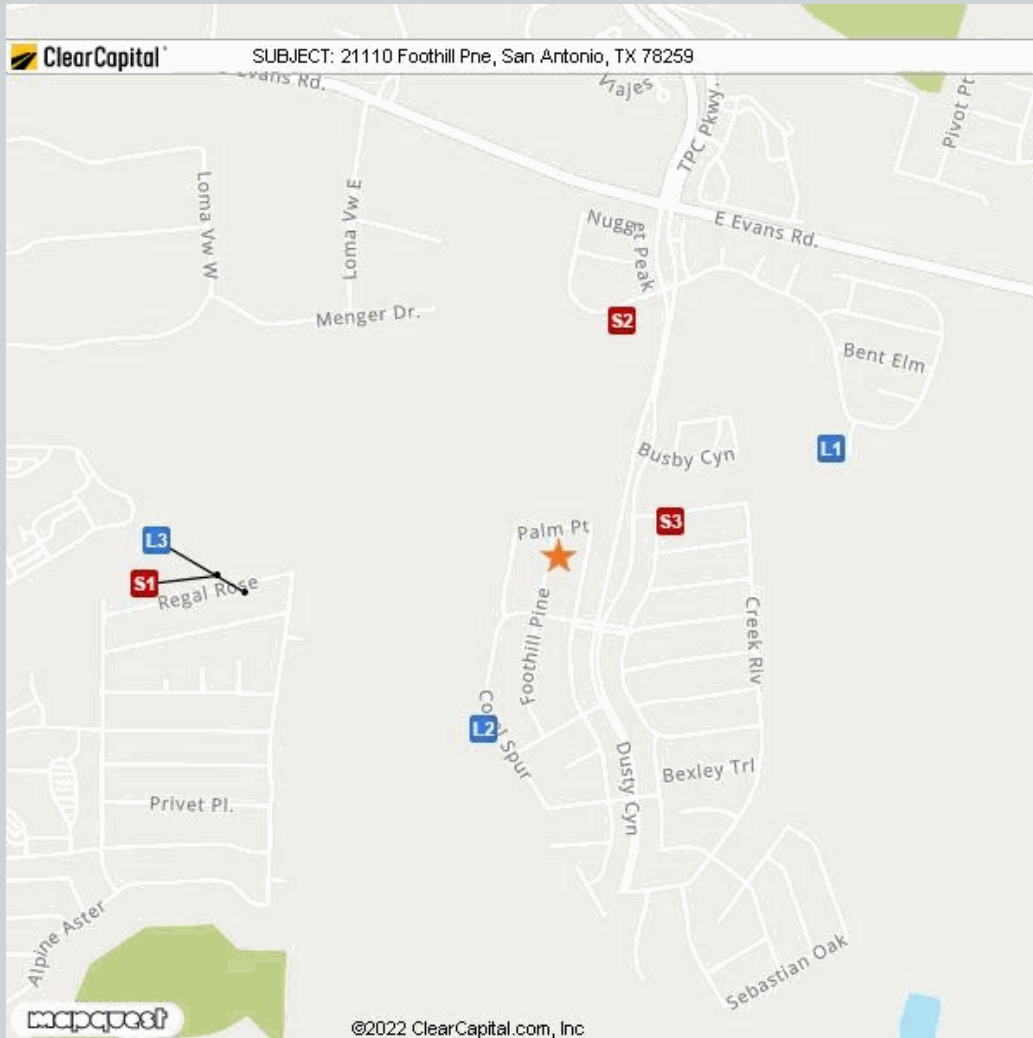

Comparable	Address	Miles to Subject	Mapping Accuracy
★ Subject	21110 Foothill Pine, San Antonio, TX 78259	--	Parcel Match
L1 Listing 1	21415 Branding Bay, San Antonio, TX 78259	0.44 Miles ¹	Parcel Match
L2 Listing 2	20823 Coral Spur, San Antonio, TX 78259	0.28 Miles ¹	Parcel Match
L3 Listing 3	4030 Regal Rose, San Antonio, TX 78259	0.47 Miles ¹	Parcel Match
S1 Sold 1	4015 Regal Rose, San Antonio, TX 78259	0.51 Miles ¹	Parcel Match
S2 Sold 2	4414 Manitou Bay, San Antonio, TX 78259	0.36 Miles ¹	Parcel Match
S3 Sold 3	4518 Summer Fall, San Antonio, TX 78259	0.18 Miles ¹	Parcel Match

¹ The Comparable "Distance from Subject" value has been calculated by the Clear Capital system.

² The Comparable "Distance from Subject" value has been provided by the Real Estate Professional.

Addendum: Report Purpose

Market Approach and Market Time

The Market Approach of this report, as established by the customer, is: **Fair Market Price**. (See definition below.)

The Marketing Time as specified by the customer is **Typical**. (See definition below.)

Definitions:

Fair Market Price

A price at which the property would sell between a willing buyer and a willing seller neither being compelled by undue pressure and both having reasonable knowledge of relevant facts.

Distressed Price

A price at which the property would sell between a willing buyer and a seller acting under duress.

Marketing Time

The amount of time the property is exposed to a pool of prospective buyers before going into contract. The customer either specifies the number of days, requests a marketing time that is typical to the subject's market area and/or requests an abbreviated marketing time.

Typical for Local Market

The estimated time required to adequately expose the subject property to the market resulting in a contract of sale.

Addendum: Report Purpose - cont.

Report Instructions

This section shows the instructions that were approved by the customer and provided to the broker prior to completing the report.

Instructions last updated: 7/17/2017

Purpose:

Please determine a fair market price for this property at which it would sell in a typical marketing time for the area.

Customer Specific Requests:

If the property is commercial or mixed use, please stop and contact Clear Capital as soon as possible

Form Help:

There are blue question marks (?) throughout this form. These are designed to offer guidance for that particular section of the form. Please click on them for help.

Comparable Requirements:

1. Please use fair market comps from the same neighborhood, block or subdivision whenever possible.
2. Please only use REO comparables if the market is driven by REOs and they are comparable in characteristics and condition.
3. Please use comps that have closed in the past 3 months to show the current market conditions or comment in the report if this is not possible. In rapidly changing markets, active listing comps should be given equal or greater weight than sold comps in your analysis.

Standard Instructions:

1. Clear Capital Code Of Conduct - Please make sure that you are always abiding by the Clear Capital Code of Conduct when completing valuation reports.
2. If the subject is currently listed, please consider all available information pertaining to the subject's condition. This information should be utilized when developing the assumption of the subject's condition.
3. Use the subject characteristics provided in the report Grid (if preloaded) to evaluate the property. This information is from a full interior appraisal and is assumed to be most accurate. If your inspection reveals obvious inaccuracies, please explain in the narrative of the report.
4. Include sufficient detail to help our mutual customer gain a complete understanding of the subject's neighborhood such as neighborhood desirability, amenities, parks, schools, commercial or industrial influences, REO activity, traffic, board-up-homes, etc.
5. Do not approach occupants or owners.
6. If the subject is a Commercial property, contact Clear Capital immediately at 530-582-5011 for direction on how to proceed with the report.
7. Please do not accept if you or your office has completed a report on this property in the last month, are currently listing this property, or have any vested interest in the subject property.
8. Clear Capital does not allow any log ins from IP addresses from foreign countries. This includes, but is not limited to; data entry services, form completion services, etc. Also, it is against Clear Capital code of conduct to share your password with anyone who is not a W2 employee in your office.
9. Clear Capital and our mutual customers greatly appreciate your expertise. If you cannot personally inspect the property, select comparables, and determine a price for the subject, please do not accept this report. Per the standards and guidelines adopted by Clear Capital and other industry leaders, the use of assistants to complete any of the aforementioned tasks is not permitted.

Report Instructions - cont.

Due to the importance of an independent opinion of price, please do not discuss your price with anyone or be influenced by list price, pending offers, accept comp packets, repair estimates or the listing agent's opinion.

1. One current, original photo of the front of the subject 2. One address verification photo 3. One street scene photo looking down the street 4. MLS listing and sold comp photos required, please comment if no MLS.

Broker Information

Broker Name	Elizabeth Ann Lentz De La Rosa	Company/Brokerage	BSL Real Estate LLC
License No	645757	Address	2186 Jackson Keller Rd Ste 1082, San Antonio TX 78213
License Expiration	04/30/2023	License State	TX
Phone	8306314469	Email	delaroselizzy@gmail.com
Broker Distance to Subject	11.19 miles	Date Signed	11/03/2022

By confirming the above contact and real estate license information and submitting the report, the above signed hereby certifies and agrees that: 1) I personally took the pictures, selected comparables, and determined the price conclusion. 2) To the best of my knowledge, the statements of fact contained in this report are true and correct. 3) The reported analyses, opinions, and conclusions are my personal, impartial, and unbiased professional analyses, opinions, and conclusions. 4) I have no present or prospective interest in the property that is the subject of this report and no personal interest with respect to the parties involved. 5) I have no bias with respect to the property that is the subject of this report or to the parties involved with this assignment. 6) My compensation for completing this assignment is not contingent upon the development or reporting of a predetermined price point. 7) I did not base, either partially or completely, my analysis and/or opinion and conclusions in this report on race, color, religion, sex, age, marital status, handicap, familial status, or national origin of either the prospective owners or occupants of the subject property or of the present owners or occupants of the properties in the vicinity of the subject property or on any other basis prohibited by law. 8) I maintain errors and omissions insurance, to the extent required by state law, for all liability associated with the preparation of this Report.

Disclaimer

THIS REPORT SHOULD NOT BE CONSIDERED AN APPRAISAL. In making any decision that relies upon my work, you should know that I have not followed the guidelines for development of an appraisal or analysis contained in the Uniform Standards of Professional Appraisal Practice of the Appraisal Foundation.

Unless otherwise specifically agreed to in writing:

The intended purpose of this report is to assist the Clear Capital account holder in making decisions within the scope of applicable statutory and regulatory requirements and performing required due diligence. This document is provided solely for the use of the Clear Capital account holder and not any other party, is not intended as any guarantee of value and/or condition of the subject property and should not be relied on as such. In the event that this document is found to be defective, incorrect, negligently prepared or unfit for its authorized use, Clear Capital's sole liability shall be to promptly refund the total fee expended by the account holder for this report or to replace it at no charge to the account holder, but in no event shall Clear Capital be responsible to the account holder for any indirect or consequential damages whatsoever. This warranty is in lieu of all other warranties, express or implied, except where otherwise required by law. The account holder shall notify Clear Capital within thirty (30) days of this report's delivery to the account holder if it believes that this document is defective, incorrect, negligently prepared or unfit for its authorized use. Under no circumstances may Clear Capital forms or their contents be published, copied, replicated, or mimicked.