

Please Note: This report was completed with the following assumptions: Market Approach: **Fair Market Price** , Marketing Time: **Typical** . Important additional information relating to this report, including use and restrictions, is contained in an attached addendum which is an integral part of this report.

<b>Address</b>	8015 Azucena Avenue, Atascadero, CA 93422	<b>Order ID</b>	8543017	<b>Property ID</b>	33714255
<b>Inspection Date</b>	12/09/2022	<b>Date of Report</b>	12/13/2022		
<b>Loan Number</b>	51882	<b>APN</b>	031-251-046		
<b>Borrower Name</b>	Breckenridge Property Fund 2016 LLC	<b>County</b>	San Luis Obispo		

Tracking IDs					
<b>Order Tracking ID</b>	12.07.22 BPO	<b>Tracking ID 1</b>	12.07.22 BPO		
<b>Tracking ID 2</b>	--	<b>Tracking ID 3</b>	--		

General Conditions		
<b>Owner</b>	Patricia Pierce	<b>Condition Comments</b> Home appears to be in average condition with off street parking, fenced yard, some landscaping. Near services, freeway access.
<b>R. E. Taxes</b>	\$2,057	
<b>Assessed Value</b>	\$154,314	
<b>Zoning Classification</b>	RSFY	
<b>Property Type</b>	SFR	
<b>Occupancy</b>	Occupied	
<b>Ownership Type</b>	Fee Simple	
<b>Property Condition</b>	Average	
<b>Estimated Exterior Repair Cost</b>	\$0	
<b>Estimated Interior Repair Cost</b>	\$0	
<b>Total Estimated Repair</b>	\$0	
<b>HOA</b>	No	
<b>Visible From Street</b>	Visible	
<b>Road Type</b>	Public	

Neighborhood & Market Data		
<b>Location Type</b>	Rural	<b>Neighborhood Comments</b> Homes in the area vary in age, style sq ftg and lot size, near lake, park, services and freeway access.
<b>Local Economy</b>	Stable	
<b>Sales Prices in this Neighborhood</b>	Low: \$660,000 High: \$780,000	
<b>Market for this type of property</b>	Increased 1 % in the past 6 months.	
<b>Normal Marketing Days</b>	<90	

### Current Listings

	Subject	Listing 1	Listing 2 *	Listing 3
<b>Street Address</b>	8015 Azucena Avenue	6025 Portola	5505 Portola	8014 Santa Rosa Rd
<b>City, State</b>	Atascadero, CA	Atascadero, CA	Atascadero, CA	Atascadero, CA
<b>Zip Code</b>	93422	93422	93422	93422
<b>Datasource</b>	Tax Records	MLS	MLS	MLS
<b>Miles to Subj.</b>	--	1.12 <sup>1</sup>	1.30 <sup>1</sup>	0.82 <sup>1</sup>
<b>Property Type</b>	SFR	SFR	SFR	SFR
<b>Original List Price \$</b>	\$	\$665,000	\$700,000	\$750,000
<b>List Price \$</b>	--	\$665,000	\$700,000	\$750,000
<b>Original List Date</b>		11/04/2022	11/24/2022	08/23/2022
<b>DOM · Cumulative DOM</b>	-- · --	9 · 39	7 · 19	109 · 112
<b>Age (# of years)</b>	50	49	69	36
<b>Condition</b>	Average	Average	Average	Average
<b>Sales Type</b>	--	Fair Market Value	Fair Market Value	Fair Market Value
<b>Location</b>	Neutral ; Residential	Neutral ; Residential	Neutral ; Residential	Neutral ; Residential
<b>View</b>	Neutral ; Residential	Neutral ; Residential	Neutral ; Residential	Neutral ; Residential
<b>Style/Design</b>	2 Stories conv	1 Story ranch	1 Story ranch	1 Story ranch
<b># Units</b>	1	1	1	1
<b>Living Sq. Feet</b>	1,812	1,802	1,700	2,036
<b>Bdrm · Bths · ½ Bths</b>	3 · 3	3 · 2	4 · 2	3 · 2
<b>Total Room #</b>	8	6	8	6
<b>Garage (Style/Stalls)</b>	Carport 2 Car(s)	None	None	None
<b>Basement (Yes/No)</b>	No	No	No	No
<b>Basement (% Fin)</b>	0%	0%	0%	0%
<b>Basement Sq. Ft.</b>	--	--	--	--
<b>Pool/Spa</b>	--	--	--	--
<b>Lot Size</b>	0.37 acres	0.6 acres	0.79 acres	0.63 acres
<b>Other</b>	--	--	--	--

\* Listing 2 is the most comparable listing to the subject.

<sup>1</sup> Comp's "Miles to Subject" was calculated by the system.

<sup>2</sup> Comp's "Miles to Subject" provided by Real Estate Professional.

<sup>3</sup> Subject \$/ft based upon as-is sale price.

**Listing Comments** Why the comparable listing is superior or inferior to the subject.

**Listing 1** Inferior sq ftg, like age and area, close to freeway , school and services, fireplace, fenced yard, off street parking.

**Listing 2** Inferior sq ftg, age , superior lot size. Home has large lot, off street parking and is near schools and services.

**Listing 3** Superior sq ftg, age and lot size, like area. home has large, fenced and landscaped lot and is near services, lake and park.

### Recent Sales

	Subject	Sold 1	Sold 2 *	Sold 3
<b>Street Address</b>	8015 Azucena Avenue	8039 Azucena	8975 Azucena	8975 Marchant
<b>City, State</b>	Atascadero, CA	Atascadero, CA	Atascadero, CA	Atascadero, CA
<b>Zip Code</b>	93422	93422	93422	93422
<b>Datasource</b>	Tax Records	MLS	MLS	MLS
<b>Miles to Subj.</b>	--	0.05 <sup>1</sup>	0.37 <sup>1</sup>	0.38 <sup>1</sup>
<b>Property Type</b>	SFR	SFR	SFR	SFR
<b>Original List Price \$</b>	--	\$739,000	\$759,000	\$750,000
<b>List Price \$</b>	--	\$739,000	\$759,000	\$750,000
<b>Sale Price \$</b>	--	\$740,000	\$755,000	\$772,000
<b>Type of Financing</b>	--	Va	Conv	Conv
<b>Date of Sale</b>	--	11/10/2022	06/24/2022	12/05/2022
<b>DOM · Cumulative DOM</b>	-- · --	11 · 74	2 · 51	5 · 37
<b>Age (# of years)</b>	50	45	50	44
<b>Condition</b>	Average	Average	Average	Average
<b>Sales Type</b>	--	Fair Market Value	Fair Market Value	Fair Market Value
<b>Location</b>	Neutral ; Residential	Neutral ; Residential	Neutral ; Residential	Neutral ; Residential
<b>View</b>	Neutral ; Residential	Neutral ; Residential	Neutral ; Residential	Neutral ; Residential
<b>Style/Design</b>	2 Stories conv	1 Story ranch	1 Story ranch	1 Story ranch
<b># Units</b>	1	1	1	1
<b>Living Sq. Feet</b>	1,812	1,488	1,846	1,774
<b>Bdrm · Bths · ½ Bths</b>	3 · 3	3 · 2 · 1	3 · 2	3 · 2
<b>Total Room #</b>	8	7	6	6
<b>Garage (Style/Stalls)</b>	Carport 2 Car(s)	Attached 2 Car(s)	Attached 2 Car(s)	Attached 1 Car
<b>Basement (Yes/No)</b>	No	No	No	No
<b>Basement (% Fin)</b>	0%	0%	0%	0%
<b>Basement Sq. Ft.</b>	--	--	--	--
<b>Pool/Spa</b>	--	--	--	--
<b>Lot Size</b>	0.37 acres	0.42 acres	0.36 acres	0.70 acres
<b>Other</b>	--	--	--	--
<b>Net Adjustment</b>	--	+\$37,400	-\$3,400	+\$9,050
<b>Adjusted Price</b>	--	\$777,400	\$751,600	\$781,050

\* Sold 2 is the most comparable sale to the subject.

<sup>1</sup> Comp's "Miles to Subject" was calculated by the system.

<sup>2</sup> Comp's "Miles to Subject" provided by Real Estate Professional.

<sup>3</sup> Subject \$/ft based upon as-is sale price.

### Recent Sales - Cont.

**Reasons for Adjustments** Why the comparable sale is superior or inferior to the subject.

- Sold 1** Inferior sq ftg, superior age, like area. Near lake ,park and services. Home has fenced yard, off street parking, some landscaping. ADJ +32400 sq ftg.+5000 age.
- Sold 2** Superior sq ftg, like age, area and lot size. Home has sunroom, fenced yard, some landscaping, off street parking. ADJ -3400 sq ft
- Sold 3** Inferior sq ftg, superior age and lot size, like area/ Home has covered patio, fenced yard, some landscaping and is near lake and services. ADJ +3800 sq ftg +6000 age. -750 lot size.

## Subject Sales & Listing History

<b>Current Listing Status</b>	Not Currently Listed			<b>Listing History Comments</b>			
<b>Listing Agency/Firm</b>				No prior listings or sales in the past 36 months.			
<b>Listing Agent Name</b>							
<b>Listing Agent Phone</b>							
<b># of Removed Listings in Previous 12 Months</b>	0						
<b># of Sales in Previous 12 Months</b>	0						
<b>Original List Date</b>	<b>Original List Price</b>	<b>Final List Date</b>	<b>Final List Price</b>	<b>Result</b>	<b>Result Date</b>	<b>Result Price</b>	<b>Source</b>

## Marketing Strategy

	<b>As Is Price</b>	<b>Repaired Price</b>
<b>Suggested List Price</b>	\$769,000	\$769,000
<b>Sales Price</b>	\$759,000	\$759,000
<b>30 Day Price</b>	\$752,000	--
<b>Comments Regarding Pricing Strategy</b>		
Comps used are the best available in area, age, sq ftg and lot size. Adjustments have been made for variances in any of the above. Area is stabilizing with longer DOM's, fewer over bids and multiple offers.		

## Clear Capital Quality Assurance Comments Addendum

<b>Reviewer's Notes</b>	The broker's as-is conclusion reflects the market for the subject. Comps are within a reasonable distance, relatively current, and accurately reflect the subject's defining characteristics. Thus, the as-is conclusion appears to be adequately supported.
-------------------------	--

## Subject Photos



Front



Address Verification



Street

## Listing Photos

**L1** 6025 Portola  
Atascadero, CA 93422



Front

**L2** 5505 Portola  
Atascadero, CA 93422



Front

**L3** 8014 Santa Rosa Rd  
Atascadero, CA 93422



Front

## Sales Photos

**S1** 8039 Azucena  
Atascadero, CA 93422



Front

**S2** 8975 Azucena  
Atascadero, CA 93422



Front

**S3** 8975 Marchant  
Atascadero, CA 93422



Front



### ClearMaps Addendum

**Address** ★ 8015 Azucena Avenue, Atascadero, CA 93422

**Loan Number** 51882

**Suggested List** \$769,000

**Suggested Repaired** \$769,000

**Sale** \$759,000

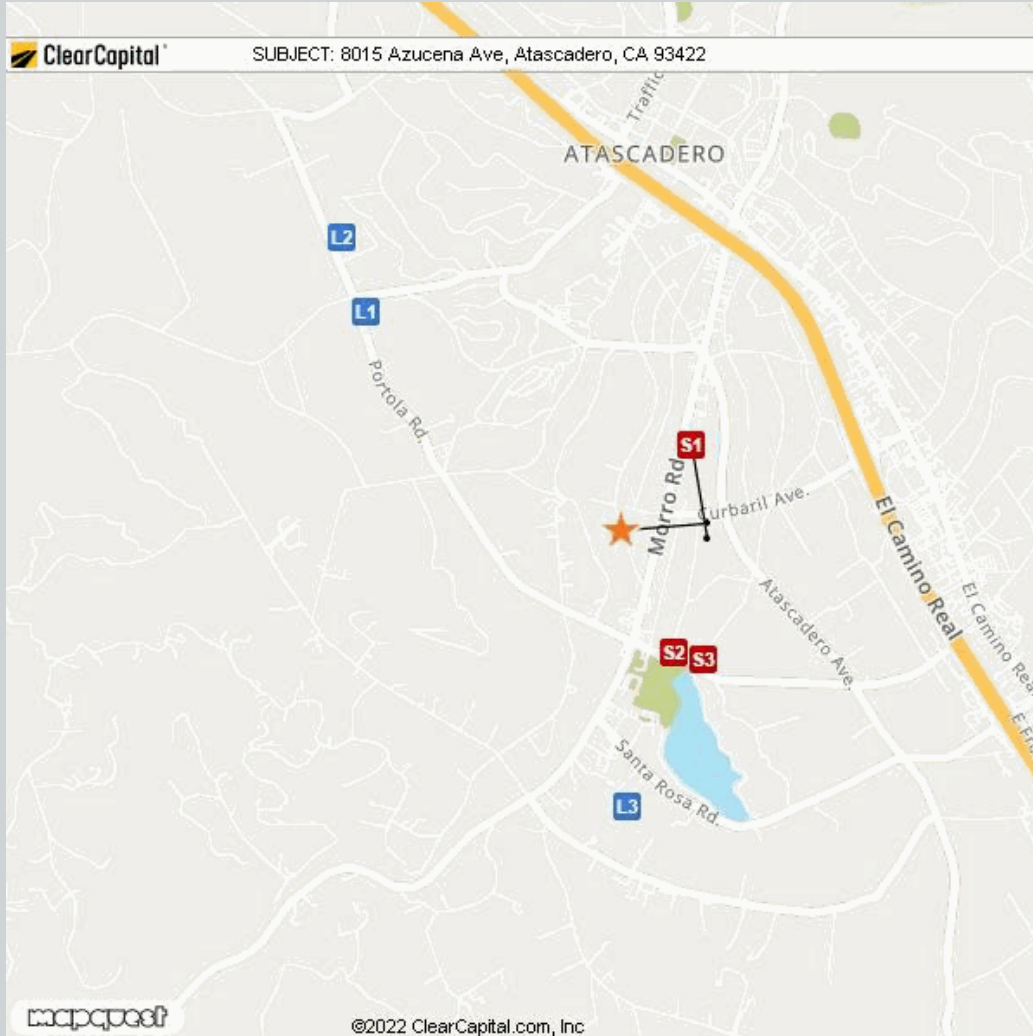

Comparable	Address	Miles to Subject	Mapping Accuracy
★ Subject	8015 Azucena Avenue, Atascadero, CA 93422	--	Parcel Match
L1 Listing 1	6025 Portola, Atascadero, CA 93422	1.12 Miles <sup>1</sup>	Parcel Match
L2 Listing 2	5505 Portola, Atascadero, CA 93422	1.30 Miles <sup>1</sup>	Parcel Match
L3 Listing 3	8014 Santa Rosa Rd, Atascadero, CA 93422	0.82 Miles <sup>1</sup>	Parcel Match
S1 Sold 1	8039 Azucena, Atascadero, CA 93422	0.05 Miles <sup>1</sup>	Parcel Match
S2 Sold 2	8975 Azucena, Atascadero, CA 93422	0.37 Miles <sup>1</sup>	Parcel Match
S3 Sold 3	8975 Marchant, Atascadero, CA 93422	0.38 Miles <sup>1</sup>	Parcel Match

<sup>1</sup> The Comparable "Distance from Subject" value has been calculated by the Clear Capital system.

<sup>2</sup> The Comparable "Distance from Subject" value has been provided by the Real Estate Professional.

## Addendum: Report Purpose

### Market Approach and Market Time

The Market Approach of this report, as established by the customer, is: **Fair Market Price**. (See definition below.)

The Marketing Time as specified by the customer is **Typical**. (See definition below.)

Definitions:

Fair Market Price

A price at which the property would sell between a willing buyer and a willing seller neither being compelled by undue pressure and both having reasonable knowledge of relevant facts.

Distressed Price

A price at which the property would sell between a willing buyer and a seller acting under duress.

Marketing Time

The amount of time the property is exposed to a pool of prospective buyers before going into contract. The customer either specifies the number of days, requests a marketing time that is typical to the subject's market area and/or requests an abbreviated marketing time.

Typical for Local Market

The estimated time required to adequately expose the subject property to the market resulting in a contract of sale.

## Addendum: Report Purpose - cont.

**Report Instructions**

This section shows the instructions that were approved by the customer and provided to the broker prior to completing the report.

Instructions last updated: 7/17/2017

Purpose:

Please determine a fair market price for this property at which it would sell in a typical marketing time for the area.

Customer Specific Requests:

\*\*If the property is commercial or mixed use, please stop and contact Clear Capital as soon as possible\*\*

Form Help:

There are blue question marks (?) throughout this form. These are designed to offer guidance for that particular section of the form. Please click on them for help.

Comparable Requirements:

1. Please use fair market comps from the same neighborhood, block or subdivision whenever possible.
2. Please only use REO comparables if the market is driven by REOs and they are comparable in characteristics and condition.
3. Please use comps that have closed in the past 3 months to show the current market conditions or comment in the report if this is not possible. In rapidly changing markets, active listing comps should be given equal or greater weight than sold comps in your analysis.

Standard Instructions:

1. Clear Capital Code Of Conduct - Please make sure that you are always abiding by the Clear Capital Code of Conduct when completing valuation reports.
2. If the subject is currently listed, please consider all available information pertaining to the subject's condition. This information should be utilized when developing the assumption of the subject's condition.
3. Use the subject characteristics provided in the report Grid (if preloaded) to evaluate the property. This information is from a full interior appraisal and is assumed to be most accurate. If your inspection reveals obvious inaccuracies, please explain in the narrative of the report.
4. Include sufficient detail to help our mutual customer gain a complete understanding of the subject's neighborhood such as neighborhood desirability, amenities, parks, schools, commercial or industrial influences, REO activity, traffic, board-up-homes, etc.
5. Do not approach occupants or owners.
6. If the subject is a Commercial property, contact Clear Capital immediately at 530-582-5011 for direction on how to proceed with the report.
7. Please do not accept if you or your office has completed a report on this property in the last month, are currently listing this property, or have any vested interest in the subject property.
8. Clear Capital does not allow any log ins from IP addresses from foreign countries. This includes, but is not limited to; data entry services, form completion services, etc. Also, it is against Clear Capital code of conduct to share your password with anyone who is not a W2 employee in your office.
9. Clear Capital and our mutual customers greatly appreciate your expertise. If you cannot personally inspect the property, select comparables, and determine a price for the subject, please do not accept this report. Per the standards and guidelines adopted by Clear Capital and other industry leaders, the use of assistants to complete any of the aforementioned tasks is not permitted.

### Report Instructions - cont.

Due to the importance of an independent opinion of price, please do not discuss your price with anyone or be influenced by list price, pending offers, accept comp packets, repair estimates or the listing agent's opinion.

1. One current, original photo of the front of the subject 2. One address verification photo 3. One street scene photo looking down the street 4. MLS listing and sold comp photos required, please comment if no MLS.

## Broker Information

<b>Broker Name</b>	Shannon Simonini	<b>Company/Brokerage</b>	Simonini-Powell Real Estate
<b>License No</b>	01297401	<b>Address</b>	4250 Tranquilla Av Atascadero CA 93422
<b>License Expiration</b>	09/07/2023	<b>License State</b>	CA
<b>Phone</b>	8055509233	<b>Email</b>	sasimonini@charter.net
<b>Broker Distance to Subject</b>	2.11 miles	<b>Date Signed</b>	12/10/2022

*By confirming the above contact and real estate license information and submitting the report, the above signed hereby certifies and agrees that: 1) I personally took the pictures, selected comparables, and determined the price conclusion. 2) To the best of my knowledge, the statements of fact contained in this report are true and correct. 3) The reported analyses, opinions, and conclusions are my personal, impartial, and unbiased professional analyses, opinions, and conclusions. 4) I have no present or prospective interest in the property that is the subject of this report and no personal interest with respect to the parties involved. 5) I have no bias with respect to the property that is the subject of this report or to the parties involved with this assignment. 6) My compensation for completing this assignment is not contingent upon the development or reporting of a predetermined price point. 7) I did not base, either partially or completely, my analysis and/or opinion and conclusions in this report on race, color, religion, sex, age, marital status, handicap, familial status, or national origin of either the prospective owners or occupants of the subject property or of the present owners or occupants of the properties in the vicinity of the subject property or on any other basis prohibited by law. 8) I maintain errors and omissions insurance, to the extent required by state law, for all liability associated with the preparation of this Report.*

## Disclaimer

**This document is not an appraisal as defined by USPAP (Uniform Standards of Professional Appraisal Practice). It is not to be construed as an appraisal and may not be used as such for any purpose.**

### **Unless otherwise specifically agreed to in writing:**

**The intended purpose of this report is to assist the Clear Capital account holder in making decisions within the scope of applicable statutory and regulatory requirements and performing required due diligence. This document is provided solely for the use of the Clear Capital account holder and not any other party, is not intended as any guarantee of value and/or condition of the subject property and should not be relied on as such. In the event that this document is found to be defective, incorrect, negligently prepared or unfit for its authorized use, Clear Capital's sole liability shall be to promptly refund the total fee expended by the account holder for this report or to replace it at no charge to the account holder, but in no event shall Clear Capital be responsible to the account holder for any indirect or consequential damages whatsoever. This warranty is in lieu of all other warranties, express or implied, except where otherwise required by law. The account holder shall notify Clear Capital within thirty (30) days of this report's delivery to the account holder if it believes that this document is defective, incorrect, negligently prepared or unfit for its authorized use. Under no circumstances may Clear Capital forms or their contents be published, copied, replicated, or mimicked.**