

Please Note: This report was completed with the following assumptions: Market Approach: **Fair Market Price** , Marketing Time: **Typical** . Important additional information relating to this report, including use and restrictions, is contained in an attached addendum which is an integral part of this report.

Address	5332 Manor Stone Drive, North Las Vegas, NEVADA 89081	Order ID	8566658	Property ID	33777995
Inspection Date	12/29/2022	Date of Report	12/30/2022		
Loan Number	51912	APN	124-35-213-040		
Borrower Name	Catamount Properties 2018 LLC	County	Clark		

Tracking IDs

Order Tracking ID	12.28.22 BPO	Tracking ID 1	12.28.22 BPO
Tracking ID 2	--	Tracking ID 3	--

General Conditions

Owner	LUZ M MARTINEZ	Condition Comments	
R. E. Taxes	\$1,517	Structure shows no apparent deferred maintenance, maintained landscaping, no repair issues noted.	
Assessed Value	\$104,601		
Zoning Classification	Residential		
Property Type	SFR		
Occupancy	Vacant		
Secure?	Yes		
(Realtor lock box on site)			
Ownership Type	Fee Simple		
Property Condition	Average		
Estimated Exterior Repair Cost	\$0		
Estimated Interior Repair Cost	\$0		
Total Estimated Repair	\$0		
HOA	Cobblestone Manor 702 655-7064		
Association Fees	\$20 / Month (Other: mgmt)		
Visible From Street	Visible		
Road Type	Public		

Neighborhood & Market Data

Location Type	Suburban	Neighborhood Comments	
Local Economy	Stable	Predominant SFR built 2003 to present, maintained neighborhoods, within 1 mile of major arterials and commercial. Competition from new home builders.	
Sales Prices in this Neighborhood	Low: \$345,000 High: \$470,000		
Market for this type of property	Remained Stable for the past 6 months.		
Normal Marketing Days	<90		

Current Listings

	Subject	Listing 1 *	Listing 2	Listing 3
Street Address	5332 Manor Stone Drive	5208 El Prado Heights St	5329 Santa Fe Heights St	5610 Caballo Corral Ct
City, State	North Las Vegas, NEVADA	North Las Vegas, NV	North Las Vegas, NV	North Las Vegas, NV
Zip Code	89081	89081	89081	89081
Datasource	Tax Records	MLS	MLS	MLS
Miles to Subj.	--	0.31 ¹	0.15 ¹	0.33 ¹
Property Type	SFR	SFR	SFR	SFR
Original List Price \$	\$	\$370,000	\$349,900	\$470,000
List Price \$	--	\$370,000	\$374,900	\$443,000
Original List Date		11/21/2022	12/13/2022	09/15/2022
DOM · Cumulative DOM	-- · --	39 · 39	17 · 17	106 · 106
Age (# of years)	18	16	18	2
Condition	Average	Average	Average	Average
Sales Type	--	Investor	Fair Market Value	Fair Market Value
Location	Neutral ; Residential	Neutral ; Residential	Neutral ; Residential	Neutral ; Residential
View	Neutral ; Residential	Neutral ; Residential	Neutral ; Residential	Neutral ; Residential
Style/Design	2 Stories detached	2 Stories detached	2 Stories detached	2 Stories detached
# Units	1	1	1	1
Living Sq. Feet	2,437	2,249	2,249	2,460
Bdrm · Bths · ½ Bths	4 · 2 · 1	4 · 3	4 · 3	3 · 2 · 1
Total Room #	7	7	7	6
Garage (Style/Stalls)	Attached 2 Car(s)	Attached 2 Car(s)	Attached 2 Car(s)	Attached 2 Car(s)
Basement (Yes/No)	No	No	No	No
Basement (% Fin)	0%	0%	0%	0%
Basement Sq. Ft.	--	--	--	--
Pool/Spa	--	--	--	--
Lot Size	0.14 acres	0.10 acres	0.09 acres	0.13 acres
Other	none	none	none	none

* Listing 1 is the most comparable listing to the subject.

¹ Comp's "Miles to Subject" was calculated by the system.

² Comp's "Miles to Subject" provided by Real Estate Professional.

³ Subject \$/ft based upon as-is sale price.

Listing Comments Why the comparable listing is superior or inferior to the subject.

Listing 1 superior: 3 bath -2000. inferior: GLA +13,150 lot size (\$2/sf) +3500. short term tenant occupied 1950/month.

Listing 2 superior: 3 bath -2000. inferior: GLA +13,150 lot size +4350.

Listing 3 superior: age -16,000. inferior: 3 bed +4000. last price change 12/16/22. none of these has accepted offer.

Recent Sales

	Subject	Sold 1	Sold 2 *	Sold 3
Street Address	5332 Manor Stone Drive	5520 Donna St	5224 Aztec Heights St	5234 Spring Canyon St
City, State	North Las Vegas, NEVADA	North Las Vegas, NV	North Las Vegas, NV	North Las Vegas, NV
Zip Code	89081	89081	89081	89081
Datasource	Tax Records	MLS	MLS	MLS
Miles to Subj.	--	0.23 ¹	0.23 ¹	0.21 ¹
Property Type	SFR	SFR	SFR	SFR
Original List Price \$	--	\$485,000	\$434,900	\$399,990
List Price \$	--	\$449,000	\$434,900	\$399,990
Sale Price \$	--	\$435,000	\$435,000	\$438,000
Type of Financing	--	Fha	Fha	Conv
Date of Sale	--	12/20/2022	08/17/2022	08/01/2022
DOM · Cumulative DOM	-- · --	38 · 67	10 · 33	6 · 109
Age (# of years)	18	15	16	20
Condition	Average	Average	Good	Average
Sales Type	--	Fair Market Value	Fair Market Value	Fair Market Value
Location	Neutral ; Residential	Neutral ; Residential	Neutral ; Residential	Neutral ; Residential
View	Neutral ; Residential	Neutral ; Residential	Neutral ; Residential	Neutral ; Residential
Style/Design	2 Stories detached	2 Stories detached	2 Stories detached	2 Stories detached
# Units	1	1	1	1
Living Sq. Feet	2,437	3,079	2,249	2,556
Bdrm · Bths · ½ Bths	4 · 2 · 1	5 · 3	4 · 3	5 · 3
Total Room #	7	8	7	8
Garage (Style/Stalls)	Attached 2 Car(s)	Attached 3 Car(s)	Attached 2 Car(s)	Attached 2 Car(s)
Basement (Yes/No)	No	No	No	No
Basement (% Fin)	0%	0%	0%	0%
Basement Sq. Ft.	--	--	--	--
Pool/Spa	--	--	--	--
Lot Size	0.14 acres	0.14 acres	0.09 acres	0.14 acres
Other	none	fireplace, concessions	none	concessions
Net Adjustment	--	-\$61,950	+\$3,500	-\$17,350
Adjusted Price	--	\$373,050	\$438,500	\$420,650

* Sold 2 is the most comparable sale to the subject.

¹ Comp's "Miles to Subject" was calculated by the system.

² Comp's "Miles to Subject" provided by Real Estate Professional.

³ Subject \$/ft based upon as-is sale price.

Reasons for Adjustments Why the comparable sale is superior or inferior to the subject.

Sold 1 superior: concessions -5000 GLA -44,950 5 bed -4000 3 bath -2000 3 car garage -4000 fireplace -2000. inferior: none.

Sold 2 superior: 3 bath -2000 condition -12,000 recent rehab. inferior: GLA +13,150 lot size +4350.

Sold 3 superior: concessions -3000 GLA -8350 5 bed -4000 3 bath -2000. inferior: none.

Subject Sales & Listing History

Current Listing Status	Not Currently Listed			Listing History Comments			
Listing Agency/Firm				Listed 9/7/22 430,000, price change 9/16/22 419,995, price change 9/28/22 399,995, contract 10/22/22, back on market 11/1/22, price change 11/15/22 385,000, price change 12/7/22 325,000, contract 12/12/22, sold 12/28/22 325,000. Subj had Notice of Default filed 6/28/22.			
Listing Agent Name							
Listing Agent Phone							
# of Removed Listings in Previous 12 Months	0						
# of Sales in Previous 12 Months	1						
Original List Date	Original List Price	Final List Date	Final List Price	Result	Result Date	Result Price	Source
09/07/2022	\$430,000	12/07/2022	\$325,000	Sold	12/28/2022	\$325,000	MLS

Marketing Strategy

	As Is Price	Repaired Price
Suggested List Price	\$382,000	\$382,000
Sales Price	\$374,000	\$374,000
30 Day Price	\$359,000	--
Comments Regarding Pricing Strategy		
Attached MLS sheet shows 5 bedroom, tax record shows 4 bedroom, used auto populated tax record info. Subj is lowest priced sale of 2 story SFR in 0.5 mile radius. List within 2% of sale price, discount quick sale 4%. Common for sales price to be greater than list. Valued subj in lower end of adjusted solds, was both a probate sale and pending foreclosure, prudent buyers would expect some discount pricing due to uncertainty of timely closing. Last 120 days has seen steady price decreases. Looks like subj final price change was too aggressive, sold price well under market.		

Clear Capital Quality Assurance Comments Addendum

Reviewer's The broker's as-is conclusion reflects the market for the subject. Comps are within a reasonable distance, relatively current, and accurately reflect
Notes the subject's defining characteristics. Thus, the as-is conclusion appears to be adequately supported.

Subject Photos



Front



Address Verification



Street

Listing Photos

L1 5208 El Prado Heights St
North Las Vegas, NV 89081



Front

L2 5329 Santa Fe Heights St
North Las Vegas, NV 89081



Front

L3 5610 Caballo Corral Ct
North Las Vegas, NV 89081



Front

Sales Photos

S1 5520 Donna St
North Las Vegas, NV 89081



Front

S2 5224 Aztec Heights St
North Las Vegas, NV 89081



Front

S3 5234 Spring Canyon St
North Las Vegas, NV 89081



Front

ClearMaps Addendum

Address ★ 5332 Manor Stone Drive, North Las Vegas, NEVADA 89081

Loan Number 51912

Suggested List \$382,000

Suggested Repaired \$382,000

Sale \$374,000

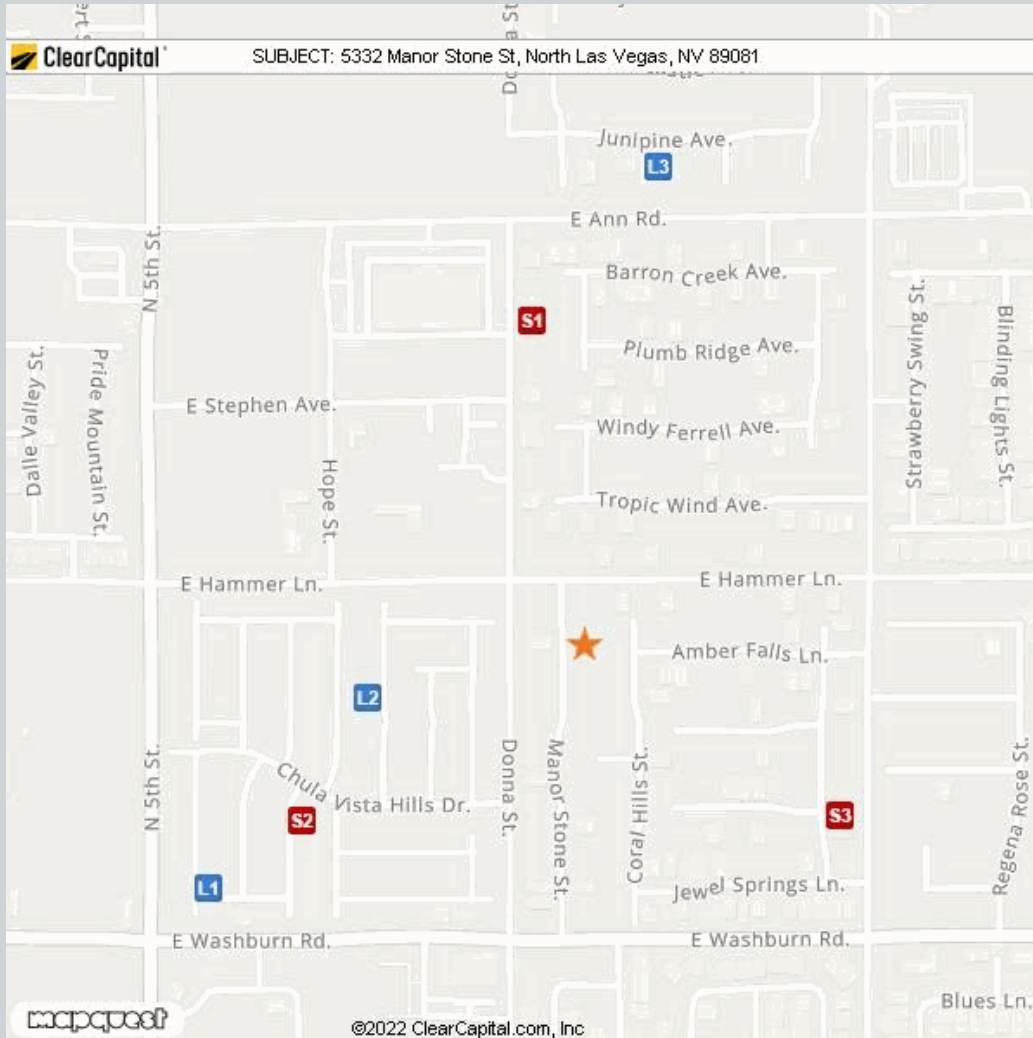

Comparable	Address	Miles to Subject	Mapping Accuracy
★ Subject	5332 Manor Stone Drive, North Las Vegas, Nevada 89081	--	Parcel Match
L1 Listing 1	5208 El Prado Heights St, North Las Vegas, NV 89081	0.31 Miles ¹	Parcel Match
L2 Listing 2	5329 Santa Fe Heights St, North Las Vegas, NV 89081	0.15 Miles ¹	Parcel Match
L3 Listing 3	5610 Caballo Corral Ct, North Las Vegas, NV 89081	0.33 Miles ¹	Parcel Match
S1 Sold 1	5520 Donna St, North Las Vegas, NV 89081	0.23 Miles ¹	Parcel Match
S2 Sold 2	5224 Aztec Heights St, North Las Vegas, NV 89081	0.23 Miles ¹	Parcel Match
S3 Sold 3	5234 Spring Canyon St, North Las Vegas, NV 89081	0.21 Miles ¹	Parcel Match

¹ The Comparable "Distance from Subject" value has been calculated by the Clear Capital system.

² The Comparable "Distance from Subject" value has been provided by the Real Estate Professional.

Addendum: Report Purpose

Market Approach and Market Time

The Market Approach of this report, as established by the customer, is: **Fair Market Price**. (See definition below.)

The Marketing Time as specified by the customer is **Typical**. (See definition below.)

Definitions:

Fair Market Price

A price at which the property would sell between a willing buyer and a willing seller neither being compelled by undue pressure and both having reasonable knowledge of relevant facts.

Distressed Price

A price at which the property would sell between a willing buyer and a seller acting under duress.

Marketing Time

The amount of time the property is exposed to a pool of prospective buyers before going into contract. The customer either specifies the number of days, requests a marketing time that is typical to the subject's market area and/or requests an abbreviated marketing time.

Typical for Local Market

The estimated time required to adequately expose the subject property to the market resulting in a contract of sale.

Addendum: Report Purpose - cont.

Report Instructions

This section shows the instructions that were approved by the customer and provided to the broker prior to completing the report.

Instructions last updated: 7/17/2017

Purpose:

Please determine a fair market price for this property at which it would sell in a typical marketing time for the area.

Customer Specific Requests:

If the property is commercial or mixed use, please stop and contact Clear Capital as soon as possible

Form Help:

There are blue question marks (?) throughout this form. These are designed to offer guidance for that particular section of the form. Please click on them for help.

Comparable Requirements:

1. Please use fair market comps from the same neighborhood, block or subdivision whenever possible.
2. Please only use REO comparables if the market is driven by REOs and they are comparable in characteristics and condition.
3. Please use comps that have closed in the past 3 months to show the current market conditions or comment in the report if this is not possible. In rapidly changing markets, active listing comps should be given equal or greater weight than sold comps in your analysis.

Standard Instructions:

1. Clear Capital Code Of Conduct - Please make sure that you are always abiding by the Clear Capital Code of Conduct when completing valuation reports.
2. If the subject is currently listed, please consider all available information pertaining to the subject's condition. This information should be utilized when developing the assumption of the subject's condition.
3. Use the subject characteristics provided in the report Grid (if preloaded) to evaluate the property. This information is from a full interior appraisal and is assumed to be most accurate. If your inspection reveals obvious inaccuracies, please explain in the narrative of the report.
4. Include sufficient detail to help our mutual customer gain a complete understanding of the subject's neighborhood such as neighborhood desirability, amenities, parks, schools, commercial or industrial influences, REO activity, traffic, board-up-homes, etc.
5. Do not approach occupants or owners.
6. If the subject is a Commercial property, contact Clear Capital immediately at 530-582-5011 for direction on how to proceed with the report.
7. Please do not accept if you or your office has completed a report on this property in the last month, are currently listing this property, or have any vested interest in the subject property.
8. Clear Capital does not allow any log ins from IP addresses from foreign countries. This includes, but is not limited to; data entry services, form completion services, etc. Also, it is against Clear Capital code of conduct to share your password with anyone who is not a W2 employee in your office.
9. Clear Capital and our mutual customers greatly appreciate your expertise. If you cannot personally inspect the property, select comparables, and determine a price for the subject, please do not accept this report. Per the standards and guidelines adopted by Clear Capital and other industry leaders, the use of assistants to complete any of the aforementioned tasks is not permitted.

Report Instructions - cont.

Due to the importance of an independent opinion of price, please do not discuss your price with anyone or be influenced by list price, pending offers, accept comp packets, repair estimates or the listing agent's opinion.

1. One current, original photo of the front of the subject 2. One address verification photo 3. One street scene photo looking down the street 4. MLS listing and sold comp photos required, please comment if no MLS.

Broker Information

Broker Name	David Berg	Company/Brokerage	Elite Realty
License No	S.0032371	Address	Attn: David Berg Las Vegas NV 89117
License Expiration	11/30/2023	License State	NV
Phone	7022815827	Email	lasvegasdavid@gmail.com
Broker Distance to Subject	11.75 miles	Date Signed	12/30/2022

By confirming the above contact and real estate license information and submitting the report, the above signed hereby certifies and agrees that: 1) I personally took the pictures, selected comparables, and determined the price conclusion. 2) To the best of my knowledge, the statements of fact contained in this report are true and correct. 3) The reported analyses, opinions, and conclusions are my personal, impartial, and unbiased professional analyses, opinions, and conclusions. 4) I have no present or prospective interest in the property that is the subject of this report and no personal interest with respect to the parties involved. 5) I have no bias with respect to the property that is the subject of this report or to the parties involved with this assignment. 6) My compensation for completing this assignment is not contingent upon the development or reporting of a predetermined price point. 7) I did not base, either partially or completely, my analysis and/or opinion and conclusions in this report on race, color, religion, sex, age, marital status, handicap, familial status, or national origin of either the prospective owners or occupants of the subject property or of the present owners or occupants of the properties in the vicinity of the subject property or on any other basis prohibited by law. 8) I maintain errors and omissions insurance, to the extent required by state law, for all liability associated with the preparation of this Report.

Disclaimer

Notwithstanding any preprinted language to the contrary, this opinion is not an appraisal of the market value of the property. If an appraisal is desired, the services of a licensed or certified appraiser must be obtained.

Unless otherwise specifically agreed to in writing:

The intended purpose of this report is to assist the Clear Capital account holder in making decisions within the scope of applicable statutory and regulatory requirements and performing required due diligence. This document is provided solely for the use of the Clear Capital account holder and not any other party, is not intended as any guarantee of value and/or condition of the subject property and should not be relied on as such. In the event that this document is found to be defective, incorrect, negligently prepared or unfit for its authorized use, Clear Capital's sole liability shall be to promptly refund the total fee expended by the account holder for this report or to replace it at no charge to the account holder, but in no event shall Clear Capital be responsible to the account holder for any indirect or consequential damages whatsoever. This warranty is in lieu of all other warranties, express or implied, except where otherwise required by law. The account holder shall notify Clear Capital within thirty (30) days of this report's delivery to the account holder if it believes that this document is defective, incorrect, negligently prepared or unfit for its authorized use. Under no circumstances may Clear Capital forms or their contents be published, copied, replicated, or mimicked.