

Please Note: This report was completed with the following assumptions: Market Approach: **Fair Market Price** , Marketing Time: **Typical** . Important additional information relating to this report, including use and restrictions, is contained in an attached addendum which is an integral part of this report.

Address	3605 Woodglow Circle, San Antonio, TEXAS 78244	Order ID	8680892	Property ID	34068869
Inspection Date	04/03/2023	Date of Report	04/03/2023		
Loan Number	52878	APN	05092-803-0200		
Borrower Name	Breckenridge Property Fund 2016 LLC	County	Bexar		

Tracking IDs					
Order Tracking ID	04.03.23_BPO	Tracking ID 1	04.03.23_BPO		
Tracking ID 2	--	Tracking ID 3	--		

General Conditions

Owner	Washington Ellis Norris	Condition Comments	
R. E. Taxes	\$4,039	Based on exterior observation, subject property is in Average condition. No immediate repair or modernization required.	
Assessed Value	\$195,690		
Zoning Classification	Residential		
Property Type	SFR		
Occupancy	Occupied		
Ownership Type	Fee Simple		
Property Condition	Average		
Estimated Exterior Repair Cost	\$0		
Estimated Interior Repair Cost	\$0		
Total Estimated Repair	\$0		
HOA	No		
Visible From Street	Visible		
Road Type	Public		

Neighborhood & Market Data

Location Type	Urban	Neighborhood Comments	
Local Economy	Stable	The subject is located in a suburban neighborhood with stable property values and a balanced supply Vs demand of homes. The economy and employment conditions are stable.	
Sales Prices in this Neighborhood	Low: \$151,200 High: \$281,880		
Market for this type of property	Remained Stable for the past 6 months.		
Normal Marketing Days	<180		

Current Listings

	Subject	Listing 1	Listing 2 *	Listing 3
Street Address	3605 Woodglow Circle	3713 Candlebluff Dr	6043 Lyndell Springs	3634 Candlehead Ln
City, State	San Antonio, TEXAS	San Antonio, TX	San Antonio, TX	San Antonio, TX
Zip Code	78244	78244	78244	78244
Datasource	Tax Records	MLS	MLS	MLS
Miles to Subj.	--	0.18 ¹	0.44 ¹	0.48 ¹
Property Type	SFR	SFR	SFR	SFR
Original List Price \$	\$	\$209,000	\$199,991	\$245,000
List Price \$	--	\$199,000	\$199,991	\$245,000
Original List Date		03/20/2023	03/20/2023	01/21/2023
DOM · Cumulative DOM	-- · --	14 · 14	14 · 14	72 · 72
Age (# of years)	37	28	23	26
Condition	Average	Average	Average	Good
Sales Type	--	Fair Market Value	Fair Market Value	Fair Market Value
Location	Neutral ; Residential	Neutral ; Residential	Neutral ; Residential	Neutral ; Residential
View	Neutral ; Residential	Neutral ; Residential	Neutral ; Residential	Neutral ; Residential
Style/Design	1 Story Ranch	2 Stories Colonial	1 Story Ranch	1 Story Ranch
# Units	1	1	1	1
Living Sq. Feet	1,597	1,501	1,332	1,610
Bdrm · Bths · ½ Bths	3 · 2	3 · 2 · 1	3 · 2	4 · 2
Total Room #	6	6	6	7
Garage (Style/Stalls)	None	Attached 1 Car	Attached 1 Car	Attached 1 Car
Basement (Yes/No)	No	No	No	No
Basement (% Fin)	0%	0%	0%	0%
Basement Sq. Ft.	--	--	--	--
Pool/Spa	--	--	--	--
Lot Size	0.130 acres	0.12 acres	0.12 acres	0.1 acres
Other	None	None	None	None

* Listing 2 is the most comparable listing to the subject.

¹ Comp's "Miles to Subject" was calculated by the system.

² Comp's "Miles to Subject" provided by Real Estate Professional.

³ Subject \$/ft based upon as-is sale price.

Current Listings - Cont.

Listing Comments Why the comparable listing is superior or inferior to the subject.

- Listing 1** Property inferior to the subject in square footage and bed count which makes it similar by comparison.
Adjustments:;Bed:0,Bath:0,HBath:-1000,GLA:\$1920,Garage:\$-2000>Total Adjustment:\$-1080,Net Adjustment Value:\$197920
- Listing 2** Single family home located in the immediate competing market. Its shares values defining qualities with the subject in regard to and location qualities, market appeals, amenities and functional utility. Similar in condition.
Adjustments:;Bed:0,Bath:0,HBath:0,GLA:\$5300,Age:\$-350,Garage:\$-2000>Total Adjustment:\$2950,Net Adjustment Value:\$202941
- Listing 3** Comparable is a larger home on a superior GLA. It has more bedroom. It appears superior to the subject in condition.
Adjustments:Condition:\$-7500,Bed:-3000,Bath:0,HBath:0,Age:\$-275,Garage:\$-2000>Total Adjustment:\$-12775,Net Adjustment Value:\$232225

Recent Sales

	Subject	Sold 1 *	Sold 2	Sold 3
Street Address	3605 Woodglow Circle	3751 Candleglenn	3747 Candleglenn	3602 Cameron Springs
City, State	San Antonio, TEXAS	San Antonio, TX	San Antonio, TX	San Antonio, TX
Zip Code	78244	78244	78244	78244
Datasource	Tax Records	MLS	MLS	MLS
Miles to Subj.	--	0.27 ¹	0.28 ¹	0.43 ¹
Property Type	SFR	SFR	SFR	SFR
Original List Price \$	--	\$199,000	\$249,000	\$234,900
List Price \$	--	\$189,000	\$229,900	\$234,900
Sale Price \$	--	\$189,000	\$225,000	\$234,900
Type of Financing	--	Conventional	Conventional	Conventional
Date of Sale	--	03/30/2023	02/13/2023	03/06/2023
DOM · Cumulative DOM	-- · --	102 · 102	126 · 126	94 · 94
Age (# of years)	37	21	20	25
Condition	Average	Average	Average	Good
Sales Type	--	Fair Market Value	Fair Market Value	Fair Market Value
Location	Neutral ; Residential	Neutral ; Residential	Neutral ; Residential	Neutral ; Residential
View	Neutral ; Residential	Neutral ; Residential	Neutral ; Residential	Neutral ; Residential
Style/Design	1 Story Ranch	1 Story Ranch	2 Stories Colonial	2 Stories Colonial
# Units	1	1	1	1
Living Sq. Feet	1,597	1,422	1,501	1,633
Bdrm · Bths · ½ Bths	3 · 2	3 · 2	3 · 2 · 1	4 · 2 · 1
Total Room #	6	6	6	7
Garage (Style/Stalls)	None	None	Attached 1 Car	Attached 1 Car
Basement (Yes/No)	No	No	No	No
Basement (% Fin)	0%	0%	0%	0%
Basement Sq. Ft.	--	--	--	--
Pool/Spa	--	--	--	--
Lot Size	0.130 acres	0.12 acres	0.12 acres	0.11 acres
Other	None	None	None	None
Net Adjustment	--	+\$3,100	-\$1,505	-\$13,800
Adjusted Price	--	\$192,100	\$223,495	\$221,100

* Sold 1 is the most comparable sale to the subject.

¹ Comp's "Miles to Subject" was calculated by the system.

² Comp's "Miles to Subject" provided by Real Estate Professional.

³ Subject \$/ft based upon as-is sale price.

Recent Sales - Cont.

Reasons for Adjustments Why the comparable sale is superior or inferior to the subject.

- Sold 1** Property is similar to the subject in style, features age, type and location. Similar in condition.
Adjustments:;Bed:0,Bath:0,HBath:0,GLA:\$3500,Age:\$-400,Total Adjustment:3100,Net Adjustment Value:\$192100
- Sold 2** Single family home inferior to subject in square footage. But similar in view, style, condition and location.
Adjustments:;Bed:0,Bath:0,HBath:-1000,GLA:\$1920,Age:\$-425,Garage:\$-2000,Total Adjustment:-1505,Net Adjustment Value:\$223495
- Sold 3** Property superior to the subject in GLA. Bed count makes it slightly superior by comparison. superior in condition.
Adjustments:Condition:\$-7500,Bed:-3000,Bath:0,HBath:-1000,Age:\$-300,Garage:\$-2000,Total Adjustment:-13800,Net Adjustment Value:\$221100

Subject Sales & Listing History

Current Listing Status	Not Currently Listed			Listing History Comments			
Listing Agency/Firm				None Noted			
Listing Agent Name							
Listing Agent Phone							
# of Removed Listings in Previous 12 Months	0						
# of Sales in Previous 12 Months	0						
Original List Date	Original List Price	Final List Date	Final List Price	Result	Result Date	Result Price	Source

Marketing Strategy

	As Is Price	Repaired Price
Suggested List Price	\$215,000	\$215,000
Sales Price	\$205,000	\$205,000
30 Day Price	\$195,000	--
Comments Regarding Pricing Strategy		
<p>The subject is a SFR 1 story, containing 1597sqft, 3bed/2bath, which was built in 1986 and is located near school, park, non residential properties, commercial area and retail stores and will not affect the subject. It was necessary to use a comparable listing with superior in condition due to limited market activity in the subject's area. The difference in bed count due to the neighborhood area is hard to find comparable that is similar to the subject bed count. Comparable with styles dissimilar to the subject (but with similar attributes) were used to provide a basis for the subject's GLA. In delivering final valuation, most weight has been placed on CS1 and CL2 as they are most similar to subject condition and overall structure.</p>		

Clear Capital Quality Assurance Comments Addendum

Reviewer's Notes The broker's as-is conclusion reflects the market for the subject. Comps are within a reasonable distance, relatively current, and accurately reflect the subject's defining characteristics. Thus, the as-is conclusion appears to be adequately supported.

Subject Photos



Front



Address Verification



Street

Listing Photos

L1 3713 Candlebluff Dr
San Antonio, TX 78244



Front

L2 6043 Lyndell Springs
San Antonio, TX 78244



Front

L3 3634 Candlehead Ln
San Antonio, TX 78244



Front

Sales Photos

S1 3751 Candleglenn
San Antonio, TX 78244



Front

S2 3747 Candleglenn
San Antonio, TX 78244



Front

S3 3602 Cameron Springs
San Antonio, TX 78244



Front

ClearMaps Addendum

Address ★ 3605 Woodglow Circle, San Antonio, TEXAS 78244

Loan Number 52878

Suggested List \$215,000

Suggested Repaired \$215,000

Sale \$205,000

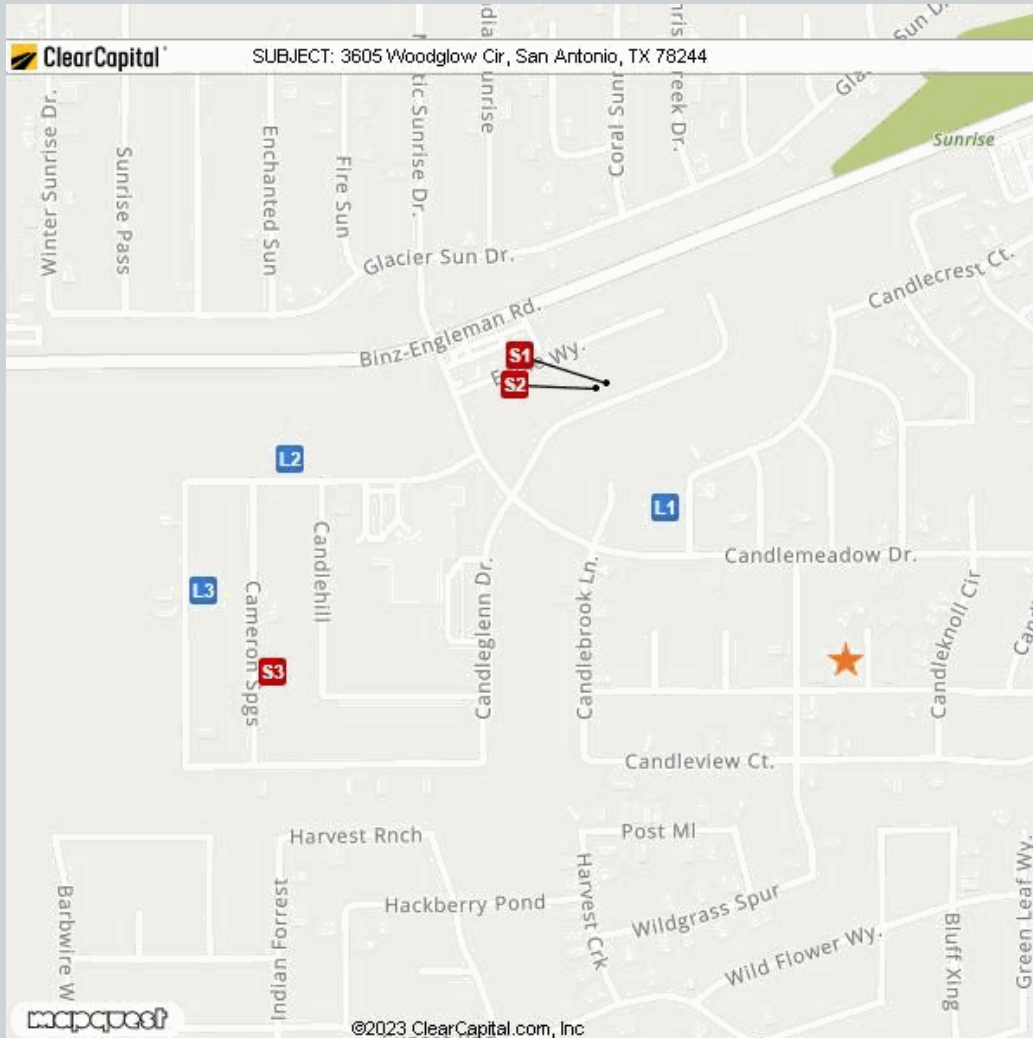

Comparable	Address	Miles to Subject	Mapping Accuracy
★ Subject	3605 Woodglow Circle, San Antonio, Texas 78244	--	Parcel Match
L1 Listing 1	3713 Candlebluff Dr, San Antonio, TX 78244	0.18 Miles ¹	Parcel Match
L2 Listing 2	6043 Lyndell Springs, San Antonio, TX 78244	0.44 Miles ¹	Parcel Match
L3 Listing 3	3634 Candlehead Ln, San Antonio, TX 78244	0.48 Miles ¹	Parcel Match
S1 Sold 1	3751 Candleglenn, San Antonio, TX 78244	0.27 Miles ¹	Parcel Match
S2 Sold 2	3747 Candleglenn, San Antonio, TX 78244	0.28 Miles ¹	Parcel Match
S3 Sold 3	3602 Cameron Springs, San Antonio, TX 78244	0.43 Miles ¹	Parcel Match

¹ The Comparable "Distance from Subject" value has been calculated by the Clear Capital system.

² The Comparable "Distance from Subject" value has been provided by the Real Estate Professional.

Addendum: Report Purpose

Market Approach and Market Time

The Market Approach of this report, as established by the customer, is: **Fair Market Price**. (See definition below.)

The Marketing Time as specified by the customer is **Typical**. (See definition below.)

Definitions:

Fair Market Price

A price at which the property would sell between a willing buyer and a willing seller neither being compelled by undue pressure and both having reasonable knowledge of relevant facts.

Distressed Price

A price at which the property would sell between a willing buyer and a seller acting under duress.

Marketing Time

The amount of time the property is exposed to a pool of prospective buyers before going into contract. The customer either specifies the number of days, requests a marketing time that is typical to the subject's market area and/or requests an abbreviated marketing time.

Typical for Local Market

The estimated time required to adequately expose the subject property to the market resulting in a contract of sale.

Addendum: Report Purpose - cont.

Report Instructions

This section shows the instructions that were approved by the customer and provided to the broker prior to completing the report.

*** Please Note: This is a RUSH assignment. Do not accept if you cannot meet the current due date and time. Please reference the set terms and contact Clear Capital at 530.582.5011 if you require any changes. Thanks! ***

Instructions last updated: 7/17/2017

Purpose:

Please determine a fair market price for this property at which it would sell in a typical marketing time for the area.

Customer Specific Requests:

If the property is commercial or mixed use, please stop and contact Clear Capital as soon as possible

Form Help:

There are blue question marks (?) throughout this form. These are designed to offer guidance for that particular section of the form. Please click on them for help.

Comparable Requirements:

1. Please use fair market comps from the same neighborhood, block or subdivision whenever possible.
2. Please only use REO comparables if the market is driven by REOs and they are comparable in characteristics and condition.
3. Please use comps that have closed in the past 3 months to show the current market conditions or comment in the report if this is not possible. In rapidly changing markets, active listing comps should be given equal or greater weight than sold comps in your analysis.

Standard Instructions:

1. Clear Capital Code Of Conduct - Please make sure that you are always abiding by the Clear Capital Code of Conduct when completing valuation reports.
2. If the subject is currently listed, please consider all available information pertaining to the subject's condition. This information should be utilized when developing the assumption of the subject's condition.
3. Use the subject characteristics provided in the report Grid (if preloaded) to evaluate the property. This information is from a full interior appraisal and is assumed to be most accurate. If your inspection reveals obvious inaccuracies, please explain in the narrative of the report.
4. Include sufficient detail to help our mutual customer gain a complete understanding of the subject's neighborhood such as neighborhood desirability, amenities, parks, schools, commercial or industrial influences, REO activity, traffic, board-up-homes, etc.
5. Do not approach occupants or owners.
6. If the subject is a Commercial property, contact Clear Capital immediately at 530-582-5011 for direction on how to proceed with the report.
7. Please do not accept if you or your office has completed a report on this property in the last month, are currently listing this property, or have any vested interest in the subject property.
8. Clear Capital does not allow any log ins from IP addresses from foreign countries. This includes, but is not limited to; data entry services, form completion services, etc. Also, it is against Clear Capital code of conduct to share your password with anyone who is not a W2 employee in your office.
9. Clear Capital and our mutual customers greatly appreciate your expertise. If you cannot

Report Instructions - cont.

personally inspect the property, select comparables, and determine a price for the subject, please do not accept this report. Per the standards and guidelines adopted by Clear Capital and other industry leaders, the use of assistants to complete any of the aforementioned tasks is not permitted.

Due to the importance of an independent opinion of price, please do not discuss your price with anyone or be influenced by list price, pending offers, accept comp packets, repair estimates or the listing agent's opinion.

1. One current, original photo of the front of the subject 2. One address verification photo 3. One street scene photo looking down the street 4. MLS listing and sold comp photos required, please comment if no MLS.

Broker Information

Broker Name	Lacy Anne Hasbrook	Company/Brokerage	Bang Realty-Texas Inc
License No	590817	Address	1819 N Main Ave San Antonio TX 78212
License Expiration	01/31/2024	License State	TX
Phone	2107560894	Email	sabpo@bangrealty.com
Broker Distance to Subject	7.92 miles	Date Signed	04/03/2023

By confirming the above contact and real estate license information and submitting the report, the above signed hereby certifies and agrees that: 1) I personally took the pictures, selected comparables, and determined the price conclusion. 2) To the best of my knowledge, the statements of fact contained in this report are true and correct. 3) The reported analyses, opinions, and conclusions are my personal, impartial, and unbiased professional analyses, opinions, and conclusions. 4) I have no present or prospective interest in the property that is the subject of this report and no personal interest with respect to the parties involved. 5) I have no bias with respect to the property that is the subject of this report or to the parties involved with this assignment. 6) My compensation for completing this assignment is not contingent upon the development or reporting of a predetermined price point. 7) I did not base, either partially or completely, my analysis and/or opinion and conclusions in this report on race, color, religion, sex, age, marital status, handicap, familial status, or national origin of either the prospective owners or occupants of the subject property or of the present owners or occupants of the properties in the vicinity of the subject property or on any other basis prohibited by law. 8) I maintain errors and omissions insurance, to the extent required by state law, for all liability associated with the preparation of this Report.

Disclaimer

THIS REPORT SHOULD NOT BE CONSIDERED AN APPRAISAL. In making any decision that relies upon my work, you should know that I have not followed the guidelines for development of an appraisal or analysis contained in the Uniform Standards of Professional Appraisal Practice of the Appraisal Foundation.

Unless otherwise specifically agreed to in writing:

The intended purpose of this report is to assist the Clear Capital account holder in making decisions within the scope of applicable statutory and regulatory requirements and performing required due diligence. This document is provided solely for the use of the Clear Capital account holder and not any other party, is not intended as any guarantee of value and/or condition of the subject property and should not be relied on as such. In the event that this document is found to be defective, incorrect, negligently prepared or unfit for its authorized use, Clear Capital's sole liability shall be to promptly refund the total fee expended by the account holder for this report or to replace it at no charge to the account holder, but in no event shall Clear Capital be responsible to the account holder for any indirect or consequential damages whatsoever. This warranty is in lieu of all other warranties, express or implied, except where otherwise required by law. The account holder shall notify Clear Capital within thirty (30) days of this report's delivery to the account holder if it believes that this document is defective, incorrect, negligently prepared or unfit for its authorized use. Under no circumstances may Clear Capital forms or their contents be published, copied, replicated, or mimicked.