

Please Note: This report was completed with the following assumptions: Market Approach: **Fair Market Price** , Marketing Time: **Typical** . Important additional information relating to this report, including use and restrictions, is contained in an attached addendum which is an integral part of this report.

Address	3216 Lykes Drive Ne, Albuquerque, NM 87110	Order ID	8719668	Property ID	34149117
Inspection Date	05/01/2023	Date of Report	05/01/2023		
Loan Number	53421	APN	101906046724841501		
Borrower Name	Breckenridge Property Fund 2016 LLC	County	Bernalillo		

Tracking IDs					
Order Tracking ID	05.01.23 BPO Request	Tracking ID 1	05.01.23 BPO Request		
Tracking ID 2	--	Tracking ID 3	--		

General Conditions		
Owner	JOSEPH A WALL	Condition Comments Subject appears to be in average condition. No damage seen at the time. Yard is being maintained
R. E. Taxes	\$2,356	
Assessed Value	\$70,002	
Zoning Classification	Residential	
Property Type	SFR	
Occupancy	Vacant	
Secure?	Yes	
(Doors and windows appear secure)		
Ownership Type	Fee Simple	
Property Condition	Average	
Estimated Exterior Repair Cost	\$0	
Estimated Interior Repair Cost	\$0	
Total Estimated Repair	\$0	
HOA	No	
Visible From Street	Visible	
Road Type	Public	

Neighborhood & Market Data		
Location Type	Urban	Neighborhood Comments Neighborhood in average and stable condition. REO properties are low. Supply low and demand high. Property value has gone up 13.5% in the past 12 months. Seller Concessions are negotiated and not usually advertised.
Local Economy	Improving	
Sales Prices in this Neighborhood	Low: \$125,000 High: \$550,000	
Market for this type of property	Increased 7 % in the past 6 months.	
Normal Marketing Days	<30	

Current Listings

	Subject	Listing 1	Listing 2 *	Listing 3
Street Address	3216 Lykes Drive Ne	4501 La Barranca Avenue Ne	9104 Hendrix Road Ne	3816 Pennsylvania Street Ne
City, State	Albuquerque, NM	Albuquerque, NM	Albuquerque, NM	Albuquerque, NM
Zip Code	87110	87111	87111	87110
Datasource	Public Records	MLS	MLS	MLS
Miles to Subj.	--	0.61 ¹	0.78 ¹	0.50 ¹
Property Type	SFR	SFR	SFR	SFR
Original List Price \$	\$	\$275,000	\$324,000	\$335,000
List Price \$	--	\$275,000	\$324,000	\$335,000
Original List Date		04/27/2023	04/11/2023	04/09/2023
DOM · Cumulative DOM	-- · --	2 · 4	3 · 20	4 · 22
Age (# of years)	63	58	53	54
Condition	Average	Average	Average	Average
Sales Type	--	Fair Market Value	Fair Market Value	Fair Market Value
Location	Neutral ; Residential	Neutral ; Residential	Neutral ; Residential	Neutral ; Residential
View	Neutral ; Mountain	Neutral ; Mountain	Neutral ; Mountain	Neutral ; Mountain
Style/Design	1 Story Ranch	2 Stories Ranch	1 Story Ranch	1 Story Ranch
# Units	1	1	1	1
Living Sq. Feet	1,898	1,847	1,715	1,936
Bdrm · Bths · ½ Bths	3 · 2	3 · 2	3 · 2	3 · 2
Total Room #	6	6	6	6
Garage (Style/Stalls)	Attached 2 Car(s)	Attached 2 Car(s)	Attached 2 Car(s)	Attached 2 Car(s)
Basement (Yes/No)	No	No	No	No
Basement (% Fin)	0%	0%	0%	0%
Basement Sq. Ft.	--	--	--	--
Pool/Spa	--	--	--	--
Lot Size	0.18 acres	0.23 acres	0.17 acres	0.24 acres
Other	--	--	--	--

* Listing 2 is the most comparable listing to the subject.

¹ Comp's "Miles to Subject" was calculated by the system.

² Comp's "Miles to Subject" provided by Real Estate Professional.

³ Subject \$/ft based upon as-is sale price.

Current Listings - Cont.

Listing Comments Why the comparable listing is superior or inferior to the subject.

- Listing 1** This charming 3 bedroom, possible 4 bedroom, 2 bath home sits on a spacious corner lot and offers an exciting investment opportunity.
- Listing 2** Lovingly maintained & updated home in sought after neighborhood & schools. Curb appeal is enhanced by a courtyard entry into a tiled foyer that is the hub of the living areas. Two large living areas offer a variety of living options for todays families. The formal & casual dining areas lend to even greater flexibility of the floorplan.
- Listing 3** This spacious, well-designed home located in the highly sought-after NE heights, greets you with a beautiful walled and private courtyard entrance. The expansive corner lot offers convenient access to the large backyard. Two living areas will make entertaining friends and family a pleasure as everyone enjoys the inviting interior space the home provides. Generous kitchen cabinet space will bring joy to the home chef. The roomy main bathroom has a large walk in shower. Mature trees will deliver cool shade and a great environment for relaxing outside on calm summer days.

Recent Sales

	Subject	Sold 1	Sold 2 *	Sold 3
Street Address	3216 Lykes Drive Ne	9008 Shoshone Road Ne	3613 General Bradley Street Ne	8312 Delaware Street Ne
City, State	Albuquerque, NM	Albuquerque, NM	Albuquerque, NM	Albuquerque, NM
Zip Code	87110	87111	87111	87110
Datasource	Public Records	MLS	MLS	MLS
Miles to Subj.	--	0.69 ¹	0.24 ¹	0.04 ¹
Property Type	SFR	SFR	SFR	SFR
Original List Price \$	--	\$305,000	\$352,500	\$325,900
List Price \$	--	\$295,000	\$340,000	\$325,900
Sale Price \$	--	\$293,000	\$318,000	\$326,000
Type of Financing	--	Rec	Conventional	Conventional
Date of Sale	--	02/08/2023	03/31/2023	07/01/2022
DOM · Cumulative DOM	-- · --	34 · 55	91 · 126	12 · 49
Age (# of years)	63	69	53	63
Condition	Average	Average	Average	Average
Sales Type	--	Fair Market Value	Fair Market Value	Fair Market Value
Location	Neutral ; Residential	Neutral ; Residential	Neutral ; Residential	Neutral ; Residential
View	Neutral ; Mountain	Neutral ; Mountain	Neutral ; Mountain	Neutral ; Mountain
Style/Design	1 Story Ranch	1 Story Ranch	1 Story Ranch	1 Story Ranch
# Units	1	1	1	1
Living Sq. Feet	1,898	1,863	1,995	1,925
Bdrm · Bths · ½ Bths	3 · 2	3 · 2	3 · 2	3 · 2
Total Room #	6	6	6	6
Garage (Style/Stalls)	Attached 2 Car(s)	None	Attached 2 Car(s)	Attached 2 Car(s)
Basement (Yes/No)	No	No	No	No
Basement (% Fin)	0%	0%	0%	0%
Basement Sq. Ft.	--	--	--	--
Pool/Spa	--	--	--	--
Lot Size	0.18 acres	0.17 acres	0.28 acres	0.14 acres
Other	--	--	--	--
Net Adjustment	--	\$0	\$0	\$0
Adjusted Price	--	\$293,000	\$318,000	\$326,000

* Sold 2 is the most comparable sale to the subject.

¹ Comp's "Miles to Subject" was calculated by the system.

² Comp's "Miles to Subject" provided by Real Estate Professional.

³ Subject \$/ft based upon as-is sale price.

Recent Sales - Cont.

Reasons for Adjustments Why the comparable sale is superior or inferior to the subject.

- Sold 1** Don't let this one get by you! Come and see this family friendly home waiting for a new owner. 3 or 4 bedroom, 2 bath, hobby room, 2 living areas, fireplace, wood floors.
- Sold 2** ADORABLE home in a very convenient and desirable location in the Northeast Heights. Beautiful 3 bedroom 2 full bathrooms with many great features, Refrigerated Air, Large back yard and views of the Sandia Mountains. Home has a (1) large living room, Breakfast Nook, and Home will not last long. and 24.5 x 11.8 Screened Porch.
- Sold 3** Brick Mid-Century Ranch Single story in the Desired Sandia High School Neighborhood Positioned on a Spacious Corner Lot. Just Minutes from Shopping, Eats, Labs and UNM! Two Large Living Areas, Wood Burning Fireplace, 3 Generous Bedrooms, 2 Full Baths, 2 Car Garage. Wood Flooring in the Owner's Suite.

Subject Sales & Listing History

Current Listing Status	Not Currently Listed			Listing History Comments			
Listing Agency/Firm				none to report			
Listing Agent Name							
Listing Agent Phone							
# of Removed Listings in Previous 12 Months	0						
# of Sales in Previous 12 Months	0						
Original List Date	Original List Price	Final List Date	Final List Price	Result	Result Date	Result Price	Source

Marketing Strategy

	As Is Price	Repaired Price
Suggested List Price	\$325,000	\$325,000
Sales Price	\$320,000	\$320,000
30 Day Price	\$315,000	--
Comments Regarding Pricing Strategy		
Comps are based on similarities of the subject's age, condition, GLA, and lot size. Comps are pulled within a 1 mile radius of the subject. Sold comps go back 6 months.		

Clear Capital Quality Assurance Comments Addendum

Reviewer's Notes	The broker's as-is conclusion reflects the market for the subject. Comps are within a reasonable distance, relatively current, and accurately reflect the subject's defining characteristics. Thus, the as-is conclusion appears to be adequately supported.
-------------------------	--

Subject Photos



Front



Address Verification



Address Verification



Street

Listing Photos

L1 4501 La Barranta Avenue NE
Albuquerque, NM 87111



Front

L2 9104 Hendrix Road NE
Albuquerque, NM 87111



Front

L3 3816 Pennsylvania Street NE
Albuquerque, NM 87110



Front

Sales Photos

S1 9008 SHOSHONE Road NE
Albuquerque, NM 87111



Front

S2 3613 GENERAL BRADLEY Street NE
Albuquerque, NM 87111



Front

S3 8312 DELAWARE Street NE
Albuquerque, NM 87110



Front

ClearMaps Addendum

Address ★ 3216 Lykes Drive Ne, Albuquerque, NM 87110

Loan Number 53421

Suggested List \$325,000

Suggested Repaired \$325,000

Sale \$320,000

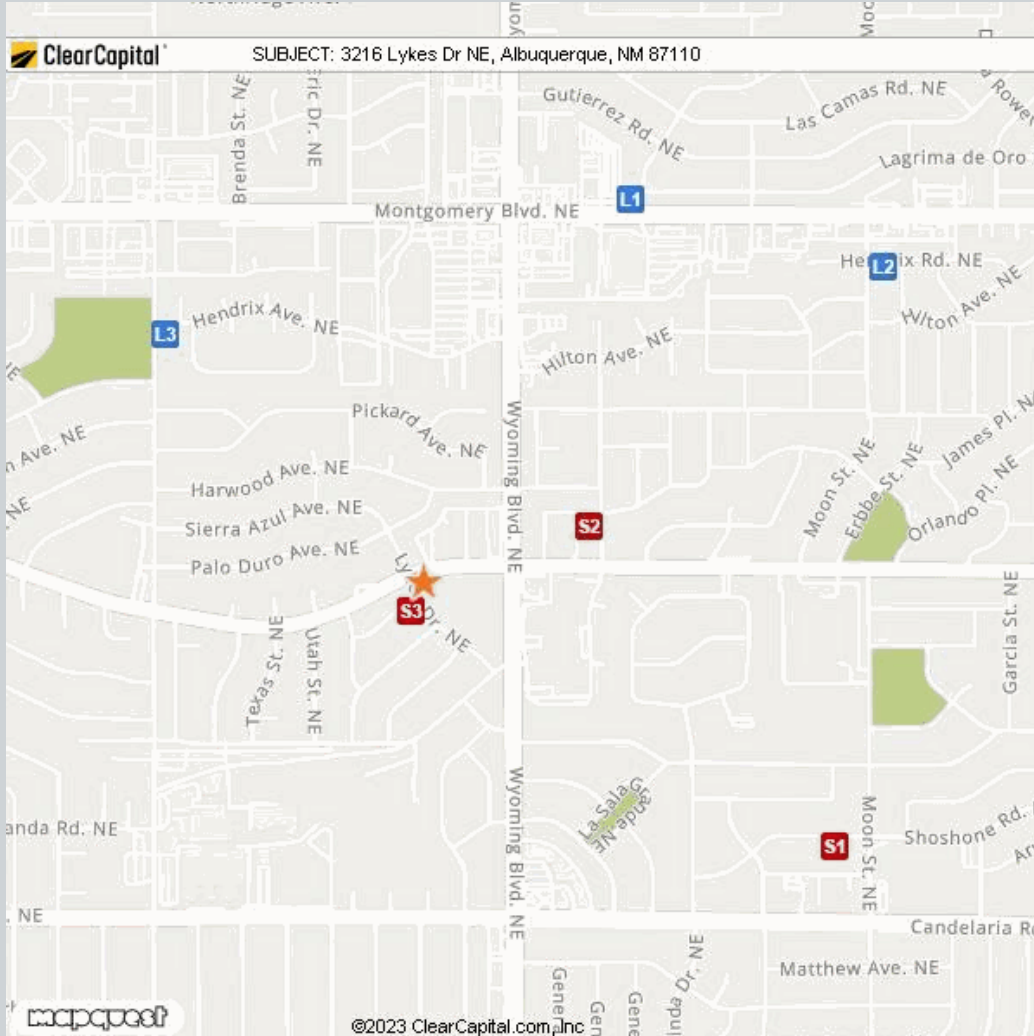

Comparable	Address	Miles to Subject	Mapping Accuracy
★ Subject	3216 Lykes Drive Ne, Albuquerque, NM 87110	--	Parcel Match
L1 Listing 1	4501 La Barranca Avenue Ne, Albuquerque, NM 87110	0.61 Miles ¹	Parcel Match
L2 Listing 2	9104 Hendrix Road Ne, Albuquerque, NM 87110	0.78 Miles ¹	Parcel Match
L3 Listing 3	3816 Pennsylvania Street Ne, Albuquerque, NM 87110	0.50 Miles ¹	Parcel Match
S1 Sold 1	9008 Shoshone Road Ne, Albuquerque, NM 87110	0.69 Miles ¹	Parcel Match
S2 Sold 2	3613 General Bradley Street Ne, Albuquerque, NM 87110	0.24 Miles ¹	Parcel Match
S3 Sold 3	8312 Delaware Street Ne, Albuquerque, NM 87110	0.04 Miles ¹	Parcel Match

¹ The Comparable "Distance from Subject" value has been calculated by the Clear Capital system.

² The Comparable "Distance from Subject" value has been provided by the Real Estate Professional.

Addendum: Report Purpose

Market Approach and Market Time

The Market Approach of this report, as established by the customer, is: **Fair Market Price**. (See definition below.)

The Marketing Time as specified by the customer is **Typical**. (See definition below.)

Definitions:

Fair Market Price

A price at which the property would sell between a willing buyer and a willing seller neither being compelled by undue pressure and both having reasonable knowledge of relevant facts.

Distressed Price

A price at which the property would sell between a willing buyer and a seller acting under duress.

Marketing Time

The amount of time the property is exposed to a pool of prospective buyers before going into contract. The customer either specifies the number of days, requests a marketing time that is typical to the subject's market area and/or requests an abbreviated marketing time.

Typical for Local Market

The estimated time required to adequately expose the subject property to the market resulting in a contract of sale.

Addendum: Report Purpose - cont.

Report Instructions

This section shows the instructions that were approved by the customer and provided to the broker prior to completing the report.

*** Please Note: This is a RUSH assignment. Do not accept if you cannot meet the current due date and time. Please reference the set terms and contact Clear Capital at 530.582.5011 if you require any changes. Thanks! ***

Instructions last updated: 7/17/2017

Purpose:

Please determine a fair market price for this property at which it would sell in a typical marketing time for the area.

Customer Specific Requests:

If the property is commercial or mixed use, please stop and contact Clear Capital as soon as possible

Form Help:

There are blue question marks (?) throughout this form. These are designed to offer guidance for that particular section of the form. Please click on them for help.

Comparable Requirements:

1. Please use fair market comps from the same neighborhood, block or subdivision whenever possible.
2. Please only use REO comparables if the market is driven by REOs and they are comparable in characteristics and condition.
3. Please use comps that have closed in the past 3 months to show the current market conditions or comment in the report if this is not possible. In rapidly changing markets, active listing comps should be given equal or greater weight than sold comps in your analysis.

Standard Instructions:

1. Clear Capital Code Of Conduct - Please make sure that you are always abiding by the Clear Capital Code of Conduct when completing valuation reports.
2. If the subject is currently listed, please consider all available information pertaining to the subject's condition. This information should be utilized when developing the assumption of the subject's condition.
3. Use the subject characteristics provided in the report Grid (if preloaded) to evaluate the property. This information is from a full interior appraisal and is assumed to be most accurate. If your inspection reveals obvious inaccuracies, please explain in the narrative of the report.
4. Include sufficient detail to help our mutual customer gain a complete understanding of the subject's neighborhood such as neighborhood desirability, amenities, parks, schools, commercial or industrial influences, REO activity, traffic, board-up-homes, etc.
5. Do not approach occupants or owners.
6. If the subject is a Commercial property, contact Clear Capital immediately at 530-582-5011 for direction on how to proceed with the report.
7. Please do not accept if you or your office has completed a report on this property in the last month, are currently listing this property, or have any vested interest in the subject property.
8. Clear Capital does not allow any log ins from IP addresses from foreign countries. This includes, but is not limited to; data entry services, form completion services, etc. Also, it is against Clear Capital code of conduct to share your password with anyone who is not a W2 employee in your office.

Report Instructions - cont.

9. Clear Capital and our mutual customers greatly appreciate your expertise. If you cannot personally inspect the property, select comparables, and determine a price for the subject, please do not accept this report. Per the standards and guidelines adopted by Clear Capital and other industry leaders, the use of assistants to complete any of the aforementioned tasks is not permitted.

Due to the importance of an independent opinion of price, please do not discuss your price with anyone or be influenced by list price, pending offers, accept comp packets, repair estimates or the listing agent's opinion.

1. One current, original photo of the front of the subject 2. One address verification photo 3. One street scene photo looking down the street 4. MLS listing and sold comp photos required, please comment if no MLS.

Broker Information

Broker Name	Billy Oney	Company/Brokerage	Realty One
License No	48871	Address	5123 Tecolote NW Albuquerque NM 87120
License Expiration	09/30/2024	License State	NM
Phone	5056881976	Email	billyjackrealty@gmail.com
Broker Distance to Subject	8.65 miles	Date Signed	05/01/2023

By confirming the above contact and real estate license information and submitting the report, the above signed hereby certifies and agrees that: 1) I personally took the pictures, selected comparables, and determined the price conclusion. 2) To the best of my knowledge, the statements of fact contained in this report are true and correct. 3) The reported analyses, opinions, and conclusions are my personal, impartial, and unbiased professional analyses, opinions, and conclusions. 4) I have no present or prospective interest in the property that is the subject of this report and no personal interest with respect to the parties involved. 5) I have no bias with respect to the property that is the subject of this report or to the parties involved with this assignment. 6) My compensation for completing this assignment is not contingent upon the development or reporting of a predetermined price point. 7) I did not base, either partially or completely, my analysis and/or opinion and conclusions in this report on race, color, religion, sex, age, marital status, handicap, familial status, or national origin of either the prospective owners or occupants of the subject property or of the present owners or occupants of the properties in the vicinity of the subject property or on any other basis prohibited by law. 8) I maintain errors and omissions insurance, to the extent required by state law, for all liability associated with the preparation of this Report.

Disclaimer

This document is not an appraisal as defined by USPAP (Uniform Standards of Professional Appraisal Practice). It is not to be construed as an appraisal and may not be used as such for any purpose.

Unless otherwise specifically agreed to in writing:

The intended purpose of this report is to assist the Clear Capital account holder in making decisions within the scope of applicable statutory and regulatory requirements and performing required due diligence. This document is provided solely for the use of the Clear Capital account holder and not any other party, is not intended as any guarantee of value and/or condition of the subject property and should not be relied on as such. In the event that this document is found to be defective, incorrect, negligently prepared or unfit for its authorized use, Clear Capital's sole liability shall be to promptly refund the total fee expended by the account holder for this report or to replace it at no charge to the account holder, but in no event shall Clear Capital be responsible to the account holder for any indirect or consequential damages whatsoever. This warranty is in lieu of all other warranties, express or implied, except where otherwise required by law. The account holder shall notify Clear Capital within thirty (30) days of this report's delivery to the account holder if it believes that this document is defective, incorrect, negligently prepared or unfit for its authorized use. Under no circumstances may Clear Capital forms or their contents be published, copied, replicated, or mimicked.