

Please Note: This report was completed with the following assumptions: Market Approach: **Fair Market Price** , Marketing Time: **Typical** . Important additional information relating to this report, including use and restrictions, is contained in an attached addendum which is an integral part of this report.

Address	740 Oak Dale Avenue, Lake Dallas, TX 75065	Order ID	8833498	Property ID	34393683
Inspection Date	07/17/2023	Date of Report	07/18/2023		
Loan Number	53804	APN	R170589		
Borrower Name	Breckenridge Property Fund 2016 LLC	County	Denton		

Tracking IDs					
Order Tracking ID	07.17.23 BPO Request	Tracking ID 1	07.17.23 BPO Request		
Tracking ID 2	--	Tracking ID 3	--		

General Conditions		
Owner	William & Angela Berryhill	Condition Comments From an exterior visual inspection, property appears to need no repairs and exhibits no deferred maintenance.
R. E. Taxes	\$7,429	
Assessed Value	\$333,478	
Zoning Classification	Single Family	
Property Type	SFR	
Occupancy	Occupied	
Ownership Type	Fee Simple	
Property Condition	Average	
Estimated Exterior Repair Cost	\$0	
Estimated Interior Repair Cost	\$0	
Total Estimated Repair	\$0	
HOA	No	
Visible From Street	Visible	
Road Type	Public	

Neighborhood & Market Data		
Location Type	Suburban	Neighborhood Comments Neighborhood consists of homes built within a decade or less of the subject. Neighborhood homes are of similar style, construction and finish out.
Local Economy	Stable	
Sales Prices in this Neighborhood	Low: \$350,000 High: \$390,000	
Market for this type of property	Remained Stable for the past 6 months.	
Normal Marketing Days	<30	

Current Listings

	Subject	Listing 1	Listing 2 *	Listing 3
Street Address	740 Oak Dale Avenue	743 Cedar Leaf Circle	319 Plantation Oak Avenue	330 Stately Oak Lane
City, State	Lake Dallas, TX	Lake Dallas, TX	Lake Dallas, TX	Lake Dallas, TX
Zip Code	75065	75065	75065	75065
Datasource	Tax Records	MLS	MLS	MLS
Miles to Subj.	--	0.04 ¹	0.24 ¹	0.30 ¹
Property Type	SFR	SFR	SFR	SFR
Original List Price \$	\$	\$340,000	\$359,900	\$399,000
List Price \$	--	\$340,000	\$359,900	\$384,000
Original List Date		06/30/2023	06/29/2023	06/08/2023
DOM · Cumulative DOM	-- · --	17 · 18	7 · 19	27 · 40
Age (# of years)	28	28	27	28
Condition	Average	Average	Average	Average
Sales Type	--	Fair Market Value	Fair Market Value	Fair Market Value
Location	Neutral ; Residential	Neutral ; Residential	Neutral ; Residential	Neutral ; Residential
View	Neutral ; Residential	Neutral ; Residential	Neutral ; Residential	Neutral ; Residential
Style/Design	2 Stories Traditional	1 Story Traditional	1 Story Traditional	2 Stories Traditional
# Units	1	1	1	1
Living Sq. Feet	1,998	1,734	1,865	2,156
Bdrm · Bths · ½ Bths	4 · 2	3 · 2	3 · 2	5 · 2 · 1
Total Room #	9	8	9	9
Garage (Style/Stalls)	Attached 2 Car(s)	Attached 2 Car(s)	Attached 2 Car(s)	Attached 2 Car(s)
Basement (Yes/No)	No	No	No	No
Basement (% Fin)	0%	0%	0%	0%
Basement Sq. Ft.	--	--	--	--
Pool/Spa	Pool - Yes	--	--	--
Lot Size	.16 acres	.17 acres	.17 acres	.16 acres
Other	--	--	--	--

* Listing 2 is the most comparable listing to the subject.

¹ Comp's "Miles to Subject" was calculated by the system.

² Comp's "Miles to Subject" provided by Real Estate Professional.

³ Subject \$/ft based upon as-is sale price.

Current Listings - Cont.

Listing Comments Why the comparable listing is superior or inferior to the subject.

- Listing 1** List one is 264 less square feet (+\$13,200) and has no pool (+\$20K). (An appraiser in our market will use one third of the sold value per square foot of the sold comps-as long as the difference is greater than 100 sf. In this neighborhood, that adjustment is \$50/sf.)
- Listing 2** List two is 133 less square feet (+\$6650) and has no pool (+\$20K). (An appraiser in our market will use one third of the sold value per square foot of the sold comps-as long as the difference is greater than 100 sf. In this neighborhood, that adjustment is \$50/sf.)
- Listing 3** List three is 158 more square feet (-\$7900), has one more half bath (-\$5K) and no pool (+\$20K). (An appraiser in our market will use one third of the sold value per square foot of the sold comps-as long as the difference is greater than 100 sf. In this neighborhood, that adjustment is \$50/sf.)

Recent Sales

	Subject	Sold 1 *	Sold 2	Sold 3
Street Address	740 Oak Dale Avenue	746 Winding Oak Bend Lane	763 Winding Oak Bend Lane	737 Winding Oak Bend Lake
City, State	Lake Dallas, TX	Lake Dallas, TX	Lake Dallas, TX	Lake Dallas, TX
Zip Code	75065	75065	75065	75065
Datasource	Tax Records	MLS	MLS	MLS
Miles to Subj.	--	0.11 ¹	0.11 ¹	0.14 ¹
Property Type	SFR	SFR	SFR	SFR
Original List Price \$	--	\$355,000	\$330,000	\$365,000
List Price \$	--	\$349,900	\$330,000	\$365,000
Sale Price \$	--	\$367,000	\$350,000	\$386,000
Type of Financing	--	Conventional	Conventional	Fha
Date of Sale	--	04/24/2023	05/04/2023	06/16/2023
DOM · Cumulative DOM	-- · --	55 · 76	4 · 20	4 · 58
Age (# of years)	28	28	29	29
Condition	Average	Average	Average	Average
Sales Type	--	Fair Market Value	Fair Market Value	Fair Market Value
Location	Neutral ; Residential	Neutral ; Residential	Neutral ; Residential	Neutral ; Residential
View	Neutral ; Residential	Neutral ; Residential	Neutral ; Residential	Neutral ; Residential
Style/Design	2 Stories Traditional	1 Story Traditional	1 Story Traditional	1 Story Traditional
# Units	1	1	1	1
Living Sq. Feet	1,998	1,734	1,972	1,977
Bdrm · Bths · ½ Bths	4 · 2	3 · 2	3 · 2	4 · 2
Total Room #	9	8	9	9
Garage (Style/Stalls)	Attached 2 Car(s)	Attached 2 Car(s)	Attached 1 Car	Attached 2 Car(s)
Basement (Yes/No)	No	No	No	No
Basement (% Fin)	0%	0%	0%	0%
Basement Sq. Ft.	--	--	--	--
Pool/Spa	Pool - Yes	Pool - Yes	--	--
Lot Size	.16 acres	.15 acres	.17 acres	.18 acres
Other	--	--	--	--
Net Adjustment	--	+\$13,200	+\$25,000	+\$20,000
Adjusted Price	--	\$380,200	\$375,000	\$406,000

* Sold 1 is the most comparable sale to the subject.

¹ Comp's "Miles to Subject" was calculated by the system.

² Comp's "Miles to Subject" provided by Real Estate Professional.

³ Subject \$/ft based upon as-is sale price.

Recent Sales - Cont.

Reasons for Adjustments Why the comparable sale is superior or inferior to the subject.

- Sold 1** Sold one is 264 less square feet (+\$13,200). (An appraiser in our market will use one third of the sold value per square foot of the sold comps-as long as the difference is greater than 100 sf. In this neighborhood, that adjustment is \$50/sf.)
- Sold 2** Sold two is 59 less square feet, has one less garage space (+\$5K) and no pool (+\$20K). (An appraiser in our market will use one third of the sold value per square foot of the sold comps-as long as the difference is greater than 100 sf. In this neighborhood, that adjustment is \$50/sf.)
- Sold 3** Sold three is 21 less square feet and has no pool (+\$20K). (An appraiser in our market will use one third of the sold value per square foot of the sold comps-as long as the difference is greater than 100 sf. In this neighborhood, that adjustment is \$50/sf.)

Subject Sales & Listing History

Current Listing Status Not Currently Listed

Listing Agency/Firm

Listing Agent Name

Listing Agent Phone

of Removed Listings in Previous 12 Months 0

of Sales in Previous 12 Months 0

Listing History Comments

There is no MLS data for this property. The most recent warranty deed transfer took place on 11/2/2021 according to the tax data from the county.

Original List Date	Original List Price	Final List Date	Final List Price	Result	Result Date	Result Price	Source
--------------------	---------------------	-----------------	------------------	--------	-------------	--------------	--------

Marketing Strategy

As Is Price

Repaired Price

Suggested List Price	\$380,000	\$380,000
Sales Price	\$380,000	\$380,000
30 Day Price	\$380,000	--

Comments Regarding Pricing Strategy

Since no repairs are observed, the repaired and "as is" value are the same.

Clear Capital Quality Assurance Comments Addendum

Reviewer's Notes The broker's as-is conclusion reflects the market for the subject. Comps are within a reasonable distance, relatively current, and accurately reflect the subject's defining characteristics. Thus, the as-is conclusion appears to be adequately supported.

Subject Photos



Front



Address Verification



Address Verification



Side



Side



Street

Subject Photos



Street



Other

Listing Photos

L1 743 Cedar Leaf Circle
Lake Dallas, TX 75065



Front

L2 319 Plantation Oak Avenue
Lake Dallas, TX 75065



Front

L3 330 Stately Oak Lane
Lake Dallas, TX 75065



Front

Sales Photos

S1 746 Winding Oak Bend Lane
Lake Dallas, TX 75065



Front

S2 763 Winding Oak Bend Lane
Lake Dallas, TX 75065



Front

S3 737 Winding Oak Bend Lake
Lake Dallas, TX 75065



Front

ClearMaps Addendum

Address ★ 740 Oak Dale Avenue, Lake Dallas, TX 75065

Loan Number 53804

Suggested List \$380,000

Suggested Repaired \$380,000

Sale \$380,000

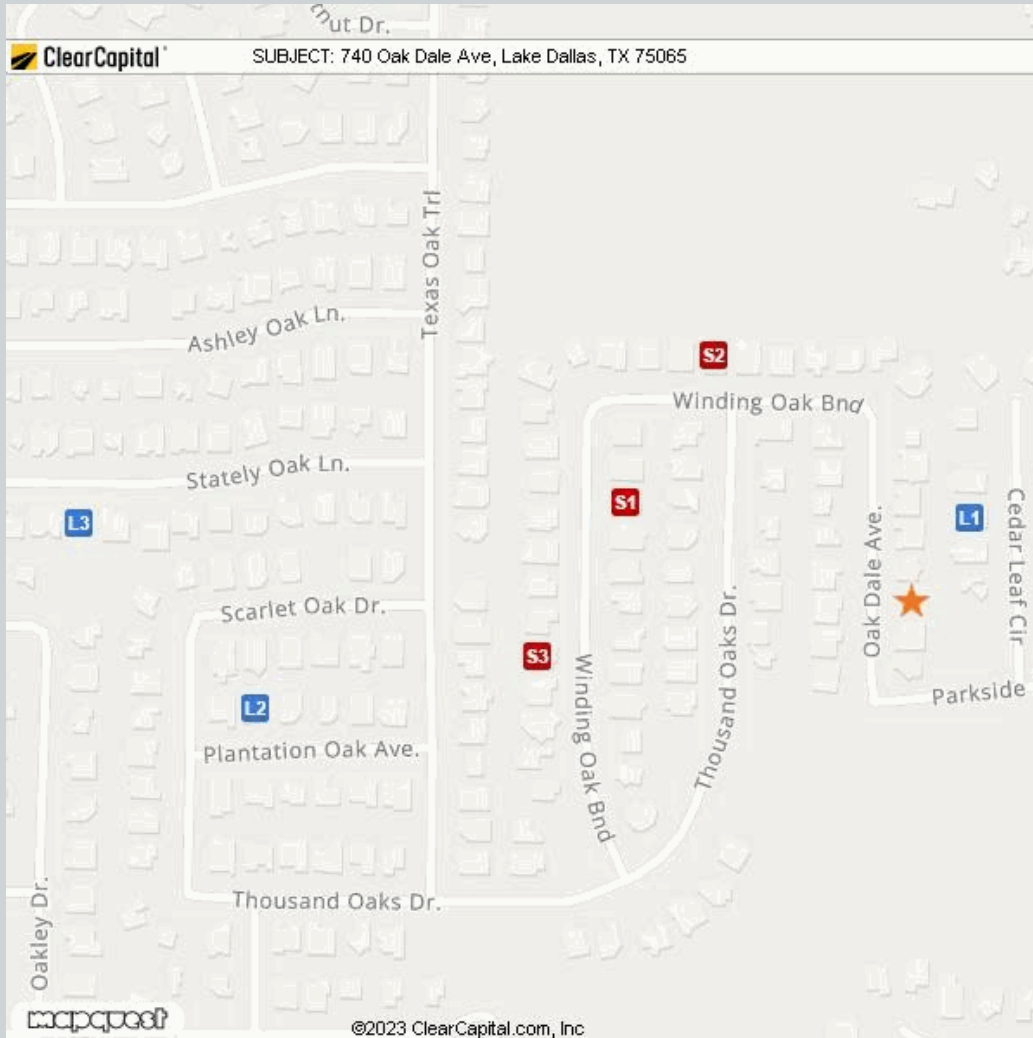

Comparable	Address	Miles to Subject	Mapping Accuracy
★ Subject	740 Oak Dale Avenue, Lake Dallas, TX 75065	--	Parcel Match
L1 Listing 1	743 Cedar Leaf Circle, Lake Dallas, TX 75065	0.04 Miles ¹	Parcel Match
L2 Listing 2	319 Plantation Oak Avenue, Lake Dallas, TX 75065	0.24 Miles ¹	Parcel Match
L3 Listing 3	330 Stately Oak Lane, Lake Dallas, TX 75065	0.30 Miles ¹	Parcel Match
S1 Sold 1	746 Winding Oak Bend Lane, Lake Dallas, TX 75065	0.11 Miles ¹	Parcel Match
S2 Sold 2	763 Winding Oak Bend Lane, Lake Dallas, TX 75065	0.11 Miles ¹	Parcel Match
S3 Sold 3	737 Winding Oak Bend Lake, Lake Dallas, TX 75065	0.14 Miles ¹	Parcel Match

¹ The Comparable "Distance from Subject" value has been calculated by the Clear Capital system.

² The Comparable "Distance from Subject" value has been provided by the Real Estate Professional.

Addendum: Report Purpose

Market Approach and Market Time

The Market Approach of this report, as established by the customer, is: **Fair Market Price**. (See definition below.)

The Marketing Time as specified by the customer is **Typical**. (See definition below.)

Definitions:

Fair Market Price	A price at which the property would sell between a willing buyer and a willing seller neither being compelled by undue pressure and both having reasonable knowledge of relevant facts.
Distressed Price	A price at which the property would sell between a willing buyer and a seller acting under duress.
Marketing Time	The amount of time the property is exposed to a pool of prospective buyers before going into contract. The customer either specifies the number of days, requests a marketing time that is typical to the subject's market area and/or requests an abbreviated marketing time.
Typical for Local Market	The estimated time required to adequately expose the subject property to the market resulting in a contract of sale.

Addendum: Report Purpose - cont.

Report Instructions

This section shows the instructions that were approved by the customer and provided to the broker prior to completing the report.

Instructions last updated: 7/17/2017

Purpose:

Please determine a fair market price for this property at which it would sell in a typical marketing time for the area.

Customer Specific Requests:

If the property is commercial or mixed use, please stop and contact Clear Capital as soon as possible

Form Help:

There are blue question marks (?) throughout this form. These are designed to offer guidance for that particular section of the form. Please click on them for help.

Comparable Requirements:

1. Please use fair market comps from the same neighborhood, block or subdivision whenever possible.
2. Please only use REO comparables if the market is driven by REOs and they are comparable in characteristics and condition.
3. Please use comps that have closed in the past 3 months to show the current market conditions or comment in the report if this is not possible. In rapidly changing markets, active listing comps should be given equal or greater weight than sold comps in your analysis.

Standard Instructions:

1. Clear Capital Code Of Conduct - Please make sure that you are always abiding by the Clear Capital Code of Conduct when completing valuation reports.
2. If the subject is currently listed, please consider all available information pertaining to the subject's condition. This information should be utilized when developing the assumption of the subject's condition.
3. Use the subject characteristics provided in the report Grid (if preloaded) to evaluate the property. This information is from a full interior appraisal and is assumed to be most accurate. If your inspection reveals obvious inaccuracies, please explain in the narrative of the report.
4. Include sufficient detail to help our mutual customer gain a complete understanding of the subject's neighborhood such as neighborhood desirability, amenities, parks, schools, commercial or industrial influences, REO activity, traffic, board-up-homes, etc.
5. Do not approach occupants or owners.
6. If the subject is a Commercial property, contact Clear Capital immediately at 530-582-5011 for direction on how to proceed with the report.
7. Please do not accept if you or your office has completed a report on this property in the last month, are currently listing this property, or have any vested interest in the subject property.
8. Clear Capital does not allow any log ins from IP addresses from foreign countries. This includes, but is not limited to; data entry services, form completion services, etc. Also, it is against Clear Capital code of conduct to share your password with anyone who is not a W2 employee in your office.
9. Clear Capital and our mutual customers greatly appreciate your expertise. If you cannot personally inspect the property, select comparables, and determine a price for the subject, please do not accept this report. Per the standards and guidelines adopted by Clear Capital and other industry leaders, the use of assistants to complete any of the aforementioned tasks is not permitted.

Report Instructions - cont.

Due to the importance of an independent opinion of price, please do not discuss your price with anyone or be influenced by list price, pending offers, accept comp packets, repair estimates or the listing agent's opinion.

1. One current, original photo of the front of the subject 2. One address verification photo 3. One street scene photo looking down the street 4. MLS listing and sold comp photos required, please comment if no MLS.

Broker Information

Broker Name	Jason Hewitt	Company/Brokerage	REMAX Trinity
License No	593477	Address	2220 Ellis Drive Flower Mound TX 75028
License Expiration	10/31/2023	License State	TX
Phone	9728160184	Email	jason@jasonhewitthomes.com
Broker Distance to Subject	8.42 miles	Date Signed	07/18/2023

By confirming the above contact and real estate license information and submitting the report, the above signed hereby certifies and agrees that: 1) I personally took the pictures, selected comparables, and determined the price conclusion. 2) To the best of my knowledge, the statements of fact contained in this report are true and correct. 3) The reported analyses, opinions, and conclusions are my personal, impartial, and unbiased professional analyses, opinions, and conclusions. 4) I have no present or prospective interest in the property that is the subject of this report and no personal interest with respect to the parties involved. 5) I have no bias with respect to the property that is the subject of this report or to the parties involved with this assignment. 6) My compensation for completing this assignment is not contingent upon the development or reporting of a predetermined price point. 7) I did not base, either partially or completely, my analysis and/or opinion and conclusions in this report on race, color, religion, sex, age, marital status, handicap, familial status, or national origin of either the prospective owners or occupants of the subject property or of the present owners or occupants of the properties in the vicinity of the subject property or on any other basis prohibited by law. 8) I maintain errors and omissions insurance, to the extent required by state law, for all liability associated with the preparation of this Report.

Disclaimer

THIS REPORT SHOULD NOT BE CONSIDERED AN APPRAISAL. In making any decision that relies upon my work, you should know that I have not followed the guidelines for development of an appraisal or analysis contained in the Uniform Standards of Professional Appraisal Practice of the Appraisal Foundation.

Unless otherwise specifically agreed to in writing:

The intended purpose of this report is to assist the Clear Capital account holder in making decisions within the scope of applicable statutory and regulatory requirements and performing required due diligence. This document is provided solely for the use of the Clear Capital account holder and not any other party, is not intended as any guarantee of value and/or condition of the subject property and should not be relied on as such. In the event that this document is found to be defective, incorrect, negligently prepared or unfit for its authorized use, Clear Capital's sole liability shall be to promptly refund the total fee expended by the account holder for this report or to replace it at no charge to the account holder, but in no event shall Clear Capital be responsible to the account holder for any indirect or consequential damages whatsoever. This warranty is in lieu of all other warranties, express or implied, except where otherwise required by law. The account holder shall notify Clear Capital within thirty (30) days of this report's delivery to the account holder if it believes that this document is defective, incorrect, negligently prepared or unfit for its authorized use. Under no circumstances may Clear Capital forms or their contents be published, copied, replicated, or mimicked.