

Please Note: This report was completed with the following assumptions: Market Approach: **Fair Market Price** , Marketing Time: **Typical** . Important additional information relating to this report, including use and restrictions, is contained in an attached addendum which is an integral part of this report.

<b>Address</b>	10508 Mission Lakes Avenue, Las Vegas, NV 89134	<b>Order ID</b>	8817888	<b>Property ID</b>	34337379
<b>Inspection Date</b>	07/07/2023	<b>Date of Report</b>	07/07/2023		
<b>Loan Number</b>	54109	<b>APN</b>	137-24-310-104		
<b>Borrower Name</b>	Catamount Properties 2018 LLC	<b>County</b>	Clark		

<b>Tracking IDs</b>					
<b>Order Tracking ID</b>	07.06.23 BPO Request	<b>Tracking ID 1</b>	07.06.23 BPO Request		
<b>Tracking ID 2</b>	--	<b>Tracking ID 3</b>	--		

General Conditions		Condition Comments
<b>Owner</b>	Charlene Ann Kogler	Property is in typical condition to the neighborhood which is average. No signs of damage, deferred maintenance or HOA violations visible. Landscape is maintained and typical to the neighborhood. Monarch Model.
<b>R. E. Taxes</b>	\$2,121	
<b>Assessed Value</b>	\$106,292	
<b>Zoning Classification</b>	Single Family Res	
<b>Property Type</b>	SFR	
<b>Occupancy</b>	Vacant	
<b>Secure?</b>	Yes	
	(doors locked, 24/7 drive-by security by HOA)	
<b>Ownership Type</b>	Fee Simple	
<b>Property Condition</b>	Average	
<b>Estimated Exterior Repair Cost</b>	\$0	
<b>Estimated Interior Repair Cost</b>		
<b>Total Estimated Repair</b>	\$0	
<b>HOA</b>	Sun City Summerlin SFD 702-966-1400	
<b>Association Fees</b>	\$137 / Month (Pool,Tennis,Greenbelt,Other: Golf, P&R, Activity Centers)	
<b>Visible From Street</b>	Visible	
<b>Road Type</b>	Public	

Neighborhood & Market Data		Neighborhood Comments
<b>Location Type</b>	Suburban	Sun City Summerlin is a 55+ age-restricted community in the northwest sector of Summer North Master Planned Development. Large community built around 3 golf courses. 1 person over the age of 50 must be on title to qualify. Spouses under 50 can inherit upon primary death. Clubhouses with pools, tennis, activities and golf. Golf cart community. Prices have a wide range based on golf course frontage, size and view lots. Single story construction. Most properties are 1100 - 2000 square feet, 2 - 3 bedrooms, 2-3 bathrooms. Retail, groceries, dining, public transportation are immediately outside th...
<b>Local Economy</b>	Stable	
<b>Sales Prices in this Neighborhood</b>	Low: \$372,000 High: \$437,000	
<b>Market for this type of property</b>	Remained Stable for the past 6 months.	
<b>Normal Marketing Days</b>	<90	

## Neighborhood Comments

Sun City Summerlin is a 55+ age-restricted community in the northwest sector of Summer North Master Planned Development. Large community built around 3 golf courses. 1 person over the age of 50 must be on title to qualify. Spouses under 50 can inherit upon primary death. Clubhouses with pools, tennis, activities and golf. Golf cart community. Prices have a wide range based on golf course frontage, size and view lots. Single story construction. Most properties are 1100 - 2000 square feet, 2 - 3 bedrooms, 2-3 bathrooms. Retail, groceries, dining, public transportation are immediately outside the entrances. Typical properties are maintained and have been updated. Fully renovated properties are becoming popular. Golf cart community, garages include a golf cart parking area. No new construction within the development. HOA fees are for the master development, no separate community fees. Buy in fee is \$1,790 which is a capital contribution to the HOA and typically paid by the buyer. Townhouses have higher HOA fees which includes landscape maintenance front and rear. Subject is SFD.

## Current Listings

	Subject	Listing 1	Listing 2 *	Listing 3
<b>Street Address</b>	10508 Mission Lakes Avenue	10400 Linfield Pl	10720 Clarion Ln	10409 Marymont Pl
<b>City, State</b>	Las Vegas, NV	Las Vegas, NV	Las Vegas, NV	Las Vegas, NV
<b>Zip Code</b>	89134	89134	89134	89134
<b>Datasource</b>	MLS	MLS	MLS	MLS
<b>Miles to Subj.</b>	--	0.49 <sup>1</sup>	0.32 <sup>1</sup>	0.56 <sup>1</sup>
<b>Property Type</b>	SFR	SFR	SFR	SFR
<b>Original List Price \$</b>	\$	\$420,000	\$385,000	\$425,000
<b>List Price \$</b>	--	\$420,000	\$385,000	\$425,000
<b>Original List Date</b>		06/29/2023	05/24/2023	05/25/2023
<b>DOM · Cumulative DOM</b>	-- · --	8 · 8	1 · 44	20 · 43
<b>Age (# of years)</b>	26	27	25	27
<b>Condition</b>	Average	Average	Average	Average
<b>Sales Type</b>	--	Fair Market Value	Fair Market Value	Fair Market Value
<b>Location</b>	Neutral ; Residential	Neutral ; Residential	Neutral ; Residential	Neutral ; Residential
<b>View</b>	Neutral ; Residential	Neutral ; Residential	Neutral ; Residential	Neutral ; Residential
<b>Style/Design</b>	1 Story conventional	1 Story conventional	1 Story conventional	1 Story conventional
<b># Units</b>	1	1	1	1
<b>Living Sq. Feet</b>	1,360	1,511	1,360	1,402
<b>Bdrm · Bths · ½ Bths</b>	2 · 2	2 · 2	2 · 2	2 · 2
<b>Total Room #</b>	4	4	4	4
<b>Garage (Style/Stalls)</b>	Attached 2 Car(s)	Attached 2 Car(s)	Attached 2 Car(s)	Attached 2 Car(s)
<b>Basement (Yes/No)</b>	No	No	No	No
<b>Basement (% Fin)</b>	0%	0%	0%	0%
<b>Basement Sq. Ft.</b>	--	--	--	--
<b>Pool/Spa</b>	--	--	--	--
<b>Lot Size</b>	0.23 acres	0.15 acres	0.15 acres	0.15 acres
<b>Other</b>	--	--	--	--

\* Listing 2 is the most comparable listing to the subject.

<sup>1</sup> Comp's "Miles to Subject" was calculated by the system.

<sup>2</sup> Comp's "Miles to Subject" provided by Real Estate Professional.

<sup>3</sup> Subject \$/ft based upon as-is sale price.

**Listing Comments** Why the comparable listing is superior or inferior to the subject.

**Listing 1** Similar size and style, similar interior layout. Typical interior finishes. Typical lot style and landscape.

**Listing 2** Model match to subject. Typical interior finishes. Typical landscape design. Most similar due to model match. Under contract, conventional loan offer since 6/3/23.

**Listing 3** Similar model style and layout. Typical interior finishes. Typical landscape style. Under contract, conventional loan offer since 6/14/23.

## Recent Sales

	Subject	Sold 1	Sold 2	Sold 3 *
<b>Street Address</b>	10508 Mission Lakes Avenue	10720 Mission Lakes Av	2229 Airlands St	10809 Brinkwood Av
<b>City, State</b>	Las Vegas, NV	Las Vegas, NV	Las Vegas, NV	Las Vegas, NV
<b>Zip Code</b>	89134	89134	89134	89134
<b>Datasource</b>	MLS	MLS	MLS	MLS
<b>Miles to Subj.</b>	--	0.34 <sup>1</sup>	0.40 <sup>1</sup>	0.47 <sup>1</sup>
<b>Property Type</b>	SFR	SFR	SFR	SFR
<b>Original List Price \$</b>	--	\$419,900	\$375,000	\$385,000
<b>List Price \$</b>	--	\$378,000	\$375,000	\$385,000
<b>Sale Price \$</b>	--	\$378,000	\$382,500	\$385,000
<b>Type of Financing</b>	--	Conventional	Va	Cash
<b>Date of Sale</b>	--	05/24/2023	05/01/2023	04/10/2023
<b>DOM · Cumulative DOM</b>	-- · --	112 · 161	14 · 53	3 · 23
<b>Age (# of years)</b>	26	25	26	25
<b>Condition</b>	Average	Average	Average	Average
<b>Sales Type</b>	--	Fair Market Value	Fair Market Value	Fair Market Value
<b>Location</b>	Neutral ; Residential	Neutral ; Residential	Neutral ; Residential	Neutral ; Residential
<b>View</b>	Neutral ; Residential	Neutral ; Residential	Neutral ; Residential	Neutral ; Residential
<b>Style/Design</b>	1 Story conventional	1 Story conventional	1 Story conventional	1 Story conventional
<b># Units</b>	1	1	1	1
<b>Living Sq. Feet</b>	1,360	1,215	1,215	1,360
<b>Bdrm · Bths · ½ Bths</b>	2 · 2	2 · 2	2 · 2	2 · 2
<b>Total Room #</b>	4	4	4	4
<b>Garage (Style/Stalls)</b>	Attached 2 Car(s)	Attached 2 Car(s)	Attached 2 Car(s)	Attached 2 Car(s)
<b>Basement (Yes/No)</b>	No	No	No	No
<b>Basement (% Fin)</b>	0%	0%	0%	0%
<b>Basement Sq. Ft.</b>	--	--	--	--
<b>Pool/Spa</b>	--	--	--	--
<b>Lot Size</b>	0.23 acres	0.15 acres	0.16 acres	0.15 acres
<b>Other</b>	--	--	--	--
<b>Net Adjustment</b>	--	\$0	\$0	\$0
<b>Adjusted Price</b>	--	\$378,000	\$382,500	\$385,000

\* Sold 3 is the most comparable sale to the subject.

<sup>1</sup> Comp's "Miles to Subject" was calculated by the system.

<sup>2</sup> Comp's "Miles to Subject" provided by Real Estate Professional.

<sup>3</sup> Subject \$/ft based upon as-is sale price.

## Recent Sales - Cont.

**Reasons for Adjustments** Why the comparable sale is superior or inferior to the subject.

- Sold 1** Similar size and model style to subject. Typical interior finishes. Typical backyard landscape design. No adjustment necessary. \$7,500 seller concession
- Sold 2** Similar model style and size as subject. Typical interior finishes. Typical landscape style. No adjustments necessary. \$7,500 seller concession.
- Sold 3** Model match to subject. Same interior layout. Typical interior finishes. Typical landscape design. No adjustments necessary.

## Subject Sales & Listing History

<b>Current Listing Status</b>	Not Currently Listed			<b>Listing History Comments</b>			
<b>Listing Agency/Firm</b>				Last recorded sale MLS 2499865 \$385,000 6/30/2023			
<b>Listing Agent Name</b>							
<b>Listing Agent Phone</b>							
<b># of Removed Listings in Previous 12 Months</b>	0						
<b># of Sales in Previous 12 Months</b>	1						
<b>Original List Date</b>	<b>Original List Price</b>	<b>Final List Date</b>	<b>Final List Price</b>	<b>Result</b>	<b>Result Date</b>	<b>Result Price</b>	<b>Source</b>
06/02/2023	\$390,000	--	--	Sold	06/30/2023	\$385,000	MLS

## Marketing Strategy

	<b>As Is Price</b>	<b>Repaired Price</b>
<b>Suggested List Price</b>	\$395,000	\$395,000
<b>Sales Price</b>	\$385,000	\$385,000
<b>30 Day Price</b>	\$384,000	--
<b>Comments Regarding Pricing Strategy</b>		
All comps from Sun City. Preferred comps are typical lots not on the golf course or city views with typical interior finishes. Median DOM is 43, mix of loans and cash and seller concessions median range 0-\$7,500 37% of the time. No adjustments necessary, all comps very similar all around. I have no existing or contemplated interest in the property.		

## Clear Capital Quality Assurance Comments Addendum

**Reviewer's** The broker's as-is conclusion reflects the market for the subject. Comps are within a reasonable distance, relatively current, and accurately reflect  
**Notes** the subject's defining characteristics. Thus, the as-is conclusion appears to be adequately supported.

## Subject Photos



Front



Address Verification



Side



Side



Street



Street



## Listing Photos

**L1** 10400 Linfield PL  
Las Vegas, NV 89134



Front

**L2** 10720 Clarion LN  
Las Vegas, NV 89134



Front

**L3** 10409 Marymont PL  
Las Vegas, NV 89134



Front

## Sales Photos

**S1** 10720 Mission Lakes AV  
Las Vegas, NV 89134



Front

**S2** 2229 Airlands ST  
Las Vegas, NV 89134



Front

**S3** 10809 Brinkwood AV  
Las Vegas, NV 89134



Front

## ClearMaps Addendum

**Address** ★ 10508 Mission Lakes Avenue, Las Vegas, NV 89134

**Loan Number** 54109

**Suggested List** \$395,000

**Suggested Repaired** \$395,000

**Sale** \$385,000

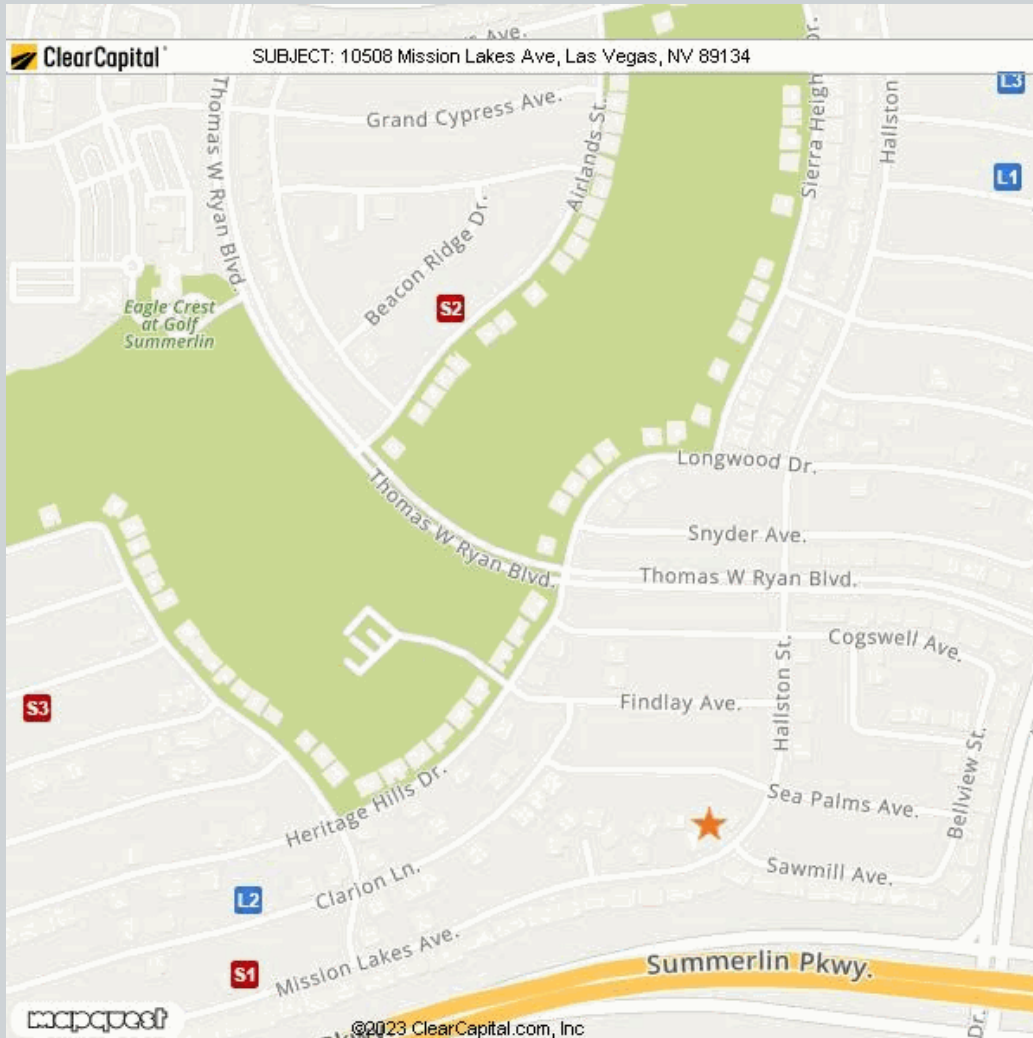

Comparable	Address	Miles to Subject	Mapping Accuracy
★ Subject	10508 Mission Lakes Avenue, Las Vegas, NV 89134	--	Parcel Match
L1 Listing 1	10400 Linfield Pl, Las Vegas, NV 89134	0.49 Miles <sup>1</sup>	Parcel Match
L2 Listing 2	10720 Clarion Ln, Las Vegas, NV 89134	0.32 Miles <sup>1</sup>	Parcel Match
L3 Listing 3	10409 Marymont Pl, Las Vegas, NV 89134	0.56 Miles <sup>1</sup>	Parcel Match
S1 Sold 1	10720 Mission Lakes Av, Las Vegas, NV 89134	0.34 Miles <sup>1</sup>	Parcel Match
S2 Sold 2	2229 Airlands St, Las Vegas, NV 89134	0.40 Miles <sup>1</sup>	Parcel Match
S3 Sold 3	10809 Brinkwood Av, Las Vegas, NV 89134	0.47 Miles <sup>1</sup>	Parcel Match

<sup>1</sup> The Comparable "Distance from Subject" value has been calculated by the Clear Capital system.

<sup>2</sup> The Comparable "Distance from Subject" value has been provided by the Real Estate Professional.

## Addendum: Report Purpose

### Market Approach and Market Time

The Market Approach of this report, as established by the customer, is: **Fair Market Price**. (See definition below.)

The Marketing Time as specified by the customer is **Typical**. (See definition below.)

Definitions:

Fair Market Price	A price at which the property would sell between a willing buyer and a willing seller neither being compelled by undue pressure and both having reasonable knowledge of relevant facts.
Distressed Price	A price at which the property would sell between a willing buyer and a seller acting under duress.
Marketing Time	The amount of time the property is exposed to a pool of prospective buyers before going into contract. The customer either specifies the number of days, requests a marketing time that is typical to the subject's market area and/or requests an abbreviated marketing time.
Typical for Local Market	The estimated time required to adequately expose the subject property to the market resulting in a contract of sale.

## Addendum: Report Purpose - cont.

**Report Instructions**

This section shows the instructions that were approved by the customer and provided to the broker prior to completing the report.

Instructions last updated: 7/17/2017

Purpose:

Please determine a fair market price for this property at which it would sell in a typical marketing time for the area.

Customer Specific Requests:

\*\*If the property is commercial or mixed use, please stop and contact Clear Capital as soon as possible\*\*

Form Help:

There are blue question marks (?) throughout this form. These are designed to offer guidance for that particular section of the form. Please click on them for help.

Comparable Requirements:

1. Please use fair market comps from the same neighborhood, block or subdivision whenever possible.
2. Please only use REO comparables if the market is driven by REOs and they are comparable in characteristics and condition.
3. Please use comps that have closed in the past 3 months to show the current market conditions or comment in the report if this is not possible. In rapidly changing markets, active listing comps should be given equal or greater weight than sold comps in your analysis.

Standard Instructions:

1. Clear Capital Code Of Conduct - Please make sure that you are always abiding by the Clear Capital Code of Conduct when completing valuation reports.
2. If the subject is currently listed, please consider all available information pertaining to the subject's condition. This information should be utilized when developing the assumption of the subject's condition.
3. Use the subject characteristics provided in the report Grid (if preloaded) to evaluate the property. This information is from a full interior appraisal and is assumed to be most accurate. If your inspection reveals obvious inaccuracies, please explain in the narrative of the report.
4. Include sufficient detail to help our mutual customer gain a complete understanding of the subject's neighborhood such as neighborhood desirability, amenities, parks, schools, commercial or industrial influences, REO activity, traffic, board-up-homes, etc.
5. Do not approach occupants or owners.
6. If the subject is a Commercial property, contact Clear Capital immediately at 530-582-5011 for direction on how to proceed with the report.
7. Please do not accept if you or your office has completed a report on this property in the last month, are currently listing this property, or have any vested interest in the subject property.
8. Clear Capital does not allow any log ins from IP addresses from foreign countries. This includes, but is not limited to; data entry services, form completion services, etc. Also, it is against Clear Capital code of conduct to share your password with anyone who is not a W2 employee in your office.
9. Clear Capital and our mutual customers greatly appreciate your expertise. If you cannot personally inspect the property, select comparables, and determine a price for the subject, please do not accept this report. Per the standards and guidelines adopted by Clear Capital and other industry leaders, the use of assistants to complete any of the aforementioned tasks is not permitted.

## Report Instructions - cont.

Due to the importance of an independent opinion of price, please do not discuss your price with anyone or be influenced by list price, pending offers, accept comp packets, repair estimates or the listing agent's opinion.

1. One current, original photo of the front of the subject 2. One address verification photo 3. One street scene photo looking down the street 4. MLS listing and sold comp photos required, please comment if no MLS.

## Broker Information

<b>Broker Name</b>	Kristina Pearson	<b>Company/Brokerage</b>	Signature Real Estate Group
<b>License No</b>	S.0066424.LLC	<b>Address</b>	10714 Sky Meadows DR Las Vegas NV 89134
<b>License Expiration</b>	07/31/2024	<b>License State</b>	NV
<b>Phone</b>	7025245336	<b>Email</b>	go2lvh@gmail.com
<b>Broker Distance to Subject</b>	0.59 miles	<b>Date Signed</b>	07/07/2023

*/Kristina Pearson/*

*By confirming the above contact and real estate license information and submitting the report, the above signed hereby certifies and agrees that: 1) I personally took the pictures, selected comparables, and determined the price conclusion. 2) To the best of my knowledge, the statements of fact contained in this report are true and correct. 3) The reported analyses, opinions, and conclusions are my personal, impartial, and unbiased professional analyses, opinions, and conclusions. 4) I have no present or prospective interest in the property that is the subject of this report and no personal interest with respect to the parties involved. 5) I have no bias with respect to the property that is the subject of this report or to the parties involved with this assignment. 6) My compensation for completing this assignment is not contingent upon the development or reporting of a predetermined price point. 7) I did not base, either partially or completely, my analysis and/or opinion and conclusions in this report on race, color, religion, sex, age, marital status, handicap, familial status, or national origin of either the prospective owners or occupants of the subject property or of the present owners or occupants of the properties in the vicinity of the subject property or on any other basis prohibited by law. 8) I maintain errors and omissions insurance, to the extent required by state law, for all liability associated with the preparation of this Report.*

## Addendum: NV Broker's Price Opinion Qualification

The attached Broker's Price Opinion ("BPO") has been prepared by: **Kristina Pearson** ("Licensee"), **S.0066424.LLC** (License #) who is an active licensee in good standing.

Licensee is affiliated with **Signature Real Estate Group** (Company).

This Addendum is an integral part of the BPO prepared by Licensee and the BPO is considered incomplete without it.

1. This BPO has been prepared for **Wedgewood Inc** (Beneficiary or agent of Beneficiary hereinafter "Beneficiary") regarding the real property commonly known and described as: **10508 Mission Lakes Avenue, Las Vegas, NV 89134**
2. Licensee is informed that the Beneficiary's interest in the real property is that of a third party making decisions or performing due diligence for an existing or potential lien holder.
3. The intended purpose of this BPO is to assist the Beneficiary in making decisions within the scope of applicable statutory and regulatory requirements and performing required due diligence.
4. Licensee certifies that Licensee has no existing or contemplated interest in the property, including without limitation the possibility of Licensee representing the seller or any purchaser.

Issue date: **July 7, 2023**

Licensee signature: */Kristina Pearson/*

**NOTWITHSTANDING ANY PREPRINTED LANGUAGE TO THE CONTRARY, THIS OPINION IS NOT AN APPRAISAL OF THE MARKET VALUE OF THE PROPERTY. IF AN APPRAISAL IS DESIRED, THE SERVICES OF A LICENSED OR CERTIFIED APPRAISER MUST BE OBTAINED.**

## Disclaimer

**Notwithstanding any preprinted language to the contrary, this opinion is not an appraisal of the market value of the property. If an appraisal is desired, the services of a licensed or certified appraiser must be obtained.**

Unless otherwise specifically agreed to in writing:

The intended purpose of this report is to assist the Clear Capital account holder in making decisions within the scope of applicable statutory and regulatory requirements and performing required due diligence. This document is provided solely for the use of the Clear Capital account holder and not any other party, is not intended as any guarantee of value and/or condition of the subject property and should not be relied on as such. In the event that this document is found to be defective, incorrect, negligently prepared or unfit for its authorized use, Clear Capital's sole liability shall be to promptly refund the total fee expended by the account holder for this report or to replace it at no charge to the account holder, but in no event shall Clear Capital be responsible to the account holder for any indirect or consequential damages whatsoever. This warranty is in lieu of all other warranties, express or implied, except where otherwise required by law. The account holder shall notify Clear Capital within thirty (30) days of this report's delivery to the account holder if it believes that this document is defective, incorrect, negligently prepared or unfit for its authorized use. Under no circumstances may Clear Capital forms or their contents be published, copied, replicated, or mimicked.