

Please Note: This report was completed with the following assumptions: Market Approach: **Fair Market Price** , Marketing Time: **Typical** . Important additional information relating to this report, including use and restrictions, is contained in an attached addendum which is an integral part of this report.

Address	1320 Guaymas Place Ne, Albuquerque, NEWMEXICO 87110	Order ID	8801046	Property ID	34306341
Inspection Date	06/23/2023	Date of Report	06/23/2023		
Loan Number	54145	APN	101905833933010820		
Borrower Name	Breckenridge Property Fund 2016 LLC	County	Bernalillo		

Tracking IDs					
Order Tracking ID	06.23.23 BPO Request	Tracking ID 1	06.23.23 BPO Request		
Tracking ID 2	--	Tracking ID 3	--		

General Conditions		
Owner	JAN BURCH	Condition Comments Subject appears to be in average condition. No damage seen at the time. Yard is being maintained.
R. E. Taxes	\$2,475	
Assessed Value	\$60,190	
Zoning Classification	Residential	
Property Type	SFR	
Occupancy	Vacant	
Secure?	Yes	
(doors and windows appear secured.)		
Ownership Type	Fee Simple	
Property Condition	Average	
Estimated Exterior Repair Cost	\$0	
Estimated Interior Repair Cost	\$0	
Total Estimated Repair	\$0	
HOA	No	
Visible From Street	Visible	
Road Type	Public	

Neighborhood & Market Data		
Location Type	Urban	Neighborhood Comments Neighborhood in average and stable condition. REO properties are low. Supply low and demand high. Property value has gone up 18.2% in the past 12 months. Seller Concessions are negotiated and not usually advertised.
Local Economy	Improving	
Sales Prices in this Neighborhood	Low: \$125,000 High: \$475,000	
Market for this type of property	Increased 9 % in the past 6 months.	
Normal Marketing Days	<30	

Current Listings

	Subject	Listing 1	Listing 2 *	Listing 3
Street Address	1320 Guaymas Place Ne	6225 Hannett Avenue Ne	2221 Utah Street Ne	900 San Pablo Street Ne
City, State	Albuquerque, NEWMEXICO	Albuquerque, NM	Albuquerque, NM	Albuquerque, NM
Zip Code	87110	87110	87110	87110
Datasource	Public Records	MLS	MLS	MLS
Miles to Subj.	--	0.98 ¹	0.77 ¹	0.62 ¹
Property Type	SFR	SFR	SFR	SFR
Original List Price \$	\$	\$298,500	\$300,000	\$305,000
List Price \$	--	\$289,500	\$300,000	\$305,000
Original List Date		05/18/2023	06/16/2023	06/20/2023
DOM · Cumulative DOM	-- · --	6 · 36	4 · 7	3 · 3
Age (# of years)	70	70	73	63
Condition	Average	Average	Average	Average
Sales Type	--	Fair Market Value	Fair Market Value	Fair Market Value
Location	Neutral ; Residential	Neutral ; Residential	Neutral ; Residential	Neutral ; Residential
View	Neutral ; Mountain	Neutral ; Mountain	Neutral ; Mountain	Neutral ; Mountain
Style/Design	1 Story Ranch	1 Story Ranch	1 Story Ranch	1 Story Ranch
# Units	1	1	1	1
Living Sq. Feet	1,834	1,708	1,843	195
Bdrm · Bths · ½ Bths	3 · 2	3 · 2	3 · 2	3 · 2
Total Room #	6	6	6	6
Garage (Style/Stalls)	Carport 2 Car(s)	None	None	None
Basement (Yes/No)	No	No	No	No
Basement (% Fin)	0%	0%	0%	0%
Basement Sq. Ft.	--	--	--	--
Pool/Spa	--	--	--	--
Lot Size	0.15 acres	0.15 acres	0.19 acres	0.15 acres
Other	--	--	--	--

* Listing 2 is the most comparable listing to the subject.

¹ Comp's "Miles to Subject" was calculated by the system.

² Comp's "Miles to Subject" provided by Real Estate Professional.

³ Subject \$/ft based upon as-is sale price.

Current Listings - Cont.

Listing Comments Why the comparable listing is superior or inferior to the subject.

- Listing 1** Close to Uptown, UNM, Coronado Mall, City maintained trails, park and more. Spacious, flexible floor plan with 2 living areas. Sliding barn doors offer privacy with a contemporary/modern appeal. Park like backyard (flagstone) with nice views...great set up for BarBQs and summer entertaining.
- Listing 2** This wonderful home has been lovingly maintained by the current owner. Enjoy the convenience of location from this great mid city neighborhood. This home offers 3 nicely sized bedrooms, 2 bathrooms, an open kitchen, a large dining room, a formal living room, and a family room with a wood burning fireplace.
- Listing 3** Rustic Feel to this home in the Jerry Cline Area. Three Bedroom home with updated Kitchen and Hall Bath Room. Primary Bedroom enclosed the four bedroom for a larger bathroom. Natural SW yards. Fenced front and Back. Access for Truck or RV in backyard. Close to uptown, parks , KAFB, Medical Groups, shopping and I40.

Recent Sales

	Subject	Sold 1	Sold 2 *	Sold 3
Street Address	1320 Guaymas Place Ne	1337 Boatright Drive Ne	1345 Marron Circle Ne	2103 Vermont Street Ne
City, State	Albuquerque, NEWMEXICO	Albuquerque, NM	Albuquerque, NM	Albuquerque, NM
Zip Code	87110	87112	87112	87110
Datasource	Public Records	MLS	MLS	MLS
Miles to Subj.	--	0.47 ¹	0.52 ¹	0.71 ¹
Property Type	SFR	SFR	SFR	SFR
Original List Price \$	--	\$315,000	\$259,900	\$280,000
List Price \$	--	\$2,749,000	\$259,900	\$280,000
Sale Price \$	--	\$245,000	\$270,000	\$281,000
Type of Financing	--	Conventional	Conventional	Conventional
Date of Sale	--	07/20/2022	02/13/2023	08/09/2022
DOM · Cumulative DOM	-- · --	53 · 89	35 · 106	4 · 55
Age (# of years)	70	78	71	64
Condition	Average	Average	Average	Average
Sales Type	--	Fair Market Value	Fair Market Value	Fair Market Value
Location	Neutral ; Residential	Neutral ; Residential	Neutral ; Residential	Neutral ; Residential
View	Neutral ; Mountain	Neutral ; Mountain	Neutral ; Mountain	Neutral ; Mountain
Style/Design	1 Story Ranch	1 Story Ranch	1 Story Ranch	1 Story Ranch
# Units	1	1	1	1
Living Sq. Feet	1,834	2,044	1,704	1,940
Bdrm · Bths · ½ Bths	3 · 2	4 · 2	4 · 2	3 · 2
Total Room #	6	7	7	6
Garage (Style/Stalls)	Carport 2 Car(s)	Attached 2 Car(s)	None	Attached 1 Car
Basement (Yes/No)	No	No	No	No
Basement (% Fin)	0%	0%	0%	0%
Basement Sq. Ft.	--	--	--	--
Pool/Spa	--	--	--	--
Lot Size	0.15 acres	0.17 acres	0.16 acres	0.15 acres
Other	--	--	--	--
Net Adjustment	--	\$0	\$0	\$0
Adjusted Price	--	\$245,000	\$270,000	\$281,000

* Sold 2 is the most comparable sale to the subject.

¹ Comp's "Miles to Subject" was calculated by the system.

² Comp's "Miles to Subject" provided by Real Estate Professional.

³ Subject \$/ft based upon as-is sale price.

Recent Sales - Cont.

Reasons for Adjustments Why the comparable sale is superior or inferior to the subject.

- Sold 1** This one of a kind home offers 4 bedrooms and 2 baths. Has a spacious living area and kitchen. Kitchen offers beautiful and plenty cabinet space. Large backyard for all your entertainment needs. Separate garage located in the back which can be converted into a casita to generate additional monthly income. Great location, near shopping, schools and entertainment.
- Sold 2** Great NE heights location in the Sandia school district. Enjoy this single story 4 bedroom 1.75 bath. Large back yard some mountain views.
- Sold 3** The Kitchen features a gas range and a skylight for natural light to flow in while you cook your favorite meals! A Jack and Jill 3/4 Bath connects bedrooms two and three! Separate laundry room with washer, dryer, and utility sink!. Enclosed patio/sunroom. Unwind after a stressful day in the backyard while surrounded by lush green landscaping and mature shade trees! Enjoy a morning cup of coffee in the Sunroom or a sunset! Quick access to I40! Close to shopping and dining! Schedule a private showing today!

Subject Sales & Listing History

Current Listing Status	Not Currently Listed			Listing History Comments			
Listing Agency/Firm				none			
Listing Agent Name							
Listing Agent Phone							
# of Removed Listings in Previous 12 Months	0						
# of Sales in Previous 12 Months	0						
Original List Date	Original List Price	Final List Date	Final List Price	Result	Result Date	Result Price	Source

Marketing Strategy

	As Is Price	Repaired Price
Suggested List Price	\$275,000	\$275,000
Sales Price	\$270,000	\$270,000
30 Day Price	\$265,000	--
Comments Regarding Pricing Strategy		
Comps are based on similarities of the subject's age, condition, GLA, and lot size. Comps are pulled within a 2 mile radius of the subject. Sold comps go back 12 months. Had to the radius and went back 12 months for sold comps due to a shortage of listing and sold comps. Extending the radius does not make any difference in value.		

Clear Capital Quality Assurance Comments Addendum

Reviewer's Notes The broker's as-is conclusion reflects the market for the subject. Comps are within a reasonable distance, relatively current, and accurately reflect the subject's defining characteristics. Thus, the as-is conclusion appears to be adequately supported.

Subject Photos



Front



Address Verification



Side



Street

Listing Photos

L1 6225 Hannett Avenue NE
Albuquerque, NM 87110



Front

L2 2221 Utah Street NE
Albuquerque, NM 87110



Front

L3 900 San Pablo Street NE
Albuquerque, NM 87110



Front

Sales Photos

S1 1337 BOATRRIGHT Drive NE
Albuquerque, NM 87112



Front

S2 1345 MARRON Circle NE
Albuquerque, NM 87112



Front

S3 2103 VERMONT Street NE
Albuquerque, NM 87110



Front

ClearMaps Addendum

Address ★ 1320 Guaymas Place Ne, Albuquerque, NEWMEXICO 87110

Loan Number 54145

Suggested List \$275,000

Suggested Repaired \$275,000

Sale \$270,000

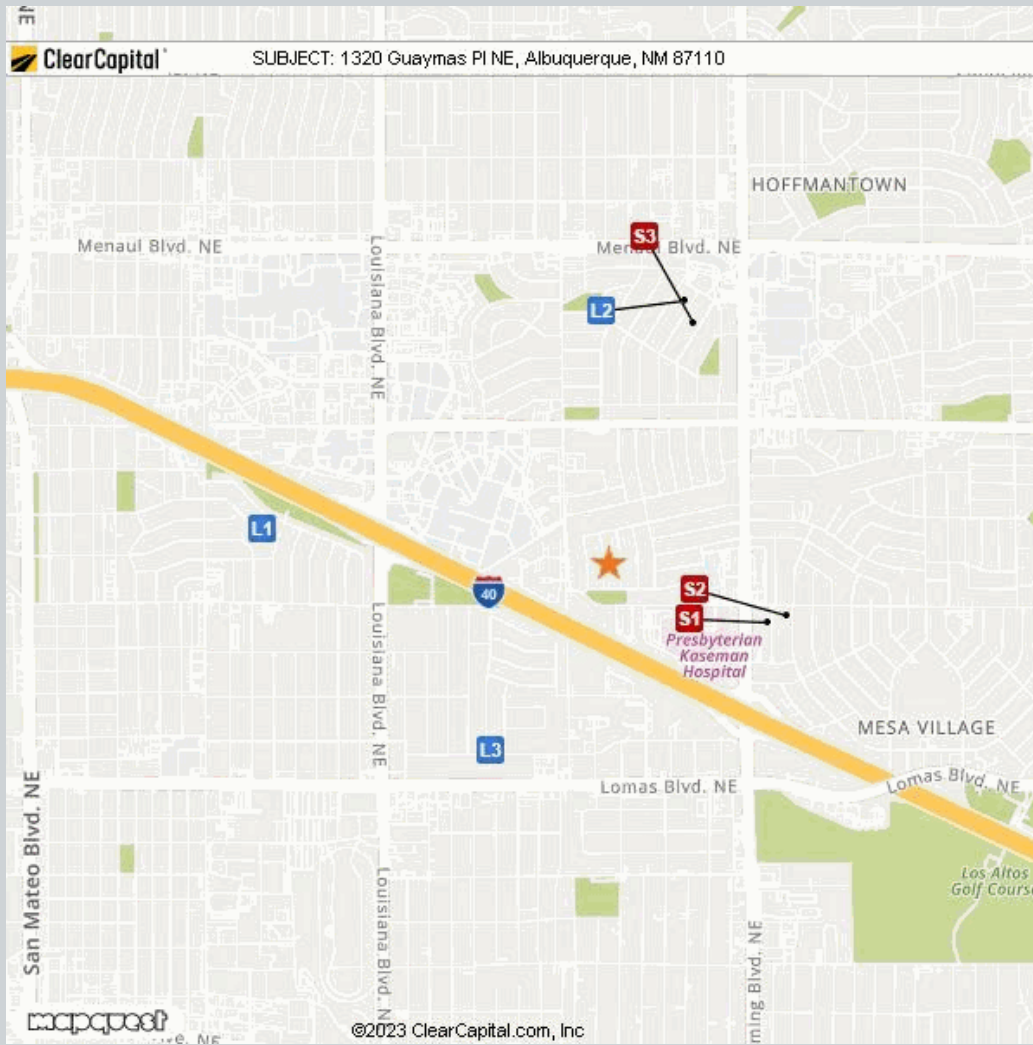

Comparable	Address	Miles to Subject	Mapping Accuracy
★ Subject	1320 Guaymas Place Ne, Albuquerque, NewMexico 87110	--	Parcel Match
L1 Listing 1	6225 Hannett Avenue Ne, Albuquerque, NM 87110	0.98 Miles ¹	Parcel Match
L2 Listing 2	2221 Utah Street Ne, Albuquerque, NM 87110	0.77 Miles ¹	Parcel Match
L3 Listing 3	900 San Pablo Street Ne, Albuquerque, NM 87110	0.62 Miles ¹	Parcel Match
S1 Sold 1	1337 Boatright Drive Ne, Albuquerque, NM 87110	0.47 Miles ¹	Parcel Match
S2 Sold 2	1345 Marron Circle Ne, Albuquerque, NM 87110	0.52 Miles ¹	Parcel Match
S3 Sold 3	2103 Vermont Street Ne, Albuquerque, NM 87110	0.71 Miles ¹	Parcel Match

¹ The Comparable "Distance from Subject" value has been calculated by the Clear Capital system.

² The Comparable "Distance from Subject" value has been provided by the Real Estate Professional.

Addendum: Report Purpose

Market Approach and Market Time

The Market Approach of this report, as established by the customer, is: **Fair Market Price**. (See definition below.)

The Marketing Time as specified by the customer is **Typical**. (See definition below.)

Definitions:

Fair Market Price	A price at which the property would sell between a willing buyer and a willing seller neither being compelled by undue pressure and both having reasonable knowledge of relevant facts.
Distressed Price	A price at which the property would sell between a willing buyer and a seller acting under duress.
Marketing Time	The amount of time the property is exposed to a pool of prospective buyers before going into contract. The customer either specifies the number of days, requests a marketing time that is typical to the subject's market area and/or requests an abbreviated marketing time.
Typical for Local Market	The estimated time required to adequately expose the subject property to the market resulting in a contract of sale.

Addendum: Report Purpose - cont.

Report Instructions

This section shows the instructions that were approved by the customer and provided to the broker prior to completing the report.

Instructions last updated: 7/17/2017

Purpose:

Please determine a fair market price for this property at which it would sell in a typical marketing time for the area.

Customer Specific Requests:

If the property is commercial or mixed use, please stop and contact Clear Capital as soon as possible

Form Help:

There are blue question marks (?) throughout this form. These are designed to offer guidance for that particular section of the form. Please click on them for help.

Comparable Requirements:

1. Please use fair market comps from the same neighborhood, block or subdivision whenever possible.
2. Please only use REO comparables if the market is driven by REOs and they are comparable in characteristics and condition.
3. Please use comps that have closed in the past 3 months to show the current market conditions or comment in the report if this is not possible. In rapidly changing markets, active listing comps should be given equal or greater weight than sold comps in your analysis.

Standard Instructions:

1. Clear Capital Code Of Conduct - Please make sure that you are always abiding by the Clear Capital Code of Conduct when completing valuation reports.
2. If the subject is currently listed, please consider all available information pertaining to the subject's condition. This information should be utilized when developing the assumption of the subject's condition.
3. Use the subject characteristics provided in the report Grid (if preloaded) to evaluate the property. This information is from a full interior appraisal and is assumed to be most accurate. If your inspection reveals obvious inaccuracies, please explain in the narrative of the report.
4. Include sufficient detail to help our mutual customer gain a complete understanding of the subject's neighborhood such as neighborhood desirability, amenities, parks, schools, commercial or industrial influences, REO activity, traffic, board-up-homes, etc.
5. Do not approach occupants or owners.
6. If the subject is a Commercial property, contact Clear Capital immediately at 530-582-5011 for direction on how to proceed with the report.
7. Please do not accept if you or your office has completed a report on this property in the last month, are currently listing this property, or have any vested interest in the subject property.
8. Clear Capital does not allow any log ins from IP addresses from foreign countries. This includes, but is not limited to; data entry services, form completion services, etc. Also, it is against Clear Capital code of conduct to share your password with anyone who is not a W2 employee in your office.
9. Clear Capital and our mutual customers greatly appreciate your expertise. If you cannot personally inspect the property, select comparables, and determine a price for the subject, please do not accept this report. Per the standards and guidelines adopted by Clear Capital and other industry leaders, the use of assistants to complete any of the aforementioned tasks is not permitted.

Report Instructions - cont.

Due to the importance of an independent opinion of price, please do not discuss your price with anyone or be influenced by list price, pending offers, accept comp packets, repair estimates or the listing agent's opinion.

1. One current, original photo of the front of the subject 2. One address verification photo 3. One street scene photo looking down the street 4. MLS listing and sold comp photos required, please comment if no MLS.

Broker Information

Broker Name	Billy Oney	Company/Brokerage	Realty One
License No	48871	Address	5123 Tecolote NW Albuquerque NM 87120
License Expiration	09/30/2024	License State	NM
Phone	5056881976	Email	billyjackrealty@gmail.com
Broker Distance to Subject	8.91 miles	Date Signed	06/23/2023

By confirming the above contact and real estate license information and submitting the report, the above signed hereby certifies and agrees that: 1) I personally took the pictures, selected comparables, and determined the price conclusion. 2) To the best of my knowledge, the statements of fact contained in this report are true and correct. 3) The reported analyses, opinions, and conclusions are my personal, impartial, and unbiased professional analyses, opinions, and conclusions. 4) I have no present or prospective interest in the property that is the subject of this report and no personal interest with respect to the parties involved. 5) I have no bias with respect to the property that is the subject of this report or to the parties involved with this assignment. 6) My compensation for completing this assignment is not contingent upon the development or reporting of a predetermined price point. 7) I did not base, either partially or completely, my analysis and/or opinion and conclusions in this report on race, color, religion, sex, age, marital status, handicap, familial status, or national origin of either the prospective owners or occupants of the subject property or of the present owners or occupants of the properties in the vicinity of the subject property or on any other basis prohibited by law. 8) I maintain errors and omissions insurance, to the extent required by state law, for all liability associated with the preparation of this Report.

Disclaimer

This document is not an appraisal as defined by USPAP (Uniform Standards of Professional Appraisal Practice). It is not to be construed as an appraisal and may not be used as such for any purpose.

Unless otherwise specifically agreed to in writing:

The intended purpose of this report is to assist the Clear Capital account holder in making decisions within the scope of applicable statutory and regulatory requirements and performing required due diligence. This document is provided solely for the use of the Clear Capital account holder and not any other party, is not intended as any guarantee of value and/or condition of the subject property and should not be relied on as such. In the event that this document is found to be defective, incorrect, negligently prepared or unfit for its authorized use, Clear Capital's sole liability shall be to promptly refund the total fee expended by the account holder for this report or to replace it at no charge to the account holder, but in no event shall Clear Capital be responsible to the account holder for any indirect or consequential damages whatsoever. This warranty is in lieu of all other warranties, express or implied, except where otherwise required by law. The account holder shall notify Clear Capital within thirty (30) days of this report's delivery to the account holder if it believes that this document is defective, incorrect, negligently prepared or unfit for its authorized use. Under no circumstances may Clear Capital forms or their contents be published, copied, replicated, or mimicked.