

Please Note: This report was completed with the following assumptions: Market Approach: **Fair Market Price** , Marketing Time: **Typical** . Important additional information relating to this report, including use and restrictions, is contained in an attached addendum which is an integral part of this report.

Address	17814 Placid Oak Court, Cypress, TX 77433	Order ID	8942353	Property ID	34632640
Inspection Date	09/26/2023	Date of Report	09/26/2023		
Loan Number	55250	APN	1231930010001		
Borrower Name	Breckenridge Property Fund 2016 LLC	County	Harris		

Tracking IDs

Order Tracking ID	09.25.23 BPO Request	Tracking ID 1	09.25.23 BPO Request
Tracking ID 2	--	Tracking ID 3	--

General Conditions

Owner	Frederik Cheney	Condition Comments	
R. E. Taxes	\$6,233	The subject is a two story 4-bedroom 3.5 bath traditional. It is in average condition and does not appear to need repairs.	
Assessed Value	\$309,569		
Zoning Classification	Residential		
Property Type	SFR		
Occupancy	Occupied		
Ownership Type	Fee Simple		
Property Condition	Average		
Estimated Exterior Repair Cost	\$0		
Estimated Interior Repair Cost	\$0		
Total Estimated Repair	\$0		
HOA	Crest Management 281-579-0761		
Association Fees	\$812 / Year (Pool)		
Visible From Street	Visible		
Road Type	Public		

Neighborhood & Market Data

Location Type	Suburban	Neighborhood Comments	
Local Economy	Stable	Lone Oak Village is a small neighborhood in Cypress. Prices have remained stable in the last 6 months. There was a lack of close by average condition comps.	
Sales Prices in this Neighborhood	Low: \$265,000 High: \$500,000		
Market for this type of property	Remained Stable for the past 6 months.		
Normal Marketing Days	<90		

Current Listings

	Subject	Listing 1	Listing 2 *	Listing 3
Street Address	17814 Placid Oak Court	18002 Shallow Leaf Lane	7619 Lone Meadow Court	8319 Bending Branch Lane
City, State	Cypress, TX	Cypress, TX	Houston, TX	Cypress, TX
Zip Code	77433	77433	77095	77433
Datasource	Tax Records	MLS	MLS	MLS
Miles to Subj.	--	0.42 ¹	0.82 ¹	0.05 ¹
Property Type	SFR	SFR	SFR	SFR
Original List Price \$	\$	\$338,000	\$375,000	\$399,000
List Price \$	--	\$319,000	\$345,000	\$399,000
Original List Date		08/18/2023	08/24/2023	08/19/2023
DOM · Cumulative DOM	-- · --	39 · 39	33 · 33	7 · 38
Age (# of years)	18	17	28	20
Condition	Average	Average	Good	Average
Sales Type	--	Fair Market Value	Fair Market Value	Fair Market Value
Location	Neutral ; Residential	Neutral ; Residential	Neutral ; Residential	Neutral ; Residential
View	Neutral ; Residential	Neutral ; Residential	Neutral ; Residential	Neutral ; Residential
Style/Design	2 Stories Traditional	2 Stories Traditional	2 Stories Traditional	2 Stories Traditional
# Units	1	1	1	1
Living Sq. Feet	2,960	2,571	2,930	3,276
Bdrm · Bths · ½ Bths	4 · 3 · 1	4 · 2 · 1	5 · 2 · 1	5 · 3 · 1
Total Room #	9	7	8	10
Garage (Style/Stalls)	Attached 2 Car(s)	Attached 2 Car(s)	Attached 2 Car(s)	Attached 2 Car(s)
Basement (Yes/No)	No	No	No	No
Basement (% Fin)	0%	0%	0%	0%
Basement Sq. Ft.	--	--	--	--
Pool/Spa	--	--	--	--
Lot Size	0.24 acres	0.15 acres	0.15 acres	0.2 acres
Other	None	MLS#48194921	MLS#25980408	MLS#38422616

* Listing 2 is the most comparable listing to the subject.

¹ Comp's "Miles to Subject" was calculated by the system.

² Comp's "Miles to Subject" provided by Real Estate Professional.

³ Subject \$/ft based upon as-is sale price.

Listing Comments Why the comparable listing is superior or inferior to the subject.

Listing 1 Living room, game room, large kitchen. No other agent comments in MLS. This property is inferior to the subject in size.

Listing 2 Many upgrades. Carpet, tile and laminate floors, granite counters, stainless appliances. Remodeled bath, granite counters, new tile, dining room, game room. This property is equal to the subject in size.

Listing 3 Carpet, tile and laminate floors, island kitchen, stainless appliances, new A/C, large lot. This property is superior to the subject in size.

Recent Sales

	Subject	Sold 1	Sold 2 *	Sold 3
Street Address	17814 Placid Oak Court	18018 Timber Crossing Lane	8607 Secret Branch	17814 Oak Park Bend Lane
City, State	Cypress, TX	Cypress, TX	Houston, TX	Cypress, TX
Zip Code	77433	77433	77095	77433
Datasource	Tax Records	MLS	MLS	MLS
Miles to Subj.	--	0.20 ¹	0.17 ¹	0.16 ¹
Property Type	SFR	SFR	SFR	SFR
Original List Price \$	--	\$280,000	\$385,000	\$430,000
List Price \$	--	\$285,000	\$354,999	\$415,000
Sale Price \$	--	\$285,000	\$350,000	\$407,500
Type of Financing	--	Unknown	Unknown	Unknown
Date of Sale	--	07/18/2023	09/18/2023	08/28/2023
DOM · Cumulative DOM	-- · --	9 · 47	41 · 207	39 · 73
Age (# of years)	18	18	19	20
Condition	Average	Average	Good	Good
Sales Type	--	Fair Market Value	Fair Market Value	Fair Market Value
Location	Neutral ; Residential	Neutral ; Residential	Neutral ; Residential	Neutral ; Residential
View	Neutral ; Residential	Neutral ; Residential	Neutral ; Residential	Neutral ; Residential
Style/Design	2 Stories Traditional	2 Stories Traditional	2 Stories Traditional	2 Stories Traditional
# Units	1	1	1	1
Living Sq. Feet	2,960	2,505	2,685	3,228
Bdrm · Bths · ½ Bths	4 · 3 · 1	4 · 2 · 1	4 · 2 · 1	4 · 3 · 1
Total Room #	9	8	10	10
Garage (Style/Stalls)	Attached 2 Car(s)	Attached 2 Car(s)	Attached 2 Car(s)	Detached 1 Car
Basement (Yes/No)	No	No	No	No
Basement (% Fin)	0%	0%	0%	0%
Basement Sq. Ft.	--	--	--	--
Pool/Spa	--	--	--	--
Lot Size	0.24 acres	0.21 acres	0.28 acres	0.25 acres
Other	None	MLS#75171005	MLS#96535705	MLS#87777347
Net Adjustment	--	+\$23,250	+\$5,750	-\$20,900
Adjusted Price	--	\$308,250	\$355,750	\$386,600

* Sold 2 is the most comparable sale to the subject.

¹ Comp's "Miles to Subject" was calculated by the system.

² Comp's "Miles to Subject" provided by Real Estate Professional.

³ Subject \$/ft based upon as-is sale price.

Recent Sales - Cont.

Reasons for Adjustments Why the comparable sale is superior or inferior to the subject.

- Sold 1** Carpet and tile floors, granite counters, island kitchen, formal dining room, den, alarm. This property is inferior to the subject in size. Adjustments GLA +22750, bath +2000, seller concession -1500
- Sold 2** Many upgrades. Carpet, tile and wood floors, quartz counters, breakfast bar, sprinkler system. This property is equal to the subject in size. Adjustments GLA +13750, bath +2000, condition -10000
- Sold 3** New carpet, new tile floors, updated bath, breakfast room, formal dining room, office. This property is superior to the subject in size. Adjustments GLA -13400, condition -10000, garage +2500

Subject Sales & Listing History

Current Listing Status	Not Currently Listed		Listing History Comments				
Listing Agency/Firm			The subject just sold on 9/22/2023. It sold under market.				
Listing Agent Name							
Listing Agent Phone							
# of Removed Listings in Previous 12 Months	1						
# of Sales in Previous 12 Months	1						
Original List Date	Original List Price	Final List Date	Final List Price	Result	Result Date	Result Price	Source
06/26/2023	\$390,000	09/12/2023	\$350,000	Withdrawn	09/11/2023	\$350,000	MLS
09/12/2023	\$350,000	--	--	Sold	09/22/2023	\$310,000	MLS

Marketing Strategy

	As Is Price	Repaired Price
Suggested List Price	\$363,000	\$363,000
Sales Price	\$356,000	\$356,000
30 Day Price	\$338,000	--
Comments Regarding Pricing Strategy		
The final price is weighted to sold comp 2 which is similar in size and proximity. The recent sale of the subject was under market. It sold for 104.73 S/F. The average selling price per S/F for the last 6 months in the neighborhood was 135.68 S/F.		

Clear Capital Quality Assurance Comments Addendum

Reviewer's Notes The broker's as-is conclusion reflects the market for the subject. Comps are within a reasonable distance, relatively current, and accurately reflect the subject's defining characteristics. Thus, the as-is conclusion appears to be adequately supported.

Subject Photos



Front



Address Verification



Side



Street



Other

Listing Photos

L1 18002 Shallow Leaf Lane
Cypress, TX 77433



Front

L2 7619 Lone Meadow Court
Houston, TX 77095



Front

L3 8319 Bending Branch Lane
Cypress, TX 77433



Front

Sales Photos

S1 18018 Timber Crossing Lane
Cypress, TX 77433



Front

S2 8607 Secret Branch
Houston, TX 77095



Front

S3 17814 Oak Park Bend Lane
Cypress, TX 77433



Front

ClearMaps Addendum

Address ★ 17814 Placid Oak Court, Cypress, TX 77433

Loan Number 55250

Suggested List \$363,000

Suggested Repaired \$363,000

Sale \$356,000

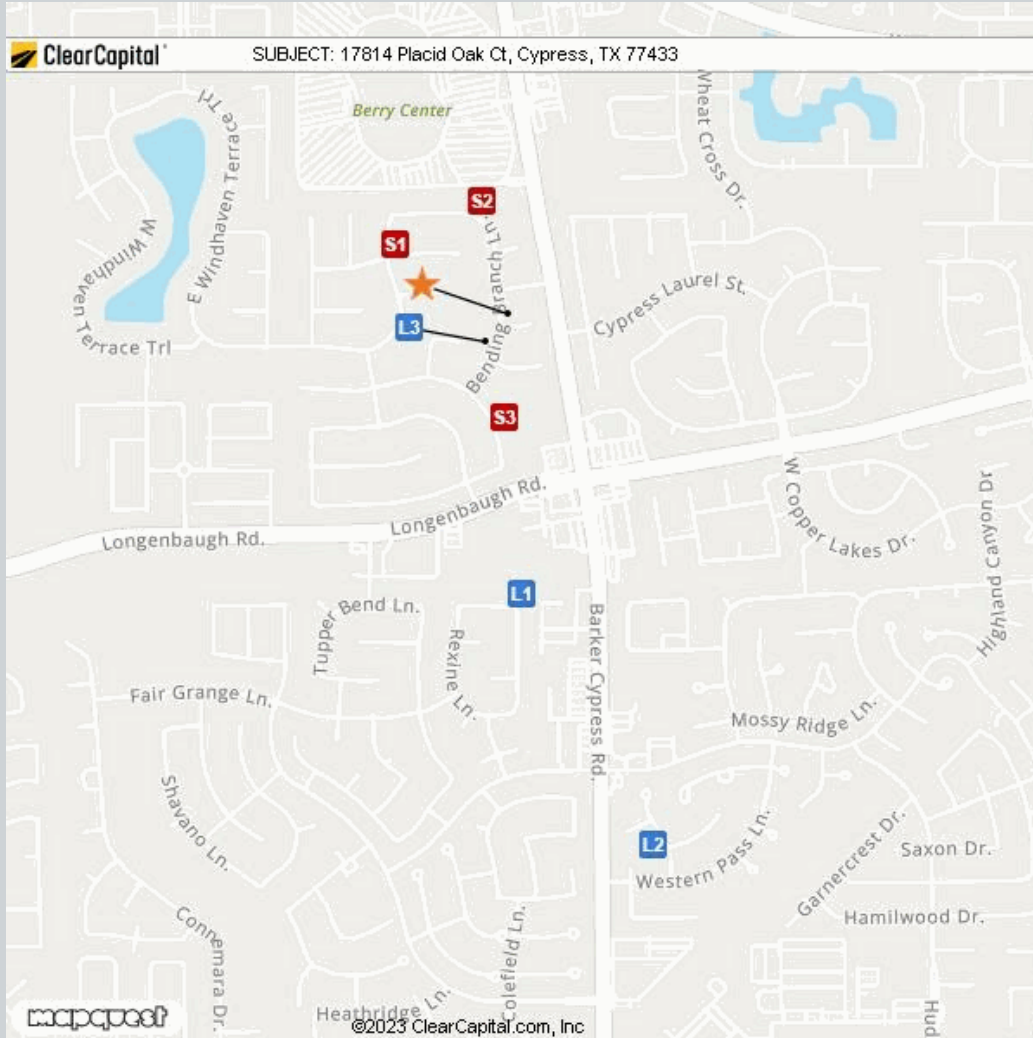

Comparable	Address	Miles to Subject	Mapping Accuracy
★ Subject	17814 Placid Oak Court, Cypress, TX 77433	--	Parcel Match
L1 Listing 1	18002 Shallow Leaf Lane, Cypress, TX 77433	0.42 Miles ¹	Parcel Match
L2 Listing 2	7619 Lone Meadow Court, Houston, TX 77095	0.82 Miles ¹	Parcel Match
L3 Listing 3	8319 Bending Branch Lane, Cypress, TX 77433	0.05 Miles ¹	Parcel Match
S1 Sold 1	18018 Timber Crossing Lane, Cypress, TX 77433	0.20 Miles ¹	Parcel Match
S2 Sold 2	8607 Secret Branch, Houston, TX 77095	0.17 Miles ¹	Parcel Match
S3 Sold 3	17814 Oak Park Bend Lane, Cypress, TX 77433	0.16 Miles ¹	Parcel Match

¹ The Comparable "Distance from Subject" value has been calculated by the Clear Capital system.

² The Comparable "Distance from Subject" value has been provided by the Real Estate Professional.

Addendum: Report Purpose

Market Approach and Market Time

The Market Approach of this report, as established by the customer, is: **Fair Market Price**. (See definition below.)

The Marketing Time as specified by the customer is **Typical**. (See definition below.)

Definitions:

Fair Market Price

A price at which the property would sell between a willing buyer and a willing seller neither being compelled by undue pressure and both having reasonable knowledge of relevant facts.

Distressed Price

A price at which the property would sell between a willing buyer and a seller acting under duress.

Marketing Time

The amount of time the property is exposed to a pool of prospective buyers before going into contract. The customer either specifies the number of days, requests a marketing time that is typical to the subject's market area and/or requests an abbreviated marketing time.

Typical for Local Market

The estimated time required to adequately expose the subject property to the market resulting in a contract of sale.

Addendum: Report Purpose - cont.

Report Instructions

This section shows the instructions that were approved by the customer and provided to the broker prior to completing the report.

Instructions last updated: 7/17/2017

Purpose:

Please determine a fair market price for this property at which it would sell in a typical marketing time for the area.

Customer Specific Requests:

If the property is commercial or mixed use, please stop and contact Clear Capital as soon as possible

Form Help:

There are blue question marks (?) throughout this form. These are designed to offer guidance for that particular section of the form. Please click on them for help.

Comparable Requirements:

1. Please use fair market comps from the same neighborhood, block or subdivision whenever possible.
2. Please only use REO comparables if the market is driven by REOs and they are comparable in characteristics and condition.
3. Please use comps that have closed in the past 3 months to show the current market conditions or comment in the report if this is not possible. In rapidly changing markets, active listing comps should be given equal or greater weight than sold comps in your analysis.

Standard Instructions:

1. Clear Capital Code Of Conduct - Please make sure that you are always abiding by the Clear Capital Code of Conduct when completing valuation reports.
2. If the subject is currently listed, please consider all available information pertaining to the subject's condition. This information should be utilized when developing the assumption of the subject's condition.
3. Use the subject characteristics provided in the report Grid (if preloaded) to evaluate the property. This information is from a full interior appraisal and is assumed to be most accurate. If your inspection reveals obvious inaccuracies, please explain in the narrative of the report.
4. Include sufficient detail to help our mutual customer gain a complete understanding of the subject's neighborhood such as neighborhood desirability, amenities, parks, schools, commercial or industrial influences, REO activity, traffic, board-up-homes, etc.
5. Do not approach occupants or owners.
6. If the subject is a Commercial property, contact Clear Capital immediately at 530-582-5011 for direction on how to proceed with the report.
7. Please do not accept if you or your office has completed a report on this property in the last month, are currently listing this property, or have any vested interest in the subject property.
8. Clear Capital does not allow any log ins from IP addresses from foreign countries. This includes, but is not limited to; data entry services, form completion services, etc. Also, it is against Clear Capital code of conduct to share your password with anyone who is not a W2 employee in your office.
9. Clear Capital and our mutual customers greatly appreciate your expertise. If you cannot personally inspect the property, select comparables, and determine a price for the subject, please do not accept this report. Per the standards and guidelines adopted by Clear Capital and other industry leaders, the use of assistants to complete any of the aforementioned tasks is not permitted.

Report Instructions - cont.

Due to the importance of an independent opinion of price, please do not discuss your price with anyone or be influenced by list price, pending offers, accept comp packets, repair estimates or the listing agent's opinion.

1. One current, original photo of the front of the subject 2. One address verification photo 3. One street scene photo looking down the street 4. MLS listing and sold comp photos required, please comment if no MLS.

Broker Information

Broker Name	Rhonda Reedy	Company/Brokerage	Realm Realtors
License No	441898	Address	1515 Valley Landing Dr. Katy TX 77450
License Expiration	07/31/2024	License State	TX
Phone	2813525442	Email	reedybpo@gmail.com
Broker Distance to Subject	10.50 miles	Date Signed	09/26/2023

By confirming the above contact and real estate license information and submitting the report, the above signed hereby certifies and agrees that: 1) I personally took the pictures, selected comparables, and determined the price conclusion. 2) To the best of my knowledge, the statements of fact contained in this report are true and correct. 3) The reported analyses, opinions, and conclusions are my personal, impartial, and unbiased professional analyses, opinions, and conclusions. 4) I have no present or prospective interest in the property that is the subject of this report and no personal interest with respect to the parties involved. 5) I have no bias with respect to the property that is the subject of this report or to the parties involved with this assignment. 6) My compensation for completing this assignment is not contingent upon the development or reporting of a predetermined price point. 7) I did not base, either partially or completely, my analysis and/or opinion and conclusions in this report on race, color, religion, sex, age, marital status, handicap, familial status, or national origin of either the prospective owners or occupants of the subject property or of the present owners or occupants of the properties in the vicinity of the subject property or on any other basis prohibited by law. 8) I maintain errors and omissions insurance, to the extent required by state law, for all liability associated with the preparation of this Report.

Disclaimer

THIS REPORT SHOULD NOT BE CONSIDERED AN APPRAISAL. In making any decision that relies upon my work, you should know that I have not followed the guidelines for development of an appraisal or analysis contained in the Uniform Standards of Professional Appraisal Practice of the Appraisal Foundation.

Unless otherwise specifically agreed to in writing:

The intended purpose of this report is to assist the Clear Capital account holder in making decisions within the scope of applicable statutory and regulatory requirements and performing required due diligence. This document is provided solely for the use of the Clear Capital account holder and not any other party, is not intended as any guarantee of value and/or condition of the subject property and should not be relied on as such. In the event that this document is found to be defective, incorrect, negligently prepared or unfit for its authorized use, Clear Capital's sole liability shall be to promptly refund the total fee expended by the account holder for this report or to replace it at no charge to the account holder, but in no event shall Clear Capital be responsible to the account holder for any indirect or consequential damages whatsoever. This warranty is in lieu of all other warranties, express or implied, except where otherwise required by law. The account holder shall notify Clear Capital within thirty (30) days of this report's delivery to the account holder if it believes that this document is defective, incorrect, negligently prepared or unfit for its authorized use. Under no circumstances may Clear Capital forms or their contents be published, copied, replicated, or mimicked.