

Please Note: This report was completed with the following assumptions: Market Approach: **Fair Market Price** , Marketing Time: **Typical** . Important additional information relating to this report, including use and restrictions, is contained in an attached addendum which is an integral part of this report.

<b>Address</b>	11062 Willow Lane, Adelanto, CALIFORNIA 92301	<b>Order ID</b>	9002498	<b>Property ID</b>	34762972
<b>Inspection Date</b>	11/01/2023	<b>Date of Report</b>	11/01/2023		
<b>Loan Number</b>	55312	<b>APN</b>	3132-281-14-0000		
<b>Borrower Name</b>	Catamount Properties 2018 LLC	<b>County</b>	San Bernardino		

<b>Tracking IDs</b>					
<b>Order Tracking ID</b>	10.31_BPO	<b>Tracking ID 1</b>	10.31_BPO		
<b>Tracking ID 2</b>	--	<b>Tracking ID 3</b>	--		

General Conditions		Condition Comments
<b>Owner</b>	Haynie, William	Subject property is mid sized, single story plan in one of the older tracts located in very large market area. Is vacant. Workmen on site trashing out property at time of inspection. Yard areas are very overgrown, weedy. Would recommend basic yard maintenance to enhance exterior appearance. All wood trim areas, fascia boards need paint with bare wood showing in most areas. No other repair issues noted at time of inspection. Fenced back yard, rockscaped front yard with shrubs. Tile roof, small porch at entry. Aerial view appears to show rear covered patio.
<b>R. E. Taxes</b>	\$2,278	
<b>Assessed Value</b>	\$174,018	
<b>Zoning Classification</b>	R1-one SFR per lot	
<b>Property Type</b>	SFR	
<b>Occupancy</b>	Vacant	
<b>Secure?</b>	Yes	
	(workmen on site trashing out property at time of inspection. Doors/windows appear intact)	
<b>Ownership Type</b>	Fee Simple	
<b>Property Condition</b>	Average	
<b>Estimated Exterior Repair Cost</b>	\$3,000	
<b>Estimated Interior Repair Cost</b>	\$0	
<b>Total Estimated Repair</b>	\$3,000	
<b>HOA</b>	No	
<b>Visible From Street</b>	Visible	
<b>Road Type</b>	Public	

Neighborhood & Market Data		Neighborhood Comments
<b>Location Type</b>	Suburban	One of the oldest tracts located in central part of very large market area that covers several square miles & which is made up of dozens of different tracts. The oldest tracts date to the late 80's, the newest were built in the last couple of years & there is some limited ongoing development being done in the area by several large national tract builders. There are also still sections of undeveloped land through out the area. For these reasons it is often necessary to expand search to find comps. This is considered to be a good commuter area with 2 major commuting routes within 1 mile. Several...
<b>Local Economy</b>	Stable	
<b>Sales Prices in this Neighborhood</b>	Low: \$199,000 High: \$465,000	
<b>Market for this type of property</b>	Remained Stable for the past 6 months.	
<b>Normal Marketing Days</b>	<90	

## Neighborhood Comments

One of the oldest tracts located in central part of very large market area that covers several square miles & which is made up of dozens of different tracts. The oldest tracts date to the late 80's, the newest were built in the last couple of years & there is some limited ongoing development being done in the area by several large national tract builders. There are also still sections of undeveloped land through out the area. For these reasons it is often necessary to expand search to find comps. This is considered to be a good commuter area with 2 major commuting routes within 1 mile. Several schools are within a 2 mile radius. Moderate sized newer shopping areas within 1.5 miles. Large regional shopping center is about 7 miles away.

### Current Listings

	Subject	Listing 1	Listing 2	Listing 3 *
Street Address	11062 Willow Lane	14562 Palo Verde Ct.	14554 Monterey Pl.	14830 Nottingham Ct.
City, State	Adelanto, CALIFORNIA	Adelanto, CA	Adelanto, CA	Adelanto, CA
Zip Code	92301	92301	92301	92301
Datasource	Tax Records	MLS	MLS	MLS
Miles to Subj.	--	0.16 <sup>1</sup>	0.45 <sup>1</sup>	0.32 <sup>1</sup>
Property Type	SFR	SFR	SFR	SFR
Original List Price \$	\$	\$384,900	\$377,000	\$340,000
List Price \$	--	\$384,900	\$377,000	\$340,000
Original List Date		09/07/2023	10/20/2023	09/28/2023
DOM · Cumulative DOM	-- · --	55 · 55	12 · 12	34 · 34
Age (# of years)	32	32	27	30
Condition	Average	Average	Average	Average
Sales Type	--	Fair Market Value	Fair Market Value	Fair Market Value
Location	Neutral ; Residential	Neutral ; Residential	Neutral ; Residential	Neutral ; Residential
View	Neutral ; Residential	Neutral ; Residential	Neutral ; Residential	Neutral ; Residential
Style/Design	1 Story ranch	1 Story ranch	1 Story ranch	1 Story ranch
# Units	1	1	1	1
Living Sq. Feet	1,671	1,516	1,645	1,671
Bdrm · Bths · ½ Bths	4 · 2	3 · 2	4 · 2	4 · 2
Total Room #	7	6	7	7
Garage (Style/Stalls)	Attached 2 Car(s)	Attached 3 Car(s)	Attached 3 Car(s)	Attached 2 Car(s)
Basement (Yes/No)	No	No	No	No
Basement (% Fin)	0%	0%	0%	0%
Basement Sq. Ft.	--	--	--	--
Pool/Spa	--	--	--	--
Lot Size	.17 acres	.28 acres	.16 acres	.18 acres
Other	fence, tile roof, porch	fence, tile roof, porch	fence, tile roof, porch	fence, tile roof, porch

\* Listing 3 is the most comparable listing to the subject.

<sup>1</sup> Comp's "Miles to Subject" was calculated by the system.

<sup>2</sup> Comp's "Miles to Subject" provided by Real Estate Professional.

<sup>3</sup> Subject \$/ft based upon as-is sale price.

**Listing Comments** Why the comparable listing is superior or inferior to the subject.

**Listing 1** Regular resale in same tract. Smaller plan with one fewer BR. Similar age, exterior style, features. Larger garage. Larger lot-still typical for the area, adjusted at about \$5000 per acre. Cul-de-sac location. Fenced back yard, rockscaped front yard, some trees, shrubs. Tile roof, small porch at entry. Rear covered patio with extended concrete.

**Listing 2** Regular resale. Different/similar slightly newer tract in same market area. Within 5 years of subject age, no adjustment. Slightly smaller SF, similar exterior style, features, room count, lot size, garage. Fenced back yard, rockscaped yard areas, trees, shrubs. Tile roof, front porch.

**Listing 3** Regular resale. Same home/tract, slightly newer section of same tract. Similar yard condition as subject. Fenced back yard, some trees, shrubs. Tile roof, front porch.

### Recent Sales

	Subject	Sold 1 *	Sold 2	Sold 3
<b>Street Address</b>	11062 Willow Lane	11194 Desert Rose Dr.	11325 Dartmouth Ct.	11739 Cornell St.
<b>City, State</b>	Adelanto, CALIFORNIA	Adelanto, CA	Adelanto, CA	Adelanto, CA
<b>Zip Code</b>	92301	92301	92301	92301
<b>Datasource</b>	Tax Records	MLS	MLS	MLS
<b>Miles to Subj.</b>	--	0.19 <sup>1</sup>	0.38 <sup>1</sup>	0.90 <sup>1</sup>
<b>Property Type</b>	SFR	SFR	SFR	SFR
<b>Original List Price \$</b>	--	\$365,000	\$369,900	\$345,000
<b>List Price \$</b>	--	\$365,000	\$369,900	\$340,000
<b>Sale Price \$</b>	--	\$385,000	\$375,000	\$340,000
<b>Type of Financing</b>	--	Fha	Conventional	Va
<b>Date of Sale</b>	--	07/18/2023	09/07/2023	08/28/2023
<b>DOM · Cumulative DOM</b>	-- · --	5 · 91	2 · 28	32 · 60
<b>Age (# of years)</b>	32	32	31	30
<b>Condition</b>	Average	Good	Average	Average
<b>Sales Type</b>	--	Fair Market Value	Fair Market Value	Fair Market Value
<b>Location</b>	Neutral ; Residential	Neutral ; Residential	Neutral ; Residential	Neutral ; Residential
<b>View</b>	Neutral ; Residential	Neutral ; Residential	Neutral ; Residential	Neutral ; Residential
<b>Style/Design</b>	1 Story ranch	1 Story ranch	1 Story ranch	1 Story ranch
<b># Units</b>	1	1	1	1
<b>Living Sq. Feet</b>	1,671	1,671	1,518	1,518
<b>Bdrm · Bths · ½ Bths</b>	4 · 2	4 · 2	4 · 2	4 · 2
<b>Total Room #</b>	7	7	7	7
<b>Garage (Style/Stalls)</b>	Attached 2 Car(s)	Attached 3 Car(s)	Attached 2 Car(s)	Attached 2 Car(s)
<b>Basement (Yes/No)</b>	No	No	No	No
<b>Basement (% Fin)</b>	0%	0%	0%	0%
<b>Basement Sq. Ft.</b>	--	--	--	--
<b>Pool/Spa</b>	--	--	--	--
<b>Lot Size</b>	.17 acres	.17 acres	.28 acres	.19 acres
<b>Other</b>	fence, tile roof, porch	fence, tile roof, porch	fence, tile roof, porch	fence, tile roof, porch
<b>Net Adjustment</b>	--	-\$10,500	-\$7,725	+\$3,825
<b>Adjusted Price</b>	--	\$374,500	\$367,275	\$343,825

\* Sold 1 is the most comparable sale to the subject.

<sup>1</sup> Comp's "Miles to Subject" was calculated by the system.

<sup>2</sup> Comp's "Miles to Subject" provided by Real Estate Professional.

<sup>3</sup> Subject \$/ft based upon as-is sale price.

## Recent Sales - Cont.

**Reasons for Adjustments** Why the comparable sale is superior or inferior to the subject.

- Sold 1** Regular resale. Same home/tract. Larger garage. Otherwise same plan, SF, room count, lot size. Fenced back yard, rockscaped yard areas. Tile roof, front porch. Rear covered patio. Interior rehabbed with new paint, flooring, fixtures, updated kitchen & bath features. Adjusted for rehabbed condition (-\$7500), larger garage (-\$3000). Multiple offers drove SP higher than LP with no concessions paid.
- Sold 2** Regular resale. Different/similar tract, same market area, built during same time frame. Smaller SF. Similar age, exterior style, features, room count, garage. Larger lot-still typical for the area. Fenced back yard, rockscaped yard areas, some shrubs. Tile roof, front porch. Interior rehabbed with new paint, flooring, fixtures, updated kitchen & bath features. Adjusted for rehabbed condition (-\$7500), concessions paid (-\$3500), larger lot (-\$550) & offset by smaller SF (+\$3825).
- Sold 3** Regular resale. Different/similar tract, same market area, built during same time frame. Smaller SF. Similar age, exterior style, features, room count, lot size, garage. Fenced back yard, some trees, shrubs, no other landscaping but yard areas are cleared & weed free. Tile roof, front porch. Some interior features updated but not a current remodel. Adjusted only for smaller SF (+\$3825).

## Subject Sales & Listing History

<b>Current Listing Status</b>	Not Currently Listed			<b>Listing History Comments</b>			
<b>Listing Agency/Firm</b>				n/a			
<b>Listing Agent Name</b>							
<b>Listing Agent Phone</b>							
<b># of Removed Listings in Previous 12 Months</b>	0						
<b># of Sales in Previous 12 Months</b>	0						
<b>Original List Date</b>	<b>Original List Price</b>	<b>Final List Date</b>	<b>Final List Price</b>	<b>Result</b>	<b>Result Date</b>	<b>Result Price</b>	<b>Source</b>

## Marketing Strategy

	<b>As Is Price</b>	<b>Repaired Price</b>
<b>Suggested List Price</b>	\$369,000	\$372,000
<b>Sales Price</b>	\$365,000	\$368,000
<b>30 Day Price</b>	\$349,000	--
<b>Comments Regarding Pricing Strategy</b>		
<p>Search was expanded to include the most proximate similar aged tracts in order to find best comps &amp; to try &amp; bracket subject features. Every effort made to find/use comps with as close proximity as possible. In this case search was expanded up to 1 mile, although most of the comps are within 1/2 mile. Most of the comps are from same tract as subject. The market is still strong in this area, on properties in this value range. However the market has started to transition &amp; inventory is increasing-note that the active listings have longer DOM than the closed sales. Many listings are seeing price reductions, some substantial. Many sales do involve seller paid concessions, usually for interest rate buy down. Rehabbed properties are still selling at the top of the market.</p>		

## Clear Capital Quality Assurance Comments Addendum

**Reviewer's Notes** The broker's as-is conclusion reflects the market for the subject. Comps are within a reasonable distance, relatively current, and accurately reflect the subject's defining characteristics. Thus, the as-is conclusion appears to be adequately supported.

### Subject Photos



Front



Address Verification



Side



Side



Street



Street



## Subject Photos



Other



Other

## Listing Photos

**L1** 14562 Palo Verde Ct.  
Adelanto, CA 92301



Front

**L2** 14554 Monterey Pl.  
Adelanto, CA 92301



Front

**L3** 14830 Nottingham Ct.  
Adelanto, CA 92301



Front

## Sales Photos

**S1** 11194 Desert Rose Dr.  
Adelanto, CA 92301



Front

**S2** 11325 Dartmouth Ct.  
Adelanto, CA 92301



Front

**S3** 11739 Cornell St.  
Adelanto, CA 92301



Front

## ClearMaps Addendum

**Address** ★ 11062 Willow Lane, Adelanto, CALIFORNIA 92301

**Loan Number** 55312

**Suggested List** \$369,000

**Suggested Repaired** \$372,000

**Sale** \$365,000

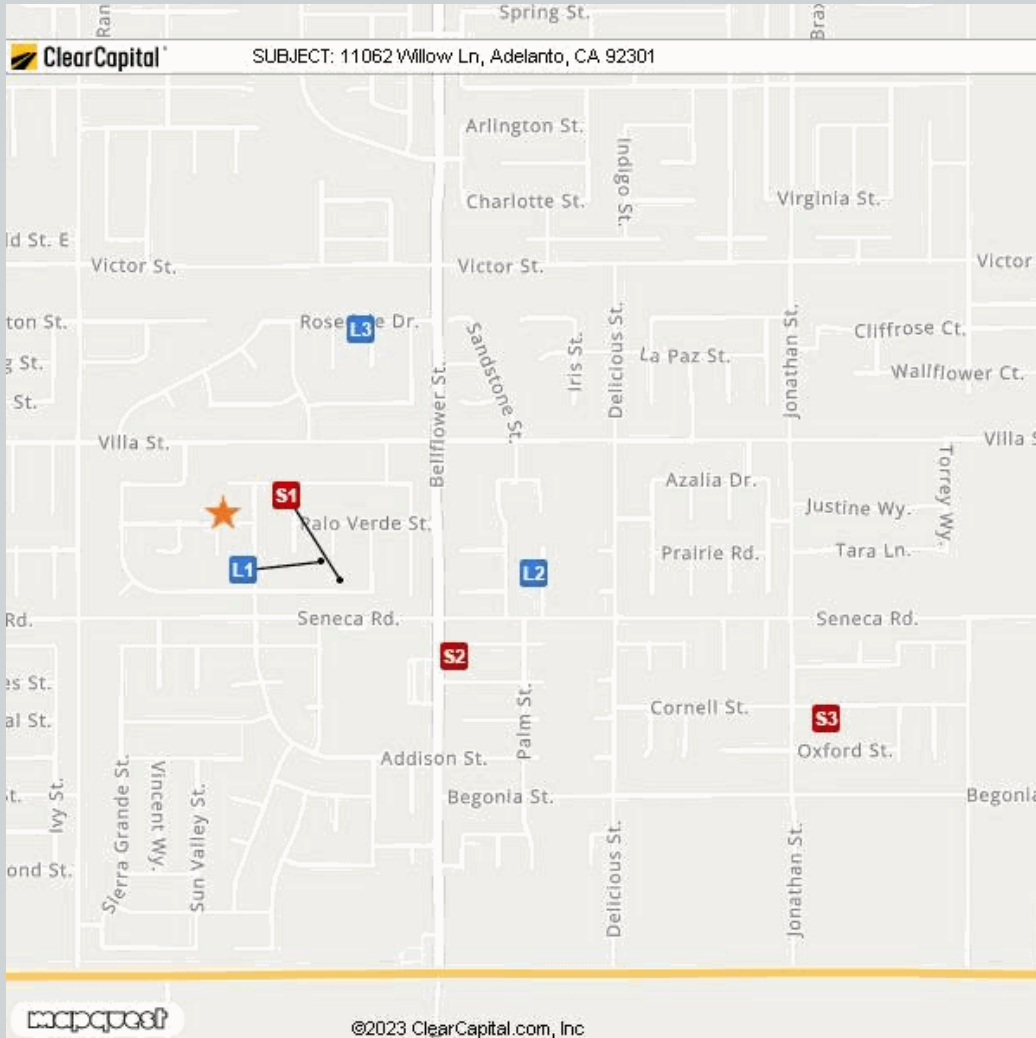

Comparable	Address	Miles to Subject	Mapping Accuracy
★ Subject	11062 Willow Lane, Adelanto, California 92301	--	Parcel Match
L1 Listing 1	14562 Palo Verde Ct., Adelanto, CA 92301	0.16 Miles <sup>1</sup>	Parcel Match
L2 Listing 2	14554 Monterey Pl., Adelanto, CA 92301	0.45 Miles <sup>1</sup>	Parcel Match
L3 Listing 3	14830 Nottingham Ct., Adelanto, CA 92301	0.32 Miles <sup>1</sup>	Parcel Match
S1 Sold 1	11194 Desert Rose Dr., Adelanto, CA 92301	0.19 Miles <sup>1</sup>	Parcel Match
S2 Sold 2	11325 Dartmouth Ct., Adelanto, CA 92301	0.38 Miles <sup>1</sup>	Parcel Match
S3 Sold 3	11739 Cornell St., Adelanto, CA 92301	0.90 Miles <sup>1</sup>	Parcel Match

<sup>1</sup> The Comparable "Distance from Subject" value has been calculated by the Clear Capital system.

<sup>2</sup> The Comparable "Distance from Subject" value has been provided by the Real Estate Professional.

## Addendum: Report Purpose

### Market Approach and Market Time

The Market Approach of this report, as established by the customer, is: **Fair Market Price**. (See definition below.)

The Marketing Time as specified by the customer is **Typical**. (See definition below.)

Definitions:

Fair Market Price

A price at which the property would sell between a willing buyer and a willing seller neither being compelled by undue pressure and both having reasonable knowledge of relevant facts.

Distressed Price

A price at which the property would sell between a willing buyer and a seller acting under duress.

Marketing Time

The amount of time the property is exposed to a pool of prospective buyers before going into contract. The customer either specifies the number of days, requests a marketing time that is typical to the subject's market area and/or requests an abbreviated marketing time.

Typical for Local Market

The estimated time required to adequately expose the subject property to the market resulting in a contract of sale.

## Addendum: Report Purpose - cont.

**Report Instructions**

This section shows the instructions that were approved by the customer and provided to the broker prior to completing the report.

Instructions last updated: 7/17/2017

Purpose:

Please determine a fair market price for this property at which it would sell in a typical marketing time for the area.

Customer Specific Requests:

\*\*If the property is commercial or mixed use, please stop and contact Clear Capital as soon as possible\*\*

Form Help:

There are blue question marks (?) throughout this form. These are designed to offer guidance for that particular section of the form. Please click on them for help.

Comparable Requirements:

1. Please use fair market comps from the same neighborhood, block or subdivision whenever possible.
2. Please only use REO comparables if the market is driven by REOs and they are comparable in characteristics and condition.
3. Please use comps that have closed in the past 3 months to show the current market conditions or comment in the report if this is not possible. In rapidly changing markets, active listing comps should be given equal or greater weight than sold comps in your analysis.

Standard Instructions:

1. Clear Capital Code Of Conduct - Please make sure that you are always abiding by the Clear Capital Code of Conduct when completing valuation reports.
2. If the subject is currently listed, please consider all available information pertaining to the subject's condition. This information should be utilized when developing the assumption of the subject's condition.
3. Use the subject characteristics provided in the report Grid (if preloaded) to evaluate the property. This information is from a full interior appraisal and is assumed to be most accurate. If your inspection reveals obvious inaccuracies, please explain in the narrative of the report.
4. Include sufficient detail to help our mutual customer gain a complete understanding of the subject's neighborhood such as neighborhood desirability, amenities, parks, schools, commercial or industrial influences, REO activity, traffic, board-up-homes, etc.
5. Do not approach occupants or owners.
6. If the subject is a Commercial property, contact Clear Capital immediately at 530-582-5011 for direction on how to proceed with the report.
7. Please do not accept if you or your office has completed a report on this property in the last month, are currently listing this property, or have any vested interest in the subject property.
8. Clear Capital does not allow any log ins from IP addresses from foreign countries. This includes, but is not limited to; data entry services, form completion services, etc. Also, it is against Clear Capital code of conduct to share your password with anyone who is not a W2 employee in your office.
9. Clear Capital and our mutual customers greatly appreciate your expertise. If you cannot personally inspect the property, select comparables, and determine a price for the subject, please do not accept this report. Per the standards and guidelines adopted by Clear Capital and other industry leaders, the use of assistants to complete any of the aforementioned tasks is not permitted.

## Report Instructions - cont.

Due to the importance of an independent opinion of price, please do not discuss your price with anyone or be influenced by list price, pending offers, accept comp packets, repair estimates or the listing agent's opinion.

1. One current, original photo of the front of the subject 2. One address verification photo 3. One street scene photo looking down the street 4. MLS listing and sold comp photos required, please comment if no MLS.

## Broker Information

<b>Broker Name</b>	Teri Ann Bragger	<b>Company/Brokerage</b>	First Team Real Estate
<b>License No</b>	00939550	<b>Address</b>	15545 Bear Valley Rd. Hesperia CA 92345
<b>License Expiration</b>	10/09/2026	<b>License State</b>	CA
<b>Phone</b>	7609000529	<b>Email</b>	teribragger@firstteam.com
<b>Broker Distance to Subject</b>	6.42 miles	<b>Date Signed</b>	11/01/2023

*By confirming the above contact and real estate license information and submitting the report, the above signed hereby certifies and agrees that: 1) I personally took the pictures, selected comparables, and determined the price conclusion. 2) To the best of my knowledge, the statements of fact contained in this report are true and correct. 3) The reported analyses, opinions, and conclusions are my personal, impartial, and unbiased professional analyses, opinions, and conclusions. 4) I have no present or prospective interest in the property that is the subject of this report and no personal interest with respect to the parties involved. 5) I have no bias with respect to the property that is the subject of this report or to the parties involved with this assignment. 6) My compensation for completing this assignment is not contingent upon the development or reporting of a predetermined price point. 7) I did not base, either partially or completely, my analysis and/or opinion and conclusions in this report on race, color, religion, sex, age, marital status, handicap, familial status, or national origin of either the prospective owners or occupants of the subject property or of the present owners or occupants of the properties in the vicinity of the subject property or on any other basis prohibited by law. 8) I maintain errors and omissions insurance, to the extent required by state law, for all liability associated with the preparation of this Report.*

## Disclaimer

**This document is not an appraisal as defined by USPAP (Uniform Standards of Professional Appraisal Practice). It is not to be construed as an appraisal and may not be used as such for any purpose.**

### **Unless otherwise specifically agreed to in writing:**

**The intended purpose of this report is to assist the Clear Capital account holder in making decisions within the scope of applicable statutory and regulatory requirements and performing required due diligence. This document is provided solely for the use of the Clear Capital account holder and not any other party, is not intended as any guarantee of value and/or condition of the subject property and should not be relied on as such. In the event that this document is found to be defective, incorrect, negligently prepared or unfit for its authorized use, Clear Capital's sole liability shall be to promptly refund the total fee expended by the account holder for this report or to replace it at no charge to the account holder, but in no event shall Clear Capital be responsible to the account holder for any indirect or consequential damages whatsoever. This warranty is in lieu of all other warranties, express or implied, except where otherwise required by law. The account holder shall notify Clear Capital within thirty (30) days of this report's delivery to the account holder if it believes that this document is defective, incorrect, negligently prepared or unfit for its authorized use. Under no circumstances may Clear Capital forms or their contents be published, copied, replicated, or mimicked.**