

Please Note: This report was completed with the following assumptions: Market Approach: **Fair Market Price** , Marketing Time: **Typical** . Important additional information relating to this report, including use and restrictions, is contained in an attached addendum which is an integral part of this report.

Address	260 Township Drive, Hendersonville, TN 37075	Order ID	9205963	Property ID	35173812
Inspection Date	03/12/2024	Date of Report	03/12/2024		
Loan Number	55333	APN	160F K 007		
Borrower Name	Catamount Properties 2018 LLC	County	Sumner		

Tracking IDs					
Order Tracking ID	3.8_CitiBPO_update	Tracking ID 1	3.8_CitiBPO_update		
Tracking ID 2	--	Tracking ID 3	--		

General Conditions		Condition Comments
Owner	LORRAINE ROETTGER	THE SUBJECT IS IN AVERAGE CONDITION WITH NORMAL WEAR AND TEAR.
R. E. Taxes	\$1,515	
Assessed Value	\$101,200	
Zoning Classification	RESIDENTIAL	
Property Type	SFR	
Occupancy	Vacant	
Secure?	Yes	
(THE SUBJECT IS VACANT. ALL DOOR LOCKS HAVE BEEN CHANGED.)		
Ownership Type	Fee Simple	
Property Condition	Average	
Estimated Exterior Repair Cost		
Estimated Interior Repair Cost		
Total Estimated Repair		
HOA	No	
Visible From Street	Visible	
Road Type	Public	

Neighborhood & Market Data		Neighborhood Comments
Location Type	Rural	THE SUBJECT IS LOCATED IN A NEIGHBORHOOD OF DCOMPARABLE SINGLE FAMILY RESIDENCES. THE SUBJECT CONFORMS WELL TO THE OTHERS.
Local Economy	Stable	
Sales Prices in this Neighborhood	Low: \$300,000 High: \$390,000	
Market for this type of property	Remained Stable for the past 6 months.	
Normal Marketing Days	<30	

Current Listings

	Subject	Listing 1	Listing 2 *	Listing 3
Street Address	260 Township Drive	114 Woodridge Dr.	110 River Bend Rd.	1024 Lynndale Dr.
City, State	Hendersonville, TN	Hendersonville, TN	Hendersonville, TN	Castalian Springs, TN
Zip Code	37075	37075	37075	37031
Datasource	Tax Records	MLS	MLS	MLS
Miles to Subj.	--	0.40 ¹	2.10 ¹	19.80 ¹
Property Type	SFR	SFR	SFR	SFR
Original List Price \$	\$	\$349,999	\$330,000	\$349,900
List Price \$	--	\$319,000	\$330,000	\$349,900
Original List Date		08/25/2023	03/07/2024	03/04/2024
DOM · Cumulative DOM	-- · --	183 · 200	4 · 5	4 · 8
Age (# of years)	42	52	30	33
Condition	Average	Average	Average	Average
Sales Type	--	Fair Market Value	Fair Market Value	Fair Market Value
Location	Neutral ; Residential	Neutral ; Residential	Neutral ; Residential	Neutral ; Residential
View	Neutral ; Residential	Neutral ; Residential	Neutral ; Residential	Neutral ; Residential
Style/Design	1 Story RANCH	1 Story RANCH	1 Story RANCH	1 Story RANCH
# Units	1	1	1	1
Living Sq. Feet	1,053	1,203	1,191	1,145
Bdrm · Bths · ½ Bths	3 · 1 · 1	3 · 1 · 1	3 · 2	3 · 2
Total Room #	5	5	5	5
Garage (Style/Stalls)	None	Attached 1 Car	None	Detached 2 Car(s)
Basement (Yes/No)	No	No	No	No
Basement (% Fin)	0%	0%	0%	0%
Basement Sq. Ft.	--	--	--	--
Pool/Spa	--	--	--	--
Lot Size	0.24 acres	0.21 acres	0.11 acres	1.40 acres
Other	--	--	--	--

* Listing 2 is the most comparable listing to the subject.

¹ Comp's "Miles to Subject" was calculated by the system.

² Comp's "Miles to Subject" provided by Real Estate Professional.

³ Subject \$/ft based upon as-is sale price.

Listing Comments Why the comparable listing is superior or inferior to the subject.

Listing 1 THIS LISTING IS SUPERIOR TO THE SUBJECT IN ITS TOTAL LIVING AREA SIZE. A - \$ 2,900 ADJUSTMENT IS MADE FOR THE DIFFERENCE.

Listing 2 THIS LISTING IS SUPERIOR TO THE SUBJECT IN ITS TOTAL LIVING AREA SIZE. A - \$ 2,760 ADJUSTMENT IS MADE FOR THE DIFFERENCE.

Listing 3 THIS LISTING IS SUPERIOR TO THE SUBJECT IN ITS TOTAL LIVING AREA SIZE. A - \$ 1,840 ADJUSTMENT IS MADE FOR THE DIFFERENCE.

Recent Sales

	Subject	Sold 1	Sold 2 *	Sold 3
Street Address	260 Township Drive	236 Township Dr.	116 Yorkside Pl	123 Creekwood Lane
City, State	Hendersonville, TN	Hendersonville, TN	Hendersonville, TN	Hendersonville, TN
Zip Code	37075	37075	37075	37075
Datasource	Tax Records	MLS	MLS	MLS
Miles to Subj.	--	0.15 ¹	1.81 ¹	1.71 ¹
Property Type	SFR	SFR	SFR	SFR
Original List Price \$	--	\$324,999	\$332,900	\$349,900
List Price \$	--	\$310,000	\$325,000	\$329,900
Sale Price \$	--	\$310,000	\$325,000	\$329,900
Type of Financing	--	Unknown	Unknown	Unknown
Date of Sale	--	02/08/2024	12/26/2023	11/11/2023
DOM · Cumulative DOM	-- · --	76 · 97	27 · --	22 · --
Age (# of years)	42	41	46	47
Condition	Average	Average	Average	Average
Sales Type	--	Fair Market Value	Fair Market Value	Fair Market Value
Location	Neutral ; Residential	Neutral ; Residential	Neutral ; Residential	Neutral ; Residential
View	Neutral ; Residential	Neutral ; Residential	Neutral ; Residential	Neutral ; Residential
Style/Design	1 Story RANCH	1 Story RANCH	1 Story RANCH	1 Story RANCH
# Units	1	1	1	1
Living Sq. Feet	1,053	1,175	1,170	1,075
Bdrm · Bths · ½ Bths	3 · 1 · 1	3 · 1 · 1	3 · 1 · 1	3 · 1 · 1
Total Room #	5	5	5	5
Garage (Style/Stalls)	None	None	None	Attached 1 Car
Basement (Yes/No)	No	No	No	No
Basement (% Fin)	0%	0%	0%	0%
Basement Sq. Ft.	--	--	--	--
Pool/Spa	--	--	--	--
Lot Size	0.24 acres	0.23 acres	0.38 acres	0.28 acres
Other	--	--	--	--
Net Adjustment	--	-\$2,444	+\$2,344	+\$600
Adjusted Price	--	\$307,556	\$327,344	\$330,500

* Sold 2 is the most comparable sale to the subject.

¹ Comp's "Miles to Subject" was calculated by the system.

² Comp's "Miles to Subject" provided by Real Estate Professional.

³ Subject \$/ft based upon as-is sale price.

Reasons for Adjustments Why the comparable sale is superior or inferior to the subject.

Sold 1 THIS SOLD COMP IS SUPERIOR TO THE IN ITS TOTAL LIVING AREA SIZE. A - \$ 2,240 ADJUSTMENT IS MADE FOR THE DIFFERESUBJECTNCE.

Sold 2 THIS SOLD COMP IS SUPERIOR TO THE IN ITS TOTAL LIVING AREA SIZE. A - \$ 2,240 ADJUSTMENT IS MADE FOR THE DIFFERESUBJECTNCE.

Sold 3 THIS SOLD COMP IS SUPERIOR TO THE IN ITS TOTAL LIVING AREA SIZE. A - \$ 600 ADJUSTMENT IS MADE FOR THE DIFFERESUBJECTNCE.

Subject Sales & Listing History

Current Listing Status	Currently Listed	Listing History Comments					
Listing Agency/Firm	SYNERGY REALTY	THE SUBJECT WAS LISTED FOR SALE 01/13/2024,114 WOODRIDGE DR. AND IT WAS LISTED FOR \$ 339,900 AT THAT TIME.					
Listing Agent Name	TOBY GRAVES						
Listing Agent Phone	615- 37-2424						
# of Removed Listings in Previous 12 Months	0						
# of Sales in Previous 12 Months	0						
Original List Date	Original List Price	Final List Date	Final List Price	Result	Result Date	Result Price	Source
01/31/2024	\$339,000	--	--	--	--	--	MLS

Marketing Strategy

	As Is Price	Repaired Price
Suggested List Price	\$324,000	\$324,000
Sales Price	\$320,000	\$320,000
30 Day Price	\$316,000	--
Comments Regarding Pricing Strategy		
THERE IS NO HOUSE NUMBERS ON MAIL BOX OR ON THE HOUSE. I IDENTIFIED THE SUBJECT WITH A COPY OF THE COUNTY TAX MAP AND BY PROPERTY'S ON BOTH SIDES OF IT.		

Clear Capital Quality Assurance Comments Addendum

Reviewer's Notes The broker's as-is conclusion reflects the market for the subject. Comps are within a reasonable distance, relatively current, and accurately reflect the subject's defining characteristics. Thus, the as-is conclusion appears to be adequately supported.

Subject Photos



Front



Address Verification



Street



Street

Listing Photos

L1 114 WOODRIDGE DR.
Hendersonville, TN 37075



Front

L2 110 RIVER BEND RD.
Hendersonville, TN 37075



Front

L3 1024 LYNNDALE DR.
Castalian Springs, TN 37031



Front

Sales Photos

S1 236 TOWNSHIP DR.
Hendersonville, TN 37075



Front

S2 116 YORKSIDE PL
Hendersonville, TN 37075



Front

S3 123 CREEKWOOD LANE
Hendersonville, TN 37075



Front

ClearMaps Addendum

Address ★ 260 Township Drive, Hendersonville, TN 37075

Loan Number 55333

Suggested List \$324,000

Suggested Repaired \$324,000

Sale \$320,000

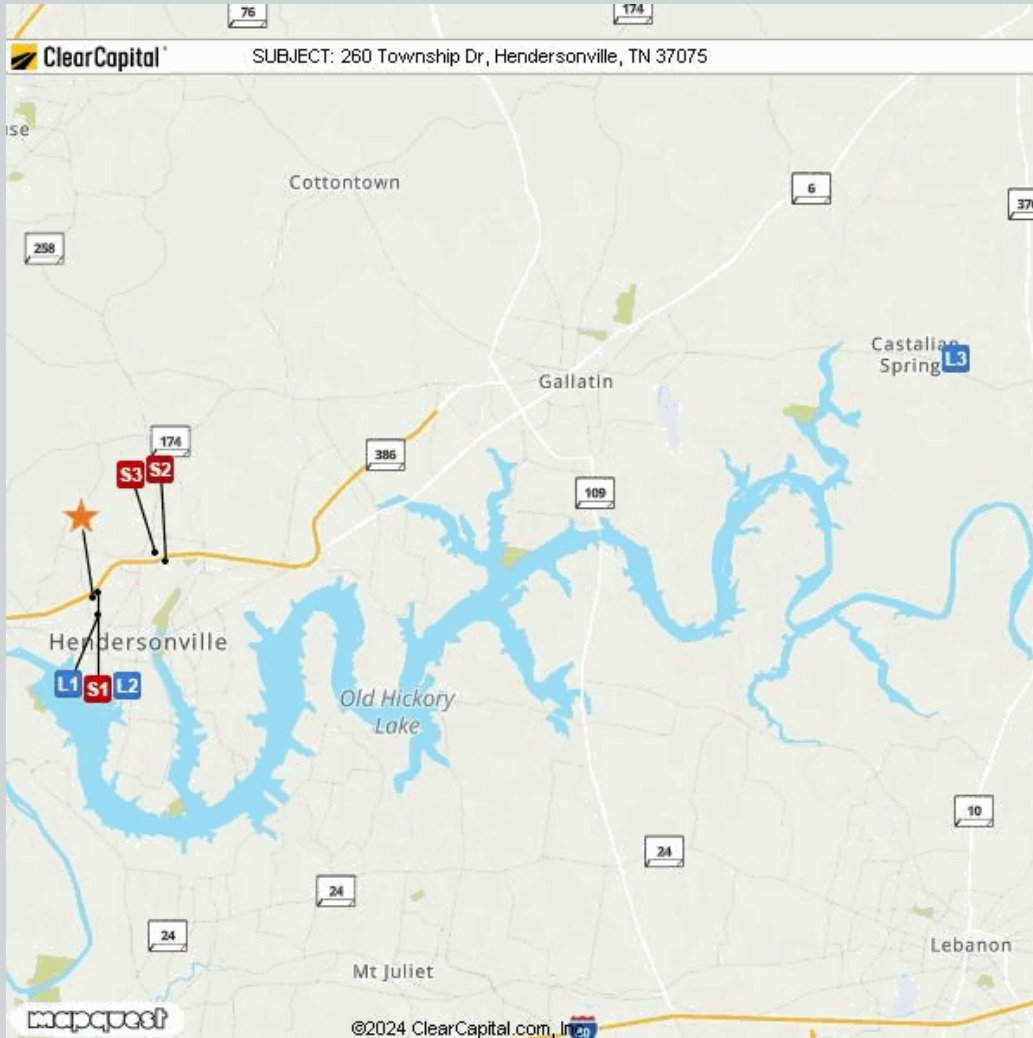

Comparable	Address	Miles to Subject	Mapping Accuracy
★ Subject	260 Township Drive, Hendersonville, TN 37075	--	Parcel Match
L1 Listing 1	114 Woodridge Dr., Hendersonville, TN 37075	0.40 Miles ¹	Parcel Match
L2 Listing 2	110 River Bend Rd., Hendersonville, TN 37075	2.10 Miles ¹	Parcel Match
L3 Listing 3	1024 Lynndale Dr., Castalian Springs, TN 37031	19.80 Miles ¹	Parcel Match
S1 Sold 1	236 Township Dr., Hendersonville, TN 37075	0.15 Miles ¹	Parcel Match
S2 Sold 2	116 Yorkside Pl, Hendersonville, TN 37075	1.81 Miles ¹	Parcel Match
S3 Sold 3	123 Creekwood Lane, Hendersonville, TN 37075	1.71 Miles ¹	Parcel Match

¹ The Comparable "Distance from Subject" value has been calculated by the Clear Capital system.

² The Comparable "Distance from Subject" value has been provided by the Real Estate Professional.

Addendum: Report Purpose

Market Approach and Market Time

The Market Approach of this report, as established by the customer, is: **Fair Market Price**. (See definition below.)

The Marketing Time as specified by the customer is **Typical**. (See definition below.)

Definitions:

Fair Market Price

A price at which the property would sell between a willing buyer and a willing seller neither being compelled by undue pressure and both having reasonable knowledge of relevant facts.

Distressed Price

A price at which the property would sell between a willing buyer and a seller acting under duress.

Marketing Time

The amount of time the property is exposed to a pool of prospective buyers before going into contract. The customer either specifies the number of days, requests a marketing time that is typical to the subject's market area and/or requests an abbreviated marketing time.

Typical for Local Market

The estimated time required to adequately expose the subject property to the market resulting in a contract of sale.

Addendum: Report Purpose - cont.

Report Instructions

This section shows the instructions that were approved by the customer and provided to the broker prior to completing the report.

Instructions last updated: 7/17/2017

Purpose:

Please determine a fair market price for this property at which it would sell in a typical marketing time for the area.

Customer Specific Requests:

If the property is commercial or mixed use, please stop and contact Clear Capital as soon as possible

Form Help:

There are blue question marks (?) throughout this form. These are designed to offer guidance for that particular section of the form. Please click on them for help.

Comparable Requirements:

1. Please use fair market comps from the same neighborhood, block or subdivision whenever possible.
2. Please only use REO comparables if the market is driven by REOs and they are comparable in characteristics and condition.
3. Please use comps that have closed in the past 3 months to show the current market conditions or comment in the report if this is not possible. In rapidly changing markets, active listing comps should be given equal or greater weight than sold comps in your analysis.

Standard Instructions:

1. Clear Capital Code Of Conduct - Please make sure that you are always abiding by the Clear Capital Code of Conduct when completing valuation reports.
2. If the subject is currently listed, please consider all available information pertaining to the subject's condition. This information should be utilized when developing the assumption of the subject's condition.
3. Use the subject characteristics provided in the report Grid (if preloaded) to evaluate the property. This information is from a full interior appraisal and is assumed to be most accurate. If your inspection reveals obvious inaccuracies, please explain in the narrative of the report.
4. Include sufficient detail to help our mutual customer gain a complete understanding of the subject's neighborhood such as neighborhood desirability, amenities, parks, schools, commercial or industrial influences, REO activity, traffic, board-up-homes, etc.
5. Do not approach occupants or owners.
6. If the subject is a Commercial property, contact Clear Capital immediately at 530-582-5011 for direction on how to proceed with the report.
7. Please do not accept if you or your office has completed a report on this property in the last month, are currently listing this property, or have any vested interest in the subject property.
8. Clear Capital does not allow any log ins from IP addresses from foreign countries. This includes, but is not limited to; data entry services, form completion services, etc. Also, it is against Clear Capital code of conduct to share your password with anyone who is not a W2 employee in your office.
9. Clear Capital and our mutual customers greatly appreciate your expertise. If you cannot personally inspect the property, select comparables, and determine a price for the subject, please do not accept this report. Per the standards and guidelines adopted by Clear Capital and other industry leaders, the use of assistants to complete any of the aforementioned tasks is not permitted.

Report Instructions - cont.

Due to the importance of an independent opinion of price, please do not discuss your price with anyone or be influenced by list price, pending offers, accept comp packets, repair estimates or the listing agent's opinion.

1. One current, original photo of the front of the subject 2. One address verification photo 3. One street scene photo looking down the street 4. MLS listing and sold comp photos required, please comment if no MLS.

Broker Information

Broker Name	Stephen Little	Company/Brokerage	RELIANT REALTY
License No	271535	Address	206 OVERLOOK CT WHITE HOUSE TN 37188
License Expiration	05/25/2024	License State	TN
Phone	6158281250	Email	splittle@realtracs.com
Broker Distance to Subject	9.73 miles	Date Signed	03/12/2024

By confirming the above contact and real estate license information and submitting the report, the above signed hereby certifies and agrees that: 1) I personally took the pictures, selected comparables, and determined the price conclusion. 2) To the best of my knowledge, the statements of fact contained in this report are true and correct. 3) The reported analyses, opinions, and conclusions are my personal, impartial, and unbiased professional analyses, opinions, and conclusions. 4) I have no present or prospective interest in the property that is the subject of this report and no personal interest with respect to the parties involved. 5) I have no bias with respect to the property that is the subject of this report or to the parties involved with this assignment. 6) My compensation for completing this assignment is not contingent upon the development or reporting of a predetermined price point. 7) I did not base, either partially or completely, my analysis and/or opinion and conclusions in this report on race, color, religion, sex, age, marital status, handicap, familial status, or national origin of either the prospective owners or occupants of the subject property or of the present owners or occupants of the properties in the vicinity of the subject property or on any other basis prohibited by law. 8) I maintain errors and omissions insurance, to the extent required by state law, for all liability associated with the preparation of this Report.

Disclaimer

This document is not an appraisal as defined by USPAP (Uniform Standards of Professional Appraisal Practice). It is not to be construed as an appraisal and may not be used as such for any purpose.

Unless otherwise specifically agreed to in writing:

The intended purpose of this report is to assist the Clear Capital account holder in making decisions within the scope of applicable statutory and regulatory requirements and performing required due diligence. This document is provided solely for the use of the Clear Capital account holder and not any other party, is not intended as any guarantee of value and/or condition of the subject property and should not be relied on as such. In the event that this document is found to be defective, incorrect, negligently prepared or unfit for its authorized use, Clear Capital's sole liability shall be to promptly refund the total fee expended by the account holder for this report or to replace it at no charge to the account holder, but in no event shall Clear Capital be responsible to the account holder for any indirect or consequential damages whatsoever. This warranty is in lieu of all other warranties, express or implied, except where otherwise required by law. The account holder shall notify Clear Capital within thirty (30) days of this report's delivery to the account holder if it believes that this document is defective, incorrect, negligently prepared or unfit for its authorized use. Under no circumstances may Clear Capital forms or their contents be published, copied, replicated, or mimicked.