

Please Note: This report was completed with the following assumptions: Market Approach: **Fair Market Price** , Marketing Time: **Typical** . Important additional information relating to this report, including use and restrictions, is contained in an attached addendum which is an integral part of this report.

| | | | | | |
|------------------------|---|-----------------------|--------------------------|--------------------|----------|
| Address | 23645 Coral Ridge Lane, Land O Lakes, FLORIDA 34639 | Order ID | 9251928 | Property ID | 35261790 |
| Inspection Date | 04/04/2024 | Date of Report | 04/04/2024 | | |
| Loan Number | 55445 | APN | 20-26-19-0080-00000-3820 | | |
| Borrower Name | Catamount Properties 2018 LLC | County | Pasco | | |

| Tracking IDs | | | | | |
|--------------------------|---------------------------|----------------------|---------------------------|--|--|
| Order Tracking ID | 4.2_BPO_Citi/Atlas_update | Tracking ID 1 | 4.2_BPO_Citi/Atlas_update | | |
| Tracking ID 2 | -- | Tracking ID 3 | -- | | |

General Conditions

| General Conditions | | Condition Comments |
|---------------------------------------|-------------------------------|--|
| Owner | Catamount Properties 2018 LLC | The subject appears to be in average overall condition from the exterior and has been well-maintained. No external obsolescence was noted. |
| R. E. Taxes | \$5,594 | |
| Assessed Value | \$352,721 | |
| Zoning Classification | Residential | |
| Property Type | SFR | |
| Occupancy | Occupied | |
| Ownership Type | Fee Simple | |
| Property Condition | Average | |
| Estimated Exterior Repair Cost | \$0 | |
| Estimated Interior Repair Cost | \$0 | |
| Total Estimated Repair | \$0 | |
| HOA | No | |
| Visible From Street | Visible | |
| Road Type | Public | |

Neighborhood & Market Data

| Neighborhood & Market Data | | Neighborhood Comments |
|--|--|---|
| Location Type | Suburban | The subject is situated in a neighborhood that consists mainly of conventional style SFR homes of various ages, displaying general similarity in design, and location views. The subject appears to be well maintained. |
| Local Economy | Stable | |
| Sales Prices in this Neighborhood | Low: \$415,000 High: \$504,000 | |
| Market for this type of property | Remained Stable for the past 6 months. | |
| Normal Marketing Days | <90 | |

Current Listings

| | Subject | Listing 1 | Listing 2 * | Listing 3 |
|------------------------|------------------------|-----------------------|-----------------------|-----------------------|
| Street Address | 23645 Coral Ridge Lane | 3045 Banyan Hill Ln | 2918 Banyan Hill Ln | 3228 Sago Point Ct |
| City, State | Land O Lakes, FLORIDA | Land O Lakes, FL | Land O Lakes, FL | Land O Lakes, FL |
| Zip Code | 34639 | 34639 | 34639 | 34639 |
| Datasource | Tax Records | MLS | MLS | MLS |
| Miles to Subj. | -- | 0.13 ¹ | 0.16 ¹ | 0.27 ¹ |
| Property Type | SFR | SFR | SFR | SFR |
| Original List Price \$ | \$ | \$439,900 | \$457,000 | \$457,000 |
| List Price \$ | -- | \$439,900 | \$457,000 | \$457,000 |
| Original List Date | | 03/27/2024 | 10/23/2023 | 03/27/2024 |
| DOM · Cumulative DOM | -- · -- | 8 · 8 | 164 · 164 | 7 · 8 |
| Age (# of years) | 21 | 23 | 21 | 21 |
| Condition | Average | Average | Average | Average |
| Sales Type | -- | Fair Market Value | Fair Market Value | Fair Market Value |
| Location | Neutral ; Residential | Neutral ; Residential | Neutral ; Residential | Neutral ; Residential |
| View | Neutral ; Residential | Neutral ; Residential | Neutral ; Residential | Neutral ; Residential |
| Style/Design | 1 Story ranch | 1 Story ranch | 1 Story ranch | 1 Story ranch |
| # Units | 1 | 1 | 1 | 1 |
| Living Sq. Feet | 1,819 | 1,819 | 1,819 | 1,866 |
| Bdrm · Bths · ½ Bths | 3 · 2 | 3 · 2 | 3 · 2 | 3 · 2 |
| Total Room # | 6 | 6 | 6 | 6 |
| Garage (Style/Stalls) | Attached 2 Car(s) | Attached 2 Car(s) | Attached 2 Car(s) | Attached 3 Car(s) |
| Basement (Yes/No) | No | No | No | No |
| Basement (% Fin) | 0% | 0% | 0% | 0% |
| Basement Sq. Ft. | -- | -- | -- | -- |
| Pool/Spa | -- | -- | -- | -- |
| Lot Size | 0.15 acres | 0.14 acres | 0.13 acres | 0.16 acres |
| Other | NONE | NONE | NONE | NONE |

* Listing 2 is the most comparable listing to the subject.

¹ Comp's "Miles to Subject" was calculated by the system.

² Comp's "Miles to Subject" provided by Real Estate Professional.

³ Subject \$/ft based upon as-is sale price.

Listing Comments Why the comparable listing is superior or inferior to the subject.

Listing 1 A fair market property, similar in GLA, similar in style and condition, similar in age, it has 3/2-floor plan, similar in view, it has 2 garage spaces. Estimated adjustment(s): There were no adjustments made.

Listing 2 It has 3/2-floor plan, it has 2 garage spaces, similar in age, similar in GLA, a fair market property, similar in style and condition, similar in view. Estimated adjustment(s): There were no adjustments made.

Listing 3 Similar in age, similar in view, similar in style and condition, it has 3/2-floor plan, similar in GLA, it has 3 garage spaces, a fair market property. Estimated adjustment(s): Garage: -\$4000

Recent Sales

| | Subject | Sold 1 | Sold 2 * | Sold 3 |
|-------------------------------|------------------------|-----------------------|-----------------------|-----------------------|
| Street Address | 23645 Coral Ridge Lane | 23717 Coral Ridge Ln | 3327 Coconut Grove Rd | 3054 Banyan Hill Ln |
| City, State | Land O Lakes, FLORIDA | Land O Lakes, FL | Land O Lakes, FL | Land O Lakes, FL |
| Zip Code | 34639 | 34639 | 34639 | 34639 |
| Datasource | Tax Records | MLS | MLS | MLS |
| Miles to Subj. | -- | 0.06 ¹ | 0.56 ¹ | 0.11 ¹ |
| Property Type | SFR | SFR | SFR | SFR |
| Original List Price \$ | -- | \$475,000 | \$455,000 | \$445,000 |
| List Price \$ | -- | \$475,000 | \$455,000 | \$445,000 |
| Sale Price \$ | -- | \$475,000 | \$455,000 | \$445,000 |
| Type of Financing | -- | Conventional | Conventional | Conventional |
| Date of Sale | -- | 07/21/2023 | 08/21/2023 | 07/31/2023 |
| DOM · Cumulative DOM | -- · -- | 3 · 50 | 22 · 64 | 2 · 45 |
| Age (# of years) | 21 | 21 | 23 | 22 |
| Condition | Average | Average | Average | Average |
| Sales Type | -- | Fair Market Value | Fair Market Value | Fair Market Value |
| Location | Neutral ; Residential | Neutral ; Residential | Neutral ; Residential | Neutral ; Residential |
| View | Neutral ; Residential | Neutral ; Residential | Neutral ; Residential | Neutral ; Residential |
| Style/Design | 1 Story ranch | 1 Story ranch | 1 Story ranch | 1 Story ranch |
| # Units | 1 | 1 | 1 | 1 |
| Living Sq. Feet | 1,819 | 1,819 | 1,861 | 1,819 |
| Bdrm · Bths · ½ Bths | 3 · 2 | 3 · 2 | 3 · 2 | 3 · 2 |
| Total Room # | 6 | 6 | 6 | 6 |
| Garage (Style/Stalls) | Attached 2 Car(s) | Attached 2 Car(s) | Attached 3 Car(s) | Attached 2 Car(s) |
| Basement (Yes/No) | No | No | No | No |
| Basement (% Fin) | 0% | 0% | 0% | 0% |
| Basement Sq. Ft. | -- | -- | -- | -- |
| Pool/Spa | -- | -- | -- | -- |
| Lot Size | 0.15 acres | 0.14 acres | 0.16 acres | 0.14 acres |
| Other | NONE | NONE | NONE | NONE |
| Net Adjustment | -- | \$0 | -\$4,000 | \$0 |
| Adjusted Price | -- | \$475,000 | \$451,000 | \$445,000 |

* Sold 2 is the most comparable sale to the subject.

¹ Comp's "Miles to Subject" was calculated by the system.

² Comp's "Miles to Subject" provided by Real Estate Professional.

³ Subject \$/ft based upon as-is sale price.

Recent Sales - Cont.

Reasons for Adjustments Why the comparable sale is superior or inferior to the subject.

- Sold 1** A fair market property, it has 3/2-floor plan, similar in age, similar in GLA, similar in view, similar in style and condition, it has 2 garage spaces. Estimated adjustment(s): There were no adjustments made.
- Sold 2** It has 3/2-floor plan, a fair market property, similar in style and condition, similar in view, similar in age, it has 2 garage spaces, similar in GLA. Estimated adjustment(s): Garage: -\$4000
- Sold 3** Similar in style and condition, similar in view, it has 3/2-floor plan, similar in GLA, it has 2 garage spaces, a fair market property, similar in age. Estimated adjustment(s): There were no adjustments made.

Subject Sales & Listing History

| | | | | | | | |
|--|--------------------------------|--|-------------------------|---------------|--------------------|---------------------|---------------|
| Current Listing Status | Currently Listed | Listing History Comments | | | | | |
| Listing Agency/Firm | RE/MAX ACTION FIRST OF FLORIDA | The subject was active last (01/19/2024) with the price of (\$449,800) | | | | | |
| Listing Agent Name | Daniel Martucci | | | | | | |
| Listing Agent Phone | 813-376-4382 | | | | | | |
| # of Removed Listings in Previous 12 Months | 0 | | | | | | |
| # of Sales in Previous 12 Months | 0 | | | | | | |
| Original List Date | Original List Price | Final List Date | Final List Price | Result | Result Date | Result Price | Source |
| 01/19/2024 | \$449,800 | -- | -- | -- | -- | -- | MLS |

Marketing Strategy

| | As Is Price | Repaired Price |
|--|-------------|----------------|
| Suggested List Price | \$459,800 | \$459,800 |
| Sales Price | \$449,800 | \$449,800 |
| 30 Day Price | \$444,800 | -- |
| Comments Regarding Pricing Strategy | | |
| <p>Comparison analysis was done by collecting market data, selecting the most appropriate comparable properties, verifying market data, applying appropriate adjustments, and reconciling the various adjusted indicators of value into a value estimate. Market prices are increasing. Low-interest rates, low inventory, and increased demand are driving prices upward. The average marketing time is 90 days. All comps were the closest possible to the subject in lot size, sq ft., and age, no better sale and active comps were found; therefore I include comps over 1 mile far from the subject property with inferior and superior features. I went back 11 months, out in distance 1-miles, GLA 20%-30% variance, age 10 years variance, lot size within 0.10- 0.50 acre. The comps used are the best possible currently available comps within 1-mile and the adjustments are sufficient for this area to account for the differences in the subject and comparables. The estimated adjustments for the comparables noted are as follows; garage \$4000 per garage space.</p> | | |

Clear Capital Quality Assurance Comments Addendum

Reviewer's Notes The broker's as-is conclusion reflects the market for the subject. Comps are within a reasonable distance, relatively current, and accurately reflect the subject's defining characteristics. Thus, the as-is conclusion appears to be adequately supported.

Subject Photos



Front



Address Verification



Side



Side



Street



Street

Subject Photos



Other

Listing Photos

L1 3045 BANYAN HILL LN
Land O Lakes, FL 34639



Front

L2 2918 BANYAN HILL LN
Land O Lakes, FL 34639



Front

L3 3228 SAGO POINT CT
Land O Lakes, FL 34639



Front

Sales Photos

S1 23717 CORAL RIDGE LN
Land O Lakes, FL 34639



Front

S2 3327 COCONUT GROVE RD
Land O Lakes, FL 34639



Front

S3 3054 BANYAN HILL LN
Land O Lakes, FL 34639



Front

ClearMaps Addendum

Address ★ 23645 Coral Ridge Lane, Land O Lakes, FLORIDA 34639

Loan Number 55445

Suggested List \$459,800

Suggested Repaired \$459,800

Sale \$449,800

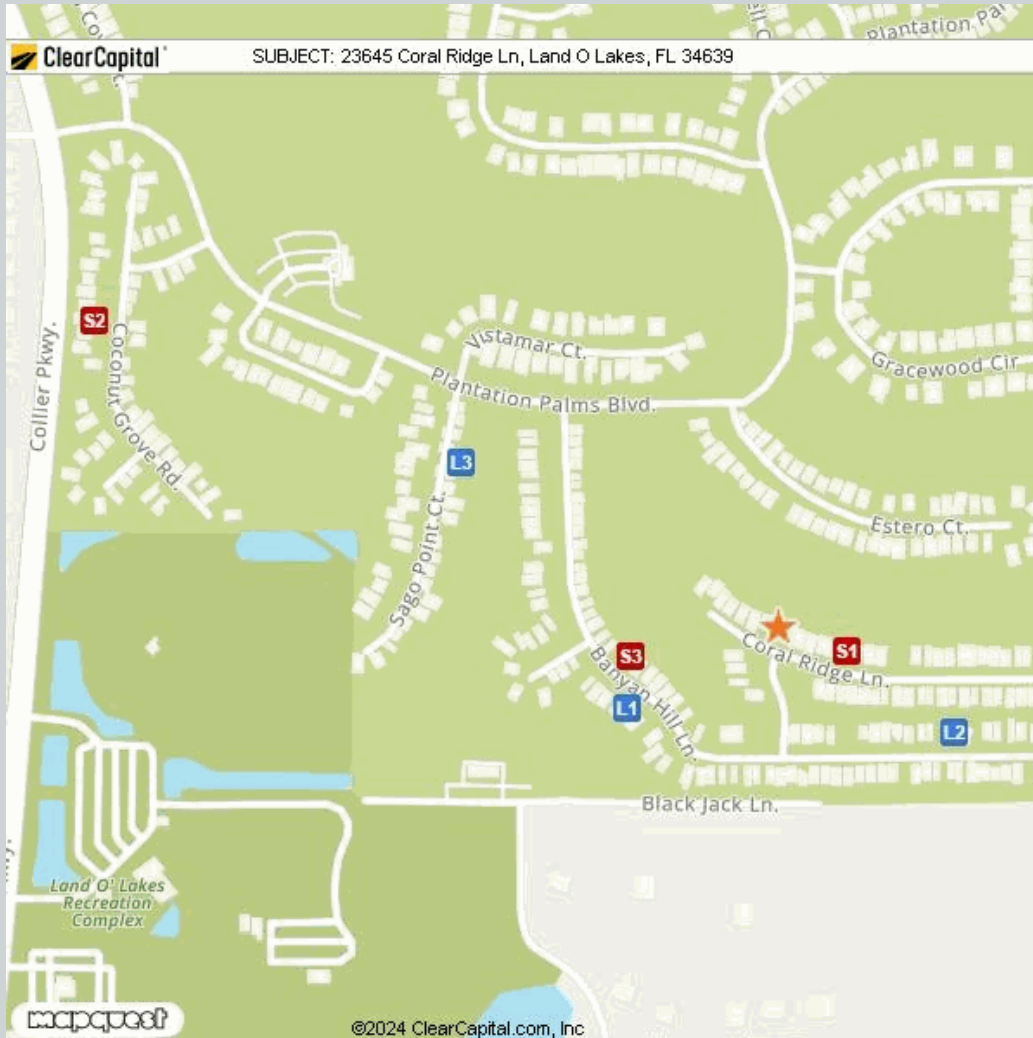

| Comparable | Address | Miles to Subject | Mapping Accuracy |
|--------------|---|-------------------------|------------------|
| ★ Subject | 23645 Coral Ridge Lane, Land O Lakes, Florida 34639 | -- | Parcel Match |
| L1 Listing 1 | 3045 Banyan Hill Ln, Land O Lakes, FL 34639 | 0.13 Miles ¹ | Parcel Match |
| L2 Listing 2 | 2918 Banyan Hill Ln, Land O Lakes, FL 34639 | 0.16 Miles ¹ | Parcel Match |
| L3 Listing 3 | 3228 Sago Point Ct, Land O Lakes, FL 34639 | 0.27 Miles ¹ | Parcel Match |
| S1 Sold 1 | 23717 Coral Ridge Ln, Land O Lakes, FL 34639 | 0.06 Miles ¹ | Parcel Match |
| S2 Sold 2 | 3327 Coconut Grove Rd, Land O Lakes, FL 34639 | 0.56 Miles ¹ | Parcel Match |
| S3 Sold 3 | 3054 Banyan Hill Ln, Land O Lakes, FL 34639 | 0.11 Miles ¹ | Parcel Match |

¹ The Comparable "Distance from Subject" value has been calculated by the Clear Capital system.

² The Comparable "Distance from Subject" value has been provided by the Real Estate Professional.

Addendum: Report Purpose

Market Approach and Market Time

The Market Approach of this report, as established by the customer, is: **Fair Market Price**. (See definition below.)

The Marketing Time as specified by the customer is **Typical**. (See definition below.)

Definitions:

Fair Market Price

A price at which the property would sell between a willing buyer and a willing seller neither being compelled by undue pressure and both having reasonable knowledge of relevant facts.

Distressed Price

A price at which the property would sell between a willing buyer and a seller acting under duress.

Marketing Time

The amount of time the property is exposed to a pool of prospective buyers before going into contract. The customer either specifies the number of days, requests a marketing time that is typical to the subject's market area and/or requests an abbreviated marketing time.

Typical for Local Market

The estimated time required to adequately expose the subject property to the market resulting in a contract of sale.

Addendum: Report Purpose - cont.

Report Instructions

This section shows the instructions that were approved by the customer and provided to the broker prior to completing the report.

Instructions last updated: 7/17/2017

Purpose:

Please determine a fair market price for this property at which it would sell in a typical marketing time for the area.

Customer Specific Requests:

If the property is commercial or mixed use, please stop and contact Clear Capital as soon as possible

Form Help:

There are blue question marks (?) throughout this form. These are designed to offer guidance for that particular section of the form. Please click on them for help.

Comparable Requirements:

1. Please use fair market comps from the same neighborhood, block or subdivision whenever possible.
2. Please only use REO comparables if the market is driven by REOs and they are comparable in characteristics and condition.
3. Please use comps that have closed in the past 3 months to show the current market conditions or comment in the report if this is not possible. In rapidly changing markets, active listing comps should be given equal or greater weight than sold comps in your analysis.

Standard Instructions:

1. Clear Capital Code Of Conduct - Please make sure that you are always abiding by the Clear Capital Code of Conduct when completing valuation reports.
2. If the subject is currently listed, please consider all available information pertaining to the subject's condition. This information should be utilized when developing the assumption of the subject's condition.
3. Use the subject characteristics provided in the report Grid (if preloaded) to evaluate the property. This information is from a full interior appraisal and is assumed to be most accurate. If your inspection reveals obvious inaccuracies, please explain in the narrative of the report.
4. Include sufficient detail to help our mutual customer gain a complete understanding of the subject's neighborhood such as neighborhood desirability, amenities, parks, schools, commercial or industrial influences, REO activity, traffic, board-up-homes, etc.
5. Do not approach occupants or owners.
6. If the subject is a Commercial property, contact Clear Capital immediately at 530-582-5011 for direction on how to proceed with the report.
7. Please do not accept if you or your office has completed a report on this property in the last month, are currently listing this property, or have any vested interest in the subject property.
8. Clear Capital does not allow any log ins from IP addresses from foreign countries. This includes, but is not limited to; data entry services, form completion services, etc. Also, it is against Clear Capital code of conduct to share your password with anyone who is not a W2 employee in your office.
9. Clear Capital and our mutual customers greatly appreciate your expertise. If you cannot personally inspect the property, select comparables, and determine a price for the subject, please do not accept this report. Per the standards and guidelines adopted by Clear Capital and other industry leaders, the use of assistants to complete any of the aforementioned tasks is not permitted.

Report Instructions - cont.

Due to the importance of an independent opinion of price, please do not discuss your price with anyone or be influenced by list price, pending offers, accept comp packets, repair estimates or the listing agent's opinion.

1. One current, original photo of the front of the subject 2. One address verification photo 3. One street scene photo looking down the street 4. MLS listing and sold comp photos required, please comment if no MLS.

Broker Information

| | | | |
|-----------------------------------|----------------|--------------------------|--------------------------------------|
| Broker Name | Matthew Duryea | Company/Brokerage | Yellowfin Realty |
| License No | SL3245371 | Address | 5404 N Central Ave Tampa FL 33604 |
| License Expiration | 03/31/2025 | License State | FL |
| Phone | 9043273239 | Email | matthew.duryea@gmail.com |
| Broker Distance to Subject | 14.34 miles | Date Signed | 04/04/2024 |

By confirming the above contact and real estate license information and submitting the report, the above signed hereby certifies and agrees that: 1) I personally took the pictures, selected comparables, and determined the price conclusion. 2) To the best of my knowledge, the statements of fact contained in this report are true and correct. 3) The reported analyses, opinions, and conclusions are my personal, impartial, and unbiased professional analyses, opinions, and conclusions. 4) I have no present or prospective interest in the property that is the subject of this report and no personal interest with respect to the parties involved. 5) I have no bias with respect to the property that is the subject of this report or to the parties involved with this assignment. 6) My compensation for completing this assignment is not contingent upon the development or reporting of a predetermined price point. 7) I did not base, either partially or completely, my analysis and/or opinion and conclusions in this report on race, color, religion, sex, age, marital status, handicap, familial status, or national origin of either the prospective owners or occupants of the subject property or of the present owners or occupants of the properties in the vicinity of the subject property or on any other basis prohibited by law. 8) I maintain errors and omissions insurance, to the extent required by state law, for all liability associated with the preparation of this Report.

Disclaimer

This document is not an appraisal as defined by USPAP (Uniform Standards of Professional Appraisal Practice). It is not to be construed as an appraisal and may not be used as such for any purpose.

Unless otherwise specifically agreed to in writing:

The intended purpose of this report is to assist the Clear Capital account holder in making decisions within the scope of applicable statutory and regulatory requirements and performing required due diligence. This document is provided solely for the use of the Clear Capital account holder and not any other party, is not intended as any guarantee of value and/or condition of the subject property and should not be relied on as such. In the event that this document is found to be defective, incorrect, negligently prepared or unfit for its authorized use, Clear Capital's sole liability shall be to promptly refund the total fee expended by the account holder for this report or to replace it at no charge to the account holder, but in no event shall Clear Capital be responsible to the account holder for any indirect or consequential damages whatsoever. This warranty is in lieu of all other warranties, express or implied, except where otherwise required by law. The account holder shall notify Clear Capital within thirty (30) days of this report's delivery to the account holder if it believes that this document is defective, incorrect, negligently prepared or unfit for its authorized use. Under no circumstances may Clear Capital forms or their contents be published, copied, replicated, or mimicked.