

Please Note: This report was completed with the following assumptions: Market Approach: **Fair Market Price** , Marketing Time: **Typical** . Important additional information relating to this report, including use and restrictions, is contained in an attached addendum which is an integral part of this report.

Address	5032 Norfolk Drive, Plano, TX 75023	Order ID	9212783	Property ID	35185046
Inspection Date	03/13/2024	Date of Report	03/13/2024		
Loan Number	56755	APN	R-0221-009-0080-1		
Borrower Name	Catamount Properties 2018 LLC	County	Collin		

Tracking IDs

Order Tracking ID	3.13_BPO	Tracking ID 1	3.13_BPO
Tracking ID 2	--	Tracking ID 3	--

General Conditions

Owner	Dilworth Lois Nahda	Condition Comments Subject did not appear to have any exterior damage. Brick, doors, windows foundation appear in tact. Roof did not have any missing, curled or damaged shingles. Subject appeared well maintained. No repairs recommended from dirve by inspections.
R. E. Taxes	\$709,760	
Assessed Value	\$411,213	
Zoning Classification	Residential	
Property Type	SFR	
Occupancy	Occupied	
Ownership Type	Fee Simple	
Property Condition	Average	
Estimated Exterior Repair Cost		
Estimated Interior Repair Cost		
Total Estimated Repair		
HOA	No	
Visible From Street	Visible	
Road Type	Public	

Neighborhood & Market Data

Location Type	Suburban	Neighborhood Comments Subject is located in Plano, Texas a desirable suburb of the Dallas metroplex. Home in this subdivision are average priced homes attracting middle income buyers. Walking distance to parks hike and bike trails and schools.
Local Economy	Stable	
Sales Prices in this Neighborhood	Low: \$400,000 High: \$700,000	
Market for this type of property	Remained Stable for the past 6 months.	
Normal Marketing Days	<90	

Current Listings

	Subject	Listing 1 *	Listing 2	Listing 3
Street Address	5032 Norfolk Drive	1828 Hatherly Drive	2501 Chamberlain Drive	2216 Loch Haven Drive
City, State	Plano, TX	Plano, TX	Plano, TX	Plano, TX
Zip Code	75023	75023	75023	75023
Datasource	Tax Records	MLS	MLS	MLS
Miles to Subj.	--	0.05 ¹	0.97 ¹	0.78 ¹
Property Type	SFR	SFR	SFR	SFR
Original List Price \$	\$	\$530,000	\$540,000	\$579,000
List Price \$	--	\$530,000	\$540,000	\$579,000
Original List Date		03/07/2024	01/26/2024	03/09/2024
DOM · Cumulative DOM	-- · --	6 · 6	3 · 47	4 · 4
Age (# of years)	45	45	43	45
Condition	Average	Average	Average	Average
Sales Type	--	Fair Market Value	Fair Market Value	Fair Market Value
Location	Neutral ; Residential	Neutral ; Residential	Neutral ; Residential	Neutral ; Residential
View	Neutral ; Residential	Neutral ; Residential	Neutral ; Residential	Neutral ; Residential
Style/Design	1 Story Trad	1 Story Trad	1 Story Trad	1 Story Trad
# Units	1	1	1	1
Living Sq. Feet	2,307	2,290	2,314	2,459
Bdrm · Bths · ½ Bths	3 · 2 · 1	4 · 2	3 · 2 · 1	4 · 2 · 1
Total Room #	6	6	6	6
Garage (Style/Stalls)	Attached 2 Car(s)	Attached 2 Car(s)	Attached 2 Car(s)	Attached 2 Car(s)
Basement (Yes/No)	No	No	No	No
Basement (% Fin)	0%	0%	0%	0%
Basement Sq. Ft.	--	--	--	--
Pool/Spa	--	--	--	Pool - Yes
Lot Size	0.230 acres	0.260 acres	0.230 acres	0.220 acres
Other	--	Covered Patio	Covered Patio	Covered Patio

* Listing 1 is the most comparable listing to the subject.

¹ Comp's "Miles to Subject" was calculated by the system.

² Comp's "Miles to Subject" provided by Real Estate Professional.

³ Subject \$/ft based upon as-is sale price.

Listing Comments Why the comparable listing is superior or inferior to the subject.

Listing 1 Four bedrooms, 2 full baths, 2 living areas, same subdivision as subject. Less GLA than subject and has one more bedroom and less 1/2 bath than subject.

Listing 2 three bedroom two- and one-half bath home same as subject. Similar GLA with similar features as subject.

Listing 3 More GLA than subject with four bedrooms and two and a half bathrooms. Has above ground pool.

Recent Sales

	Subject	Sold 1 *	Sold 2	Sold 3
Street Address	5032 Norfolk Drive	4012 Hatherly Drive	5005 Crooked Lane	4025 Halifax Drive
City, State	Plano, TX	Plano, TX	Plano, TX	Plano, TX
Zip Code	75023	75023	75023	75023
Datasource	Tax Records	MLS	MLS	MLS
Miles to Subj.	--	0.15 ¹	0.11 ¹	0.60 ¹
Property Type	SFR	SFR	SFR	SFR
Original List Price \$	--	\$500,000	\$585,000	\$550,000
List Price \$	--	\$494,900	\$585,000	\$500,000
Sale Price \$	--	\$494,900	\$590,000	\$495,000
Type of Financing	--	Va	Conventional	Conventional
Date of Sale	--	02/02/2024	03/07/2024	12/29/2023
DOM · Cumulative DOM	-- · --	68 · 94	6 · 32	134 · 134
Age (# of years)	45	46	45	43
Condition	Average	Average	Average	Average
Sales Type	--	Fair Market Value	Fair Market Value	Fair Market Value
Location	Neutral ; Residential	Neutral ; Residential	Neutral ; Residential	Neutral ; Residential
View	Neutral ; Residential	Neutral ; Residential	Neutral ; Residential	Neutral ; Residential
Style/Design	1 Story Trad	1 Story Trad	1 Story Trad	1 Story Trad
# Units	1	1	1	1
Living Sq. Feet	2,307	2,180	2,581	2,378
Bdrm · Bths · ½ Bths	3 · 2 · 1	4 · 2 · 1	4 · 3 · 1	4 · 2
Total Room #	6	1	1	1
Garage (Style/Stalls)	Attached 2 Car(s)	Attached 2 Car(s)	Attached 2 Car(s)	Attached 2 Car(s)
Basement (Yes/No)	No	No	No	No
Basement (% Fin)	0%	0%	0%	0%
Basement Sq. Ft.	--	--	--	--
Pool/Spa	--	--	--	--
Lot Size	0.230 acres	0.230 acres	0.250 acres	0.280 acres
Other	--	--	8700 seller concessions	7500 seller concessions
Net Adjustment	--	-\$2,460	-\$21,680	-\$12,420
Adjusted Price	--	\$492,440	\$568,320	\$482,580

* Sold 1 is the most comparable sale to the subject.

¹ Comp's "Miles to Subject" was calculated by the system.

² Comp's "Miles to Subject" provided by Real Estate Professional.

³ Subject \$/ft based upon as-is sale price.

Reasons for Adjustments Why the comparable sale is superior or inferior to the subject.

Sold 1 4Bedrooms, 2.5 baths, 2 living areas, with less GLA than subject. Has similar features as subject in same sub division.

Sold 2 Same subdivision and subject with one more bedroom and one more full bathroom than subject. More GLA than subject.

Sold 3 four bedroom 2 full bath versus subject 3 bedroom, 2 and 1/2 baths. More GLA than subject. Same subdivision as subject and similar in age and features.

Subject Sales & Listing History

Current Listing Status	Not Currently Listed			Listing History Comments			
Listing Agency/Firm				MLS does not have any evidence that subject has been sold in the last 12 months or that subject had been listed and removed from market in the last 12 months.			
Listing Agent Name							
Listing Agent Phone							
# of Removed Listings in Previous 12 Months	0						
# of Sales in Previous 12 Months	0						
Original List Date	Original List Price	Final List Date	Final List Price	Result	Result Date	Result Price	Source

Marketing Strategy

	As Is Price	Repaired Price
Suggested List Price	\$505,000	\$505,000
Sales Price	\$500,000	\$500,000
30 Day Price	\$495,000	--
Comments Regarding Pricing Strategy		
Interests rates remain high at this time. The economy is still unstable however, researcher are optimistic about the market in the coming months. There are no recommended repairs to subject from drive by. Comparable properties used were in the same subdivision and within GLA and sold time requirements. Pricing is based on this as well as the necessary adjustments made.		

Clear Capital Quality Assurance Comments Addendum

Reviewer's Notes The broker's as-is conclusion reflects the market for the subject. Comps are within a reasonable distance, relatively current, and accurately reflect the subject's defining characteristics. Thus, the as-is conclusion appears to be adequately supported.

Subject Photos



Front



Address Verification



Street

Listing Photos

L1 1828 Hatherly Drive
Plano, TX 75023



Front

L2 2501 Chamberlain Drive
Plano, TX 75023



Front

L3 2216 Loch Haven Drive
Plano, TX 75023



Front

Sales Photos

S1 4012 Hatherly Drive
Plano, TX 75023



Front

S2 5005 Crooked Lane
Plano, TX 75023



Front

S3 4025 Halifax Drive
Plano, TX 75023



Front

ClearMaps Addendum

Address ★ 5032 Norfolk Drive, Plano, TX 75023

Loan Number 56755

Suggested List \$505,000

Suggested Repaired \$505,000

Sale \$500,000

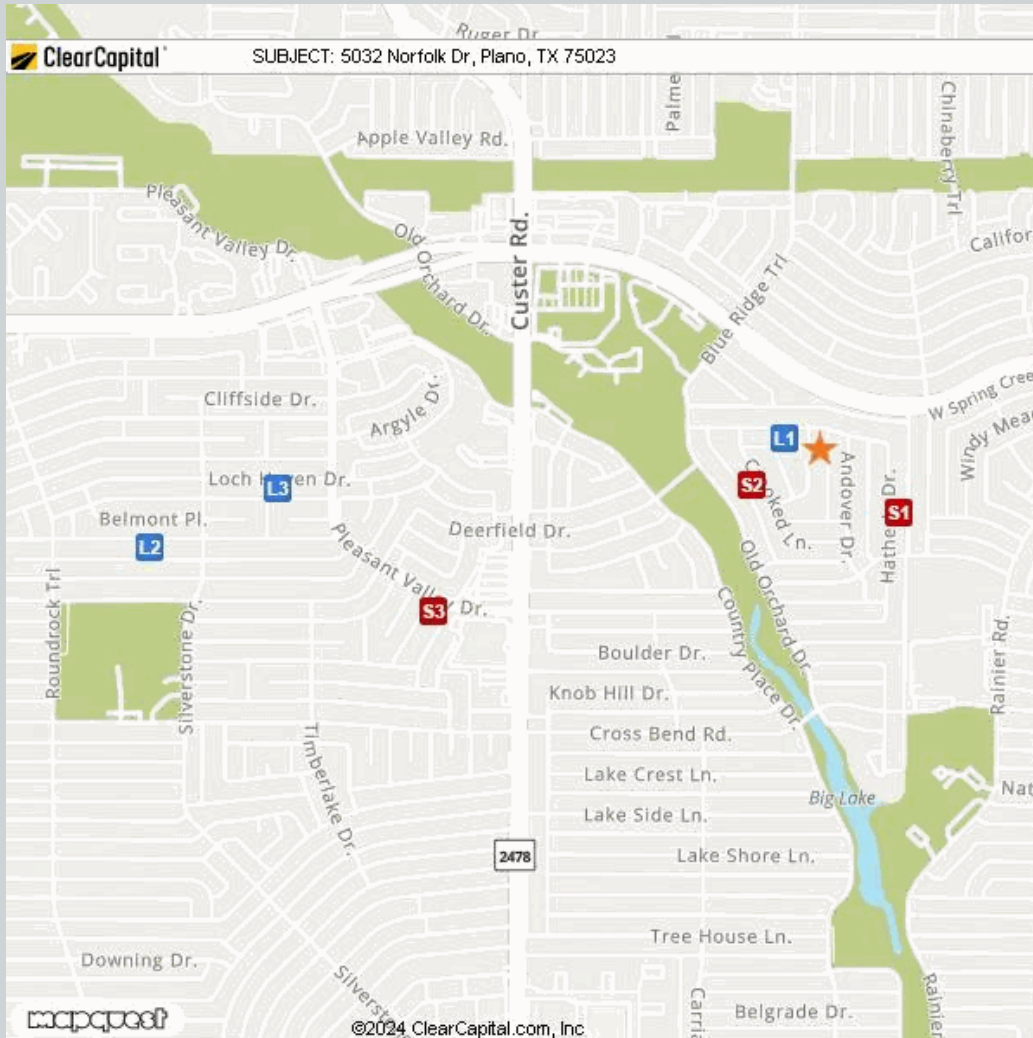

Comparable	Address	Miles to Subject	Mapping Accuracy
★ Subject	5032 Norfolk Drive, Plano, TX 75023	--	Parcel Match
L1 Listing 1	1828 Hatherly Drive, Plano, TX 75023	0.05 Miles ¹	Parcel Match
L2 Listing 2	2501 Chamberlain Drive, Plano, TX 75023	0.97 Miles ¹	Parcel Match
L3 Listing 3	2216 Loch Haven Drive, Plano, TX 75023	0.78 Miles ¹	Parcel Match
S1 Sold 1	4012 Hatherly Drive, Plano, TX 75023	0.15 Miles ¹	Parcel Match
S2 Sold 2	5005 Crooked Lane, Plano, TX 75023	0.11 Miles ¹	Parcel Match
S3 Sold 3	4025 Halifax Drive, Plano, TX 75023	0.60 Miles ¹	Parcel Match

¹ The Comparable "Distance from Subject" value has been calculated by the Clear Capital system.

² The Comparable "Distance from Subject" value has been provided by the Real Estate Professional.

Addendum: Report Purpose

Market Approach and Market Time

The Market Approach of this report, as established by the customer, is: **Fair Market Price**. (See definition below.)

The Marketing Time as specified by the customer is **Typical**. (See definition below.)

Definitions:

Fair Market Price

A price at which the property would sell between a willing buyer and a willing seller neither being compelled by undue pressure and both having reasonable knowledge of relevant facts.

Distressed Price

A price at which the property would sell between a willing buyer and a seller acting under duress.

Marketing Time

The amount of time the property is exposed to a pool of prospective buyers before going into contract. The customer either specifies the number of days, requests a marketing time that is typical to the subject's market area and/or requests an abbreviated marketing time.

Typical for Local Market

The estimated time required to adequately expose the subject property to the market resulting in a contract of sale.

Addendum: Report Purpose - cont.

Report Instructions

This section shows the instructions that were approved by the customer and provided to the broker prior to completing the report.

*** Please Note: This is a RUSH assignment. Do not accept if you cannot meet the current due date and time. Please reference the set terms and contact Clear Capital at 530.582.5011 if you require any changes. Thanks! ***

Instructions last updated: 7/17/2017

Purpose:

Please determine a fair market price for this property at which it would sell in a typical marketing time for the area.

Customer Specific Requests:

If the property is commercial or mixed use, please stop and contact Clear Capital as soon as possible

Form Help:

There are blue question marks (?) throughout this form. These are designed to offer guidance for that particular section of the form. Please click on them for help.

Comparable Requirements:

1. Please use fair market comps from the same neighborhood, block or subdivision whenever possible.
2. Please only use REO comparables if the market is driven by REOs and they are comparable in characteristics and condition.
3. Please use comps that have closed in the past 3 months to show the current market conditions or comment in the report if this is not possible. In rapidly changing markets, active listing comps should be given equal or greater weight than sold comps in your analysis.

Standard Instructions:

1. Clear Capital Code Of Conduct - Please make sure that you are always abiding by the Clear Capital Code of Conduct when completing valuation reports.
2. If the subject is currently listed, please consider all available information pertaining to the subject's condition. This information should be utilized when developing the assumption of the subject's condition.
3. Use the subject characteristics provided in the report Grid (if preloaded) to evaluate the property. This information is from a full interior appraisal and is assumed to be most accurate. If your inspection reveals obvious inaccuracies, please explain in the narrative of the report.
4. Include sufficient detail to help our mutual customer gain a complete understanding of the subject's neighborhood such as neighborhood desirability, amenities, parks, schools, commercial or industrial influences, REO activity, traffic, board-up-homes, etc.
5. Do not approach occupants or owners.
6. If the subject is a Commercial property, contact Clear Capital immediately at 530-582-5011 for direction on how to proceed with the report.
7. Please do not accept if you or your office has completed a report on this property in the last month, are currently listing this property, or have any vested interest in the subject property.
8. Clear Capital does not allow any log ins from IP addresses from foreign countries. This includes, but is not limited to; data entry services, form completion services, etc. Also, it is against Clear Capital code of conduct to share your password with anyone who is not a W2 employee in your office.
9. Clear Capital and our mutual customers greatly appreciate your expertise. If you cannot

Report Instructions - cont.

personally inspect the property, select comparables, and determine a price for the subject, please do not accept this report. Per the standards and guidelines adopted by Clear Capital and other industry leaders, the use of assistants to complete any of the aforementioned tasks is not permitted.

Due to the importance of an independent opinion of price, please do not discuss your price with anyone or be influenced by list price, pending offers, accept comp packets, repair estimates or the listing agent's opinion.

1. One current, original photo of the front of the subject 2. One address verification photo 3. One street scene photo looking down the street 4. MLS listing and sold comp photos required, please comment if no MLS.

Broker Information

Broker Name	Mary Travis	Company/Brokerage	Fathom Realty
License No	0371292	Address	7112 Chase Oaks Blvd Plano TX 75025
License Expiration	08/31/2025	License State	TX
Phone	2147898935	Email	travishomes4sale@hotmail.com
Broker Distance to Subject	2.24 miles	Date Signed	03/13/2024

By confirming the above contact and real estate license information and submitting the report, the above signed hereby certifies and agrees that: 1) I personally took the pictures, selected comparables, and determined the price conclusion. 2) To the best of my knowledge, the statements of fact contained in this report are true and correct. 3) The reported analyses, opinions, and conclusions are my personal, impartial, and unbiased professional analyses, opinions, and conclusions. 4) I have no present or prospective interest in the property that is the subject of this report and no personal interest with respect to the parties involved. 5) I have no bias with respect to the property that is the subject of this report or to the parties involved with this assignment. 6) My compensation for completing this assignment is not contingent upon the development or reporting of a predetermined price point. 7) I did not base, either partially or completely, my analysis and/or opinion and conclusions in this report on race, color, religion, sex, age, marital status, handicap, familial status, or national origin of either the prospective owners or occupants of the subject property or of the present owners or occupants of the properties in the vicinity of the subject property or on any other basis prohibited by law. 8) I maintain errors and omissions insurance, to the extent required by state law, for all liability associated with the preparation of this Report.

Disclaimer

THIS REPORT SHOULD NOT BE CONSIDERED AN APPRAISAL. In making any decision that relies upon my work, you should know that I have not followed the guidelines for development of an appraisal or analysis contained in the Uniform Standards of Professional Appraisal Practice of the Appraisal Foundation.

Unless otherwise specifically agreed to in writing:

The intended purpose of this report is to assist the Clear Capital account holder in making decisions within the scope of applicable statutory and regulatory requirements and performing required due diligence. This document is provided solely for the use of the Clear Capital account holder and not any other party, is not intended as any guarantee of value and/or condition of the subject property and should not be relied on as such. In the event that this document is found to be defective, incorrect, negligently prepared or unfit for its authorized use, Clear Capital's sole liability shall be to promptly refund the total fee expended by the account holder for this report or to replace it at no charge to the account holder, but in no event shall Clear Capital be responsible to the account holder for any indirect or consequential damages whatsoever. This warranty is in lieu of all other warranties, express or implied, except where otherwise required by law. The account holder shall notify Clear Capital within thirty (30) days of this report's delivery to the account holder if it believes that this document is defective, incorrect, negligently prepared or unfit for its authorized use. Under no circumstances may Clear Capital forms or their contents be published, copied, replicated, or mimicked.