

Please Note: This report was completed with the following assumptions: Market Approach: **Fair Market Price** , Marketing Time: **Typical** . Important additional information relating to this report, including use and restrictions, is contained in an attached addendum which is an integral part of this report.

<b>Address</b>	15123 Melissa Lane, Surprise, ARIZONA 85374	<b>Order ID</b>	9359666	<b>Property ID</b>	35450587
<b>Inspection Date</b>	05/23/2024	<b>Date of Report</b>	05/23/2024		
<b>Loan Number</b>	57493	<b>APN</b>	23236127		
<b>Borrower Name</b>	Catamount Properties 2018 LLC	<b>County</b>	Maricopa		

<b>Tracking IDs</b>					
<b>Order Tracking ID</b>	5.22_BPO	<b>Tracking ID 1</b>	5.22_BPO		
<b>Tracking ID 2</b>	--	<b>Tracking ID 3</b>	--		

## General Conditions

<b>Owner</b>	SANTIAGO J CARRILLO	<b>Condition Comments</b>	
<b>R. E. Taxes</b>	\$1,127	Subject home appears to be in good condition, no visible repairs are evident from an exterior viewing. Home conforms to the neighborhood and has good curb appeal.	
<b>Assessed Value</b>	\$35,010		
<b>Zoning Classification</b>	Residential PAD		
<b>Property Type</b>	SFR		
<b>Occupancy</b>	Occupied		
<b>Ownership Type</b>	Fee Simple		
<b>Property Condition</b>	Average		
<b>Estimated Exterior Repair Cost</b>			
<b>Estimated Interior Repair Cost</b>			
<b>Total Estimated Repair</b>			
<b>HOA</b>	Kingswood Parke 623-873-4300		
<b>Association Fees</b>	\$125 / Quarter (Other: Common area maintenance)		
<b>Visible From Street</b>	Visible		
<b>Road Type</b>	Public		

## Neighborhood & Market Data

<b>Location Type</b>	Urban	<b>Neighborhood Comments</b>	
<b>Local Economy</b>	Stable	Established neighborhood consisting of both single story and 2 story homes. Average home size in this area is 1801 sq ft and most homes were built in the mid to late 1990's. Neighborhood is located less than 1 mile from shopping, restaurants, schools, and major roadways. Market values in this area are steady as supply increases and demand decreases. Most active and sold listings are traditional sales, however short sales and foreclosures do still exist. Most homes are selling in under 90 days and in most cases seller's are paying no concessions.	
<b>Sales Prices in this Neighborhood</b>	Low: \$309800 High: \$435720		
<b>Market for this type of property</b>	Remained Stable for the past 6 months.		
<b>Normal Marketing Days</b>	<90		

### Current Listings

	Subject	Listing 1 *	Listing 2	Listing 3
<b>Street Address</b>	15123 Melissa Lane	14993 W Heritage Oak Way	14715 W Willow Ln	15337 W Honeysuckle Ln
<b>City, State</b>	Surprise, ARIZONA	Surprise, AZ	Surprise, AZ	Surprise, AZ
<b>Zip Code</b>	85374	85374	85374	85374
<b>Datasource</b>	Tax Records	MLS	MLS	MLS
<b>Miles to Subj.</b>	--	0.43 <sup>1</sup>	0.67 <sup>1</sup>	0.26 <sup>1</sup>
<b>Property Type</b>	SFR	SFR	SFR	SFR
<b>Original List Price \$</b>	\$	\$399,000	\$417,000	\$435,000
<b>List Price \$</b>	--	\$399,000	\$417,000	\$420,000
<b>Original List Date</b>		04/27/2024	05/17/2024	02/22/2024
<b>DOM · Cumulative DOM</b>	-- · --	26 · 26	6 · 6	90 · 91
<b>Age (# of years)</b>	26	35	28	27
<b>Condition</b>	Average	Average	Average	Average
<b>Sales Type</b>	--	Fair Market Value	Fair Market Value	Fair Market Value
<b>Location</b>	Neutral ; Residential	Neutral ; Residential	Neutral ; Residential	Neutral ; Residential
<b>View</b>	Neutral ; Residential	Neutral ; Residential	Neutral ; Residential	Neutral ; Residential
<b>Style/Design</b>	1 Story Ranch	1 Story Ranch	1 Story Ranch	1 Story Ranch
<b># Units</b>	1	1	1	1
<b>Living Sq. Feet</b>	1,667	1,487	1,702	1,670
<b>Bdrm · Bths · ½ Bths</b>	3 · 2	3 · 2	3 · 2	3 · 2
<b>Total Room #</b>	6	6	6	6
<b>Garage (Style/Stalls)</b>	Attached 2 Car(s)	Attached 2 Car(s)	Attached 2 Car(s)	Attached 2 Car(s)
<b>Basement (Yes/No)</b>	No	No	No	No
<b>Basement (% Fin)</b>	0%	0%	0%	0%
<b>Basement Sq. Ft.</b>	--	--	--	--
<b>Pool/Spa</b>	--	--	--	Pool - Yes
<b>Lot Size</b>	0.12 acres	0.10 acres	0.14 acres	0.15 acres
<b>Other</b>	--	--	--	--

\* Listing 1 is the most comparable listing to the subject.

<sup>1</sup> Comp's "Miles to Subject" was calculated by the system.

<sup>2</sup> Comp's "Miles to Subject" provided by Real Estate Professional.

<sup>3</sup> Subject \$/ft based upon as-is sale price.

**Listing Comments** Why the comparable listing is superior or inferior to the subject.

**Listing 1** Similar size, style, model, equal location, same number of bedrooms and baths, equal interior and exterior amenities, new flooring, new fixtures, sold with all appliances, equal age and slightly smaller lot size, equal to subject home

**Listing 2** Similar size, style, model, equal location, same number of bedrooms and baths, equal interior and exterior amenities, new carpet, sold with all appliances, equal age and slightly larger lot size, equal to subject home

**Listing 3** Similar size, style, model, equal location, same number of bedrooms and baths, equal interior amenities, comp has private pool, sold with all appliances, newer interior paint, equal age and slightly larger lot size, equal to subject home

### Recent Sales

	Subject	Sold 1	Sold 2 *	Sold 3
<b>Street Address</b>	15123 Melissa Lane	14931 W Evening Star Trl	17412 N Cassi Dr	14707 W Ashley Ct
<b>City, State</b>	Surprise, ARIZONA	Surprise, AZ	Surprise, AZ	Surprise, AZ
<b>Zip Code</b>	85374	85374	85374	85374
<b>Datasource</b>	Tax Records	MLS	MLS	MLS
<b>Miles to Subj.</b>	--	0.29 <sup>1</sup>	0.29 <sup>1</sup>	0.56 <sup>1</sup>
<b>Property Type</b>	SFR	SFR	SFR	SFR
<b>Original List Price \$</b>	--	\$420,000	\$410,000	\$450,000
<b>List Price \$</b>	--	\$410,000	\$410,000	\$439,000
<b>Sale Price \$</b>	--	\$400,000	\$405,000	\$439,000
<b>Type of Financing</b>	--	Conventional	Fha	Conventional
<b>Date of Sale</b>	--	03/08/2024	01/19/2024	02/28/2024
<b>DOM · Cumulative DOM</b>	-- · --	51 · 53	6 · 35	66 · 110
<b>Age (# of years)</b>	26	26	27	28
<b>Condition</b>	Average	Average	Average	Average
<b>Sales Type</b>	--	Fair Market Value	Fair Market Value	Fair Market Value
<b>Location</b>	Neutral ; Residential	Neutral ; Residential	Neutral ; Residential	Neutral ; Residential
<b>View</b>	Neutral ; Residential	Neutral ; Residential	Neutral ; Residential	Neutral ; Residential
<b>Style/Design</b>	1 Story Ranch	1 Story Ranch	1 Story Ranch	1 Story Ranch
<b># Units</b>	1	1	1	1
<b>Living Sq. Feet</b>	1,667	1,533	1,611	1,710
<b>Bdrm · Bths · ½ Bths</b>	3 · 2	3 · 2	4 · 2	4 · 2
<b>Total Room #</b>	6	6	6	6
<b>Garage (Style/Stalls)</b>	Attached 2 Car(s)	Attached 2 Car(s)	Attached 2 Car(s)	Attached 2 Car(s)
<b>Basement (Yes/No)</b>	No	No	No	No
<b>Basement (% Fin)</b>	0%	0%	0%	0%
<b>Basement Sq. Ft.</b>	--	--	--	--
<b>Pool/Spa</b>	--	Pool - Yes	--	Pool - Yes
<b>Lot Size</b>	0.12 acres	0.14 acres	0.21 acres	0.16 acres
<b>Other</b>	--	--	--	--
<b>Net Adjustment</b>	--	-\$8,510	-\$3,900	-\$9,425
<b>Adjusted Price</b>	--	\$391,490	\$401,100	\$429,575

\* Sold 2 is the most comparable sale to the subject.

<sup>1</sup> Comp's "Miles to Subject" was calculated by the system.

<sup>2</sup> Comp's "Miles to Subject" provided by Real Estate Professional.

<sup>3</sup> Subject \$/ft based upon as-is sale price.

## Recent Sales - Cont.

**Reasons for Adjustments** Why the comparable sale is superior or inferior to the subject.

- Sold 1** Similar size, style, model, equal location, same number of bedrooms and baths, equal interior amenities, comp has private pool (-7500), sold with all appliances, equal age and slightly larger lot size (-1010), equal to subject home
- Sold 2** Similar size, style, model, equal location, one additional bedroom, same number of baths, equal interior and exterior amenities, new interior paint, new flooring, equal age and larger lot size (-3900), equal to subject home
- Sold 3** Similar size, style, model, equal location, one additional bedroom, same number of baths, equal interior amenities, comp has private pool (-7500), sold with appliances, owned solar, new flooring, updated roof, equal age and slightly larger lot size (-1925), equal to subject home

## Subject Sales & Listing History

<b>Current Listing Status</b>	Not Currently Listed		<b>Listing History Comments</b>				
<b>Listing Agency/Firm</b>			HOMe last sold in 2018 for \$214000				
<b>Listing Agent Name</b>							
<b>Listing Agent Phone</b>							
<b># of Removed Listings in Previous 12 Months</b>	0						
<b># of Sales in Previous 12 Months</b>	0						
<b>Original List Date</b>	<b>Original List Price</b>	<b>Final List Date</b>	<b>Final List Price</b>	<b>Result</b>	<b>Result Date</b>	<b>Result Price</b>	<b>Source</b>

## Marketing Strategy

	<b>As Is Price</b>	<b>Repaired Price</b>
<b>Suggested List Price</b>	\$401,900	\$401,900
<b>Sales Price</b>	\$401,900	\$401,900
<b>30 Day Price</b>	\$399,900	--
<b>Comments Regarding Pricing Strategy</b>		
Price subject home in the mid range of comps. Most homes are selling at or near original list price and in most cases seller's are paying some concessions. Most homes are selling in under 90 days.		

## Clear Capital Quality Assurance Comments Addendum

<b>Reviewer's Notes</b>	The broker's as-is conclusion reflects the market for the subject. Comps are within a reasonable distance, relatively current, and accurately reflect the subject's defining characteristics. Thus, the as-is conclusion appears to be adequately supported.
-------------------------	--

## Subject Photos



Front



Address Verification



Street



Street

## Listing Photos

**L1** 14993 W HEritage Oak Way  
Surprise, AZ 85374



Front

**L2** 14715 W Willow Ln  
Surprise, AZ 85374



Front

**L3** 15337 W Honeysuckle Ln  
Surprise, AZ 85374



Front



## Sales Photos

**S1** 14931 W Evening Star Trl  
Surprise, AZ 85374



Front

**S2** 17412 N Cassi Dr  
Surprise, AZ 85374

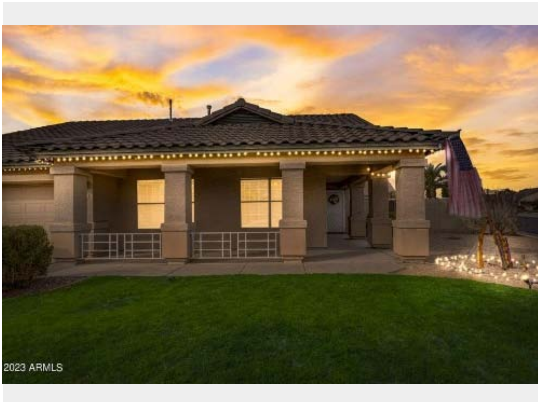

Front

**S3** 14707 W Ashley Ct  
Surprise, AZ 85374



Front



### ClearMaps Addendum

**Address** ★ 15123 Melissa Lane, Surprise, ARIZONA 85374

**Loan Number** 57493

**Suggested List** \$401,900

**Suggested Repaired** \$401,900

**Sale** \$401,900

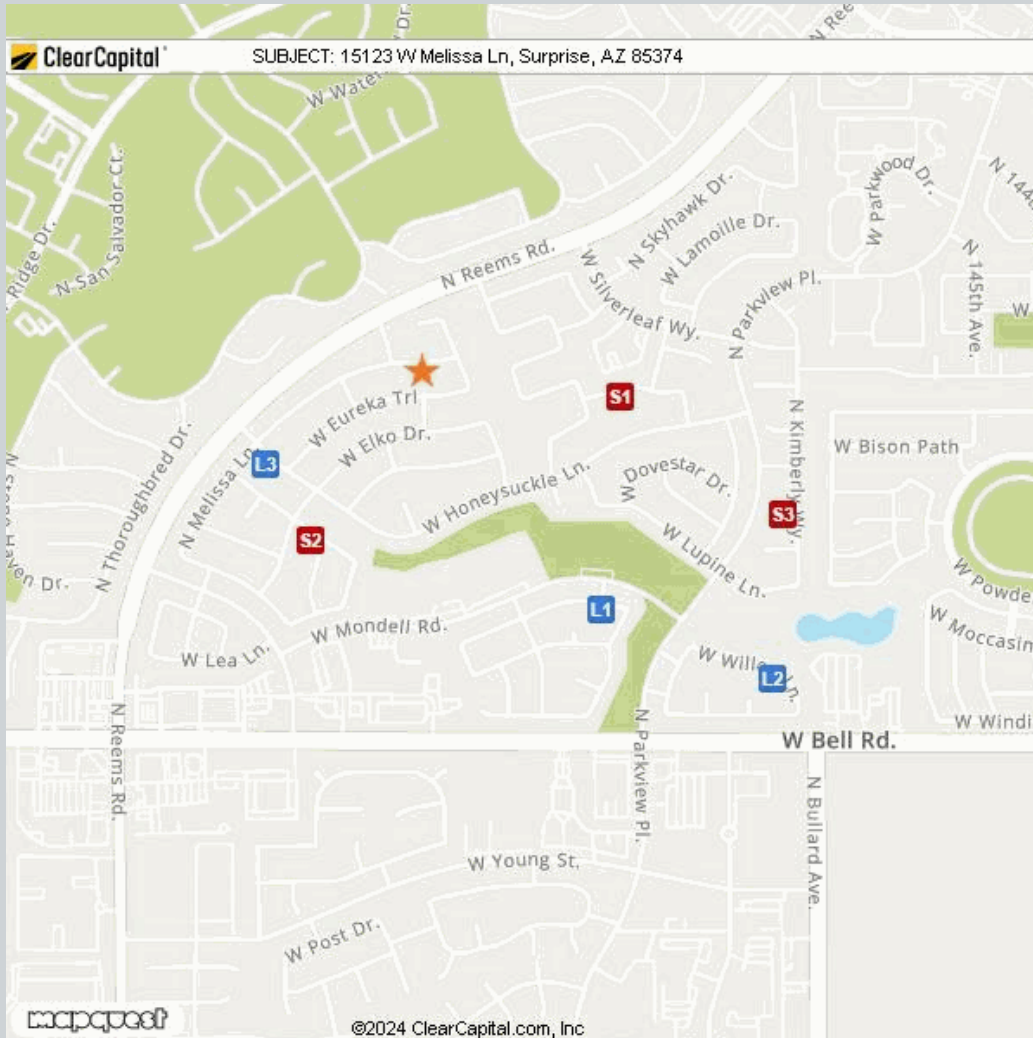

Comparable	Address	Miles to Subject	Mapping Accuracy
★ Subject	15123 Melissa Lane, Surprise, Arizona 85374	--	Parcel Match
L1 Listing 1	14993 W Heritage Oak Way, Surprise, AZ 85374	0.43 Miles <sup>1</sup>	Parcel Match
L2 Listing 2	14715 W Willow Ln, Surprise, AZ 85374	0.67 Miles <sup>1</sup>	Parcel Match
L3 Listing 3	15337 W Honeysuckle Ln, Surprise, AZ 85374	0.26 Miles <sup>1</sup>	Parcel Match
S1 Sold 1	14931 W Evening Star Trl, Surprise, AZ 85374	0.29 Miles <sup>1</sup>	Parcel Match
S2 Sold 2	17412 N Cassi Dr, Surprise, AZ 85374	0.29 Miles <sup>1</sup>	Parcel Match
S3 Sold 3	14707 W Ashley Ct, Surprise, AZ 85374	0.56 Miles <sup>1</sup>	Parcel Match

<sup>1</sup> The Comparable "Distance from Subject" value has been calculated by the Clear Capital system.

<sup>2</sup> The Comparable "Distance from Subject" value has been provided by the Real Estate Professional.

## Addendum: Report Purpose

### Market Approach and Market Time

The Market Approach of this report, as established by the customer, is: **Fair Market Price**. (See definition below.)

The Marketing Time as specified by the customer is **Typical**. (See definition below.)

Definitions:

Fair Market Price

A price at which the property would sell between a willing buyer and a willing seller neither being compelled by undue pressure and both having reasonable knowledge of relevant facts.

Distressed Price

A price at which the property would sell between a willing buyer and a seller acting under duress.

Marketing Time

The amount of time the property is exposed to a pool of prospective buyers before going into contract. The customer either specifies the number of days, requests a marketing time that is typical to the subject's market area and/or requests an abbreviated marketing time.

Typical for Local Market

The estimated time required to adequately expose the subject property to the market resulting in a contract of sale.

## Addendum: Report Purpose - cont.

**Report Instructions**

This section shows the instructions that were approved by the customer and provided to the broker prior to completing the report.

Instructions last updated: 7/17/2017

Purpose:

Please determine a fair market price for this property at which it would sell in a typical marketing time for the area.

Customer Specific Requests:

\*\*If the property is commercial or mixed use, please stop and contact Clear Capital as soon as possible\*\*

Form Help:

There are blue question marks (?) throughout this form. These are designed to offer guidance for that particular section of the form. Please click on them for help.

Comparable Requirements:

1. Please use fair market comps from the same neighborhood, block or subdivision whenever possible.
2. Please only use REO comparables if the market is driven by REOs and they are comparable in characteristics and condition.
3. Please use comps that have closed in the past 3 months to show the current market conditions or comment in the report if this is not possible. In rapidly changing markets, active listing comps should be given equal or greater weight than sold comps in your analysis.

Standard Instructions:

1. Clear Capital Code Of Conduct - Please make sure that you are always abiding by the Clear Capital Code of Conduct when completing valuation reports.
2. If the subject is currently listed, please consider all available information pertaining to the subject's condition. This information should be utilized when developing the assumption of the subject's condition.
3. Use the subject characteristics provided in the report Grid (if preloaded) to evaluate the property. This information is from a full interior appraisal and is assumed to be most accurate. If your inspection reveals obvious inaccuracies, please explain in the narrative of the report.
4. Include sufficient detail to help our mutual customer gain a complete understanding of the subject's neighborhood such as neighborhood desirability, amenities, parks, schools, commercial or industrial influences, REO activity, traffic, board-up-homes, etc.
5. Do not approach occupants or owners.
6. If the subject is a Commercial property, contact Clear Capital immediately at 530-582-5011 for direction on how to proceed with the report.
7. Please do not accept if you or your office has completed a report on this property in the last month, are currently listing this property, or have any vested interest in the subject property.
8. Clear Capital does not allow any log ins from IP addresses from foreign countries. This includes, but is not limited to; data entry services, form completion services, etc. Also, it is against Clear Capital code of conduct to share your password with anyone who is not a W2 employee in your office.
9. Clear Capital and our mutual customers greatly appreciate your expertise. If you cannot personally inspect the property, select comparables, and determine a price for the subject, please do not accept this report. Per the standards and guidelines adopted by Clear Capital and other industry leaders, the use of assistants to complete any of the aforementioned tasks is not permitted.

## Report Instructions - cont.

Due to the importance of an independent opinion of price, please do not discuss your price with anyone or be influenced by list price, pending offers, accept comp packets, repair estimates or the listing agent's opinion.

1. One current, original photo of the front of the subject 2. One address verification photo 3. One street scene photo looking down the street 4. MLS listing and sold comp photos required, please comment if no MLS.

## Broker Information

<b>Broker Name</b>	Jennifer Dewaele	<b>Company/Brokerage</b>	Pro-Formance Realty Concepts
<b>License No</b>	SA627850000	<b>Address</b>	19405 W Echo Ln Waddell AZ 85355
<b>License Expiration</b>	06/30/2026	<b>License State</b>	AZ
<b>Phone</b>	6239107905	<b>Email</b>	jcdewaele3@yahoo.com
<b>Broker Distance to Subject</b>	8.04 miles	<b>Date Signed</b>	05/23/2024

*By confirming the above contact and real estate license information and submitting the report, the above signed hereby certifies and agrees that: 1) I personally took the pictures, selected comparables, and determined the price conclusion. 2) To the best of my knowledge, the statements of fact contained in this report are true and correct. 3) The reported analyses, opinions, and conclusions are my personal, impartial, and unbiased professional analyses, opinions, and conclusions. 4) I have no present or prospective interest in the property that is the subject of this report and no personal interest with respect to the parties involved. 5) I have no bias with respect to the property that is the subject of this report or to the parties involved with this assignment. 6) My compensation for completing this assignment is not contingent upon the development or reporting of a predetermined price point. 7) I did not base, either partially or completely, my analysis and/or opinion and conclusions in this report on race, color, religion, sex, age, marital status, handicap, familial status, or national origin of either the prospective owners or occupants of the subject property or of the present owners or occupants of the properties in the vicinity of the subject property or on any other basis prohibited by law. 8) I maintain errors and omissions insurance, to the extent required by state law, for all liability associated with the preparation of this Report.*

## Disclaimer

**This document is not an appraisal as defined by USPAP (Uniform Standards of Professional Appraisal Practice). It is not to be construed as an appraisal and may not be used as such for any purpose.**

**Unless otherwise specifically agreed to in writing:**

**The intended purpose of this report is to assist the Clear Capital account holder in making decisions within the scope of applicable statutory and regulatory requirements and performing required due diligence. This document is provided solely for the use of the Clear Capital account holder and not any other party, is not intended as any guarantee of value and/or condition of the subject property and should not be relied on as such. In the event that this document is found to be defective, incorrect, negligently prepared or unfit for its authorized use, Clear Capital's sole liability shall be to promptly refund the total fee expended by the account holder for this report or to replace it at no charge to the account holder, but in no event shall Clear Capital be responsible to the account holder for any indirect or consequential damages whatsoever. This warranty is in lieu of all other warranties, express or implied, except where otherwise required by law. The account holder shall notify Clear Capital within thirty (30) days of this report's delivery to the account holder if it believes that this document is defective, incorrect, negligently prepared or unfit for its authorized use. Under no circumstances may Clear Capital forms or their contents be published, copied, replicated, or mimicked.**