

Please Note: This report was completed with the following assumptions: Market Approach: **Fair Market Price** , Marketing Time: **Typical** . Important additional information relating to this report, including use and restrictions, is contained in an attached addendum which is an integral part of this report.

Address	18811 W Palo Verde Drive, Litchfield Park, ARIZONA 85340	Order ID	9500856	Property ID	35729292
Inspection Date	07/26/2024	Date of Report	07/26/2024		
Loan Number	58086	APN	502-32-051		
Borrower Name	Catamount Properties 2018 LLC	County	Maricopa		

Tracking IDs					
Order Tracking ID	7.24_bpo	Tracking ID 1	7.24_bpo		
Tracking ID 2	--	Tracking ID 3	--		

General Conditions		
Owner	JAMILA A CLAY	Condition Comments Subject home appears to be in good condition, no visible repairs are evident from an exterior viewing. Home conforms to the neighborhood and has good curb appeal.
R. E. Taxes	\$2,060	
Assessed Value	\$40,700	
Zoning Classification	Residential	
Property Type	SFR	
Occupancy	Occupied	
Ownership Type	Fee Simple	
Property Condition	Good	
Estimated Exterior Repair Cost		
Estimated Interior Repair Cost		
Total Estimated Repair		
HOA	Zanjero Trails 6022882653	
Association Fees	\$83 / Month (Other: Common area maintenance)	
Visible From Street	Visible	
Road Type	Public	

Neighborhood & Market Data		
Location Type	Urban	Neighborhood Comments Established neighborhood consisting of both single story and 2 story homes. Average home size in this area is 1975 sq ft and most homes were built in the early to late 2020's. Neighborhood is located less than 1 mile from shopping, restaurants, schools, and major roadways. Market values in this area are steady as supply increases and demand decreases. Most active and sold listings are traditional sales, however short sales and foreclosures do still exist. Most homes are selling on average around 90 days and in most cases seller's are paying some concessions.
Local Economy	Stable	
Sales Prices in this Neighborhood	Low: \$368389 High: \$954000	
Market for this type of property	Decreased 1 % in the past 6 months.	
Normal Marketing Days	<90	

Current Listings

	Subject	Listing 1	Listing 2 *	Listing 3
Street Address	18811 W Palo Verde Drive	18712 W Georgia Ave	19122 W Solano Dr	19005 W Rancho Dr
City, State	Litchfield Park, ARIZONA	Litchfield Park, AZ	Litchfield Park, AZ	Litchfield Park, AZ
Zip Code	85340	85340	85340	85340
Datasource	Tax Records	MLS	MLS	MLS
Miles to Subj.	--	0.48 ¹	0.42 ¹	0.21 ¹
Property Type	SFR	SFR	SFR	SFR
Original List Price \$	\$	\$500,000	\$475,000	\$550,000
List Price \$	--	\$475,000	\$475,000	\$495,000
Original List Date		03/17/2024	06/27/2024	04/10/2024
DOM · Cumulative DOM	-- · --	127 · 131	24 · 29	76 · 107
Age (# of years)	2	5	1	3
Condition	Good	Good	Good	Good
Sales Type	--	Fair Market Value	Fair Market Value	Fair Market Value
Location	Neutral ; Residential	Neutral ; Residential	Neutral ; Residential	Neutral ; Residential
View	Neutral ; Residential	Neutral ; Residential	Neutral ; Residential	Neutral ; Residential
Style/Design	1 Story Ranch	1 Story Ranch	1 Story Ranch	1 Story Ranch
# Units	1	1	1	1
Living Sq. Feet	1,933	2,140	1,942	2,227
Bdrm · Bths · ½ Bths	4 · 2 · 1	3 · 2 · 1	4 · 2 · 1	4 · 3
Total Room #	8	8	8	8
Garage (Style/Stalls)	Attached 2 Car(s)	Attached 2 Car(s)	Attached 2 Car(s)	Attached 2 Car(s)
Basement (Yes/No)	No	No	No	No
Basement (% Fin)	0%	0%	0%	0%
Basement Sq. Ft.	--	--	--	--
Pool/Spa	--	--	--	--
Lot Size	0.12 acres	0.18 acres	0.12 acres	0.16 acres
Other	--	--	--	--

* Listing 2 is the most comparable listing to the subject.

¹ Comp's "Miles to Subject" was calculated by the system.

² Comp's "Miles to Subject" provided by Real Estate Professional.

³ Subject \$/ft based upon as-is sale price.

Listing Comments Why the comparable listing is superior or inferior to the subject.

Listing 1 Similar size, style, model, equal location, one less bedroom, same number of baths, equal interior and exterior amenities, sold with all appliances, newer fixtures, equal age and slightly larger lot size, equal to subject home

Listing 2 Similar size, style, model, equal location, same number of bedrooms and baths, equal interior and exterior amenities, sold with all appliances, updated backyard landscaping, equal age and lot size, equal to subject home

Listing 3 Similar size, style, model, equal location, same number of bedrooms and one additional half bath, equal interior and exterior amenities, sold with all appliances, upgraded kitchen, equal age and slightly larger lot size, equal to subject home

Recent Sales

	Subject	Sold 1	Sold 2 *	Sold 3
Street Address	18811 W Palo Verde Drive	5805 N 192nd Ave	19221 W Solano Dr	5506 N 194th Ave
City, State	Litchfield Park, ARIZONA	Litchfield Park, AZ	Litchfield Park, AZ	Litchfield Park, AZ
Zip Code	85340	85340	85340	85340
Datasource	Tax Records	MLS	MLS	MLS
Miles to Subj.	--	0.47 ¹	0.52 ¹	0.87 ¹
Property Type	SFR	SFR	SFR	SFR
Original List Price \$	--	\$479,900	\$484,990	\$510,990
List Price \$	--	\$459,990	\$484,990	\$510,990
Sale Price \$	--	\$465,000	\$475,000	\$505,000
Type of Financing	--	Fha	Fha	Conventional
Date of Sale	--	02/29/2024	03/28/2024	02/29/2024
DOM · Cumulative DOM	-- · --	89 · 182	10 · 160	22 · 83
Age (# of years)	2	1	1	1
Condition	Good	Good	Good	Good
Sales Type	--	Fair Market Value	Fair Market Value	Fair Market Value
Location	Neutral ; Residential	Neutral ; Residential	Neutral ; Residential	Neutral ; Residential
View	Neutral ; Residential	Neutral ; Residential	Neutral ; Residential	Neutral ; Residential
Style/Design	1 Story Ranch	1 Story Ranch	1 Story Ranch	1 Story Ranch
# Units	1	1	1	1
Living Sq. Feet	1,933	1,943	1,943	1,897
Bdrm · Bths · ½ Bths	4 · 2 · 1	4 · 2 · 1	4 · 2 · 1	3 · 2
Total Room #	8	8	8	7
Garage (Style/Stalls)	Attached 2 Car(s)	Attached 2 Car(s)	Attached 2 Car(s)	Attached 2 Car(s)
Basement (Yes/No)	No	No	No	No
Basement (% Fin)	0%	0%	0%	0%
Basement Sq. Ft.	--	--	--	--
Pool/Spa	--	--	--	--
Lot Size	0.12 acres	0.12 acres	0.12 acres	0.16 acres
Other	--	--	--	--
Net Adjustment	--	\$0	\$0	+\$800
Adjusted Price	--	\$465,000	\$475,000	\$505,800

* Sold 2 is the most comparable sale to the subject.

¹ Comp's "Miles to Subject" was calculated by the system.

² Comp's "Miles to Subject" provided by Real Estate Professional.

³ Subject \$/ft based upon as-is sale price.

Recent Sales - Cont.

Reasons for Adjustments Why the comparable sale is superior or inferior to the subject.

- Sold 1** Similar size, style, model, equal location, same number of bedrooms and baths, equal interior and exterior amenities, sold with all appliances, new build, equal age and lot size, equal to subject home
- Sold 2** Similar size, style, model, equal location, same number of bedrooms and baths, equal interior and exterior amenities, sold with all appliances, former model home, upgraded flooring, fully landscaped backyard, equal age and lot size, equal to subject home
- Sold 3** Similar size, style, model, equal location, same number of bedrooms and one less half bath (+2500), equal interior and exterior amenities, sold with all appliances, gourmet kitchen full of upgrades, upgraded flooring, equal age and slightly larger lot size (-1700), equal to subject home

Subject Sales & Listing History

Current Listing Status	Not Currently Listed			Listing History Comments			
Listing Agency/Firm				Home last sold in 2022 for \$422095			
Listing Agent Name							
Listing Agent Phone							
# of Removed Listings in Previous 12 Months	0						
# of Sales in Previous 12 Months	0						
Original List Date	Original List Price	Final List Date	Final List Price	Result	Result Date	Result Price	Source

Marketing Strategy

	As Is Price	Repaired Price
Suggested List Price	\$480,000	\$480,000
Sales Price	\$480,000	\$480,000
30 Day Price	\$475,000	--
Comments Regarding Pricing Strategy		
Price subject home in the mid range of comps. Most homes are selling at or near original list price and in most cases seller's are paying some concessions. Most homes are selling in under 90 days.		

Clear Capital Quality Assurance Comments Addendum

Reviewer's Notes	The broker's as-is conclusion reflects the market for the subject. Comps are within a reasonable distance, relatively current, and accurately reflect the subject's defining characteristics. Thus, the as-is conclusion appears to be adequately supported.
-------------------------	--

Subject Photos



Front



Address Verification



Street



Street

Listing Photos

L1 18712 W Georgia Ave
Litchfield Park, AZ 85340



Front

L2 19122 W Solano Dr
Litchfield Park, AZ 85340



Front

L3 19005 W Rancho Dr
Litchfield Park, AZ 85340



Front

Sales Photos

S1 5805 N 192nd Ave
Litchfield Park, AZ 85340



Front

S2 19221 W Solano Dr
Litchfield Park, AZ 85340



Front

S3 5506 N 194th ave
Litchfield Park, AZ 85340



Front

ClearMaps Addendum

Address ★ 18811 W Palo Verde Drive, Litchfield Park, ARIZONA 85340

Loan Number 58086

Suggested List \$480,000

Suggested Repaired \$480,000

Sale \$480,000

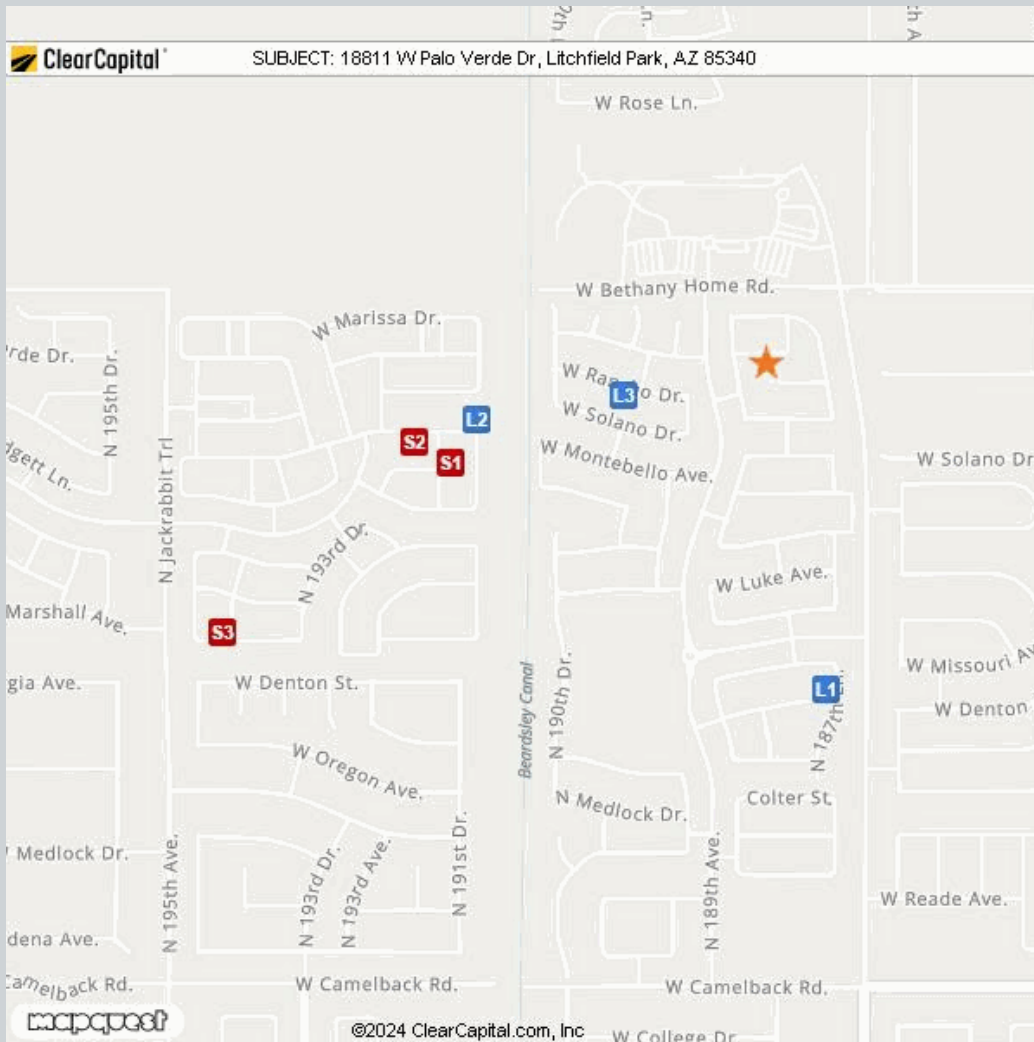

Comparable	Address	Miles to Subject	Mapping Accuracy
★ Subject	18811 W Palo Verde Drive, Litchfield Park, Arizona 85340	--	Parcel Match
L1 Listing 1	18712 W Georgia Ave, Litchfield Park, AZ 85340	0.48 Miles ¹	Parcel Match
L2 Listing 2	19122 W Solano Dr, Litchfield Park, AZ 85340	0.42 Miles ¹	Parcel Match
L3 Listing 3	19005 W Rancho Dr, Litchfield Park, AZ 85340	0.21 Miles ¹	Parcel Match
S1 Sold 1	5805 N 192nd Ave, Litchfield Park, AZ 85340	0.47 Miles ¹	Parcel Match
S2 Sold 2	19221 W Solano Dr, Litchfield Park, AZ 85340	0.52 Miles ¹	Parcel Match
S3 Sold 3	5506 N 194th Ave, Litchfield Park, AZ 85340	0.87 Miles ¹	Parcel Match

¹ The Comparable "Distance from Subject" value has been calculated by the Clear Capital system.

² The Comparable "Distance from Subject" value has been provided by the Real Estate Professional.

Addendum: Report Purpose

Market Approach and Market Time

The Market Approach of this report, as established by the customer, is: **Fair Market Price**. (See definition below.)

The Marketing Time as specified by the customer is **Typical**. (See definition below.)

Definitions:

Fair Market Price	A price at which the property would sell between a willing buyer and a willing seller neither being compelled by undue pressure and both having reasonable knowledge of relevant facts.
Distressed Price	A price at which the property would sell between a willing buyer and a seller acting under duress.
Marketing Time	The amount of time the property is exposed to a pool of prospective buyers before going into contract. The customer either specifies the number of days, requests a marketing time that is typical to the subject's market area and/or requests an abbreviated marketing time.
Typical for Local Market	The estimated time required to adequately expose the subject property to the market resulting in a contract of sale.

Addendum: Report Purpose - cont.

Report Instructions

This section shows the instructions that were approved by the customer and provided to the broker prior to completing the report.

Instructions last updated: 7/17/2017

Purpose:

Please determine a fair market price for this property at which it would sell in a typical marketing time for the area.

Customer Specific Requests:

If the property is commercial or mixed use, please stop and contact Clear Capital as soon as possible

Form Help:

There are blue question marks (?) throughout this form. These are designed to offer guidance for that particular section of the form. Please click on them for help.

Comparable Requirements:

1. Please use fair market comps from the same neighborhood, block or subdivision whenever possible.
2. Please only use REO comparables if the market is driven by REOs and they are comparable in characteristics and condition.
3. Please use comps that have closed in the past 3 months to show the current market conditions or comment in the report if this is not possible. In rapidly changing markets, active listing comps should be given equal or greater weight than sold comps in your analysis.

Standard Instructions:

1. Clear Capital Code Of Conduct - Please make sure that you are always abiding by the Clear Capital Code of Conduct when completing valuation reports.
2. If the subject is currently listed, please consider all available information pertaining to the subject's condition. This information should be utilized when developing the assumption of the subject's condition.
3. Use the subject characteristics provided in the report Grid (if preloaded) to evaluate the property. This information is from a full interior appraisal and is assumed to be most accurate. If your inspection reveals obvious inaccuracies, please explain in the narrative of the report.
4. Include sufficient detail to help our mutual customer gain a complete understanding of the subject's neighborhood such as neighborhood desirability, amenities, parks, schools, commercial or industrial influences, REO activity, traffic, board-up-homes, etc.
5. Do not approach occupants or owners.
6. If the subject is a Commercial property, contact Clear Capital immediately at 530-582-5011 for direction on how to proceed with the report.
7. Please do not accept if you or your office has completed a report on this property in the last month, are currently listing this property, or have any vested interest in the subject property.
8. Clear Capital does not allow any log ins from IP addresses from foreign countries. This includes, but is not limited to; data entry services, form completion services, etc. Also, it is against Clear Capital code of conduct to share your password with anyone who is not a W2 employee in your office.
9. Clear Capital and our mutual customers greatly appreciate your expertise. If you cannot personally inspect the property, select comparables, and determine a price for the subject, please do not accept this report. Per the standards and guidelines adopted by Clear Capital and other industry leaders, the use of assistants to complete any of the aforementioned tasks is not permitted.

Report Instructions - cont.

Due to the importance of an independent opinion of price, please do not discuss your price with anyone or be influenced by list price, pending offers, accept comp packets, repair estimates or the listing agent's opinion.

1. One current, original photo of the front of the subject 2. One address verification photo 3. One street scene photo looking down the street 4. MLS listing and sold comp photos required, please comment if no MLS.

Broker Information

Broker Name	Jennifer Dewaele	Company/Brokerage	Pro-Formance Realty Concepts
License No	SA627850000	Address	19405 W Echo Ln Waddell AZ 85355
License Expiration	06/30/2026	License State	AZ
Phone	6239107905	Email	jcdewaele3@yahoo.com
Broker Distance to Subject	2.64 miles	Date Signed	07/26/2024

By confirming the above contact and real estate license information and submitting the report, the above signed hereby certifies and agrees that: 1) I personally took the pictures, selected comparables, and determined the price conclusion. 2) To the best of my knowledge, the statements of fact contained in this report are true and correct. 3) The reported analyses, opinions, and conclusions are my personal, impartial, and unbiased professional analyses, opinions, and conclusions. 4) I have no present or prospective interest in the property that is the subject of this report and no personal interest with respect to the parties involved. 5) I have no bias with respect to the property that is the subject of this report or to the parties involved with this assignment. 6) My compensation for completing this assignment is not contingent upon the development or reporting of a predetermined price point. 7) I did not base, either partially or completely, my analysis and/or opinion and conclusions in this report on race, color, religion, sex, age, marital status, handicap, familial status, or national origin of either the prospective owners or occupants of the subject property or of the present owners or occupants of the properties in the vicinity of the subject property or on any other basis prohibited by law. 8) I maintain errors and omissions insurance, to the extent required by state law, for all liability associated with the preparation of this Report.

Disclaimer

This document is not an appraisal as defined by USPAP (Uniform Standards of Professional Appraisal Practice). It is not to be construed as an appraisal and may not be used as such for any purpose.

Unless otherwise specifically agreed to in writing:

The intended purpose of this report is to assist the Clear Capital account holder in making decisions within the scope of applicable statutory and regulatory requirements and performing required due diligence. This document is provided solely for the use of the Clear Capital account holder and not any other party, is not intended as any guarantee of value and/or condition of the subject property and should not be relied on as such. In the event that this document is found to be defective, incorrect, negligently prepared or unfit for its authorized use, Clear Capital's sole liability shall be to promptly refund the total fee expended by the account holder for this report or to replace it at no charge to the account holder, but in no event shall Clear Capital be responsible to the account holder for any indirect or consequential damages whatsoever. This warranty is in lieu of all other warranties, express or implied, except where otherwise required by law. The account holder shall notify Clear Capital within thirty (30) days of this report's delivery to the account holder if it believes that this document is defective, incorrect, negligently prepared or unfit for its authorized use. Under no circumstances may Clear Capital forms or their contents be published, copied, replicated, or mimicked.