

Please Note: This report was completed with the following assumptions: Market Approach: **Fair Market Price** , Marketing Time: **Typical** . Important additional information relating to this report, including use and restrictions, is contained in an attached addendum which is an integral part of this report.

Address	5588 Vision Quest Court, Las Vegas, NEVADA 89139	Order ID	9566097	Property ID	35864945
Inspection Date	08/22/2024	Date of Report	08/22/2024		
Loan Number	58229	APN	176-12-111-084		
Borrower Name	WH1 LLC	County	Clark		

Tracking IDs					
Order Tracking ID	8.21_BPO 2	Tracking ID 1	8.21_BPO 2		
Tracking ID 2	--	Tracking ID 3	--		

General Conditions		Condition Comments
Owner	SON BAC TRAN	No damage or repair issues noted. Doors, windows, roof, paint, landscaping, appear to be in average condition for age and neighborhood. Clark County Tax Assessor data shows Cost Class for this property as Fair. Subject property is a 2 story, single family detached home with 2 car attached garage with entry into house. Roof is pitched concrete tile, typical for age and area. It has no pool or spa. Last sold by Quit Claim Deed 10/17/2013 for \$1,087, and not listed for sale since purchased. This property is located in the Promise Two subdivision in the southwestern area of Las Vegas. This tract is comprised of 77 single family detached homes which vary in square footage from 1,527-1,855 square feet. Access to schools, shopping is within 1/2-1 mile and freeway entry is within 1-2 miles. Most likely buyer is owner occupant with conventional financing.
R. E. Taxes	\$2,395	
Assessed Value	\$107,545	
Zoning Classification	Residential	
Property Type	SFR	
Occupancy	Vacant	
Secure?	Yes (Secured by dead bolt)	
Ownership Type	Fee Simple	
Property Condition	Average	
Estimated Exterior Repair Cost		
Estimated Interior Repair Cost		
Total Estimated Repair		
HOA	Paseo at Coronado 702-737-8580	
Association Fees	\$220 / Year (Other: Management and CC&Rs)	
Visible From Street	Visible	
Road Type	Public	

Neighborhood & Market Data		Neighborhood Comments
Location Type	Suburban	There is a shortage of competing listings within a 1/2 mile radius of subject property on the date of this report. Currently there are 6 competing homes listed for sale (0 REO, 0 short sales). In the past 12 months, there have been 58 closed MLS transactions in this area. This indicates a shortage of listings, assuming 90 days on market. Average days on market time was 30 days with range 2-263 days. Average sale price was 99% of final list price.
Local Economy	Stable	
Sales Prices in this Neighborhood	Low: \$349507 High: \$488800	
Market for this type of property	Increased 3 % in the past 6 months.	
Normal Marketing Days	<30	

Current Listings

	Subject	Listing 1	Listing 2 *	Listing 3
Street Address	5588 Vision Quest Court	5290 Paiute Pine Ct	5578 Fewkes Canyon Ct	5865 Enchanted Palms Ave
City, State	Las Vegas, NEVADA	Las Vegas, NV	Las Vegas, NV	Las Vegas, NV
Zip Code	89139	89139	89139	89139
Datasource	Public Records	MLS	MLS	MLS
Miles to Subj.	--	0.29 ¹	0.54 ¹	0.43 ¹
Property Type	SFR	SFR	SFR	SFR
Original List Price \$	\$	\$399,900	\$455,000	\$485,000
List Price \$	--	\$399,900	\$455,000	\$485,000
Original List Date		07/26/2024	08/02/2024	08/08/2024
DOM · Cumulative DOM	-- · --	27 · 27	5 · 20	14 · 14
Age (# of years)	20	18	18	23
Condition	Average	Average	Average	Average
Sales Type	--	Fair Market Value	Fair Market Value	Fair Market Value
Location	Neutral ; Residential	Neutral ; Residential	Neutral ; Residential	Neutral ; Residential
View	Neutral ; Residential	Neutral ; Residential	Neutral ; Residential	Neutral ; Residential
Style/Design	2 Stories Bi-level	2 Stories Bi-level	2 Stories Bi-level	2 Stories Bi-level
# Units	1	1	1	1
Living Sq. Feet	1,855	1,125	1,846	2,001
Bdrm · Bths · ½ Bths	3 · 2 · 1	3 · 2	4 · 2 · 1	4 · 2 · 1
Total Room #	5	5	8	9
Garage (Style/Stalls)	Attached 2 Car(s)	Attached 2 Car(s)	Attached 2 Car(s)	Attached 2 Car(s)
Basement (Yes/No)	No	No	No	No
Basement (% Fin)	0%	0%	0%	0%
Basement Sq. Ft.	--	--	--	--
Pool/Spa	--	--	--	--
Lot Size	0.07 acres	0.08 acres	0.09 acres	0.11 acres
Other	No Fireplace	No Fireplace	No Fireplace	1 Fireplace

* Listing 2 is the most comparable listing to the subject.

¹ Comp's "Miles to Subject" was calculated by the system.

² Comp's "Miles to Subject" provided by Real Estate Professional.

³ Subject \$/ft based upon as-is sale price.

Listing Comments Why the comparable listing is superior or inferior to the subject.

Listing 1 Not under contract. Owner occupied property when listed. Identical in bedrooms, condition, garage capacity and nearly identical in age. It is inferior in square footage, baths, but is superior in lot size. This property is inferior to subject property.

Listing 2 Under contract, will be FHA sale. Vacant property when listed. Identical in baths, condition, garage capacity, no fireplace and nearly identical in square footage and age. It is superior in lot size. This property is slightly superior to subject property.

Listing 3 Not under contract. Tenant occupied property, leased for \$1,940/month when listed. Identical in baths, condition, garage capacity and nearly identical in age. It is superior in square footage, lot size and fireplace. This property is superior to subject property.

Recent Sales

	Subject	Sold 1	Sold 2 *	Sold 3
Street Address	5588 Vision Quest Court	7410 Aurora Glow St	7413 Treasure Chest St	7471 Jacaranda Leaf St
City, State	Las Vegas, NEVADA	Las Vegas, NV	Las Vegas, NV	Las Vegas, NV
Zip Code	89139	89139	89139	89139
Datasource	Public Records	MLS	MLS	MLS
Miles to Subj.	--	0.07 ¹	0.19 ¹	0.26 ¹
Property Type	SFR	SFR	SFR	SFR
Original List Price \$	--	\$425,000	\$420,000	\$489,000
List Price \$	--	\$425,000	\$420,000	\$489,000
Sale Price \$	--	\$418,000	\$420,000	\$488,000
Type of Financing	--	Cash	Fha	Fha
Date of Sale	--	05/10/2024	07/09/2024	06/04/2024
DOM · Cumulative DOM	-- · --	56 · 72	15 · 62	9 · 26
Age (# of years)	20	21	21	20
Condition	Average	Average	Average	Good
Sales Type	--	Fair Market Value	Fair Market Value	Fair Market Value
Location	Neutral ; Residential	Neutral ; Residential	Neutral ; Residential	Neutral ; Residential
View	Neutral ; Residential	Neutral ; Residential	Neutral ; Residential	Neutral ; Residential
Style/Design	2 Stories Bi-level	2 Stories Bi-level	2 Stories Bi-level	2 Stories Bi-level
# Units	1	1	1	1
Living Sq. Feet	1,855	1,668	1,668	2,001
Bdrm · Bths · ½ Bths	3 · 2 · 1	3 · 2 · 1	3 · 2 · 1	3 · 2 · 1
Total Room #	5	6	6	9
Garage (Style/Stalls)	Attached 2 Car(s)	Attached 2 Car(s)	Attached 2 Car(s)	Attached 2 Car(s)
Basement (Yes/No)	No	No	No	No
Basement (% Fin)	0%	0%	0%	0%
Basement Sq. Ft.	--	--	--	--
Pool/Spa	--	--	--	--
Lot Size	0.07 acres	0.08 acres	0.08 acres	0.09 acres
Other	No Fireplace	1 Fireplace	1 Fireplace	1 Fireplace
Net Adjustment	--	+\$15,500	+\$15,500	-\$50,000
Adjusted Price	--	\$433,500	\$435,500	\$438,000

* Sold 2 is the most comparable sale to the subject.

¹ Comp's "Miles to Subject" was calculated by the system.

² Comp's "Miles to Subject" provided by Real Estate Professional.

³ Subject \$/ft based upon as-is sale price.

Recent Sales - Cont.

Reasons for Adjustments Why the comparable sale is superior or inferior to the subject.

- Sold 1** Cash sale. Vacant property when listed. Identical in bedrooms, baths, condition, garage capacity and nearly identical in age. It is inferior in square footage adjusted @ \$100/square foot \$18,700 but is superior in lot size adjusted @\$5/square foot (\$2,200) and fireplace (\$1,000).
- Sold 2** FHA sale. Vacant property when listed. Identical in bedrooms, baths, condition, garage capacity and nearly identical in age. It is inferior in square footage adjusted @ \$100/square foot \$18,700 but is superior in lot size adjusted @\$5/square foot (\$2,200) and fireplace (\$1,000).
- Sold 3** FHA sale. Vacant property when listed. Identical in bedrooms, baths, garage capacity and nearly identical in age. It is superior in square footage adjusted @ \$100/square foot (\$14,600), condition with new paint and carpet (\$30,000), lot size adjusted @ \$5/square foot (\$4,400) and fireplace (\$1,000).

Subject Sales & Listing History

Current Listing Status	Not Currently Listed			Listing History Comments			
Listing Agency/Firm				Sold as non MLS sale.			
Listing Agent Name							
Listing Agent Phone							
# of Removed Listings in Previous 12 Months	0						
# of Sales in Previous 12 Months	1						
Original List Date	Original List Price	Final List Date	Final List Price	Result	Result Date	Result Price	Source
--	--	--	--	Sold	08/16/2024	\$375,000	Tax Records

Marketing Strategy

	As Is Price	Repaired Price
Suggested List Price	\$439,900	\$439,900
Sales Price	\$436,000	\$436,000
30 Day Price	\$430,000	--
Comments Regarding Pricing Strategy		
Subject property should be priced near mid range of competing listings due to shortage of directly competing homes but slowing of pending sales in this area. This property is most like Sale #2 which sold for adsuted sales price of \$435,500. It was under contract in 15 days on market. Subject property would be expected to sell near high range of adjusted recently closed sales with 90 days on market.		

Clear Capital Quality Assurance Comments Addendum

Reviewer's Notes The broker's as-is conclusion reflects the market for the subject. Comps are within a reasonable distance, relatively current, and accurately reflect the subject's defining characteristics. Thus, the as-is conclusion appears to be adequately supported.

Subject Photos



Front



Address Verification



Side



Side



Street

Listing Photos

L1 5290 Paiute Pine Ct
Las Vegas, NV 89139



Front

L2 5578 Fewkes Canyon Ct
Las Vegas, NV 89139



Front

L3 5865 Enchanted Palms Ave
Las Vegas, NV 89139



Front

Sales Photos

S1 7410 Aurora Glow St
Las Vegas, NV 89139



Front

S2 7413 Treasure Chest St
Las Vegas, NV 89139



Front

S3 7471 Jacaranda Leaf St
Las Vegas, NV 89139



Front

ClearMaps Addendum

Address ★ 5588 Vision Quest Court, Las Vegas, NEVADA 89139
Loan Number 58229 **Suggested List** \$439,900 **Suggested Repaired** \$439,900 **Sale** \$436,000

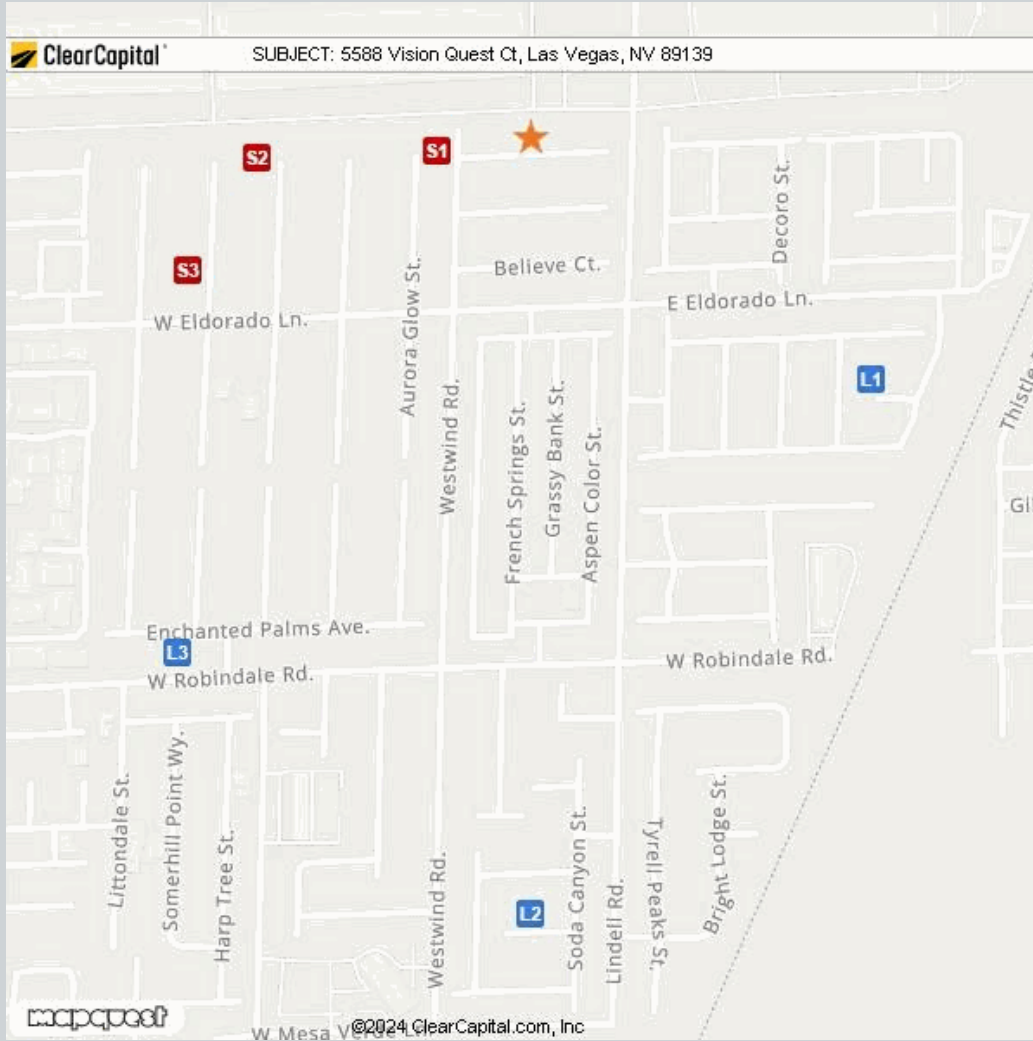

Comparable	Address	Miles to Subject	Mapping Accuracy
★ Subject	5588 Vision Quest Court, Las Vegas, Nevada 89139	--	Parcel Match
L1 Listing 1	5290 Paiute Pine Ct, Las Vegas, NV 89139	0.29 Miles ¹	Parcel Match
L2 Listing 2	5578 Fewkes Canyon Ct, Las Vegas, NV 89139	0.54 Miles ¹	Parcel Match
L3 Listing 3	5865 Enchanted Palms Ave, Las Vegas, NV 89139	0.43 Miles ¹	Parcel Match
S1 Sold 1	7410 Aurora Glow St, Las Vegas, NV 89139	0.07 Miles ¹	Parcel Match
S2 Sold 2	7413 Treasure Chest St, Las Vegas, NV 89139	0.19 Miles ¹	Parcel Match
S3 Sold 3	7471 Jacaranda Leaf St, Las Vegas, NV 89139	0.26 Miles ¹	Parcel Match

¹ The Comparable "Distance from Subject" value has been calculated by the Clear Capital system.

² The Comparable "Distance from Subject" value has been provided by the Real Estate Professional.

Addendum: Report Purpose

Market Approach and Market Time

The Market Approach of this report, as established by the customer, is: **Fair Market Price**. (See definition below.)

The Marketing Time as specified by the customer is **Typical**. (See definition below.)

Definitions:

Fair Market Price

A price at which the property would sell between a willing buyer and a willing seller neither being compelled by undue pressure and both having reasonable knowledge of relevant facts.

Distressed Price

A price at which the property would sell between a willing buyer and a seller acting under duress.

Marketing Time

The amount of time the property is exposed to a pool of prospective buyers before going into contract. The customer either specifies the number of days, requests a marketing time that is typical to the subject's market area and/or requests an abbreviated marketing time.

Typical for Local Market

The estimated time required to adequately expose the subject property to the market resulting in a contract of sale.

Addendum: Report Purpose - cont.

Report Instructions

This section shows the instructions that were approved by the customer and provided to the broker prior to completing the report.

Instructions last updated: 07/29/2024

Purpose:

Please determine a Fair market price for this property at which it would sell in a typical marketing time for the area.

Comparable Requirements:

If any of the following comparable criteria cannot be met, the commentary is required as to why you expanded your search, and what the effect on price will be.

1. Use comps from the same neighborhood, block or subdivision.
2. Use REO comparables only if the market is driven by REOs and they are comparable in characteristics and condition.
3. Use comps that have closed in the past 3 months to show the current market conditions. In rapidly changing markets, active listing comps should be given equal or greater weight than sold comps in your analysis.

Property Condition Definitions:

1. Poor: Uninhabitable or severely damaged from fire, flood, vandalism or mold
2. Fair: Repairs needed, may not be eligible for all forms of financing, below the neighborhood average
3. Average: Minor cosmetic or no repairs needed; typical for the neighborhood, move-in ready but no significant updates or renovations
4. Good: Above average, move in ready, no repairs necessary and has recent and significant updates and/or renovations (or, for customers that do not provide for 'Average', any move-in ready property)
5. Excellent: Newer construction (1-5 years) or high end luxury

Standard Instructions:

1. Clear Capital Code Of Conduct - Please make sure that you are always abiding by the Clear Capital Code of Conduct when completing valuation reports.
2. If the subject is currently listed, please consider all available information pertaining to the subject's condition. This information should be utilized when developing the assumption of the subject's condition.
3. Use the subject characteristics provided in the report Grid (if preloaded) to evaluate the property. This information is from a full interior appraisal and is assumed to be most accurate. If your inspection reveals obvious inaccuracies, please explain in the narrative of the report.
4. Include sufficient, factual detail to help our mutual customer gain a complete understanding of the subject's neighborhood such as substantiated distance to amenities, parks, schools, commercial or industrial influences, REO activity, traffic, etc.
5. Do not approach occupants or owners.
6. If the subject is a Commercial property, contact Clear Capital immediately at 530-582-5011 for direction on how to proceed with the report.
7. Please do not accept if you or your office has completed a report on this property in the last month, are currently listing this property, or have any vested interest in the subject property.
8. Clear Capital does not allow any log ins from IP addresses from foreign countries. This includes, but is not limited to; data entry services, form completion services, etc. Also, it is against Clear Capital code of conduct to share your password with anyone who is not a W2 employee in your office.
9. Clear Capital and our mutual customers greatly appreciate your expertise. If you cannot personally inspect the property, select comparables, and determine a price for the subject, please do not accept this report. Per the standards and guidelines adopted by Clear Capital and other industry leaders, the use of assistants to complete any of the aforementioned tasks is not permitted.
10. No part of your analysis or reporting may be based on the race, color, religion, sex, actual or perceived sexual orientation, actual or perceived gender identity, age, actual or perceived marital status, disability, familial status, national origin of either the prospective owners or occupants of the subject property, present owners or occupants of the property, or present owners or occupants of the properties in the vicinity of the subject property, or on any other basis prohibited by federal, state or local law.
11. When commenting on the subject property or comp selections, refrain from the use of unsupported or subjective terms to assess or rate, such as, but not limited to, "high," "low," "good," "bad," "fair," "poor," "strong," "weak," "rapid," "slow," "fast" or "average" without providing a foundation for analysis and contextual information. It is inappropriate to add language that could indicate unconscious bias, including but not limited to: "pride of ownership," "crime-ridden area," "desirable neighborhood or location" or "undesirable neighborhood or location"

Undue Influence Concerns

Please contact uiproducer@clearcapital.com for any Undue Influence concerns.

Independence Hotline

Please notify Clear Capital of any independence concerns by calling (530) 550-2138

Report Instructions - cont.

Terms of Use, Code of Conduct and Professional Discretion:

Due to the importance of an independent opinion of price, please do not discuss your price with anyone or be influenced by list price, pending offers, accept comp packets, repair estimates or the listing agent's opinion.

If you accept and perform this assignment, you do so in accordance with the Clear Capital Vendor Agreement Terms of Use and Code of Conduct to which you agreed.

All interactions with consumers (borrowers, homeowners, POCs, etc.) must be performed in a professional manner. Should you observe any concerning or suspicious activity while you engage with a consumer whether onsite or otherwise, please contact Clear Capital immediately. Please refrain from discussing anything related to the observation with the consumer directly. This includes suspected elder abuse, elder financial abuse, vulnerable adults, fraud, forgery or any violations of local, state or federal laws.

1. One current, original photo of the front of the subject 2. One address verification photo 3. One street scene photo looking down the street 4. MLS listing and sold comp photos required, please comment if no MLS.

Broker Information

Broker Name	Linda Bothof	Company/Brokerage	Linda Bothof
License No	B.0056344.INDV	Address	8565 S Eastern Ave Las Vegas NV 89123
License Expiration	05/31/2026	License State	NV
Phone	7025248161	Email	lbothof7@gmail.com
Broker Distance to Subject	5.65 miles	Date Signed	08/22/2024

By confirming the above contact and real estate license information and submitting the report, the above signed hereby certifies and agrees that: 1) I personally took the pictures, selected comparables, and determined the price conclusion. 2) To the best of my knowledge, the statements of fact contained in this report are true and correct. 3) The reported analyses, opinions, and conclusions are my personal, impartial, and unbiased professional analyses, opinions, and conclusions. 4) I have no present or prospective interest in the property that is the subject of this report and no personal interest with respect to the parties involved. 5) I have no bias with respect to the property that is the subject of this report or to the parties involved with this assignment. 6) My compensation for completing this assignment is not contingent upon the development or reporting of a predetermined price point. 7) I did not base, either partially or completely, my analysis and/or opinion and conclusions in this report on race, color, religion, sex, age, marital status, handicap, familial status, or national origin of either the prospective owners or occupants of the subject property or of the present owners or occupants of the properties in the vicinity of the subject property or on any other basis prohibited by law. 8) I maintain errors and omissions insurance, to the extent required by state law, for all liability associated with the preparation of this Report.

Disclaimer

Notwithstanding any preprinted language to the contrary, this opinion is not an appraisal of the market value of the property. If an appraisal is desired, the services of a licensed or certified appraiser must be obtained.

Unless otherwise specifically agreed to in writing:

The intended purpose of this report is to assist the Clear Capital account holder in making decisions within the scope of applicable statutory and regulatory requirements and performing required due diligence. This document is provided solely for the use of the Clear Capital account holder and not any other party, is not intended as any guarantee of value and/or condition of the subject property and should not be relied on as such. In the event that this document is found to be defective, incorrect, negligently prepared or unfit for its authorized use, Clear Capital's sole liability shall be to promptly refund the total fee expended by the account holder for this report or to replace it at no charge to the account holder, but in no event shall Clear Capital be responsible to the account holder for any indirect or consequential damages whatsoever. This warranty is in lieu of all other warranties, express or implied, except where otherwise required by law. The account holder shall notify Clear Capital within thirty (30) days of this report's delivery to the account holder if it believes that this document is defective, incorrect, negligently prepared or unfit for its authorized use. Under no circumstances may Clear Capital forms or their contents be published, copied, replicated, or mimicked.